

BARRON SWIM SCHOOL

INDEX

REVISIONS

		1	2	3	4	5	6	7	8	9
C1.0	COVER SHEET									
C2.0	NOTE SHEET (O'FALLON)									
C2.1	NOTE SHEET (COLE)									
C3.0	DEMOLITION PLAN									
C4.0	SITE PLAN									
C4.1	HORIZONTAL CONTROL PLAN									
C5.0	GRADING PLAN									
C6.0	UTILITY PLAN									
C6.1	STORM SEWER PROFILE									
C6.2	UTILITY DETAILS									
C6.3	UTILITY DETAILS									
C7.0	SWPPP									
C7.1	SWPPP NOTES									
C7.2	SWPPP DETAILS									
C8.0	CONSTRUCTION DETAILS									
C8.1	CONSTRUCTION DETAILS									
C8.2	CONSTRUCTION DETAILS									
C9.0	DRAINAGE AREA MAP									
L1.0	LANDSCAPE PLAN									

CALEDONIA CENTER, LOT 9A
330 MIDFIELD CIRCLE
O'FALLON, MO 63368

AS-BUILT CONSTRUCTION DOCUMENTS



LOCATION MAP
(NOT TO SCALE)

The existing sewer length, sizes, flowlines, depths of sewer structures, and spot elevations have been measured to define the location and elevation of improvements. The results of those measurements are shown on this Final Measurement plan.

Brian Higgins

Brian G. Higgins, P.L.S.
Missouri
License No. 2013020064
Date: 10/12/2022

MD SURVEYING LLC (AGENT)

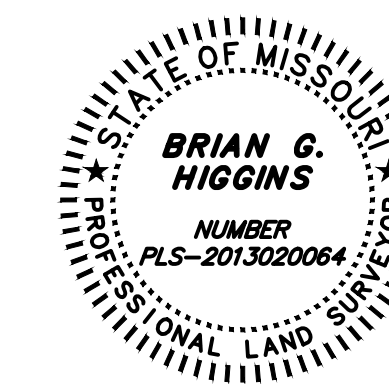

DESIGN AND DEVELOPMENT CONTACTS

CIVIL ENGINEER	COLE & ASSOCIATES, INC. 1520 SOUTH FIFTH STREET, SUITE 307 ST. CHARLES, MO 63303 (636) 978-7508 CONTACT: CHRIS WILSON
ARCHITECT	HOENER ASSOCIATES, INC. 6707 PLAINVIEW AVENUE ST. LOUIS, MO 63109 (314) 781-9855 CONTACT: MATT MCDERMOTT
SURVEYOR	COLE & ASSOCIATES, INC. 1520 SOUTH FIFTH STREET, SUITE 307 ST. CHARLES, MO 63303 (636) 978-7508 CONTACT: TERRY WESTERMAN
LANDSCAPE ARCHITECT	COLE & ASSOCIATES, INC. 1520 SOUTH FIFTH STREET, SUITE 307 ST. CHARLES, MO 63303 (636) 978-7508 CONTACT: JOE HORVATH

STORMWATER NOTE

STORMWATER DETENTION AND WATER QUALITY HAVE BEEN PROVIDED WITH THE LARGER CALEDONIA DEVELOPMENT.

PLANNING AND ZONING COMMISSION CONDITIONS FOR APPROVAL

- PROVIDE A PASSIVE ENTRANCE ON THE DUMPSTER
- A BOUNDARY ADJUSTMENT PLAT WILL NEED TO BE APPROVED BEFORE THE SITE PLAN CAN BE APPROVED
- PROVIDE STREET LIGHTING FOR THE INTERNAL DRIVE AISLE. THE PARKING LOT LIGHTING CAN BE EXTENDED TO COVER THE ROAD.
- THE DUMPSTER, A CORNER OF THE BUILDING AND PARKING SPOTS ARE WITHIN THE PERMANENT SLOPE EASEMENT. PROVIDE MODOT APPROVAL TO EITHER BUILD WITHIN THE EASEMENT, OR HAVE MODOT VACATE THE EASEMENT.
- PROVIDE INTERNAL LOT LINE EASEMENTS,

UTILITY INFORMATION

UTILITIES SHOWN HAVE BEEN TAKEN FROM AVAILABLE SURVEYS, UTILITY COMPANY MAPS AND PHYSICAL PROPERTY INSPECTION. THE LOCATIONS AND FACILITIES SHALL BE CONSIDERED APPROXIMATE ONLY. THERE MAY BE ADDITIONAL UTILITIES THAT HAVE NOT BEEN SHOWN ON THIS SURVEY. THE CONTRACTOR WILL BE RESPONSIBLE FOR THE LOCATIONS OF ALL UTILITIES PRIOR TO EXCAVATION OR CONSTRUCTION.



CALL 1-800-DIG-RITE (MISSOURI ONE CALL) TO HAVE LOCATIONS MARKED IN THE FIELD (SUBSCRIBING UTILITIES REQUIRE 48 HOURS NOTICE PRIOR TO CONSTRUCTION).

Planning File # 21-002774
Approved with Conditions on 5/6/2021

LEGEND

EXISTING		PROPOSED
460 459 +620.15	CONTOURS	460 459 +621.25 (TOP OF CURB) (FINISH PAVEMENT)
	SPOT GRADE	
	TREE LINE	
	TREE	
	BUSH	
	STORM MANHOLE	
	AREA INLET	
	CURB INLET	
	GRATED INLET	
	FLARED END SECTION	
12" RCP	STORM SEWER	
	GRATED MANHOLE	
	STORM DESIGNATOR	
	DOWNSPOUT	
	DRAINAGE PIPE	
	SWALE/SLOPE INDICATOR	
8" VCP	SANITARY MANHOLE	
	SANITARY SEWER	
	CLEAN OUT	
	SANITARY DESIGNATOR	
	UTILITY POLE	
	GUY WIRE	
	OVERHEAD UTILITY	
UE	UNDERGROUND ELECTRIC	
	ELECTRIC MARKER	
	ELECTRIC METER	
	ELECTRIC BOX	
	ELECTRIC PULL BOX	
	ELECTRIC TRANSFORMER	
	ELECTRIC MANHOLE	
	UNDERGROUND TELEPHONE	
	FIBER OPTIC MARKER	
	CABLE MARKER	
	GAS LINE	
	GAS VALVE	
	GAS METER	
	GAS MARKER	
	WATER LINE	
	WATER VALVE	
	WATER METER	
	FIRE HYDRANT	
	SIGN	
	MAIL BOX	
	TEST HOLE	
	LIGHT STANDARD	
	FENCE	
	BOLLARD	
	RETAINING WALL	
	CONCRETE PAVEMENT	
	SILTATION FENCE	
	AIR CONDITIONER	
	FLAG POLE	
	MONITORING WELL	
	PARKING METER	
	PLANTER	
	SPRINKLER CONTROL BOX	
	SPRINKLER	
	SPRINKLER VALVE	
	TRAFFIC CONTROL BOX	
	TRAFFIC POLE	
	YARD LIGHT	
	GUARD RAIL	
	PROPERTY LINE	
	EASEMENT	
	SETBACK	
	INLET PROTECTION	
	WATTLE	
	CHECK DAM	
	USE IN PLACE	(UIP)
	TO BE REMOVED	(TBR)
	ADJUST TO GRADE	(ATG)
	TO BE REMOVED & RELOCATED	(TBR&R)
	TYPICAL	(TYP)
	NOT TO SCALE	N.T.S.
	HIGH POINT IN GRADE	HP
	LOW POINT IN GRADE	LP
	TOP OF WALL	TW
	BOTTOM OF WALL	BW
	NOT IN CONTRACT	(NIC)

PERTINENT DATA

SITE DATA	
CURRENT ZONING DISTRICT	C-2, GENERAL BUSINESS
PROPOSED ZONING DISTRICT	C-2, GENERAL BUSINESS
FEMA MAP PANEL	ZONE X PER FEMA MAP 29183C0410G, DATE: 01/20/2016
WETLANDS	NONE

AREA CALCULATIONS

BUILDING AREA	12,000 S.F. (15%)
IMPERVIOUS AREA	43,991 S.F. (56%)
PERVIOUS AREA	23,204 S.F. (29%)
TOTAL SITE AREA	79,195 S.F.

UTILITIES

GAS SERVICE	SPIRE 6400 GRAHAM RD ST. LOUIS, MO 63134 314-522-2297	PHONE SERVICE	AT&T 12930 OLIVE ST. ST. LOUIS, MO 63141 314-275-0025
WATER SERVICE	PUBLIC WATER SUPPLY DIST. 2 100 WATER DRIVE O'FALLON, MO 63366 636-561-3737	SANITARY SEWER SERVICE	DUCKETT CREEK SANITARY DISTRICT 3550 HIGHWAY K O'FALLON, MO 63368 636-441-1244
ELECTRIC SERVICE	CUIVRE RIVER ELECTRIC CO. BOX 160 TROY, MO 63379 1-800-392-3709	STORM SEWER SERVICE	CITY OF O'FALLON 100 N. MAIN ST. O'FALLON, MO 63366 636-281-2858
FIRE DISTRICT	WENTZVILLE FIRE DISTRICT 502 LUETKENHAUS BOULEVARD WENTZVILLE, MO 63385 636-332-9869	COMMUNICATIONS SERVICE	CHARTER COMMUNICATIONS 815 CHARTER COMMONS TOWN AND COUNTRY, MO 63107 314-275-0025

SITE BENCHMARK

BENCHMARK INFORMATION:
NAVD 88 ELEVATION = 503.51 - "X" CUT IN SOUTHWEST CORNER OF NORTH ABUTMENT OF BOX CULVERT UNDER PHOENIX PARKWAY EAST OF THE ENCLAVE AT WINGHAVEN APARTMENTS.

SITE BENCHMARK:
NAVD 88 ELEVATION = 562.70, SQUARE IN THE CONCRETE BASE OF A LIGHT POLE LOCATED IN THE NORTHERN MOST PARKING ISLAND 35 FEET OF THE EAST CURB LINE OF THE SIDEWALK ON THE EAST SIDE OF THE MOVIE THEATER BUILDING.

DEVELOPER/OWNER:
BARRON SWIM SCHOOL
1158 LINDBERGH BUSINESS CT.
ST. LOUIS, MO 63123

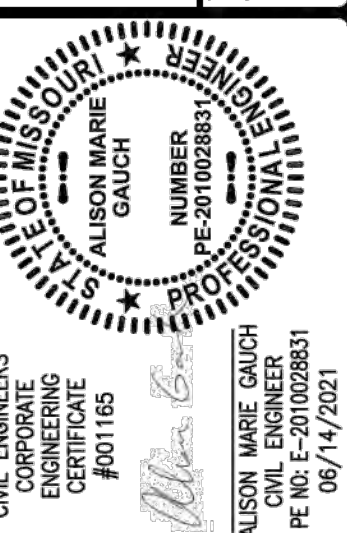

BARRON SWIM SCHOOL
CALEDONIA CENTER, LOT 9A
O'FALLON, MO 63368
COVER SHEET



DESIGN/CALC BY
CAW
DRAWN BY
CAW
CHECKED BY
AMG
DRAWING SCALE
AS SHOWN
DATE
06/14/21
Job Number
21-0036-000A
Sheet Number
C1.0

STATE HIGHWAY DD (VARIABLE WIDTH)

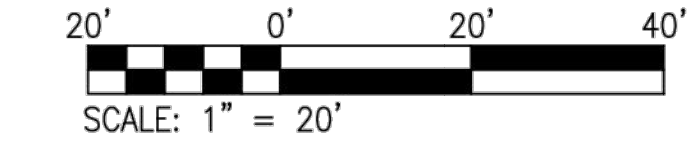

GRADING ABBREVIATIONS

- BC BOTTOM OF CURB FACE
- BW BOTTOM OF WALL
- EC EDGE OF CONCRETE
- FF FINISHED FLOOR
- FG FINISHED GRADE
- HP HIGH POINT
- LP LOW POINT
- ME MATCH EXISTING
- TC TOP OF CURB FACE
- TP TOP OF PAVEMENT
- TW TOP OF WALL

AS-BUILT

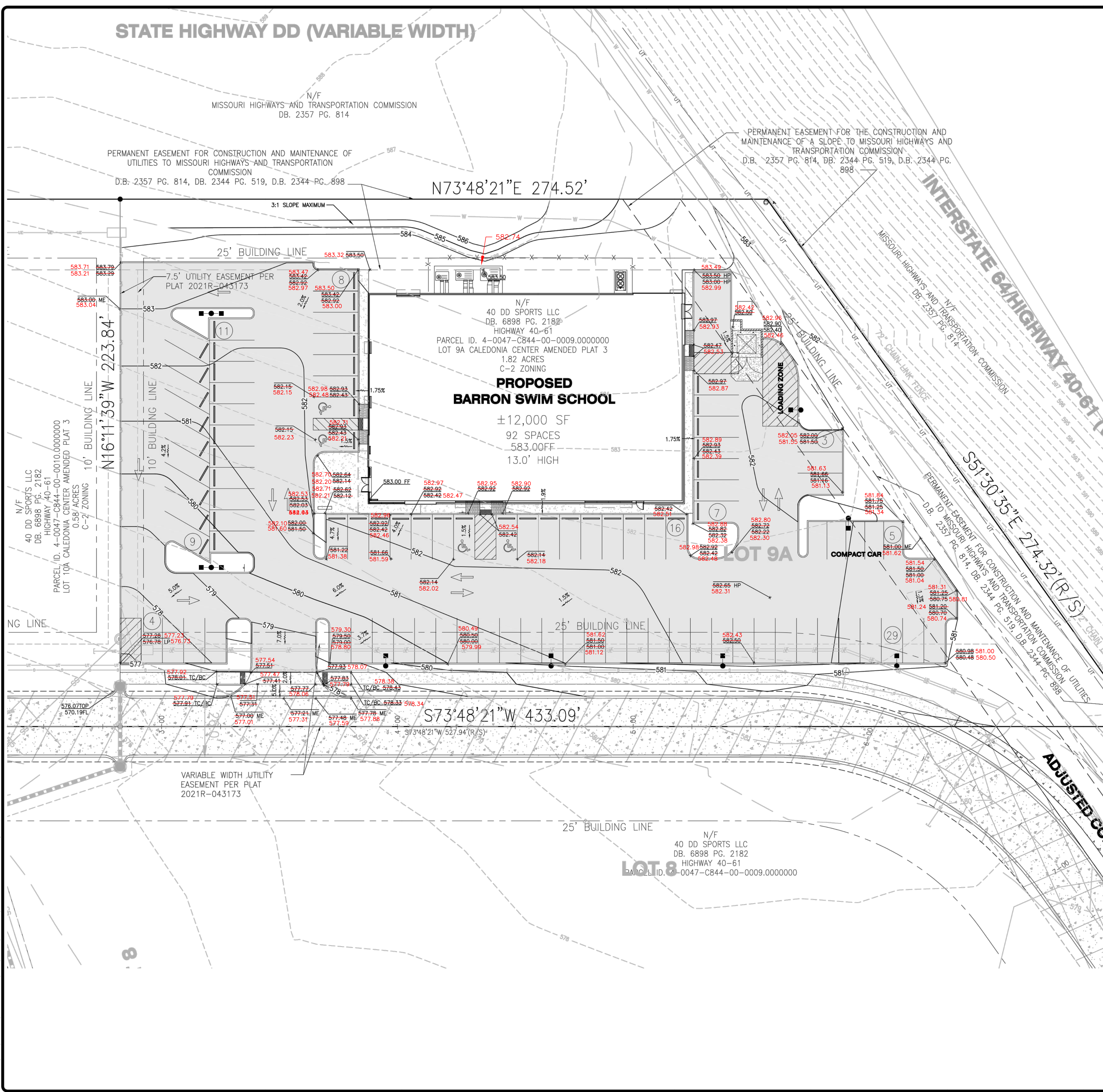

NO	REVISION DESCRIPTION	DATE

DEVELOPER/OWNER:
BARRON SWIM SCHOOL
 1158 LINDBERGH BUSINESS CT.
 ST. LOUIS, MO 63123

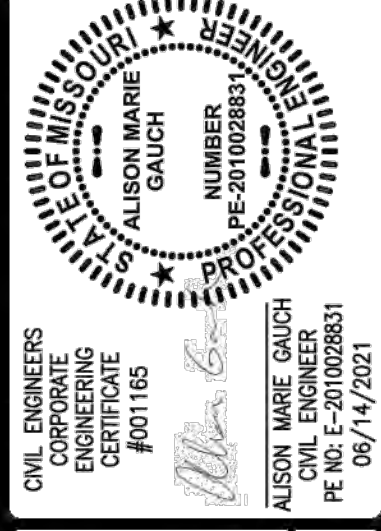

BARRON SWIM SCHOOL
 CALEDONIA CENTER, LOT 9A
 OF FALLON, MO 63368



DESIGN/CALC BY	CAW
DRAWN BY	CAW
CHECKED BY	AMG
DRAWING SCALE	AS SHOWN
DATE	06/14/21
Job Number	21-0036-000A
Sheet Number	C5.0

The existing sewer length, sizes, flowlines, depths of sewer structures, and spot elevations have been measured to define the location and elevation of improvements. The results of those measurements are shown on this Final Measurement plan.

Brian Higgins
 Brian G. Higgins, P.L.S. Missouri
 License No. 2013020064
 Date: 10/12/2022

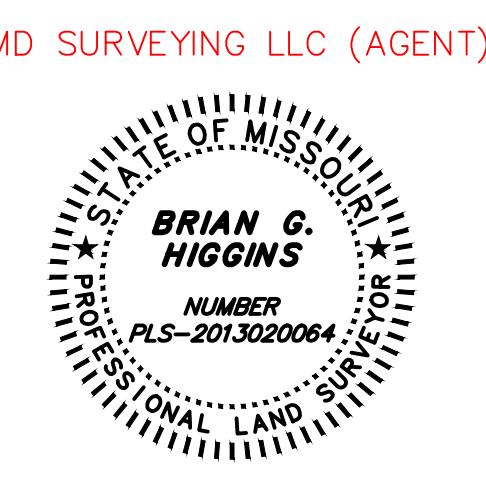

USER: Alison Gauch TAB: C5.0 GRADE
 DATE: June 15, 2021 - 2:43:53 PM
 DRAWING: S:\0085\Jobs\2021\21-0036-000A\0000\C-Plan\Grading\01-PLAN_C5.0E-21-0036.dwg

STATE HIGHWAY DD (VARIABLE WIDTH)

AS-BUILT

The existing sewer length, sizes, flowlines, depths of sewer structures, and spot elevations have been measured to define the location and elevation of improvements. The results of those measurements are shown on this Final Measurement plan.

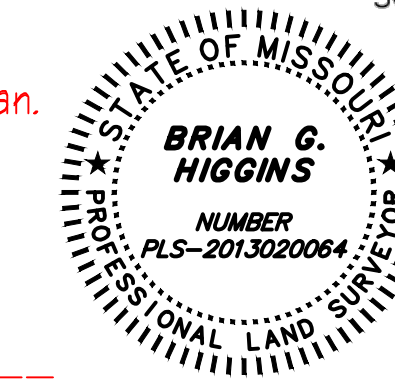
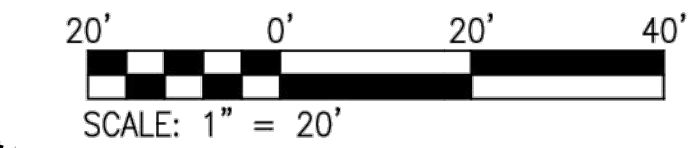

Brian Higgins

Brian G. Higgins, P.L.S.
Missouri
License No. 2013020064
Date: 10/12/2022
MD SURVEYING LLC (AGENT)

N/F MISSOURI HIGHWAYS AND TRANSPORTATION COMMISSION DB. 2357 PG. 814

PERMANENT EASEMENT FOR CONSTRUCTION AND MAINTENANCE OF UTILITIES TO MISSOURI HIGHWAYS AND TRANSPORTATION COMMISSION D.B. 2357 PG. 814, DB. 2344 PG. 519, D.B. 2344 PG. 898

PERMANENT EASEMENT FOR THE CONSTRUCTION AND MAINTENANCE OF A SLOPE TO MISSOURI HIGHWAYS AND TRANSPORTATION COMMISSION D.B. 2357 PG. 814, DB. 2344 PG. 519, D.B. 2344 PG. 898

INTERSTATE 64 HIGHWAY 40-61 (VARIABLE WIDTH)
MISSOURI HIGHWAYS AND TRANSPORTATION COMMISSION
N/F MISSOURI HIGHWAYS AND TRANSPORTATION COMMISSION DB. 2357 PG. 814
72' CHAIN LINK FENCE
PERMANENT EASEMENT FOR CONSTRUCTION AND MAINTENANCE OF UTILITIES TO MISSOURI HIGHWAYS AND TRANSPORTATION COMMISSION D.B. 2357 PG. 814, DB. 2344 PG. 519, D.B. 2344 PG. 898
S51°30'35"E 274.32'(R/S) 2' CHAIN LINK FENCE

25' BUILDING LINE

7.5' UTILITY EASEMENT PER PLAT 2021R-043173

N73°48'21"E 274.52'

PROPOSED
BARRON SWIM SCHOOL
±12,000 SF
92 SPACES
583.00FF
13.0' HIGH

N/F 40 DD SPORTS LLC DB. 6898 PG. 2182 HIGHWAY 40-61
PARCEL ID. 4-0047-C844-00-0010.0000000 LOT 9A CALEDONIA CENTER AMENDED PLAT 3 1.82 ACRES C-2 ZONING

N16°11'39"W 223.84'

10' BUILDING LINE

NG LINE

25' BUILDING LINE

S73°48'21"W 433.09'

VARIABLE WIDTH UTILITY EASEMENT PER PLAT 2021R-043173

N/F 40 DD SPORTS LLC DB. 6898 PG. 2182 HIGHWAY 40-61
PARCEL ID. 4-0047-C844-00-0009.0000000 LOT 8

25' BUILDING LINE

ADJUSTED COMMON BOUNDARY

DUCKETT CREEK SANITARY DISTRICT NOTES:

- 1. EXISTING SANITARY SEWER SERVICE SHALL NOT BE INTERRUPTED.
2. CONNECTION TO DUCKETT CREEK SANITARY DISTRICT (DCSD) SANITARY MAIN REQUIRES DCSD INSPECTION. CONTACT THE DCSD INSPECTION DEPARTMENT AT 636-441-1244 TO SCHEDULE INSPECTION. 48 HOUR ADVANCE NOTICE IS REQUIRED.
3. CONNECTION TO DCSD MANHOLE AND CAPPING OF PROPOSED LATERAL STUB REQUIRE DCSD INSPECTION. CONTACT THE DCSD INSPECTION DEPARTMENT AT 636-441-1244 TO SCHEDULE INSPECTION. A 48 HOUR ADVANCE NOTICE IS REQUIRED.

PUBLIC WATER SUPPLY DISTRICT NOTES:

- 1. ALL METER PITS/VAULTS/DETECTOR CHECKS MUST BE INSTALLED IN GREENSPACE PER THE WATER DISTRICTS SPECIFICATIONS..
2. ALL CONSTRUCTION AND INSTALLATION MUST BE PER THE WATER DISTRICTS GUIDELINES AND SPECIFICATIONS.
3. ANY CITY OR MODOT PERMITS REQUIRED ALONG THE ROADWAYS ARE THE RESPONSIBILITY OF THE CONTRACTOR TO OBTAIN PRIOR TO CONSTRUCTION.
4. ALL OFFSITE RESTORATION MUST BE SODDED UNLESS OTHERWISE SPECIFIED BY THE PROPERTY OWNERS.
5. THE WATER DISTRICT REQUIRES ONE (1) WEEK NOTICE BEFORE THE START OF CONSTRUCTION.
6. PROPOSED FIRE LANE WILL NEED INSTALLED AND TESTED PER THE WATER DISTRICTS SPECIFICATIONS BEFORE IT CAN BE PUT INTO SERVICE.

KEYED NOTES

- GAS SERVICE
1. NEW GAS SERVICE POINT OF CONNECTION. ALL MATERIAL AND INSTALLATION BY SPIRE AT THE CONTRACTOR'S EXPENSE. THE CONTRACTOR SHALL CONTACT SPIRE AS SOON AS POSSIBLE TO ACCOMMODATE REQUIRED LEAD TIME FOR DESIGN AND COORDINATION OF THE NEW SERVICE.
2. NEW GAS SERVICE. ALL MATERIAL AND INSTALLATION BY SPIRE AT THE CONTRACTOR'S EXPENSE.
3. NEW GAS METER. ALL MATERIAL AND INSTALLATION BY SPIRE AT THE CONTRACTOR'S EXPENSE.
4. REFER TO ARCHITECTURAL PLANS FOR EXACT LOCATION AND CONTINUATION OF GAS SERVICE.
WATER SERVICE
5. 8" WATER MAIN TO BE CONSTRUCTED UNDER SEPARATE PROJECT.
6. NEW FIRE HYDRANT TO BE CONSTRUCTED UNDER SEPARATE PROJECT.
7. NEW WET TAP WITH VALVE. ALL MATERIAL AND INSTALLATION BY PSWD NO.2 AT THE CONTRACTOR'S EXPENSE. THE CONTRACTOR SHALL CONTACT PSWD NO.2 AS SOON AS POSSIBLE TO ACCOMMODATE REQUIRED LEAD TIME FOR DESIGN AND COORDINATION OF THE NEW SERVICE.
8. NEW 2" PVC DOMESTIC WATER SERVICE (PRIVATE) WITH 36" MINIMUM COVER.
9. NEW 2" DOMESTIC WATER METER AND 36" POLY METER PIT (PER PSWD NO.2 STANDARDS). PSWD NO.2 TO PROVIDE AND SET THE METER AT THE CONTRACTOR'S EXPENSE. THE CONTRACTOR SHALL BE RESPONSIBLE FOR ALL OTHER MATERIAL AND INSTALLATION.
10. REFER TO ARCHITECTURAL PLANS FOR EXACT LOCATION AND CONTINUATION OF DOMESTIC WATER SERVICE.
11. NEW 6" C900 FIRE SERVICE (PRIVATE) WITH DETECTOR CHECK IN PYRAMID BOX, 36" MINIMUM COVER. FINAL FIRE SERVICE LINE SIZE SHALL BE VERIFIED BY THE FIRE SPRINKLER CONTRACTOR PRIOR TO THE START OF CONSTRUCTION.
12. NEW 11.25' BEND WITH CONCRETE THRUST BLOCK (PER PSWD NO.2 STANDARDS).
13. NEW 45' BEND WITH CONCRETE THRUST BLOCK (PER PSWD NO.2 STANDARDS).
14. NEW 90' BEND WITH CONCRETE THRUST BLOCK (PER PSWD NO.2 STANDARDS).
15. NEW FIRE DEPARTMENT CONNECTION, 108"± FROM NEW HYDRANT ALONG MIDFIELD CIRCLE DR. REFER TO ARCHITECTURAL PLANS.
16. REFER TO ARCHITECTURAL PLANS FOR EXACT LOCATION AND CONTINUATION OF FIRE SERVICE.
17. NEW IRRIGATION SERVICE (DESIGN BY OTHERS).
18. NEW 1" IRRIGATION METER AND PIT (PER PSWD NO.2 STANDARDS). PSWD NO.2 TO PROVIDE AND SET THE METER AT THE CONTRACTOR'S EXPENSE. THE CONTRACTOR SHALL BE RESPONSIBLE FOR ALL OTHER MATERIAL AND INSTALLATION.
19. REFER TO ARCHITECTURAL PLANS FOR EXACT LOCATION AND CONTINUATION OF IRRIGATION SERVICE.
ELECTRIC SERVICE
20. UNDERGROUND ELECTRIC SERVICE TO BE CONSTRUCTED UNDER SEPARATE PROJECT. NEW ELECTRIC SERVICE POINT OF CONNECTION. ALL MATERIAL AND INSTALLATION BY CUIVRE RIVER ELECTRIC AT THE CONTRACTOR'S EXPENSE. THE CONTRACTOR SHALL CONTACT CUIVRE RIVER ELECTRIC AS SOON AS POSSIBLE TO ACCOMMODATE REQUIRED LEAD TIME FOR DESIGN AND COORDINATION OF THE NEW SERVICE.
21. NEW PRIMARY UNDERGROUND ELECTRIC SERVICE. CUIVRE RIVER ELECTRIC SHALL SIZE CONDUIT AND PROVIDE AND PULL CONDUCTOR AT THE CONTRACTOR'S EXPENSE. THE CONTRACTOR SHALL BE RESPONSIBLE FOR PROVIDING AND INSTALLING THE CONDUIT.
22. NEW GROUND MOUNTED TRANSFORMER (PER CUIVRE RIVER ELECTRIC STANDARDS). CUIVRE RIVER ELECTRIC TO PROVIDE AND INSTALL THE TRANSFORMER. THE CONTRACTOR SHALL BE RESPONSIBLE FOR PROVIDING AND INSTALLING THE CONCRETE PAD (CUIVRE RIVER ELECTRIC STANDARDS).
23. NEW SECONDARY UNDERGROUND ELECTRIC SERVICE. ELECTRIC UTILITY TO SIZE CONDUIT AND CONDUCTOR. THE CONTRACTOR SHALL BE RESPONSIBLE FOR ALL MATERIAL AND INSTALLATION.
24. REFER TO ARCHITECTURAL PLANS FOR EXACT LOCATION AND CONTINUATION OF ELECTRIC SERVICE.
COMMUNICATIONS SERVICE
25. NEW COMMUNICATIONS SERVICE POINT OF CONNECTION. ALL MATERIAL AND INSTALLATION BY AT&T AT THE CONTRACTOR'S EXPENSE. THE CONTRACTOR SHALL CONTACT AT&T AS SOON AS POSSIBLE TO ACCOMMODATE REQUIRED LEAD TIME FOR DESIGN AND COORDINATION OF THE NEW SERVICE.
26. NEW (1) 2" PVC AND (1) 4" PVC COMMUNICATION SERVICE CONDUIT. THE CONTRACTOR SHALL BE RESPONSIBLE FOR PROVIDING AND INSTALLING THE CONDUIT AND PULLWIRE. ALL OTHER MATERIAL AND INSTALLATION BY AT&T AT THE CONTRACTOR'S EXPENSE.
27. REFER TO ARCHITECTURAL PLANS FOR EXACT LOCATION AND CONTINUATION OF COMMUNICATIONS SERVICE.
SANITARY SEWER SERVICE
28. 8" SANITARY SEWER TO BE CONSTRUCTED UNDER SEPARATE PROJECT.
29. NEW SANITARY SEWER SERVICE POINT OF CONNECTION (PER DUCKETT CREEK STANDARDS, INVERT ELEVATION = 568.03).
30. NEW 8" PVC SANITARY SEWER SERVICE WITH 1.0% MINIMUM SLOPE AND 36" MINIMUM COVER.
31. NEW SANITARY SEWER CLEANOUT. REFER TO DETAIL ON SHEET C6.2.
32. NEW SANITARY SEWER POINT OF BUILDING ENTRY (INVERT ELEVATION = 576.50). REFER TO ARCHITECTURAL PLANS FOR EXACT LOCATION AND CONTINUATION OF SANITARY SEWER SERVICE.
STORM SEWER SERVICE
33. NEW 12" STORM SEWER. REFER TO STORM SEWER PROFILES ON SHEET C6.1.
34. NEW GRATED INLET WITH SIDE INTAKE STORM SEWER STRUCTURE WITH DRAIN MARKER PER DETAIL ON SHEET C6.2. REFER TO STORM SEWER PROFILES ON SHEET C6.1.
MISCELLANEOUS ITEMS
35. NEW BUILDING MECHANICAL EQUIPMENT SCREENED BY 8' HIGH VINYL SIGHT-PROOF FENCE. REFER TO ARCHITECTURAL PLANS.
36. THE CONTRACTOR SHALL MAINTAIN 18" MINIMUM VERTICAL CLEARANCE AT ALL UTILITY CROSSINGS.

DEVELOPER/OWNER: BARRON SWIM SCHOOL 1158 LINDBERGH BUSINESS CT. ST. LOUIS, MO 63123

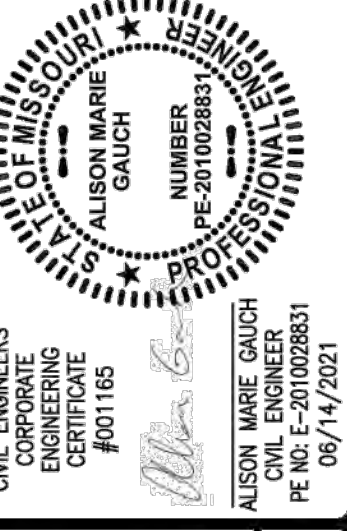

BARRON SWIM SCHOOL CALEDONIA CENTER, LOT 9A O'FALLON, MO 63368

+ ST. CHARLES 1520 S. Fifth Street Suite 307 St. Charles, MO 63303 636-242-7477 www.colerch.com

DESIGN/CALC BY: CAW DRAWN BY: CAW CHECKED BY: AMG DRAWING SCALE: AS SHOWN DATE: 06/14/21 Job Number: 21-0036-000A Sheet Number: C6.0

USER: Alison Gauth, TAB: C6.0, UTILITY DATE: June 15, 2021 - 2:42:47 PM DRAWING: S:\0085\Jobs\2021\21-0036-000A\0003\CAW\Plan\UTILITY_21-0036.dwg

AS-BUILT

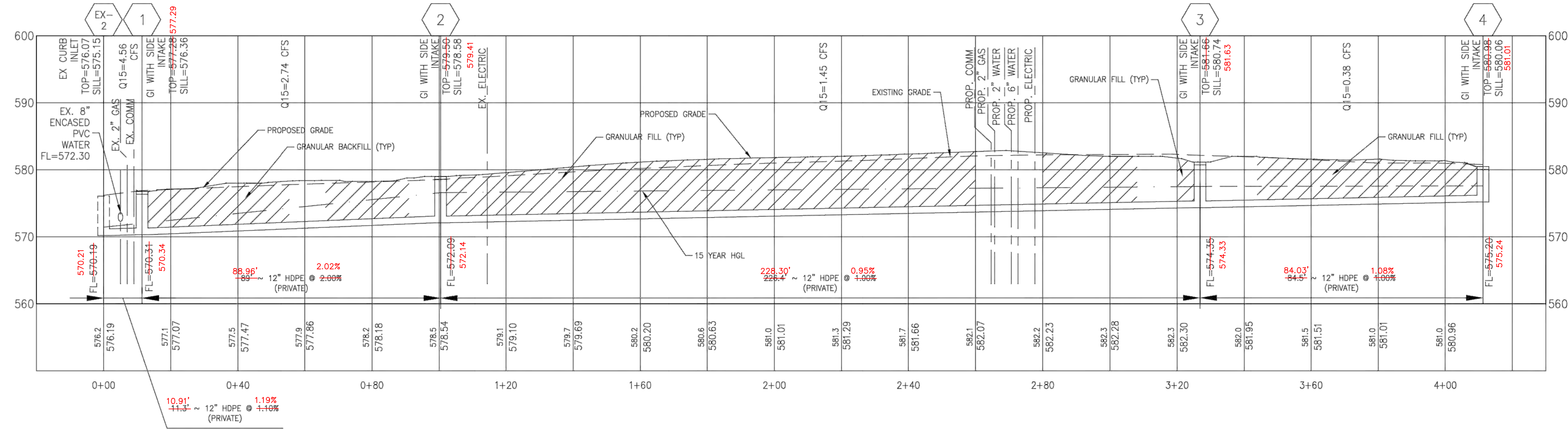

Label	Diameter (in)	Length (Unified) (ft)	Manning's n	Bend Angle (Calculated) (degrees)	Slope (Calculated) (ft/ft)	Flow (cfs)	Capacity (Excess Full Flow) (cfs)	Capacity (Full Flow) (cfs)	Velocity (In) (ft/s)	Velocity (Out) (ft/s)	Stop Node	Invert (Stop) (ft)	Elevation Ground (Stop) (ft)	Hydraulic Grade Line (Out) (ft)	Start Node	Invert (Start) (ft)	Elevation Ground (Start) (ft)	Hydraulic Grade Line (In) (ft)	Freeboard
4-3	12	84.5	0.013	77.89	0.01	0.38	3.19	3.57	0.48	0.48	3	574.35	580.68	577.52	4	575.2	580.06	577.53	2.53
3-2	12	226.4	0.013	18.81	0.01	1.45	2.11	3.56	1.85	1.85	2	572.09	578.58	576.61	3	574.35	580.68	576.98	3.7
2-1	12	89	0.013	79.44	0.02	2.74	2.3	5.04	3.49	3.49	1	570.31	576.36	575.23	2	572.09	578.58	575.76	2.82
1 - EX 2	12	11.3	0.013	10.49	0.011	4.56	-0.9	3.66	5.81	5.81	EX CB-2	570.19	575.15	571.26	1	570.31	576.36	571.44	4.92
EX 2 - EX 1	18	34	0.013	0	0.01	5.12	5.38	10.5	4.81	5.83	EX CB-1	569.85	575.15	570.6	EX CB-2	570.19	575.15	571.06	4.09

1 STORM SEWER PROFILE
 SCALE: 1"=10' VERT. 1"=20' HORIZ. REF. DWG. C6.0

The existing sewer length, sizes, flowlines, depths of sewer structures, and spot elevations have been measured to define the location and elevation of improvements. The results of those measurements are shown on this Final Measurement plan.

MD SURVEYING LLC (AGENT)

Brian Higgins

Brian G. Higgins, P.L.S. Missouri
 License No. 2013020064
 Date: 10/12/2022

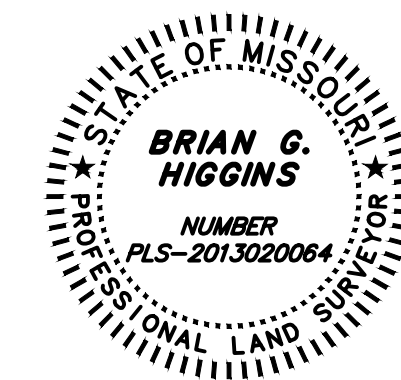

DEVELOPER/OWNER:
BARRON SWIM SCHOOL
 1158 LINDBERGH BUSINESS CT.
 ST. LOUIS, MO 63123

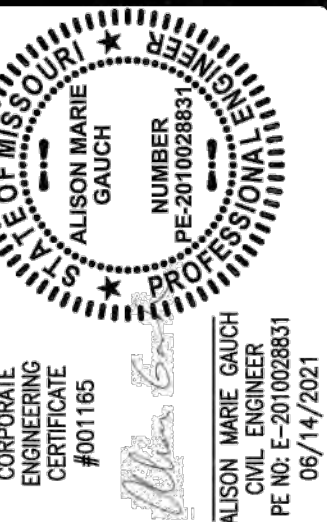

BARRON SWIM SCHOOL
 CALEDONIA CENTER, LOT 9A
 OFALLON, MO 63368
STORM SEWER PROFILES

ST. CHARLES
 1520 S. Fifth Street
 Suite 307
 St. Charles, MO 63303
 636.978.1888
COLE
 CIVIL ENGINEERING / SURVEYING / PLANNING / LANDSCAPE ARCHITECTURE

DESIGN/CALC BY	CAW
DRAWN BY	CAW
CHECKED BY	AMG
DRAWING SCALE	AS SHOWN
DATE	06/14/21
Job Number	21-0036-000A
Sheet Number	C6.1