

A SET OF "AS-BUILT" PLANS FOR
FALLON PARKWAY
PLAT TWO
 (VILLAS AT FALLON PARK SANITARY REVISION)
 A TRACT OF LAND BEING PART OF FRACTIONAL
 SECTION 9, TOWNSHIP 46 NORTH, RANGE 3 EAST,
 CITY OF O'FALLON, ST. CHARLES COUNTY, MISSOURI

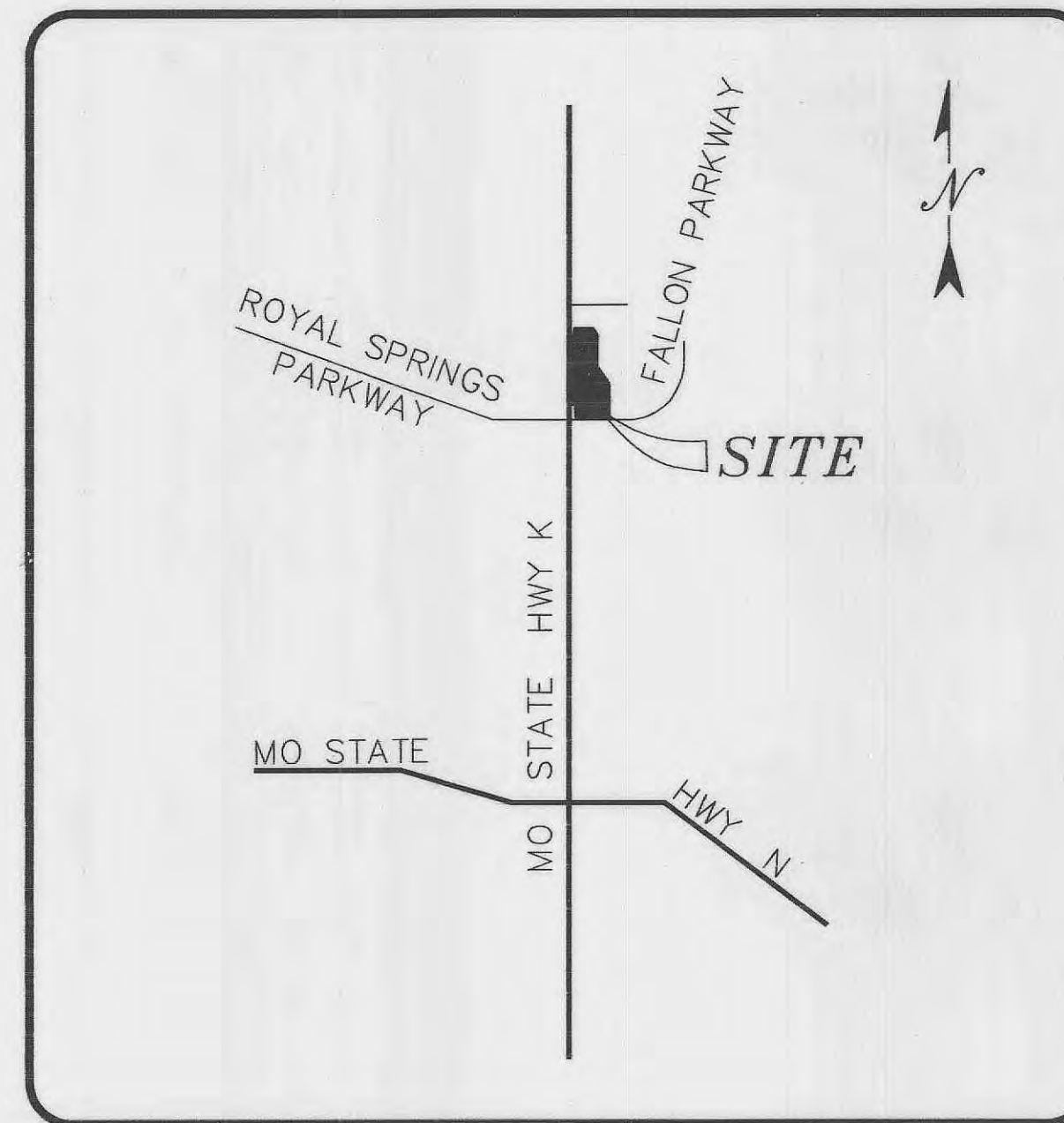

LOCATION MAP
 NOT TO SCALE

MODOT
 1-314-340-4100
 * FIBEROPTICS ARE PRESENT

 Call BEFORE you DIG
 TOLL FREE
 1-800-344-7483
 MISSOURI ONE-CALL SYSTEM, INC.

THE UNDERGROUND UTILITIES SHOWN HEREON WERE PLOTTED FROM AVAILABLE INFORMATION AND DO NOT NECESSARILY REFLECT THE ACTUAL EXISTENCE, NONEXISTENCE, SIZE, TYPE, NUMBER OR LOCATION OF THESE OR OTHER UTILITIES. THE CONTRACTOR SHALL BE RESPONSIBLE FOR VERIFYING THE ACTUAL LOCATION OF ALL UNDERGROUND UTILITIES, SHOWN OR NOT SHOWN, AND SAID UTILITIES SHALL BE LOCATED IN THE FIELD PRIOR TO ANY GRADING, EXCAVATION OR CONSTRUCTION OF IMPROVEMENTS. THESE PROVISIONS SHALL IN NO WAY ABSOLVE ANY PARTY FROM COMPLYING WITH THE UNDERGROUND FACILITY SAFETY AND DAMAGE PREVENTION ACT, CHAPTER 319, RSMo

SITE BENCHMARK:

ELEVATION: 521.66
 DESCRIPTION: A cut cross at the centerline intersection of Fallon Parkway and Fallon Villas Court.

U.S.G.S. BENCHMARK:

STATION NAME: SC-45
 PID: 183045
 ELEVATION: 535.76
 DESCRIPTION: The station and azimuth mark are standard Missouri DNR GRS aluminum disks stamped "SC-45 2000" and "SC-45A 2000". The station is set in a 12 inch diameter concrete monument about 30 inches long and flush with the ground. The azimuth is grouted into a concrete headwall.

PROFESSIONAL ENGINEER'S AUTHENTICATION

The responsibility for Professional Engineering Liability on this project is hereby limited to the set of "As-Built" plans authenticated by the seal, signature and date hereunder. Responsibility is disclaimed for all other plans in this project.

7-25-14
 DATE

 JEFFREY R. SMITH, PE
 Missouri License No. 2001004672



SHEET INDEX

- 1 COVER SHEET
- 2 SITE PLAN
- 3 PROFILES
- 4 DETENTION DETAILS

DATE:	NO.:	REVISION:
MUSLER ENGINEERING COMPANY		
CIVIL ENGINEERING - PLANNING - LAND SURVEYING		
32 Portwest Court, St. Charles, Missouri 63303		
Telephone: (636) 916-0444		
DATE: JULY 2008	DRAWN: J.R.S.	CHECKED: F.R.V.
PROJECT NO.:	SHEET NO.:	
02-695-C	1 OF 4	



Call BEFORE you DIG
TOLL FREE
1-800-344-7483
MISSOURI ONE-CALL SYSTEM, INC.

THE UNDERGROUND UTILITIES SHOWN HEREON WERE PLOTTED FROM AVAILABLE INFORMATION AND DO NOT NECESSARILY REFLECT THE ACTUAL EXISTENCE, NONEXISTENCE, SIZE, TYPE, NUMBER OR LOCATION OF THESE OR OTHER UTILITIES. THE CONTRACTOR SHALL BE RESPONSIBLE FOR VERIFYING THE ACTUAL LOCATION OF ALL UNDERGROUND UTILITIES, SHOWN OR NOT SHOWN, AND SAID UTILITIES SHALL BE LOCATED IN THE FIELD PRIOR TO ANY GRADING, EXCAVATION OR CONSTRUCTION OF IMPROVEMENTS. THESE PROVISIONS SHALL IN NO WAY ABSOLVE ANY PARTY FROM COMPLYING WITH THE UNDERGROUND FACILITY SAFETY AND DAMAGE PREVENTION ACT, CHAPTER 319, RSMo

LEONARD KAPLAN, TRUSTEE
(2408/1783)
5.50 AC. - ZONED R-1
FUTURE DEVELOPMENT

NOTE:
MULTI USE TRAIL TO BE LOCATED ON EAST SIDE OF CREEK. EXACT LOCATION AND DETAILS TO BE PROVIDED AT TIME OF DEVELOPMENT OF THIS PARCEL.

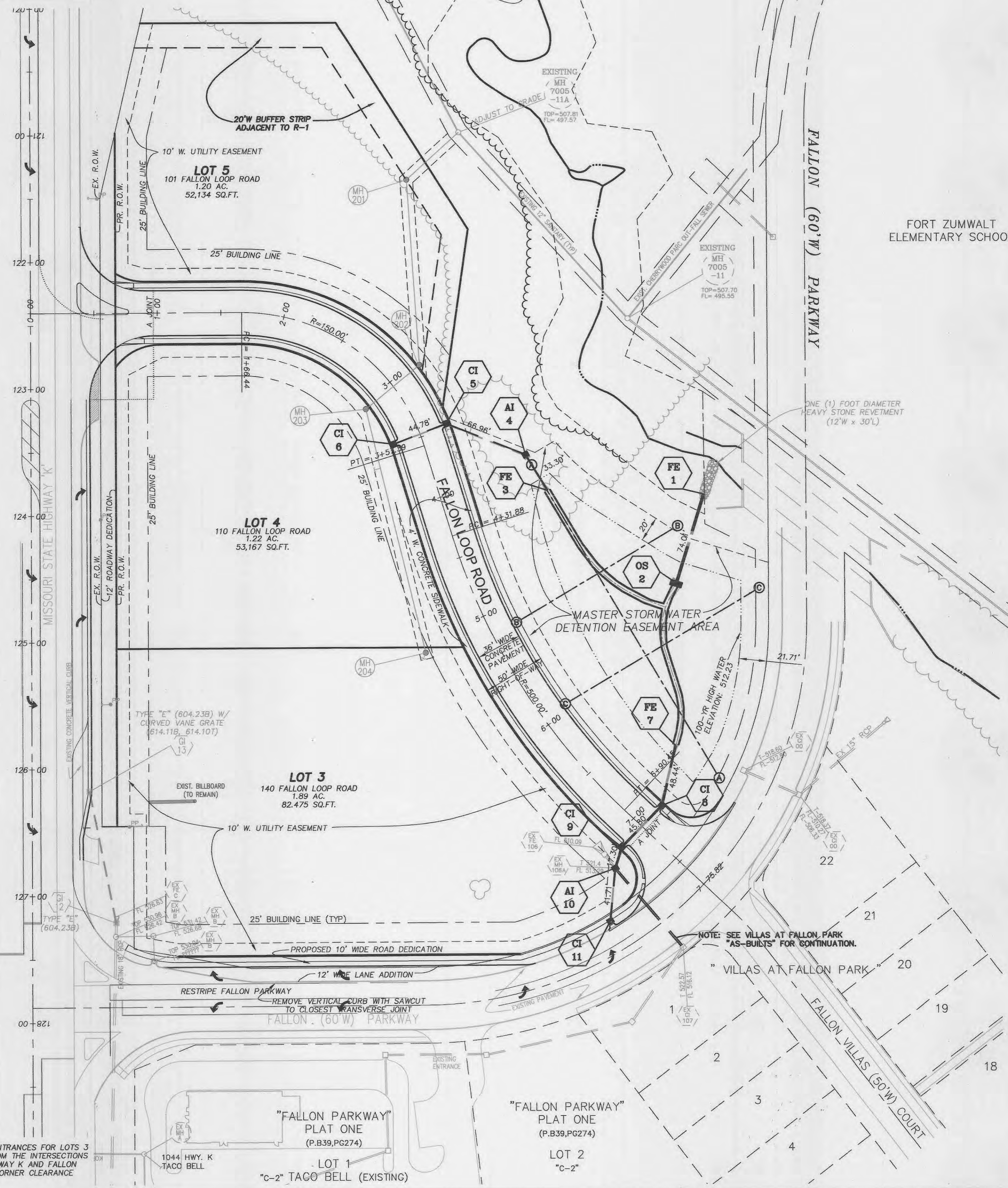
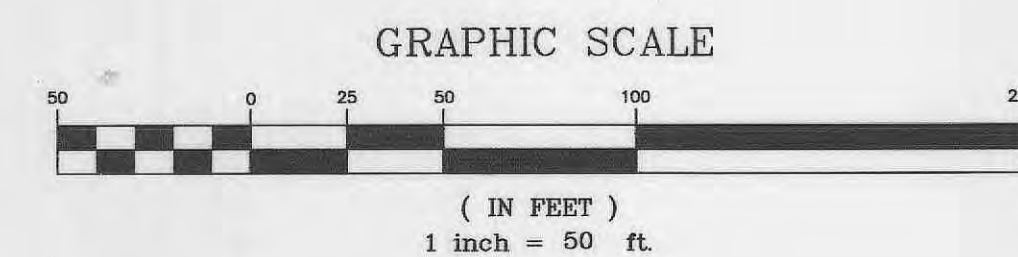
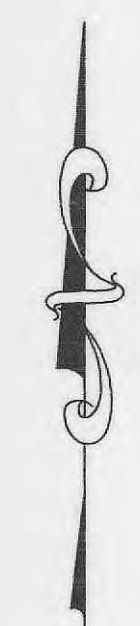

FORT ZUMWALT
ELEMENTARY SCHOOL

FALLON (60' W) PARKWAY

MISSOURI STATE HIGHWAY K

EXISTING
MH
7005
-10
TOP=504.08
FL=482.96

NOTE: SEE VILLAS AT FALLON PARK
"AS-BUILTS" FOR CONTINUATION.

PROFESSIONAL ENGINEER'S AUTHENTICATION
The responsibility for Professional Engineering Liability on this project is hereby limited to the set of "As-Built" plans authenticated by the seal, signature and date hereunder. Responsibility is disclaimed for all other plans in this project.

7-25-14
DATE
JEFFREY R. SMITH, PE
Missouri License No. 2001004672



NOTE: MDDOT SUGGEST LOCATING THE ENTRANCES FOR LOTS 3 AND 5 AS FAR AS PRACTICABLE FROM THE INTERSECTIONS OF FALLON LOOP ROAD AND HIGHWAY K AND FALLON PARKWAY TO PROVIDE MAXIMUM CORNER CLEARANCE FROM INTERSECTION.

CONTRACTOR TO INSTALL OUTFALL REACH AND STRUCTURE AND LINE WITH FABRIC TO UTILIZE AS A SEDIMENT TRAP DURING FILL PLACEMENT.

PRIVATE

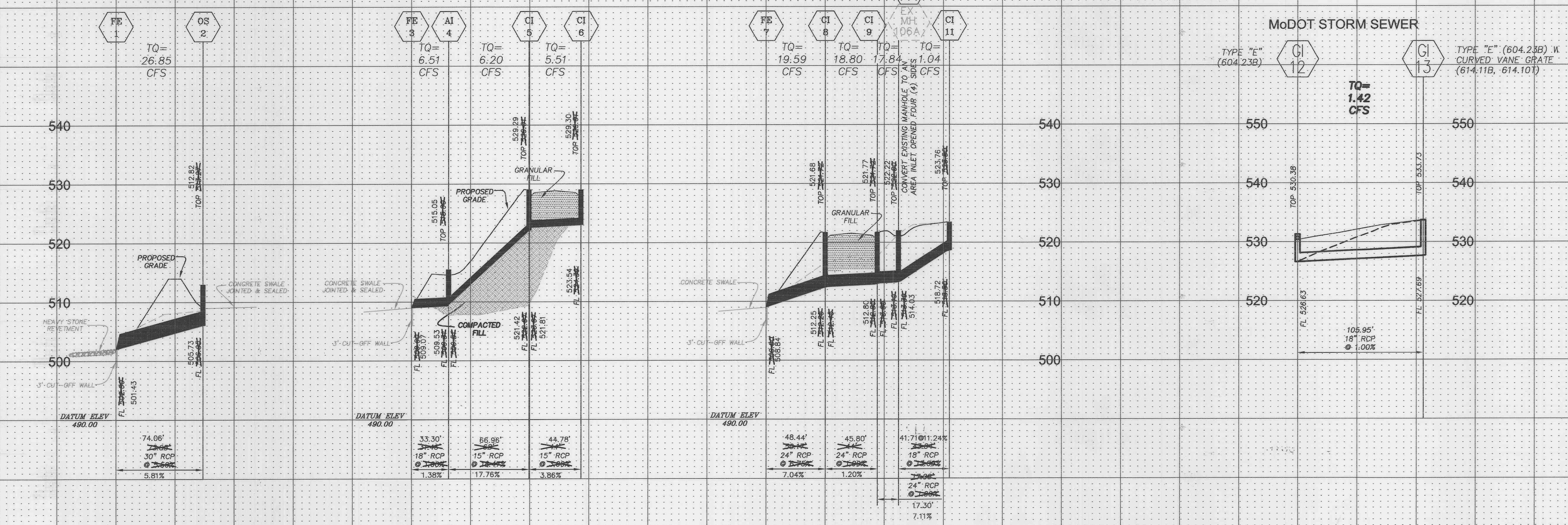

MoDOT STORM SEWER

TYPE "E" (604.23B) CI 12
TYPE "E" (604.23B) W CURVED VANE GRATE (614.11B, 614.101) CI 13

TQ= 1.42 CFS

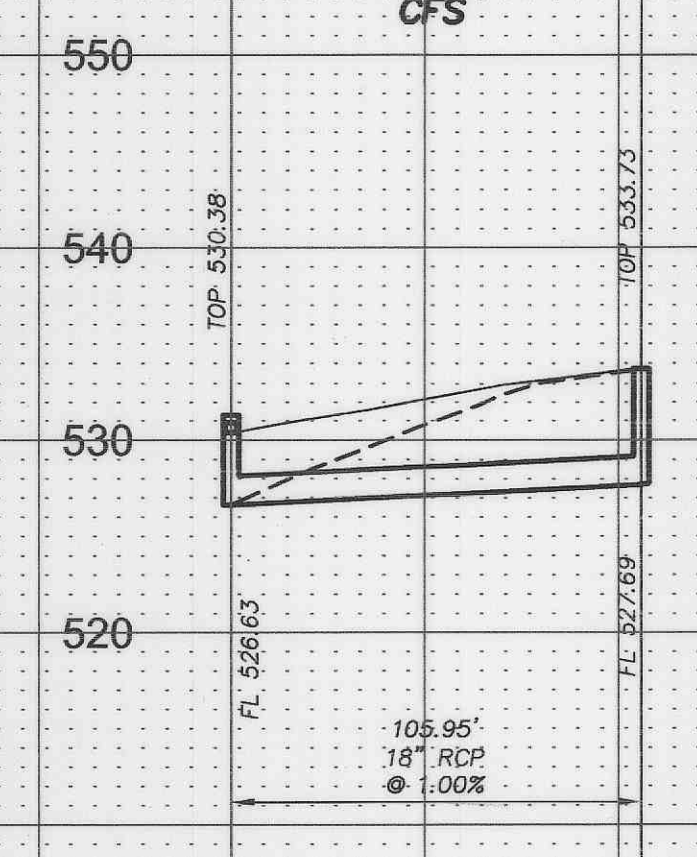

PROFESSIONAL ENGINEER'S AUTHENTICATION

The responsibility for Professional Engineering liability on this project is hereby limited to the set of "As-Built" plans authenticated by the seal, signature and date hereunder. Responsibility is disclaimed for all other plans in this project.



DATE: 7-25-14
JEFFREY R. SMITH, PE
Missouri License No. 2001004672

Call BEFORE you DIG
TOLL FREE
1-800-344-7483
MISSOURI ONE-CALL SYSTEM, INC.

THE UNDERGROUND UTILITIES SHOWN HEREON WERE PLOTTED FROM AVAILABLE INFORMATION AND DO NOT NECESSARILY REFLECT THE ACTUAL EXISTENCE, NONEXISTENCE, SIZE, TYPE, NUMBER OR LOCATION OF THESE OR OTHER UTILITIES. THE CONTRACTOR SHALL BE RESPONSIBLE FOR VERIFYING THE ACTUAL LOCATION OF ALL UNDERGROUND UTILITIES, SHOWN OR NOT SHOWN, AND SAID UTILITIES SHALL BE LOCATED IN THE FIELD PRIOR TO ANY GRADING, EXCAVATION OR CONSTRUCTION OF IMPROVEMENTS. THESE PROVISIONS SHALL IN NO WAY ABSOLVE ANY PARTY FROM COMPLYING WITH THE UNDERGROUND FACILITY SAFETY AND DAMAGE PREVENTION ACT, CHAPTER 319, RSMo.

HORIZONTAL SCALE: 1" = 50'
VERTICAL SCALE: 1" = 10'

CONTRACTOR TO INSTALL OUTFALL REACH AND STRUCTURE AND LINE WITH FABRIC TO UTILIZE AS A SEDIMENT TRAP DURING FILL PLACEMENT.

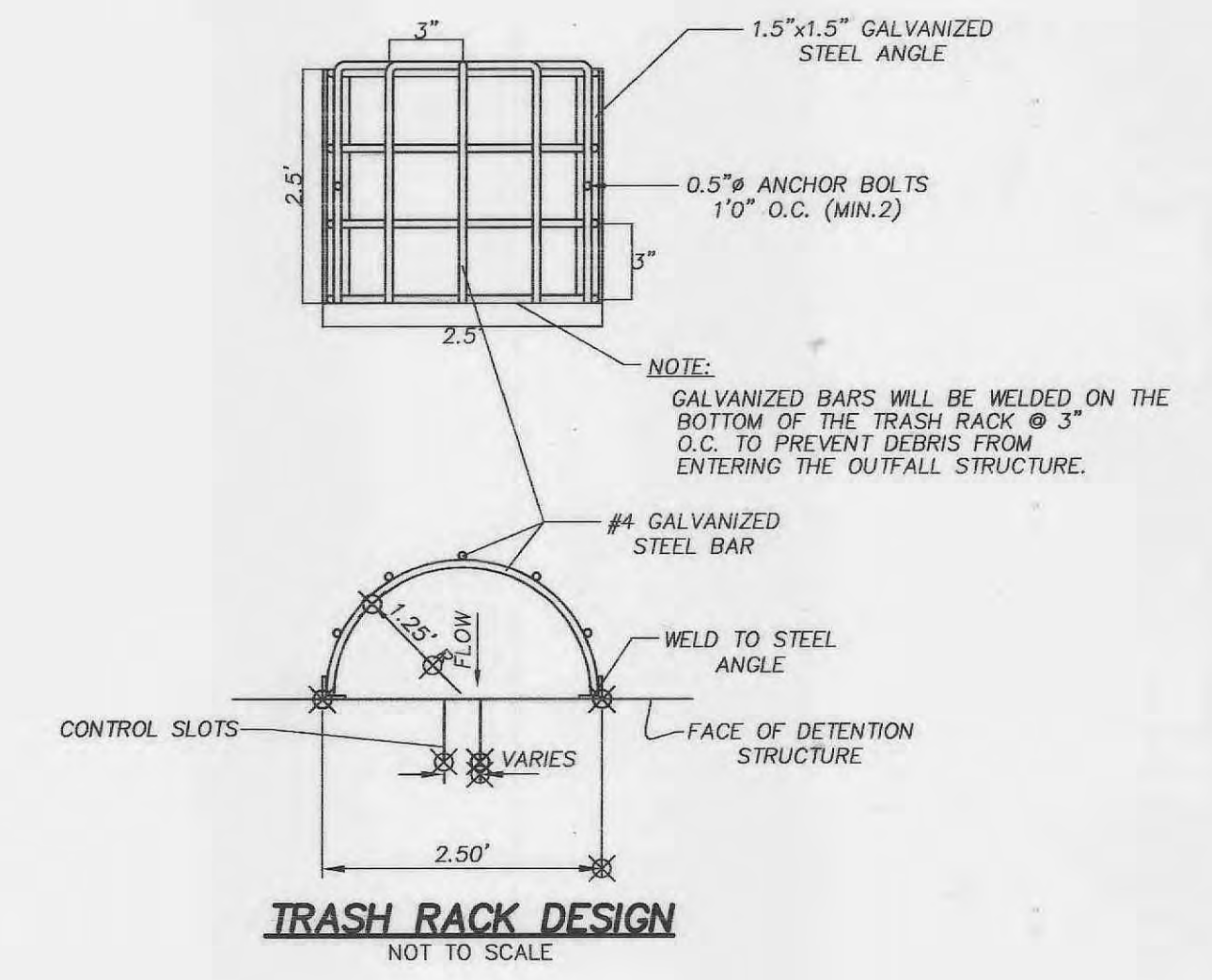
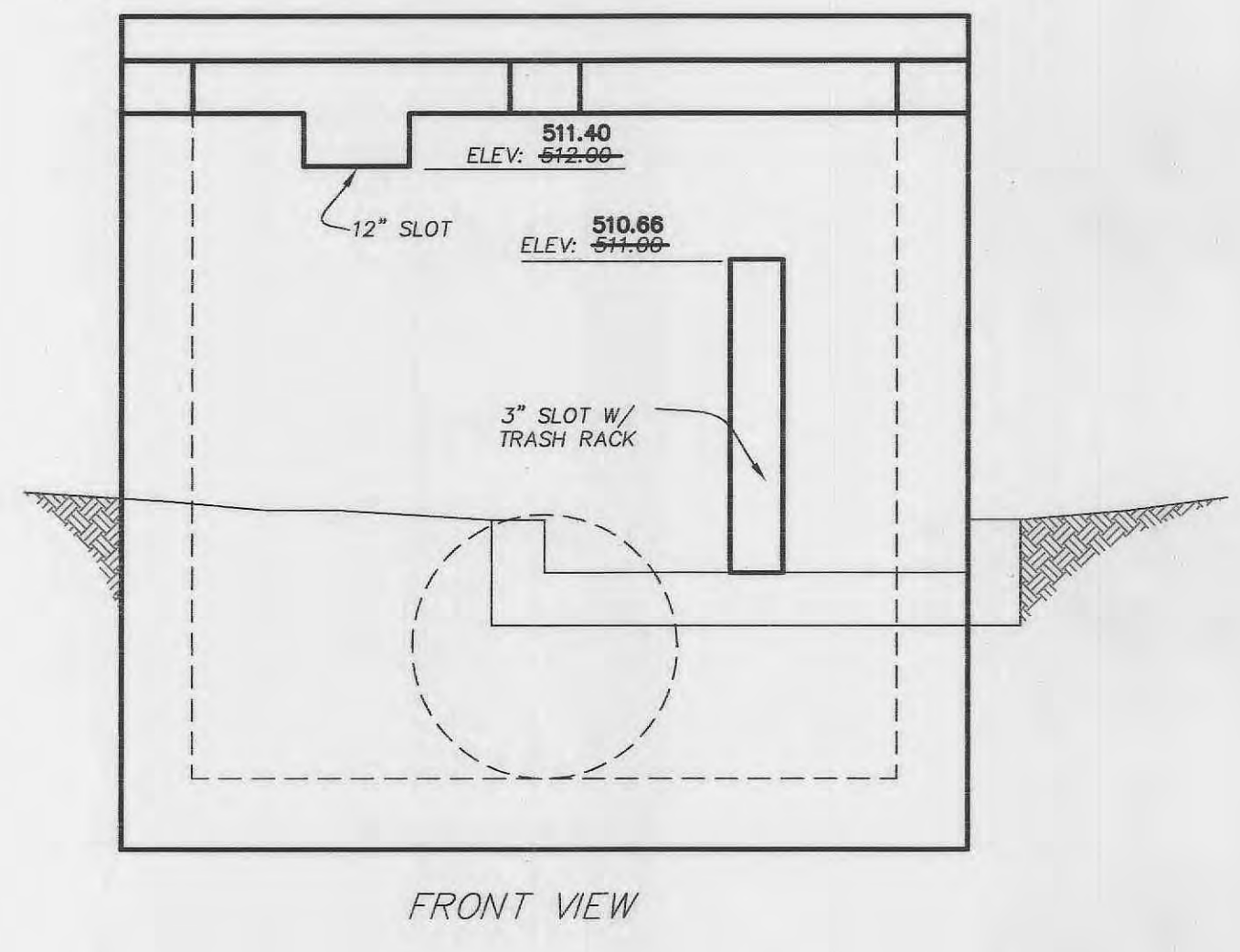
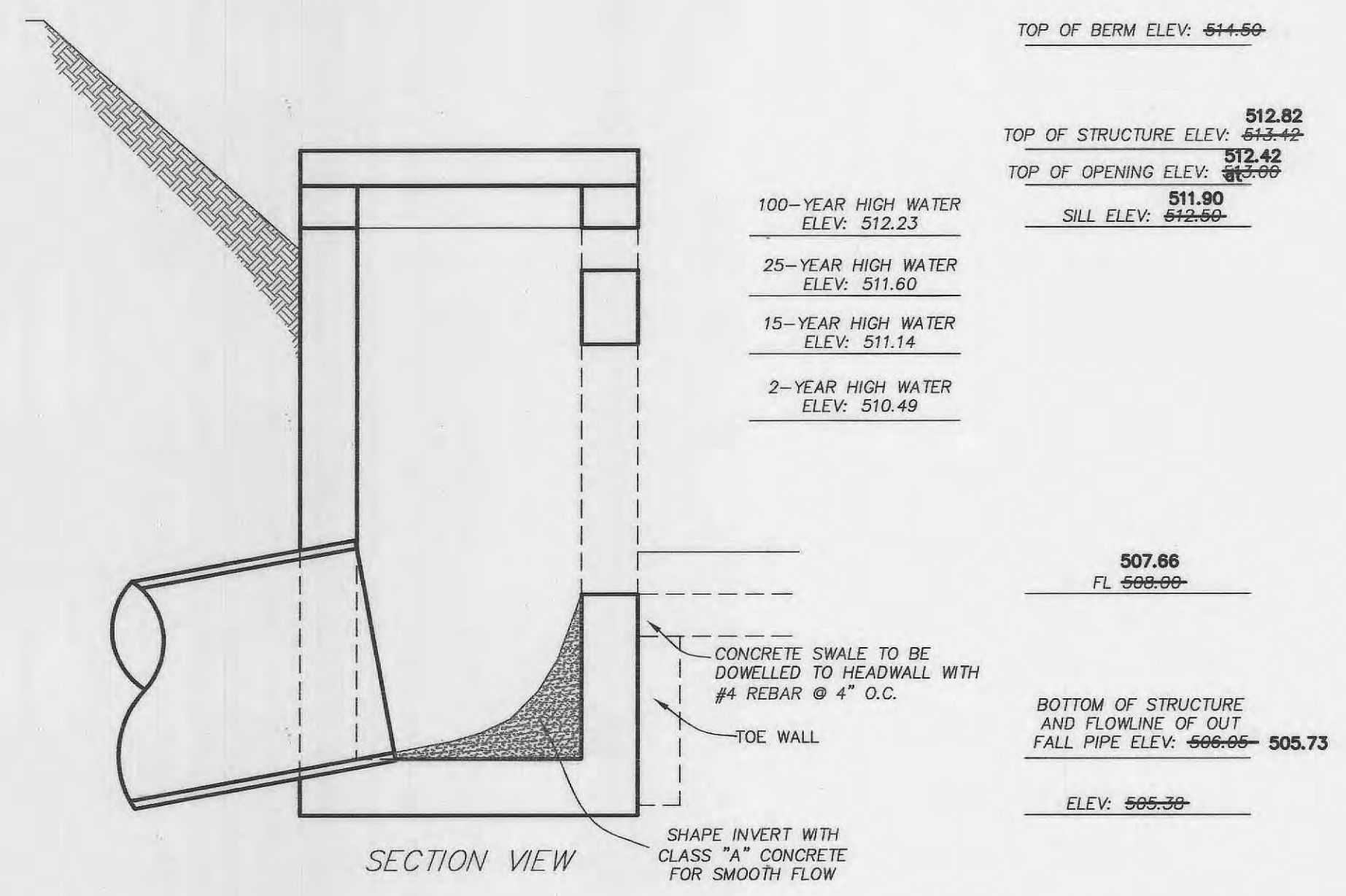

DOUBLE AREA INLET
OPEN 4 SIDES

- NOTES:
1. USE DIMENSIONS FOR DOUBLE AREA INLET.
2. REINFORCE WITH #4 BARS @ 12" O.C. BOTH WAYS ALL SIDES AND BOTTOM.

OUTFALL STRUCTURE 2
NOT TO SCALE

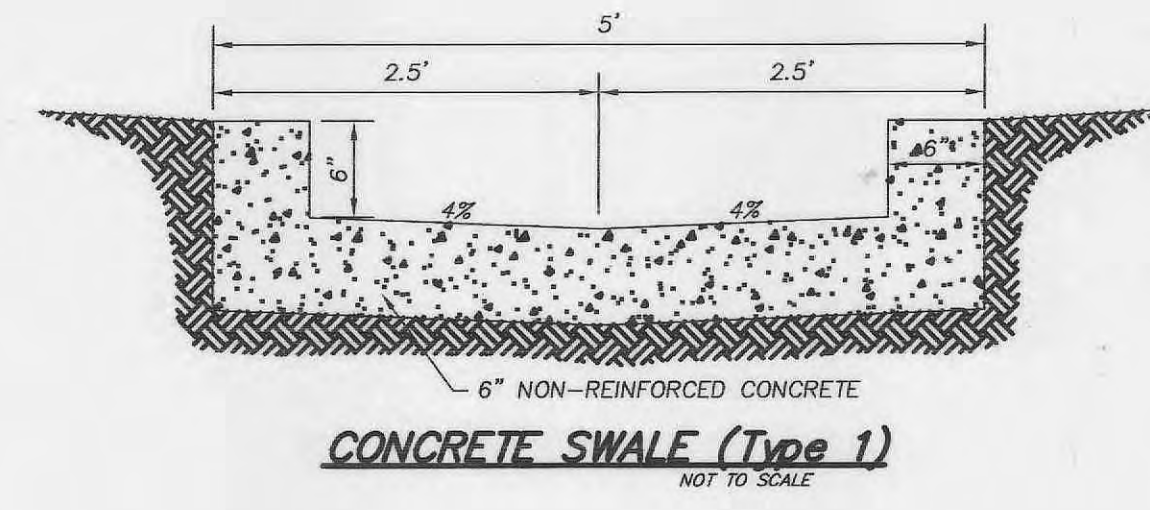

PROFESSIONAL ENGINEER'S AUTHENTICATION
The responsibility for Professional Engineering Liability on this project is hereby limited to the set of "As-Built" plans authenticated by the seal, signature and date hereunder. Responsibility is disclaimed for all other plans in this project.



7.25.14
DATE
JEFFREY R. SMITH, PE
Missouri License No. 2001004672

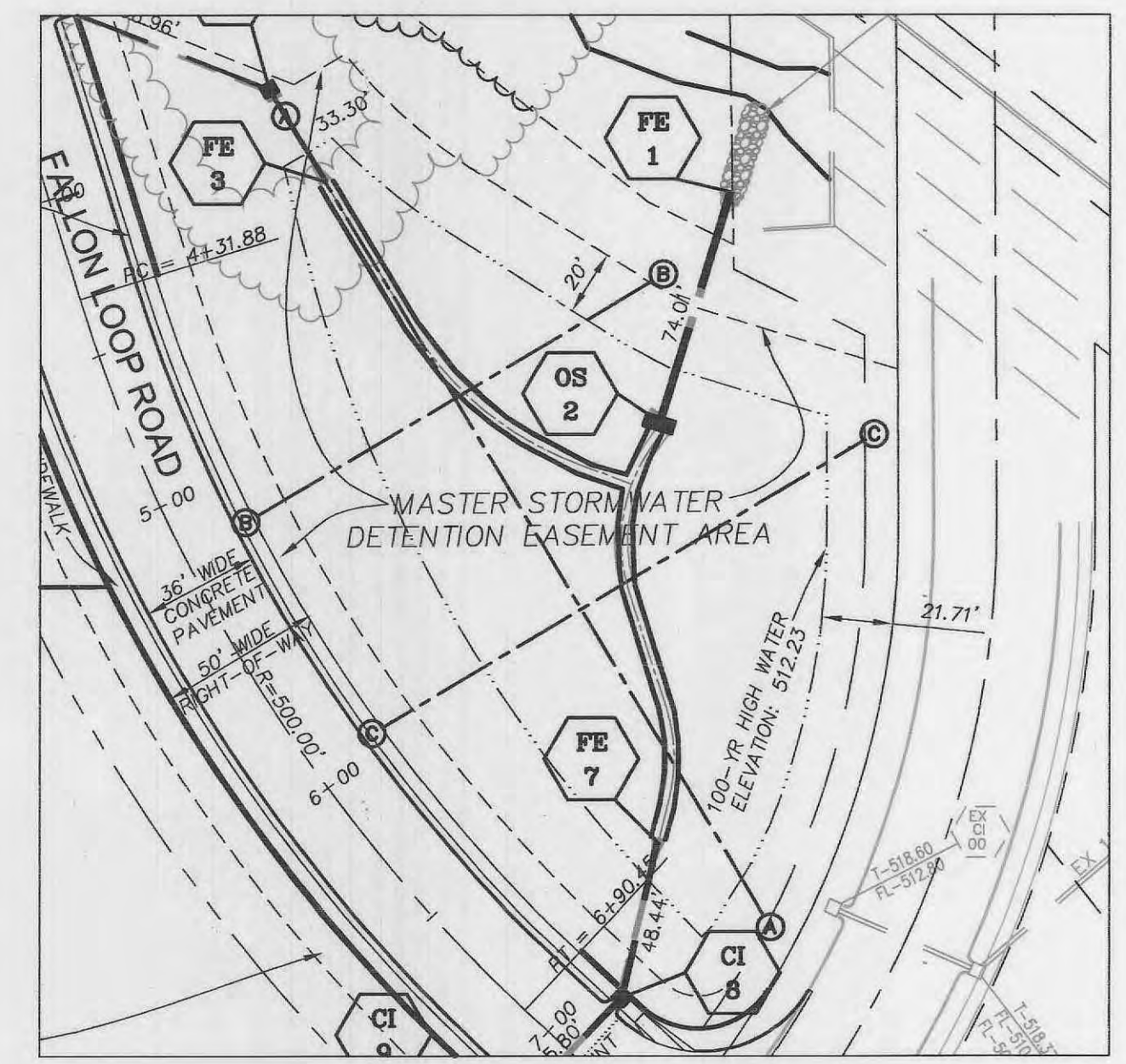

DETENTION TO BE PROVIDED DURING THE INITIAL PHASE OF DEVELOPMENT.

