

GENERAL NOTES:

1. COMMERCIAL DISTRICT C-3 REQUIRES ONE (1) TREE FOR EVERY FORTY (40) FEET, OR PORTION THEREOF, OF STREET FRONTAGE, PUBLIC OR PRIVATE, SHALL BE REQUIRED WITHIN THE LANDSCAPE SETBACK ADJUTING SAID FRONTAGE. SAID TREES MAY BE CLUSTERED OR ARRANGED WITHIN THE SETBACK AND NEED NOT BE PLACED EVENLY AT FORTY (40) FOOT INTERVALS. IN ADDITION TO THE REQUIRED TREES, BASED UPON STREET FRONTAGE, ONE (1) TREE SHALL ALSO BE REQUIRED FOR EVERY (3,000) S.F. OF LANDSCAPED OPEN SPACE. THESE MAY INCLUDE TREES REQUIRED IN PARKING LOTS, AS SET OUT IN SUBSECTION (C) OF PLANTING REQUIREMENTS WITHIN PARKING AND VEHICULAR USE AREAS AS DEFINED BY ARTICLE X - LANDSCAPING AND SCREENING REGULATIONS.
2. PROPERTY TYPE: MISC. NOT FOR PROFIT AG. & R.
3. THIS PROPERTY IS SERVICED BY THE FOLLOWING UTILITY COMPANIES.
AMEREN UE COMPANY
SOUTHWESTERN BELL TELEPHONE COMPANY
LACLEDE GAS COMPANY
ST. CHARLES COUNTY WATER DISTRICT NO.2
DUCKETT CREEK SANITARY SEWER DISTRICT
4. FLOOD AND FLOOD WAY BOUNDARY DETERMINED FROM FLOOD INSURANCE RATE MAP FOR ST. CHARLES COUNTY, MISSOURI AND INCORPORATED AREAS, MAP NUMBER 29183C0430, PANEL 430 REVISED AUGUST 2, 1996 (ZONE "AE" BASE FLOOD ELEVATIONS DETERMINED).
5. AREA OF DISTURBANCE: 2.82 ACRES
6. THE PROJECT SHALL INCLUDE EXCAVATING A FILL AREA FOR THE MATERIAL DREDGED FROM THE RETENTION POND BOTTOM TO THE LINES AND GRADES SHOWN ON THE PLANS, PLACEMENT AND COMPACTION OF THE EXCAVATED MATERIAL FROM THE BORROW AREA TO THE POND LEVEE TO THE LINES AND GRADES SHOWN ON THE PLANS, DRAINING AND DREDGING OF THE RETENTION POND BOTTOM TO THE LINES AND GRADES SHOWN ON THE PLANS, AND PLACING OF THE DREGED MATERIAL FROM THE POND BOTTOM IN THE FILL AREA EXCAVATED PREVIOUSLY TO THE LINES AND GRADES SHOWN ON THE PLANS. WORK IS BE DONE IN TWO PHASES AS FOLLOWS:

PHASE A.
THE CONTRACTOR IS TO EXCAVATE THE MATERIAL BORROW AND DREDGED FILL AREA TO THE LINES AND GRADES SHOWN ON THE PLAN CROSS-SECTIONS. SAID BORROW AREA IS LOCATED ON THE SIDE EAST SIDE OF THE RETENTION BASIN IN THE SCHOTE CREEK FLOOD PLAIN. THE EXCAVATED MATERIAL FROM SAID BORROW AND DREDGE FILL AREA IS TO BE PLACED AND COMPACTED ON THE EAST (OUTSIDE) SLOPE OF THE RETENTION BASIN TO THE LINES AND GRADES SHOWN ON THE PLAN CROSS-SECTIONS. PART OF THIS PHASE IS EXTENDING THE EXISTING 36" DIAMETER RETENTION BASIN OUTFALL CULVERT AS SHOWN ON THE PLANS.

PHASE B.
DRAINING OF THE BASIN SHALL PRECEDE PHASE A OR BE PERFORMED SIMULTANEOUSLY WITH PHASE A. TH

BRIS FROM THE RETENTION BASIN IS TO LEAVE THE SITE OR BE DISCHARGED INTO THE CREEK. THE RETENTION BASIN BOTTOM WILL THEN BE EXCAVATED TO THE GRADES SHOWN ON THE PLAN. THE EXCAVATED MATERIAL FROM THE RETENTION POND BOTTOM WILL BE PLACED AND COMPACTED IN THE EXCAVATED AREA OF THE MATERIAL BORROW AND DREDGED FILL AREA TO THE LINES AND GRADES SHOWN ON THE PLAN.

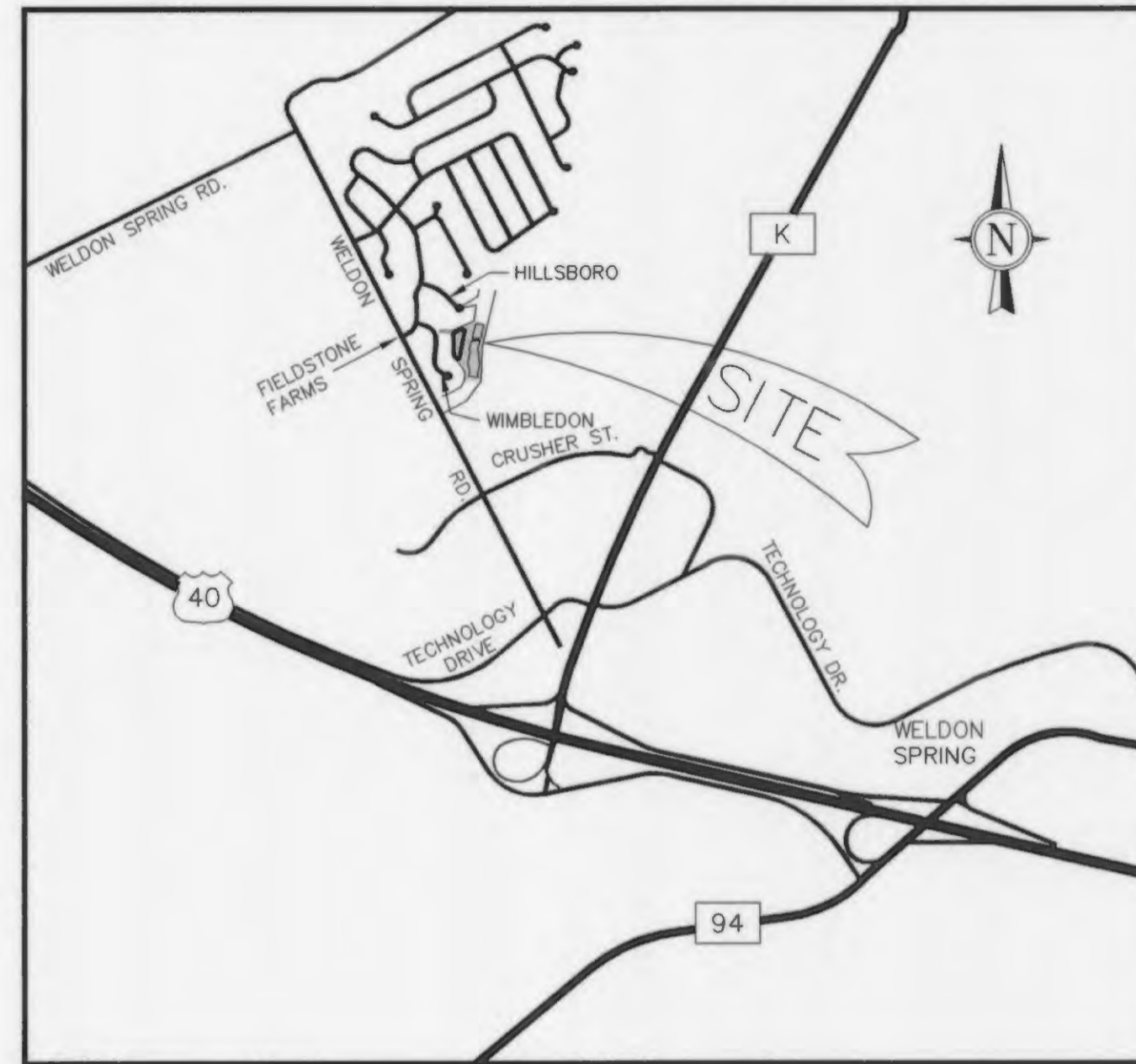

VICINITY MAP
NOT TO SCALE

AS-BUILT
IMPROVEMENT PLANS
TO SERVE

FIELDSTONE FARMS SUBDIVISION
RETENTION POND IMPROVEMENTS

CITY OF O'FALLON, MISSOURI 63368

SITE ADDRESS:

WIMBLETON COURT
CITY OF O'FALLON, MISSOURI 63368

PROPERTY OWNER:

FIELDSTONE FARMS SUBD. TRUSTEES
c/o HELENE REECE
6904 FIELDSTONE FARMS DRIVE
O'FALLON, MISSOURI 63368
PHONE: 636-284-7535

EARTHWORK ESTIMATES:

THE FOLLOWING EARTHWORK CALCULATIONS ARE ESTIMATES BASED ON EXISTING AND PROPOSED GRADES SHOWN HEREON AND ARE TO BE CONSIDERED APPROXIMATE. THESE CALCULATIONS ARE GIVEN FOR COMPARISON VALUES ONLY AND ARE NOT INTENDED FOR USE BY THE CONTRACTORS FOR PREPARING COSTS FOR THE PROJECT. ANYONE USING THESE CALCULATIONS DO SO AT THEIR OWN RISK. FOR ESTIMATING PURPOSES WE HAVE SELECTED A 15% SHRINKAGE FACTOR. NO SHRINKAGE FACTOR WAS APPLIED TO THE DREDGED MATERIAL FROM THE POND PLACED IN THE FLOODWAY EXCAVATION.

- ESTIMATED VOLUME OF EXCAVATION IN THE FLOODWAY = 2882 C.Y. (TO BE PLACED ON RETENTION BASIN LEVEE)
- ESTIMATED VOLUME OF FILL ON RETENTION BASIN LEVEE = 2506 C.Y.
- ESTIMATED VOLUME OF FILL ON RETENTION BASIN LEVEE ABOVE BASE FLOOD ELEVATION = 1668 C.Y.
- ESTIMATED VOLUME OF FILL ON RETENTION BASIN LEVEE BELOW BASE FLOOD ELEVATION = 838 C.Y.
- ESTIMATED VOLUME OF DREDGED MATERIAL FROM THE POND = 2030 C.Y.

LEGEND

BELL	TELEPHONE JUNCT BOX	(*)	NEW TREE
PP	UTILITY POLE	(O)	NEW SHRUB
PP	POWER POLE	(O)	GAS LINE
PP	GUY WIRE	UT	BURIED TELEPHONE
PP	EXISTING SIGN	FO	FIBER OPTIC CABLE
PP	FIRE HYDRANT	510	EX. 10' CONTOUR
PP	WATER VALVE	502	EX. 2' CONTOUR
PP	WATER METER	(502)	FINISHED CONTOUR
PP	PROPERTY LINE	x	FENCE LINES
PP	RIGHT OF WAY LINE	o	NEW CURB
PP	AERIAL ELECTRIC	---	SILTATION CONTROL FENCE
PP	EXISTING MANHOLE	x-784.75	EXISTING SPOT GRADE
PP	NEW MANHOLE	784.79	NEW SPOT GRADE
PP	EXISTING STORM DRAIN	TC-784.50	NEW TOP CURB GRADE
PP	PROPOSED STORM DRAIN	EX-TW 80.85	EXISTING TOP OF WALL
PP	TEST HOLE LOCATION	EX-BW 55.25	EXISTING BASE OF WALL
PP	EXISTING WATER LINE	(TYP)	TYPICAL
PP	PROPOSED WATER LINE	(TBR)	TO BE REMOVED
PP	NEW SANITARY SEWER	(TBA)	TO BE ADJUSTED
		(UIP)	USE IN PLACE
		BOC	BACK OF CURB

OSHA RULES AND REGULATIONS
All OSHA rules and regulations established for the types of construction activities required by these Plans shall be strictly followed.

BENCHMARKS:
BM TOP CENTER MANHOLE - ELEV. 497.70' - EX. MH 11 AS SHOWN ON FIELDSTONE FARMS PHASE 1 GRADING PLAN SH 4 OF 19, DATED JULY, 1998. REVISED AUG. 28, 1998

THE UTILITIES SHOWN HEREIN WERE PLOTTED FROM AVAILABLE INFORMATION AND DO NOT NECESSARILY REFLECT THE ACTUAL EXISTENCE, NON-EXISTENCE, SIZE, TYPE, OR LOCATION OF THESE OR OTHER UTILITIES. THE CONTRACTOR SHALL BE RESPONSIBLE FOR THE VERIFYING THE ACTUAL LOCATION OF ALL UTILITIES, SHOWN OR NOT SHOWN, AND SAID UTILITIES SHALL BE LOCATED IN THE FIELD PRIOR TO ANY CONSTRUCTION OF IMPROVEMENTS. THESE PROVISIONS SHALL IN NO WAY ABSOLVE ANY PARTY FROM COMPLYING WITH THE UNDERGROUND FACILITY SAFETY AND DAMAGE PREVENTION ACT, CHAPTER 319 RSMo.



Missouri One Call System, Inc.
Call Before You Dig!
1-800-DIG-RITE
(1-800-344-7483)

GENERAL NOTES (CONTINUED):

7. NO SLOPES SHALL BE STEEPER THAN 3 (HORIZONTAL) TO 1 (VERTICAL)
 8. GRADED AREAS THAT ARE TO REMAIN BARE FOR OVER 2 WEEKS SHALL BE SEEDED AND MULCHED PER DNR REQUIREMENTS.
 9. ALL EROSION CONTROL SYSTEMS SHALL BE INSPECTED AND NECESSARY CORRECTIONS MADE WITHIN 24 HOURS OF ANY RAINSTORM RESULTING IN ONE-HALF INCH OF RAIN OR MORE.
 10. TRAFFIC CONTROL IS TO BE PER MDDOT (MISSOURI STANDARD PLANS FOR HIGHWAY CONSTRUCTION).
 11. TREES, ORGANIC DEBRIS, RUBBLE, FOUNDATIONS AND OTHER DELETERIOUS MATERIAL SHALL BE REMOVED FROM THE SITE AND DISPOSED IN COMPLIANCE WITH ALL APPLICABLE LAWS AND REGULATIONS. LANDFILL TICKETS FOR SUCH DISPOSAL SHALL BE MAINTAINED ON FILE BY THE CONTRACTOR. BURNING ON SITE SHALL BE ALLOWED ONLY BY PERMIT FROM THE LOCAL FIRE DISTRICT. IF A BURN PIT IS PROPOSED THE LOCATION AND MITIGATION SHALL BE SHOWN ON THE GRADING PLAN AND DOCUMENTED BY THE SOILS ENGINEER.
 12. ALL UTILITIES INCLUDING SANITARY SEWER LATERAL TRENCHES SHALL BE BACKFILLED WITH GRANULAR MATERIAL UNDER ALL PAVED AREAS.
 13. SIGNAL IMPROVEMENTS OR MODIFICATIONS ARE NOT REQUIRED FOR THIS PROJECT.
 14. ALL UTILITIES INCLUDING SANITARY SEWER LATERAL TRENCHES SHALL BE BACKFILLED WITH GRANULAR MATERIAL UNDER ALL PAVED AREAS.
 15. RIP-RAP SHOWN AT FLARED ENDS WILL BE EVALUATED IN THE FIELD AFTER INSTALLATION FOR EFFECTIVENESS AND FIELD MODIFIED IF NECESSARY TO REDUCE EROSION ON AND OFF SITE.
 16. CONTRACTOR MUST SUPPLY CITY CONSTRUCTION INSPECTORS WITH SOIL REPORTS PRIOR TO OR DURING SITE SOIL TESTING.
 17. **SOILS NOTES:**
 1. DEVELOPER MUST SUPPLY CITY CONSTRUCTION INSPECTORS WITH SOIL REPORTS PRIOR TO OR DURING SITE SOIL TESTINGS AND
 2. THE SOIL REPORT WILL BE REQUIRED TO CONTAIN THE FOLLOWING INFORMATION ON SOIL TEST CURVES (PROCTOR REPORTS FOR PROJECTS WITH THE CITY.
 - * MAXIMUM DRY DENSITY
 - * OPTIMUM MOISTURE CONTENT
 - * MAXIMUM AND MINIMUM ALLOWABLE MOISTURE CONTENT.
 - * CURVE MUST BE PLOTTED TO SHOW DENSITY FROM A MINIMUM OF 90% COMPACTION AND ABOVE AS DETERMINED BY THE "MODIFIED AASHTO T-180 COMPACTION TEST" (A.S.T.M.-D-1157) OR FROM A MINIMUM 95% AS DETERMINED BY THE "STANDARD PROCTOR TEST AASHTO T-99, METHOD C" (A.S.T.M.-D-698).
 - * PROCTOR MUST BE DESIGNED ON DOCUMENT.
 - * CURVE MUST HAVE AT LEAST 5 DENSITY POINTS WITH MOISTURE CONTENT AND SAMPLE LOCATIONS LISTED ON DOCUMENT.
 - * SPECIFIC GRAVITY
 - * NATURAL MOISTURE CONTENT
 - * LIQUID LIMIT
 - * PLASTIC LIMIT
- BE ADVISED THAT IF THIS INFORMATION IS NOT PROVIDED TO THE CITY'S CONSTRUCTION INSPECTOR THE CITY WILL NOT ALLOW GRADING OR CONSTRUCTION ACTIVITIES TO PROCEED ON ANY PROJECT SITE.
18. ALL LOW PLACES WHETHER ON-SITE OR OFF-SITE SHALL BE GRADED TO ALLOW DRAINAGE. THIS MAY BE ACCOMPLISHED WITH TEMPORARY DITCHES. ANY OFF-SITE DRAINAGE EASEMENTS SHALL BE ACQUIRED BEFORE GRADING BEGINS.
 19. GRADED AREAS SHALL BE SEEDED AND MULCHED WITHIN FOURTEEN (14) DAYS OF STOPPING LAND DISTURBANCE ACTIVITIES. VEGETATIVE GROWTH SHALL BE ESTABLISHED WITHIN SIX (6) WEEKS OF GRADING WORK BEING STOPPED OR COMPLETED IN ANY AREA. VEGETATIVE GROWTH SHALL BE SUFFICIENT TO PREVENT EROSION (70% COVERAGE PER SQUARE FOOT) AS REQUIRED BY MNR AND EPA.
 20. THE CONTRACTOR SHALL ASSUME COMPLETE RESPONSIBILITY FOR CONTROLLING ALL SILTATION AND EROSION OF THE PROJECT AREA. THE CONTRACTOR SHALL USE WHATEVER MEANS NECESSARY TO CONTROL EROSION AND SILTATION INCLUDING, BUT NOT LIMITED TO, STAKED STRAW BALES AND/OR SILTATION FABRIC FENCES (POSSIBLE METHODS OF CONTROL ARE DETAILED IN THE PLAN). CONTROL SHALL COMMENCE WITH GRADING AND BE MAINTAINED THROUGHOUT THE PROJECT UNTIL ACCEPTANCE OF THE WORK BY THE OWNER, AND/OR THE CITY OF O'FALLON AND/OR AS NECESSARY BY MDDOT. THE CONTRACTOR'S RESPONSIBILITIES INCLUDE ALL DESIGN AND IMPLEMENTATION AS REQUIRED TO PREVENT EROSION AND THE DEPOSITING OF SILT. THE OWNER AND/OR THE CITY OF O'FALLON, AND/OR AS NECESSARY MDDOT MAY AT THEIR OPTION DIRECT THE CONTRACTOR IN HIS METHODS AS DEEMED FIT TO PROTECT PROPERTY AND IMPROVEMENTS. ANY DEPOSITING OF SILT OR MUD ON NEW OR EXISTING PAVEMENT SHALL BE REMOVED IMMEDIATELY ANY DEPOSITING OF SILTS OR MUD IN NEW OR EXISTING STORM SEWERS OR SWALES SHALL BE REMOVED AFTER EACH RAIN AND AFFECTED AREAS CLEANED TO THE SATISFACTION OF THE OWNER AND/OR THE CITY OF O'FALLON, AND/OR AS NECESSARY MDDOT.
 21. ALL EROSION CONTROL SYSTEMS SHALL BE INSPECTED AND CORRECTED WEEKLY, ESPECIALLY WITHIN 48 HOURS OF ANY RAINSTORM RESULTING IN ONE-HALF INCH OF RAIN OR MORE. ANY SILT OF DEBRIS LEAVING THE SITE AND AFFECTING PUBLIC RIGHTS-OF-WAYS OR STORM WATER DRAINAGE FACILITIES SHALL BE CLEANED UP WITHIN 24 HOURS AFTER THE END OF THE STORM.
 22. CLEARING LIMITS SHALL BE VISIBLY MARKED IN THE FIELD PRIOR TO REMOVAL OF TREES.
 23. SITE ACCESS FOR CONSTRUCTION EQUIPMENT IS THROUGH EXISTING GRAVELED ENTRYWAY TO SUBDIVISION COMMON AREA OFF OF WELDON SPRING ROAD AT SOUTH END OF SUBDIVISION. ALL EQUIPMENT WILL BE BROUGHT TO THE SITE AND REMOVED FROM THE SITE BY TRAILERS; THERE IS NO HAUL OFF OF MATERIAL; THEREFORE NO VEHICLE WASH OFF AREA IS SHOWN. WORKER PARKING ON WIMBLETON COURT WILL BE ALLOWED AS LONG AS DRIVEWAY ACCESS AND TRAFFIC FLOW IS NOT IMPEDED; ACCESS TO THE SITE FROM ANY OTHER LOCATION OTHER THAN THE PROPOSED SITE ACCESS, SHOWN OR NOT SHOWN IS STRICTLY PROHIBITED.
 24. CONSTRUCTION WORKING HOURS SHALL BE AS FOLLOWS:
 - OCTOBER 1 - MAY 31
7:00 A.M. TO 7:00 P.M. MONDAY-SUNDAY
 - JUNE 1 - SEPTEMBER 30
6:00 A.M. TO 8:00 P.M. MONDAY-FRIDAY
7:00 A.M. TO 8:00 P.M. SATURDAY AND SUNDAY
- ALL SURROUNDING PROPERTY OWNERS SHALL BE NOTIFIED A MINIMUM OF 24 HOURS PRIOR TO THE START OF GRADING AND DREDGING ACTIVITIES.

SHEET INDEX

SHEET	1 OF 4	COVER SHEET
SHEET	2 OF 4	SITE GRADING AND SWPPP PLAN
SHEET	3 OF 4	PROFILES
SHEET	4 OF 4	DETAILS

AS-BUILT

THIS IS TO CERTIFY THAT THE "AS-BUILT" CROSS-SECTIONS AND ELEVATIONS OF THE RETENTION BASIN, THE BASIN CONTROL STRUCTURE, AND THE BASIN DISCHARGE CULVERT, AS SHOWN ON THESE AS-BUILT PLANS ARE BASED ON FIELD MEASUREMENTS AS PERFORMED ON 4/28/2014 AND 4/29/2014. THIS IS ALSO TO CERTIFY THAT BASED ON SAID FIELD MEASUREMENTS THE AS-BUILT STORMWATER DETENTION CAPACITY AND AS-BUILT DESIGN HIGH WATER LEVELS OF THE AS-BUILT BASIN HAVE NOT CHANGED SIGNIFICANTLY FROM THE CONSTRUCTION PLAN AND CLOSELY RESEMBLE THE REVISED APPROVED ENGINEERING REPORT DATED 9/10/2013.

CITY PLANNING & DEVELOPMENT DIVISION FILE#:
GRADING PLAN APPROVAL DATE:

This document shall remain the property of Buescher Ditch and Associates, Inc. (BDA) and may not be used by any other party without the written consent of said BDA.

No.	DATE	REVISION DESCRIPTION
1	8/20/2013	REVISED PER CITY OF O'FALLON COMMENTS
2	5/15/2014	ADDED AS-BUILT TITLE, NOTES, AND CERTIFICATION

BUESCHER DITCH & ASSOCIATES, INC.
2 East Fifth Street, P.O. Box 621, Washington, Missouri 63090
Telephone: 1-636-239-7681
E-mail: www.buescherditch.com
P.E. Corporation No. 2001010603
P.L.S. Corporation No. 2001010600

AS-BUILT PLANS
COVER SHEET
RETENTION POND IMPROVEMENTS
FIELDSTONE FARMS SUBDIVISION
O'FALLON, MISSOURI 63368



MARK A. FELDMANN
PROJECT ENGINEER
E-19097
LICENSE NUMBER
5-15-2014
DATE
13002
PROJECT NUMBER
SIP RETENTION POND.dwg
FILE NAME
1 OF 4
SHEET OF
MAF
DRAWN CHECKED

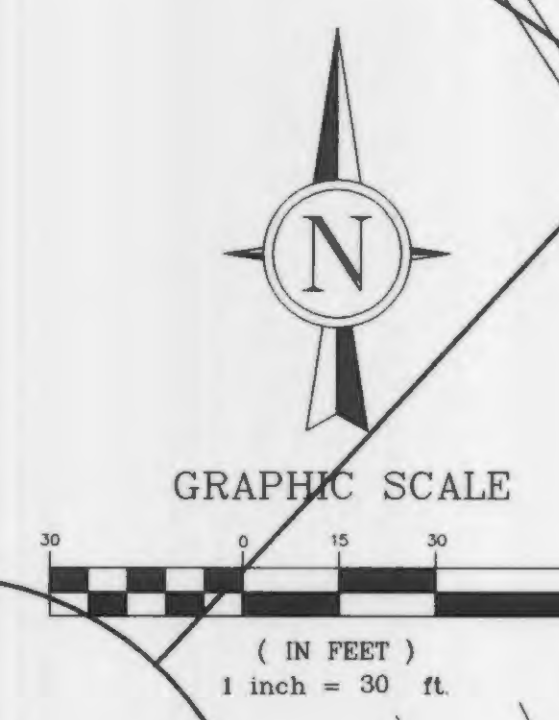
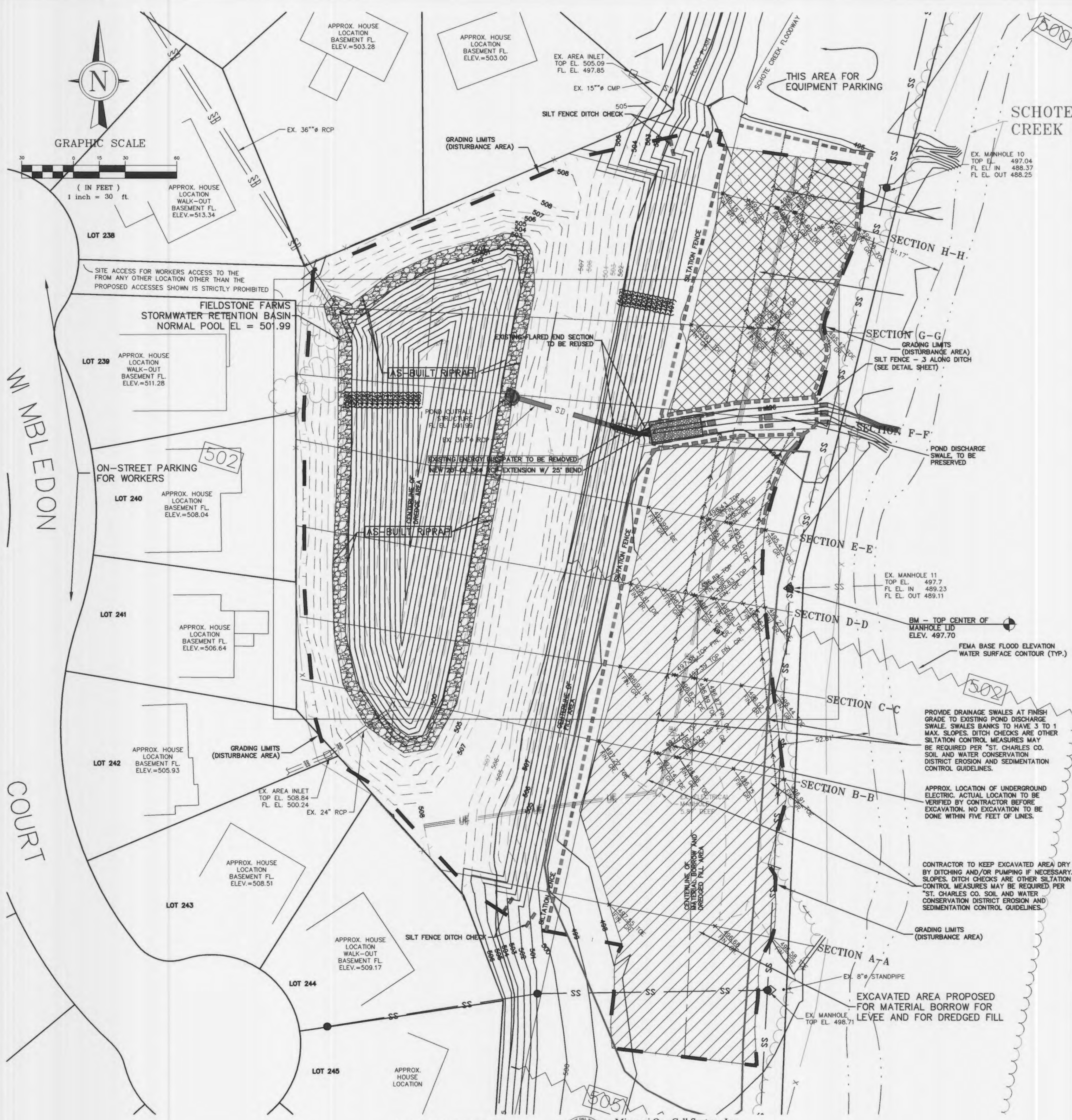

- SITE NOTES:**
- UNDERGROUND UTILITIES SHOWN HEREON HAVE BEEN PLOTTED FROM AVAILABLE INFORMATION AND DO NOT NECESSARILY REFLECT THE ACTUAL EXISTENCE, NON-EXISTENCE OR LOCATION OF THESE OR OTHER UTILITIES. THE LOCATION OF ANY EXISTING UNDERGROUND UTILITIES SHOWN HEREON SHALL BE CONSIDERED APPROXIMATE ONLY. THE VERIFICATION OF THE LOCATION OF ALL UNDERGROUND UTILITIES, EITHER SHOWN OR NOT SHOWN ON THESE PLANS, SHALL BE THE RESPONSIBILITY OF THE CONTRACTOR AND SHALL BE LOCATED PRIOR TO ANY GRADING OR CONSTRUCTION OF IMPROVEMENTS. THESE PROVISIONS SHALL IN NO WAY ABSOLVE ANY PARTY FROM COMPLYING WITH THE UNDERGROUND FACILITY SAFETY AND DAMAGE PREVENTION ACT, CHAPTER 319 RSMo.
 - THE CITY OF O'FALLON SHALL BE NOTIFIED AT LEAST 48 HOURS PRIOR TO CONSTRUCTION FOR COORDINATION OF INSPECTION.
 - ANY PERMITS, LICENSES, EASEMENTS, OR APPROVALS REQUIRED TO WORK ON PUBLIC OR PRIVATE PROPERTIES OR ROADWAYS ARE THE RESPONSIBILITY OF THE CONTRACTOR.
 - A GRADING PERMIT FROM THE CITY OF O'FALLON IS REQUIRED PRIOR TO ANY GRADING ON THE SITE AND A LAND DISTURBANCE PERMIT FROM THE DEPARTMENT OF NATURAL RESOURCES IS REQUIRED WHERE APPLICABLE. NO CHANGE IN WATERSHEDS SHALL BE PERMITTED.
 - PROPOSED EARTHWORK SHALL NOT CONFLICT WITH THE DEPTH OR HORIZONTAL LOCATION OF EXISTING UTILITIES. EXISTING UTILITY SERVICES SHALL NOT BE INTERRUPTED.
 - ALL EXISTING SITE IMPROVEMENTS DISTURBED, DAMAGED OR DESTROYED SHALL BE REPAIRED OR REPLACED TO CLOSELY MATCH PRE CONSTRUCTION CONDITIONS.
 - ALL FILL INCLUDING PLACES UNDER PROPOSED STORM AND SANITARY SEWER LINES AND PAVED AREAS INCLUDING TRENCH BACKFILLS WITHIN AND OFF THE ROAD RIGHT-OF-WAY SHALL BE PLACED IN MAXIMUM 8 INCH THICK LOOSE LIFTS AND SHALL BE MECHANICALLY COMPACTED TO AT LEAST 90 PERCENT OF MAXIMUM DENSITY AS DETERMINED BY THE MODIFIED AASHTO T-100 COMPACTION TEST (ASTM D1557). ALL TESTS SHALL BE VERIFIED BY A SOILS ENGINEER CONCURRENT WITH GRADING AND BACKFILLING OPERATIONS. THE COMPACTED FILL SHALL BE FREE OF ROOTS AND SHALL BE NON-YIELDING AND NON-PUMPING DURING PROOFROLLING AND COMPACTED. SHALL BE COMPACTED FROM THE BOTTOM OF THE FILL UP. NOTE THAT THE MOISTURE CONTENT OF THE SOIL IN FILL AREAS IS TO CORRESPOND TO THE COMPACTIVE EFFORT AS DEFINED BY THE STANDARD MODIFIED PROCTOR TEST. OPTIMUM MOISTURE CONTENT SHALL BE DETERMINED USING THE SAME TEST THAT WAS USED FOR COMPACTION. SOIL COMPACTION CURVES SHALL BE SUBMITTED TO THE CITY OF O'FALLON PRIOR TO THE PLACEMENT OF FILL. PROOF ROLLING MAY BE REQUIRED TO VERIFY SOIL STABILITY AT THE DISCRETION OF THE CITY OF O'FALLON.
 - EACH LAYER SHALL BE WETTED OR DRIED, IF NECESSARY, AND COMPACTED TO REQUIRED DENSITY. COMPACTIVE EFFORT ON EACH LAYER TO CONSIST OF DISTRIBUTING ALL EQUIPMENT MOVEMENTS OVER ENTIRE FILL AREA AND MAKING AT LEAST THREE COMPLETE COVERAGES WITH A TAMPING-TYPE ROLLER. THE TAMPING-TYPE ROLLER TO HAVE TAMPERS OR FEET PROJECTING NOT LESS THAN 6 INCHES FROM THE SURFACE OF THE DRUM AND SHALL HAVE A MINIMUM LOAD ON EACH TAMPER OF 250 POUNDS PER SQUARE INCH OF TAMPING AREA.
 - COMPACTION TESTS TO BE RESPONSIBILITY OF CONTRACTOR AS A FORM OF QUALITY CONTROL. TESTS TO BE TAKEN BY AN APPROVED TESTING FIRM AT LOCATIONS APPROVED BY THE ENGINEER. FREQUENCY OF THE TESTING FOR EACH LIFT TO BE ONE DENSITY TEST EVERY 10,000 SQUARE FEET OF FILL AREA OR AS DIRECTED BY THE ENGINEER. ALL TEST REPORTS TO BE SENT TO THE ENGINEER FOR REVIEW AND APPROVAL. THE CITY OF O'FALLON MAY, AT ITS DISCRETION, EMPLOY A TESTING FIRM AS A FORM OF QUALITY ASSURANCE.
 - THE FIELD DENSITY AFTER COMPACTION WILL BE DETERMINED IN ACCORDANCE WITH ASTM D2922 (NUCLEAR METHOD), ASTM D1556 (SAND CONE METHOD), ASTM D2167 (RUBBER BALLOON METHOD), OR ASTM D2937 (DRIVE CYLINDER METHOD).
 - WHERE EXCAVATION RESULTS IN SUBGRADE OR SLOPES OF UNSUITABLE MATERIAL, SUCH MATERIAL TO BE REMOVED AND REPLACED WITH APPROVED MATERIAL.
 - ROCK IS DEFINED AS MATERIAL THAT CANNOT BE EXCAVATED BY A STANDARD EXCAVATING MACHINE (BULLDOZER, BACKHOE, ETC.) WITHOUT DRILLING AND BLASTING OR WEDGING. ROCK SHALL BE REMOVED DOWN TO FINISH GRADES SHOWN ON THE PLANS. WHERE ROCK IS ENCOUNTERED, CONTRACTOR SHALL PROVIDE SUITABLE EQUIPMENT AND PERSONNEL FOR CARRYING OUT DRILLING, BLASTING, AND ROCK REMOVAL OPERATIONS IN A SAFE AND SENSIBLE MANNER.
 - WHEN SOLID ROCK IS ENCOUNTERED, STRIP ALL OVERLYING EARTH FROM ROCK AREA, THEN NOTIFY ENGINEER FOR INSPECTION AND MEASUREMENT. ENGINEER MAY THEN TAKE ELEVATIONS ON THE SURFACE OF THE ROCK AND ADJACENT GROUND LEVEL OR MAY, AT HIS DISCRETION, DEFER MEASUREMENT UNTIL EXCAVATION IS COMPLETED. IN ANY EVENT, CONTRACTOR SHALL NOT EXCAVATE FURTHER INTO THE ROCK UNTIL TOLD TO DO SO BY THE ENGINEER. ROCK VOLUME WILL BE DETERMINED USING LENGTHS AND DEPTHS AS MEASURED IN THE FIELD. CONTRACTOR WILL NOT BE ALLOWED PAYMENT FOR ANY ROCK CLAIMED UNLESS SAME HAS BEEN MEASURED AS HEREIN DEFINED.
 - ALL EXCAVATED MATERIAL TO BE STOCKPILED IN A MANNER THAT WILL NOT ENDANGER THE WORK OR IMPEDE DISCHARGE OF SURFACE WATER.
 - ALL EXCESS OR UNSUITABLE EXCAVATED MATERIAL TO BE STORED IN DESIGNATED STORAGE AREAS OR AS DIRECTED BY THE ENGINEER, AND LATER USED AS FILL IN UNCRITICAL AREAS OR REMOVED FROM THE SITE.
 - NEWLY FINISHED SURFACES TO BE PROTECTED FROM ANY ACTION OF THE ELEMENTS, OR ANY SETTLEMENT OR WASHING THAT MAY OCCUR.
 - MAINTAIN ACCESS TO EXISTING RESIDENTIAL DRIVEWAYS AND STREETS.
 - EXISTING UTILITY SERVICES SHALL NOT BE INTERRUPTED.
 - SILTATION CONTROL DEVICES TO BE IN PLACE DURING ALL OPERATIONS TO CONTROL EROSION. ADDITIONAL SILTATION AND EROSION CONTROL DEVICES MAY BE REQUIRED AS DIRECTED BY THE CITY OF O'FALLON.
 - ALL DISTURBED AREAS OF THE SITE TO BE PREPARED, LIMED, FERTILIZED AND SEEDING SURFACES TO BE FREE OF LARGE CLODS AND STONES AND FIRST SMOOTHED BY DISKING AND DRAGGING TO FORM A GOOD SEEDBED. SEEDBED SHALL THEN BE FIRMED BY ROLLING OR CULTIPACKING.
 - SEEDS TO BE SOWN BY A METHOD THAT WILL INSURE UNIFORM DISTRIBUTION OVER ENTIRE AREA.
 - STARTER LIME AND FERTILIZER TO BE UNIFORMLY APPLIED OVER THE PREPARED SURFACE AT THE FOLLOWING RATES:
 A.) LIME: 75 LB. PER 1,000 SQ. FT. (LIME SHALL ONLY BE ADDED WITH A SOIL pH OF 6.0 AND BELOW. DO NOT ADD LIME TO SOILS WITH A pH HIGHER THAN 7.0.)
 B.) FERTILIZER: 5-10-5 FERTILIZER AT 25 LB. PER 1,000 SQ. FT.
 - SEEDBEDS TO BE SEED AT 3.5 LB. PER 1,000 SQ. FT. WITH THE FOLLOWING MIXTURE:
 A.) PERENNIAL REGRESS 25%
 B.) KENTUCKY BLUEGRASS 60%
 C.) WHITE DUTCH CLOVER 15%
 IF CUT AND FILL OPERATIONS OCCUR DURING A SEASON NOT FAVORABLE FOR IMMEDIATE ESTABLISHMENT OF GROUND COVER, A FAST GERMINATING ANNUAL SEED SUCH AS RYE GRASS (COOL WEATHER) OR SUDAN GRASS (HOT WEATHER) SHALL BE UTILIZED TO RETARD EROSION.
 - ALL LEGUME SEEDS TO BE INOCULATED AT SEEDING TIME. SOW AS SOON AS POSSIBLE AFTER INOCULATION. KEEP INOCULATED SEED IN A SHADY PLACE BETWEEN TIME OF INOCULATION AND PLANTING. SEED HELD MORE THAN 24 HOURS SHOULD BE RE-INOCULATED.
 - THE SEEDING AREA TO BE ROLLED OR CULTIPACKED AFTER SEEDING AND MULCHED WITH STRAW OR BURLAP. RATE OF APPLICATION OF STRAW TO BE APPROXIMATELY 1 BALE PER 1,000 SQ. FT. AREA TO BE KEPT CONTINUALLY DAMP UNTIL SEEDLINGS ARE WELL ESTABLISHED.
 - THE CONTRACTOR SHALL PROTECT AND AVOID DAMAGE TO ALL PUBLIC AND PRIVATE PROPERTY ALONG THE LINE OF WORK. ANY DAMAGE DONE TO BE REPAIRED OR RESTORED AT HIS EXPENSE. PARTICULAR ATTENTION SHALL BE PAID TO AVOID DAMAGE TO TREES, SHRUBS, BUSHES, AND PRIVATE PROPERTY LOCATED IN AND ADJACENT TO EASEMENTS ON PRIVATE PROPERTY.
 - NO TREES MAY BE REMOVED OUTSIDE CONSTRUCTION LIMITS WITHOUT THE PERMISSION OF THE PROPERTY OWNER.
 - FINISHED LAWN AREA UPON WHICH EARTH HAS BEEN DEPOSITED SHALL BE CLEARED TO THE LEVEL OF THE EXISTING SOD, RAKED AND WATERED. AREAS WHERE SOD HAS BEEN DAMAGED, DESTROYED, OR RUTS HAVE BEEN FILLED IN, SHALL BE RE-SODDED. AREAS WHERE SOD IS ONLY SLIGHTLY DAMAGED MAY BE LIGHTLY RE-SEEDING, IF SO PERMITTED. ANY FENCES DISTURBED OUTSIDE THE CONSTRUCTION LINES WILL BE REPLACED TO THE SATISFACTION OF THE ENGINEER.
 - FINISHED LAWN AREA UPON WHICH EARTH HAS BEEN DEPOSITED SHALL BE CLEARED TO THE LEVEL OF THE EXISTING SOD, RAKED AND WATERED. AREAS WHERE SOD HAS BEEN DAMAGED, DESTROYED, OR RUTS HAVE BEEN FILLED IN, SHALL BE RE-SODDED. AREAS WHERE SOD IS ONLY SLIGHTLY DAMAGED MAY BE LIGHTLY RE-SEEDING, IF SO PERMITTED. ANY FENCES DISTURBED OUTSIDE THE CONSTRUCTION LINES WILL BE REPLACED TO THE SATISFACTION OF THE ENGINEER.
 - THERE IS NO HAUL-OFF, THEREFORE NO HAULING EQUIPMENT SHALL BE LEAVING SITE UNTIL COMPLETION OF PROJECT. (SEE NOTE 23 ON COVER SHEET)
 - ON-STREET PARKING ON WIMBLEDON IS PROVIDED FOR CONSTRUCTION CREW. (SEE NOTE 23 ON COVER SHEET)
 - SITE ACCESS FOR CONSTRUCTION EQUIPMENT IS THROUGH GRAVELLED ENTRYWAY TO SUBDIVISION COMMON AREA OFF OF WELDON SPRING ROAD AT SOUTH END OF SUBDIVISION (NOT SHOWN). ACCESS TO THE SITE FROM ANY OTHER LOCATION OTHER THAN THE PROPOSED SITE ACCESS, SHOWN OR NOT SHOWN IS STRICTLY PROHIBITED. (SEE NOTE 23 ON COVER SHEET)
 - ALL CONSTRUCTION ACCESSES SHALL BE STABILIZED WITH VEGETATION OR OTHER APPROVED MEANS AS NECESSARY IMMEDIATELY UPON COMPLETION OF THE WORK TO PREVENT FUTURE EROSION DUE TO CONSTRUCTION TRAFFIC.
 - THE CITY OF O'FALLON WILL NOT BE RESPONSIBLE FOR THE REMOVAL AND/OR REPLACEMENT OF ANY TREES THAT ARE DAMAGED AND/OR DESTROYED NOTE: DURING GRADING OPERATIONS AND BEYOND.
- THE CONTRACTOR SHALL ASSUME COMPLETE RESPONSIBILITY FOR CONTROLLING ALL SILTATION AND EROSION OF THE PROJECT AREA. THE CONTRACTOR SHALL USE WHATEVER MEANS NECESSARY TO CONTROL EROSION AND SILTATION INCLUDING, BUT NOT LIMITED TO, STAKED STRAW BALES AND/OR SILTATION FABRIC FENCES (POSSIBLE METHODS OF CONTROL ARE DETAILED IN THE PLAN). CONTROL SHALL COMMENCE WITH GRADING AND BE MAINTAINED THROUGHOUT THE PROJECT UNTIL ACCEPTANCE OF THE WORK BY THE OWNER, AND/OR THE CITY OF O'FALLON AND/OR AS NECESSARY BY MODOT. THE CONTRACTOR'S RESPONSIBILITIES INCLUDE ALL DESIGN AND IMPLEMENTATION AS REQUIRED TO PREVENT EROSION AND THE DEPOSITING OF SILT. THE OWNER AND/OR THE CITY OF O'FALLON, AND/OR AS NECESSARY BY MODOT MAY AT THEIR OPTION DIRECT THE CONTRACTOR IN HIS METHODS AS DEEMED FIT TO PROTECT PROPERTY AND IMPROVEMENTS. ANY DEPOSITING OF SILT OR MUD ON NEW OR EXISTING PAVEMENT SHALL BE REMOVED IMMEDIATELY ANY DEPOSITING OF SILTS OR MUD IN NEW OR EXISTING STORM SEWERS OR SWALES SHALL BE REMOVED AFTER EACH RAIN AND AFFECTED AREAS CLEARED TO THE SATISFACTION OF THE OWNER AND/OR THE CITY OF O'FALLON, AND/OR AS NECESSARY BY MODOT.
- TO CONTROL SEDIMENT RUNOFF AND EROSION, DRAINAGE SWALES IN THE FLOODWAY MAY REQUIRE DITCH CHECKS OR OTHER SILTATION CONTROL MEASURES IN ADDITION TO EROSION CONTROL MEASURES SHOWN. REFER TO "ST. CHARLES CO. SOIL AND WATER CONSERVATION DISTRICT EROSION AND SEDIMENTATION CONTROL" GUIDELINES FOR ADDITIONAL INFORMATION AND REQUIREMENTS.

No.	DATE	REVISION DESCRIPTION
1	8/30/2013	RELEASED FOR CITY OF O'FALLON COMMENTS
2	9/10/2013	CALLED OUT 25" BEND IN 36" RCP
3	10/15/2014	ISSUE AS-BUILT TITLE, NOTES, AND CERTIFICATION

BUESCHER DITCH & ASSOCIATES, INC.
 2 East Fifth Street, P.O. Box 621, Washington, Missouri 63090
 Telephone: 1-636-293-6285
 Fax: 1-636-293-7661
 E-mail: www.buescherditch.com
 P.L.S. Corporation No. 2001010603
 P.L.S. Corporation No. 2001010600

AS-BUILT PLANS
SITE, GRADING, AND SWPPP PLAN
RETENTION POND IMPROVEMENTS
FIELDSTONE FARMS SUBDIVISION
O'FALLON, MISSOURI 63368



Mark A. Feldmann
 9/21/2014
 MARK A. FELDMANN
 PROJECT ENGINEER
 E-19097
 LICENSE NUMBER
 5-15-2014
 DATE
 13002
 PROJECT NUMBER
 SIP RETENTION POND.dwg
 FILE NAME
 2 OF 4
 SHEET OF
 MAF
 DRAWN CHECKED

AS-BUILT

THIS IS TO CERTIFY THAT THE "AS-BUILT" CROSS-SECTIONS AND ELEVATIONS OF THE RETENTION BASIN, THE BASIN CONTROL STRUCTURE, AND THE BASIN DISCHARGE CULVERT, AS SHOWN ON THESE AS-BUILT PLANS ARE BASED ON FIELD MEASUREMENTS AS PERFORMED ON 4/28/2014 AND 4/29/2014. THIS IS ALSO TO CERTIFY THAT BASED ON SAID FIELD MEASUREMENTS THE AS-BUILT STORMWATER DETENTION CAPACITY AND AS-BUILT DESIGN HIGH WATER LEVELS OF THE AS-BUILT BASIN HAVE NOT CHANGED SIGNIFICANTLY FROM THE CONSTRUCTION PLAN AND CLOSELY RESEMBLE THE REVISED APPROVED ENGINEERING REPORT DATED 9/10/2013.

This document shall remain the property of Buescher Ditch and Associates, Inc. (BDA) and may not be used by any other party without the written consent of said BDA.

OSHA RULES AND REGULATIONS
 All OSHA rules and regulations established for the types of construction activities required by these Plans shall be strictly followed.

Missouri One Call System, Inc.
 Call Before You Dig!
 1-800-DIG-RITE
 (1-800-344-7483)

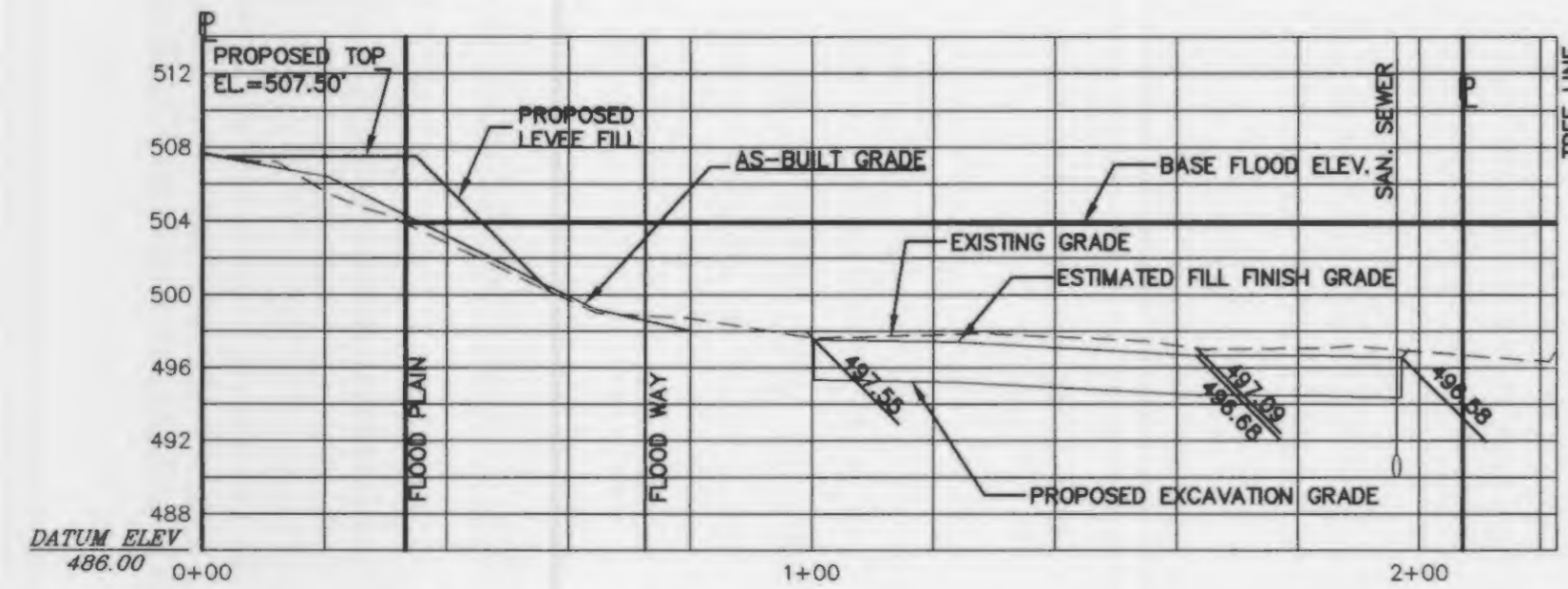

SECTION A-A

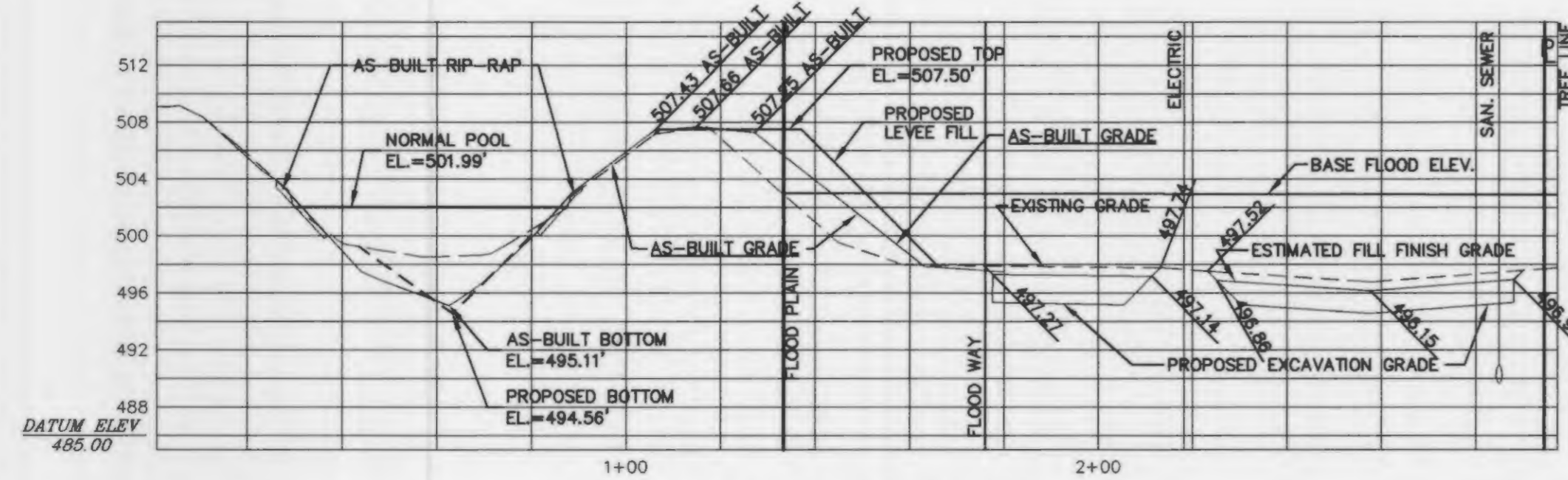

SECTION B-B

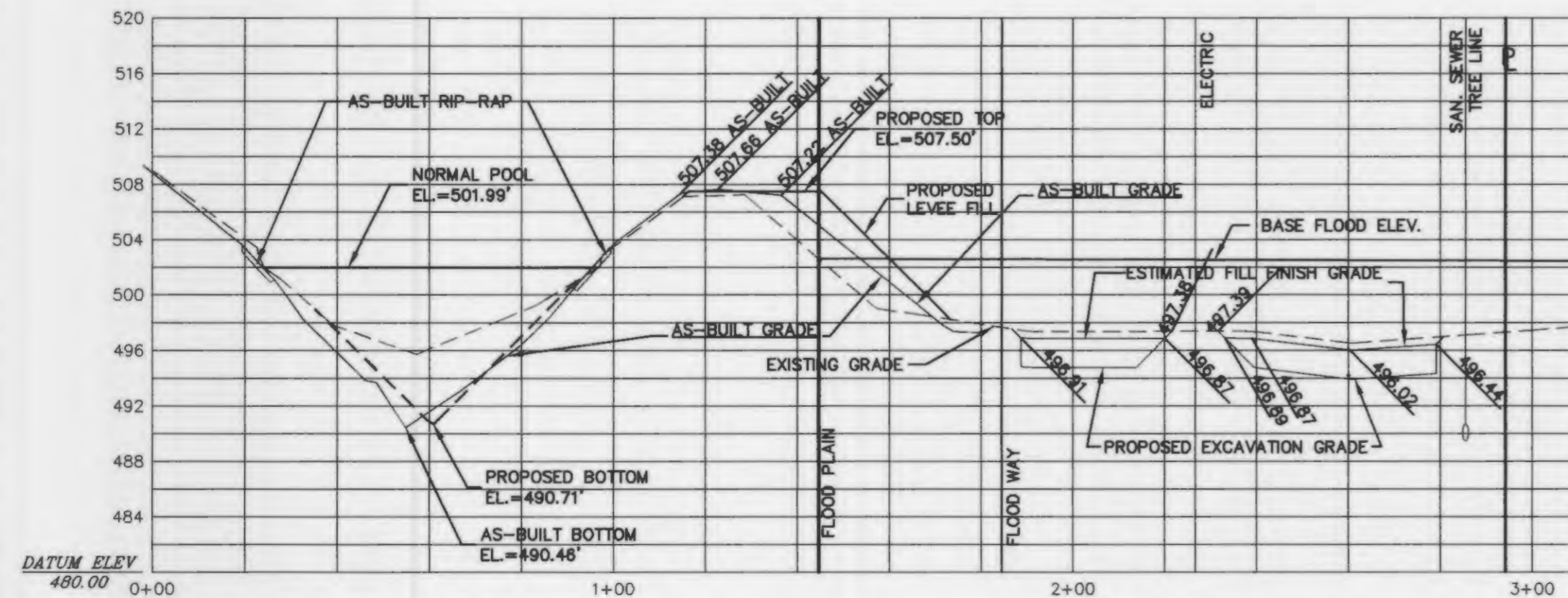

SECTION C-C

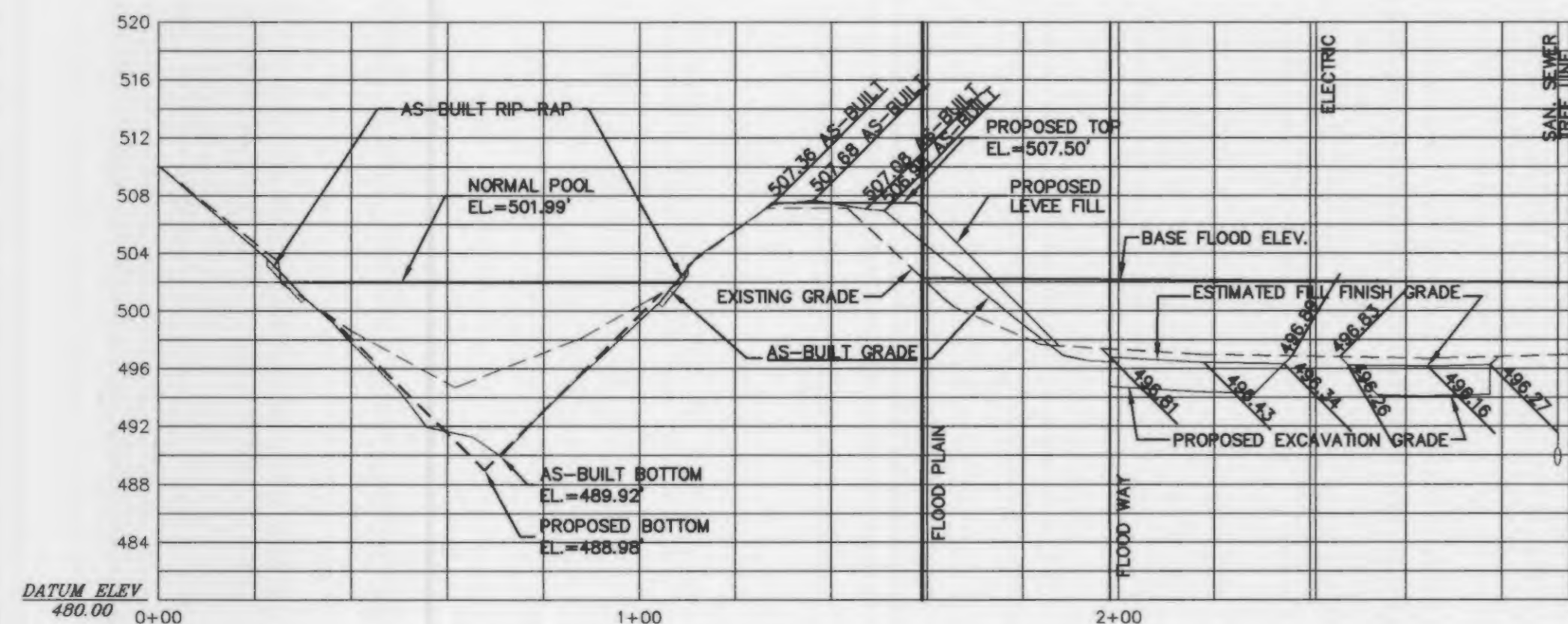

SECTION D-D

SCALE:
HORIZONTAL 1" = 30'
VERTICAL 1" = 10'

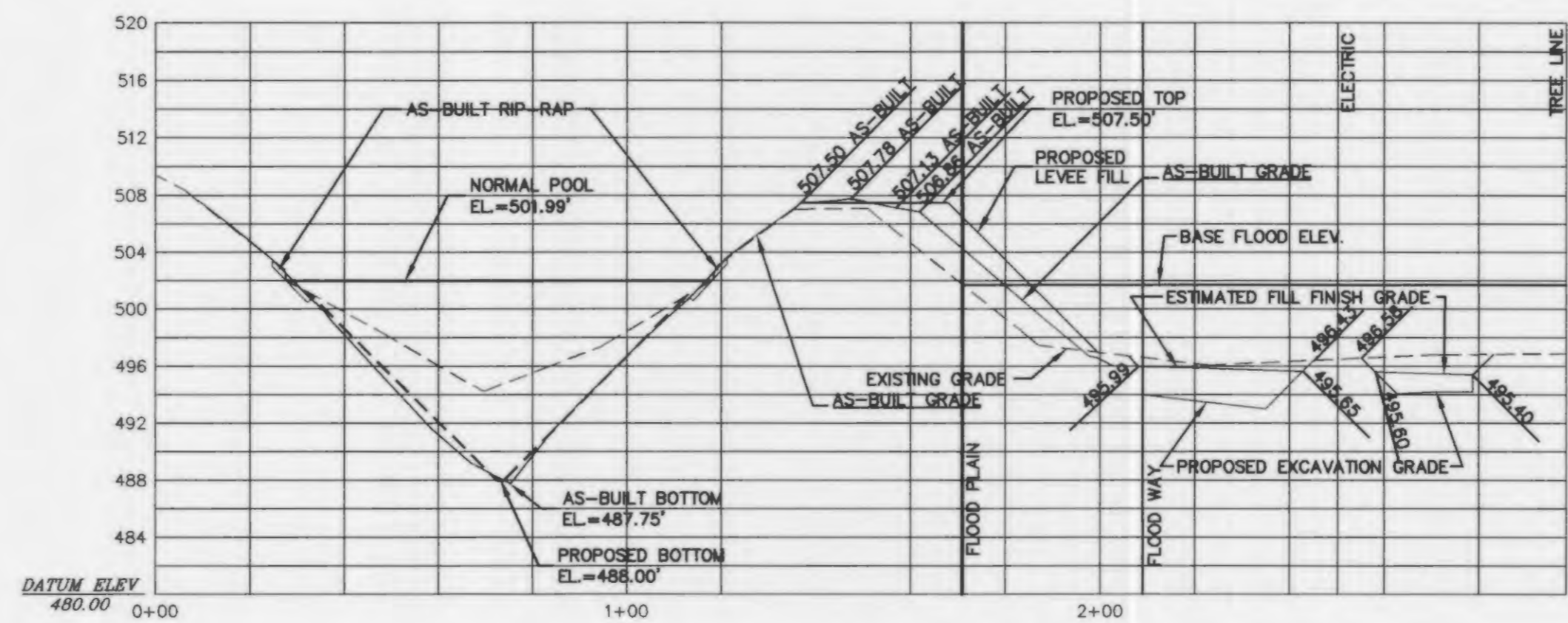

SECTION E-E

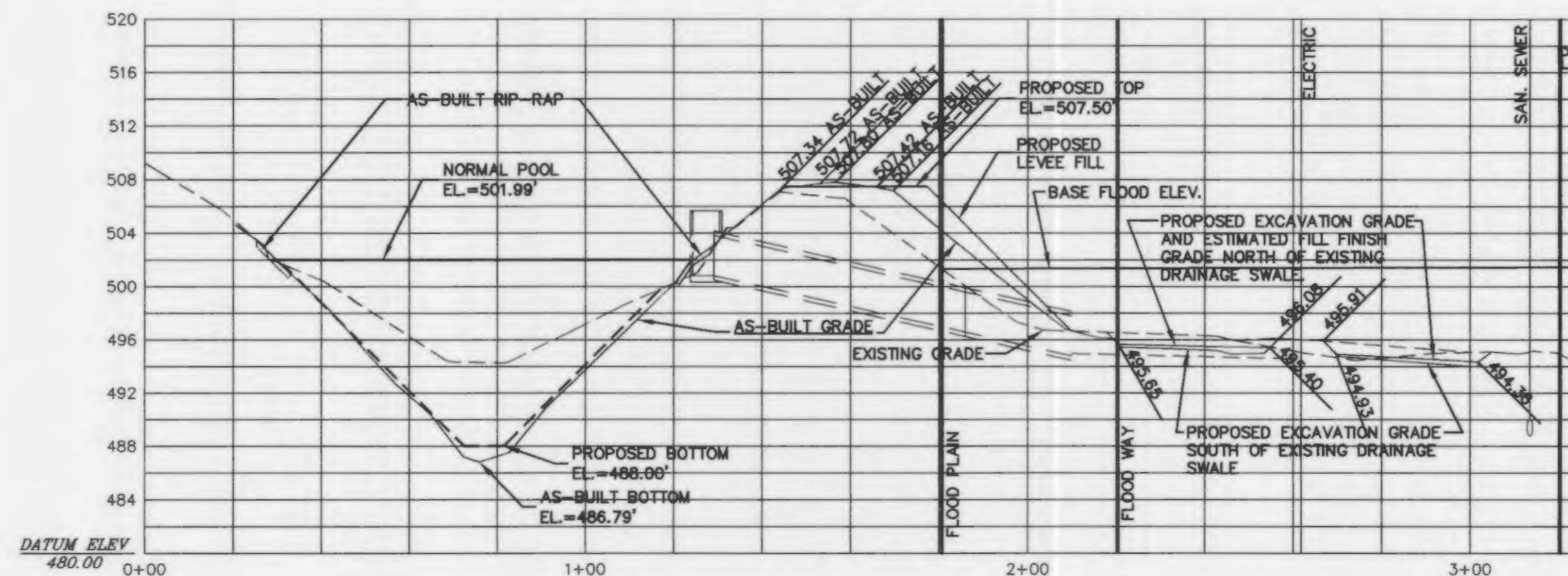

SECTION F-F

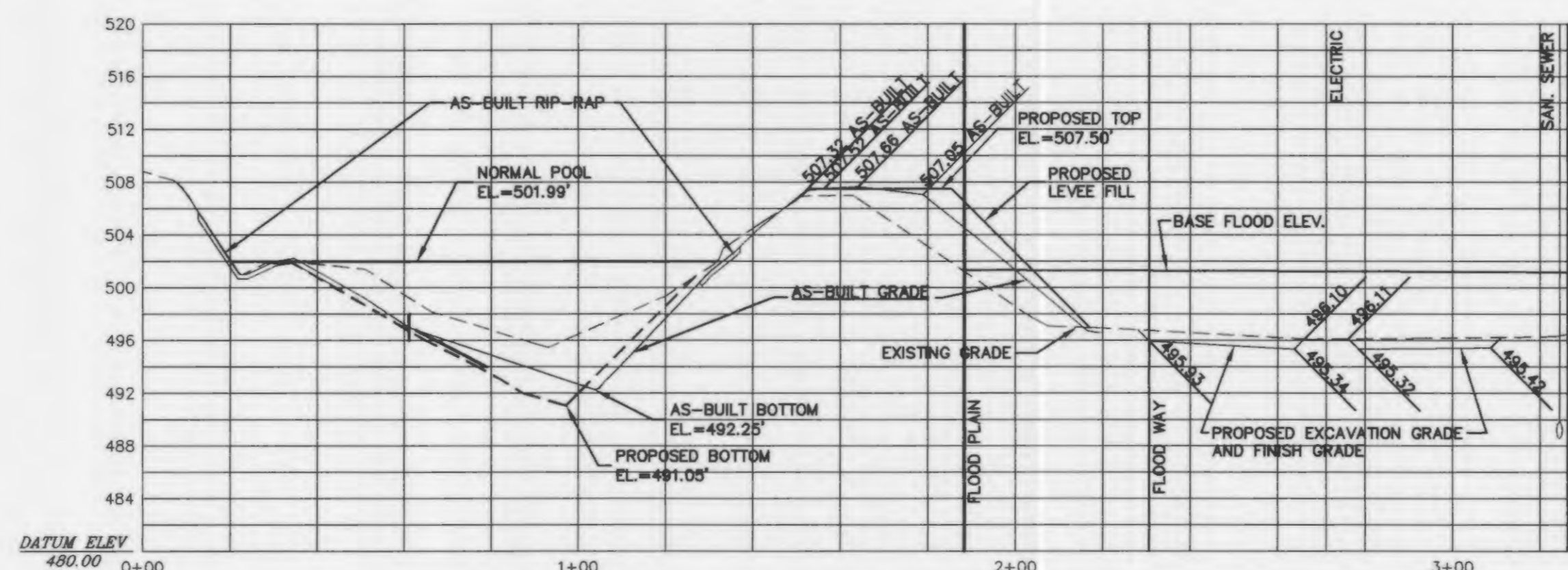

SECTION G-G

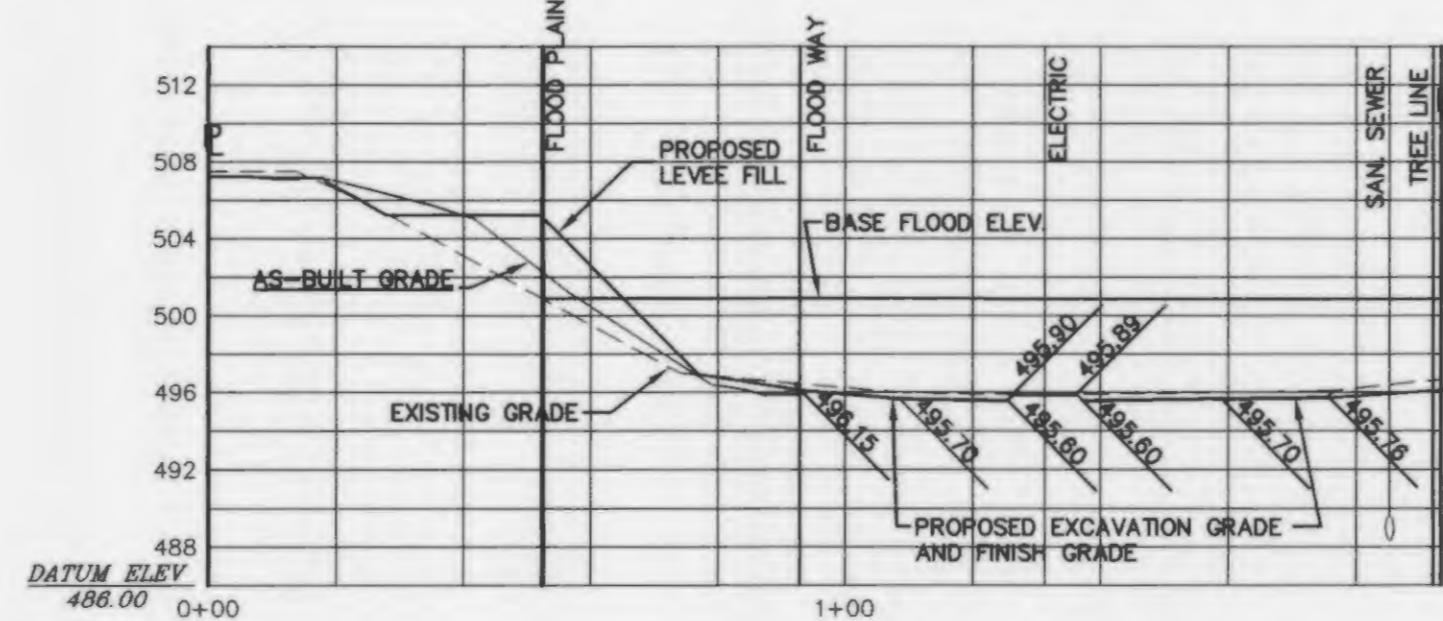

SECTION H-H

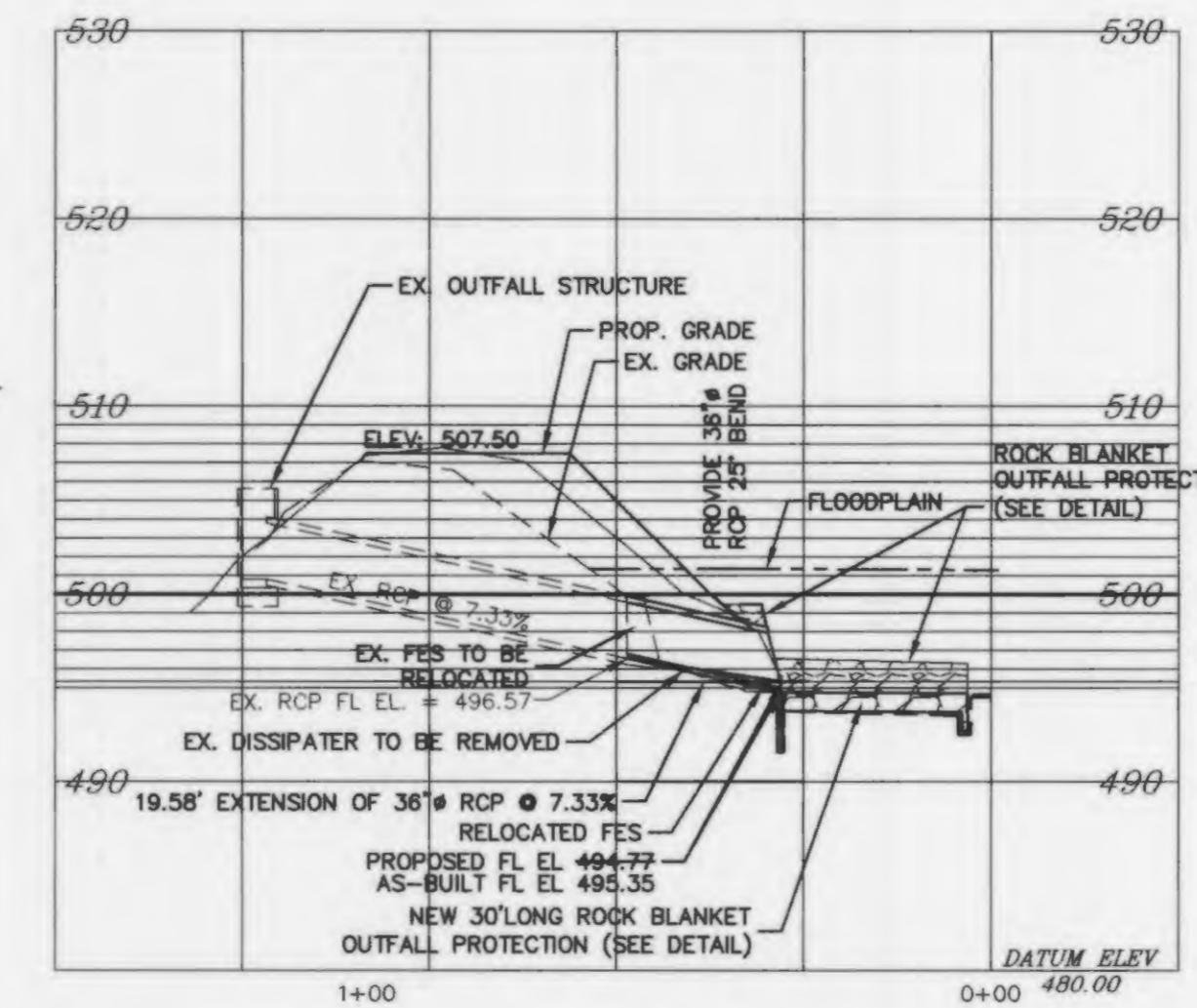

PROFILE OF EXISTING DISCHARGE CULVERT AND PROPOSED EXTENSION

AS-BUILT

AS-BUILT CALCULATED STORMWATER DETENTION HIGH WATER ELEVATIONS

15 YR - 20 MIN.	- PROPOSED 504.80 FT., AS-BUILT 504.80 FT.
25 YR - 20 MIN.	- PROPOSED 505.25 FT., AS-BUILT 505.25 FT.
100 YR - 20 MIN.	- PROPOSED 505.95 FT., AS-BUILT 505.95 FT.
100 YR - 20 MIN.	- PROPOSED 506.50 FT., AS-BUILT 506.50 FT.

THIS IS TO CERTIFY THAT THE "AS-BUILT" CROSS-SECTIONS AND ELEVATIONS OF THE RETENTION BASIN, THE BASIN CONTROL STRUCTURE, AND THE BASIN DISCHARGE CULVERT, AS SHOWN ON THESE AS-BUILT PLANS ARE BASED ON FIELD MEASUREMENTS AS PERFORMED ON 4/28/2014 AND 4/29/2014. THIS IS ALSO TO CERTIFY THAT BASED ON SAID FIELD MEASUREMENTS THE AS-BUILT STORMWATER DETENTION CAPACITY AND AS-BUILT DESIGN HIGH WATER LEVELS OF THE AS-BUILT BASIN HAVE NOT CHANGED SIGNIFICANTLY FROM THE CONSTRUCTION PLAN AND CLOSELY RESEMBLE THE REVISED APPROVED ENGINEERING REPORT DATED 9/10/2013.

No.	DATE	REVISION DESCRIPTION
1	18/30/2013	REVISED PER CITY OF FALLON COMMENTS
2	19/10/2013	CALLED OUT "25" BEND IN 36" RCP
3	5/15/2014	ADDED AS-BUILT TITLE NOTES, AS-BUILT AND AS-BUILT BASIN CROSS-SECTIONS

BUESCHER DITCH & ASSOCIATES, INC.
2 East Fifth Street, P.O. Box 621, Washington, Missouri 63090
Telephone: 1-636-239-7681
E-mail: www.buescherditch.com
P.E. Corporation No. 2001010603
P.L.S. Corporation No. 2001010600

AS-BUILT PLANS
SECTIONS & PROFILES
RETENTION POND IMPROVEMENTS
FIELDSTONE FARMS SUBDIVISION
O'FALLON, MISSOURI 63368

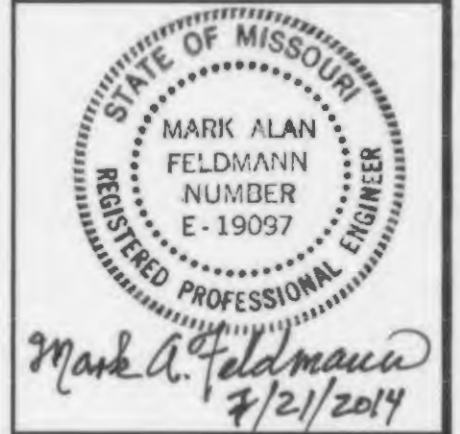

MARK A. FELDMANN
PROJECT ENGINEER
E-19097
LICENSE NUMBER
5-15-2014
DATE
13002
PROJECT NUMBER
SIP RETENTION POND.dwg
FILE NAME
3 OF 4
SHEET OF
MAF
DRAWN CHECKED

Missouri One Call System, Inc.
Call Before You Dig!
1-800-DIG-RITE
(1-800-344-7483)

This document shall remain the property of Buescher Ditch and Associates, Inc. (BDA) and may not be used by any other party without the written consent of said BDA.

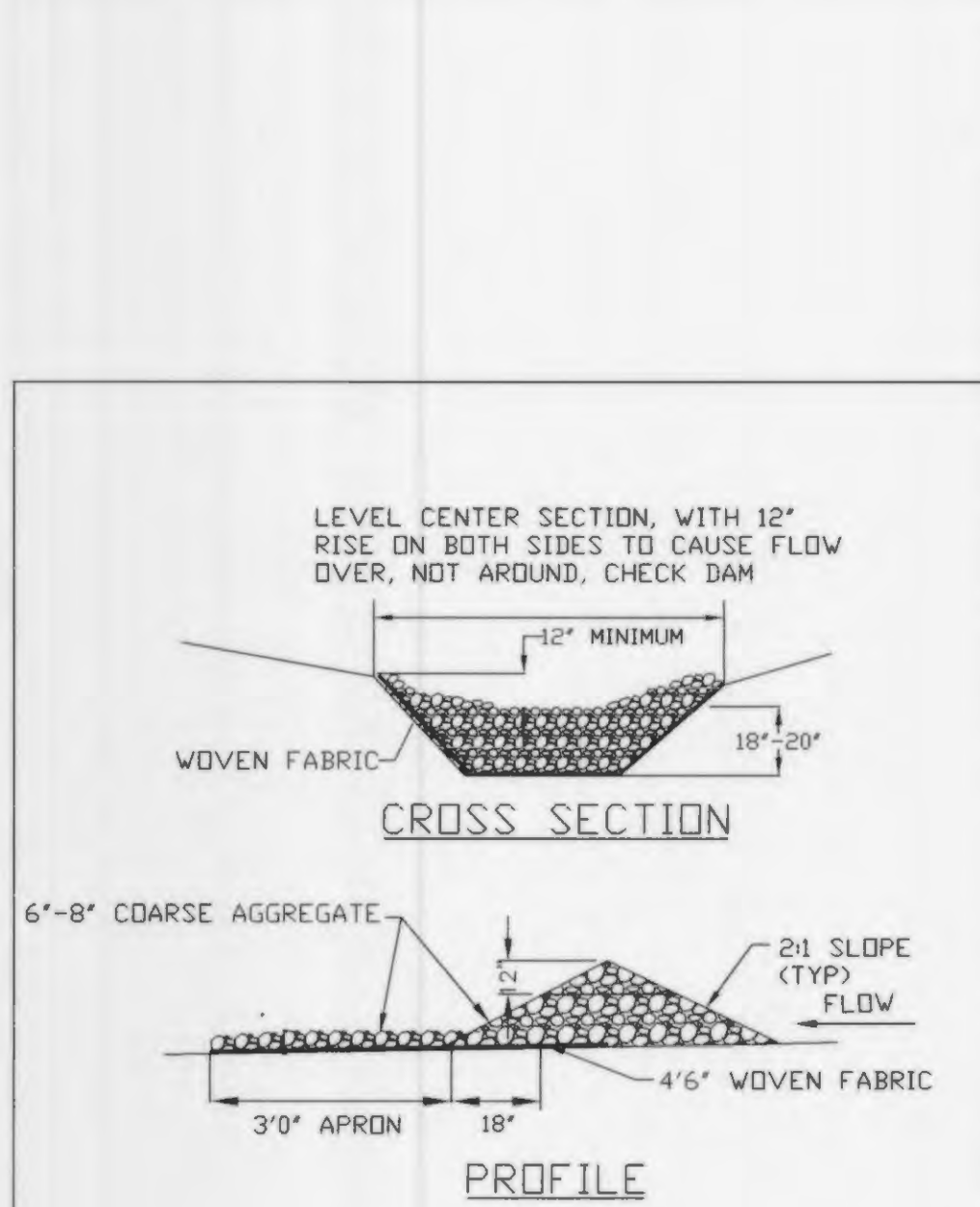

NOTE:
1. CHECK DAMS MAY BE CONSTRUCTED OF SEVERAL ESC CHECK DAM PRODUCTS, SUCH AS TRIANGULAR SILT DIKE®.

ROCK CHECK DAM

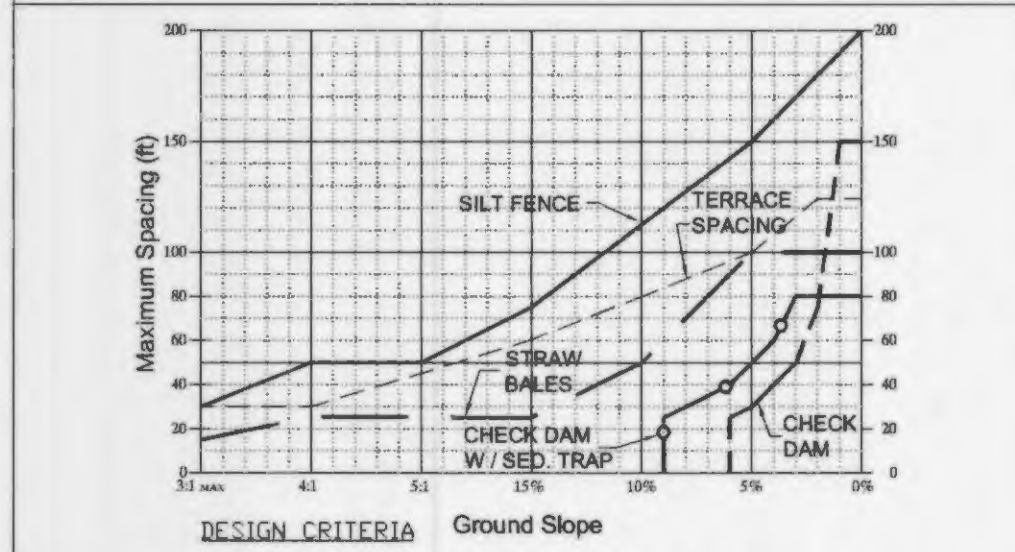

- SILT FENCE SHALL HAVE MAXIMUM DRAINAGE AREA OF 1/2 ACRE PER 100 LF.
- STRAW BALE BARRIERS FOR SHEET FLOW SHALL HAVE A MAXIMUM DRAINAGE AREA OF 1/4 ACRE PER 100 LF.
- REFER TO INDIVIDUAL DETAIL FOR INSTALLATION.
- TERRACING INCLUDES LOGS, WATTLES & FILTER SOCKS. EROSION & SEDIMENT CONTROLS SPACING CHART FOR ESC DEVICES

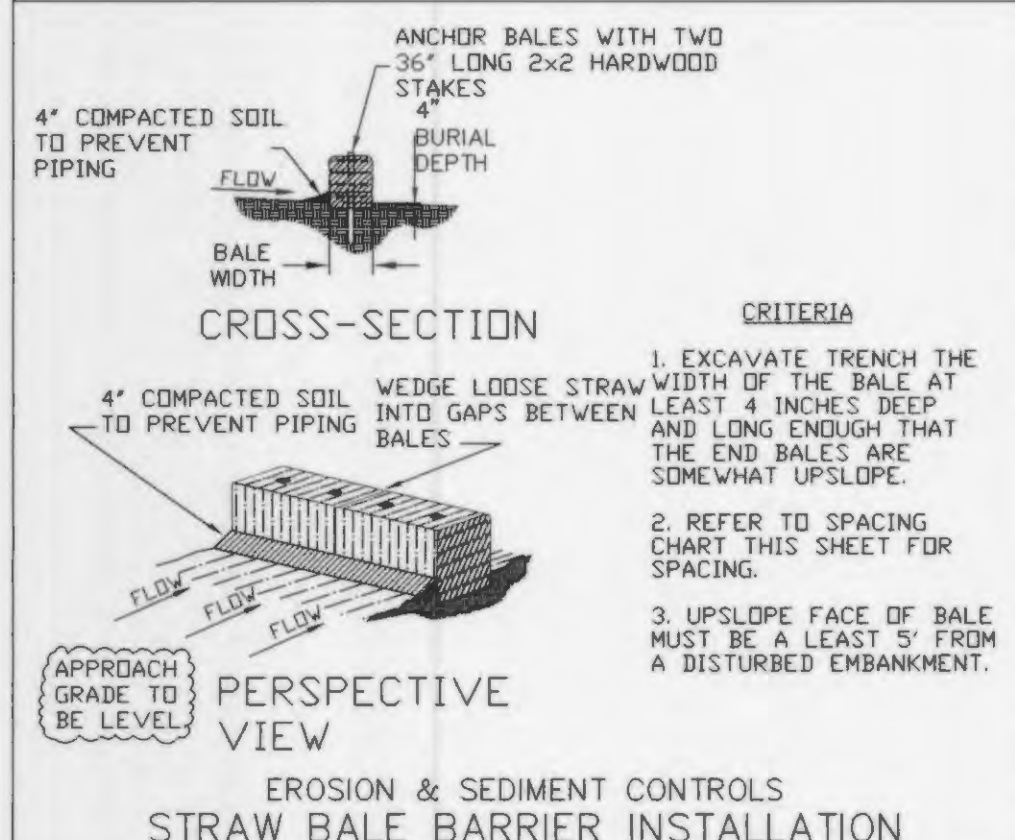

- GENERAL SILTATION CONTROL NOTES:**
- DO NOT SCALE DRAWING FOLLOW DIMENSIONS
 - ADDITIONAL STRAW BALES MAY BE REQUIRED AS DIRECTED BY THE GOVERNING AUTHORITY
 - SILTATION CONTROL DEVICES TO REMAIN IN PLACE UNTIL ADEQUATE VEGETATIVE GROWTH INSURES NO FURTHER EROSION OF THE SOIL
 - SILTATION FENCES SHALL BE INSPECTED PERIODICALLY FOR DAMAGE AND FOR THE AMOUNT OF SEDIMENTATION WHICH HAS ACCUMULATED. REMOVAL OF SEDIMENT WILL BE REQUIRED WHEN IT REACHES 1/2 OF THE HEIGHT OF THE SILTATION FENCE.
 - STRAW BALES SHALL BE INSPECTED PERIODICALLY FOR DETERIORATION. BALES WHICH HAVE ROTTED OR FAILED SHALL BE REPLACED AS DIRECTED BY THE GOVERNING AUTHORITY.
 - ATTACHMENT OF WELDED WIRE FENCE AND GEOTEXTILE FABRIC TO BE IN ACCORDANCE WITH THE MANUFACTURER'S RECOMMENDATION.

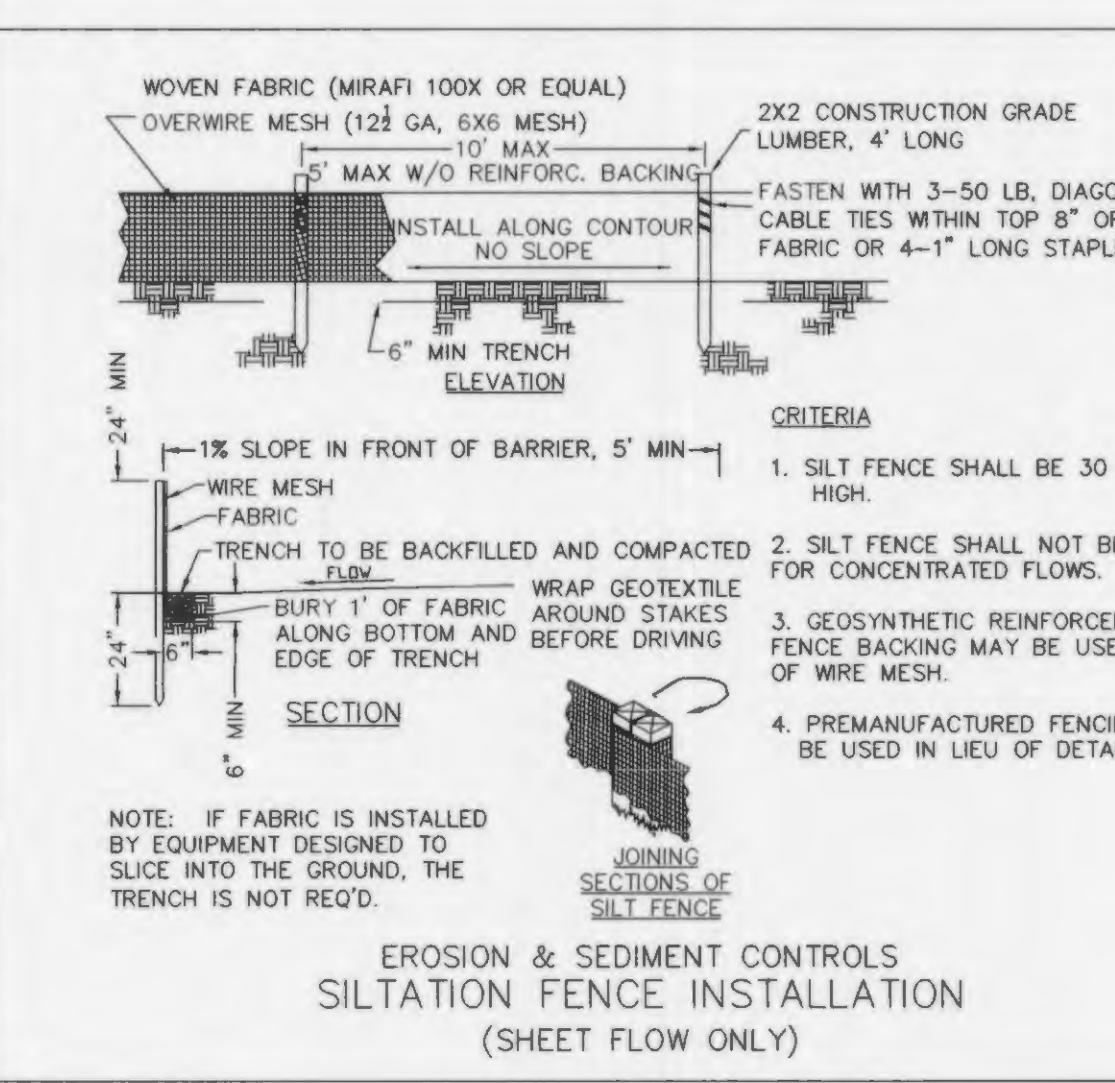
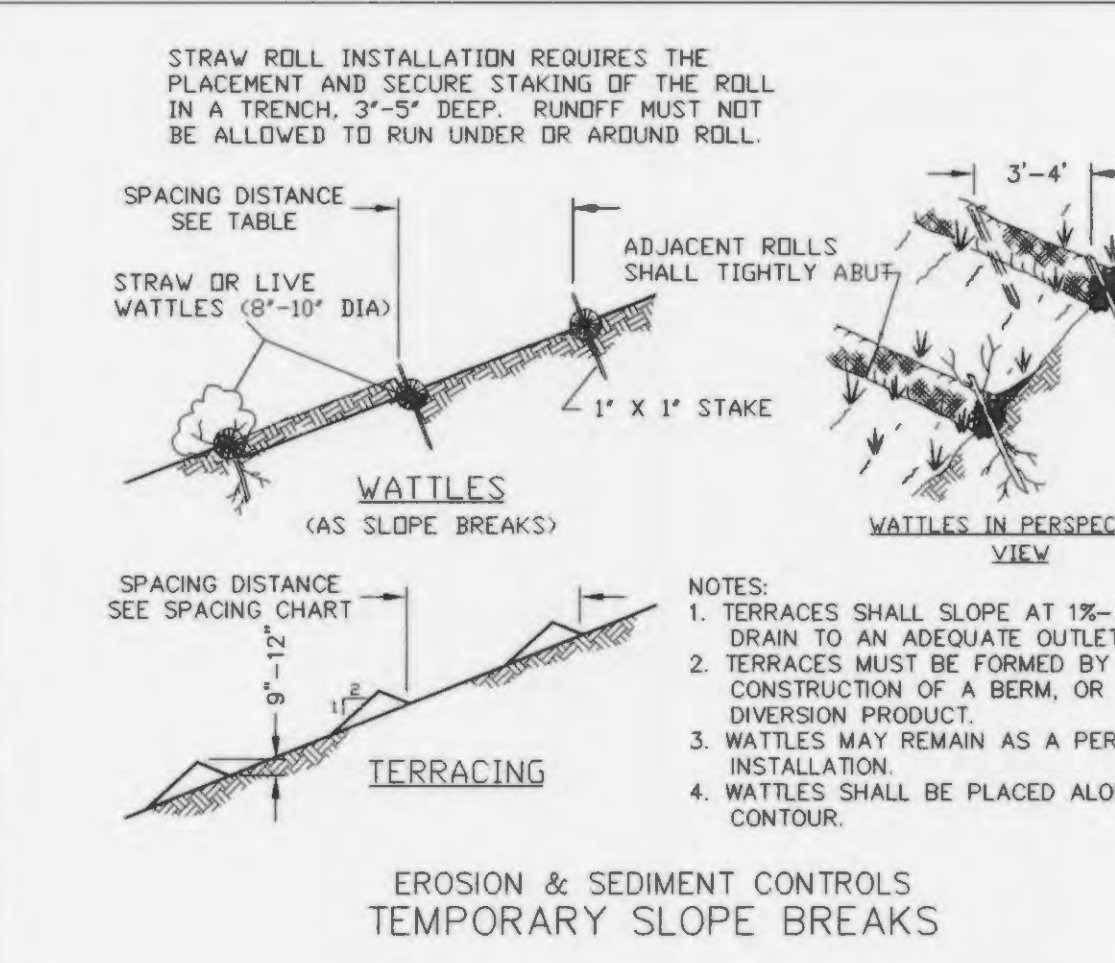
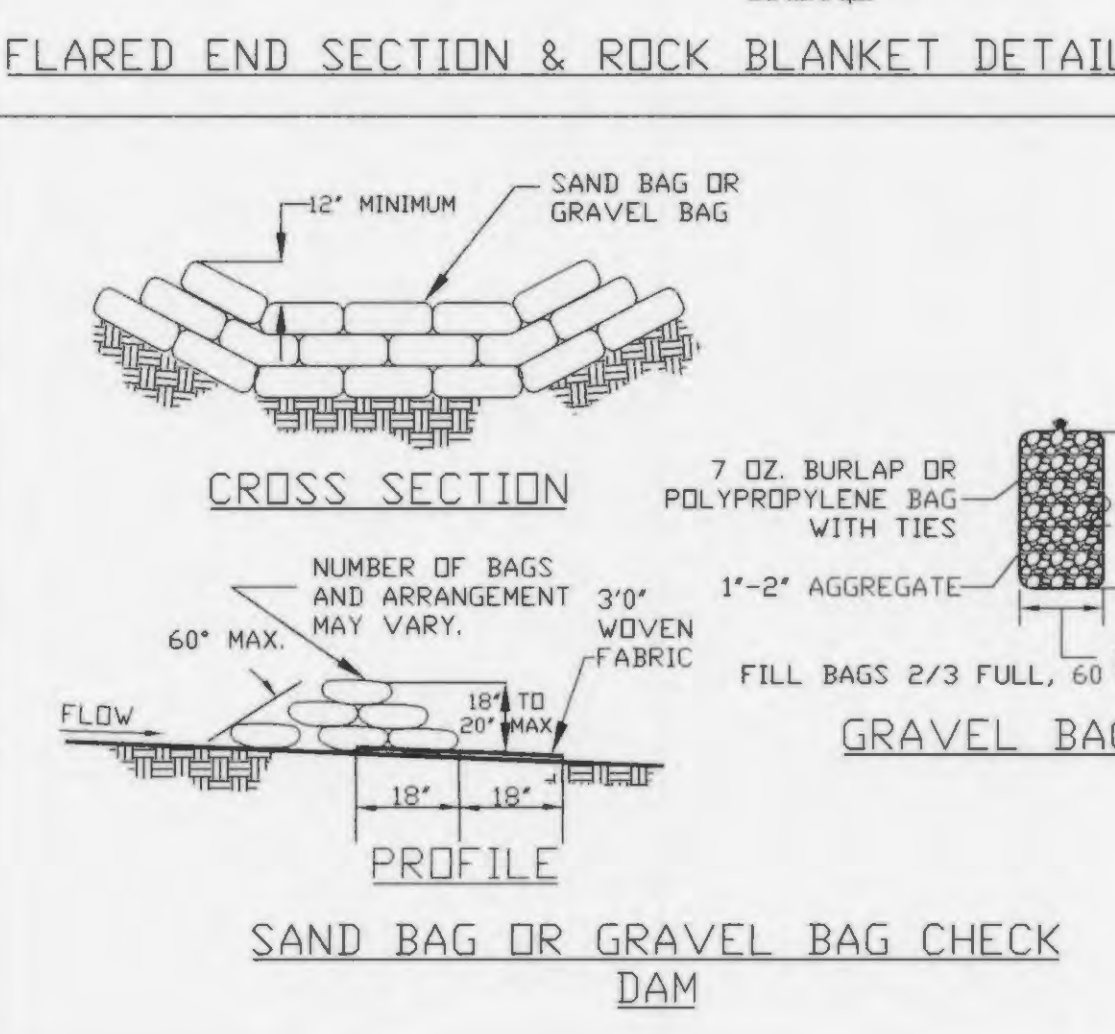
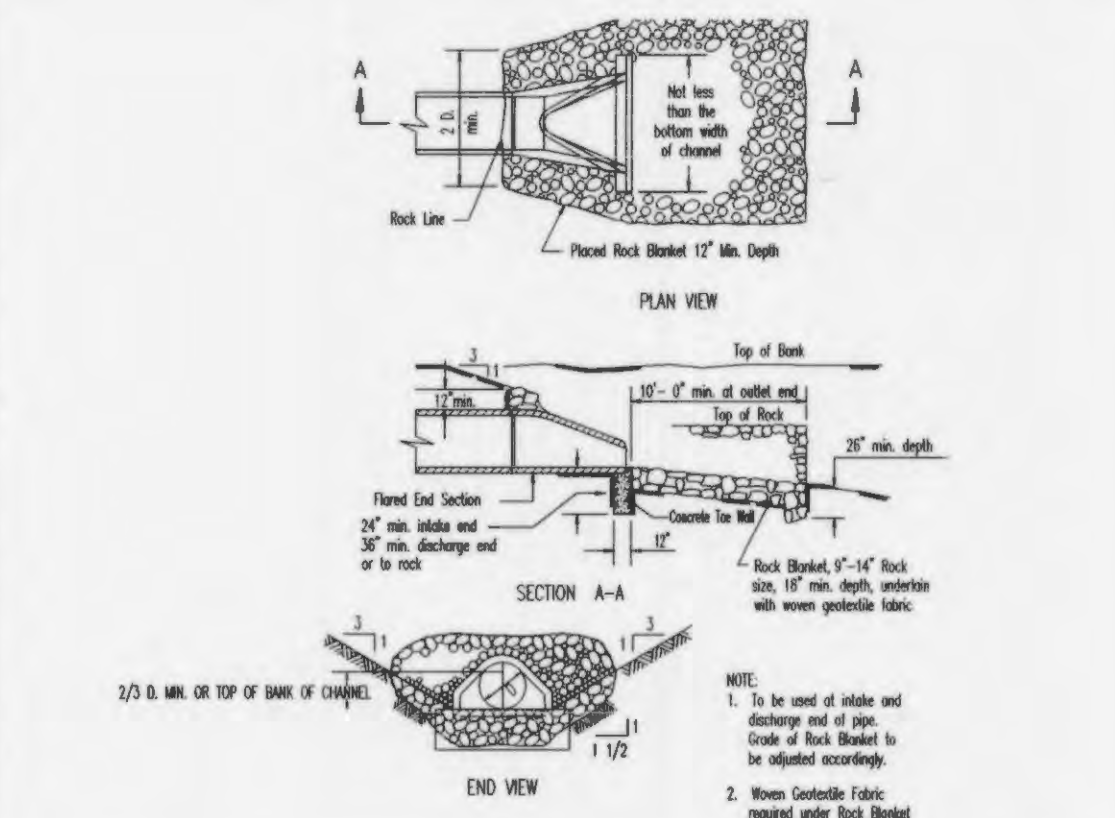

- MAINTENANCE:**
- INLET PROTECTION DEVICES AND BARRIERS SHALL BE REPLACED IF THEY SHOW SIGNS OF UNDERMINING OR DETERIORATION.
 - ALL SEEDED AREAS SHALL BE CHECKED REGULARLY TO SEE THAT A GOOD STAND IS MAINTAINED. AREAS SHOULD BE FERTILIZED, WATERED, AND RESEEDED AS NEEDED.
 - SEDIMENT FENCES SHALL BE REPAIRED TO THEIR ORIGINAL CONDITION IF DAMAGED. SEDIMENT SHOULD BE REMOVED FROM THE SEDIMENT FENCES WHEN IT REACHES ONE-THIRD THE HEIGHT OF THE SEDIMENT FENCE.
 - THE CONSTRUCTION ENTRANCE (WASH OFF AREA) SHALL BE MAINTAINED IN A CONDITION WHICH WILL PREVENT TRACKING OR FLOW OF MUD ONTO PUBLIC RIGHTS-OF-WAY. THIS MAY REQUIRE PERIODIC TOP DRESSING OF THE CONSTRUCTION ENTRANCE AS CONDITIONS DEMAND.
- GENERAL NOTES:**
- THE UTILITIES SHOWN HEREIN WERE PLOTTED FROM AVAILABLE INFORMATION AND DO NOT NECESSARILY REFLECT THE ACTUAL EXISTENCE, NONEXISTENCE, SIZE, TYPE, OR LOCATION OF THESE OR OTHER UTILITIES. THE CONTRACTOR SHALL BE RESPONSIBLE FOR VERIFYING THE ACTUAL LOCATION OF ALL UTILITIES, SHOWN OR NOT SHOWN, AND SAID UTILITIES SHALL BE LOCATED IN THE FIELD PRIOR TO ANY CONSTRUCTION OF IMPROVEMENTS. THESE PROVISIONS SHALL IN NO WAY ABSOLVE ANY PARTY FROM COMPLYING WITH THE UNDERGROUND FACILITY SAFETY AND DAMAGE PREVENTION ACT, CHAPTER 319 RSMO.
 - ALL GRADED AREAS SHALL BE PROTECTED FROM EROSION BY EROSION CONTROL DEVICES AND/OR SEEDING AND MULCHING.
 - GRADING CONTRACTOR SHALL INSTALL SILTATION CONTROL PRIOR TO STARTING THE GRADING.
 - ALL FILLS AND BACKFILLS SHALL BE MADE OF SELECTED EARTH MATERIALS, FREE FROM BROKEN MASONRY, ROCK, FROZEN EARTH, RUBBISH, ORGANIC MATERIAL AND DEBRIS.
 - GRADING CONTRACTOR SHALL KEEP EXISTING ROADWAYS CLEAN OF MUD AND DEBRIS AT ALL TIMES.
 - NO GRADE SHALL EXCEED 3:1 SLOPE, OR AS DIRECTED BY SOIL CONSULTANT.
 - A GRADING PERMIT FROM THE DIRECTOR OF PUBLIC WORKS IS REQUIRED PRIOR TO ANY GRADING ON THE SITE AND A LAND DISTURBANCE PERMIT FROM THE DEPARTMENT OF NATURAL RESOURCES, WHERE APPLICABLE NO CHANGE IN WATERSHEDS SHALL BE PERMITTED.
 - ALL JOINTS SHALL BE GASKETED "O-RING" TYPE.
 - PROVIDE 3/8" DIA. TRASH BARS FOR ALL INLETS.
 - ALL PROPOSED FENCING REQUIRES A SEPARATE PERMIT THROUGH THE PLANNING DIVISION.

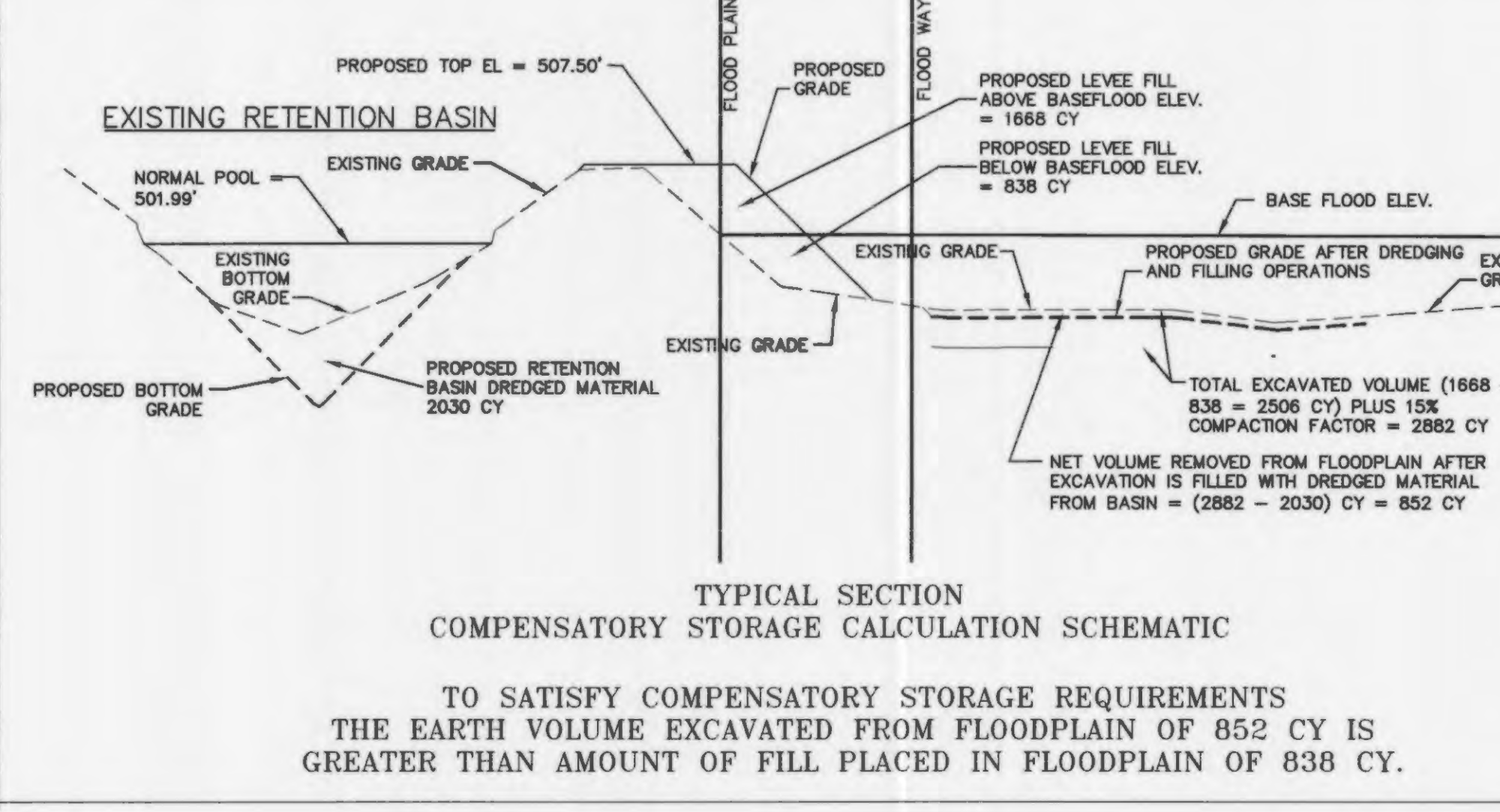
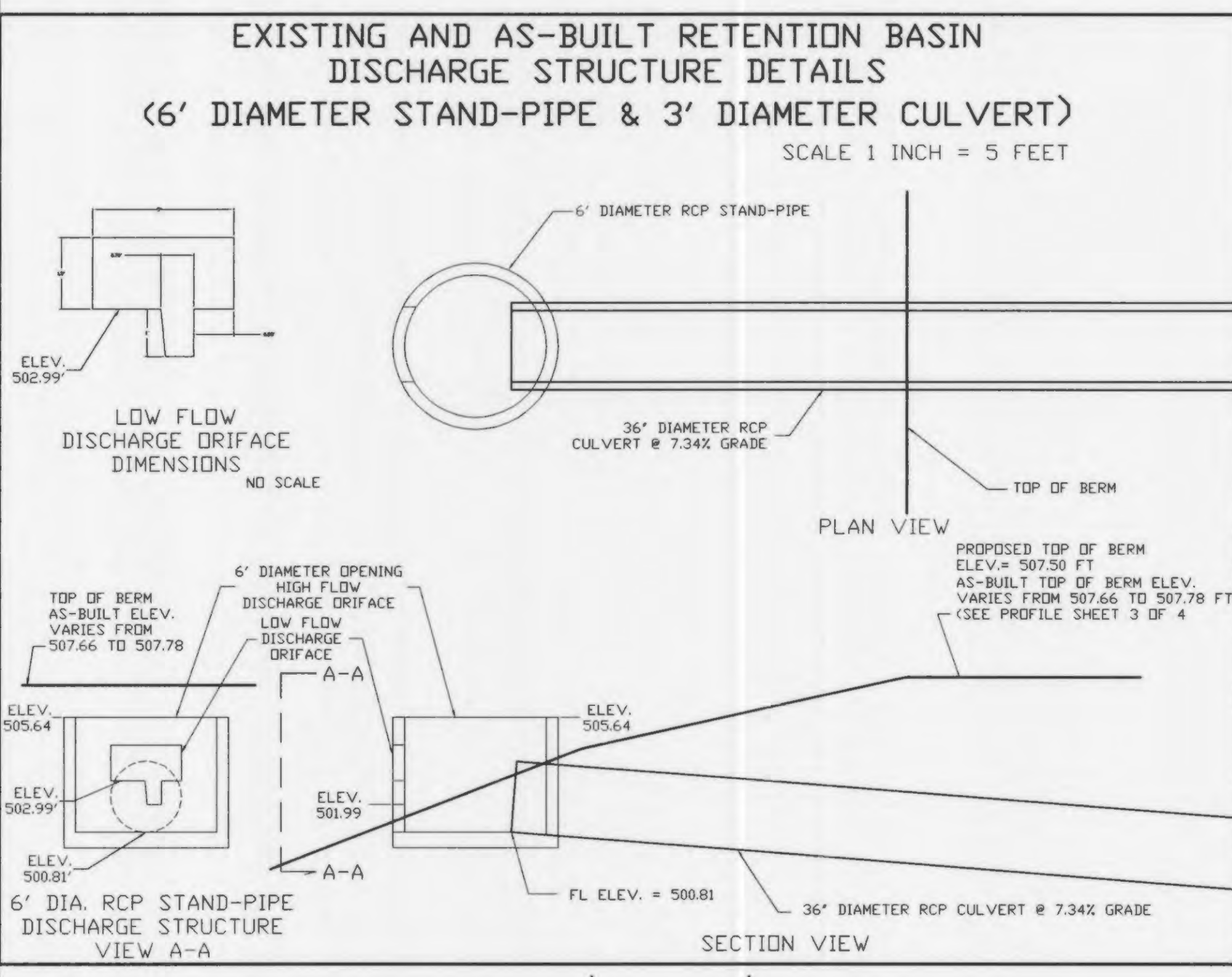

- SWPPP NOTES:**
- UNDERGROUND UTILITIES SHOWN HEREON HAVE BEEN PLOTTED FROM AVAILABLE INFORMATION AND DO NOT NECESSARILY REFLECT THE ACTUAL EXISTENCE, NONEXISTENCE, SIZE, TYPE, OR LOCATION OF THESE OR OTHER UTILITIES. THE LOCATION OF ANY EXISTING UNDERGROUND UTILITIES SHOWN HEREON SHALL BE CONSIDERED APPROXIMATE ONLY. THE VERIFICATION OF THE LOCATION OF ALL UNDERGROUND UTILITIES, EITHER SHOWN OR NOT SHOWN ON THESE PLANS, SHALL BE THE RESPONSIBILITY OF THE CONTRACTOR AND SHALL BE LOCATED PRIOR TO ANY GRADING OR CONSTRUCTION OF IMPROVEMENTS. THESE PROVISIONS SHALL IN NO WAY ABSOLVE ANY PARTY FROM COMPLYING WITH THE UNDERGROUND FACILITY SAFETY AND DAMAGE PREVENTION ACT, CHAPTER 319 RSMO.
 - ANY PERMITS, LICENSES, EASEMENTS, OR APPROVALS REQUIRED TO WORK ON PUBLIC OR PRIVATE PROPERTIES OR ROADWAYS ARE THE RESPONSIBILITY OF THE CONTRACTOR.
 - EXISTING ROADWAYS SHALL BE KEPT CLEAN OF MUD AND DEBRIS AT ALL TIMES.
 - ALL EXCAVATED MATERIAL TO BE STOCKPILED IN A MANNER THAT WILL NOT IMPEDE DISCHARGE OF SURFACE WATER OR CAUSE SEDIMENT RUNOFF FROM SITE.
 - NEWLY FINISHED SURFACES TO BE PROTECTED FROM ANY ACTION OF THE ELEMENTS, OR ANY SETTLEMENT OR EROSION THAT MAY OCCUR.
 - GRADING CONTRACTOR SHALL INSTALL SILTATION CONTROL PRIOR TO STARTING THE GRADING. SILTATION CONTROL DEVICES TO BE IN PLACE DURING ALL OPERATIONS TO CONTROL EROSION. ALL GRADED AREAS SHALL BE PROTECTED FROM EROSION BY EROSION CONTROL DEVICES AND/OR SEEDING AND MULCHING. ADDITIONAL SILTATION AND EROSION CONTROL DEVICES MAY BE REQUIRED AS DIRECTED BY THE CITY OF FALLON.
 - DURING CONSTRUCTION, IF A DISTURBED AREA IS TO BE LEFT IDLE FOR MORE THAN 21 DAYS, TEMPORARY EROSION CONTROL PRACTICES SHALL BE INITIATED BY THE 14TH DAY. TEMPORARY EROSION CONTROL MEASURES INCLUDE TEMPORARY SEEDING, MULCHING, GEOTEXTILES, ETC.
 - ALL DISTURBED AREAS OF THE SITE TO BE PREPARED, LIMED, FERTILIZED AND SEEDED SURFACES TO BE FREE OF LARGE CLODS AND STONES AND FIRST SMOOTHED BY DISKING AND DRAGGING TO FORM A GOOD SEEDBED. SEEDED SHALL THEN BE FIRMED BY ROLLING OR CULPACKING.
 - TEMPORARY SEEDING: TEMPORARY SEEDING SHALL CONSIST OF FAST GROWING ANNUAL VEGETATION TO PROVIDE EROSION CONTROL FOR UP TO 6 MONTHS.
 - PERMANENT SEEDING SHALL BE PERFORMED WITHIN 30 DAYS OF FINISH GRADING.
 - SEEDS TO BE SOWN BY A METHOD THAT WILL INSURE UNIFORM DISTRIBUTION OVER ENTIRE AREA.
 - STARTER LIME AND FERTILIZER TO BE UNIFORMLY APPLIED OVER THE PREPARED SURFACE AT THE FOLLOWING RATES:
 - LIME: 75 LB. PER 1,000 SQ. FT. (LIME SHALL ONLY BE ADDED WITH A SOIL pH OF 6.0 AND BELOW, DO NOT ADD LIME TO SOILS WITH A pH HIGHER THAN 7.0.)
 - FERTILIZER: 5-10-5 FERTILIZER AT 25 LB. PER 1,000 SQ. FT.
 - SEEDBEDS TO BE SEEDED AT THE FOLLOWING RATES AND WITH THE FOLLOWING MIXTURE:

SEEDING TYPE	RATE
TEMPORARY SEEDING	2 LB. PER 1,000 SQ. FT. OF ANNUAL RYE
PERMANENT SEEDING	3.5 LB. PER 1,000 SQ. FT. OF:
	A.) PERENNIAL REGRESS 25%
	B.) KENTUCKY BLUEGRASS 60%
	C.) WHITE DUTCH CLOVER 15%
 - IF CUT AND FILL OPERATIONS OCCUR DURING A SEASON NOT FAVORABLE FOR IMMEDIATE ESTABLISHMENT OF GROUND COVER, A FAST GERMINATING ANNUAL SEED SUCH AS RYE GRASS (COOL WEATHER) OR SUDAN GRASS (HOT WEATHER) SHALL BE UTILIZED TO RETARD EROSION.
 - ALL LEGUME SEEDS TO BE INOCULATED AT SEEDING TIME. SOW AS SOON AS POSSIBLE AFTER INOCULATION. KEEP INOCULATED SEED IN A SHADY PLACE BETWEEN TIME OF INOCULATION AND PLANTING. SEED HELD MORE THAN 24 HOURS SHOULD BE RE-INOCULATED.
 - THE SEEDING AREA TO BE ROLLED OR CULPACKED AFTER SEEDING AND MULCHED WITH STRAW OR BURLAP. RATE OF APPLICATION OF STRAW TO BE APPROXIMATELY 1 BALE PER 1,000 SQ. FT. AREA TO BE KEPT CONTINUALLY DAMP UNTIL SEEDLINGS ARE WELL ESTABLISHED.
 - THE VEGETATIVE GROWTH ESTABLISHED SHALL BE SUFFICIENT TO PREVENT EROSION. THE MINIMUM STANDARD COVERAGE SHALL BE AS REQUIRED BY THE EPA AND MISSOURI DNR (70% PER SQ. FT. MINIMUM)
 - THE CONTRACTOR SHALL PROTECT AND AVOID DAMAGE TO ALL PUBLIC AND PRIVATE PROPERTY ALONG THE LINE OF WORK. ANY DAMAGE DONE TO BE REPAIRED OR RESTORED AT HIS EXPENSE. PARTICULAR ATTENTION SHALL BE PAID TO AVOID DAMAGE TO TREES, SHRUBS, BUSHES, AND PRIVATE PROPERTY LOCATED IN AND ADJACENT TO EASEMENTS OR PRIVATE PROPERTY.
 - NO TREES MAY BE REMOVED OUTSIDE CONSTRUCTION LIMITS WITHOUT THE PERMISSION OF THE PROPERTY OWNER.
 - ALL EROSION CONTROL SYSTEMS SHALL BE INSPECTED AND NECESSARY CORRECTIONS MADE WITHIN 24 HOURS OF ANY RAINSTORM RESULTING IN ONE-HALF INCH OF RAIN OR MORE.



Missouri One Call System, Inc.
 Call Before You Dig!
 1-800-DIG-RITE
 (1-800-344-7483)

NO.	DATE	REVISION DESCRIPTION
1	8/20/2013	REVISED PER CITY OF FALLON COMMENTS
2	5/15/2014	ADDED AS-BUILT TITLE, NOTES, CERTIFICATION, AND AS-BUILT DISCHARGE STRUCTURE DETAIL

BUESCHER DITCH & ASSOCIATES, INC.
 2 East Fifth Street, P.O. Box 621, Washington, Missouri 63090
 P: 636-239-7681 F: 636-239-7681
 E-mail: www.buescherditch.com
 P.E. Corporation No. 2001010603
 P.L.S. Corporation No. 2001010600

AS-BUILT PLANS SWPPP DETAILS
RETENTION POND IMPROVEMENTS
FIELDSTONE FARMS SUBDIVISION
O'FALLON, MISSOURI 63368

STATE OF MISSOURI REGISTERED PROFESSIONAL ENGINEER
 MARK ALAN FELDMANN
 LICENSE NUMBER E-19097
 DATE 5-15-2014
 PROJECT NUMBER 13002
 FILE NAME SIP RETENTION POND.dwg
 SHEET OF 4
 DRAWN CHECKED

SWPPP BMP DETAILS

This document shall remain the property of Buescher Ditch and Associates, Inc. (BDA) and may not be used by any other party without the written consent of said BDA.