

PROPERTY N/F  
 BENNETT LAND HOLDINGS LP  
 BK. 3298 PG. 347  
 1700 W TERRA LANE  
 4-0053-1780-00-10.1

PROPERTY N/F  
 FRED WEBER, INC.  
 BK. 1011 PG. 356

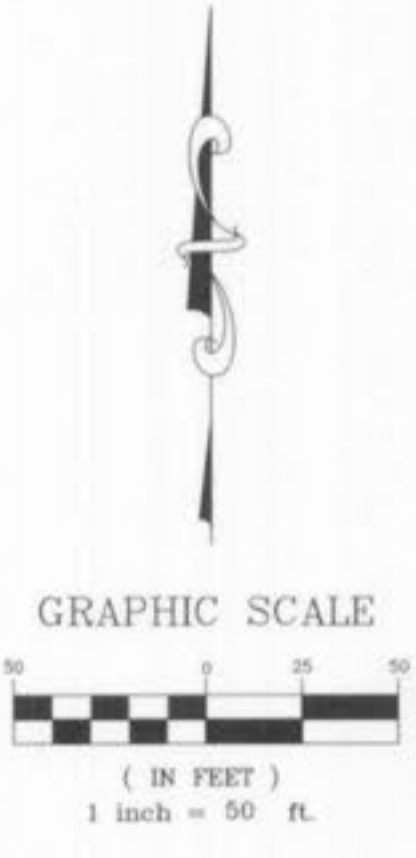

CONSTRUCTION OF RETAINING WALLS WILL BE UNDER SEPARATE PERMIT.



UNDERGROUND UTILITIES HAVE BEEN PLOTTED FROM AVAILABLE INFORMATION AND THEREFORE THEIR LOCATIONS SHALL BE CONSIDERED APPROXIMATE ONLY. THE VERIFICATION OF THE LOCATION OF ALL UNDERGROUND UTILITIES, EITHER SHOWN OR NOT SHOWN ON THESE PLANS SHALL BE THE RESPONSIBILITY OF THE CONTRACTOR, AND SHALL BE LOCATED PRIOR TO ANY GRADING OR CONSTRUCTION OF THE IMPROVEMENTS.

W.B. HIGHWAY 70  
 E.B. HIGHWAY 70

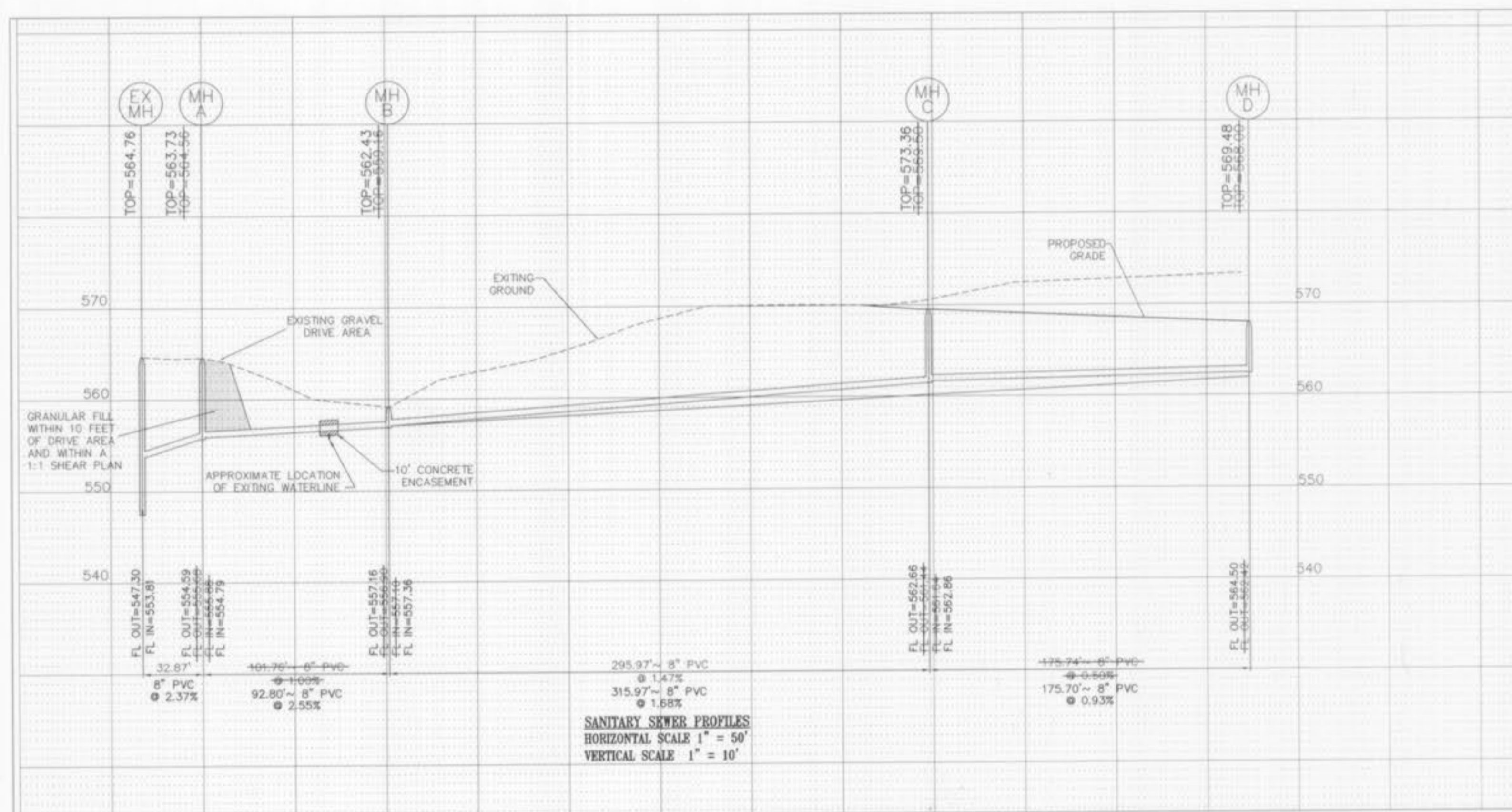
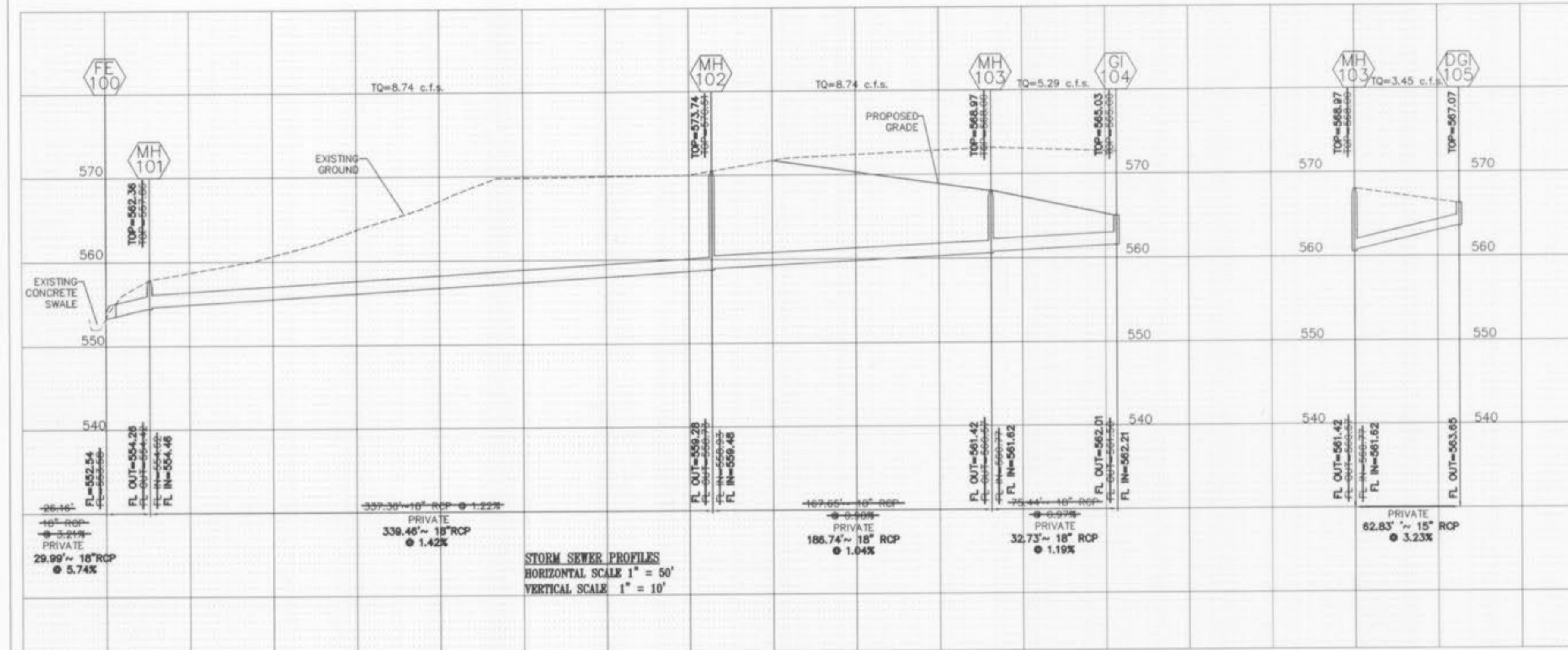

RAX PROJECT NAME : FRED WEBER ASPHALT PLANT  
 RAX PROJECT NO. : 84-16280  
 DESIGN DATE : 10-14-08  
 DESIGNED BY : SWR

SUBMITTED: 10-15-08 FILENAME: 16280

15 YEAR HYDRAULICS

UPP STR	LOW STR	L DIA	UPPER FL LN	LOWER FL LN	PS	UPPER ST EL	DEPTH HY GR	UPPER HY EL	LOWER HY EL	HYDR GRADE	FR HEAD	VEL	VEL HEAD	JUNC LOSS	TURN LOSS	CURVE LOSS	STR GRADE	INL CAP	DR AREA	PI	Q	TO	PIPE CAP	LINE NUMBER	REMARKS
DG1105	MH103	63	15	563.65	561.62	3.23	567.07	2.95	564.12*	562.87	.00290	0.18	2.81	0.12	0.12	0.00	0.00	0.00	0.00	0.00	0.00	3.45	11.61	1	
GI104	MH103	33	18	562.01	561.62	1.18	565.03	1.69	563.34	563.12	.00250	0.08	2.99	0.14	0.14	0.00	0.00	0.00	0.00	0.00	0.00	5.29	11.42	2	
MH103	MH102	187	18	561.42	559.48	1.04	568.97	6.40	562.57	560.98	.00690	1.29	4.95	0.38	0.30	0.08	0.00	0.00	0.00	0.00	0.00	8.74	10.70	3	
MH102	MH101	339	18	559.28	554.46	1.42	573.74	13.54	560.20*	555.96	.00690	2.35	4.95	0.38	0.23	0.23	0.00	0.00	0.00	0.00	0.00	8.74	12.53	4	
MH101	FE100	30	18	554.26	552.54	5.73	562.36	6.95	555.41	555.08	.00690	0.21	4.95	0.38	0.12	0.12	0.00	0.00	0.00	0.00	0.00	8.74	29.15	5	HW=555.08

\* INDICATES CRITICAL DEPTH

