

# GOLDEN CORRAL

LOT D OF BRAMBLETT CROSSING AS RECORDED IN P.B. 46 PG. 112-114  
U.S. SURVEY 1766, TOWNSHIP 47 NORTH, RANGE 3 EAST.  
CITY OF O'FALLON ST. CHARLES COUNTY, MISSOURI

## (CONSTRUCTION PLANS) AS-BUILT DRAWING

### SHEET INDEX

C1	COVER SHEET
C1A	NOTES
C2	EX. CONDITIONS PLAN
C3	DEMO PLAN
C4	GRADING PLAN
C5	SITE PLAN
C6	SWPPP PLAN
C7	SWPPP DETAILS
C8-C8A	SEWER PROFILES
C9	EXISTING DAM
C10	PROPOSED DAM
C11	BMP DAM
C12-C12G	DETAILS
C13	WAPPING

#### LEGAL DESCRIPTION:

OVERALL TRACT  
LOT D OF BRAMBLETT CROSSING, AS PER PLAT RECORDED IN PLAT BOOK 46 PAGES 112 THRU 115 OF THE ST. CHARLES COUNTY RECORDERS OFFICE, BEING PART OF U.S. SURVEY 1766, TOWNSHIP 47 NORTH, RANGE 3 EAST, ST. CHARLES COUNTY MISSOURI, SAID TRACT BEING MORE PARTICULARLY DESCRIBED AS FOLLOWS:

LOT D-1  
A TRACT OF LAND BEING PART OF LOT D OF BRAMBLETT CROSSING, AS PER PLAT RECORDED IN PLAT BOOK 46 PAGES 112 THRU 115 OF THE ST. CHARLES COUNTY RECORDERS OFFICE, BEING PART OF U.S. SURVEY 1766, TOWNSHIP 47 NORTH, RANGE 3 EAST, ST. CHARLES COUNTY MISSOURI, SAID TRACT BEING MORE PARTICULARLY DESCRIBED AS FOLLOWS:  
BEGINNING AT THE SOUTHWEST CORNER OF SAID LOT D, THENCE ALONG THE WESTERN LINE OF SAID LOT, NORTH 00 DEGREES 28 MINUTES 42 SECONDS EAST 125.64 FEET, TO A POINT OF CURVE TO THE RIGHT, WHOSE RADIUS POINT BEARS SOUTH 89 DEGREES 31 MINUTES 18 SECONDS EAST 130.00 FEET FROM THE LAST DESCRIBED POINT, THENCE ALONG THE ARC OF SAID CURVE 58.11 FEET TO THE POINT OF TANGENT, THENCE NORTH 28 DEGREES 05 MINUTES 28 SECONDS EAST 272.33 FEET, THENCE NORTH 22 DEGREES 02 MINUTES 15 SECONDS EAST 10.59 FEET, THENCE LEAVING SAID WESTERN LOT LINE, SOUTH 89 DEGREES 31 MINUTES 18 SECONDS EAST 151.13 FEET TO A POINT ON A CURVE ON THE WESTERN LINE OF BRAMBLETT ROAD 60 FEET WIDE, SAID LINE BEING THE EASTERN LINE OF AFORESAID LOT D, THENCE ALONG EASTERN LINE OF SAID LOT D, ALONG THE ARC OF SAID CURVE, WHOSE RADIUS POINT BEARS SOUTH 52 DEGREES 08 MINUTES 11 SECONDS WEST 345.00 FEET FROM THE LAST DESCRIBED POINT, WITH AN ARC DISTANCE OF 231.23 FEET TO THE POINT OF TANGENT, THENCE SOUTH 00 DEGREES 32 MINUTES 15 SECONDS WEST 248.80 FEET TO THE SOUTHEAST CORNER OF SAID LOT D, THENCE LEAVING SAID RIGHT OF WAY LINE IN A WESTERLY DIRECTION ALONG THE SOUTHERN LINE OF SAID LOT D, SOUTH 89 DEGREES 31 MINUTES 18 SECONDS WEST 26.89 FEET TO A POINT OF CURVE TO THE RIGHT, WHOSE RADIUS POINT BEARS NORTH 00 DEGREES 32 MINUTES 15 SECONDS WEST 167.50 FEET, FROM THE LAST DESCRIBED POINT, THENCE ALONG THE ARC OF SAID CURVE 50.14 FEET TO THE POINT OF TANGENT, THENCE NORTH 72 DEGREES 04 MINUTES 14 SECONDS WEST 40.30 FEET TO THE POINT OF CURVE TO THE LEFT, WHOSE RADIUS POINT BEARS SOUTH 17 DEGREES 55 MINUTES 46 SECONDS WEST 132.50 FEET FROM THE LAST DESCRIBED POINT, THENCE ALONG THE ARC OF SAID CURVE 40.36 FEET TO THE POINT OF TANGENT, THENCE NORTH 89 DEGREES 31 MINUTES 18 SECONDS WEST 204.54 FEET TO THE POINT OF BEGINNING AND CONTAINING 3.11 ACRES.

LOT D-2  
A TRACT OF LAND BEING PART OF LOT D OF BRAMBLETT CROSSING, AS PER PLAT RECORDED IN PLAT BOOK 46 PAGES 112 THRU 115 OF THE ST. CHARLES COUNTY RECORDERS OFFICE, BEING PART OF U.S. SURVEY 1766, TOWNSHIP 47 NORTH, RANGE 3 EAST, ST. CHARLES COUNTY MISSOURI, SAID TRACT BEING MORE PARTICULARLY DESCRIBED AS FOLLOWS:  
BEGINNING AT THE SOUTHWEST CORNER OF SAID LOT D, THENCE ALONG THE WESTERN LINE OF SAID LOT, NORTH 00 DEGREES 28 MINUTES 42 SECONDS EAST 125.64 FEET, TO A POINT OF CURVE TO THE RIGHT, WHOSE RADIUS POINT BEARS SOUTH 89 DEGREES 31 MINUTES 18 SECONDS EAST 130.00 FEET FROM THE LAST DESCRIBED POINT, THENCE ALONG THE ARC OF SAID CURVE 58.11 FEET TO THE POINT OF TANGENT, THENCE NORTH 28 DEGREES 05 MINUTES 28 SECONDS EAST 272.33 FEET, THENCE NORTH 22 DEGREES 02 MINUTES 15 SECONDS EAST 10.59 FEET TO THE ACTUAL POINT OF BEGINNING OF THE DESCRIPTION HEREIN, THENCE CONTINUING ALONG THE LAST DESCRIBED LINE NORTH 22 DEGREES 02 MINUTES 15 SECONDS EAST 94.38 FEET, THENCE NORTH 07 DEGREES 30 MINUTES 58 SECONDS EAST 68.19 FEET TO A POINT BEING THE NORTHERMOST POINT OF SAID LOT D, SAID POINT BEING ON THE WESTERN LINE OF BRAMBLETT ROAD 60' WIDE, THENCE ALONG SAID RIGHT OF WAY LINE, BEING THE EASTERN LINE OF SAID LOT D, ALONG A CURVE TO THE LEFT, WHOSE RADIUS POINT BEARS NORTH 68 DEGREES 07 MINUTES 28 SECONDS EAST 405.00 FEET FROM THE LAST DESCRIBED POINT, WITH AN ARC DISTANCE OF 154.20 FEET TO A POINT OF REVERSE CURVE, WHOSE RADIUS POINT BEARS SOUTH 46 DEGREES 12 MINUTES 39 SECONDS WEST 345.00 FEET FROM THE LAST DESCRIBED POINT, THENCE ALONG THE ARC OF SAID CURVE 95.88 FEET, THENCE LEAVING SAID RIGHT OF WAY LINE NORTH 89 DEGREES 31 MINUTES 18 SECONDS WEST 151.13 FEET TO THE ACTUAL POINT OF BEGINNING AND CONTAINING 0.23 ACRES.

City approval of any construction site plans does not mean that any building can be constructed on the lots without meeting the building setbacks as required by the zoning codes.

All installations and construction shall conform to the approved engineering drawings. However, if the developer chooses to make minor modifications in design and/or specifications during construction, they shall make such changes at their own risk, without any assurance that the City Engineer will approve the completed installation or construction. It shall be the responsibility of the developer to notify the City Engineer of any changes from the approved drawings. The developer may be required to correct the installed improvement so as to conform to the approved engineering drawings. The developer may request a letter from the Construction Inspection Division regarding any field changes approved by the City Inspector.

Lighting values will be reviewed on site prior to the final occupancy inspection.

City of O'Fallon Construction work hours per City Ordinance 3429 as shown in section 500.420 of the Municipal Code of the City of O'Fallon are as follows:

October 1 through May 31  
7:00 A.M. To 7:00 P.M. Monday Through Sunday  
June 1 Through September 30  
6:00 A.M. To 8:00 P.M. Monday Through Friday  
7:00 A.M. To 8:00 P.M. Saturday and Sunday

#### Conditions of Approval From Planning and Zoning

#### CONDITIONAL APPROVAL (STAFF)

- THE ITEMS LISTED UNDER "MUNICIPAL CODE REQUIREMENTS" SHALL BE ADDRESSED ON THE CONSTRUCTION PLANS.
- A PEDESTRIAN CONNECTION BETWEEN THE EXISTING SIDEWALK AND BUILDING ENTRANCE SHALL BE PROVIDED.
- ALL ROOFTOP EQUIPMENT SHALL BE COMPLETELY SCREENED IN ACCORDANCE TO SECTION 400.278. COMPLIANCE WITH THIS REQUIREMENT SHALL BE SHOWN ON THE BUILDING PERMIT PLANS.
- THE PETITIONER SHALL WORK WITH CITY STAFF TO DETERMINE THE LIMITS NECESSARY FOR A GUARD RAIL ALONG THE SOUTH SIDE OF THE PRIVATE ROAD WHERE STEEP GRADES MAY BE HAZARDOUS FOR VEHICULAR TRAFFIC.
- WHEN THE RECORD PLAT FOR THE LOTS IN QUESTION IS SUBMITTED FOR APPROVAL BY THE CITY COUNCIL THE SCRIPT FOR THE UTILITY EASEMENTS SHALL GIVE PRIMARY RIGHTS TO THE CITY OF O'FALLON. FINAL WORDING TO BE DETERMINED BY AND APPROVED BY THE CITY ATTORNEY.
- THE PETITIONER INDICATED THAT THE PROPOSED BUILDING ELEVATIONS HAVE NOT BEEN FINALIZED, ONCE THE ELEVATIONS ARE DECIDED UPON THE COMMISSION SHALL BE INFORMED OF THE PROPOSED BUILDING ELEVATIONS.

#### CONDITIONAL APPROVAL (MUNICIPAL CODE)

- DETAILS OF THE BICYCLE RACK SHALL BE SHOWN ON THE CONSTRUCTION SITE PLANS.
- THE MINOR ARTERIAL WITH PARKWAY OPTIONS DETAILS SHALL NOT BE INCLUDED ON THE CONSTRUCTION PLANS.
- PROVIDE DETAILS ON THE ROLLED CURB AND GUTTER.

### PARKING CALCS:

#### REQUIRED PARKING:

11,648 S.F. x 1 SPACE/100 S.F. = 117 SPACES  
ADDITIONAL REQUIRED SPACES = 20 SPACES  
TOTAL REQUIRED SPACES = 137 SPACES  
INCLUDING 6 ACCESSIBLE SPACES AND 1 LOADING SPACE REQUIRED

PROPOSED PARKING  
178 SPACES INCLUDING 6 ACCESSIBLE SPACES  
AND 1 LOADING SPACE

### BICYCLE PARKING:

#### REQUIRED PARKING:

1 RACK SPACE PER 15 AUTOMOBILE SPACES REQUIRED

PROPOSED PARKING  
137 PARKING SPACES REQUIRED / 15 =  
10 BICYCLE RACK SPACES

10 BICYCLE RACK SPACES PROVIDED

### STORM AND SANITARY SEWER MEASUREMENTS

THE EXISTING SEWER LENGTH, SIZES, FLOWLINES, DEPTHS OF STRUCTURES AND SEWERS, AND LOCATIONS WITH RESPECT TO EXISTING OR PROPOSED EASEMENTS HAVE BEEN MEASURED. THE RESULTS OF THOSE MEASUREMENTS ARE SHOWN ON THIS SET OF FINAL MEASUREMENT PLANS. SINCE THE WYE LOCATIONS HAVE BEEN PLOTTED FROM INFORMATION PROVIDED BY THE SEWER CONTRACTOR OR OTHER SOURCES, I DISCLAIM ANY RESPONSIBILITY FOR THAT SPECIFIC INFORMATION.

ALL PUBLIC SEWERS ARE LOCATED WITHIN DESIGNATED EXISTING OR PROPOSED EASEMENTS EXCEPT AS FOLLOWS:

NO EXCEPTIONS

MARK A. DOERING, P.E. E-23059

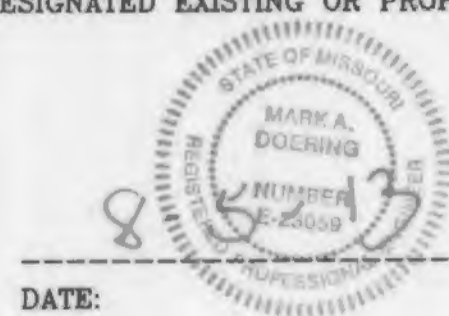

DATE:



### LOCATION MAP

(NOT TO SCALE)

WUNNENBURG'S: 0018 - 38  
PARCEL NO.: 2-0119-A685-00-D

ADDRESS: BRAMBLETT ROAD  
O'FALLON, MO 63366

TOTAL AREA OF TRACT: 3.34 ACRES  
PRESENT ZONING: C-2

### WATER QUALITY DATA

SITE LOCATION:	CITY OF O'FALLON	
SITE AREA	145,390.92 S.F.	3.34 ACRES
DRAINAGE AREA	118,539.19 S.F.	2.72 ACRES
DISTURBED AREA	108,425.34 S.F.	2.49 ACRES
SOIL TYPE	62.50% "B" 37.50% "C"	

### BENCHMARK

BENCHMARK  
BENCH MARK: F-149 ELEVATION 542.80 RM  
DESCRIBED BY NATIONAL GEODETTIC SURVEY 1949  
AT O'FALLON, ST. CHARLES COUNTY, ON THE WABASH RAILROAD, ONE BLOCK EAST OF THE STATION, IN THE SOUTHEAST CORNER OF THE ST. MARY INSTITUTE YARD, 40 FEET EAST OF THE CENTER OF A STREET CROSSING, AND 45 FEET NORTH OF THE CENTERLINE OF THE MAIN TRACK. A STANDARD DISK, STAMPED F 149 1935 AND SET IN THE TOP OF A CONCRETE POST PROJECTING 6 INCHES ABOVE THE GROUND.

### FLOOD MAP

FEMA MAP # 29183C0237E H, EFFECTIVE DATE AUGUST 2, 1996  
SUBJECT PROPERTY WITHIN FLOOD ZONES

### LEGEND

#### NEW IMPROVEMENTS

CONTOUR	— ELEV —
SPOT ELEVATION	• ELEV
CURB INLET	■
CLEANOUT / SAMPLE TEE	• CO/ST
DOWNSPOUT	○ DS
SIGN	—
HANDICAPPED SYMBOL	♿
WATER LINE	— W —
GAS SERVICE	— G —
ELECTRIC SERVICE	— E —
TELEPHONE SERVICE	— T —
CONCRETE PAVEMENT	▨
ASPHALT PAVEMENT	▩
USE IN PLACE	U.I.P.
ADJUST TO GRADE	A.T.G.

### LEGEND

#### EXISTING TOPOGRAPHIC

Sidewalk	—
Building Foundation	—
Fence	—
Wall	—
Tree Line	—
Stream	—
Brush/Shrub Line	—
Index Contour	—
Intermediate Contour	—
Depression Contour	—
Guard Rail	—
Swamp Symbol	—
Control Point	—
Spot Elevation	× 325.6
Single Tree	—
Located Object	—
Catch Basin	—
Manhole	—
Pole	—
Sign	—
Fire Hydrant	—
Light Pole	—
Inlet Symbol	—
Railroad	—
Paved Road	—
Unpaved Road	—
Trail	—
Pipe line	—
Driveway	—
Traffic Light	—
Electric Box	—
Water Valve	—
Water Meter	—
Gas Meter	—

### PERTINENT INFORMATION:

- SEWER DISTRICT: CITY OF O'FALLON
- ELECTRIC: AMERENUE
- GAS: LACLEDE GAS
- PHONE: CENTURY TEL
- WATER: CITY OF O'FALLON
- SCHOOL DISTRICT: FORT ZUMWALT
- FIRE DISTRICT: O'FALLON FIRE PROTECTION DISTRICT
- TOPO: DOERING-ENGINEERING/AUGUST 2011

### PREPARED FOR:

GOLDEN CORRAL  
RFR PROPERTIES, LLC  
150 WESTMOUNT DRIVE  
FARMINGTON MO. 63640  
573-756-6656

Call Before you DIG  
TOLL FREE  
1-800-344-7483  
MISSOURI ONE-CALL SYSTEM INC.

MoDOT  
MoDOT underground facilities are not on the DIGRITE system. The MoDOT call number is 314-340-4100.

PLANNING AND DEVELOPMENT DIVISION # 3805.07 + 3805.07.01  
APPROVED 11/3/2011

Revised	12/26/12	Rev. per city comments
Comment	8/5/13	Rev. per city comments

Missouri Office  
5000 Griffin Rd.  
St. Louis, MO 63114  
Phone: (314) 645-1783  
Fax: (314) 645-1778

Engineered By:  
**DOERING**  
ENGINEERING INC.  
CIVIL ENGINEERING • PLANNING • SURVEYING

Seal

MARK DOERING  
CIVIL ENGINEER E-23059  
8/5/13  
MO. CORPORATE  
LICENSE NO. 001347  
IL. CORPORATE  
LICENSE NO. 184.003035

GOLDEN CORRAL  
BRAMBLETT ROAD  
O'FALLON, MO 63366  
COVER SHEET  
AS-BUILT DRAWING

Date: 12/15/11  
Project Number: 11063  
File Name: 11063 CD  
Drawn By: JAB Sheet  
Check By: MAD  
**C1**



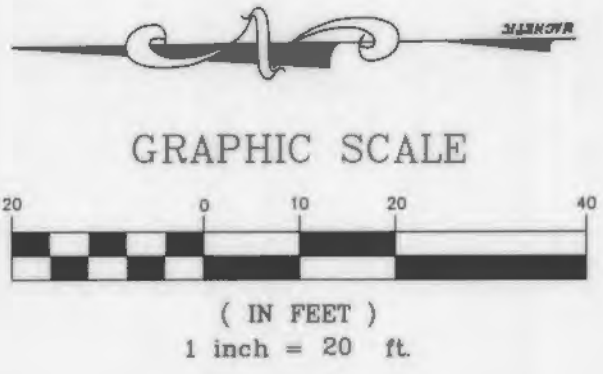

ZONE:  
R4

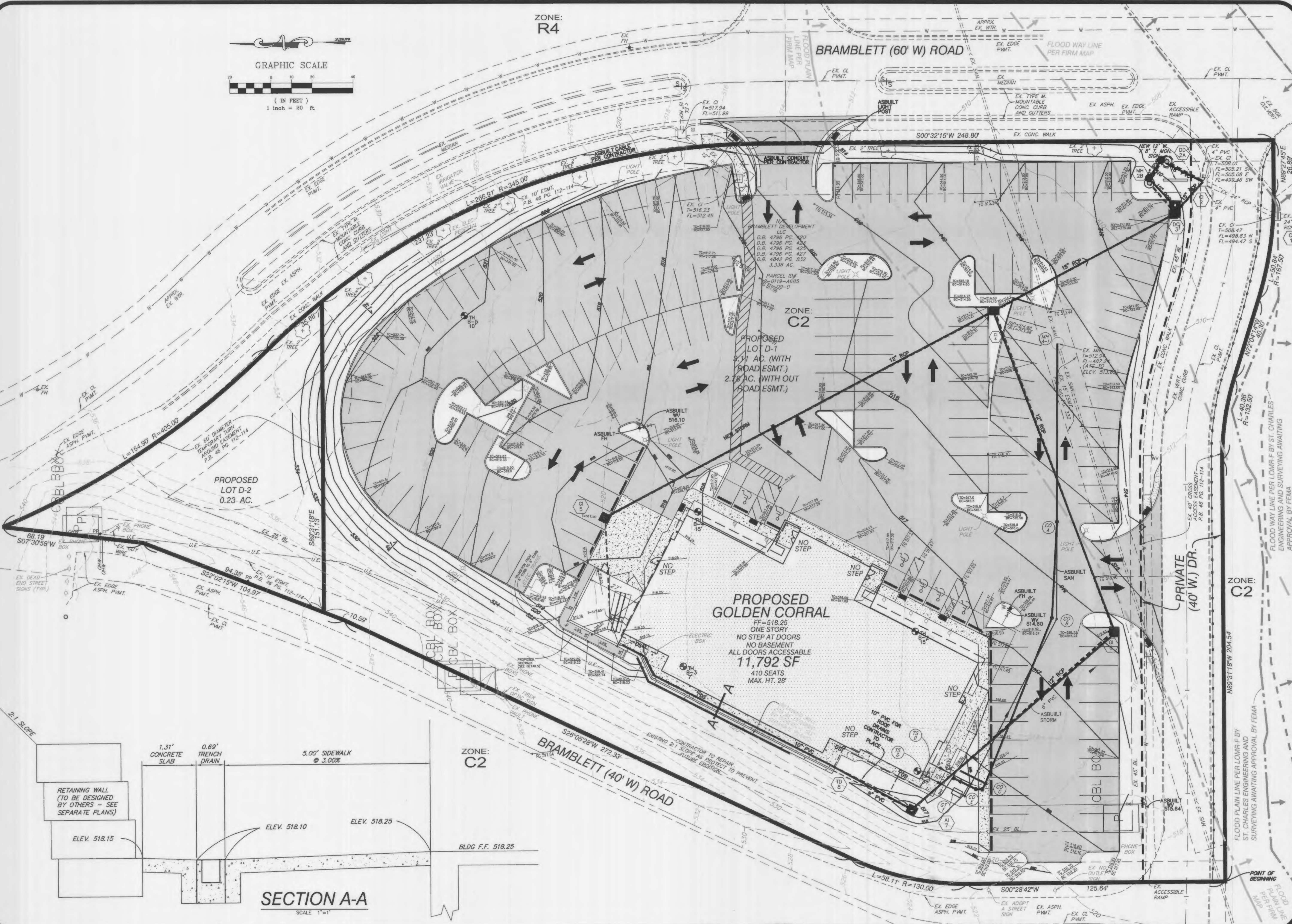

**PROPOSED GOLDEN CORRAL**  
 FF=518.25  
 ONE STORY  
 NO STEP AT DOORS  
 NO BASEMENT  
 ALL DOORS ACCESSIBLE  
**11,792 SF**  
 410 SEATS  
 MAX. HT. 28'

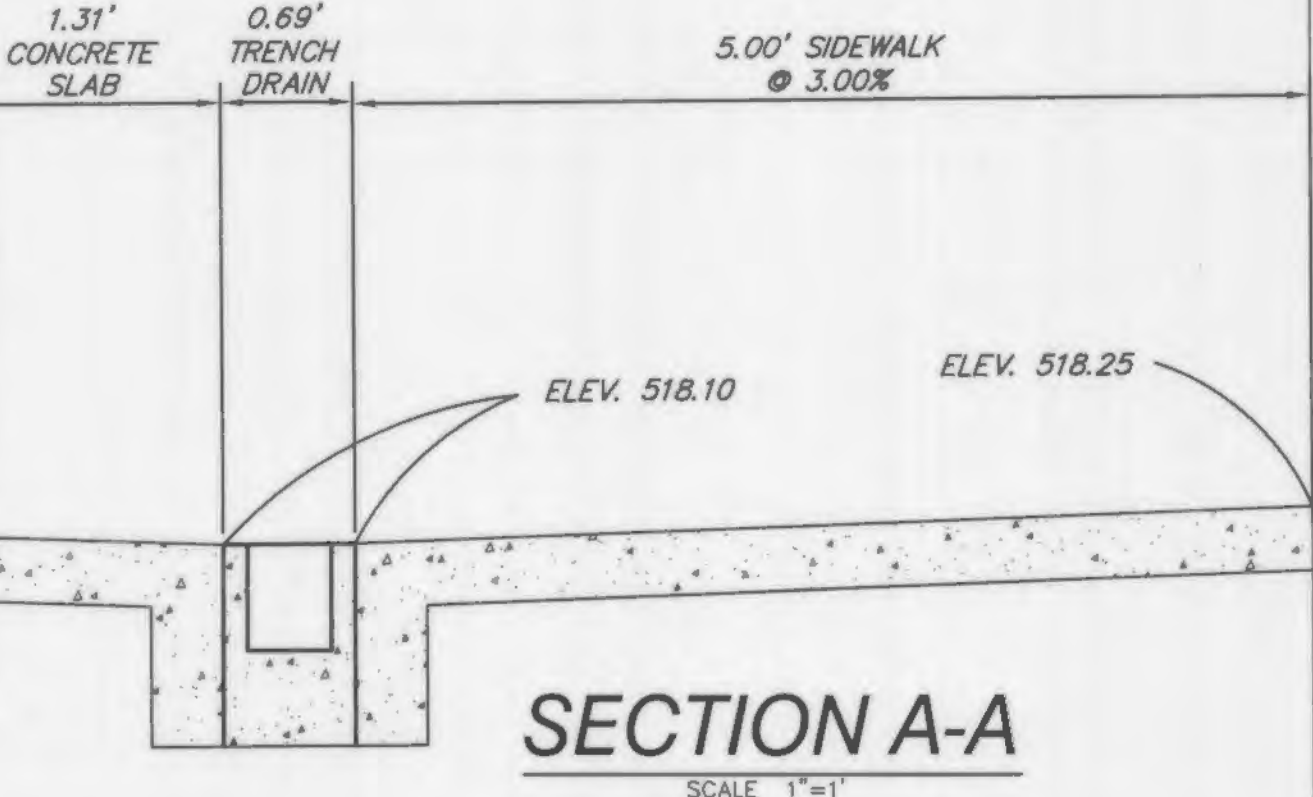

Comment	Revised	By	Date
Rev. per city comments	12/26/12	JAB	8/5/13
Rev. per city comments	8/5/13	JAB	

Engineered By:  
**DOERING ENGINEERING, Inc.**  
 CIVIL ENGINEERING • PLANNING • SURVEYING

Missouri Office  
 5030 Grinn Rd.  
 St. Louis, Missouri 63128  
 Telephone: (314) 967-8870  
 Fax: (314) 967-1776

Seal  
  
 MARK DOERING  
 CIVIL ENGINEER E-23059  
 8513  
 MO. CORPORATE  
 LICENSE NO. 001347  
 IL CORPORATE  
 LICENSE NO. 184.0003035

**GOLDEN CORRAL**  
 BRAMBLETT ROAD  
 O'FALLON, MO 63366  
**GRADING PLAN**  
 AS-BUILT DRAWING

Date: 12/15/11
Project Number: 11063
File Name: 11063 CD
Drawn By: JAB
Check By: MAD
<b>C4</b>



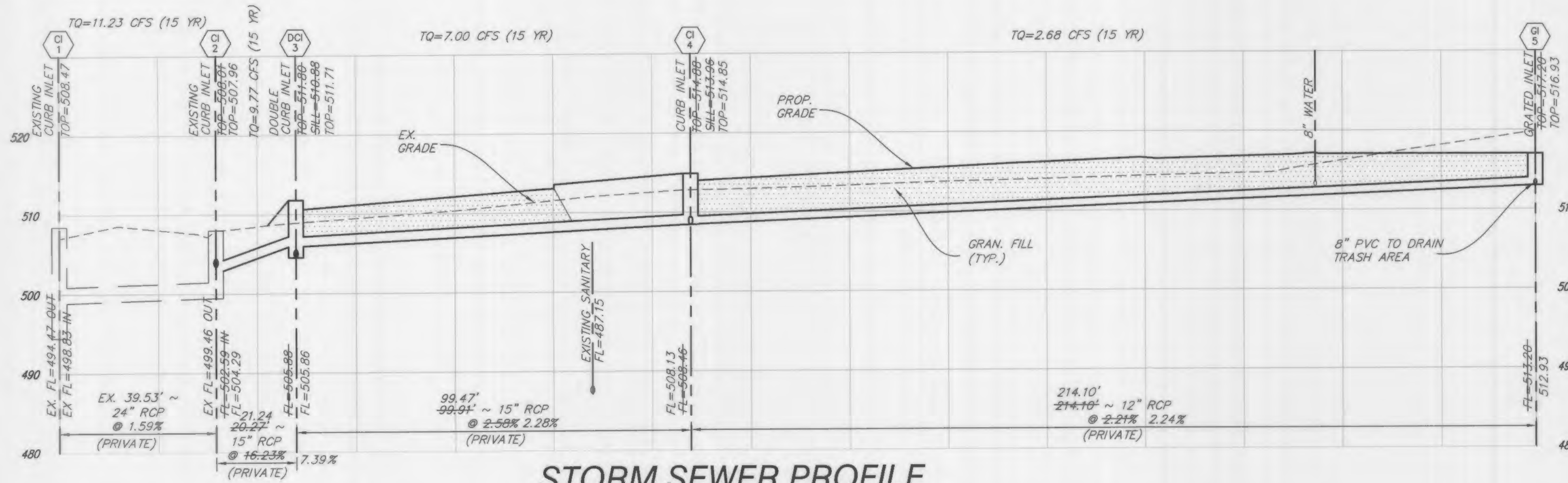

**STORM SEWER PROFILE**

SCALE 1"=20'H  
1"=10'V

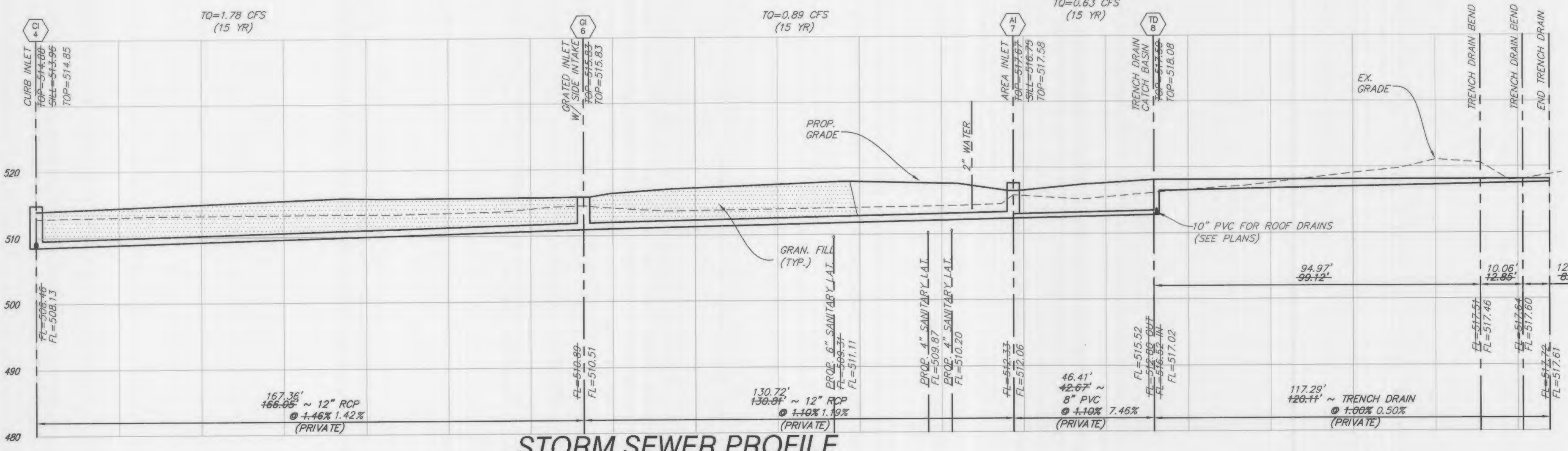

**STORM SEWER PROFILE**

SCALE 1"=20'H  
1"=10'V

**AS-BUILT HYDRAULIC CALCS**

LINE NO.	PIPE	LENGTH	DIAMETER	ROUGHNESS	INLET ELEVATION	OUTLET ELEVATION	HEAD LOSS	LOSS COEFFICIENT	LOSS	INLET FLOW	OUTLET FLOW	LOSS PER FOOT
1	24" RCP	39.53'	24"	0.015	498.47	498.46	0.01	0.00	0.00	11.23	11.23	0.0003
2	15" RCP	21.24'	15"	0.015	504.29	504.29	0.01	0.00	0.00	9.77	9.77	0.0003
3	12" RCP	99.94'	12"	0.015	508.15	508.15	0.01	0.00	0.00	7.00	7.00	0.0003
4	8" PVC	214.10'	8"	0.015	514.85	514.85	0.01	0.00	0.00	2.68	2.68	0.0003

**AS-BUILT HYDRAULIC CALCS**

LINE NO.	PIPE	LENGTH	DIAMETER	ROUGHNESS	INLET ELEVATION	OUTLET ELEVATION	HEAD LOSS	LOSS COEFFICIENT	LOSS	INLET FLOW	OUTLET FLOW	LOSS PER FOOT
1	12" RCP	130.72'	12"	0.015	510.51	510.51	0.01	0.00	0.00	0.89	0.89	0.0003
2	8" PVC	46.41'	8"	0.015	517.00	517.00	0.01	0.00	0.00	0.63	0.63	0.0003
3	10" PVC	117.29'	10"	0.015	517.02	517.02	0.01	0.00	0.00	0.63	0.63	0.0003

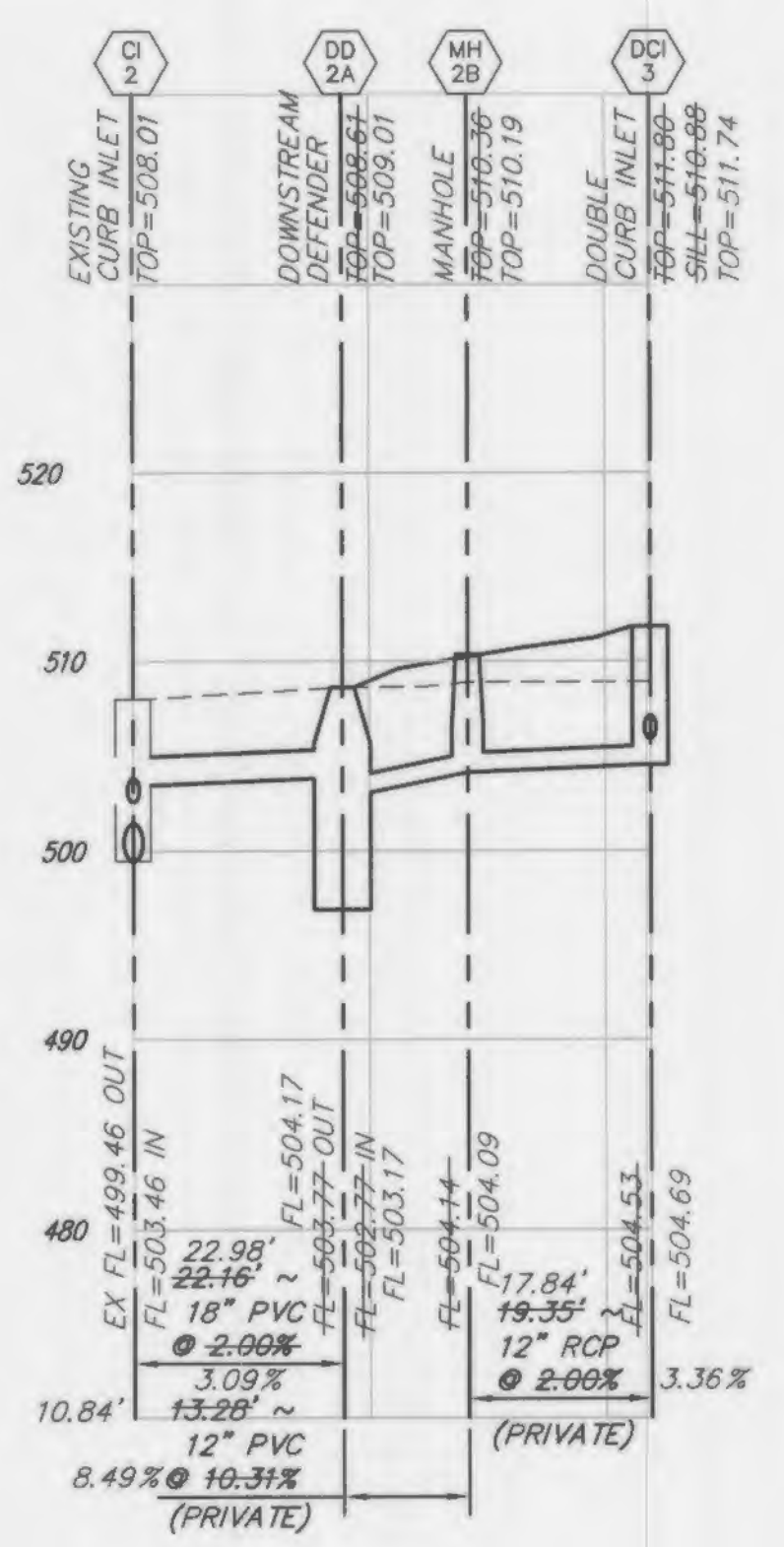

**Sanitary Sewer Notes**

- SAN # 1 All sanitary sewer installation is to be in accordance with M.S.D. 2007 standards and specifications except as modified by the City of O'Fallon.
- SAN # 2 Brick shall not be used in the construction of sanitary sewer structures. Pre cast concrete structures are to be used unless otherwise approved by the City of O'Fallon.
- SAN # 3 Connections at all sanitary structures are to be made with A-lock joint or equal.
- SAN # 4 All sanitary laterals shall be a minimum of 4" residential, 6" commercial diameter pipe.
- SAN # 5 All sanitary mains shall be a minimum of 8" diameter pipe.
- SAN # 6 All sanitary sewer line with a slope greater than 20% will require concrete cradle or concrete collar. Sanitary line with a slope greater than 50% will require a special approved design as shown on detail sheet.
- SAN # 7 All manholes built within the 100 year flood plain must have lock type watertight manhole covers.
- SAN # 8 All sanitary sewer mains must have a minimum of 42" cover.
- SAN # 9 When sanitary mains cross over storm line the sanitary main must be ductile iron pipe for 10 feet on each side of the crossing.
- SAN # 10 Encase with concrete both sanitary and storm sewer at crossing when storm sewer is within 18 inches above sanitary sewer. Add concrete grade to only RCP storm sewer and encase HDPE storm sewer when it is more than 18 inches above sanitary line. Show on profile sheet.
- SAN # 11 The sanitary sewers should run diagonally through the side yards to minimize any additional utility easements required.
- SAN # 12 All sanitary sewer structures shall be waterproofed on the exterior in accordance to Missouri DNR specifications 10CSR-8.120 (7)(E).
- SAN # 13 All sanitary sewer pipe shall be SDR35 or equal.
- SAN # 14 All sanitary sewer manholes and pipes will be tested to the following specifications: ASTM C1244, Standard testing method for Concrete Sewer Manhole by Negative Air Pressure (Vacuum), Latest revision ASTM F1417, Standard testing method for installation Acceptance of Plastic Gravity Sewer Lines Using Low Pressure Air, Latest revision.
- SAN # 15 Add 1" minus rock back fill to all sanitary sewer and all other utilities that lie within the 1:1 shear plane of the road.

**Storm Sewer Notes**

- STM # 1 All Storm Sewer installation is to be in accordance with M.S.D. 2007 standards and specifications except as modified by the City of O'Fallon.
- STM # 2 Brick shall not be used in the construction of storm sewer structures. Pre cast concrete structures are to be used unless otherwise approved by the City of O'Fallon.
- STM # 3 A 5/8" trash bar shall be installed horizontally in the center of the opening(s) in all curb inlets and area inlets.
- STM # 4 HDPE pipe is to be N-12WT or equal and meet ASTM F1417 water tight field test.
- STM # 5 Encase with concrete both sanitary and storm sewer at crossing when storm sewer is within 18 inches above sanitary sewer. Add concrete grade to only RCP storm sewer and encase HDPE storm sewer when it is more than 18 inches above sanitary line. Show on profile sheet.
- STM # 6 The storm sewers should run diagonally through the side yards to minimize any additional utility easements required.
- STM # 7 All concrete pipes will be installed with O-ring rubber type gaskets.
- STM # 8 Connections at all storm structures are to be made with A-lock joint or equal.
- STM # 9 Pre cast concrete inlet covers are not to be used.
- STM # 10 The swale in the detention basins shall have a minimum 1% longitudinal slope and be lined with a permanent erosion control blanket that will allow infiltration of storm water.
- STM # 11 All storm sewer shall be reinforced concrete pipe or H.D.P.E. pipe. All structures and flared end sections must be concrete. Manufacturing specifications must be followed and details provided for the installation of H.D.P.E. pipe. H.D.P.E. pipe will not be allowed for detention basin outfalls, final pipe run to detention basins, creek discharge or other approved means.
- STM # 12 The discharge point of all flared end sections shall be protected by rip rap or other approved means.
- STM # 13 Rip rap shown at flared end sections will be evaluated in the field by the Engineer, Contractor, and City Inspectors after installation for effectiveness and field modified, if necessary to reduce erosion on and off site.
- STM # 14 Add 1" minus rock back fill to all storm sewer that lie within the 1:1 shear plane of the road.

Revised	Comment
12/28/12	Rev. per city comments
8/5/13	Rev. per city comments

Engineered By:

**DOERING ENGINEERING INC.**

CIVIL ENGINEERING • PLANNING • SURVEYING

Missouri Office  
5200 Cahoon Rd.  
St. Louis, Missouri 63128  
Telephone: (314) 987-8973  
Fax: (314) 983-1718

Seal

MARK DOERING  
CIVIL ENGINEER E-23058  
8/5/13  
MO. CORPORATE  
LICENSE NO. 001347  
IL CORPORATE  
LICENSE NO. 164.003035

**GOLDEN CORRAL**  
BRAMBLETT ROAD  
O'FALLON, MO 63366  
SEWER PROFILES  
AS-BUILT DRAWING

Date: 12/15/11	Sheet
Project Number: 1063	Drawn By: JAB
File Name: 1063_CD	Check By: MAD
<b>C8</b>	



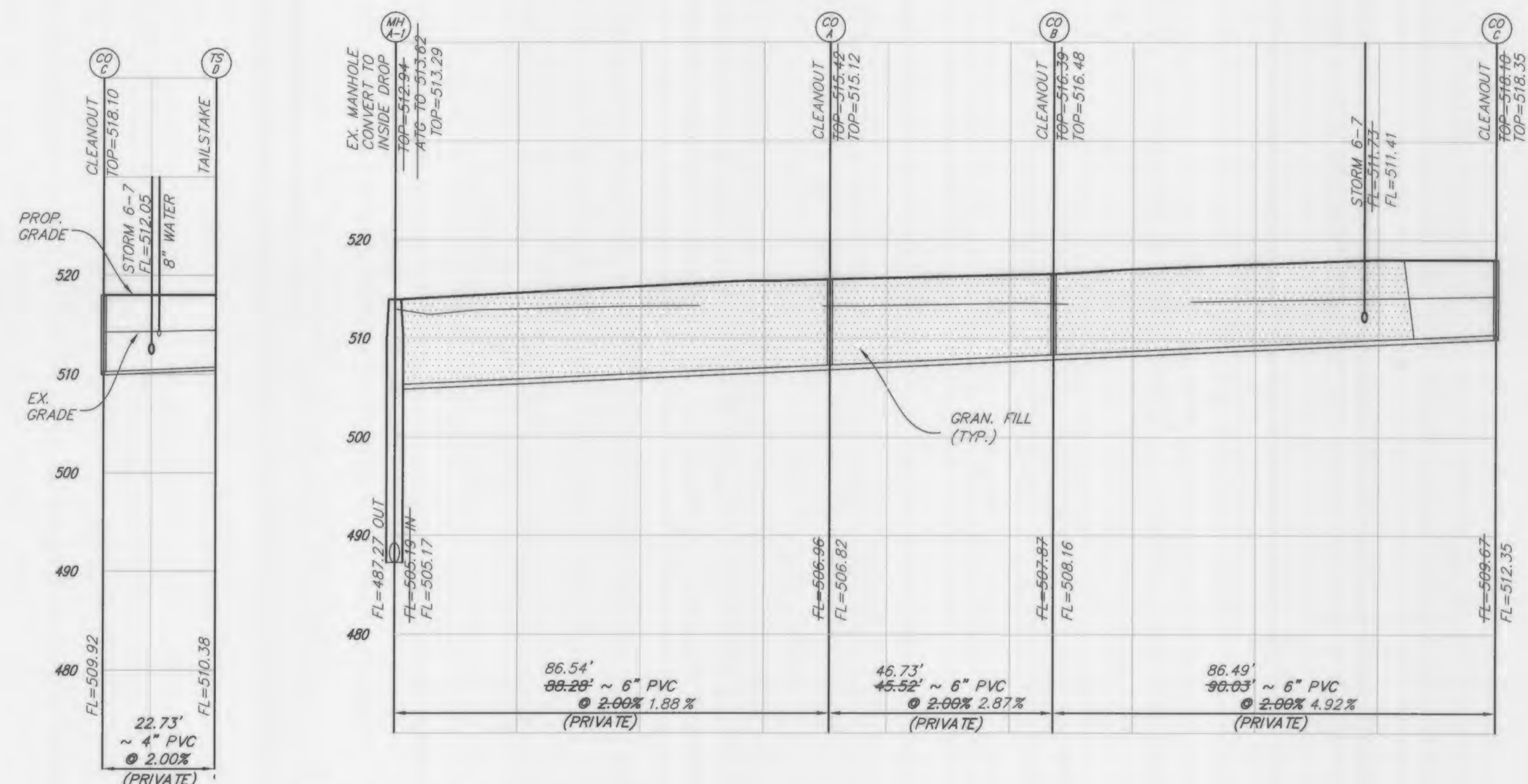

**SANITARY LATERAL PROFILE**

SCALE 1"=20'H  
1"=10'V

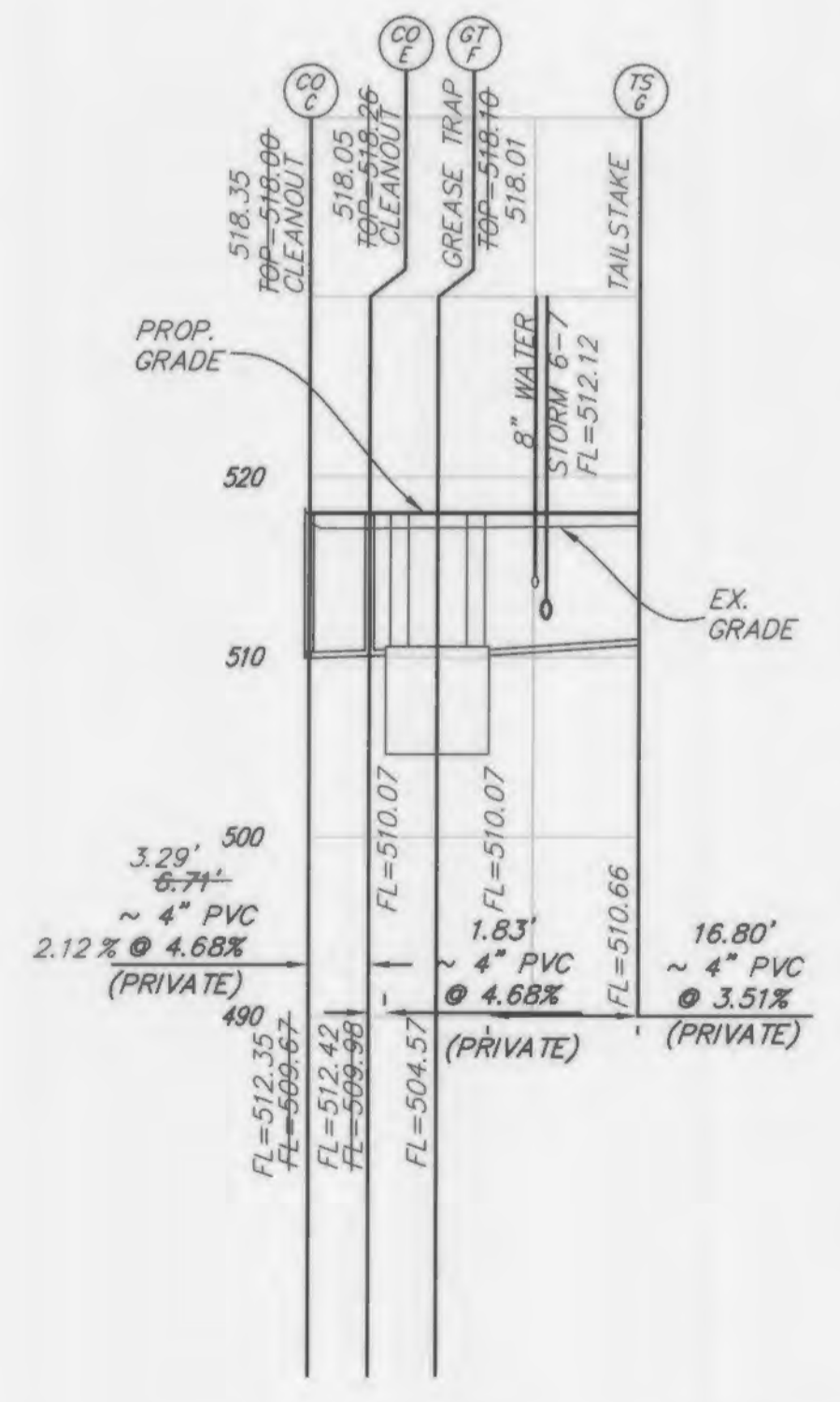

**SANITARY LATERAL PROFILE**

SCALE 1"=20'H  
1"=10'V

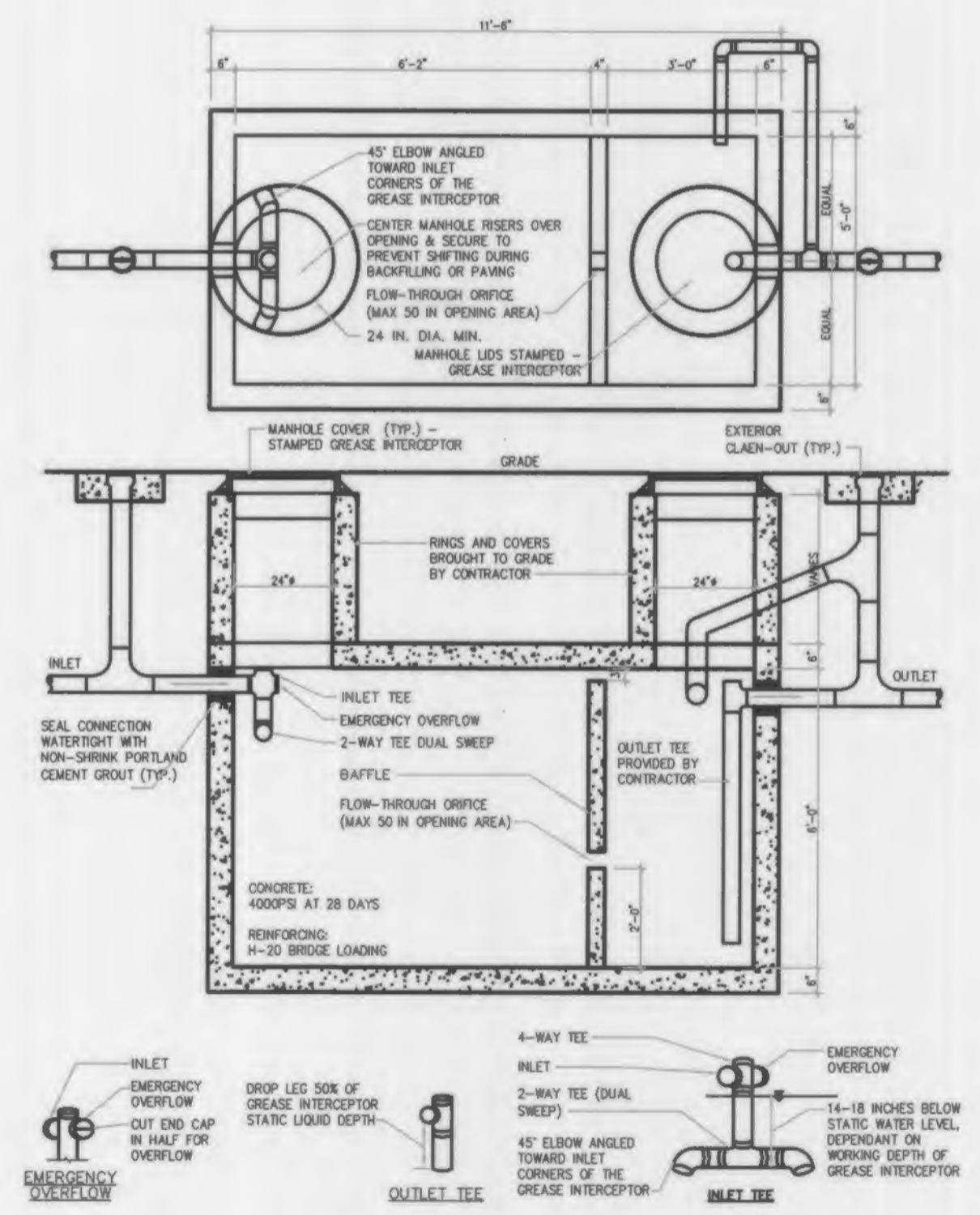

- NOTES:**
- GREASE TRAP SHALL BE ENGINEER DESIGNED BY MANUFACTURER TO RESIST ALL LOADS.
  - IF FRE-TAB SEPTIC TANK IS USED, THEN TANK SHALL BE MODIFIED TO MEET ALL DETAILS & OPENINGS & NOTES.
  - SHOP DRAWINGS SHALL SHOW EXACT DIMENSIONS, WALL THICKNESS, CONC. STRENGTH, ETC.
  - GREASE TRAP INSIDE DIMENSIONS ARE APPROPRIATE & ANY CHANGES IN LENGTH x WIDTH x DEPTH SHALL BE ADJUSTED IN PROPORTIONS SHOWN.
  - P.C. SHALL SUPPLY GREASE INTERCEPTOR BY "STAY-RIGHT TANK COMPANY, INC." (800) 788-8285 OR EQUAL.

**1 2000 GAL. GREASE INTERCEPTOR**  
SCALE: N.T.S.

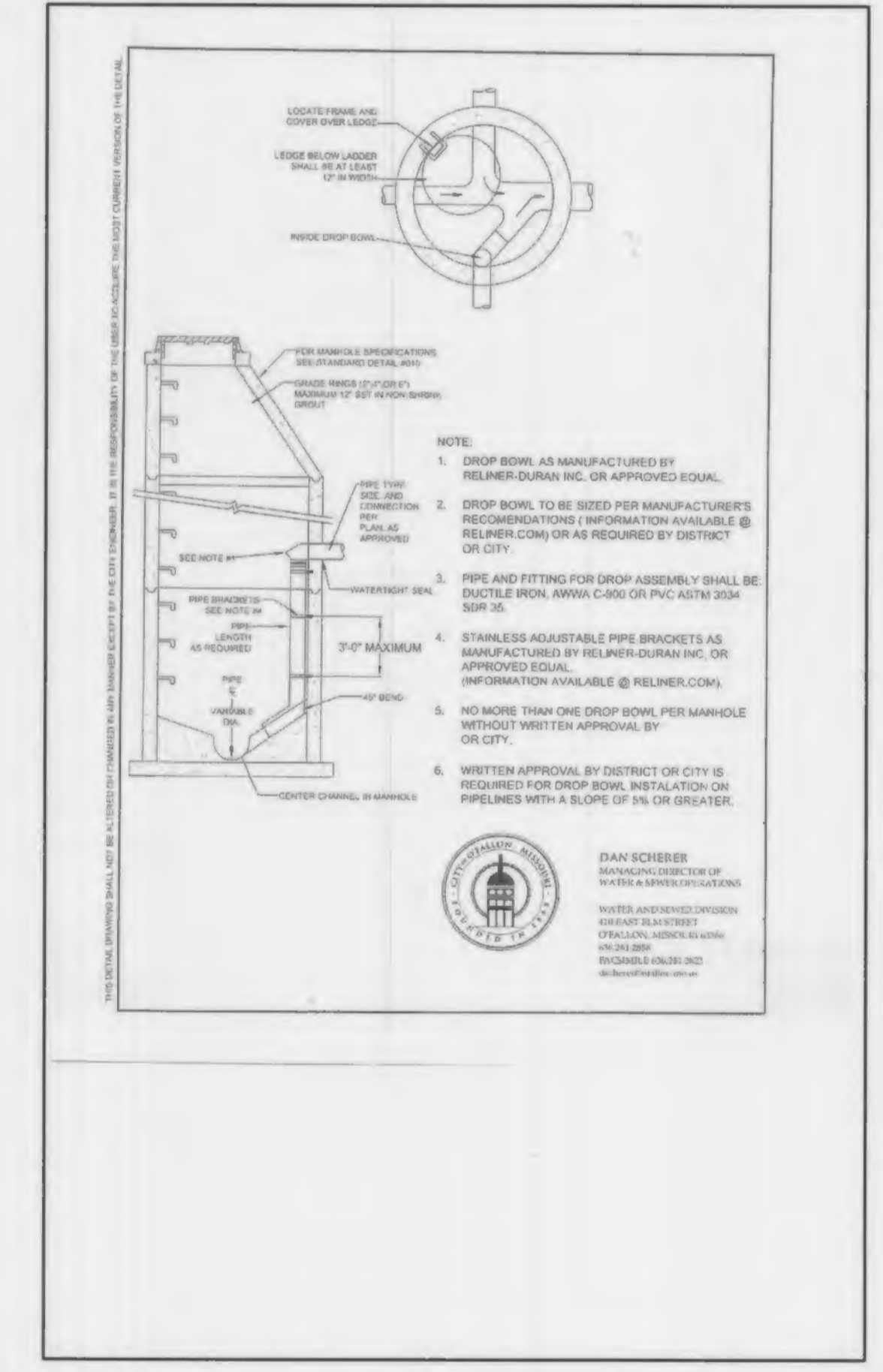

- NOTE:**
- DROP BOWL AS MANUFACTURED BY REHMER-DURRAH INC. OR APPROVED EQUAL.
  - DROP BOWL TO BE SITED PER MANUFACTURER'S RECOMMENDATIONS (INFORMATION AVAILABLE @ REHMER.COM) OR AS REQUIRED BY DISTRICT OR CITY.
  - PIPE AND FITTING FOR DROP ASSEMBLY SHALL BE DUCTILE IRON, AWWA C-900 OR PVC ASTM 2524 SDR 35.
  - STAINLESS ADJUSTABLE PIPE BRACKETS AS MANUFACTURED BY REHMER-DURRAH INC. OR APPROVED EQUAL (INFORMATION AVAILABLE @ REHMER.COM).
  - NO MORE THAN ONE DROP BOWL PER MANHOLE WITHOUT WRITTEN APPROVAL BY DISTRICT OR CITY.
  - WRITTEN APPROVAL BY DISTRICT OR CITY IS REQUIRED FOR DROP BOWL INSTALLATION ON PIPELINES WITH A SLOPE OF 1% OR GREATER.

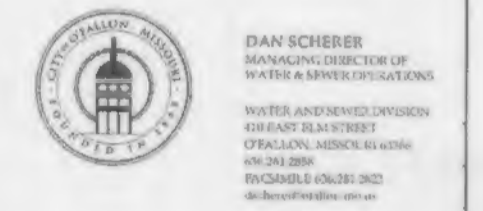

Revised	Comment
12/26/12	Rev. per city comments
8/25/13	Rev. per city comments

Engineered By:

**DOERING ENGINEERING inc.**  
CIVIL ENGINEERING • PLANNING • SURVEYING

Missouri Office  
5030 Corral Rd.  
St. Louis, Missouri 63128  
Telephone: (314) 887-8913  
Fax: (314) 843-1718

Seal

MARK DOERING  
CIVIL ENGINEER E-23059  
8/5/13  
MO. CORPORATE  
LICENSE NO. 001347  
IL CORPORATE  
LICENSE NO. 184.003035

**GOLDEN CORRAL**  
BRAMBLETT ROAD  
O'FALLON, MO 63366  
SEWER PROFILES  
AS-BUILT DRAWING

Date: 12/15/11
Project Number: 11063
File Name: 11063_CD
Drawn By: JAB
Check By: MAD
<b>C8A</b>



