

# REVISED STORM SEWER AS-BUILTS FOR INDIAN SPRINGS PLAT TWO

A TRACT OF LAND IN  
IN FRACTIONAL SECTION 6, TOWNSHIP 46 NORTH, RANGE 3 EAST  
OF THE FIFTH PRINCIPAL MERIDIAN,  
CITY OF O'FALLON, ST. CHARLES COUNTY, MISSOURI



### U.S.G.S. BENCHMARK

RM 62 - CHISELED SQUARE IN THE TOP OF SOUTH HEADWALL IN THE MIDDLE OF MEXICO ROAD BRIDGE OVER BELLEAU CREEK TRIBUTARY. ELEVATION = 493.87

### SITE BENCHMARK

AN OLD IRON PIPE LOCATED AT THE INTERSECTION OF THE WESTERN RIGHT-OF-WAY OF FIESE ROAD AND THE SOUTHWESTERN BOUNDARY OF THE TRACT. ELEVATION = 609.04

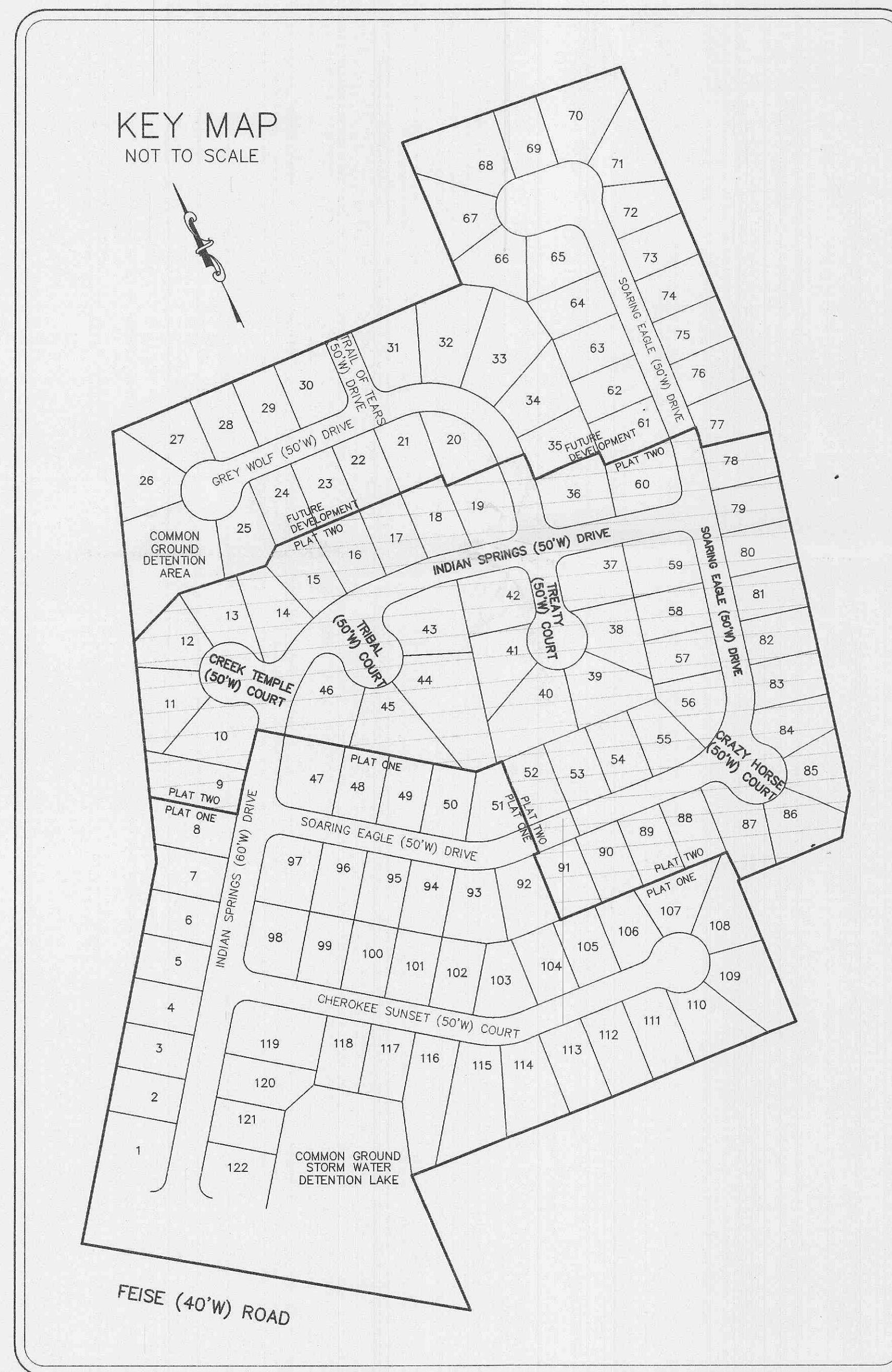

### SHEET INDEX

- 1 OF 3 - COVER SHEET
- 2 OF 3 - SITE PLAN
- 3 OF 3 - STORM PROFILES

### STORM SEWER MEASUREMENTS

THE EXISTING SEWER LENGTHS, SIZES, FLOWLINES, DEPTHS OF STRUCTURES AND SEWERS AND LOCATIONS WITH RESPECT TO EXISTING OR PROPOSED EASEMENTS HAVE BEEN MEASURED. THE RESULTS OF THOSE MEASUREMENTS ARE SHOWN ON THIS SET OF FINAL MEASUREMENT PLANS.

ALL PUBLIC SEWERS ARE LOCATED AND DESIGNATED EXISTING OR PROPOSED EASEMENTS EXCEPT AS FOLLOWS:

SIGNED: \_\_\_\_\_ DATE: \_\_\_\_\_  
P.E./L.S. \_\_\_\_\_

**"NEW ASBUILTS ADDED NOVEMBER, 2007"**  
**"ASBUILTS ADDED JUNE, 1999"**

PREPARED FOR: KAPLAN DEVELOPMENT  
P.O. BOX 340  
ST. PETERS, MISSOURI 63376  
636-397-4471

DISCLAIMER OF RESPONSIBILITY  
I hereby specify that the documents intended to be distributed by my seal are limited to this sheet, and I hereby disclaim any responsibility for all other drawings, specifications, estimates, reports or other documents or instruments relating to or intended to be used for any part or parts of the architectural or engineering project or survey.

Copyright 2007  
Box Engineering Company, Inc.  
All Rights Reserved

REVISIONS	
12-11-07	City Comments

**ENGINEERING  
PLANNING  
SURVEYING**  
221 Point West Blvd.  
St. Charles, MO 63301  
636-928-6552  
FAX 928-1718

11-5-07  
DATE  
96-8861G  
PROJECT NUMBER  
1 OF 3  
SHEET OF  
8861-ASB-SUP  
FILE NAME  
SAZ  
DRAWN  
DESIGNED CHECKED



PROPERTY N/F  
PAUL J. AND CHARLES A. FEISE  
810/1757  
PARCEL 2

GRAPHIC SCALE

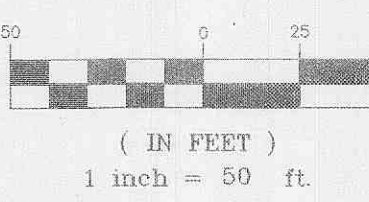

PROPERTY N/F  
KAPLAN DEVELOPMENT CO  
ZONED R-1 (CITY OF FALLON)

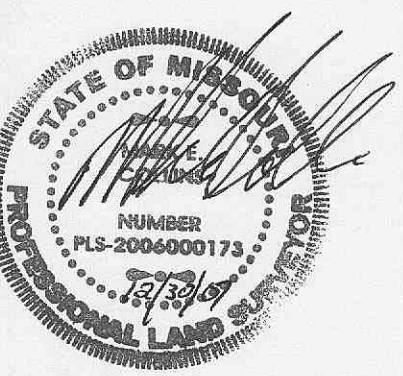



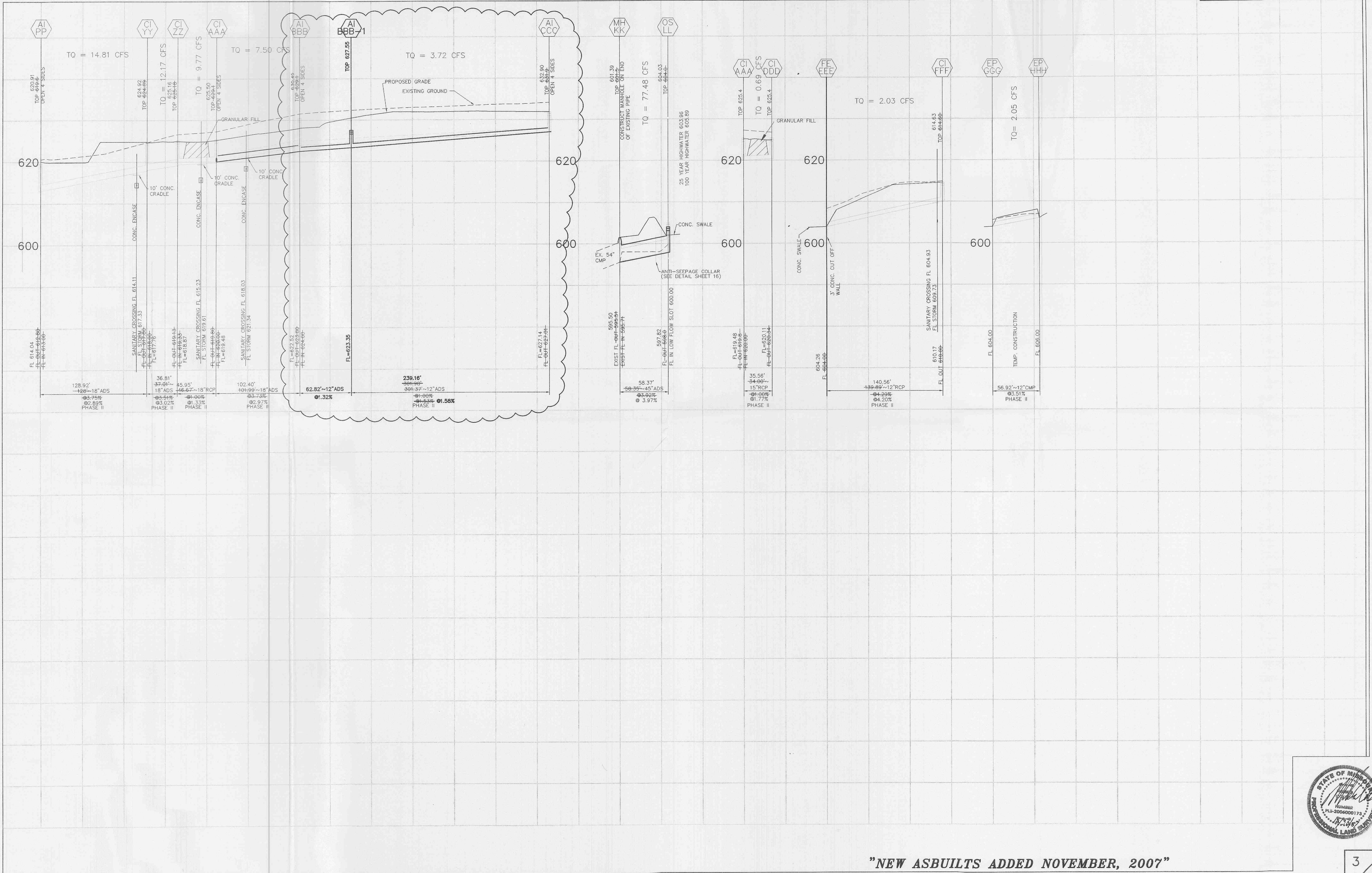

**"NEW ASBUILTS ADDED NOVEMBER, 2007"**  
**"ASBUILTS ADDED JUNE, 1999"**

SCALE: VERTICAL = 10  
HORIZONTAL = 50

