

LOWE'S HOME IMPROVEMENT
8501 MEXICO RD
ST. PETERS, MO 63376

1-STORY
CONCRETE & STONE BUILDING
FF = 524.77'

PROPOSED TOOL
RENTAL AREA
(±3,192 SF)
FFE: 524.77

OUTDOOR
STORAGE
AREA

ENCLOSED STORAGE AREA

LEGEND

- EXISTING CONTOURS
- PROPOSED CONTOURS
- - - XX"SD - EXISTING STORM SEWER
- - - PROPOSED STORM SEWER
- x (595.50) PROPOSED SPOT SHOT
- x (595.50 EX) EXISTING SPOT SHOT
- x (6590.50) PROPOSED TOP OF CURB SPOT SHOT
- x (6590.50) PROPOSED BOTTOM OF CURB SPOT SHOT

BENCHMARK INFORMATION

- ⊕ BENCHMARK SET
ELEV = 514.77'
E: 764975.59
N: 1077215.21

ASBUILT NOTE

ALL INLET AND/OR MANHOLE TOPS WERE
BUILT WITHIN 0.5 FEET OF THE DESIGNED
ELEVATION

AS-BUILT

NOTE: AS-BUILT REVISIONS ARE BASED ON
CONTRACTOR RED-LINE MARKUPS. NO FIELD
SURVEYS WERE PERFORMED.

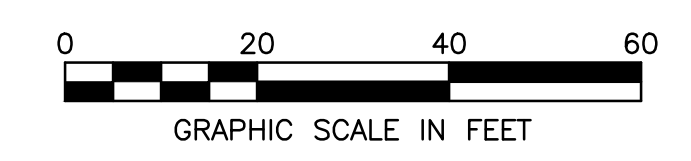
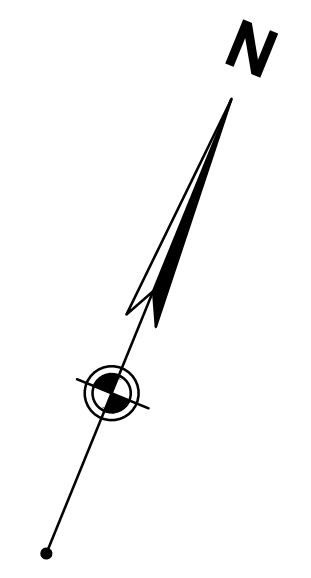

REVISIONS	
PRE-BID SET	POST-BID SET
DATE	DESCRIPTION
06/16/21	AS 03

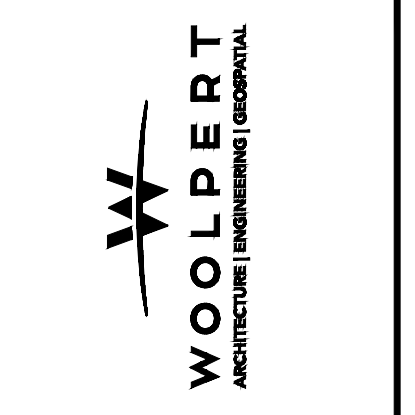

LOWE'S HOME CENTERS, LLC
1000 LOWE'S BOULEVARD
MOORESVILLE, NC 28117
704.758.1000 (PH.)

THIS DRAWING IS THE PROPERTY OF LOWE'S HOME CENTERS, LLC. ANY USE OR REPRODUCTION IN WHOLE OR PART IS PROHIBITED WITHOUT THE EXPRESSED WRITTEN CONSENT OF LOWE'S HOME CENTERS, LLC. COPYRIGHT 2009 ALL RIGHTS RESERVED.

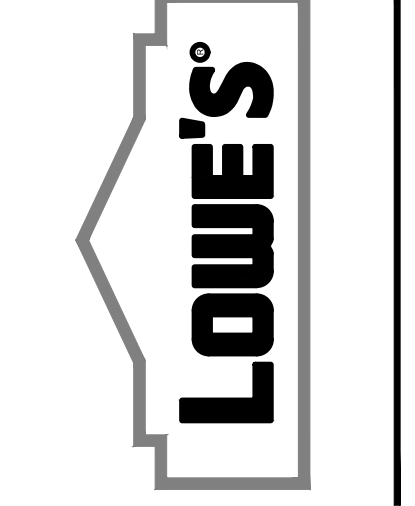

TOOL RENTAL CENTER
GRADING PLAN

LOWE'S OF
#0753 O'FALLON
O'FALLON, MO

PROJECT No. 000 DRAWN BY: CHECKED BY:

CRITERIA	
ISSUE DATE:	
PERMIT SET	
ISSUE DATE:	
CONSTRUCTION SET	
ISSUE DATE:	
DRAWING NUMBER:	

C300

ORIGINAL
SECOND
FINAL

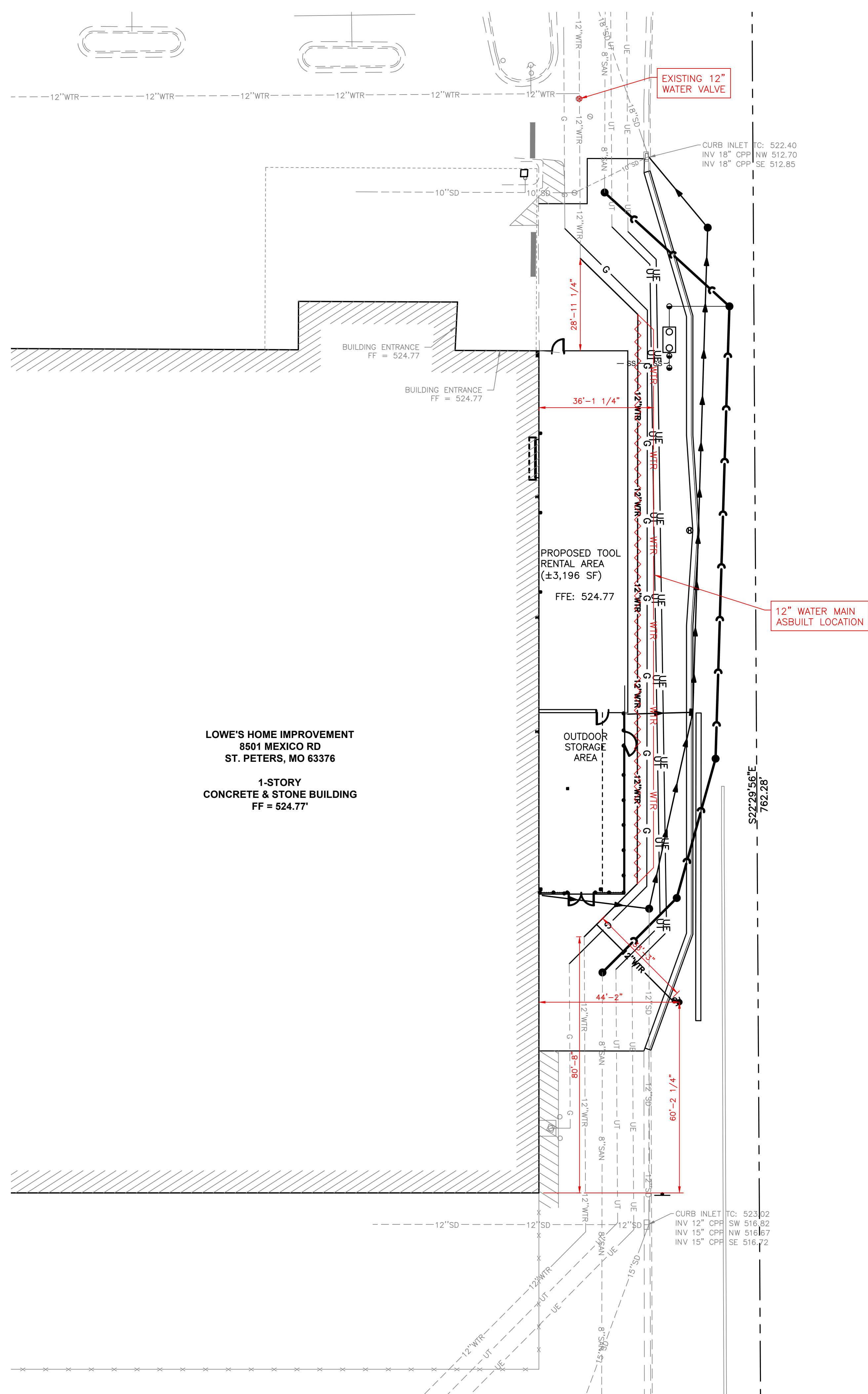

LOWE'S HOME IMPROVEMENT
8501 MEXICO RD
ST. PETERS, MO 63376

1-STORY
CONCRETE & STONE BUILDING
FF = 524.77'

NOTES

LOCATION OF SITE UTILITIES SHALL BE VERIFIED BY GENERAL CONTRACTOR AND THE UTILITY COMPANY PROVIDING SERVICE.

GENERAL CONTRACTOR SHALL PROVIDE 2' x 2' x 6" THICK CONCRETE APRON AT ALL CLEANOUTS, VALVES, AND METERS OUTSIDE OF BUILDING.

GENERAL CONTRACTOR WILL BE RESPONSIBLE FOR ALL TAP AND TIE ON FEES REQUIRED, AS WELL AS COST OF UNDERGROUND SERVICE CONNECTIONS TO THE BUILDING.

GENERAL CONTRACTOR SHALL FURNISH (2) - 4" TELEPHONE CONDUIT(S) AS SHOWN ON PLAN, VERIFY LOCATION OF TIE IN AT TELEPHONE COMPANY'S SERVICE LINE. PROVIDE NYLON PULL CORDS INSIDE CONDUIT.

THRUST BLOCKS SHALL BE PROVIDED AT ALL BENDS, TEES, AND FIRE HYDRANTS. DIMENSIONS SHOWN ARE TO CENTERLINE OF PIPE OR FITTING.

ALL WATER AND SANITARY LEADS TO BUILDING SHALL END 5' OUTSIDE THE BUILDING LIMITS AS SHOWN ON PLAN AND SHALL BE PROVIDED WITH A TEMPORARY PLUG AT END.

ALL FIRE HYDRANTS SHALL BE PROVIDED WITH AN APPROVED GATE VALVE A MAXIMUM OF 5'-0" FROM HYDRANT.

ALL TRENCHING, PIPE LAYING, AND BACKFILLING SHALL BE IN ACCORDANCE WITH FEDERAL OSHA REGULATIONS.

GENERAL CONTRACTOR SHALL HAVE APPROVAL OF ALL GOVERNING AGENCIES HAVING JURISDICTION OVER THIS SYSTEM PRIOR TO INSTALLATION.

ALL WORK SHALL BE DONE IN STRICT ACCORDANCE WITH DIVISION 2 OF LOWE'S STANDARD SITE SPECIFICATIONS.

REFER TO PLUMBING SHEETS FOR LOCATION OF SEWER, DOMESTIC AND IRRIGATION CONNECTIONS.

CONTACTOR SHALL COORDINATE AND SCHEDULE ALL UTILITY SERVICE OUTAGES WITH THE STORE MANAGER A MINIMUM OF 48 HOURS IN ADVANCE.

SEWER FLOW IS FROM JANITOR CLOSET AND EXTERIOR FLOOR DRAIN. NO RESTROOMS CONNECT TO SYSTEM.

LEGEND

- 18"SD --- EXISTING STORM SEWER
- SAN --- EXISTING SANITARY SEWER
- WTR --- EXISTING WATER
- UT --- EXISTING UNDERGROUND TELEPHONE
- UP --- EXISTING UNDERGROUND ELECTRIC
- G --- EXISTING GAS
- OEC --- EXISTING OVERHEAD ELECTRIC/CABLE
- WS --- WS --- WS --- WS --- PROPOSED WATER SERVICE
- 8"WTR --- PROPOSED WATER
- IRR --- PROPOSED IRRIGATION LINE
- SS --- SS --- SS --- SS --- PROPOSED SANITARY SEWER LATERAL
- FM --- PROPOSED SANITARY FORCEMAIN
- --- PROPOSED STORM SEWER
- --- STORM SEWER UNDERDRAIN
- PROPOSED STORM INLET
- PROPOSED MANHOLE
- EXISTING SANITARY MANHOLE
- 1.1.1.1 STORM STRUCTURE #
- A.1.1.1 SANITARY STRUCTURE #
- SANITARY CLEANOUT
- LIGHTPOLE
- ⊗ GATE VALVE
- ⊕ WATER SERVICE SHUT OFF VALVE
- ▲ FIRE HYDRANT

AS-BUILT

NOTE: AS-BUILT REVISIONS ARE BASED ON CONTRACTOR RED-LINE MARKUPS. NO FIELD SURVEYS WERE PERFORMED.

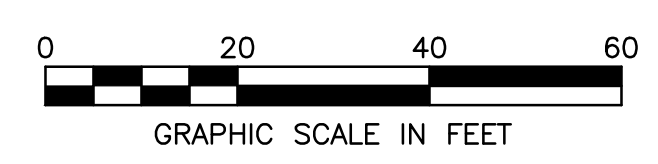
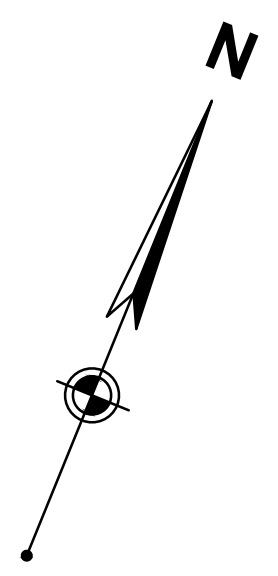

REVISIONS	
PRE-BID SET	POST-BID SET
DATE	DESCRIPTION
06/16/21	ASB

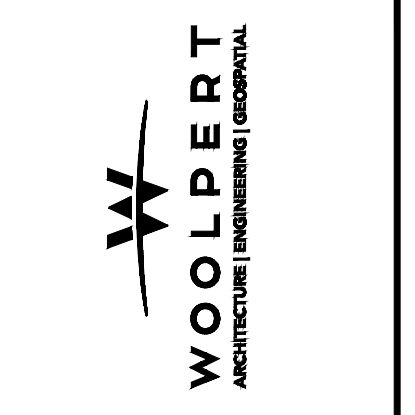

LOWE'S HOME CENTERS, LLC
1000 LOWE'S BOULEVARD
MOORESVILLE, NC 28117
704.758.1000 (PH.)

THIS DRAWING IS THE PROPERTY OF LOWE'S HOME CENTERS, LLC. ANY USE OR REPRODUCTION IN WHOLE OR IN PART IS PROHIBITED WITHOUT THE EXPRESSED WRITTEN CONSENT OF LOWE'S HOME CENTERS, LLC. COPYRIGHT 2009 ALL RIGHTS RESERVED.

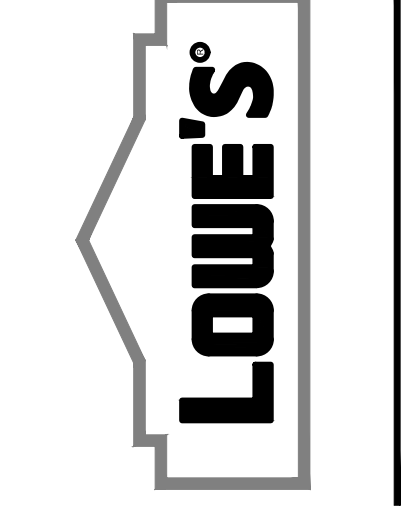

TOOL RENTAL CENTER
UTILITY PLAN

LOWE'S OF
#0753 O'FALLON
O'FALLON, MO

PROJECT No. XXX
DRAWN BY: []
CHECKED BY: []

CRITERIA	ISSUE DATE:
PERMIT SET	ISSUE DATE:
CONSTRUCTION SET	ISSUE DATE:
DRAWING NUMBER:	

C400

ORIGINAL	
SECOND	
FINAL	

REVISIONS	
DATE	DESCRIPTION
06/12/21	UPDATED FOR ENGINEERING REVIEW

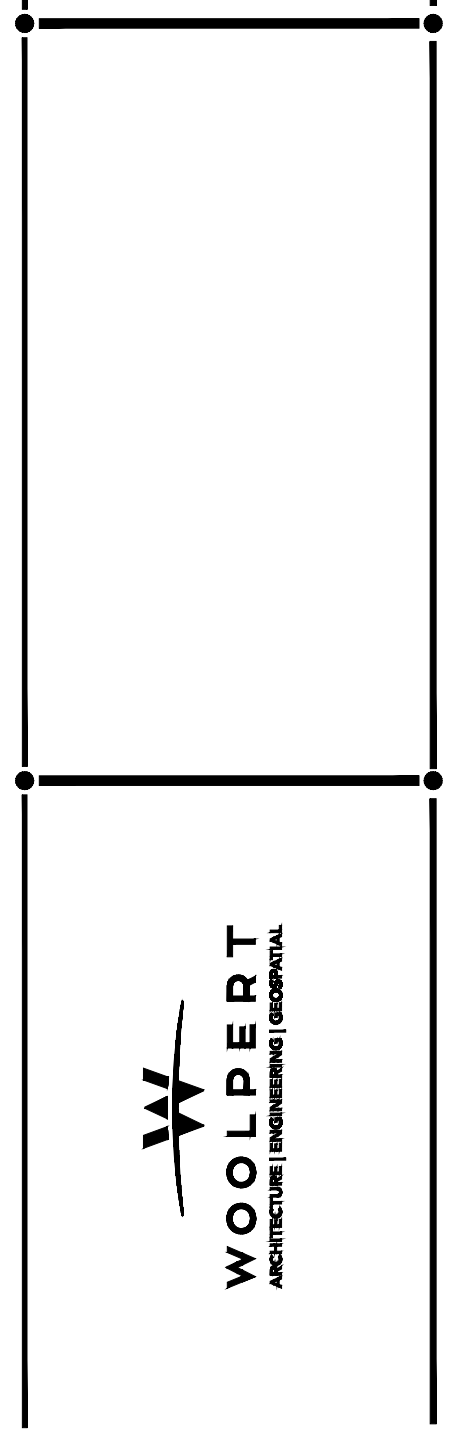

LOWE'S HOME CENTERS, LLC
 1000 LOWE'S BOULEVARD
 MOORESVILLE, NC 28117
 704.758.1000 (PH.)

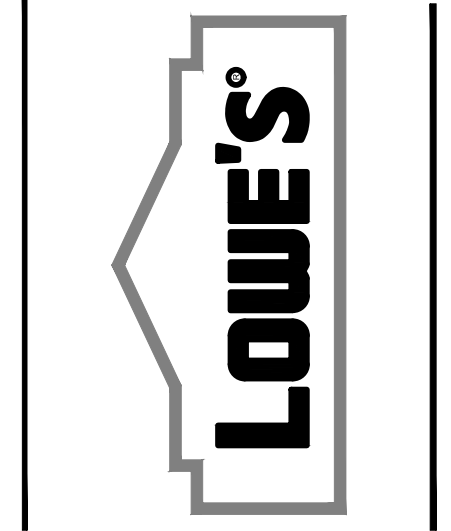

TOOL RENTAL CENTER
 UTILITY PROFILES
 LOWE'S OF
 #0753 O'FALLON
 O'FALLON, MO

PROJECT No. XXX
 DRAWN BY: []
 CHECKED BY: []
 CRITERIA
 ISSUE DATE:
 PERMIT SET
 ISSUE DATE:
 CONSTRUCTION SET
 ISSUE DATE:
 DRAWING NUMBER:
C401

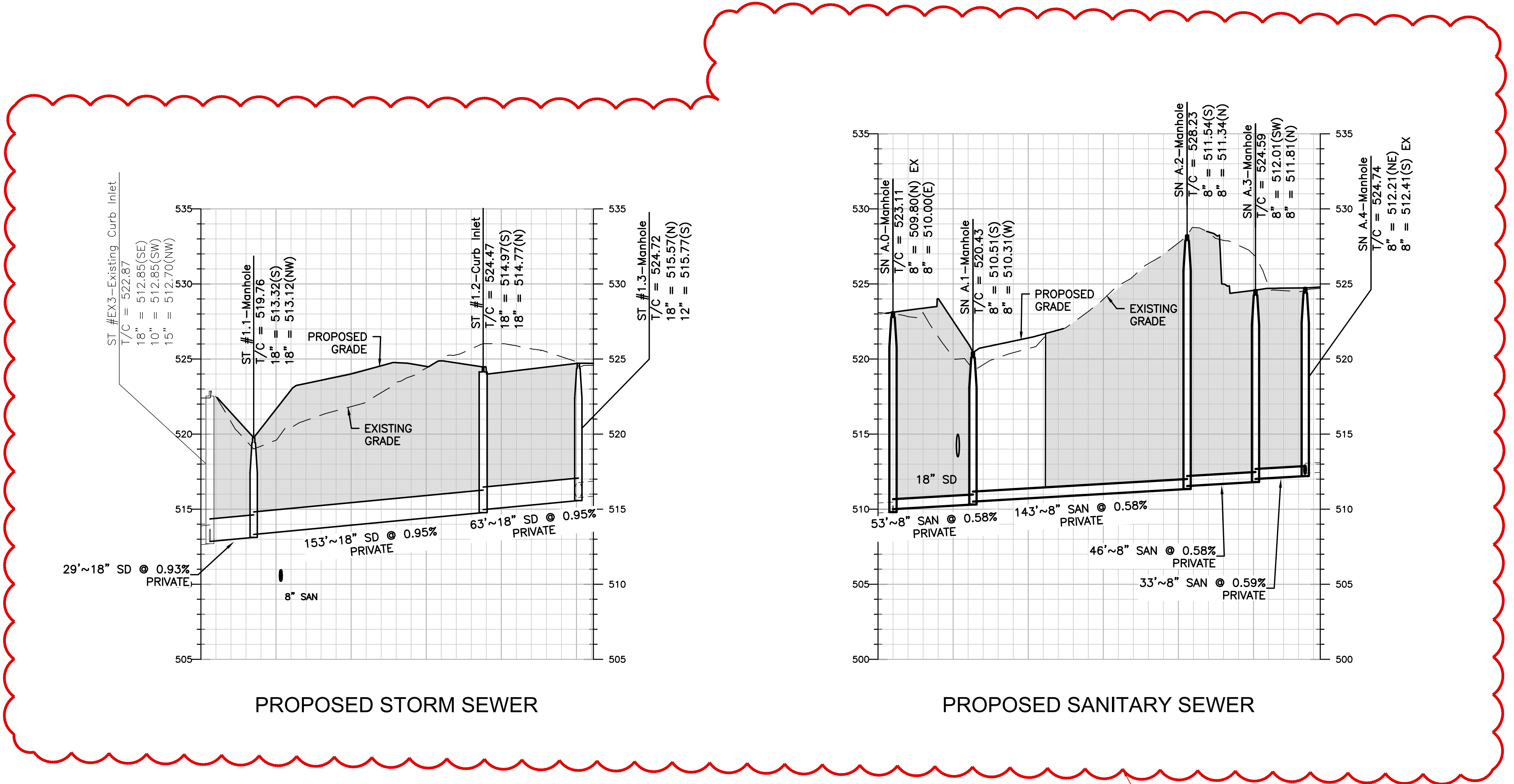

LEGEND
 [Shaded Box] ROCK BACKFILL

ASBUILT NOTE
 ALL INLET AND/OR MANHOLE TOPS WERE BUILT WITHIN 0.5 FEET OF THE DESIGNED ELEVATION

AS-BUILT
 NOTE: AS-BUILT REVISIONS ARE BASED ON CONTRACTOR RED-LINE MARKUPS. NO FIELD SURVEYS WERE PERFORMED.

ASBUILT INFORMATION MATCHES DESIGN INFORMATION

- NOTES**
1. T/C SHALL INDICATE THE TOP BACK OF CURB FOR CURB INLETS AND TOP OF CASTING FOR SANITARY/STORM MANHOLES.
 2. ALL CONNECTIONS TO EXISTING MAINS SHALL HAVE INVERTS AND LOCATION VERIFIED BEFORE BEGINNING CONSTRUCTION. ANY DIFFERENCE BETWEEN FIELD AND PLANS SHALL BE REPORTED TO THE ENGINEER.

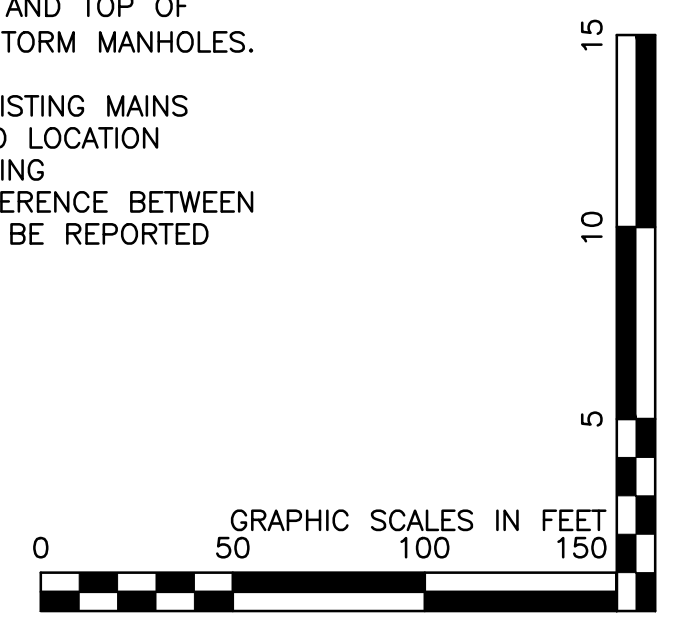

ORIGINAL	
SECOND	
FINAL	