

LEGEND:

- VTR — PROPOSED WATER MAIN
- SAN — PROPOSED SANITARY SEWER
- ST — PROPOSED STORM SEWER
- UE — UTILITY EASEMENT
- WM — WATER METER
- WV — WATER VALVE
- FH — FIRE HYDRANT
- C.I. — CURB INLET
- J.B. — JUNCTION BOX
- P.V.R. — UNDERGROUND ELECTRICAL 1/0 PRIMARY
- ES — UNDERGROUND ELECTRICAL TRIPLEX SECONDARY
- ET — ELECTRICAL TRANSFORMER
- ▲ F.E.S. — FLARED END SECTION
- D.S. — DOWN SPOUT
- C.O. — CLEAN OUT

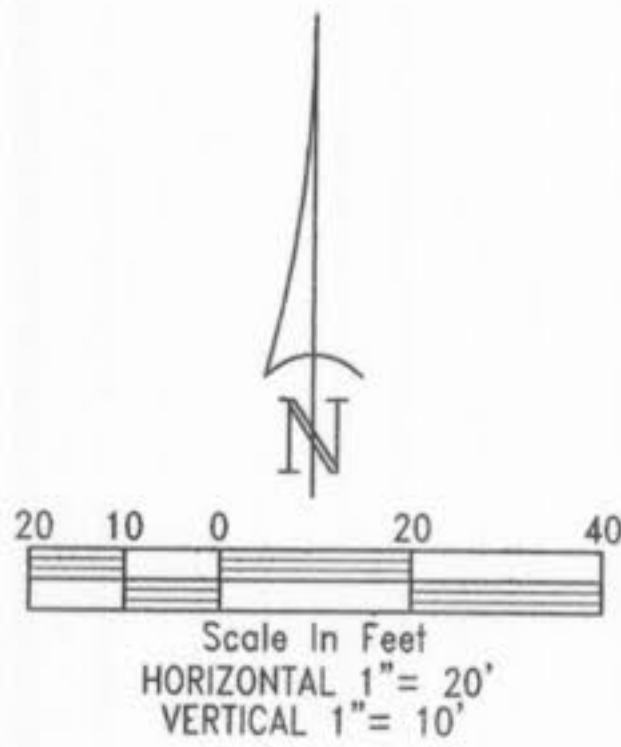

STORM SEWER COMPUTATIONS - AS-BUILT
RETURN PERIOD = 25 YEAR, K = 1

SEWER LOCATION		DRAINAGE AREA		TIME OF FLOW (minutes)			RAINFALL		RUNOFF FLOW, Q (cfs)		SEWER CHARACTERISTICS, N=0.012 HDPE									
FROM	TO	DESIGNATION	AREA, A (acres)	COEFF. C	T ₁	T ₂	ACT. T _c	DESIGN T _c	INTENSITY, I (in./hr.)	INLET K.L.C.A.	BYPASS	IN-PIPE K.L. Σ C.A.	DIAMETER (inches)	CAPACITY, Q _p (CFS)	VELOCITY (fps)	SLOPE (%)	LENGTH (ft.)	FALL (ft.)	FLE _{UP}	FLE _{DN}
LINE 1	CI-1-3	CI-1-2	DA-6	0.72	0.60	11.87	0.13	12	6.59	3.13		6.25	18	23.57	13.34	4.29	87.30	586.58	582.83	
	CI-1-2	FES-1-1	DA-2, DA-5	0.34	0.80	4.74	0.26	5	8.53	2.52		9.73	24	25.88	8.24	1.11	140.00	582.73	581.17	
LINE 2	CI-2-1	CI-1-2	DA-4	0.14	0.73	4.73	0.27	5	8.53	0.96		0.96	18	9.04	5.11	0.61	128.6	583.61	582.83	

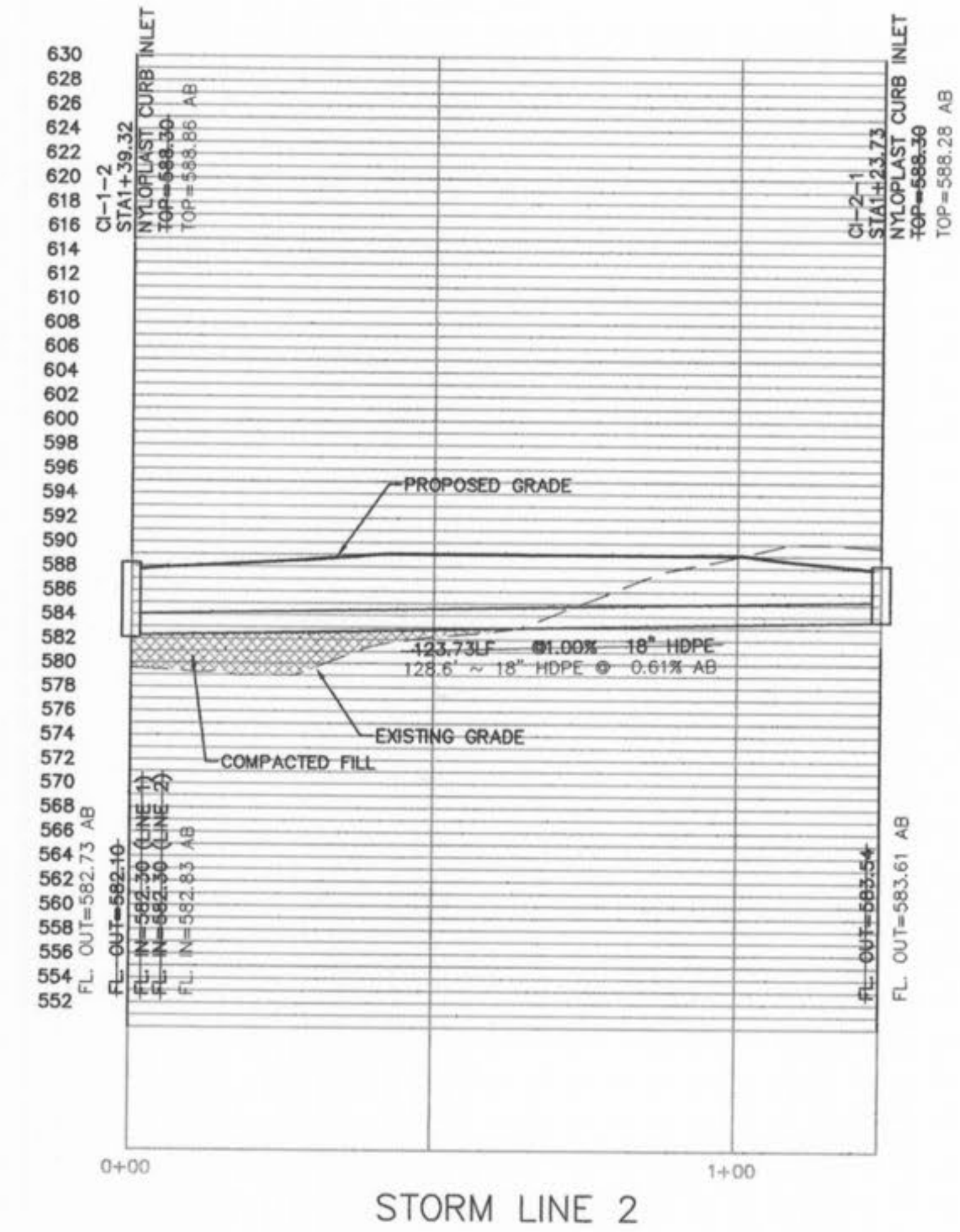
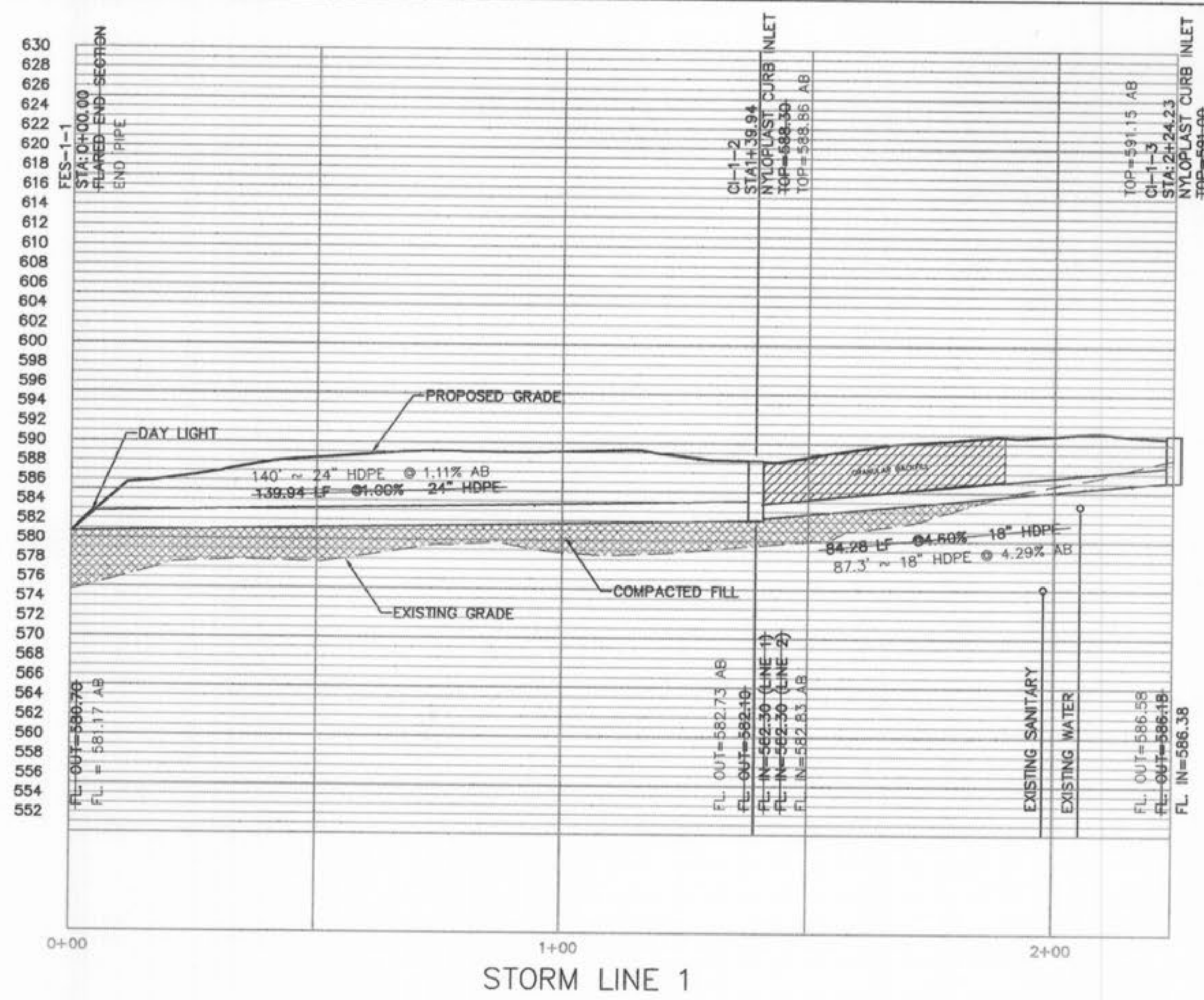

NECAC OFFICE BUILDING
 O'FALLON, ST. CHARLES COUNTY, MISSOURI

Berger Devine Yaeger, Inc.
 5705 BROADWAY, SUITE 300
 KANSAS CITY, MISSOURI 64111-2506
 PHONE: (816) 561-2761
 FAX: (816) 561-9722

COPYRIGHT © 2003
 1ST ISSUE
 09-JULY-04
 REVISIONS
 01-FEB-05
 22-DEC-05
 03-JAN-06
 02-FEB-06 AS-BUILT

SHEET NO.
C1.3

UTILITY PLAN
 PLANNING AND ZONING FILE #4202

JOB NO.
2285
 SHEET
As built