

GENERAL NOTES

1. Gas, water and other underground utilities shall not conflict with the depth or horizontal location of existing and proposed sanitary and storm sewers including house laterals.
2. Underground utilities have been plotted from available information and therefore their locations must be considered approximate only. The verification of the location of all underground utilities, either shown or not shown on these plans shall be the responsibility of the contractor, and shall be located prior to grading or construction of improvements.
3. Polyvinyl Chloride (PVC) shall conform to the requirements of ASTM D-3034 Standard Specifications for the PSM Polyvinyl Chloride (PVC) Sewer Pipe and Fittings, SDR35.
4. Storm sewers 18" diameter or smaller shall be A.S.T.M. C-14.
5. Storm sewers 21" diameter or larger shall be A.S.T.M. C-76, Class II.
6. All storm sewer pipe under pavement, regardless of size, shall be reinforced concrete pipe (A.S.T.M. C-76, Class II) unless noted otherwise on the plans.
7. Corrugated metal pipe shall conform to the standard specifications for corrugated culvert pipe M 36, A.A.S.H.O. See plans for gauge.
8. All filled places under buildings, proposed storm and sanitary sewer lines and/or paved areas including trench backfills shall be compacted to 90% of maximum density as determined by the "Modified A.A.S.H.O. T-180 Compaction Test" (A.S.T.M. D-1557) unless otherwise specified by local governing authority specifications. All tests shall be verified by a Soils Engineer.
9. All filled places in paved State, County or City roads (Highways) shall be compacted to 90% of maximum density as determined by the "Standard Proctor Test A.A.S.H.O. T-99" (A.S.T.M. D-698) unless otherwise specified by local governing authority specifications. All tests shall be verified by a Soils Engineer.
10. All storm and sanitary trench backfills will be water jetted. Granular backfill will be used under pavement areas.
11. Easements shall be provided for storm sewers, sanitary sewers and all utilities on the record plat. See record plat for location and size of easements. This does not apply to house laterals.
12. No area shall be cleared without permission of the developer.
13. All grade shall be within 0.2 feet more or less of those shown on the grading plan.
14. No slope shall be greater than 3:1 and shall be either sodded or seeded and mulched.
15. Barricades will consist of three standard 12" x 36" red and white striped scotchlite hazard markers mounted on two pound "U" channel sign post, with bottom of marker seven feet above pavement surface.
16. All manhole and catch basin tops built without elevations furnished by the Engineer will be the responsibility of the sewer contractor. At the time of construction stake-out of the sewer lines, all curb and grate inlets will be face staked. If normal face stakes fall in line with sewer construction the Engineer will set these stakes on a double offset. It shall be the responsibility of the sewer contractor to preserve all face stakes from destruction.
17. All standard street curb inlets to have front of inlet 2 feet behind curb.
18. The minimum vertical distance from the low point of the basement to the flowline of a sanitary sewer at the corresponding house connection shall not be less than the diameter of the sanitary sewer plus a vertical distance not less than two and one half feet (2-1/2').
19. Water lines, valves, sleeves, meters and etc. shall meet all specifications and installation requirements of the local governing authority.
20. All cast iron pipe for water mains shall conform to A.W.W.A. specification C-106 and/or C-108. The cast iron fittings shall conform to A.W.W.A. specification C-110. All rubber gasket joints for water cast iron pressure pipe and fittings shall conform to A.W.W.A. specification C-111.
21. All water hydrants and valves shall be cast iron and installed in accordance with plans and details.
22. All sanitary and storm sewers shall meet all specifications and installation requirements of the local governing authority.
23. All P.V.C. water pipe shall have a minimum pressure rating of PR-200 or SDR-21.
24. All P.V.C. sanitary sewer pipe to be DR-35 or equal with crushed stone bedding uniformly graded between 1" and 1/4" size. This bedding shall extend from 6" below the pipe to 7/10 of the pipe dia. above the bottom of the pipe.
25. All grading on Missouri State Highway Right-of-Way shall be seeded and mulched and all disturbed Right-of-Way Markers shall be reset at the completion of grading.
26. All streets must meet the specifications and installation requirements of the City of O'Fallon
27. This tract is served by
 - A. O'Fallon Sewers
 - B. O'Fallon Water
 - C. Union Electric
 - D. O'Fallon Gas
 - E. Continental Telephone

OSAGE MEADOWS

PLAT THREE

INDEX

SHEET	DESCRIPTION
1	Cover Sheet
2a-2b	Record Plat
3	Flat Plan
4	Grading Plan
5	Drainage Area Map
6-8-4-C	Storm Sewer Profiles
9-11-7-9	Sanitary Sewer Profiles
12-14	Street Profiles
15-17	Detail Sheets



LEGEND

C.I.	Curb Inlet
D.C.I.	Double Curb Inlet
A.I.	Area Inlet
G.I.	Grate Inlet
M.H.	Manhole
F.E.	Flared end section
E.P.	End pipe
C.P.	Concrete pipe
R.C.P.	Reinforced concrete pipe
C.M.P.	Corrugated metal pipe
C.I.P.	Cast iron pipe
P.V.C.	Polyvinyl chloride pipe
V.C.P.	Vitrified clay pipe
C.O.	Clean out
V.T.	Vent trap
—●—	Storm sewer (proposed)
—○—	Sanitary sewer (proposed)
—50—	Existing contour
—50—	Proposed contour
—T—	Street sign
— —	End of lateral
— —	Lateral
5	Lot or building number
—○—	Test Hole
—x—	Existing fence line
—wavy—	Existing tree line
—dashed—	Storm sewer (existing)
—dashed—	Sanitary sewer (existing)
—solid—	Water line
—T—	Tee and valve
—○—	Cap
—○—	Hydrant
—T—	Thrust block

PROPERTY OF
CITY OF O'FALLON
BUILDING DEPARTMENT

This is to certify that the as-constructed elevations, locations and distances shown hereon are correct and were taken in the field during March, 1986.

RAY PICKETT, P.E. E-14395

Pickett
R
S
&
Silver
CIVIL ENGINEERS
LAND SURVEYORS
INC.

T.C. INVESTMENT CO. INC.
STANLEY COTTON
12 GEORGETOWN
ST. LOUIS, MO. 63122
PHONE 821-1256

DRAWN BY inc DATE Dec. 1984
CHECKED BY DATE 82-120

Scale: Horiz. 1"=50'
Vert. 1"=10'

AS BUILTS

FINAL SURVEY BY DATE
NOTED BY
NOTE BOOK NO.
TEMPLATE NO.
ANAS CHECKED

ORIGINAL SURVEY BY DATE
NOTED BY
NOTE BOOK NO.
TEMPLATE NO.
ANAS CHECKED

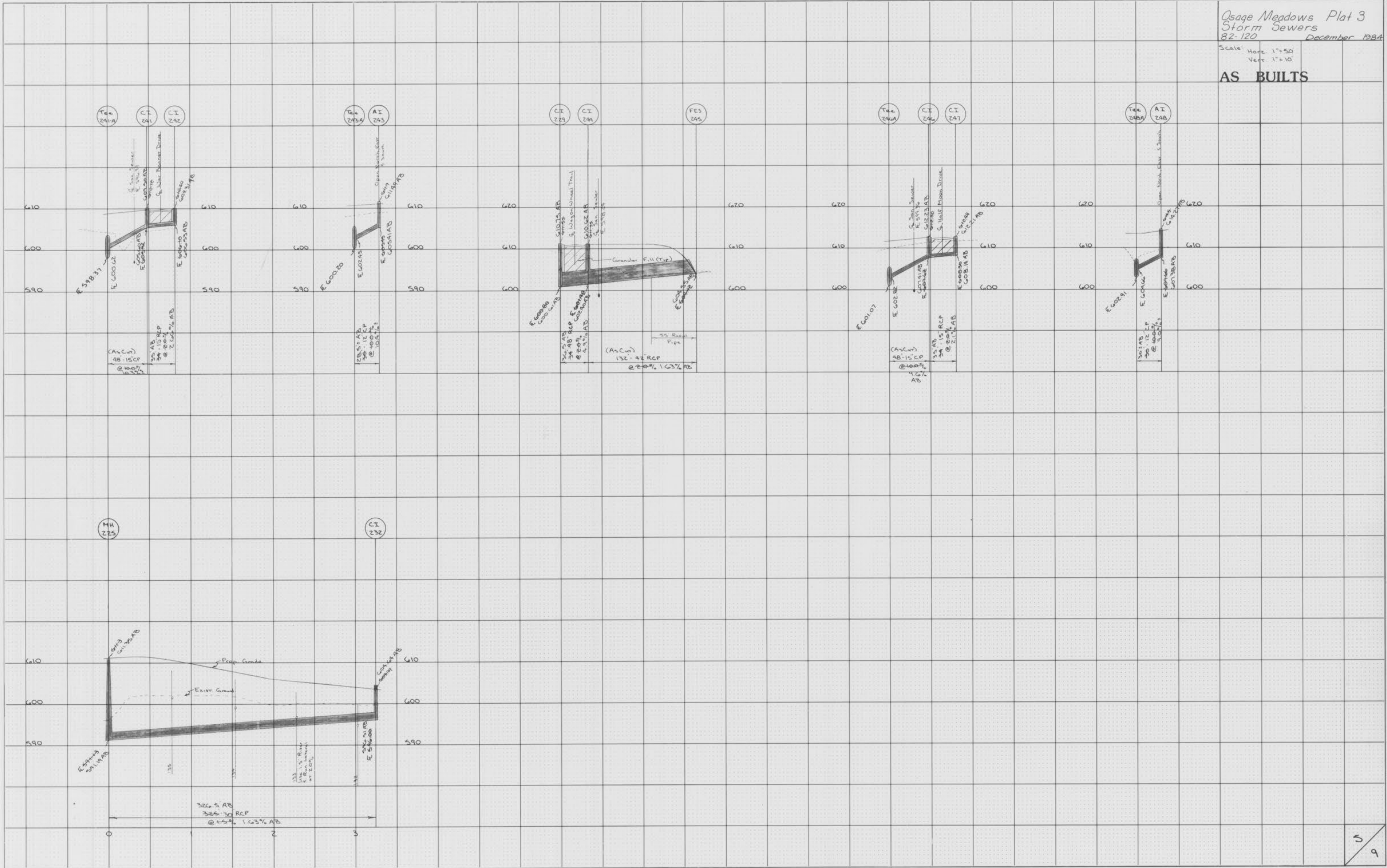

HIGHWAY FEDERAL AID SHEET
PLATE 3-FULL CROSS SECTION LINE & DOT
W/LEADS
PRINTED IN U.S.A.

PROPERTY OF
CITY OF FALLON
BUILDING DEPARTMENT

OSAGE MEADOWS PLAT 3
STORM SEWERS
AS BUILTS

U
9

Scale: Horiz. 1"=50'
Vert. 1"=10'

AS BUILTS

FINAL SURVEY DRAWING
DATE: _____
BY: _____
CHECKED: _____
NO. _____

ORIGINAL SURVEY DRAWING
DATE: _____
BY: _____
CHECKED: _____
NO. _____

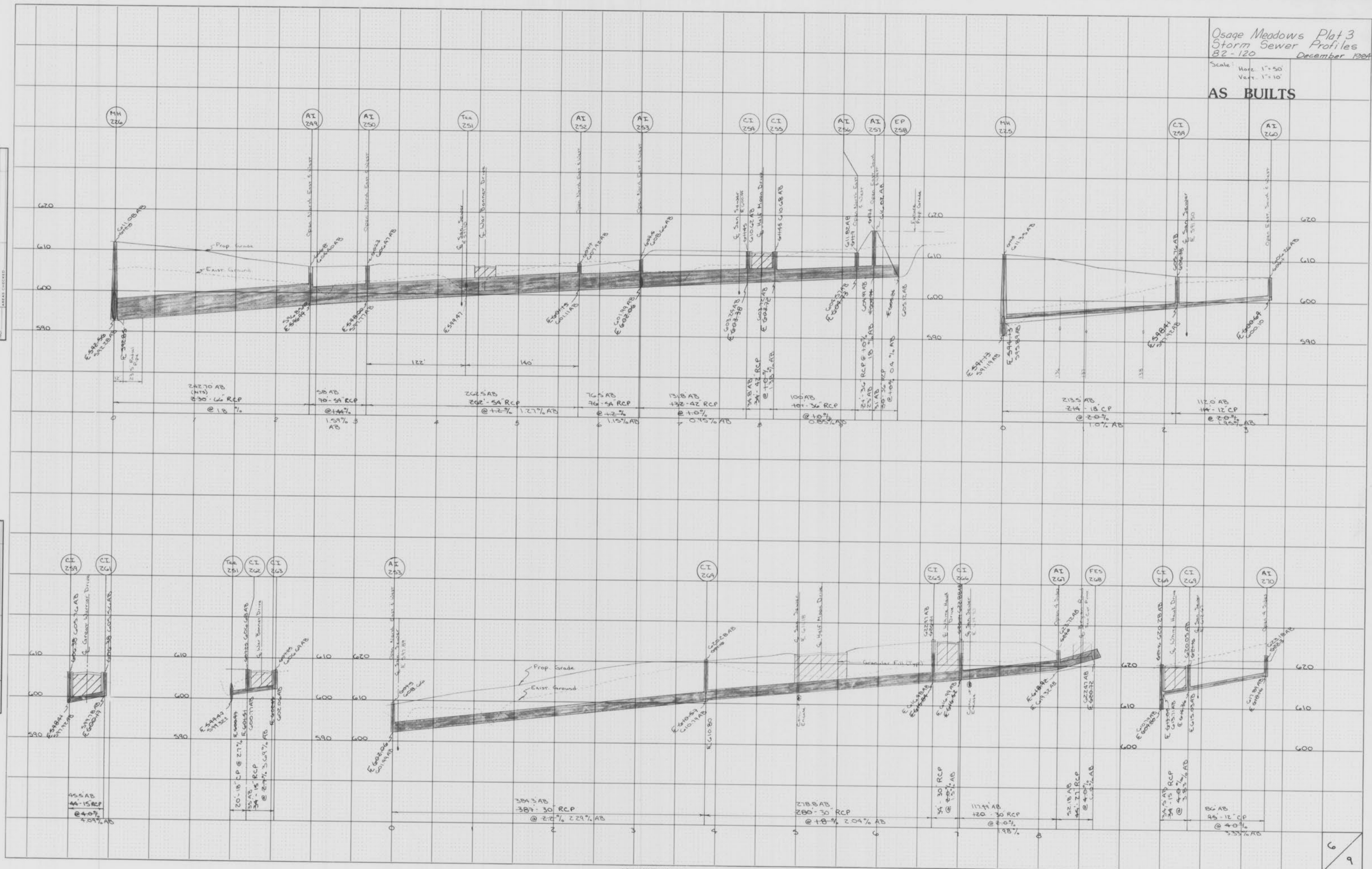

PLATE 3-FULL CROSS SECTION LINE & DOT
PRINTED IN U.S.A.

PROPERTY OF
CITY OF FALLON
BUILDING DEPARTMENT

OSAGE MEADOWS PLAT 3
STORM SEWER PROFILES
AS BUILTS

Scale:
Hort. 1" = 50'
Vert. 1" = 10'

AS BUILTS

NOTES:
All MH Tops set at 0.2' above prop. grade.
Use only compacted, crushed clean limestone for backfill over pipe.
MH exteriors shall be waterproofed with a minimum of 31 mils of coal tar pitch or approved equal.

FINAL SURVEY DRAWING
DATE REVISION
NO.

ORIGINAL SURVEY DRAWING
DATE REVISION
NO.

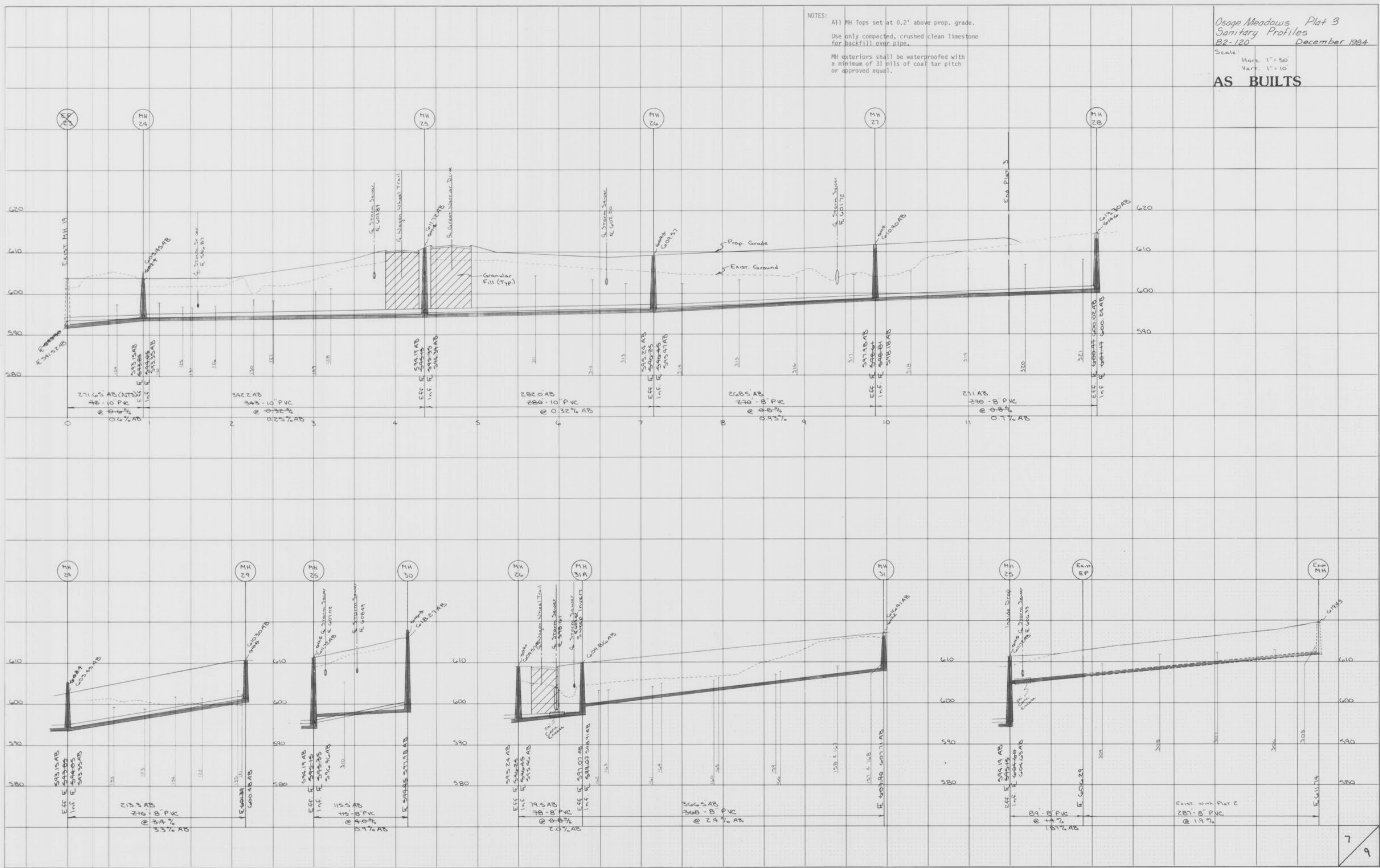

HIGHWAY FEDERAL AID SHEET
PLATE 3-FULL CROSS SECTION LINE & DOT
TELEPHONE
PRINTED IN U.S.A.

PROPERTY OF
CITY OF FALLON
BUILDING DEPARTMENT

OSAGE MEADOWS PLAT 3
Sanitary Profiles
AS BUILTS

7
9

FINAL SURVEY
 DATE: _____ BY: _____
 PLANNED: _____
 PLOTTED: _____
 TEMPLATE: _____
 NOTE BOOK: _____
 NO. _____
 AREAS CHECKED: _____

ORIGINAL SURVEY
 DATE: _____ BY: _____
 PLANNED: _____
 PLOTTED: _____
 TEMPLATE: _____
 NOTE BOOK: _____
 NO. _____
 AREAS CHECKED: _____

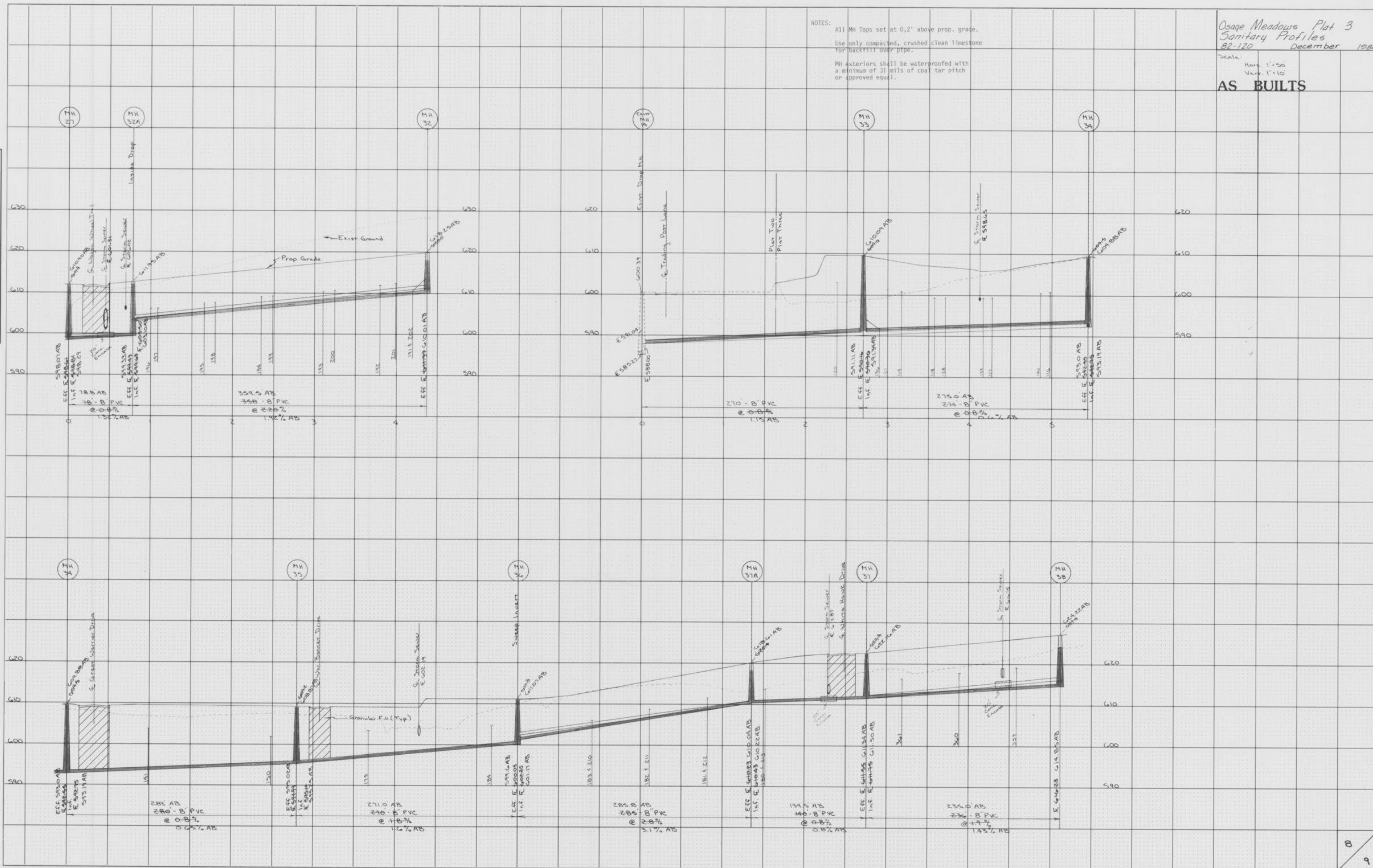

NOTES:
 All MH Tops set at 0.2' above prop. grade.
 Use only compacted, crushed clean limestone for backfill over pipe.
 MH exteriors shall be waterproofed with a minimum of 31 mils of coal tar pitch or approved equal.

Osage Meadows Plat 3
 Sanitary Profiles
 82-120 December 1984
 Scale: Horiz. 1"=50'
 Vert. 1"=10'
AS BUILTS

HIGHWAY FEDERAL AID SHEET
 PLATE 3-FULL CROSS SECTION LINE & DOT
 WYLLIAMS
 PRINTED IN U.S.A.

