

AS-BUILTS PARKSIDE VILLAS

A TRACT OF LAND BEING PART OF THE SOUTHWEST 1/4 OF
THE NORTHWEST FRACTIONAL 1/4 OF SECTION 22
TOWNSHIP 41 NORTH, RANGE 3 EAST
ST. CHARLES COUNTY, MISSOURI

PROPERTY N/F
CITY OF FALLON



Legend

- Sewer structure (as-built)
- Storm sewer structure (design)
- Sanitary sewer structure (design)
- Storm sewer alignment (as-built)
- Storm sewer alignment (design)
- Sanitary sewer alignment (as-built)
- Sanitary sewer alignment (design)

INDEX

- 1 COVER SHEET/FLAT PLAN
- 2 SANITARY SEWER PROFILES
- 3 STORM SEWER PROFILES

The responsibility for professional Land Surveying liability on this project is hereby limited to the set of "As-Built" plans authenticated by the seal, signature and date hereunder. Responsibility is disclaimed for all other plans in this project.

Fred Velogram 3-29-99
FRED VELOGRAM
MISSOURI REG. L.S. #2073



DATE:	NO.:	REVISION:		
MUSLER ENGINEERING COMPANY				
CIVIL ENGINEERING - PLANNING - LAND SURVEYING				
32 Port West Court, ST. Charles, Missouri 63303				
Telephone: (314) 916-0444				
DATE:	DRAWN:	CHECKED:	PROJECT NO.:	SHEET NO.:
MAR99	HFV	FRV	96-25702	103

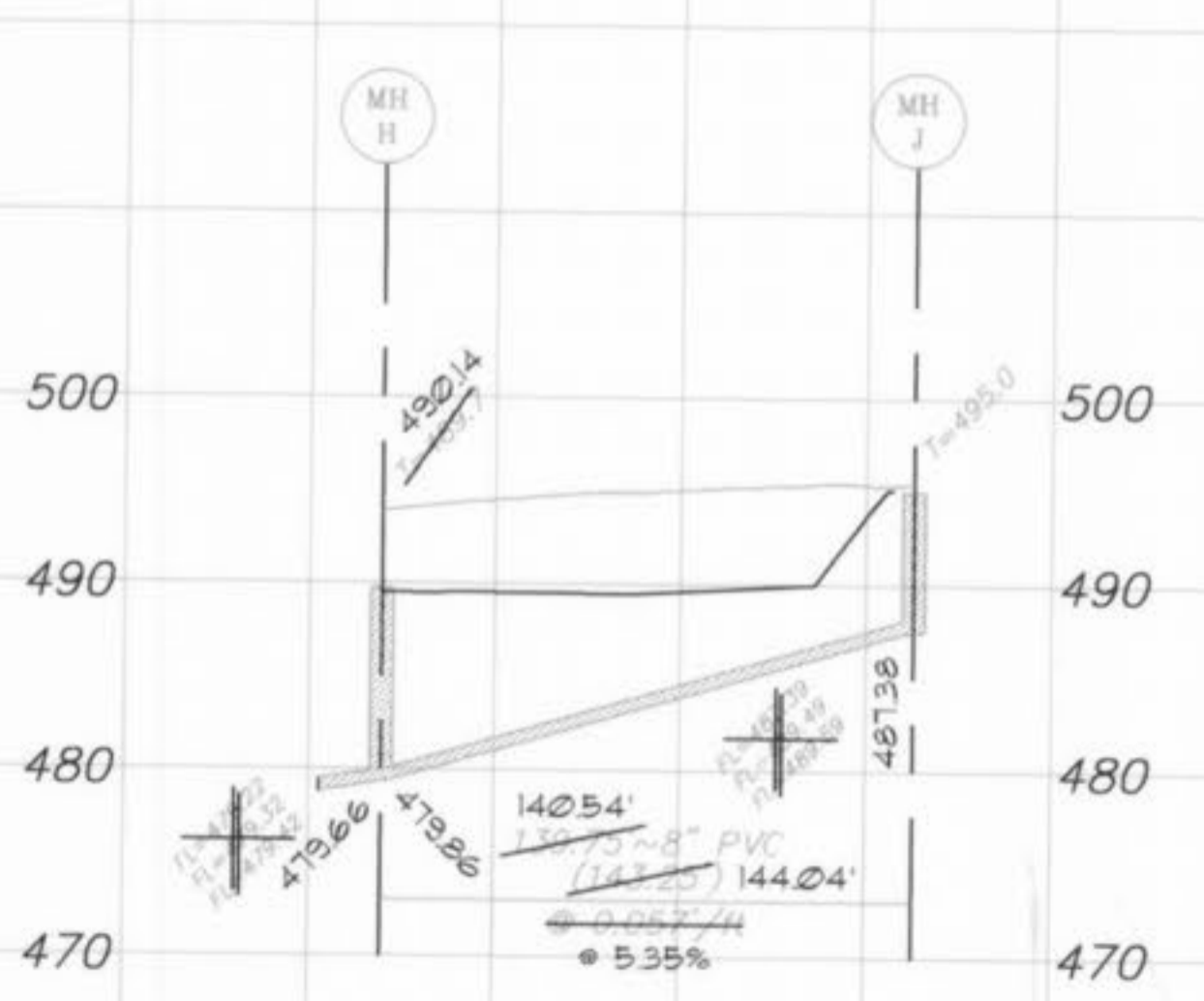
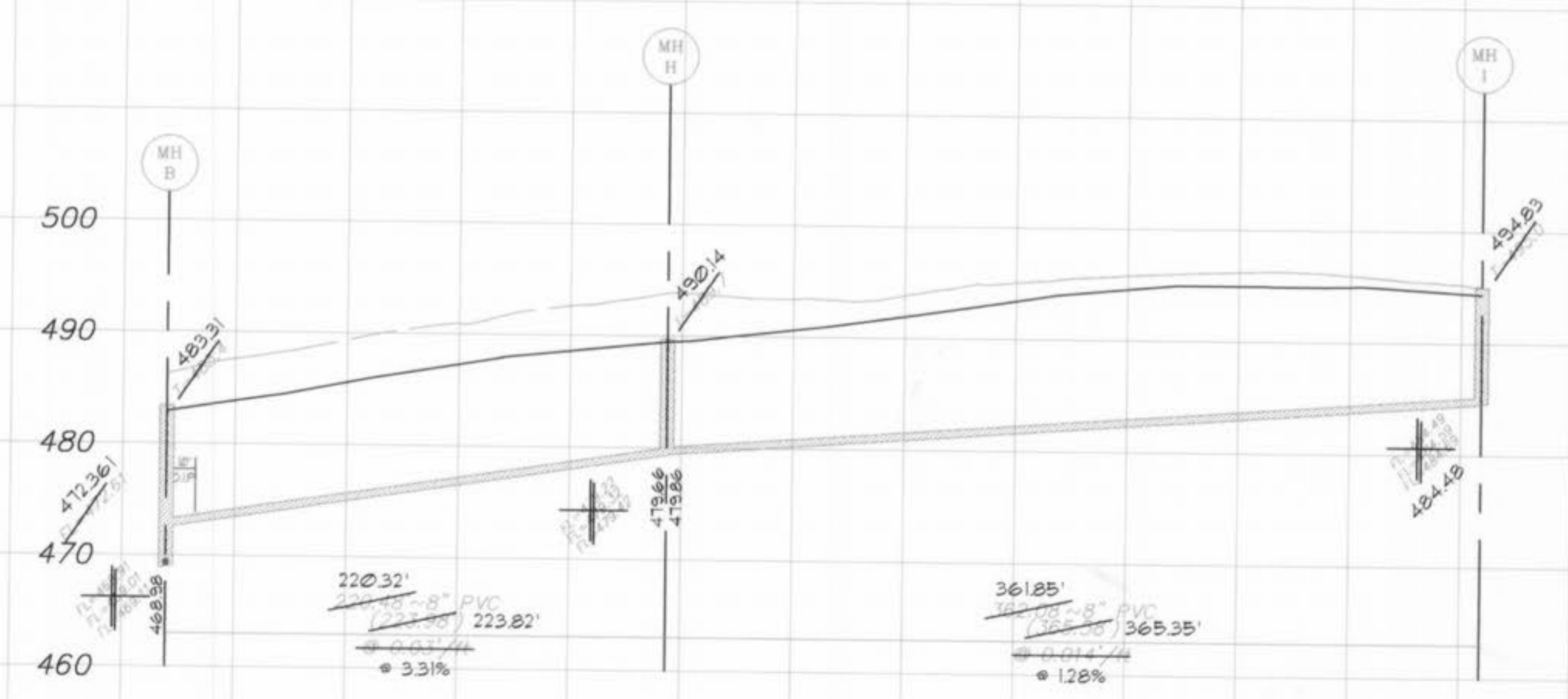
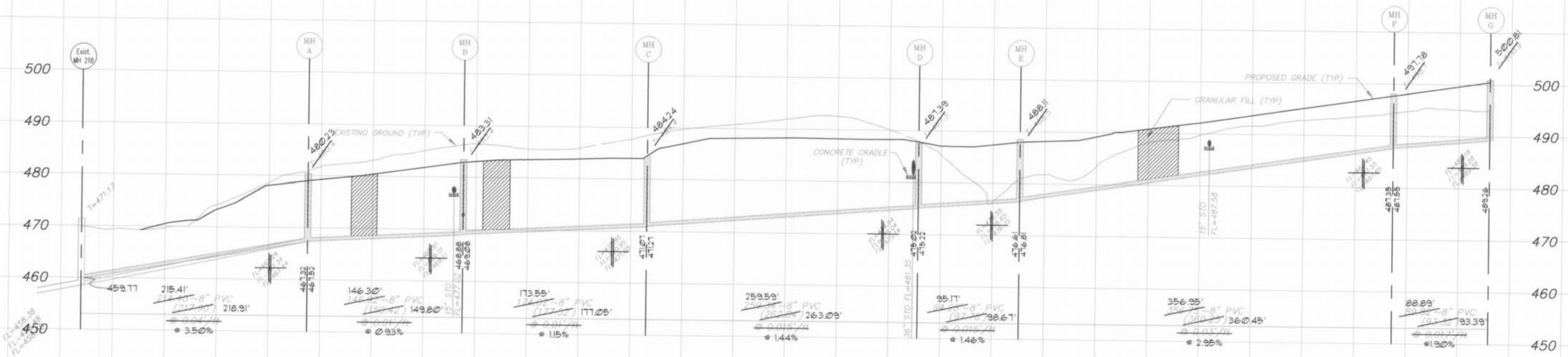

The responsibility for professional Land Surveying liability on this project is hereby limited to the set of "As-Built" plans authenticated by the seal, signature and date hereunder. Responsibility is disclaimed for all other plans in this project.

Fred Velgram
 FRED VELGRAM
 MISSOURI REG. L.S. #2073 3-29-99

Horizontal Scale: 1"=50'
 Vertical Scale: 1"=10'

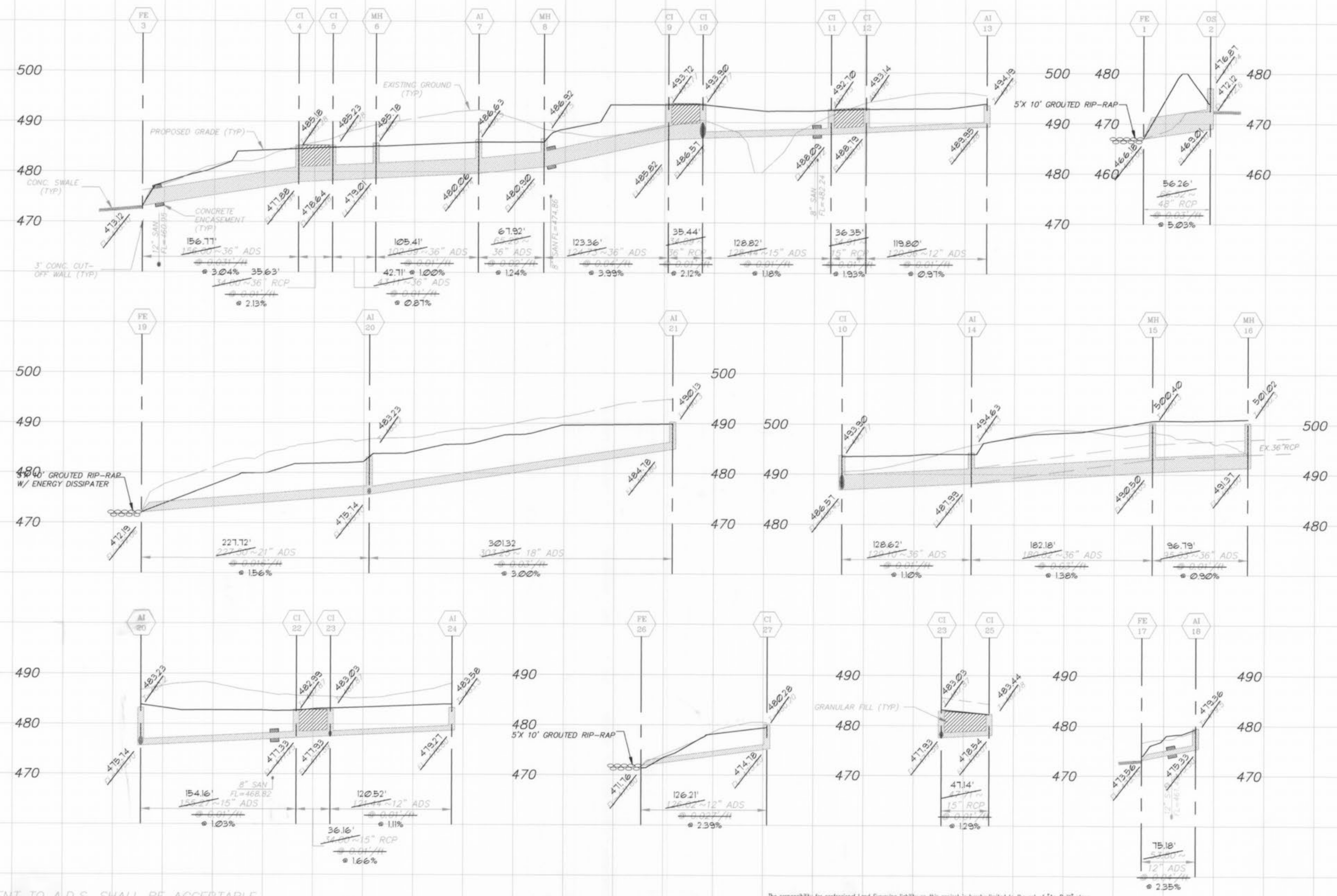

NOTE:
 AN EQUIVALENT TO A.D.S. SHALL BE ACCEPTABLE
 WHENEVER A.D.S. IS PERMITTED.

NOTE:
 ALL STORM SEWERS SHALL HAVE POSITIVE DRAINAGE
 THROUGH MANHOLES. NO FLAT BASE STRUCTURES ARE ALLOWED.

The responsibility for professional Land Surveying liability on this project is hereby limited to the set of "As-Built" plans
 authenticated by the seal, signature and date hereunder. Responsibility is disclaimed for all other plans in this project.

FRED WILGRAM
 MISSOURI REG. L.S. #2073
 3-27-99

Horizontal Scale: 1"=50'
 Vertical Scale: 1"=10'