

# WINGHAVEN™

## WINGHAVEN™ RESIDENTIAL L.L.C. CHESTNUT HILLS & PERSIMMON HILL VILLAGES SANITARY SEWER AS-BUILTS

The existing sewer lengths, sizes, flowlines, depths of structures and sewers and locations with respect to existing or proposed easements have been measured. The results of those measurements are shown on this set of Final Measurement Plans. Since the wye locations have been plotted from information provided by the sewer contractor or other sources, I disclaim any responsibility for that specific information.

All public sewers are located within designated existing or proposed easements except as shown in this drawing.

The results of those measurements are shown on this drawing by lining out the planned number and indicating the measured number adjacent to the planned number. All other numbers shown have not been measured or verified.

The location of the sewers were determined by locating the manholes and traversing in a straight line between them.

No hydraulic computations have been done on the measured lines to verify or confirm the capacity, freeboard or design requirements of the sewers.

1-21-00  
ROGER G. ALLEN  
REGISTERED PROFESSIONAL ENGINEER  
NUMBER LS-2185  
*Roger G. Allen*  
ROGER G. ALLEN  
MO. REG. L.S. NO. 2185



**VOLZ**

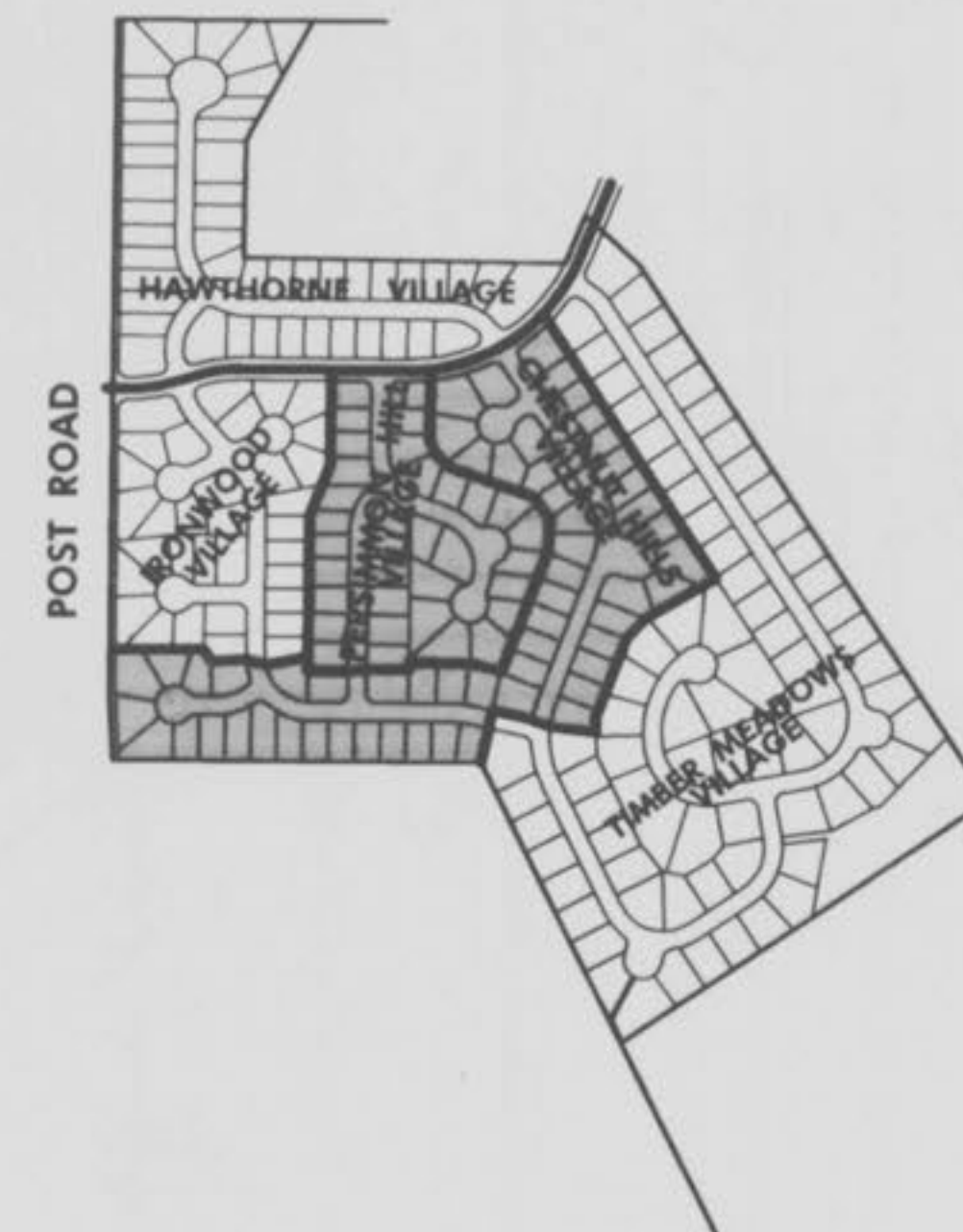





**WINGHAVEN**  
 RESIDENTIAL L.L.C.  
 111 W. BRIDGE & SON  
 CORPORATE CENTER DRIVE  
 ST. LOUIS, MISSOURI 63005  
 PHONE (314) 413-3377-2000



# WINGHAVEN

SEVATILIA HILL VILLAGES & PERSIMMON HILL  
 CHESTNUT HILLS & STILLMEADOWS VILLAGES

**SITE PLAN**

Drawn By: G.A.S.  
 5000  
 9-10-99  
 2

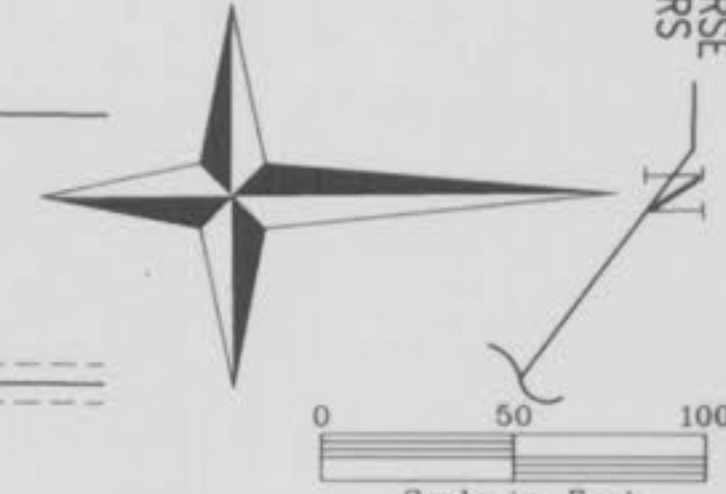

This Site Has no areas within the 100 Year Flood Plain per FIRM Map No. 29183C0220 E

STORMWATER DETENTION FOR WINGHAVEN WILL BE PROVIDED IN SEVERAL DETENTION PONDS WITHIN THE DEVELOPMENT. VOLZ, INC. IS PREPARING A DETENTION STUDY FOR ALL OF WINGHAVEN WHICH WILL SHOW HOW DETENTION IS PROVIDED FOR EACH PHASE OF THE DEVELOPMENT.

SEWER AS-BUILTS

Parsimmon Hill





Scale in Feet  
1" = 50'

POST ROAD (30'W) POST ROAD (30'W)

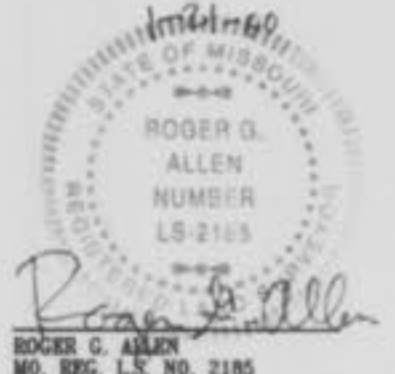
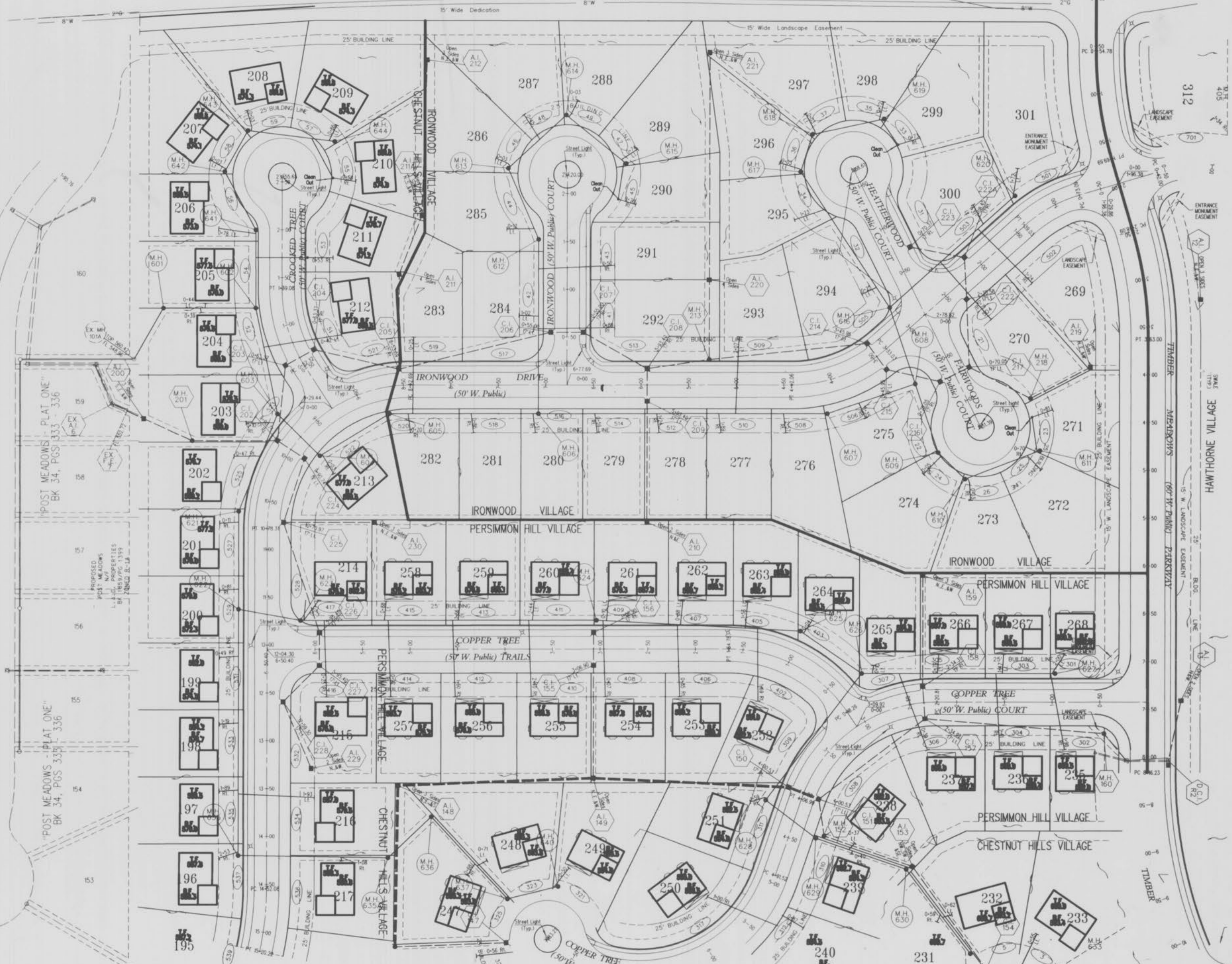

SEWER AS-BUILTS

**WINGHAVEN**  
RESIDENTIAL L.L.C.  
\*MCGIBBE & SON  
CORPORATE CENTER DRIVE  
ST. LOUIS, MO 63103  
PHONE (314) 537-2000

**VOLZ**

**WINGHAVEN™**  
CHESTNUT HILLS & PERSIMMON HILL VILLAGES

**SITE PLAN**

Design By: R.L.M.  
Drawn By: G.A.S.  
Checked By: E.A.K.

5500

8-20-99

3

Persimmon Hill



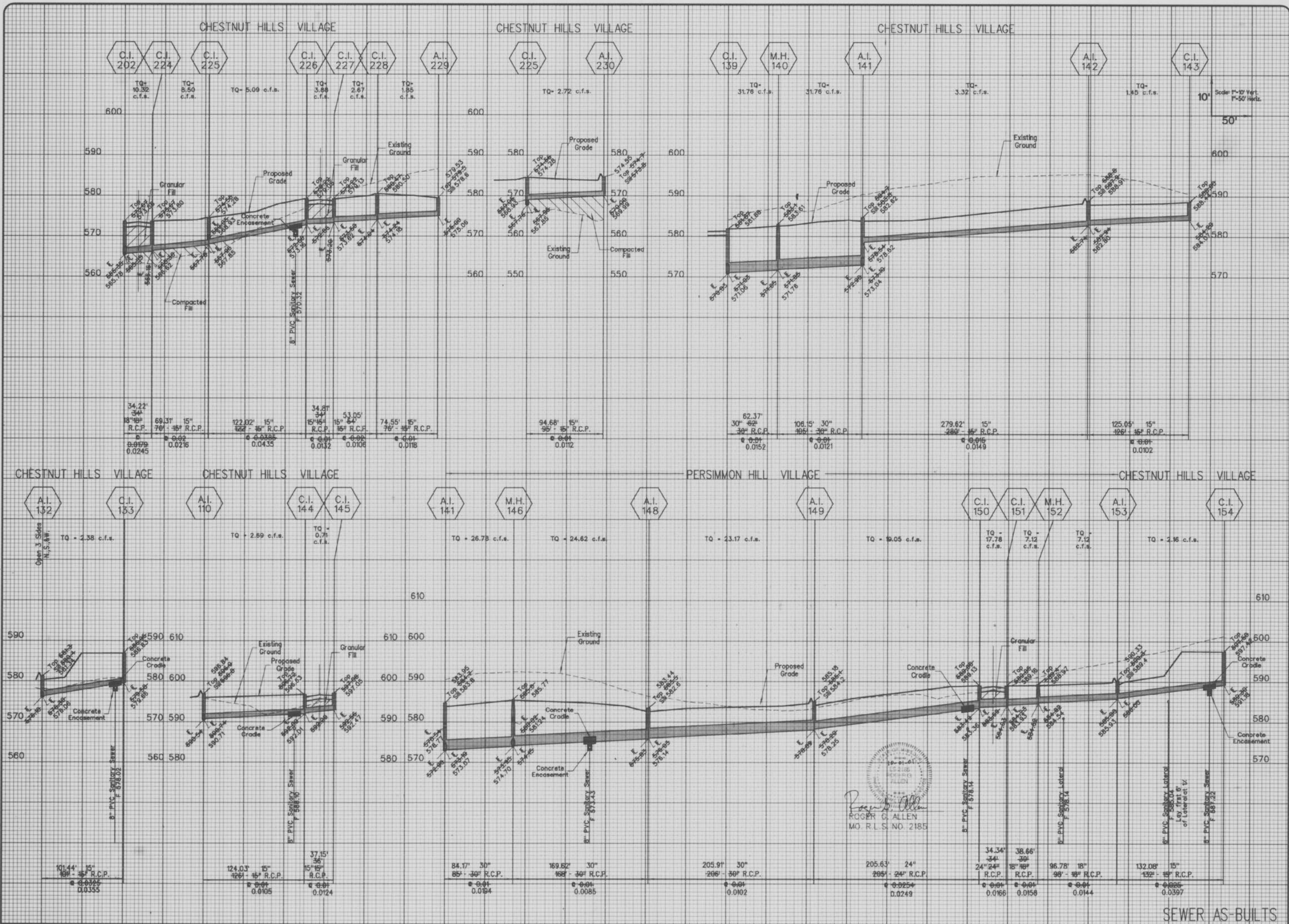

WINGHAVEN  
RESIDENTIAL L.L.C.  
11 MCBRIDE & SON  
CORPORATE CENTER DRIVE  
ST. LOUIS, MISSOURI 63105  
PHONE (314) 537-2000

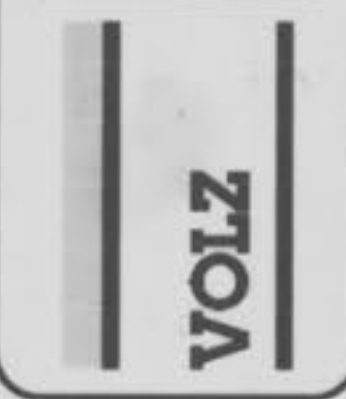

WINGHAVEN™  
CHESTNUT HILLS VILLAGE

STORM SEWER PROFILES  
Design By: G.A.S.  
Drawn By: G.A.S.  
Checked By: E.A.K.  
5000  
9-24-01  
6A



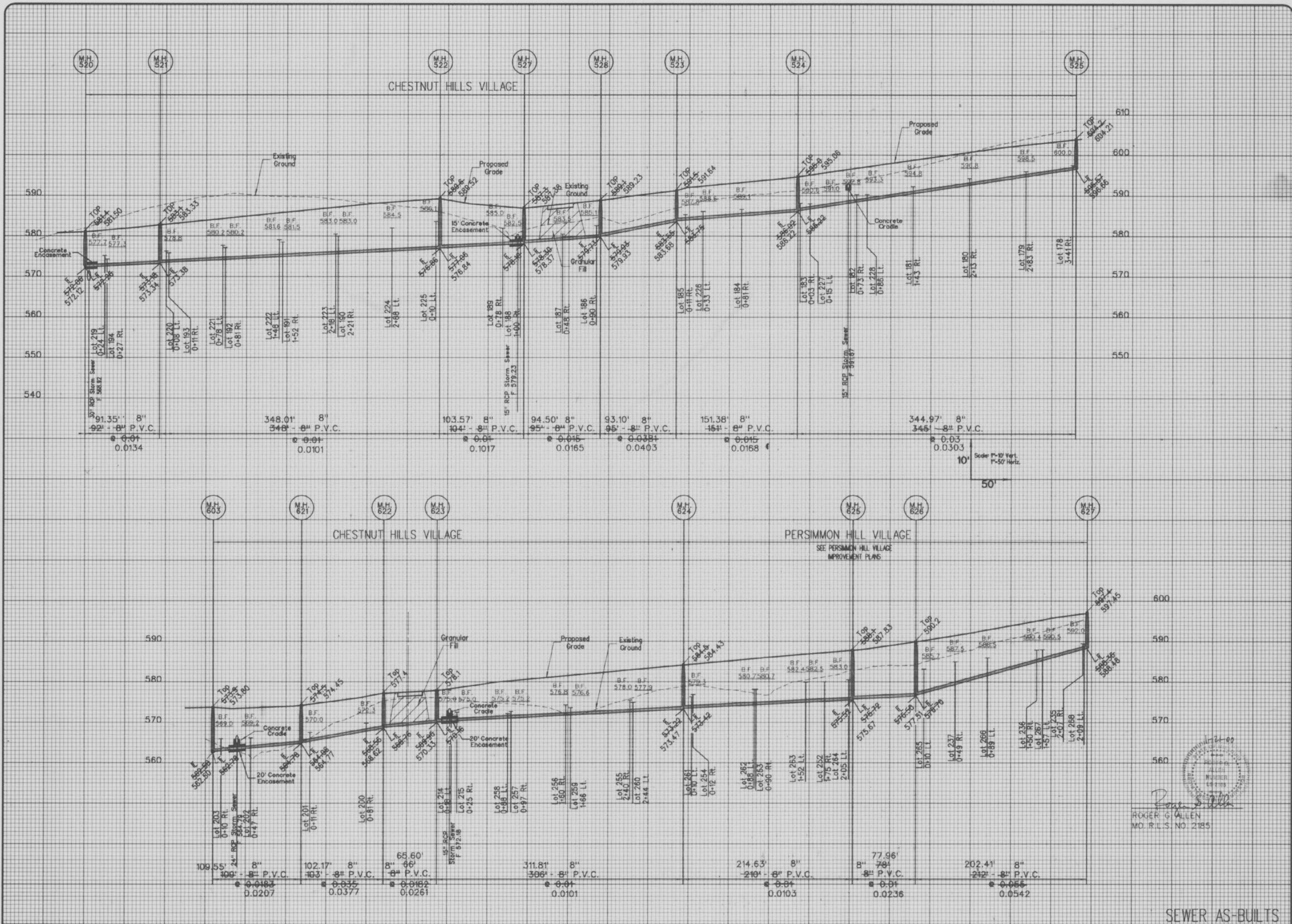

B5500\PHASE2\IRONWOOD\SANITARY.DGN

**WINGHAVEN**  
RESIDENTIAL L.L.C.  
1146 BRUCE A. SON  
CORPORATE CENTER DRIVE  
ST. LOUIS, MISSOURI 63005  
PHONE (314) 537-2000

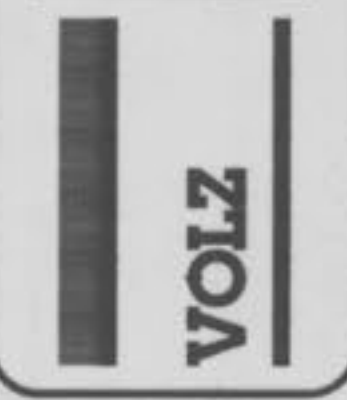

**WINGHAVEN™**  
CHESTNUT HILLS & PERSIMMON HILL VILLAGES

ROGER G. ALLEN  
MO. R.L.S. NO. 2185

**SANITARY SEWER PROFILES**  
Design By: G.A.S.  
Drawn By: G.A.S.  
Checked By: E.A.K.  
5000  
9-10-99  
9



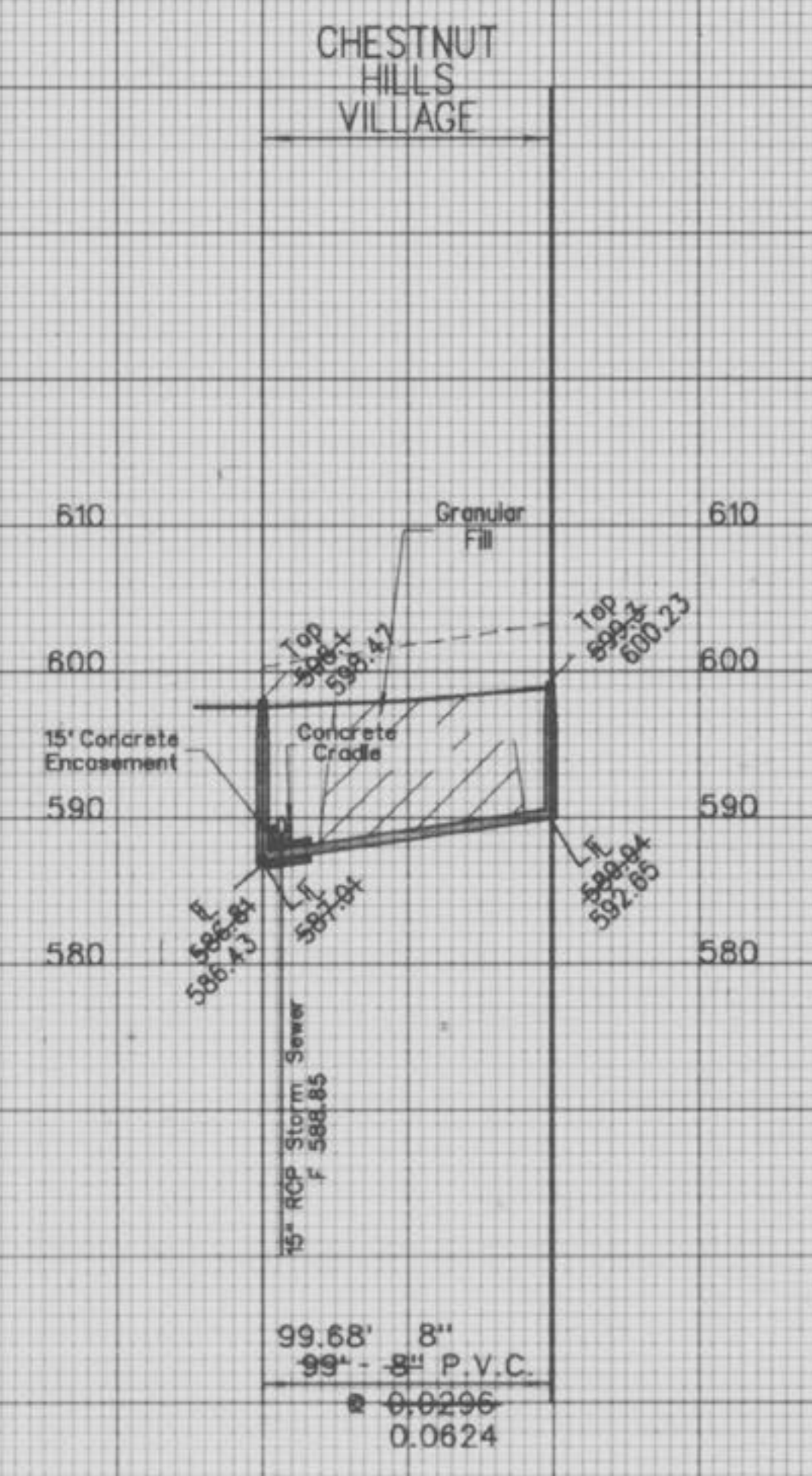
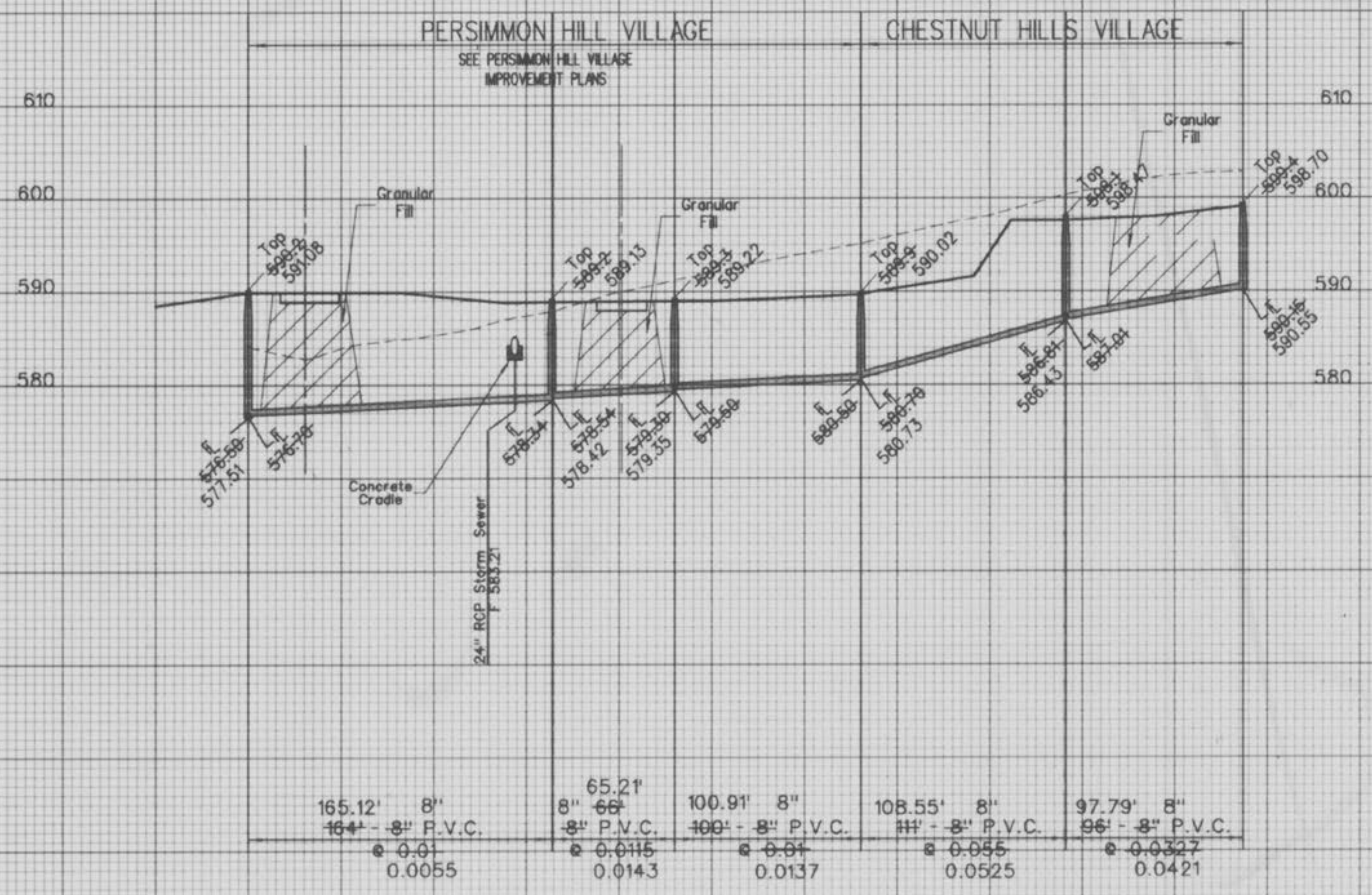

10' Scale P-10 Vert.  
P-50 Horiz.  
50'

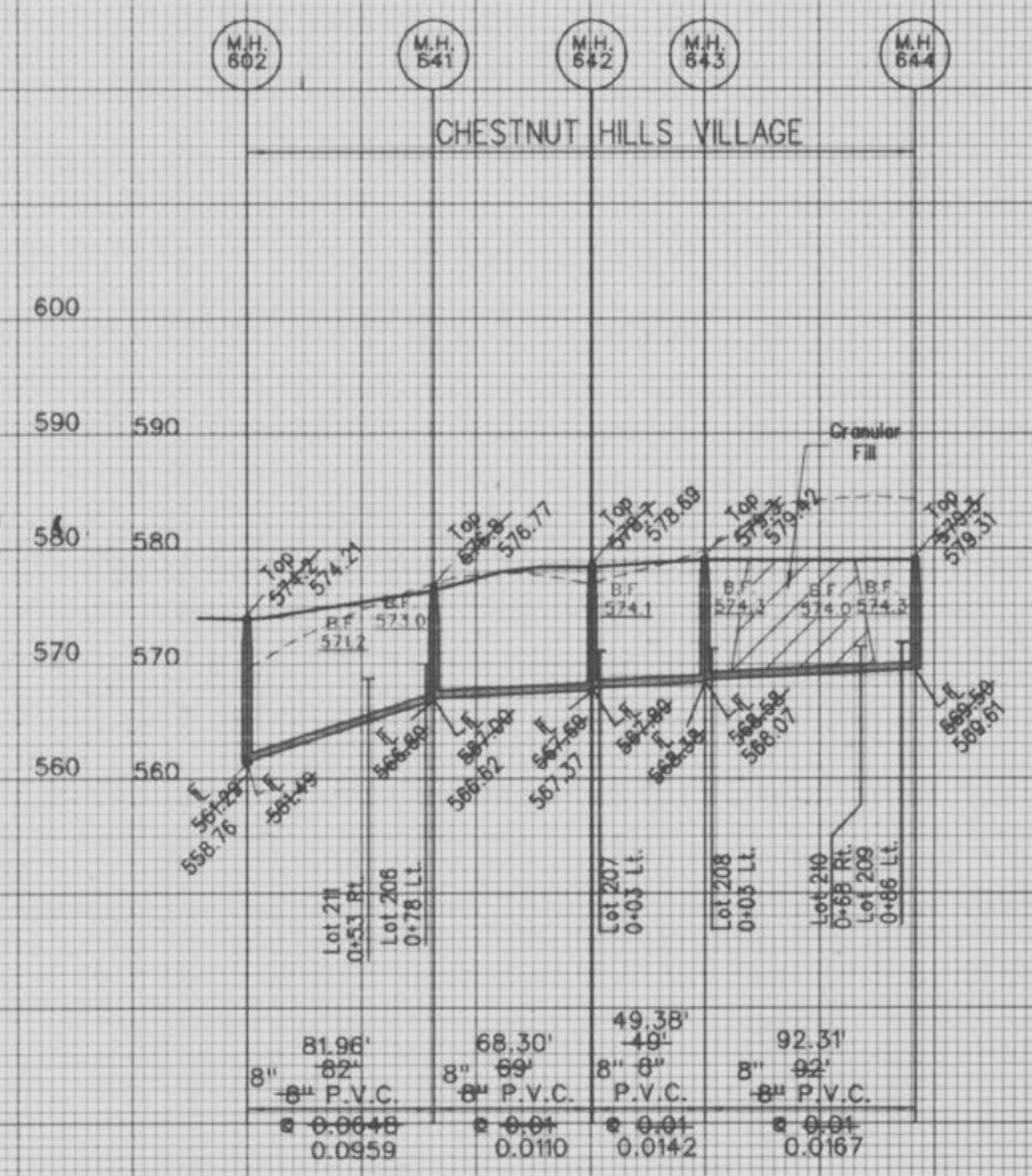
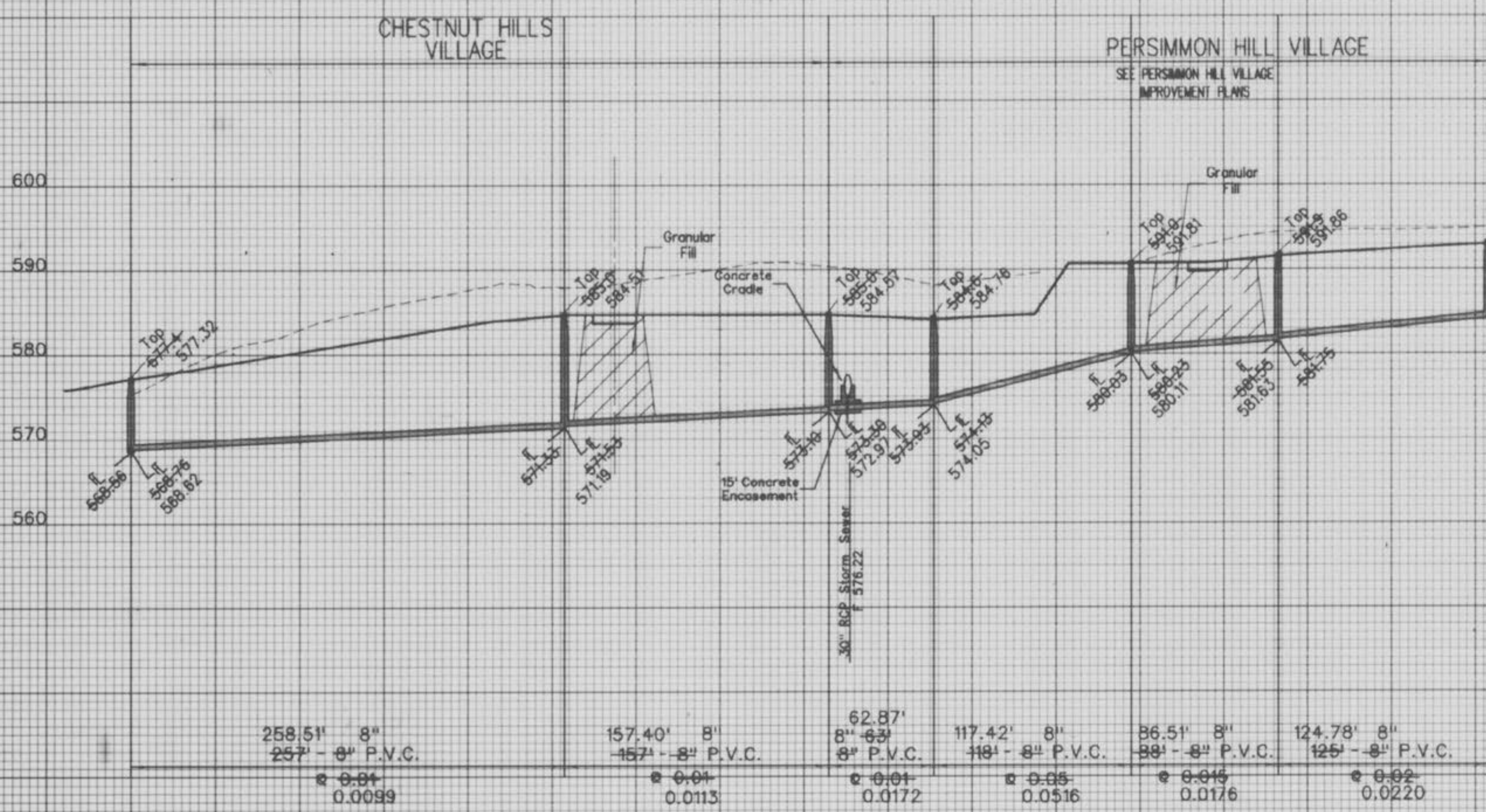

SEWER AS-BUILTS

WINGHAVEN  
RESIDENTIAL, L.L.C.  
\*MURPHY & SON  
CORPORATE CENTER DRIVE  
ST. LOUIS, MISSOURI 63005  
PHONE (314) 537-2000

**VOLZ**



**WINGHAVEN™**  
CHESTNUT HILLS & PERSIMMON HILL VILLAGES

SANITARY SEWER PROFILES

Design By: G.A.S.  
Drawn By: G.A.S.  
Checked By: E.A.K.

5000

9-10-99  
10



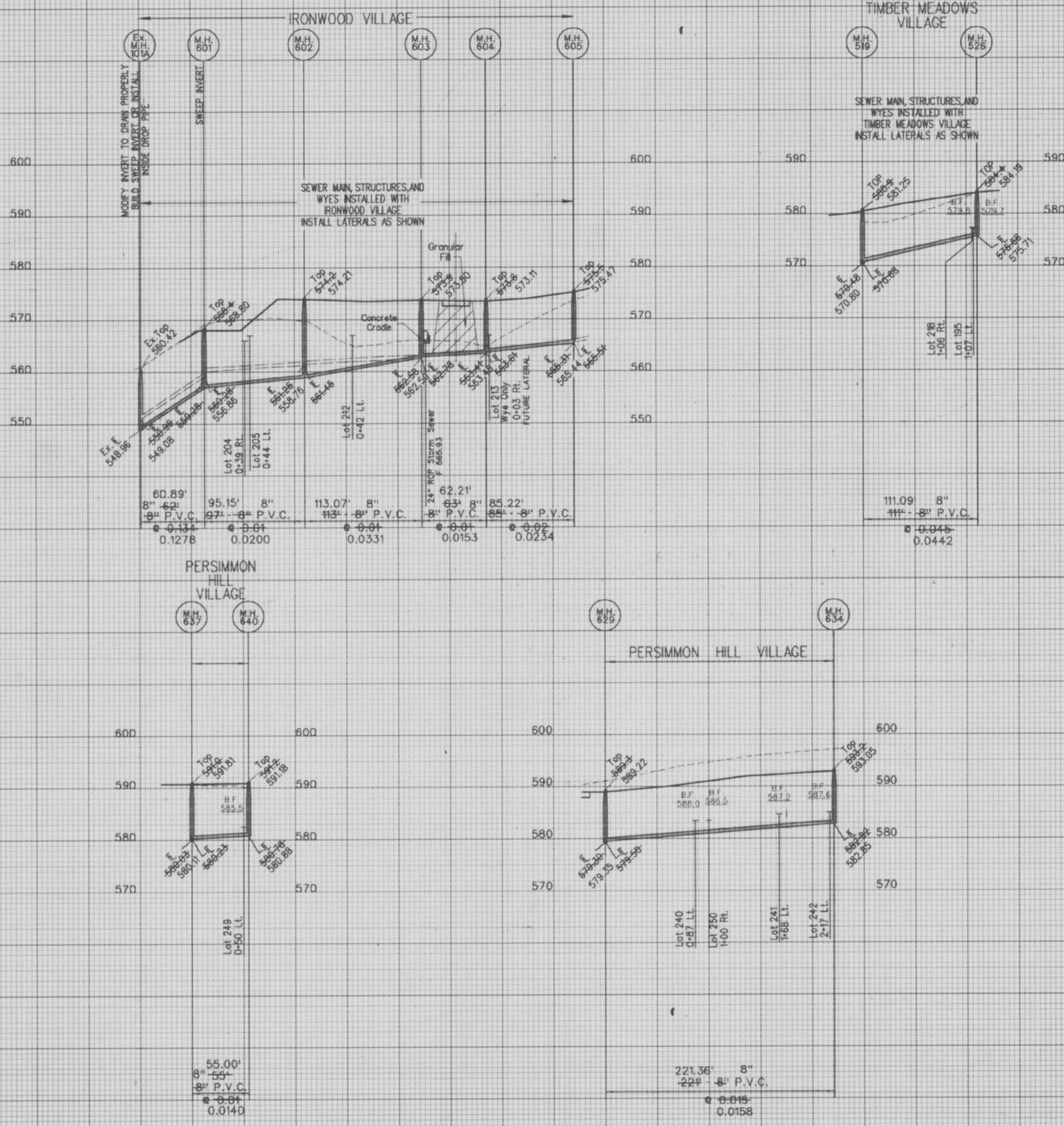

10' Scale  
 P=10' Vert.  
 H=50' Horiz.

Professional Engineer  
 Roger S. Allen  
 M.O. R.E. NO. 2185  
 ROGER S. ALLEN

SEWER AS-BUILTS

WINGHAVEN  
 RESIDENTIAL L.L.C.  
 \*1 MCBRIDE & SON  
 CORPORATE CENTER DRIVE  
 ST. LOUIS, MISSOURI 63005  
 PHONE (314) 537-2000

**VOLZ**

WINGHAVEN™  
 CHESTNUT HILLS & PERSIMMON HILL VILLAGES

SANITARY SEWER PROFILES  
 Design By: G.A.S.  
 Drawn By: G.A.S.  
 Checked By: E.A.K.  
 5000  
 8-20-99  
 11