



203 BLDG  
209 BLDG

OAKS ONE  
OAKS 33  
OAKS 34

184 Spring Orchard Plat 1  
Slope AS BUILT

A topographical survey was performed on this slope on October 25th, 2005 and the results of said survey are shown above.

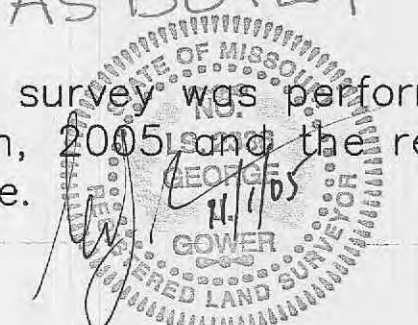

MORGAN OAKS  
PLAT TWO  
P.B.26

STA. 1+52.78  
TIE PAVT. INTO EXIST.  
MATCH HORIZ. & VERT.

1" = 20'