

Plan View

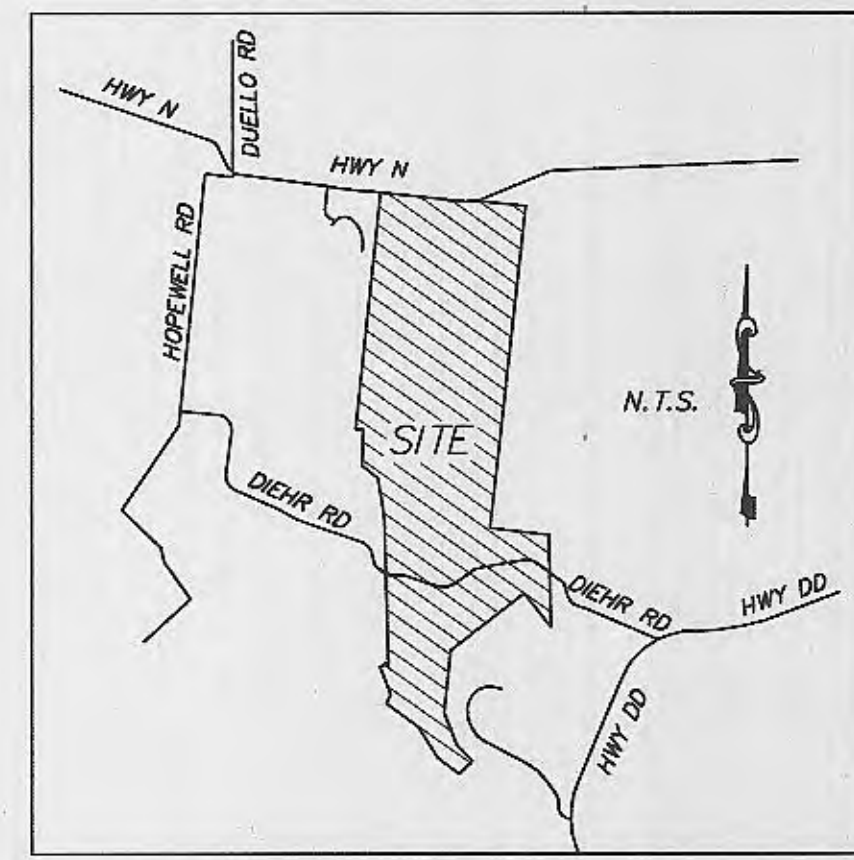

Locator Map

A SET OF CONSTRUCTION PLANS FOR Wyndgate Village B Plat Three

TRACTS OF LAND BEING PART OF FRACTIONAL
SECTIONS 16 & 17, AND U.S. SURVEYS 61 & 417,
TOWNSHIP 46 NORTH, RANGE 2 EAST,
ST. CHARLES COUNTY, MISSOURI

AS-BUILTS Wyndgate Village B Plat Three-A

DCSD PHASE 1

~~9-13-13~~

11-22-13

Utility Contacts

Sanitary Sewers
Duckett Creek Sanitary District
3550 Highway K
O'Fallon, MO. 63368
636-441-1244

Water
Public Water Supply District No. 2
P.O. Box 967
O'Fallon, MO. 63366
636-561-3737 Ext. 131

Storm Sewer
City of O'Fallon
100 N. Main St.
O'Fallon, MO. 63366
636-281-2858

Electric
Cuivre River Electric Co.
P.O. Box 160
Troy, MO. 63379-0160
1-800-392-3709

Gas
Laclede Gas Company
6400 Graham Road
St. Louis, MO. 63134
314-522-2297

Telephone
Century Tel
1151 Century Tel Dr.
Wentzville, MO. 63385
636-332-7261

Fire Protection
Wentzville Fire District
209 West Pearce Blvd.
Wentzville, MO. 63385

PROJECT TITLE

WYNDGATE VILLAGE B
PLAT THREE

PICKETT, RAY & SILVER INC

CIVIL ENGINEERING, LAND SURVEYING,
AND NATURAL RESOURCES SERVICES
St. Peters
22 Richmond Center Court
St. Peters, MO 65376
Phone (636) 987-1211 Fax (636) 987-1104
www.prs.com 1-800-768-9816

ENGINEER AUTHENTICATION
THE RESPONSIBILITY FOR
PROFESSIONAL ENGINEERING LIABILITY
ON THIS PROJECT IS HEREBY LIMITED
TO THE SET OF PLANS AUTHENTICATED
BY THE SEAL, SIGNATURE, AND DATE
HEREUNDER ATTACHED. RESPONSIBILITY
IS DISCLAIMED FOR ALL OTHER
ENGINEERING PLANS INVOLVED IN THIS
PROJECT AND SPECIFICALLY EXCLUDES
REVISIONS AFTER THIS DATE UNLESS
SPECIFICALLY NOTED OTHERWISE.
PICKETT, RAY & SILVER, INC.
NO LICENSE ISSUED

DELLAS S. TOWMAN
PROFESSIONAL ENGINEER LICENSE E-23945

Developer / Owner Information
McBride Wyndgate, LLC
16091 Swingley Ridge Road, Suite 300
Chesterfield, Missouri 63077

CONTACT:
Mr. Jeremy Rort
314-338-0237 Office
314-338-0175 Fax

Plat No. 3203

City No.

Page No.

1 of 23

WyndG B3A ASB

PRS No. 01267.MCSO.02R

Drawing Index

- 1 COVER SHEET
- 2 GENERAL NOTES
- 3 SITE PLAN
- 4 GRADING PLAN
- 5 EROSION CONTROL PLAN
- 6 STREET PROFILES
- 7 SANITARY SEWER PROFILES
- 8 STORM SEWER PROFILES
- 9 DRAINAGE AREA MAP
- 10 WATER LAYOUT
- 11 LANDSCAPE PLAN
- 12-13 PAVEMENT DETAILS
- 14 STORM SEWER & SIDEWALK DETAILS
- 15-19 SANITARY SEWER DETAILS
- 20-21 WATER DETAILS
- 22-23 EROSION CONTROL DETAILS

Benchmarks

Project
U.S.G.S BENCH MARK
At Dardenne T.46N., R.2E. Near Approx. Corner
Sections 1, 2, 11 & 12. 31' north & 20' west
of crossroads, 49' south of S.E. corner of Catholic Church,
2.0' north of sidewalk & in a concrete post standard
tablet stamped "T1" 60C 1936 616".
Elev. 616.50

Site

Cut cross "+" at the centerline - centerline
intersection of Wyndgate Ridge Drive with Parkgate
Drive and Towergate Drive.
Elev. 639.91

Legend

— Sanitary Sewer (Proposed)	⊙ Sanitary Structure	R.C.P. Reinforced Concrete Pipe
⊙ Sanitary Sewer (Existing)	⊙ Storm Structure	C.M.P. Corrugated Metal Pipe
--- Storm Sewer (Proposed)	⊕ Test Hole	C.I.P. Cast Iron Pipe
--- Storm Sewer (Existing)	⊙ Power Pole	P.V.C. Polyvinyl Chloride
— Water Line & Size	⊙ Light Standard	V.C.P. Vitrified Clay Pipe
— EX W Existing water line	⊙ Double Water Meter Setting	C.O. Clean Out
⊕ Tee & Valve	⊙ Single Water Meter Setting	V.T. Vent Trap
⊕ Hydrant	C.I. Curb Inlet	T.B.R. To Be Removed
⊕ Cap	S.C.I. Skewed Curb Inlet	T.B.R.&R To Be Removed & Relocated
18 Lot or Building Number	D.C.I. Double Curb Inlet	T.B.P. To Be Protected
— Existing Fence Line	G.I. Grate Inlet	T.B.A. To Be Abandoned
— Existing Tree Line	A.I. Area Inlet	B.C. Base Of Curb
⊕ Street Sign/Stop Sign	D.A.I. Double Area Inlet	T.C. Top Of Curb
— Existing Contour	C.C. Concrete Collar	T.W. Top Of Wall
— Proposed Contour	F.E.S. Flared End Section	B.W. Base Of Wall
⊕ Rip-Rap	E.P. End Pipe	(TYP) Typical
— End of Lateral	E.D. Energy Dissipater	U.N.O. Unless Noted Otherwise
⊕ Asphalt Pavement	M.H. Manhole	U.I.P. Use in Place
⊕ Concrete Pavement	C.P. Concrete Pipe	▽ Yield Sign
— Proposed Swale	S.A.S. Sinkhole Access Structure	

These "AS-BUILT" SANITARY & STORM plans are based on actual field observations conducted during DECEMBER 2005, JULY & NOVEMBER 2013 and the results are shown hereon.

By: Stanley M. Mundwiler 1/10/14
STANLEY M. MUNDWILLER, P.L.S., #2005019226
STATE OF MISSOURI

PICKETT, RAY & SILVER'S CORPORATE
REGISTRATION NO. LS-54-D

CITY OF O'FALLON
COMMUNITY DEVELOPMENT DEPARTMENT
ACCEPTED FOR CONSTRUCTION
BY: _____ DATE _____
PROFESSIONAL ENGINEER'S SEAL
INDICATES RESPONSIBILITY FOR DESIGN