

6 ACCESSIBLE PARKING SYMBOL DETAIL
 A2.0 | A2.0 NTS

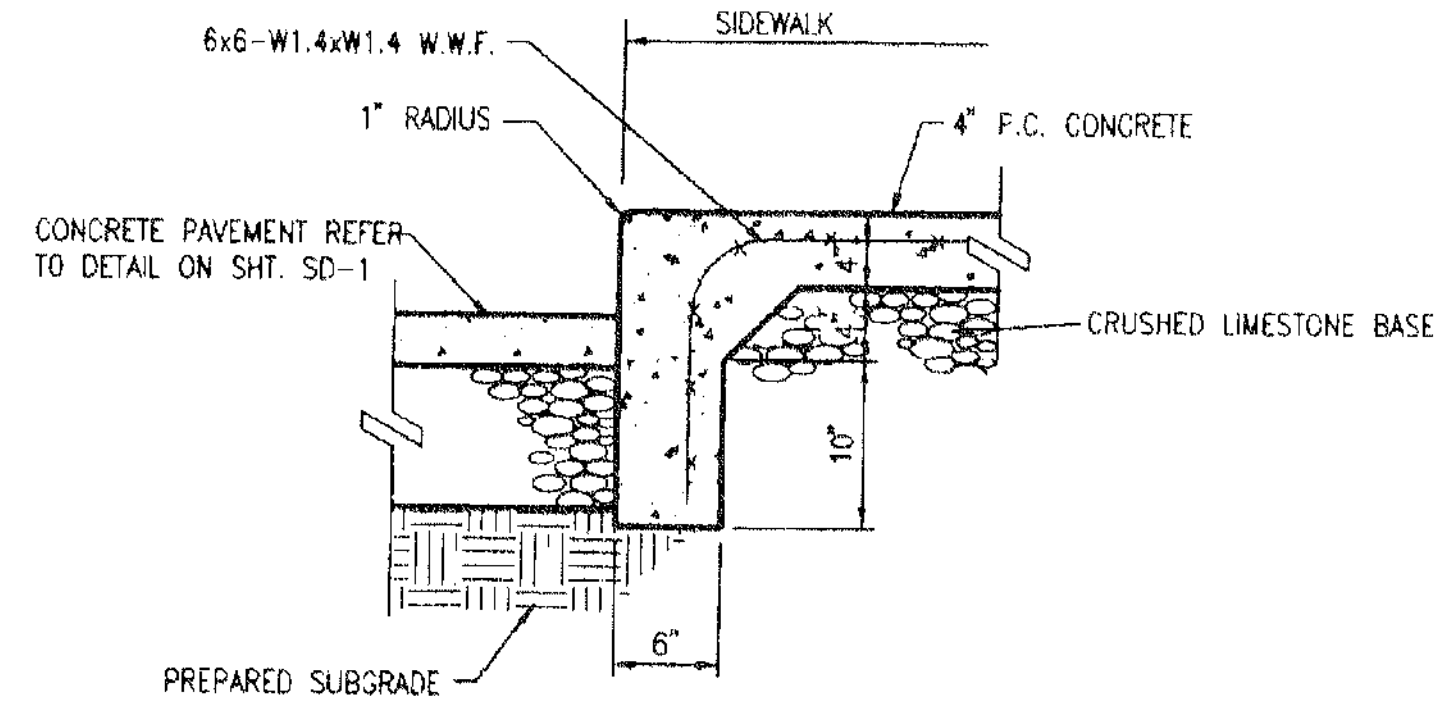

5 TURNED DOWN CONCRETE WALK DETAIL
 A2.0 | A2.0 NTS

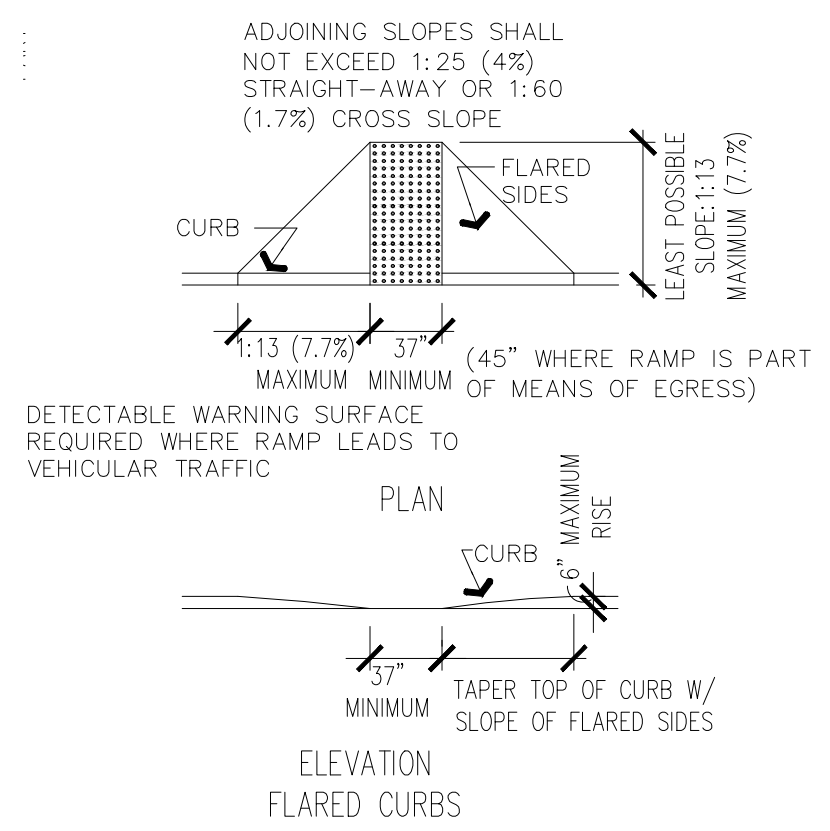

4 CURB RAMP DETAILS
 A2.0 | A2.0 SCALE: 1/2" = 1'-0"

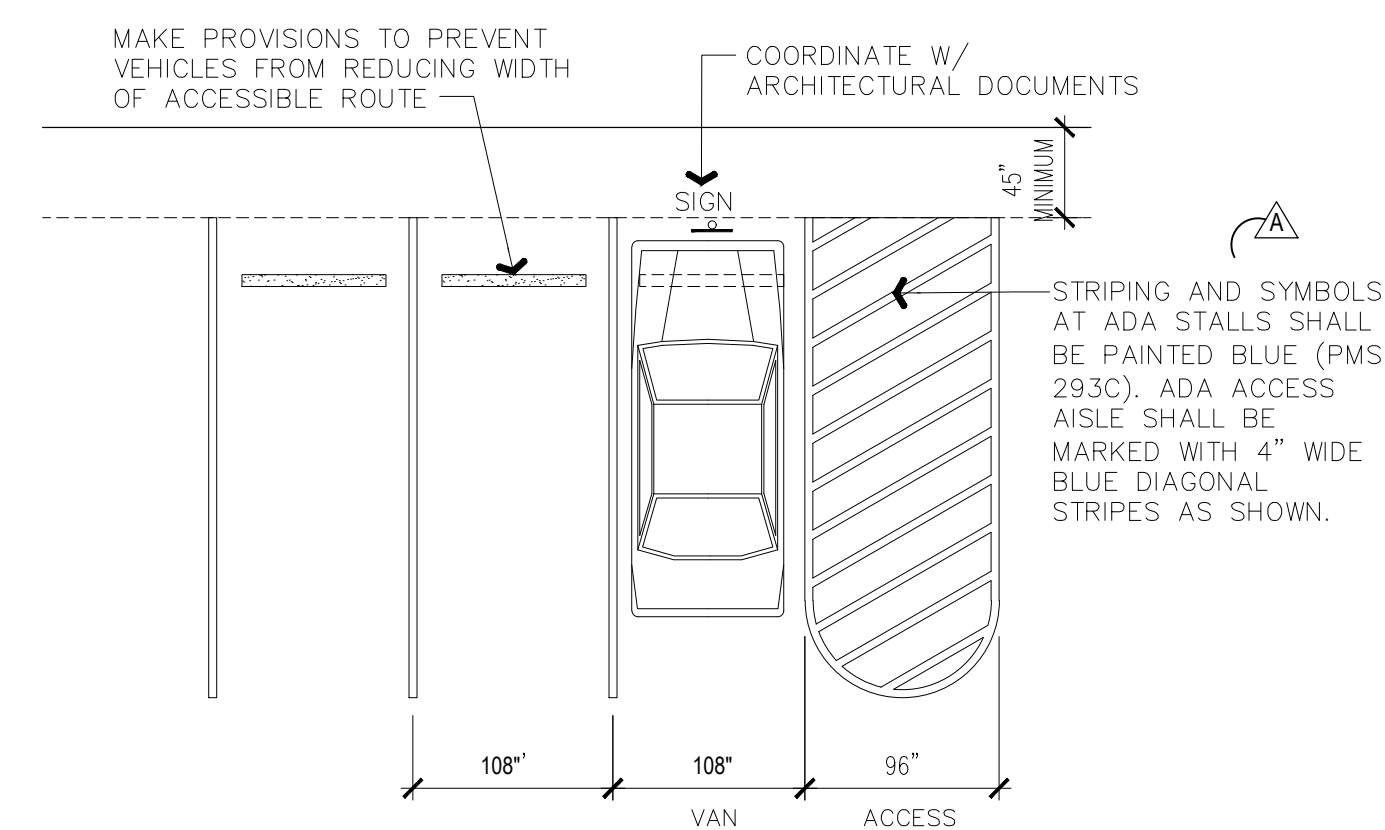

3 ACCESSIBLE PARKING DETAIL
 A2.0 | A2.0 SCALE: 1/2" = 1'-0"

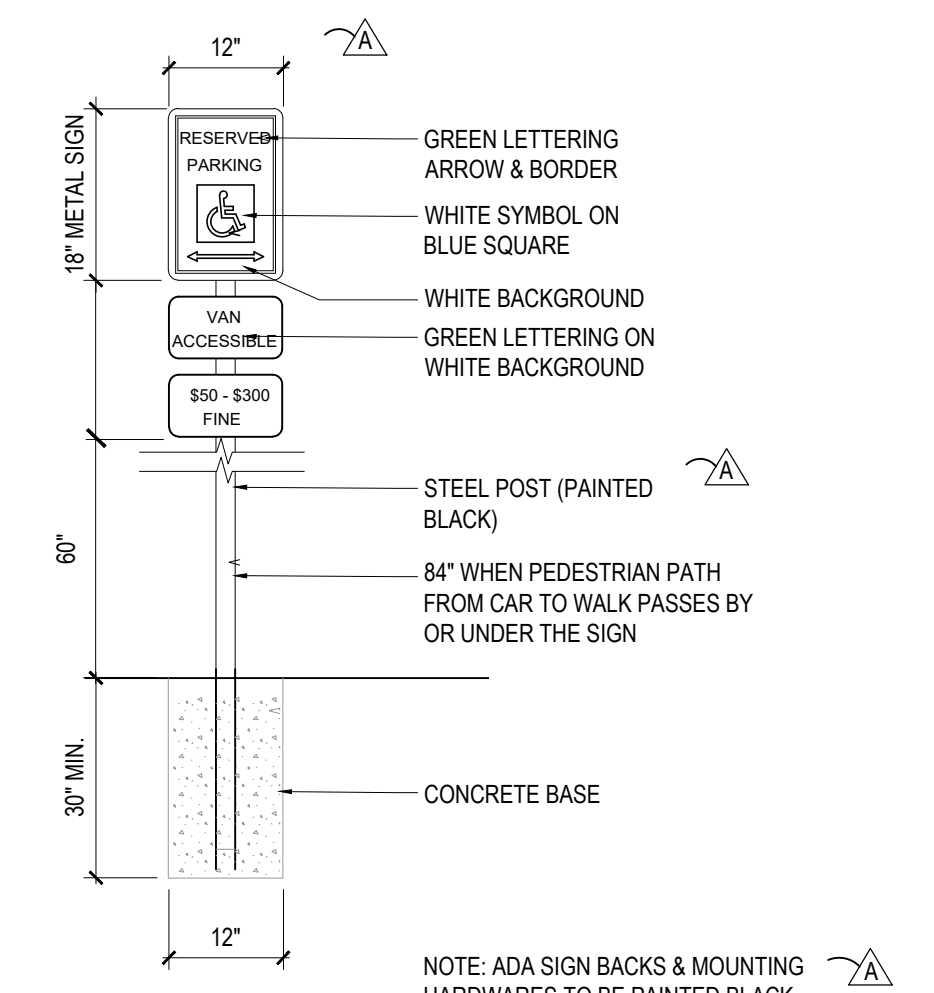

2 ACCESSIBLE PARKING SIGN DETAIL
 A2.0 | A2.0 SCALE: 1/2" = 1'-0"

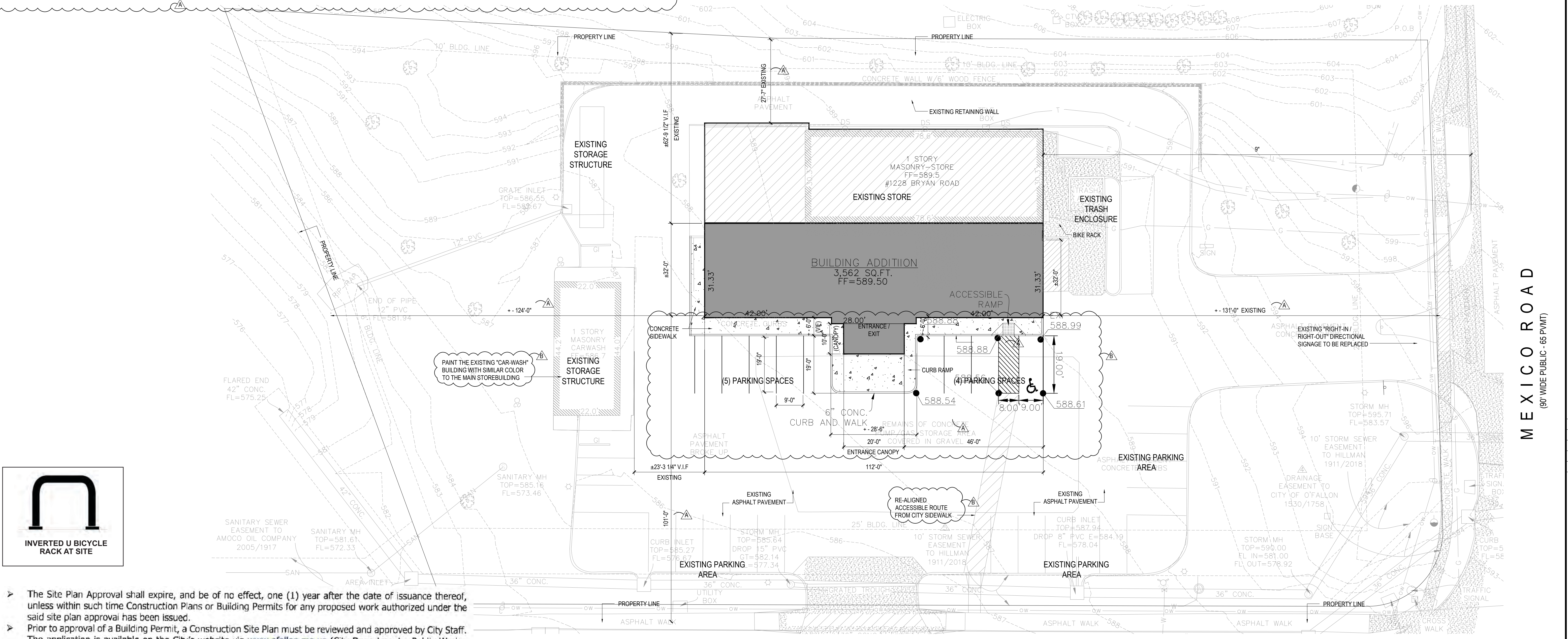

- The Site Plan Approval shall expire, and be of no effect, one (1) year after the date of issuance thereof, unless within such time Construction Plans or Building Permits for any proposed work authorized under the said site plan approval has been issued.
- Prior to approval of a Building Permit, a Construction Site Plan must be reviewed and approved by City Staff. The application is available on the City's website via www.ofallon.mo.us (City Departments, Public Works, Engineering) through the O'Fallon Permitting, Licensing, and Enforcement (OPLE) system.
- The appropriate Fire District will need to review and approve the development.
- Any signage to be placed on the subject property requires a separate Sign Permit.
- Any business occupying the site requires approval of a Business License.

LOT SIZE = (1.57 AC) 68,389 SQ. FT.
 BLDG. SQ. FT. = 6,905 SF
 LOT COVERAGE = 10%

BRYAN ROAD
 (90' WIDE PUBLIC - 65 PVMT)

NOTE:
 THE OWNER/CONTRACTOR SHALL REINSTALL ALL TRAFFIC CONTROL MARKERS AND TRAFFIC SIGNS AT THE ENTRANCE AND EXIT ON MEXICO ROAD PER THE APPROVED SITE CONSTRUCTION PLAN DATED 10-6-2013. THE OWNER SHALL BE RESPONSIBLE TO SECURE A COPY OF THE APPROVED 2013 DRAWINGS. CONTACT KARL BERT (KEBERT@OFALLONMO.US) @ 636-379-7630 TO SECURE A COPY OF THE APPROVED DRAWINGS.

1 SITE PLAN
 A2.0 | A2.0 SCALE: 1/16" = 1'-0"

MEXICO ROAD
 (80' WIDE PUBLIC - 65 PVMT)