

SITE PLAN
CONSOLIDATED LOT 1A
OF CONSOLIDATION PLAT OF WILLERDING PLAT
PLAT BOOK 38 PAGE 178
ST. CHARLES COUNTY, MISSOURI

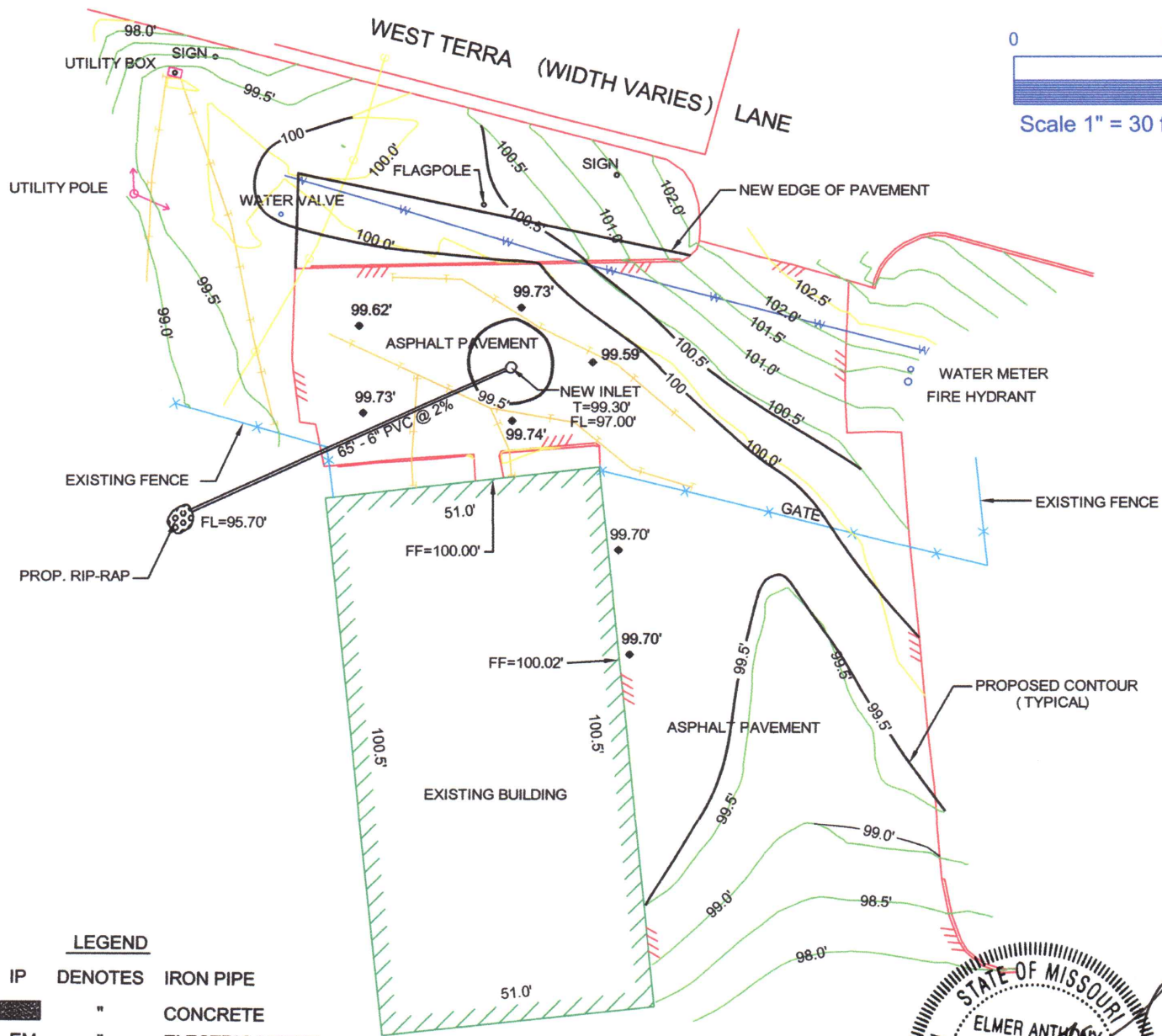

LEGEND

IP	DENOTES	IRON PIPE
	"	CONCRETE
EM	"	ELECTRIC METER
GM	"	GAS METER
R.	"	RECORD
SVY.	"	SURVEY
WM	"	WATER METER
	"	CHAINLINK FENCE
A/C	"	AIR CONDITIONER
	"	GAS LINE MARKED
	"	TELEPHONE LINE MARKED
	"	WATER LINE MARKED
	"	EDGE OF ASPHALT PAVEMENT

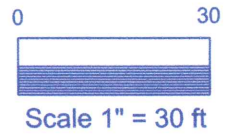
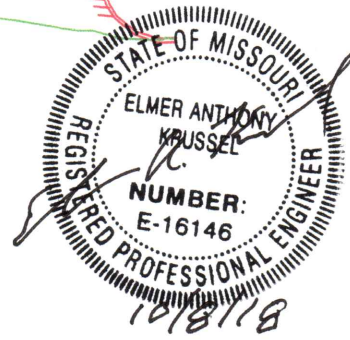

NOTE:
 ASPHALT THICKNESS TYPES: 1-1/2" TYPE C SURFACE
 + 2-1/2" TYPE X BASE = 4" TOTAL

DESCRIPTION: CONSOLIDATED LOT 1A OF CONSOLIDATION PLAT OF WILLERDING PLAT, ACCORDING TO THE PLAT THEREOF RECORDED IN PLAT BOOK 38 PAGE 178 OF THE ST. CHARLES COUNTY, MISSOURI RECORDS.

I HEREBY CERTIFY THAT THE ADJACENT DESCRIBED TRACT OF LAND WAS SURVEYED UNDER MY AUTHORITY AND DIRECTION DURING AUGUST THRU SEPTEMBER, 2018 AT THE ORDER OF MARK LAYNE TO PREPARE A SITE PLAN AND THAT SAID SURVEY WAS EXECUTED IN ACCORDANCE WITH THE CURRENT MINIMUM STANDARDS FOR PROPERTY BOUNDARY SURVEYS OF THE MISSOURI DEPARTMENT OF NATURAL RESOURCES, DIVISION OF GEOLOGY AND LAND SURVEY, AND THE MISSOURI BOARD OF REGISTRATION FOR ARCHITECTS, PROFESSIONAL ENGINEERS, PROFESSIONAL LAND SURVEYORS AND LANDSCAPE ARCHITECTS AND THAT THE RESULTS OF THE SURVEY, AND ALL VISIBLE ENCROACHMENTS AND THE EASEMENTS INDICATED IN THE INSTRUMENTS REFERRED TO IN THE ADJACENT DESCRIPTION ON THIS TRACT, ARE CORRECTLY SHOWN HEREON. **CITY OF O'FALLON**

METRON
 Surveying & Layout Co.
 313 WOOD STREET
 O'FALLON, MO, 63366
 314-432-5400 FAX: 636-294-5851

ELMER A. KRUSSEL E-16146

COMMUNITY DEVELOPMENT DEPARTMENT
ACCEPTED FOR CONSTRUCTION
 BY: Jamie Deonke DATE: 10/11/2018
PROFESSIONAL ENGINEER'S SEAL
INDICATES RESPONSIBILITY FOR DESIGN

SCALE : 1" = 30'
 ORDER #: 8806
 DATE : OCTOBER 4, 2018