

# PRE-DEVELOPED DRAINAGE AREA MAP

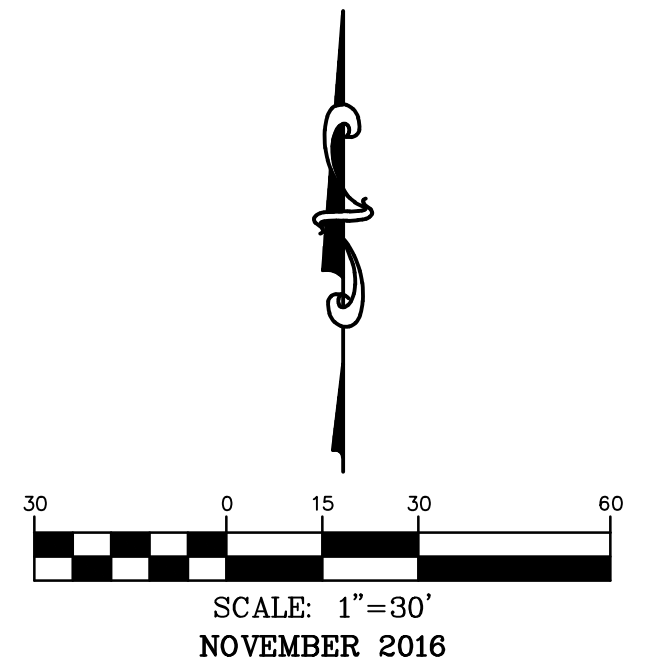
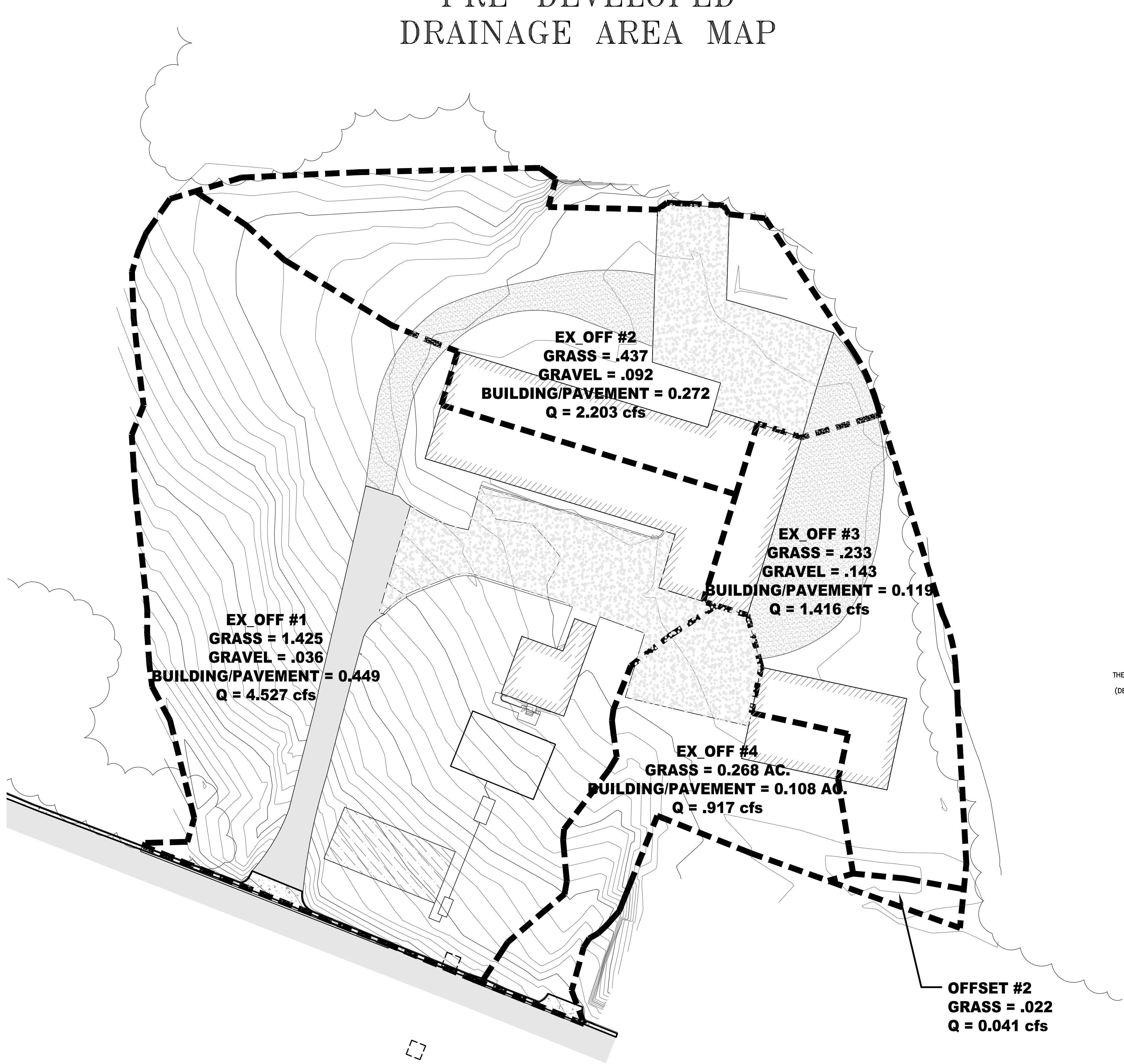

**EX\_OFF #1**  
**GRASS = 1.425**  
**GRAVEL = .036**  
**BUILDING/PAVEMENT = 0.449**  
**Q = 4.527 cfs**

**EX\_OFF #2**  
**GRASS = .437**  
**GRAVEL = .092**  
**BUILDING/PAVEMENT = 0.272**  
**Q = 2.203 cfs**

**EX\_OFF #3**  
**GRASS = .233**  
**GRAVEL = .143**  
**BUILDING/PAVEMENT = 0.119**  
**Q = 1.416 cfs**

**EX\_OFF #4**  
**GRASS = 0.268 AC.**  
**BUILDING/PAVEMENT = 0.108 AC.**  
**Q = .917 cfs**

**OFFSET #2**  
**GRASS = .022**  
**Q = 0.041 cfs**

N/F  
 THE EMERALD REALTY  
 GROUP, LLC  
 (DB 4045, PG 782)

636-332-4574 (tel.)  
 636-327-0760 (fax)  
 www.cochraneng.com

North Office  
 8 East Main Street  
 Wentzville, Missouri 63385

**COCHRAN**

- Civil Engineering
- Land Surveying
- Architecture
- Site Development
- City Planning
- Master Planning



DATE  
 Eric S. Kirchner No. E-2001004618  
 Registered Professional Engineer  
 State of Missouri  
 for Cochran Engineering & Surveying

**Developer / Owner Information:**  
 C Bennett Premium Building Supplies  
 1285 W. Terra Lane  
 O'Fallon, MO 63366

**City of O'Fallon Standard Sheet**

P+Z No.  
 Approval Date: 9/1/16  
 City No.

Page No.  
 C5