

STORM SEWER PLAN VIEW - 01

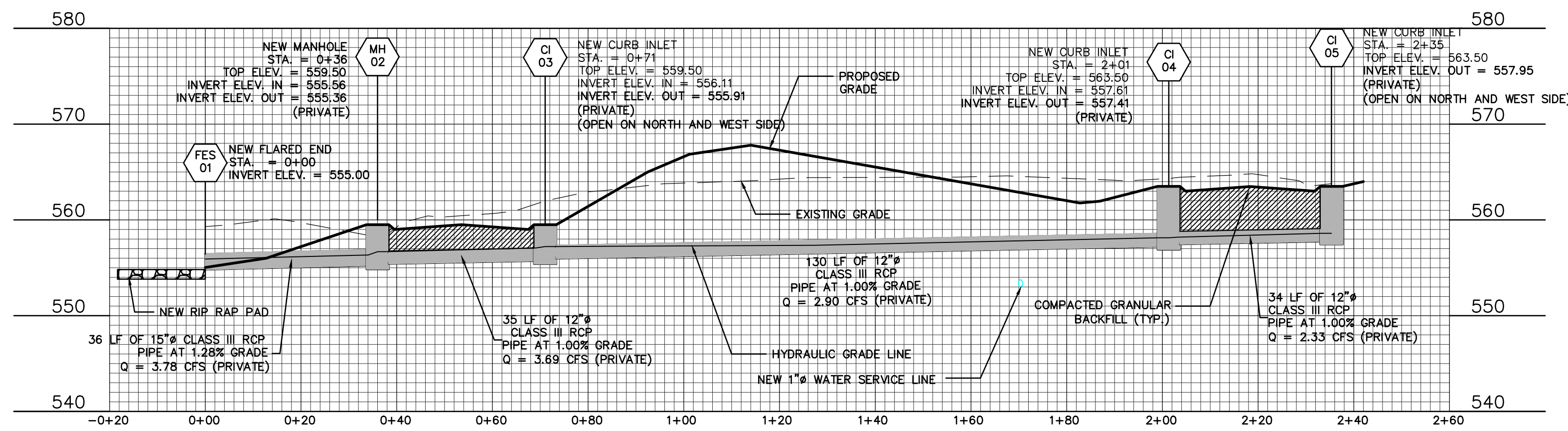

STORM SEWER PROFILE VIEW - 01

SCALE: HORZ. 0 10 20  
VERT. 0 5 10

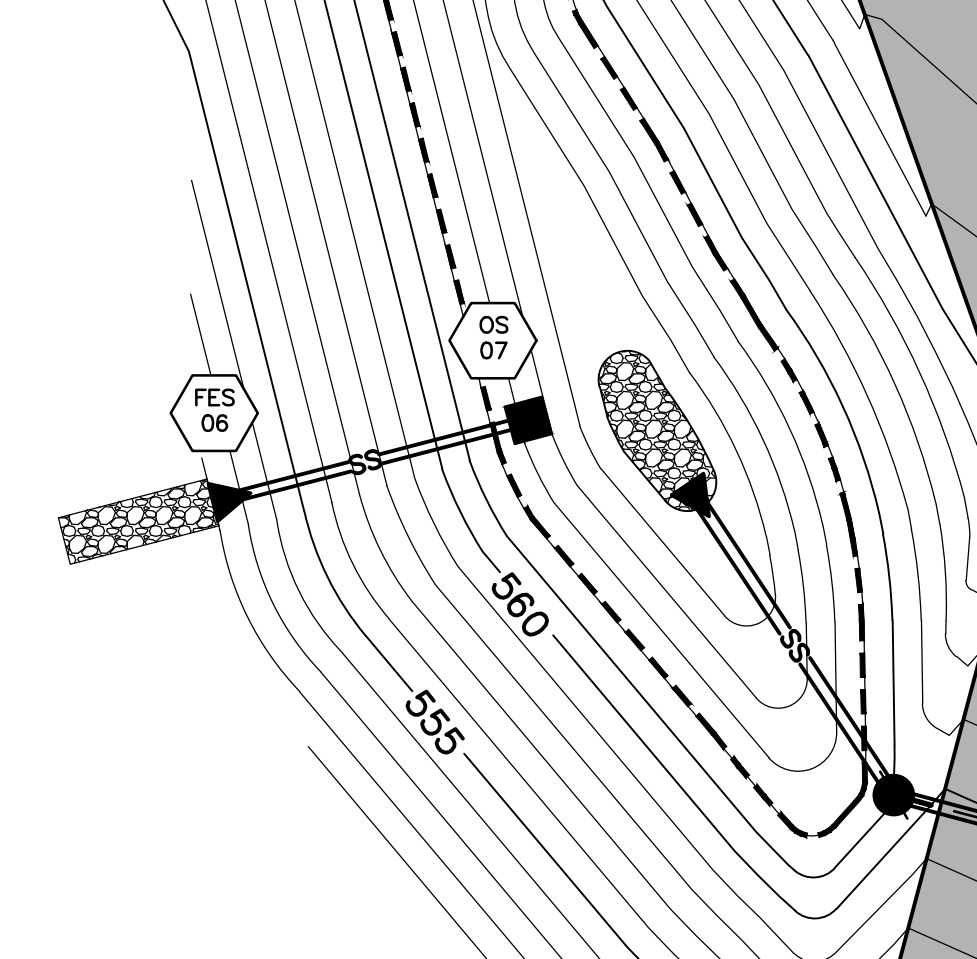

STORM SEWER PLAN VIEW - 02

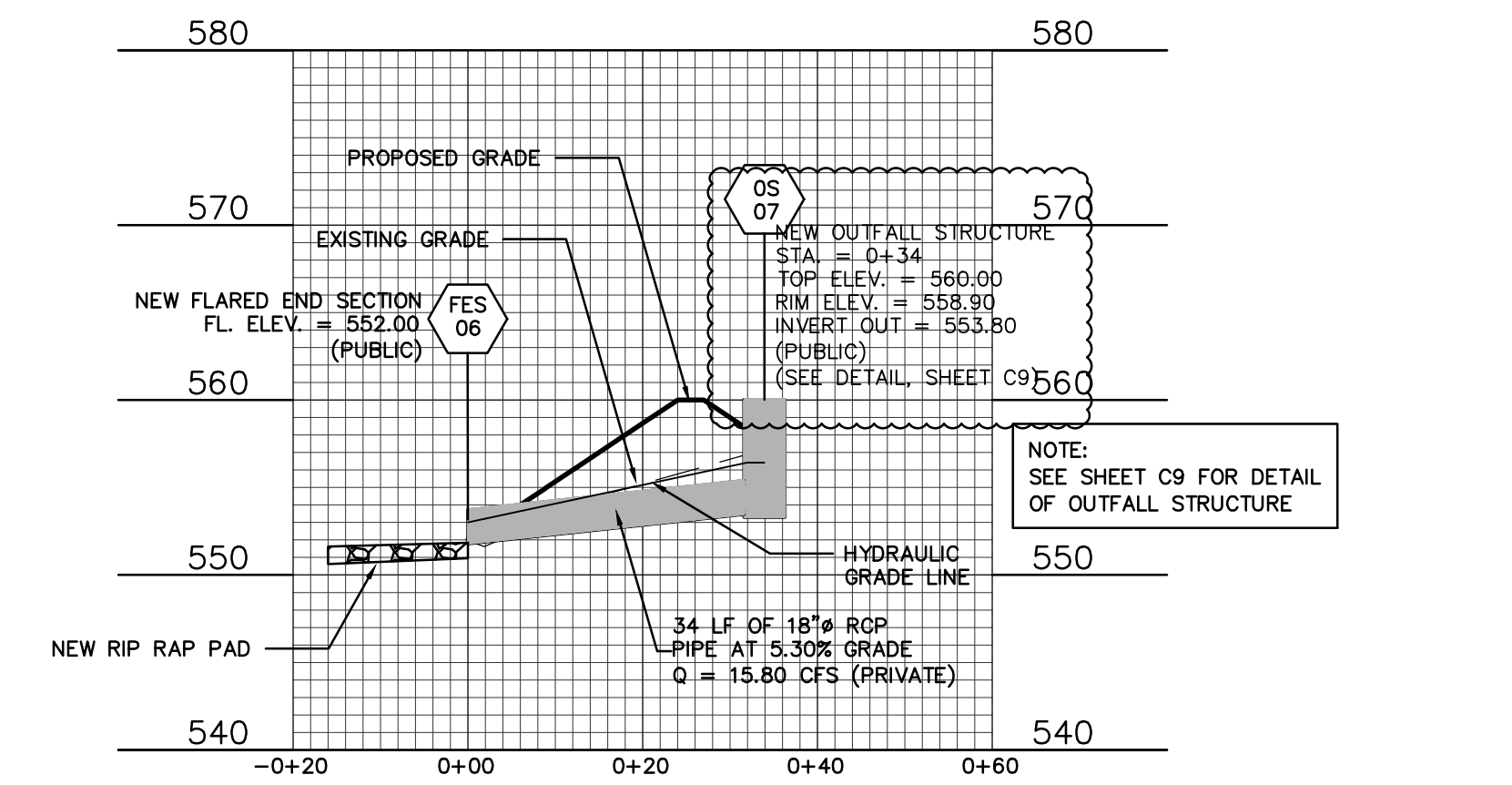

STORM SEWER PROFILE VIEW - 02

SCALE: HORZ. 0 10 20  
VERT. 0 5 10

North Office  
8 East Main Street  
Wentzville, Missouri 63385  
636-332-4574 (tel.)  
636-327-0760 (fax)  
www.motcall.com

**COCHRAN**  
Civil Engineering  
Land Surveying  
Architecture  
Site Development  
Construction Management  
Master Planning

STATE OF MISSOURI  
REGISTERED PROFESSIONAL ENGINEER  
ERIC SCOTT KIRCHNER  
E-2001004618  
12/24/2017

DATE  
Eric S. Kirchner No. E-2001004618  
Registered Professional Engineer  
State of Missouri  
for Cochran Engineering & Surveying

Developer / Owner Information:  
C Bennett / Premium Building Supplies  
1285 W. Terra Lane  
O'Fallon, MO 63366

City of O'Fallon Standard Sheet

P+Z No.  
Approval Date: 9/1/16  
City No.

Page No.  
C3

PREPARED FOR:  
C BENNETT PREMIUM BUILDING SUPPLIES  
1700 W. TERRA LAINE  
O'FALLON MO, 63366

All OSHA rules & regulations established for the type of construction required by these plans shall be strictly followed (ie. Trenching, Blasting, etc.)

CALL OR CLICK 3 DAYS BEFORE YOU DIG!  
MISSOURI ONE CALL SYSTEM  
1-800-DIG-RITE or 811  
www.motcall.com

City of O'Fallon Standard Commercial Notes and Details - October 2016