

STORM SEWER PLAN VIEW - 01

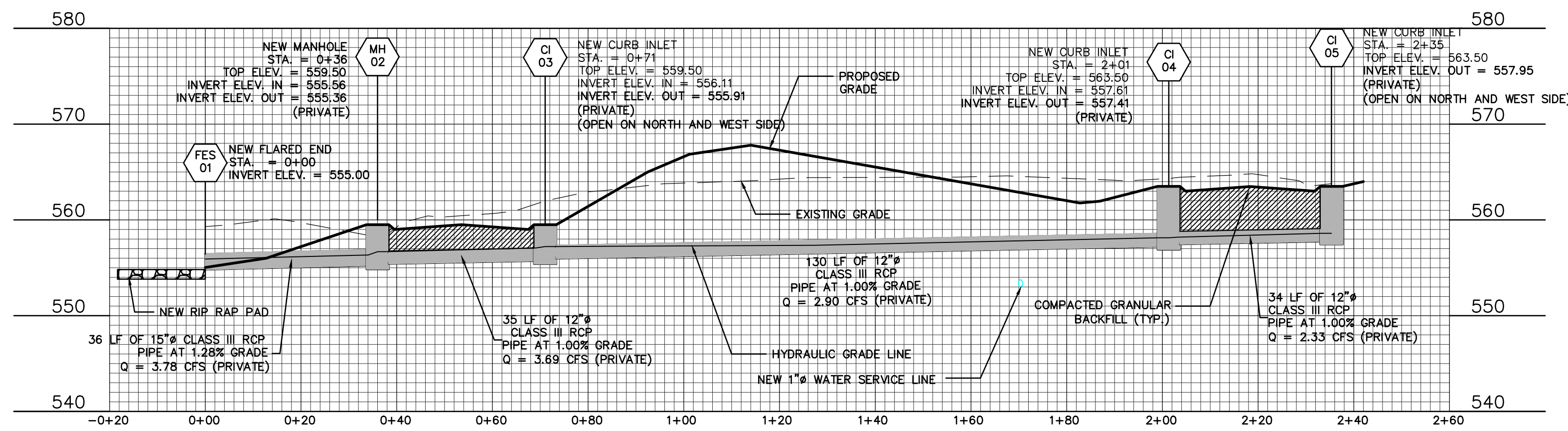

STORM SEWER PROFILE VIEW - 01

SCALE: HORZ. 0 10 20
VERT. 0 5 10

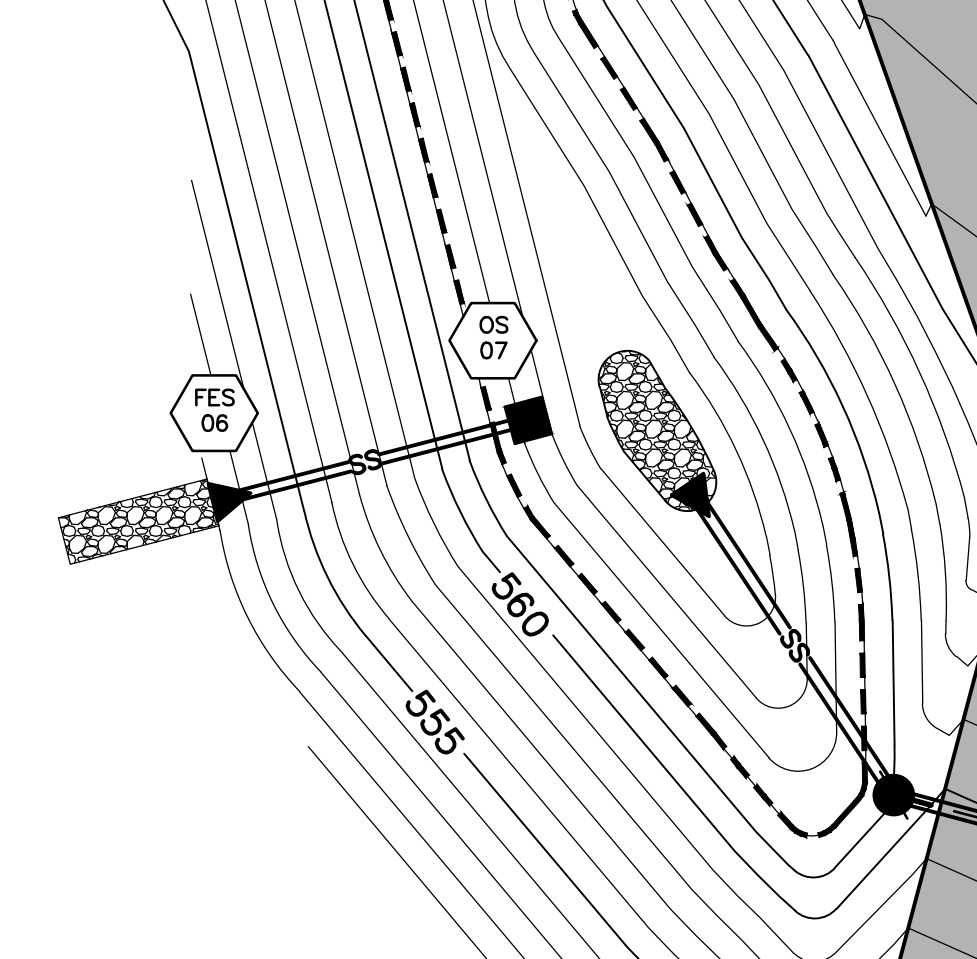

STORM SEWER PLAN VIEW - 02

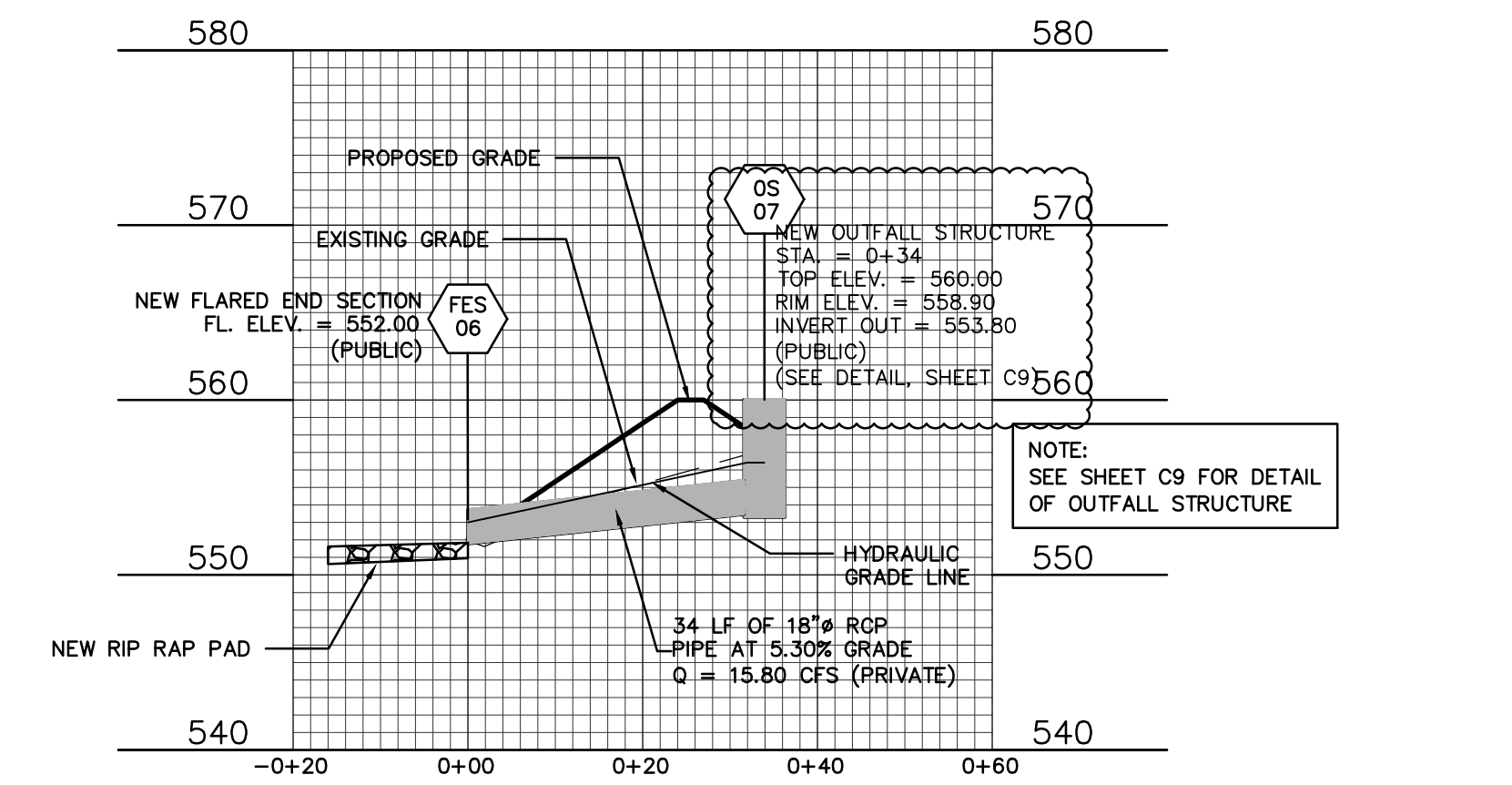

STORM SEWER PROFILE VIEW - 02

SCALE: HORZ. 0 10 20
VERT. 0 5 10

North Office
8 East Main Street
Wentzville, Missouri 63385
636-332-4574 (tel.)
636-357-0760 (fax)
www.motcall.com
Civil Engineering
Land Surveying
Architecture
Site Development
Civil Consulting
Master Planning



DATE
Eric S. Kirchner No. E-2001004618
Registered Professional Engineer
State of Missouri
for Cochran Engineering & Surveying

Developer / Owner Information:
C Bennett / Premium Building Supplies
1285 W. Terra Lane
O'Fallon, MO 63366

City of O'Fallon Standard Sheet

P+Z No.
Approval Date: 9/1/16
City No.

Page No.
C3

PREPARED FOR:
C BENNETT PREMIUM BUILDING SUPPLIES
1700 W. TERRA LAINE
O'FALLON MO, 63366

All OSHA rules & regulations established for the type of construction required by these plans shall be strictly followed (ie. Trenching, Blasting, etc.)

CALL OR CLICK 3 DAYS BEFORE YOU DIG!
MISSOURI ONE CALL SYSTEM
1-800-DIG-RITE or 811
www.motcall.com

City of O'Fallon Standard Commercial Notes and Details - October 2016