

PRE-DEVELOPED DRAINAGE AREA MAP

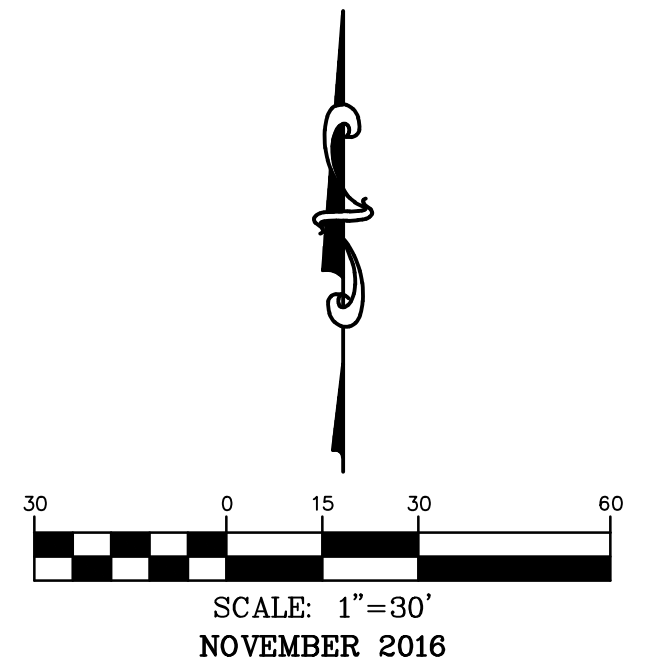
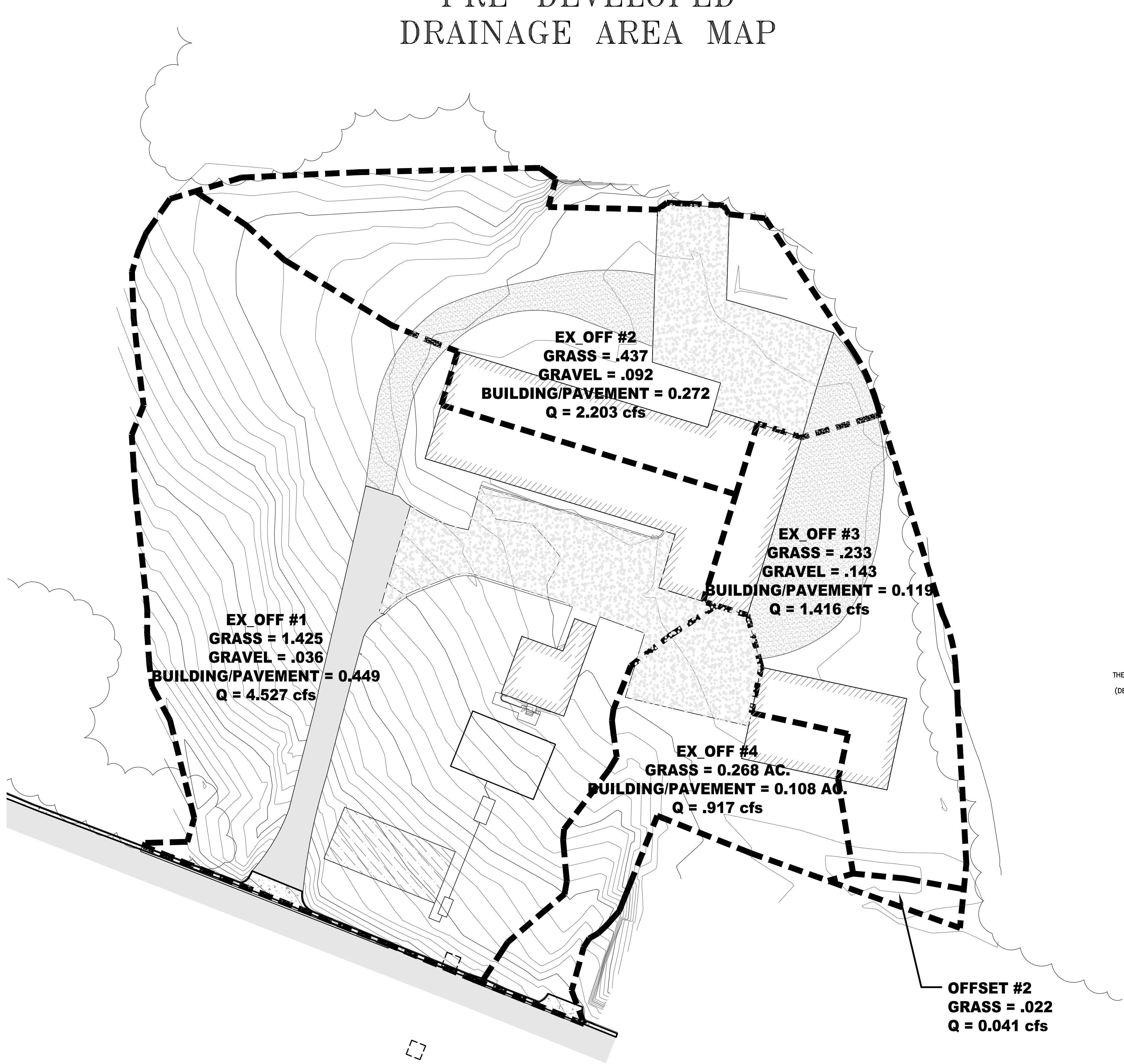

EX_OFF #1
GRASS = 1.425
GRAVEL = .036
BUILDING/PAVEMENT = 0.449
Q = 4.527 cfs

EX_OFF #2
GRASS = .437
GRAVEL = .092
BUILDING/PAVEMENT = 0.272
Q = 2.203 cfs

EX_OFF #3
GRASS = .233
GRAVEL = .143
BUILDING/PAVEMENT = 0.119
Q = 1.416 cfs

EX_OFF #4
GRASS = 0.268 AC.
BUILDING/PAVEMENT = 0.108 AC.
Q = .917 cfs

OFFSET #2
GRASS = .022
Q = 0.041 cfs

N/F
 THE EMERALD REALTY
 GROUP, LLC
 (DB 4045, PG 782)

636-332-4574 (tel.)
 636-327-0760 (fax)
 www.cochranengineering.com

North Office
 8 East Main Street
 Wentzville, Missouri 63385

COCHRAN

- Civil Engineering
- Land Surveying
- Architecture
- Site Development
- City Planning
- Master Planning



DATE
 Eric S. Kirchner No. E-2001004618
 Registered Professional Engineer
 State of Missouri
 for Cochran Engineering & Surveying

Developer / Owner Information:
 C Bennett Premium Building Supplies
 1285 W. Terra Lane
 O'Fallon, MO 63366

City of O'Fallon Standard Sheet

P+Z No.
 Approval Date: 9/1/16
 City No.

Page No.
 C5