

# WARPING DETAILS

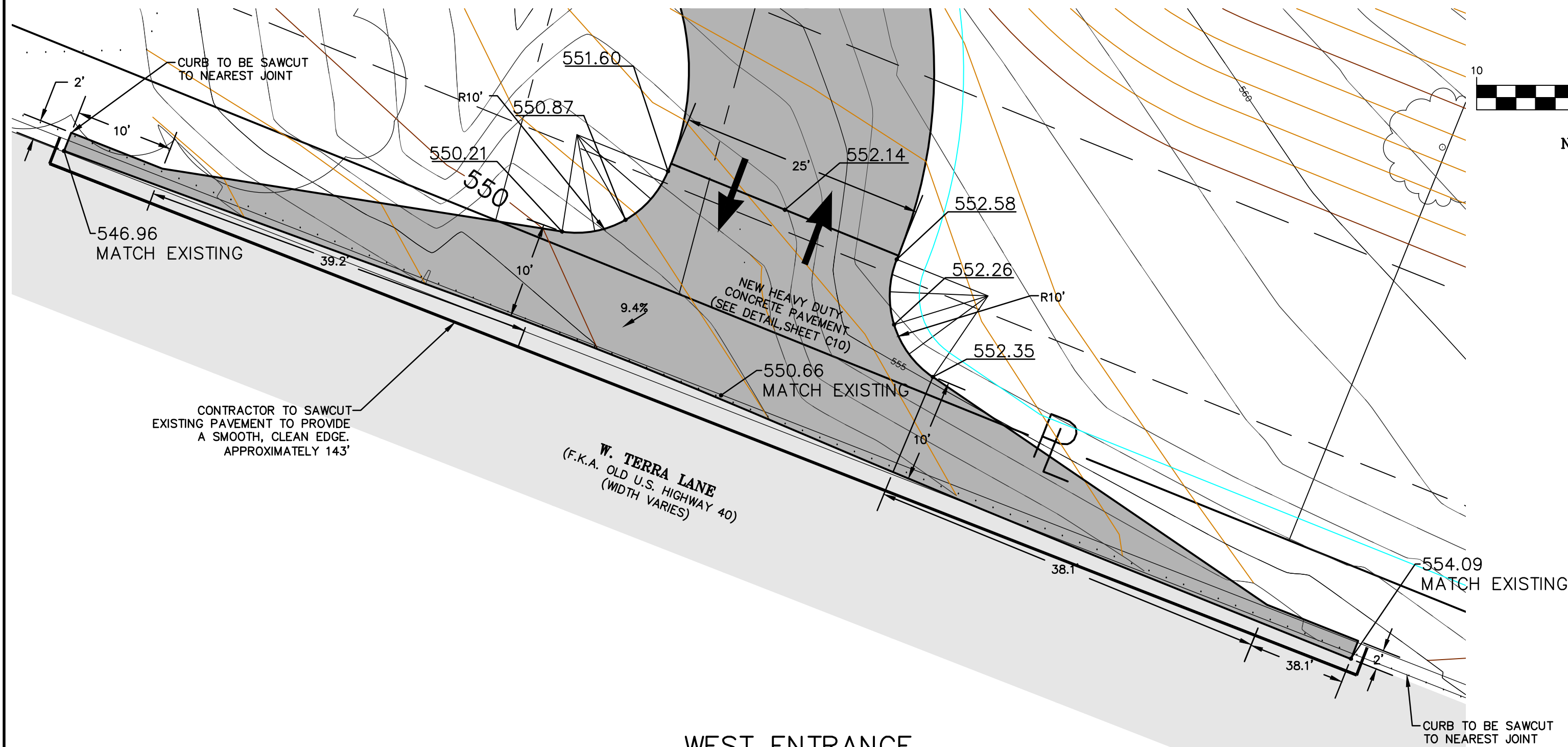

**WEST ENTRANCE  
WARPING DETAIL**

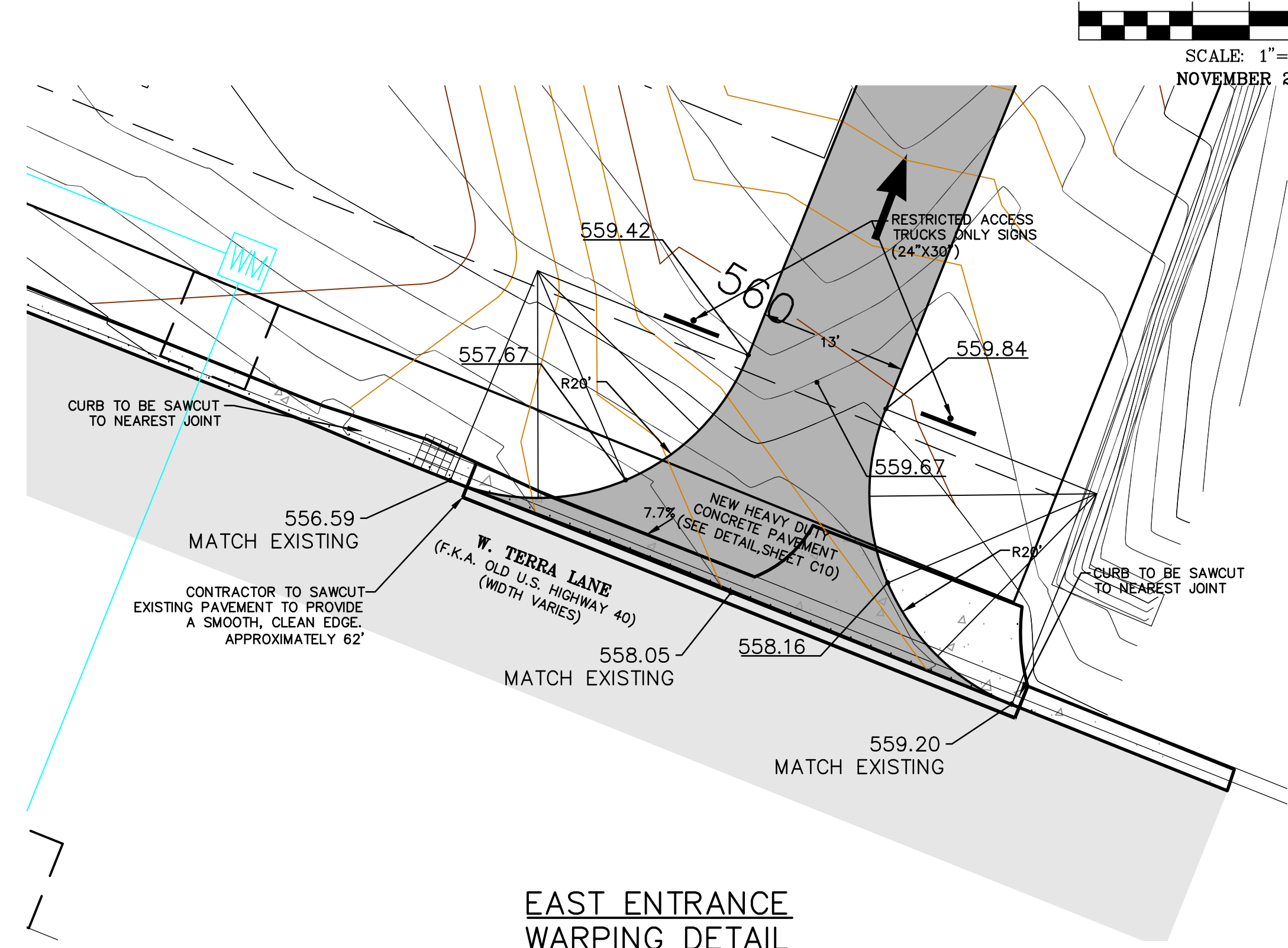
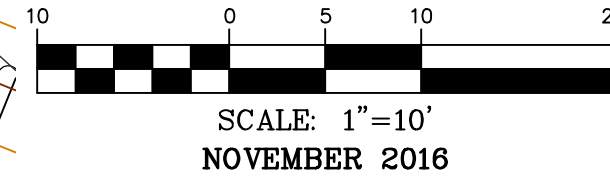

**EAST ENTRANCE  
WARPING DETAIL**

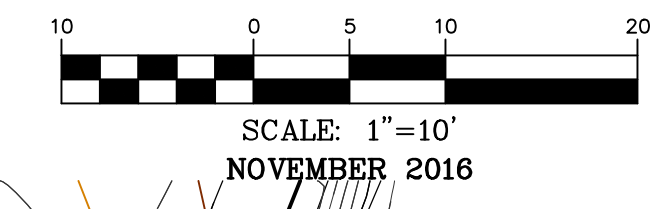

636-332-4574 (tel)  
636-327-0760 (fax)  
www.mhcochran.com

**COCHRAN**

North Office  
8 East Main Street  
Wentzville, Missouri 63385

- Civil Engineering
- Land Surveying
- Architecture
- Site Development
- General Consulting
- Master Planning

Eric S. Kirchner No. E-2001004618  
Registered Professional Engineer  
State of Missouri  
for Cochran Engineering & Surveying

**Developer / Owner Information:**  
C Bennett Premium Building Supplies  
1285 W. Terra Lane  
O'Fallon, MO 63366

**City of O'Fallon Standard Sheet**

**P+Z No.**  
Approval Date: 9/1/16  
**City No.**

**Page No.**  
C8