

STABILIZED CONSTRUCTION ENTRANCE

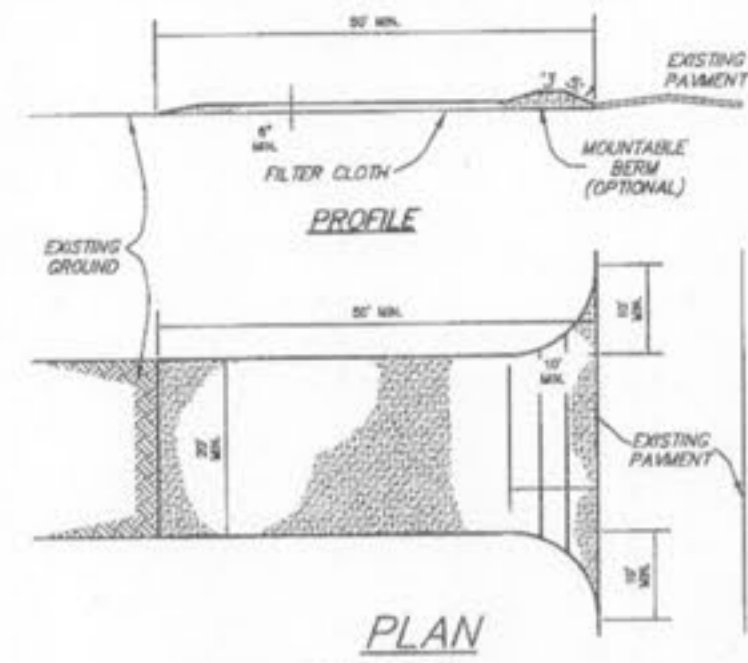

- CONSTRUCTION SPECIFICATIONS**
1. Stone Size - Use 2" stone, or reclaimed or recycled concrete equivalent.
 2. Length - As required, but not less than 50 feet (except on a single residence lot where a 30 foot minimum length would apply).
 3. Thickness - Not less than six (6) inches.
 4. Width - Twenty (20) foot minimum, but not less than the full width at points where ingress or egress occurs.
 5. Filter Cloth - Will be placed over the entire area prior to placing of stone. Filter will not be required on a single family residence lot.
 6. Surface Water - All surface water flowing or diverted toward construction entrances shall be piped across the entrance. If piping is impractical, a mountable berm with 2:1 slopes will be permitted.
 7. Maintenance - The entrance shall be maintained in a condition which will prevent tracking or leeching of sediment onto public rights-of-way. This may require periodic top dressing with additional stone as conditions demand and repair and/or cleanup of any measures used to trap sediment. All sediment applied, dropped, washed or tracked onto public rights-of-way must be removed immediately.
 8. Washing - Vehicles shall be cleaned to remove sediment prior to entrance onto public rights-of-way. When washing is required, it shall be done on an area stabilized with stone and which drains into an approved sediment trapping device.
 9. Periodic inspection and needed maintenance shall be provided after each rain.

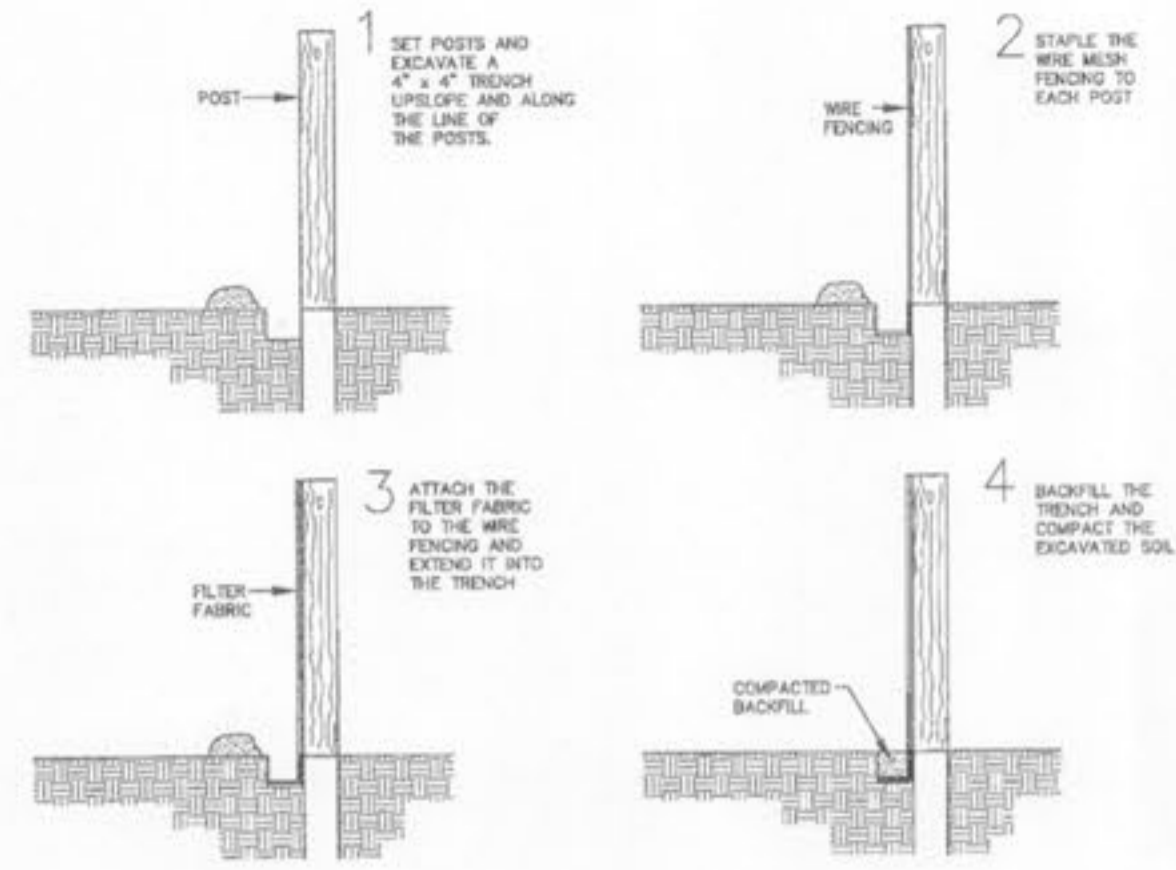

1. FILTER BARRIERS SHALL BE INSPECTED IMMEDIATELY AFTER EACH RAINFALL AND AT LEAST DURING PROLONGED RAINFALL. ANY REQUIRED REPAIRS SHALL BE MADE IMMEDIATELY.
2. SHOULD THE FABRIC DECOMPOSE OR BECOME INEFFECTIVE PRIOR TO THE END OF THE EXPECTED USABLE LIFE AND THE BARRIER STILL BE NECESSARY, THE FABRIC SHALL BE REPLACED PROMPTLY.
3. SEDIMENT DEPOSITS SHOULD BE REMOVED AFTER EACH STORM EVENT. THEY MUST BE REMOVED WHEN DEPOSITS REACH APPROXIMATELY HALF THE HEIGHT OF THE BARRIER.
4. ANY SEDIMENT DEPOSITS REMAINING IN PLACE AFTER THE SILT FENCE OR FILTER BARRIER IS NO LONGER REQUIRED SHALL BE DRESSED TO CONFORM WITH THE EXISTING GRADE, PREPARED AND SEEDS.



SILTATION FENCE DETAIL
NOT TO SCALE

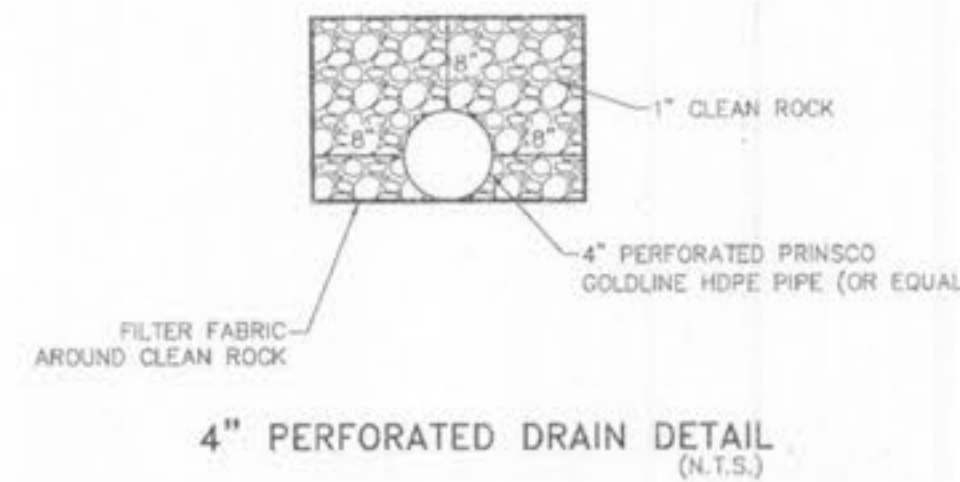

MAINTENANCE SCHEDULE:

1. THE PROPERTY OWNER WILL MAINTAIN THE RAIN GARDENS IN GOOD WORKING ORDER AND WILL BE INSPECTED EVERY 6 MONTHS FOR THE FOLLOWING:
 - A. SAID AREA SHALL BE CLEANED SHORTLY AFTER THE PROJECT IS COMPLETED AND EROSION CONTROL HAS BEEN REMOVED AND VEGETATION HAS BEEN ESTABLISHED.
 - B. AREA SHALL BE CLEANED OF ANY WEEDS, UNDERBRUSH, WILD GROWTH, DEBRIS OR LITTER.
 - C. PLANTINGS WILL BE EVALUATED AND ANY DEAD PLANT SHALL BE REPLACED.
 - D. IF ACCUMULATED SEDIMENT HAS CLOGGED THE SURFACE PORES OF THE RAIN GARDEN, THEN DRILLING OR PUNCHING SMALL HOLES INTO THE SURFACE LAYER SHALL BE DONE TO RESTORE INFILTRATION CAPACITY OF THE SOIL.

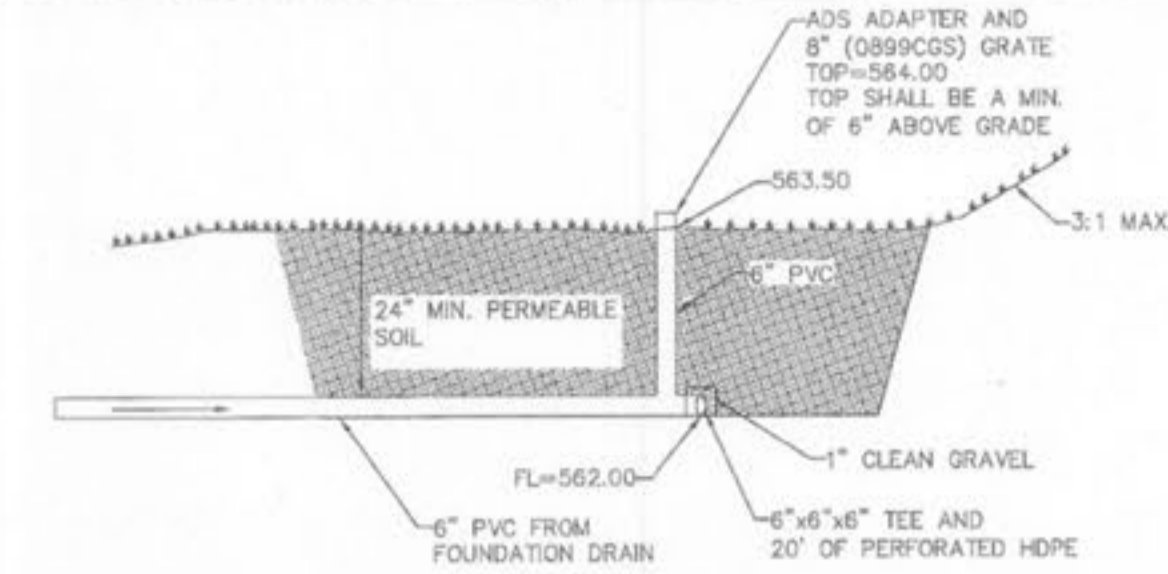

RAIN GARDEN PROFILE
NOT TO SCALE

RAIN GARDEN NOTES:

1. PERMEABLE SOIL LAYER SHOULD CONSIST OF 50% TOPSOIL, 25% SAND AND 25% COMPOST OR LEAF MULCH. TOPSOIL MUST HAVE NO MORE THAN 10% CLAY CONTENT.
2. AFTER CONSTRUCTION, WATER PLANTS FOR 14 CONSECUTIVE DAYS UNLESS THERE IS SUFFICIENT RAINFALL.
3. ALL PLANT MATERIAL SHOULD BE NATIVE PLANTS. REFER TO MSD'S LANDSCAPE GUIDE.
4. CONTRACTOR MUST VERIFY LOCATION OF ANY POTENTIAL UNDERGROUND UTILITIES IN THE VICINITY OF THE PROPOSED RAIN GARDEN AND ADJUST LAYOUT IF NEEDED TO AVOID ANY CONFLICTS OR DAMAGE TO UTILITY LINES.
5. APPLY 3 INCHES OF HARDWOOD MULCH AFTER PLANTINGS ARE COMPLETED. DO NOT FERTILIZE.

RAIN GARDEN PLANT LIST:

INTERPERSE RAIN GARDEN WITH A SELECTION OF GRASSES/SEDGES AND FORBS.

GRASSES/SEDGES:
TOLLWAY SEDGE
SHORTS SEDGE
SIDEOTS GRAMA
PALM SEDGE

FORBS:
LANCERLEAF COREOPSIS
RATTLESNAKE MASTER
GOLDEN ALEXANDER
BUTTERFLY MILKWOOD
AROMATIC ASTER
PRAIRIE ALUNROOT
COPPER IRIS

CONSTRUCTION DETAILS
16 SANDERS DRIVE

04-13010A 04/15/10

- REVISIONS:**
- 06-14-10 CITY COMMENTS
 - 06-30-10 CITY COMMENTS
 - 07-09-10 ADD TRANSFORMER
 - 07-14-10 ADD LIGHTING
 - 07-25-10 AMREM LJE NOTE
 - 07-30-10 RETAINING WALL

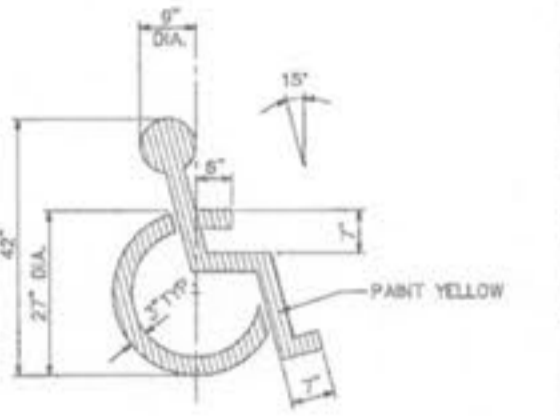

PAINTED HANDICAPPED PARKING SYMBOL
NOT TO SCALE

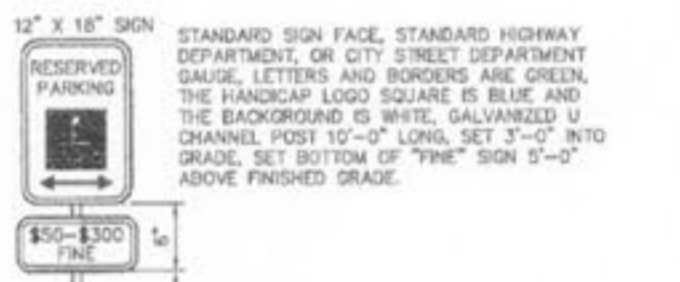

HANDICAP PARKING SIGN (CITY OF O'FALLON)
NOT TO SCALE

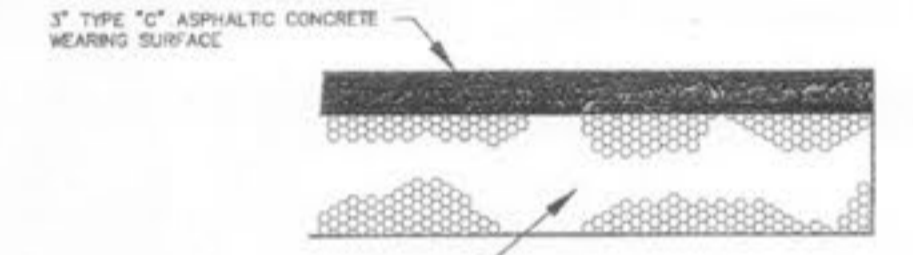

ASPHALT PAVEMENT DETAIL
NOT TO SCALE

- THE ASPHALT SURFACE SHALL BE COMPACTED TO 98% MAXIMUM DENSITY.
- ALL GRANULAR ROLLED STONE BASE UNDER PROPOSED CONCRETE MUST BE COMPACTED TO 100% OF THE MAXIMUM DENSITY AS DETERMINED BY THE STANDARD PROCTOR TEST AASHTO T-99.



- NOTES:**
1. STRAW BALES, NOT HAY BALES SHALL BE USED.
 2. BUTT ENDS OF BALES TIGHTLY TOGETHER.
 3. INSTALL BALES WITH BINDING AROUND SIDES, NOT TOP AND BOTTOM.
 4. FILL ANY GAP BETWEEN BALES BY WEDGING LOOSE STRAW BETWEEN THEM.

SEDIMENT BARRIER
NOT TO SCALE



STANDARD SIGN FACE, STANDARD HIGHWAY DEPARTMENT, OR CITY STREET DEPARTMENT GAUGE, LETTERS AND BORDERS ARE GREEN, THE HANDICAP LOGO SQUARE IS BLUE AND THE BACKGROUND IS WHITE. GALVANIZED U CHANNEL, POST 6\"/>



VAN ACCESSIBLE HANDICAP PARKING SIGN
NOT TO SCALE

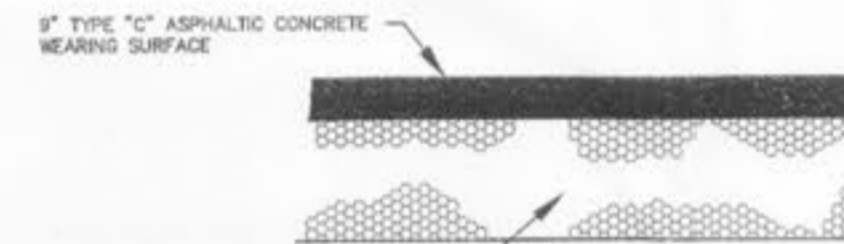

ASPHALT PAVEMENT WITHIN RIGHT-OF-WAY DETAIL
NOT TO SCALE

- THE ASPHALT SURFACE SHALL BE COMPACTED TO 98% MAXIMUM DENSITY.
- ALL GRANULAR ROLLED STONE BASE UNDER PROPOSED CONCRETE MUST BE COMPACTED TO 100% OF THE MAXIMUM DENSITY AS DETERMINED BY THE STANDARD PROCTOR TEST AASHTO T-99.

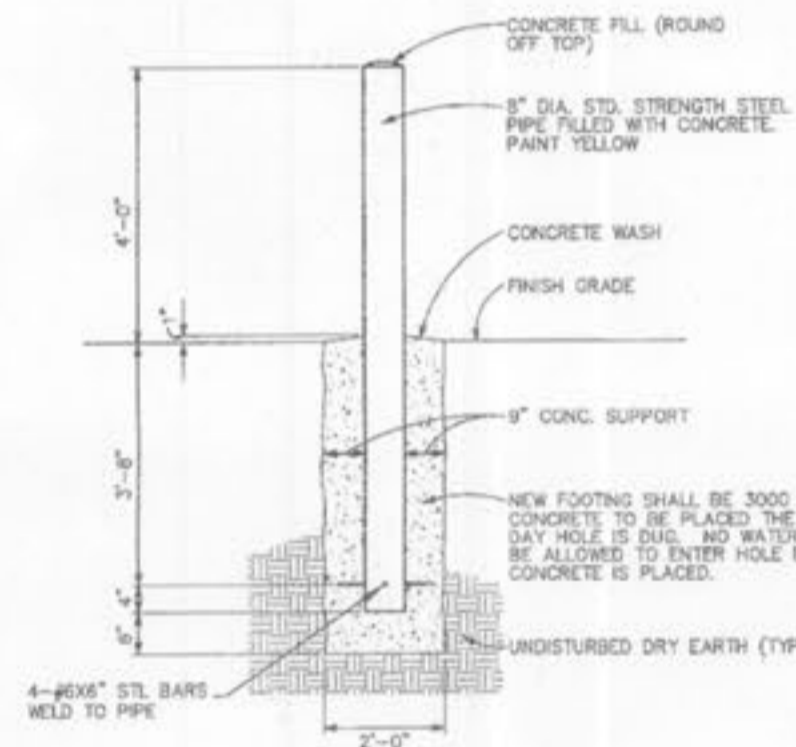

PIPE BOLLARD DETAIL
NOT TO SCALE

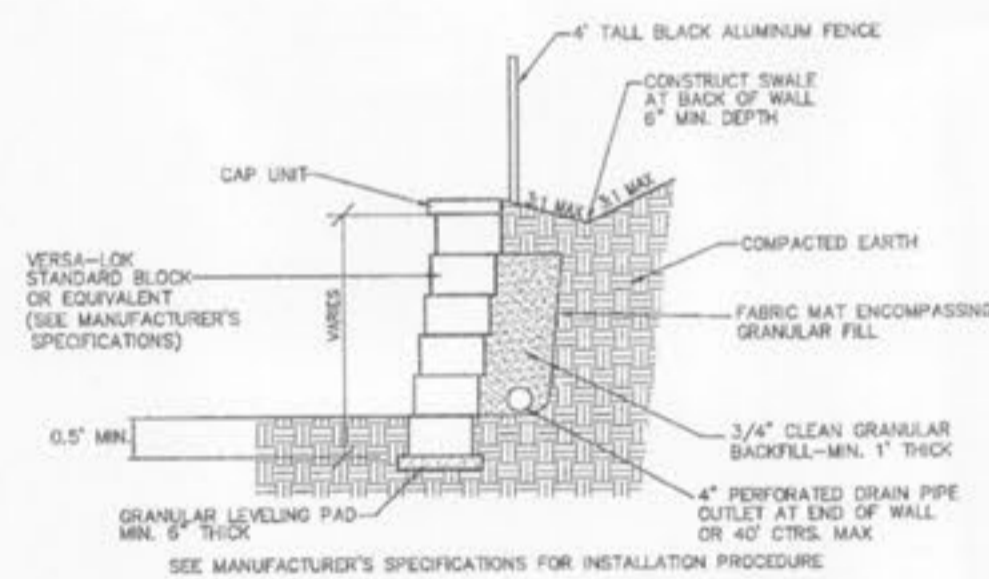

MODULAR BLOCK CONCRETE RETAINING WALL (RETAINING WALL DESIGN BY OTHERS)
NOT TO SCALE

- WALL DESIGN TO TAKE INTO ACCOUNT ANY LOADING OR IMPACT THE PROPOSED FENCE WILL HAVE ON SAID WALL.



PRECAST CONCRETE WHEELSTOP
NOT TO SCALE

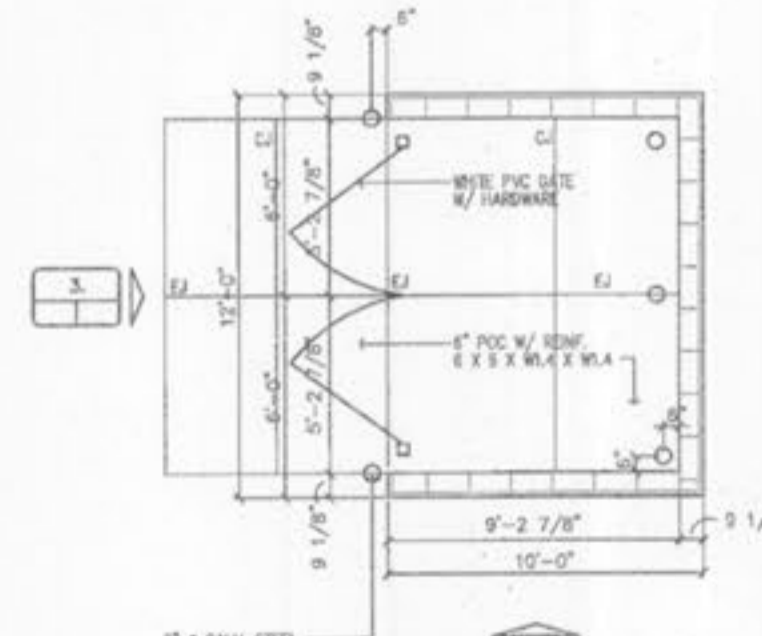

1. TRASH ENCLOSURE PLAN
NOT TO SCALE

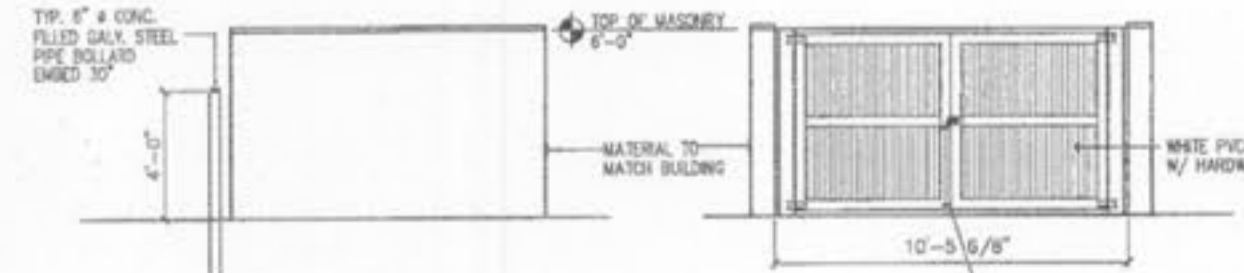

2. ELEVATION
NOT TO SCALE

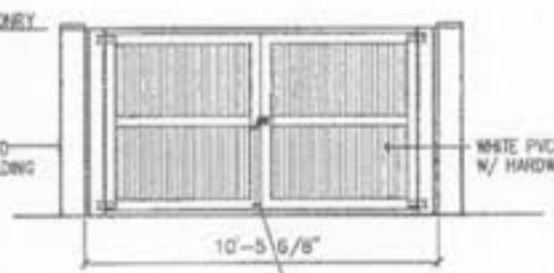

3. ELEVATION
NOT TO SCALE

* COMPRESSIVE STRENGTH OF CONCRETE PAD SHALL BE 4,000PSI IN 28 DAYS.

Nyloplast Grate Options for Drain Basin & Inline Drains
(Locking options is available for all grates)

Part #	Drain Basin	Adapter (B)	Adaptor In Place Size
2710AG	10"		4", 6", 8"
2710AG	10"		4", 6", 8", 10", 12"
2712AG	12"		4", 6", 8", 10", 12", 15"
2715AG	15"		4", 6", 8", 10", 12", 15", 18"
2718AG	18"		4", 6", 8", 10", 12", 15", 18", 24", 30"
2724AG	24"		4", 6", 8", 10", 12", 15", 18", 24", 30"
2730AG	30"		4", 6", 8", 10", 12", 15", 18", 24", 30"

3-7 day lead times are required for product delivery.



Larry David Walker
Engineer
2007020343
Copyright 2010
Box Engineering Company, Inc.
Authority No. 000005
All Rights Reserved