

LOCATION: S:\2023\W230784 - STL\Engineering\Design\Drawings\W230784-01-C201 - 01a.dwg
DATE/TIME: December 31, 2024 - 4:56pm
PLOT/FILE BY: Sonny

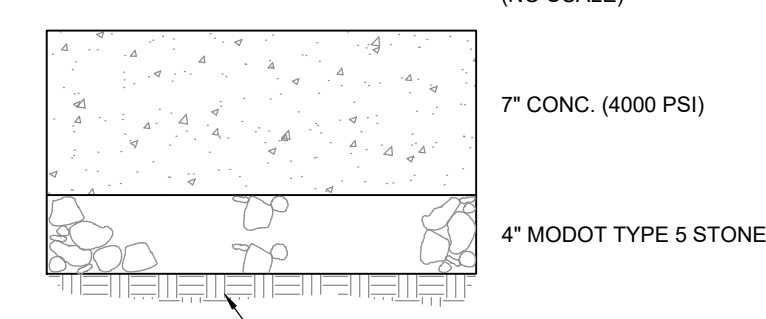
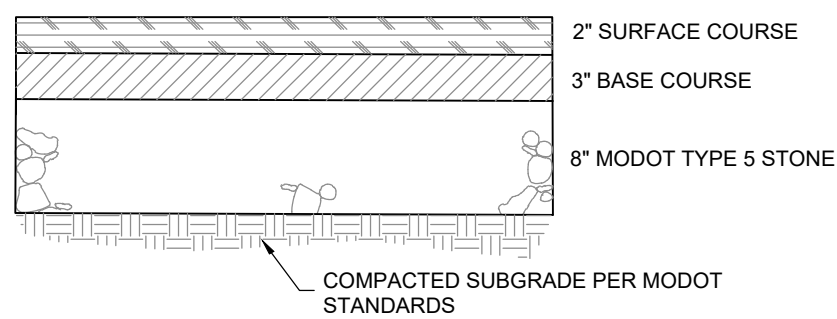
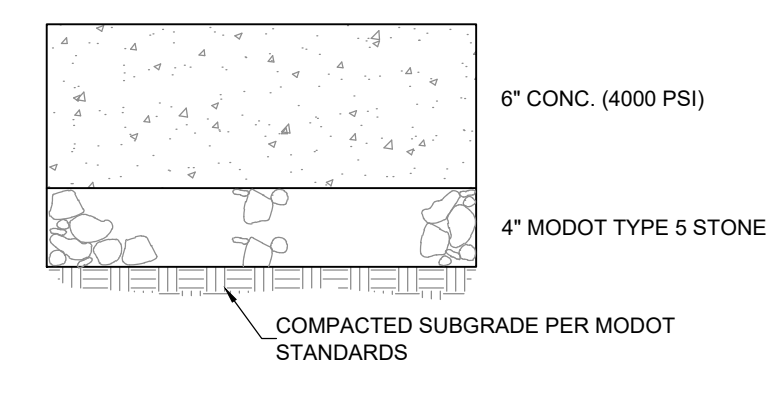
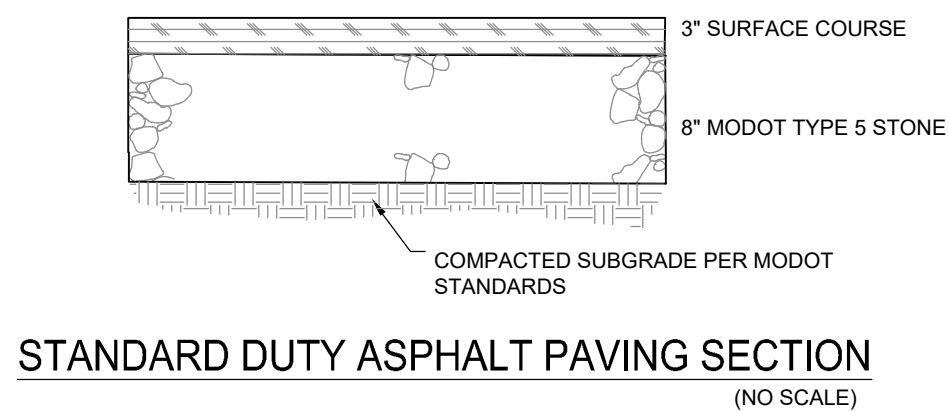

NOTE: THE ASPHALT SURFACE SHALL BE
COMPACTED TO 98% MAXIMUM DENSITY

NOTE: ALL NON-REINFORCED CONCRETE SHALL BE
4000 P.S.I. AT 28 DAYS

MINIMUM PAVEMENT SECTIONS

NOTE: PAVING SECTIONS PROVIDED FROM GEOTECH
REPORT PREPARED BY JACOBI GEOTECHNICAL
ENGINEERING, LLC, DATED MARCH 11, 2024

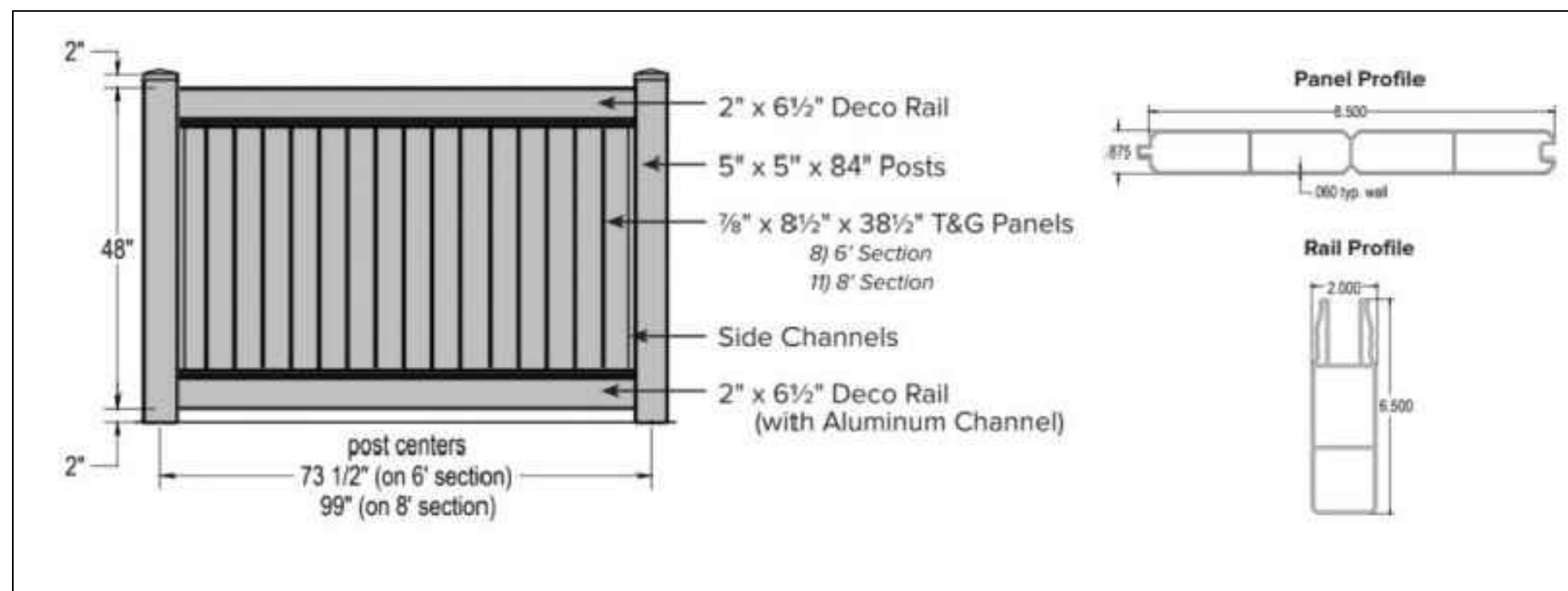

VINYL FENCE DETAIL

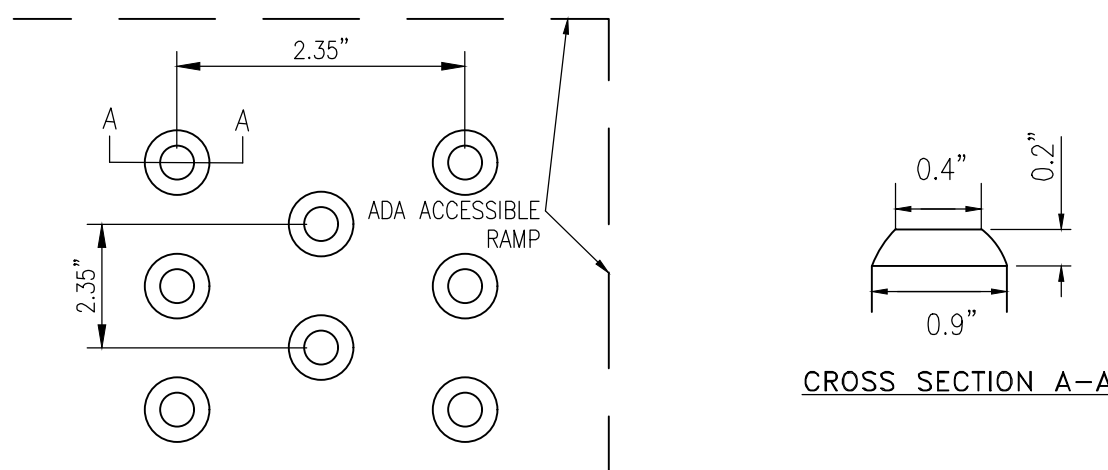

NOTE: TRUNCATED DOMES
TO BE PLACED ON RAMP
SLOPES OF ALL ADA RAMPS

TRUNCATED DOME DETECTABLE WARNINGS FOR ADA RAMPS

NOT TO SCALE

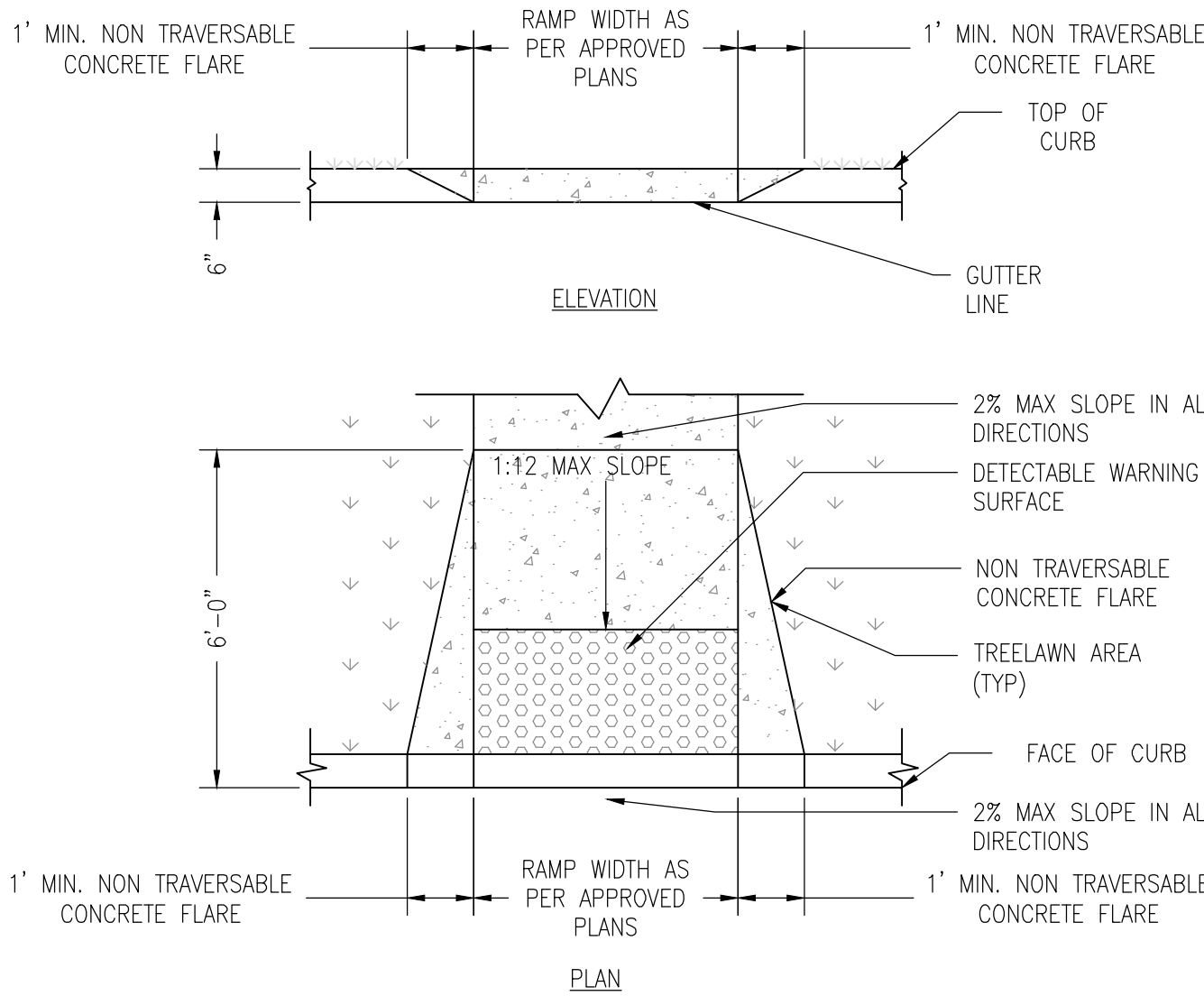

NOTE: MAINTAIN 4" SIDEWALK THICKNESS IN DEPRESSED AREA.

ADA RAMP

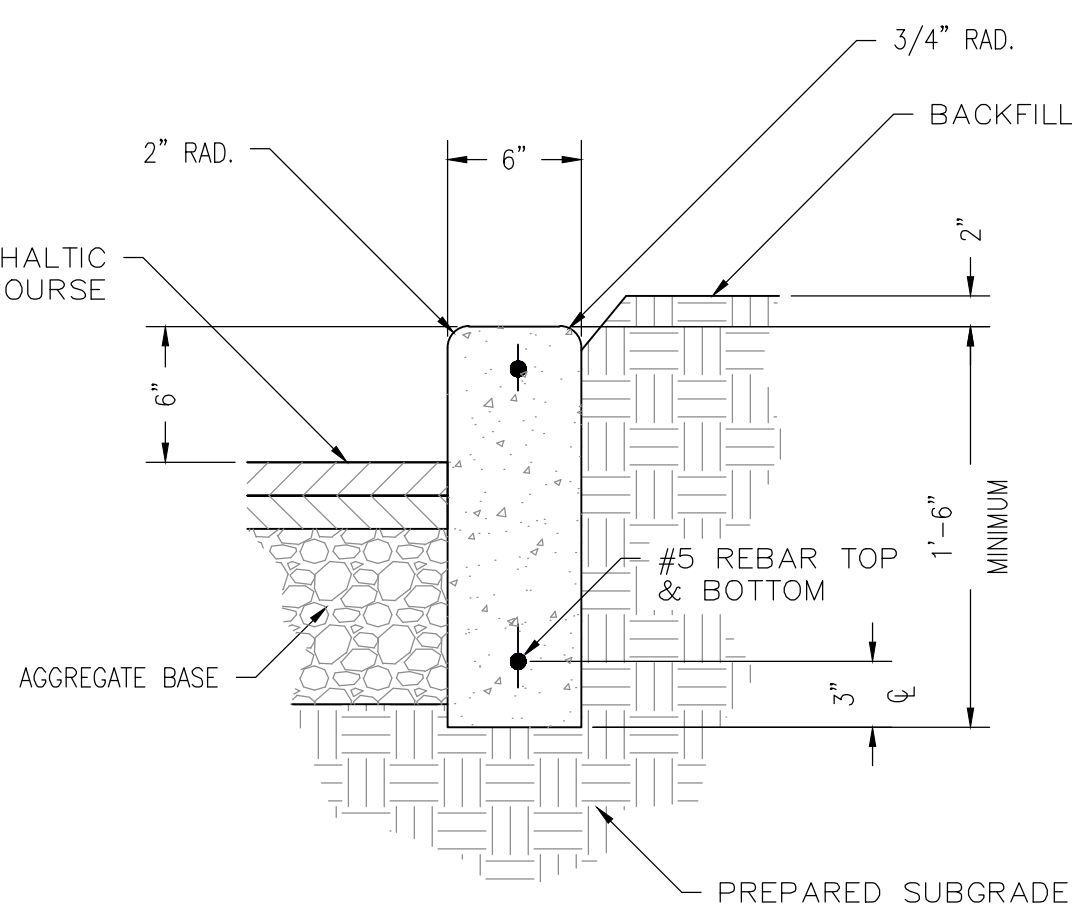

VERTICAL CURB

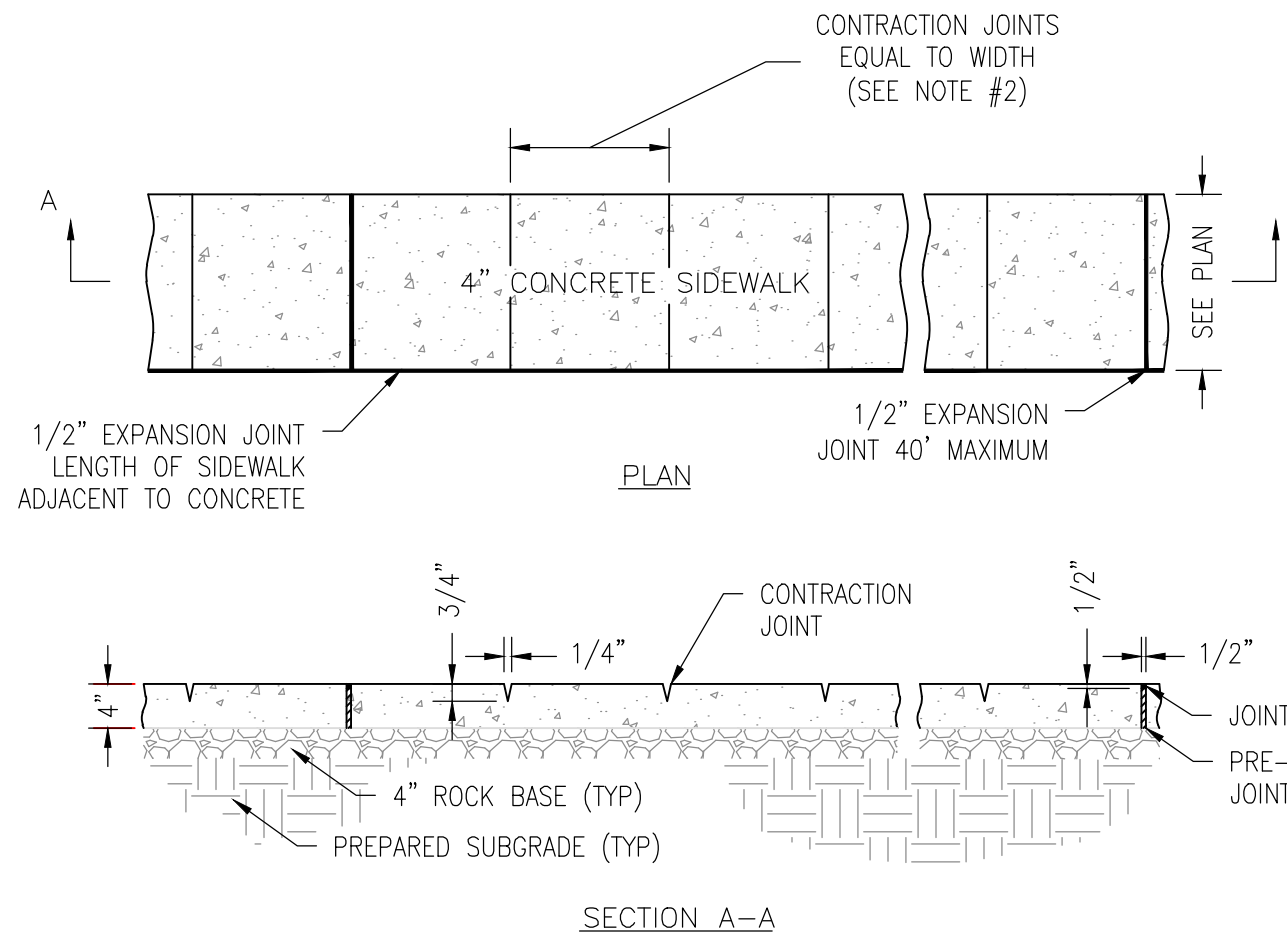

- NOTES:
- CONTRACTOR TO COORDINATE WITH ARCHITECTURAL SITE PLANS FOR DETAILS OF ALL INTERIOR WALKS AND HARDSCAPE AREAS.
 - DETAIL IS INTENDED FOR SIDEWALK WIDTHS OF 4 TO 6 FEET. CONTRACTOR SHALL COORDINATE WITH ARCHITECT OR ENGINEER FOR ANY SIDEWALK WIDTHS THAT EXCEED 6 FEET.

SIDEWALK

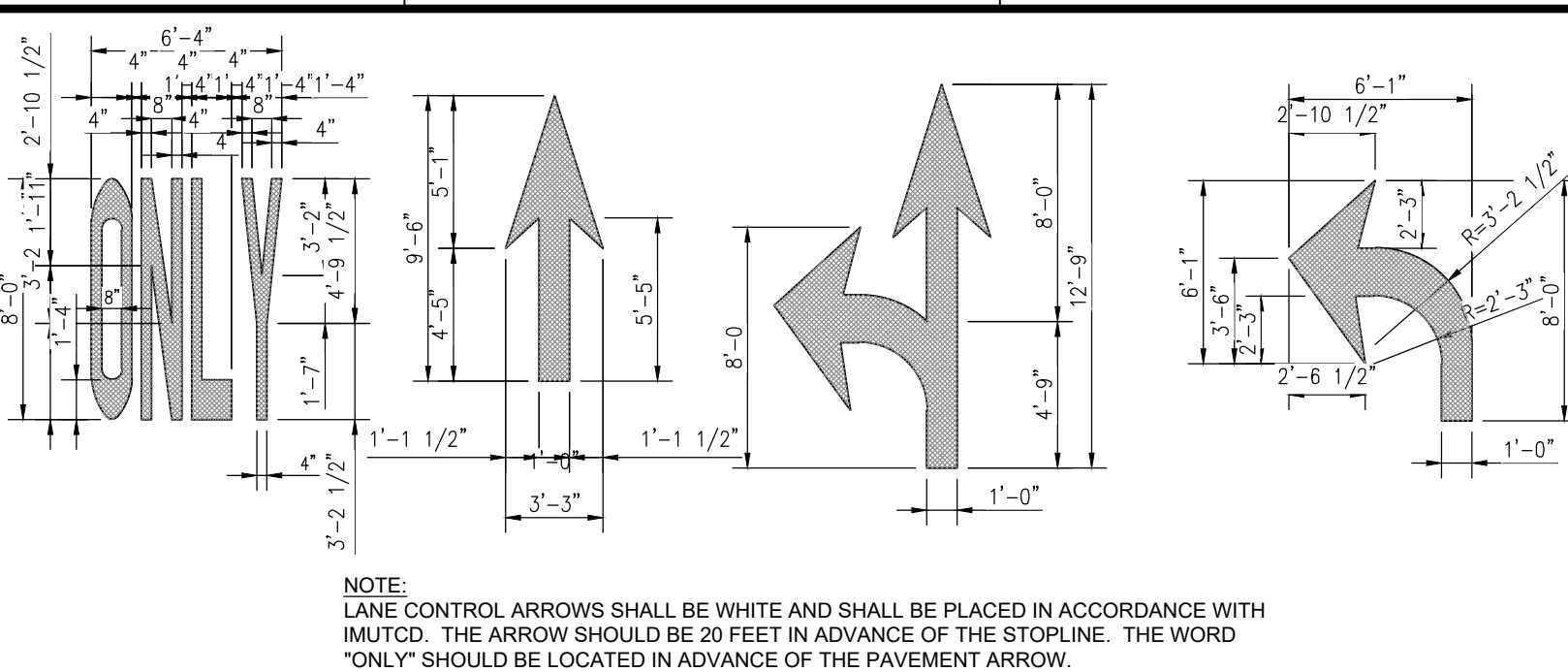

TRAFFIC MARKING DETAILS

(NO SCALE)

NOTE:
TYPICAL SIZES FOR NORMAL INSTALLATION. SIZES MAY
BE REDUCED APPROXIMATELY ONE-THIRD FOR
LOW-SPEED URBAN CONDITIONS.

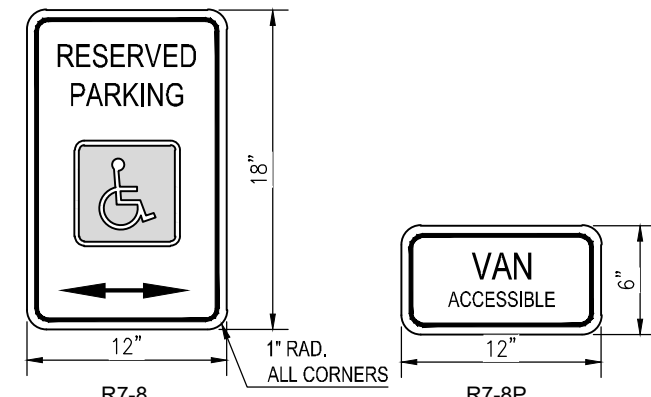

NOTE:
12"x18" 18 GAUGE HOT DIP GALVANIZED NON-REFLECTIVE SIGN.

NOTE:
WHERE PARKING SPACES THAT ARE RESERVED FOR PERSONS WITH
DISABILITIES ARE DESIGNATED TO ACCOMMODATE WHEELCHAIR VANS, A
VAN ACCESSIBLE (R7-8P) PLAQUE SHALL BE MOUNTED BELOW THE R7-8
SIGN. THE R7-8SIGN SHALL HAVE A GREEN LEGEND AND BORDER AND A
WHITE WHEELCHAIR SYMBOL ON A BLUE SQUARE ALL ON A WHITE
BACKGROUND. THE R7-8P PLAQUE SHALL HAVE A GREEN LEGEND AND
BORDER ON A WHITE BACKGROUND.

ACCESSIBLE SIGNS

(NO SCALE)

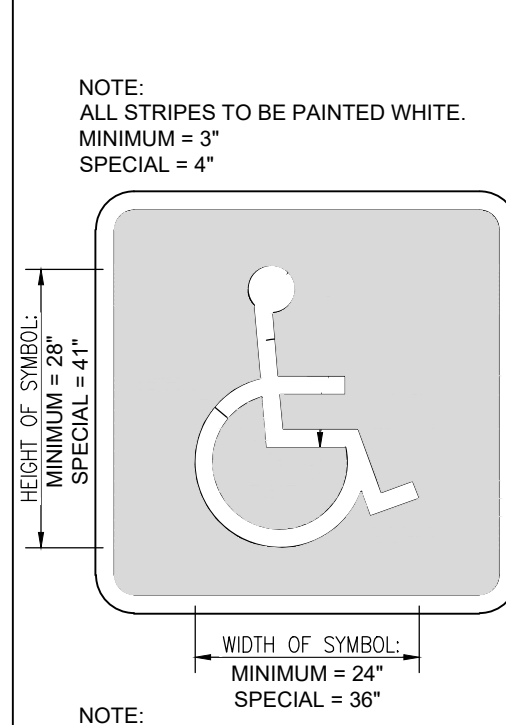

NOTE:
BLUE BACKGROUND AND
WHITE BORDER ARE OPTIONAL

ACCESSIBLE PARKING SYMBOL DETAIL

(NO SCALE)

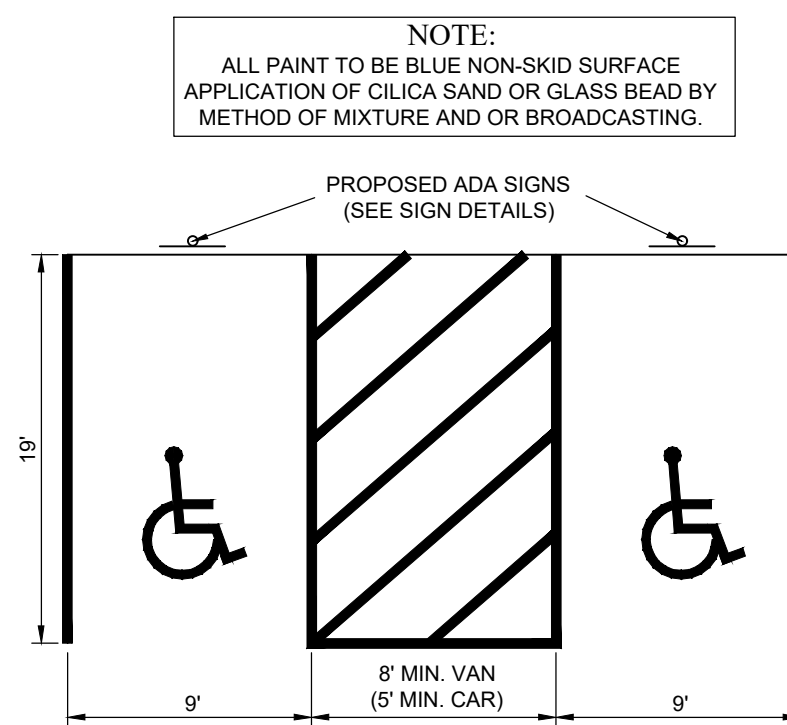

ACCESSIBLE PARKING SPACES

(NO SCALE)

ALL SIGNS SHALL COMPLY WITH U.S. DEPARTMENT OF TRANSPORTATION,
FEDERAL HIGHWAY ADMINISTRATIONS "MANUAL OF UNIFORM TRAFFIC
CONTROL DEVICES", LOCAL CODES AND AS SPECIFIED. MOUNT SIGNS TO
POST IN ACCORDANCE WITH MANUFACTURER'S INSTRUCTIONS.

WHERE PARKING SPACES THAT ARE RESERVED FOR PERSONS WITH
DISABILITIES ARE DESIGNATED TO ACCOMMODATE WHEELCHAIR VANS, A VAN
ACCESSIBLE (R7-8P) PLAQUE SHALL BE MOUNTED BELOW THE R7-8 SIGN.
THE R7-8SIGN SHALL HAVE A GREEN LEGEND AND BORDER AND A WHITE
WHEELCHAIR SYMBOL ON A BLUE SQUARE ALL ON A WHITE BACKGROUND.
THE R7-8P PLAQUE SHALL HAVE A GREEN LEGEND AND BORDER ON A WHITE
BACKGROUND.

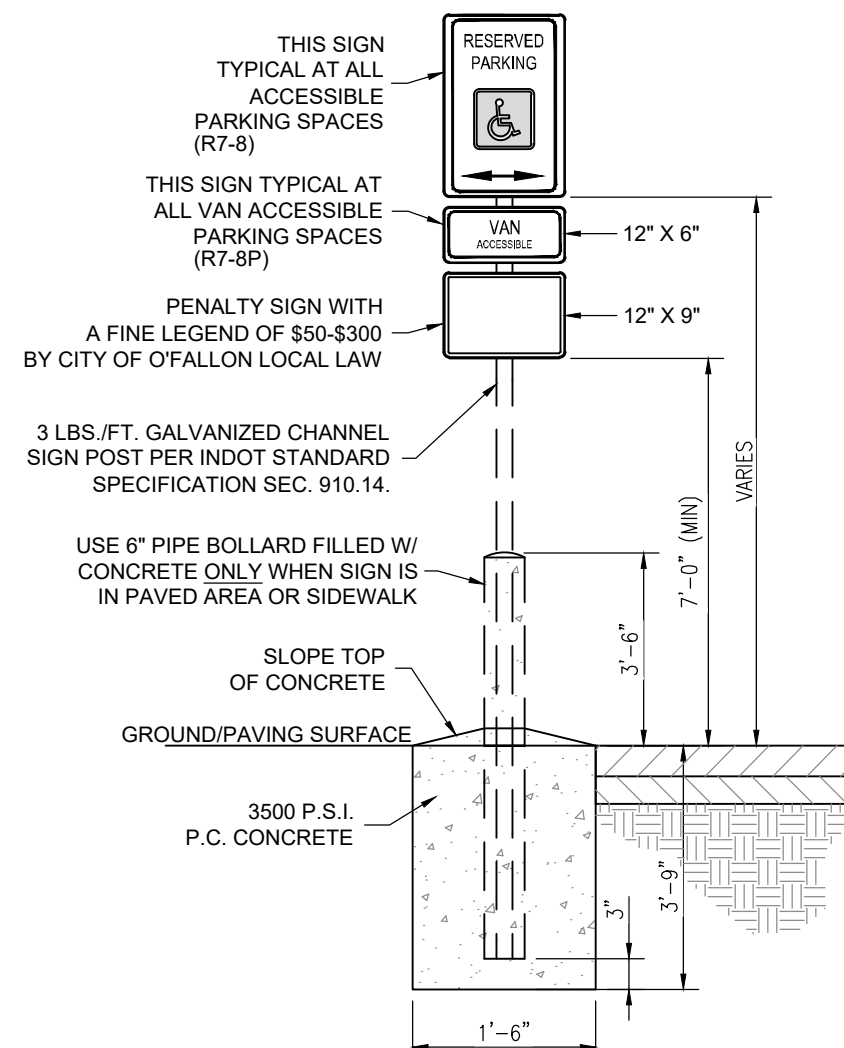

ACCESSIBLE SIGN BOLLARD MOUNT DETAIL

(NO SCALE)

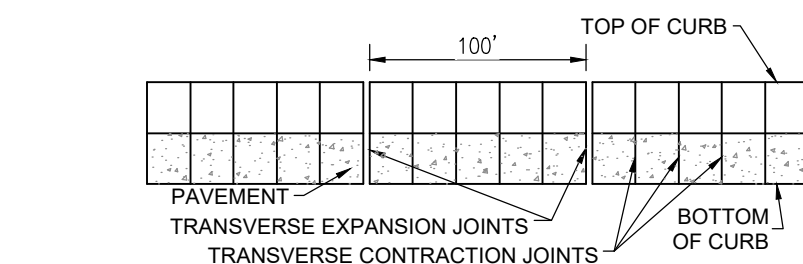

CURB JOINT DETAIL

(NO SCALE)

NOTE: MAXIMUM TRANSVERSE CONTRACTION JOINT DISTANCE 10 FEET
FOR TANGENT SECTIONS AND 5 FEET FOR RADIUS SECTIONS.

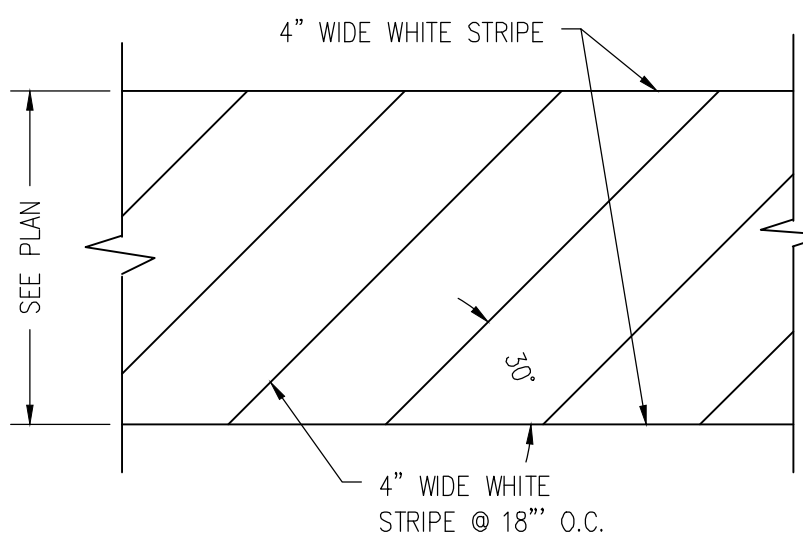

PEDESTRIAN CROSSWALK

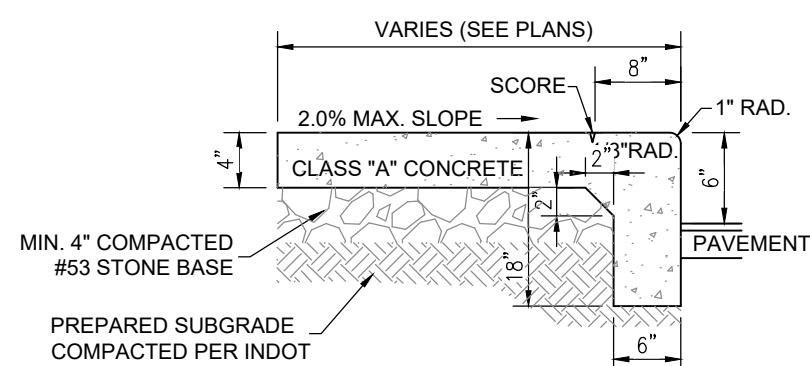

INTEGRAL WALK AND CURB DETAIL

(NO SCALE)

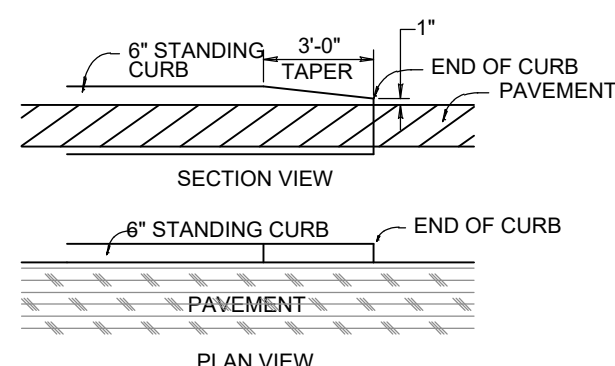

CURB TAPER DETAIL

(NO SCALE)

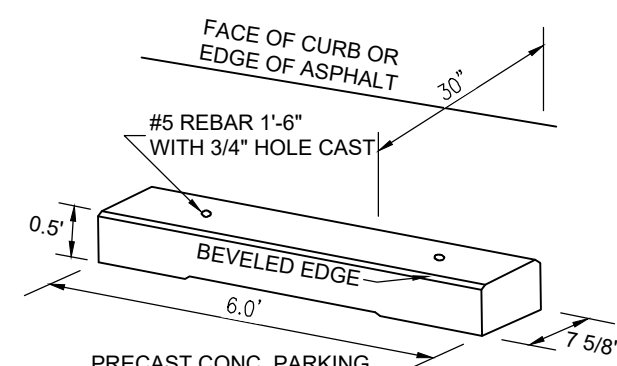

PARKING BARRIER

(NO SCALE)

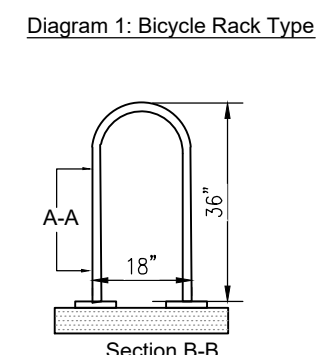

BICYCLE PARKING DETAIL

(NO SCALE)

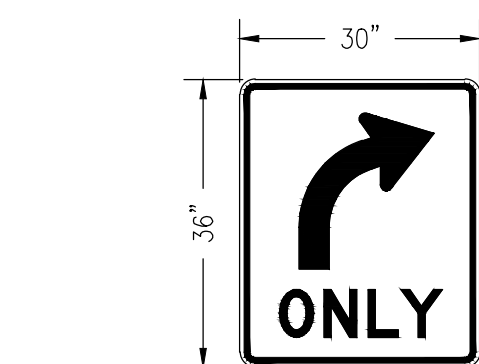

BLACK LEGEND ON WHITE BACKGROUND

R3-5R

"RIGHT TURN ONLY" SIGN

N.T.S.

10505 N. College Avenue
Indianapolis, Indiana 46280
weihe.net
317 | 846 - 6611
800 | 452 - 6408
317 | 843 - 0546 fax

WEIHE
ENGINEERS
Land Surveying | Civil Engineering
Landscape Architecture
Build with confidence.

PROJECT NO.:	W23.0784
DATE:	08/13/2024
BY:	DD
FOR:	ISSUED FOR CITY OF OFALLON COMMENTS
DATE:	08/28/2024
BY:	DD
FOR:	ISSUED FOR CITY OF OFALLON COMMENTS
DATE:	10/18/2024
BY:	DD
FOR:	ISSUED FOR CITY OF OFALLON COMMENTS
DATE:	12/31/2024
BY:	DD
FOR:	ISSUED FOR CITY OF OFALLON COMMENTS

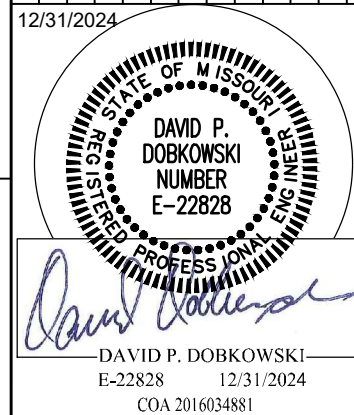

DAVID P. DOBKOWSKI
E-22828 12/31/2024
COA 201654881

PREPARED FOR:
HOTEL - CALEDONIA
LOT 4 AND 5, CALEDONIA CENTER, OFALLON, MO
63368
SITE PLAN DETAILS
PART OF SECTION 13, TOWNSHIP 48 NORTH, RANGE 2 EAST, ST. CHARLES COUNTY, MO.

SHEET NO.
C201
PROJECT NO.
W23.0784