

LOCATION: C:\2024\W23.0784 - STA\Engineering\Utility\CALEDONIA\CALEDONIA_C300_grading_plan.rvt
DATE/TIME: December 31, 2024 - 4:58pm
PLOTTER BY: belling

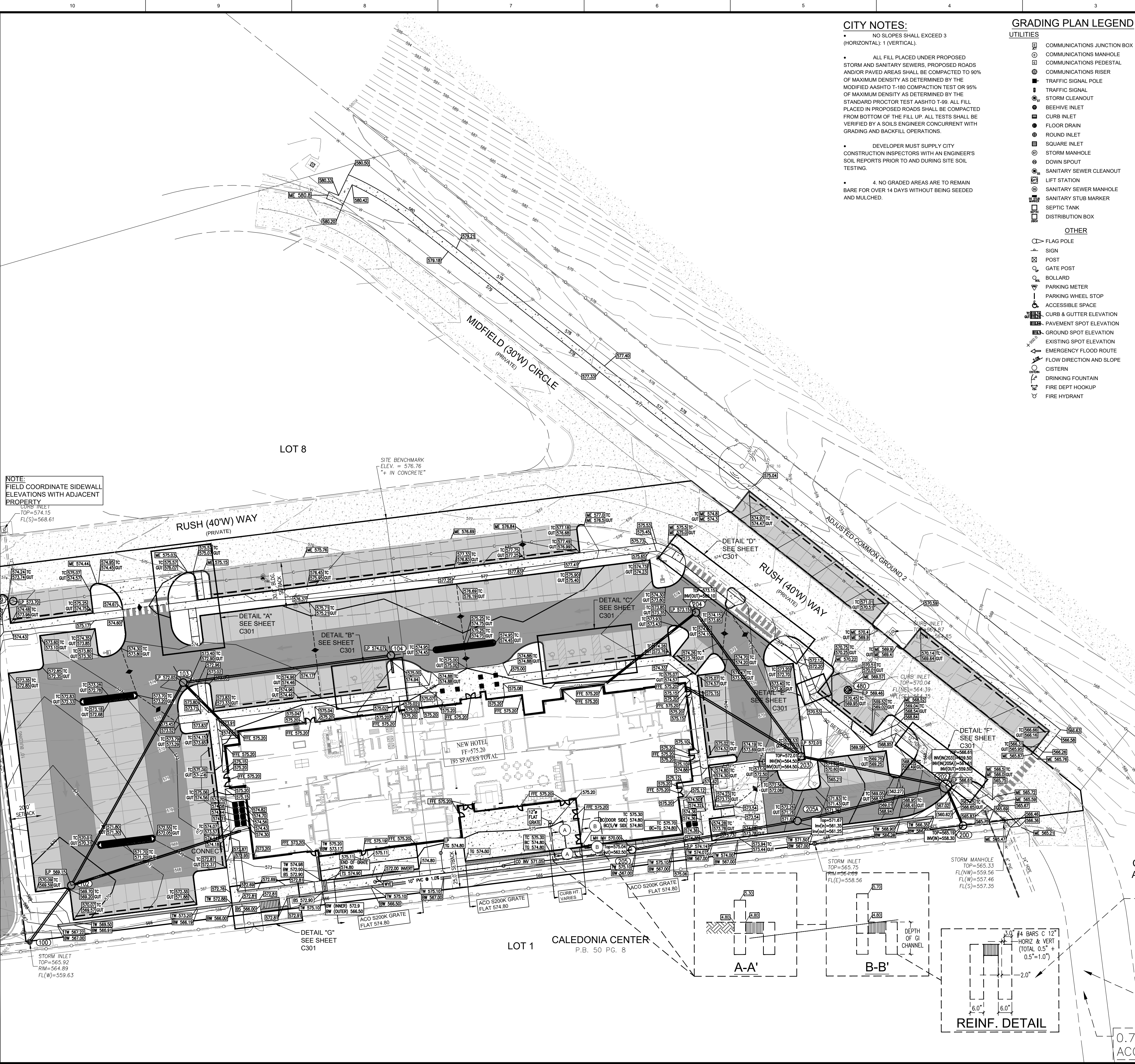

NOTE:
FIELD COORDINATE SIDEWALL
ELEVATIONS WITH ADJACENT
PROPERTY

- CITY NOTES:**
- NO SLOPES SHALL EXCEED 3 (HORIZONTAL): 1 (VERTICAL).
 - ALL FILL PLACED UNDER PROPOSED STORM AND SANITARY SEWERS, PROPOSED ROADS AND/OR PAVED AREAS SHALL BE COMPACTED TO 90% OF MAXIMUM DENSITY AS DETERMINED BY THE MODIFIED AASHTO T-180 COMPACTION TEST OR 95% OF MAXIMUM DENSITY AS DETERMINED BY THE STANDARD PROCTOR TEST AASHTO T-99. ALL FILL PLACED IN PROPOSED ROADS SHALL BE COMPACTED FROM BOTTOM OF THE FILL UP. ALL TESTS SHALL BE VERIFIED BY A SOILS ENGINEER CONCURRENT WITH GRADING AND BACKFILL OPERATIONS.
 - DEVELOPER MUST SUPPLY CITY CONSTRUCTION INSPECTORS WITH AN ENGINEER'S SOIL REPORTS PRIOR TO AND DURING SITE SOIL TESTING.
 - 4. NO GRADED AREAS ARE TO REMAIN BARE FOR OVER 14 DAYS WITHOUT BEING SEEDED AND MULCHED.

- GRADING PLAN LEGEND**
- UTILITIES**
- COMMUNICATIONS JUNCTION BOX
 - COMMUNICATIONS MANHOLE
 - COMMUNICATIONS PEDESTAL
 - COMMUNICATIONS RISER
 - TRAFFIC SIGNAL POLE
 - TRAFFIC SIGNAL
 - STORM CLEANOUT
 - BEEHIVE INLET
 - CURB INLET
 - FLOOR DRAIN
 - ROUND INLET
 - SQUARE INLET
 - STORM MANHOLE
 - DOWN SPOUT
 - SANITARY SEWER CLEANOUT
 - LIFT STATION
 - SANITARY SEWER MANHOLE
 - SANITARY STUB MARKER
 - SEPTIC TANK
 - DISTRIBUTION BOX
- OTHER**
- FLAG POLE
 - SIGN
 - POST
 - GATE POST
 - BOLLARD
 - PARKING METER
 - PARKING WHEEL STOP
 - ACCESSIBLE SPACE
 - CURB & GUTTER ELEVATION
 - PAVEMENT SPOT ELEVATION
 - GROUND SPOT ELEVATION
 - EXISTING SPOT ELEVATION
 - EMERGENCY FLOOD ROUTE
 - FLOW DIRECTION AND SLOPE
 - CISTERN
 - DRINKING FOUNTAIN
 - FIRE DEPT HOOKUP
 - FIRE HYDRANT

- POST INDICATOR VALVE**
- CHILLED WATER MANHOLE
 - WATER MANHOLE
 - SPRINKLER CONTROL BOX
 - SPRINKLER CONTROL VALVE
 - SPRINKLER
 - SPIGOT
 - WELL HEAD
 - WATER METER
 - WATER VALVE
 - GAS METER
 - GAS VALVE
 - ELECTRIC MANHOLE
 - ELECTRIC OUTLET
 - ELECTRIC METER
 - ELECTRIC RISER
 - TRANSFORMER
 - GUY ANCHOR
 - ELECTRIC JUNCTION BOX
 - GENERATOR
 - UTILITY POLE
 - UTILITY POLE W/ TRANSFORMER
 - MONITORING WELL
 - LIQUID PROPANE GAS TANK
 - ORNAMENTAL LIGHT
 - STREET LIGHT
 - PARKING LOT LIGHT (1 HEAD)
 - PARKING LOT LIGHT (2 HEAD)
 - PARKING LOT LIGHT (3 HEAD)
 - PARKING LOT LIGHT (4 HEAD)
- ABBREVIATIONS**
- ROW RIGHT OF WAY
 - ESMT EASEMENT
 - D.S.U.E. DRAINAGE AND UTILITY EASEMENT
 - FFE FINISH FLOOR ELEVATION
 - TC TOP OF CURB
 - GUT GUTTER
 - CMP CORRUGATED METAL PIPE
 - RCP REINFORCED CONCRETE PIPE
 - PVC POLYVINYL CHLORIDE PIPE
 - VCP VITRIFIED CLAY PIPE
 - HDPE HIGH DENSITY POLYETHYLENE PIPE
 - DIP DUCTILE IRON PIPE
 - SSD SUB SURFACE DRAIN PIPE
 - STM STORM
 - SAN SANITARY
 - STR STRUCTURE
 - CO CLEANOUT

GENERAL NOTES

THE SITE DOES NOT LIE IN A SPECIAL FLOOD HAZARD AREA AS ESTABLISHED BY THE FEDERAL EMERGENCY MANAGEMENT AGENCY - NATIONAL FLOOD INSURANCE PROGRAM, WHEN PLOTTED BY SCALE ON FLOOD INSURANCE RATE MAP #29183C0410G, DATED 01/20/2016.

EXISTING AREAS
PERVIOUS = 2.84± AC.
IMPERVIOUS = 0.05± AC.

PROPOSED AREAS
PERVIOUS = 0.60± AC.
IMPERVIOUS = 2.75± AC.

BENCHMARK INFORMATION

PROJECT BM
NNS CORP STATION "MOOF" ELEVATION = 596.94 (NAVD 88) OBSERVED
NAVD88 ELEVATIONS WERE DERIVED FROM GPS OBSERVATIONS
USING THE MISSOURI DEPARTMENT OF TRANSPORTATION VRS
NETWORK FROM BASE STATION "MOOF" USING TRIMBLE REAL-TIME
KINEMATIC GPS HARDWARE TAKEN ON FEBRUARY 12, 2024.

SITE BM
ELEVATION = 576.76 (NAVD 88)
"CROSS IN CONCRETE" FOUND IN THE CENTER OF RUSH WAY,
APPROXIMATELY 86 FEET NORTHEAST OF ITS INTERSECTION WITH
THE CENTERLINE OF MIDFIELD CIRCLE. 34 FEET NORTH OF A STORM
MANHOLE, 56 FEET NORTHWEST OF A CURB INLET AND 56 FEET
SOUTHWEST OF ANOTHER CURB INLET, LOCATION SHOWN HEREON.

PAVEMENT

- STANDARD DUTY ASPHALT
- HEAVY DUTY ASPHALT
- CONCRETE PAVEMENT

LINE TYPES

- RIGHT OF WAY LINE
- FENCE
- GUARD RAIL
- BOUNDARY LINE
- FLOW LINE
- INDEX CONTOUR
- INTERMEDIATE CONTOUR
- UNDERGROUND GAS
- UNDERGROUND WATER
- AERIAL ELECTRIC
- UNDERGROUND ELECTRIC
- UNDERGROUND COMMUNICATIONS
- AERIAL COMMUNICATIONS
- UNDERGROUND FIBER OPTIC
- AERIAL FIBER OPTIC CABLE
- OVERHEAD UTILITY
- FORCE MAIN
- SANITARY SEWER LATERAL
- SANITARY SEWER MAIN
- ROOF DRAIN
- SUB SURFACE DRAIN
- STORM SEWER MAIN
- GRADE BREAK LINE

LOT 3A

**CALEDONIA CENTER
AMENDED PLAT TWO**
P.B. 50 PG. 400

REFER TO ACO S200K
INSTALLATION MANUAL
DETAIL
<https://acoswm.com/drain/powerdrain/s200k/>

**CHANNEL
DEPTH**

**0.78' WIDE
ACO**

REINF. DETAIL

SCALE: 1" = 30'

10505 N. College Avenue
Indianapolis, Indiana 46280
weihe.net

317 | 846 - 6611
800 | 452 - 6408
317 | 843 - 0546 fax

ALLAN H. WEIHE, P.E., L.S. - FOUNDER

WEIHE
ENGINEERS

Land Surveying | Civil Engineering
Landscape Architecture

Build with confidence.

PROJECT NO: W23.0784
DWG NAME: 20784ST_C300 grading plan
DATE: 06/13/2024
ISSUED FOR CLIENT REVIEW
07/18/2024
DESIGNED BY: DD
CHECKED BY: DD
DATE: 08/29/2024

REVISIONS AND ISSUES

ISSUED FOR CLIENT REVIEW
07/18/2024
ISSUED FOR CITY OF OFALLON COMMENTS
10/16/2024

DAVID P. DOBKOWSKI
E-22828
12/31/2024
COA 20190488

DAVID P. DOBKOWSKI
E-22828
12/31/2024
COA 20190488

PREPARED FOR:
HOTEL - CALEDONIA
LOT 4 AND 5, CALEDONIA CENTER, OFALLON, MO
63068
GRADING PLAN
PART OF SECTION 13, TOWNSHIP 48 NORTH, RANGE 2 EAST, ST. CHARLES COUNTY, MO.

SHEET NO:
PROJECT NO:
W23.0784