

**SANITARY SEWER PROFILE**  
 HORIZONTAL SCALE: 1"=20'  
 VERTICAL SCALE 1"=10'

BAX PROJECT NAME :  
 BAX PROJECT NO. :  
 DESIGN DATE :  
 DESIGNED BY :  
 SUBMITTED: FILENAME: TAUC

| UPP STR | LOW STR | L   | DIA | UPPER FL LN | LOWER FL LN | PS   | UPPER ST EL | DEPTH HY GR | UPPER HY EL | LOWER HY EL | HYDR GRADE | FR HEAD | VEL  | VEL HEAD | JUNC LOSS | TURN LOSS | CURVE LOSS | STR GRADE | INL CAP | OR AREA | PI   | Q    | TO   | PIPE CAP | REMARKS      |
|---------|---------|-----|-----|-------------|-------------|------|-------------|-------------|-------------|-------------|------------|---------|------|----------|-----------|-----------|------------|-----------|---------|---------|------|------|------|----------|--------------|
| AI101   | G100    | 155 | 12  | 541.50      | 539.16      | 1.51 | 547.42      | 5.49        | 541.93*     | 540.06      | .00210     | 0.33    | 2.10 | 0.07     | 0.07      | 0.00      | 0.00       | 0.00      | 0.00    | 0.00    | 0.00 | 0.00 | 1.65 | 4.38     | 1 ITP 540.06 |

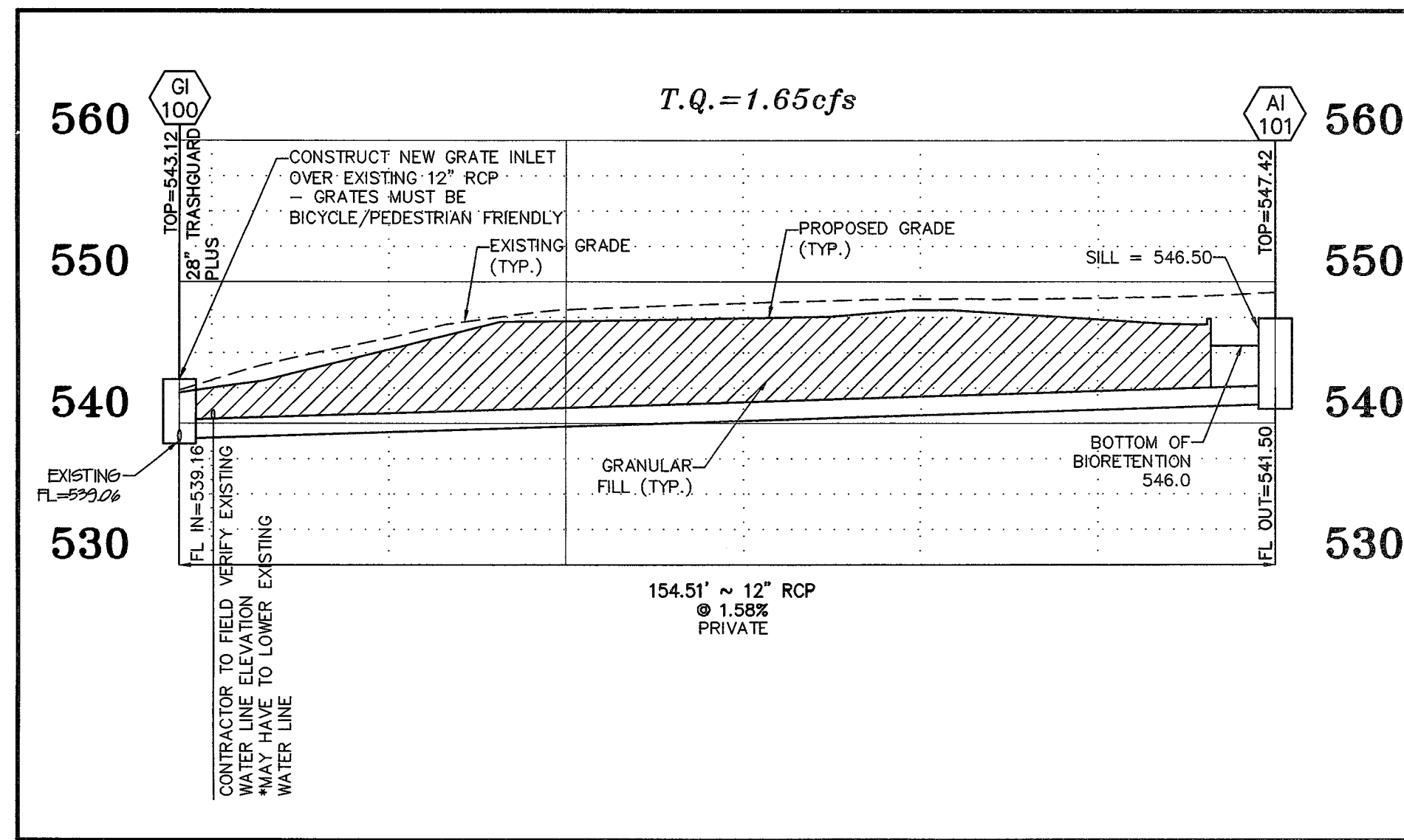

**STORM SEWER PROFILE**  
 HORIZONTAL SCALE: 1"=20'  
 VERTICAL SCALE 1"=10'

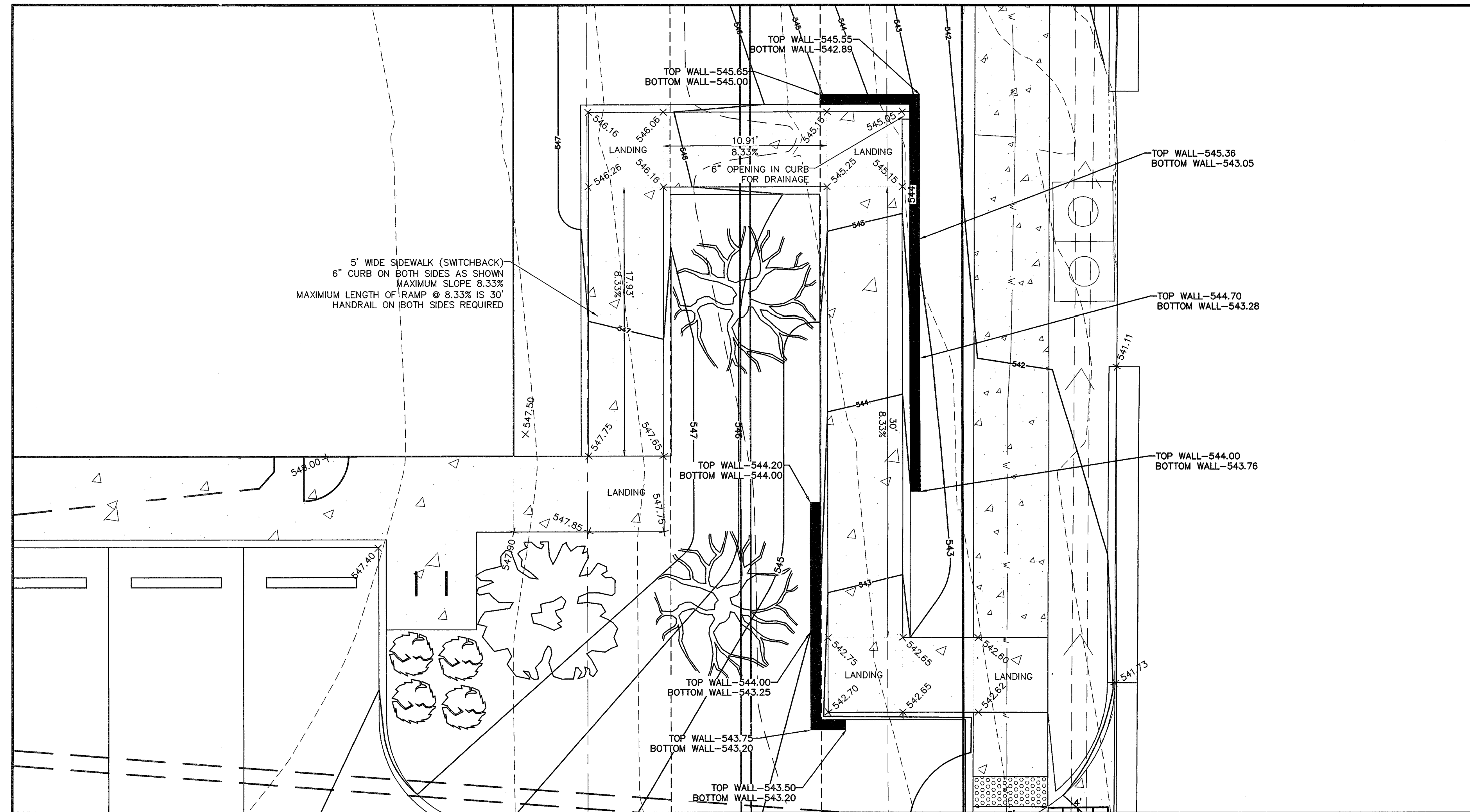

**SWITCHBACK ACCESSIBLE RAMP**  
 HORIZONTAL SCALE: 1"=5'

**PROJECT TITLE:**  
 TAUC PROPERTIES  
 OF FALLON MAIN  
 507 S. MAIN ST.

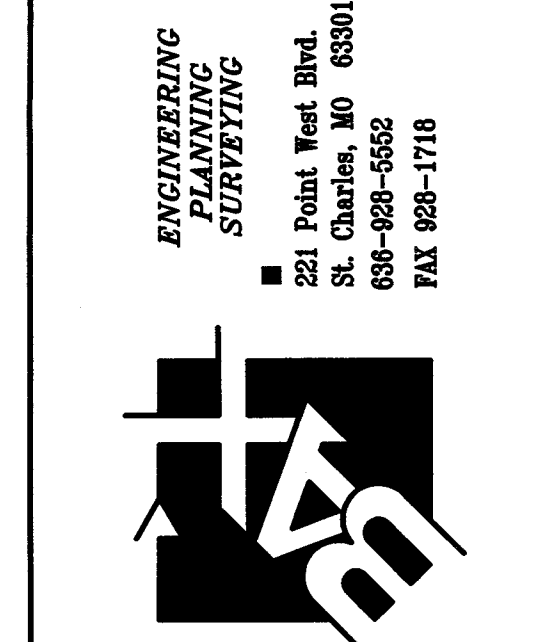

**DISCLAIMER OF RESPONSIBILITY:**  
 I hereby specify that the documents intended to be authenticated by my seal are limited to this sheet, and I hereby disclaim any responsibility for all other drawings, specifications, estimates, reports or other documents or instruments relating to or intended to be used for any project other than the architectural or engineering project specifically identified herein.

STATE OF MISSOURI  
 CLIFFORD L. HEITMANN  
 NUMBER E-29817  
 PROFESSIONAL ENGINEER  
 CIVIL ENGINEER  
 E29817

Copyright 2016  
 Box Engineering Company, Inc.  
 Engineering Authority No. 000655  
 Surveying Authority No. 000144  
 All Rights Reserved

**REVISIONS**

|          |                    |
|----------|--------------------|
| 8-31-16  | COMMENTS FROM CITY |
| 10-7-16  | COMMENTS FROM CITY |
| 12-28-16 | COMMENTS FROM CITY |

**Developer / Owner:**  
 DR. MATT BRUCKEL  
 TAUC PROPERTIES LLC  
 9556 MANCHESTER ROAD  
 ST. LOUIS, MO 63119

**SANITARY AND STORM PROFILE -  
 SIDEWALK SWITCHBACK DETAIL**

**P+Z No.**  
 19-16 (approved 7-7-16)

**City No.**  
 16-000028

**Page No.**  
 8 of 19

**CALL BEFORE YOU DIG!**  
 1-800-DIG-RITE

\*UNDERGROUND PIPELINES PRESENT

Bax Project # 95-6396A Issue Date: 8-14-16