

**320511-P-RETAINING WALL 1 PROFILE**  
SCALE H:1"=30'; V:1"=6'

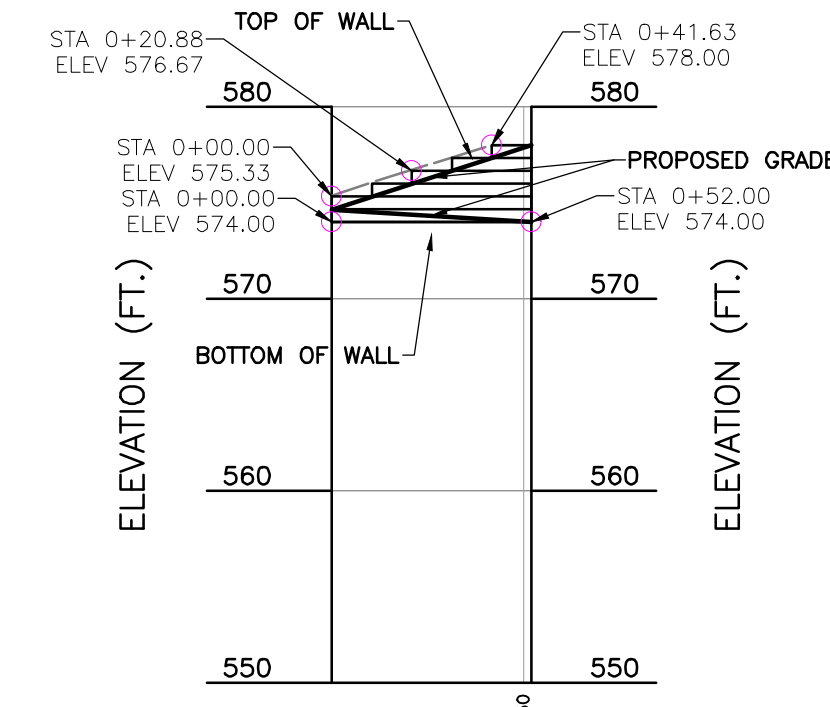

**320511-P-RETAINING WALL 2 PROFILE**  
SCALE H:1"=30'; V:1"=6'

**RETAINING WALLS**

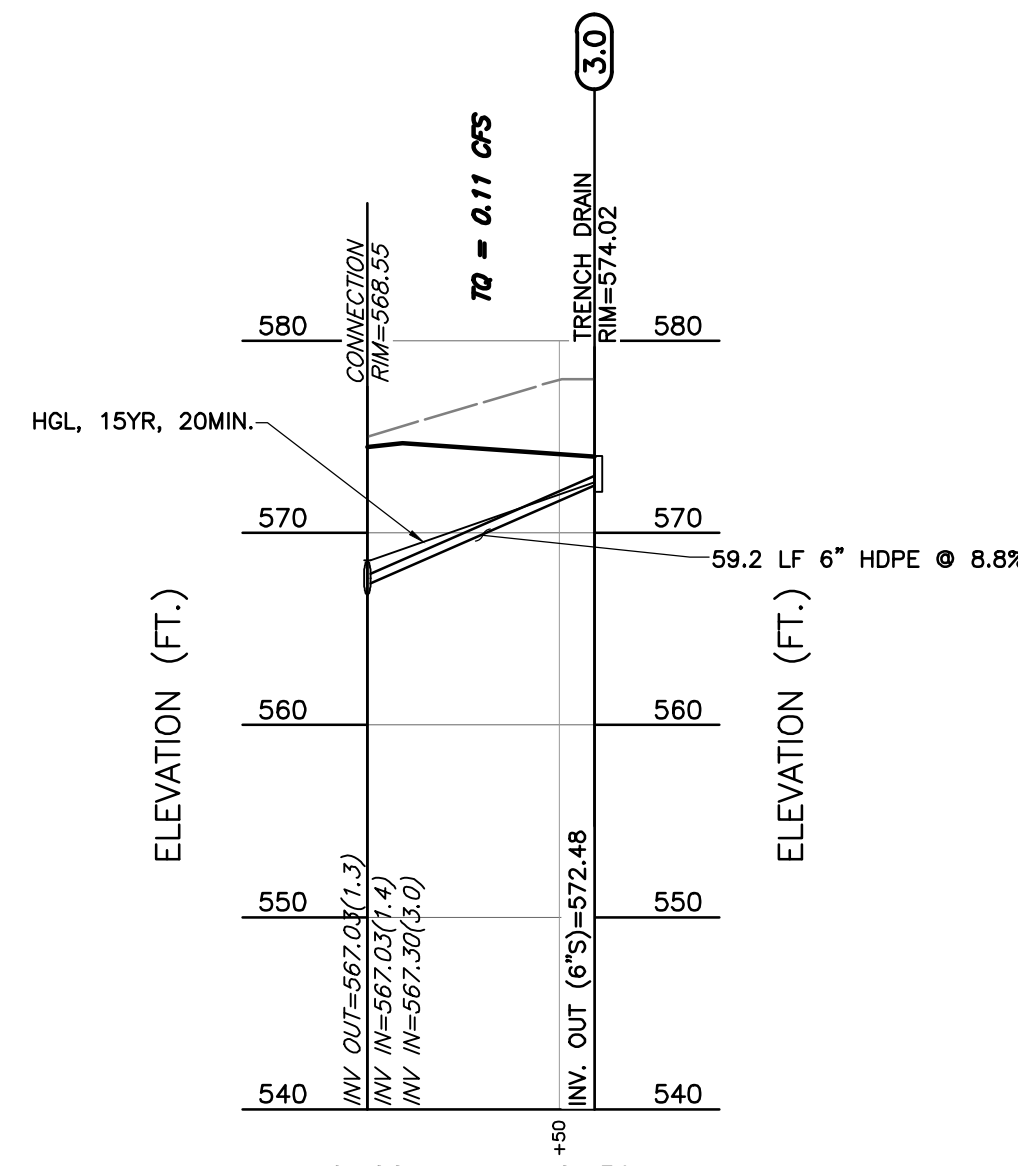

**320511-P-STM 1 PROFILE**  
SCALE H:1"=50'; V:1"=10'  
**TRENCH DRAIN**

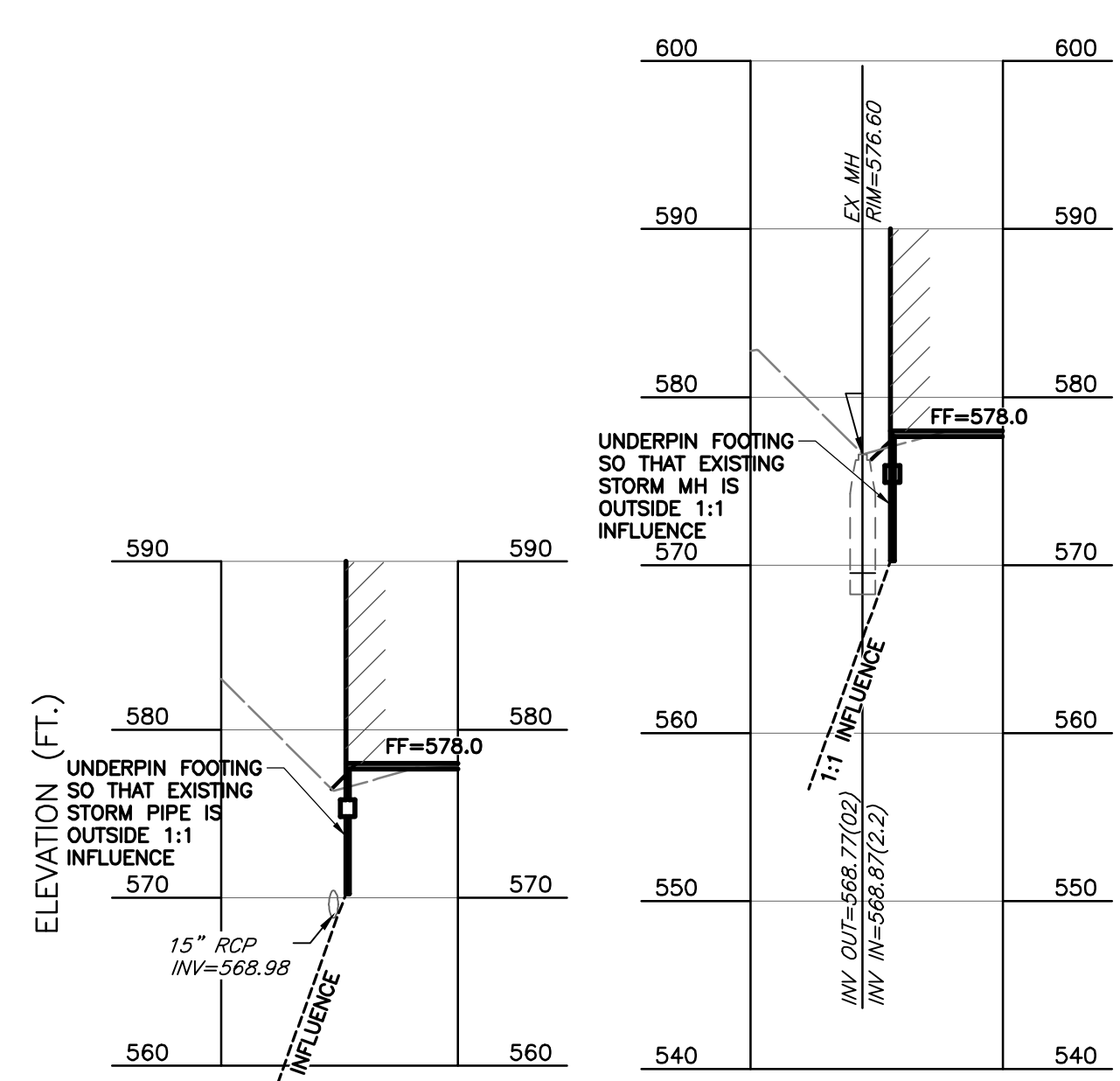

**A-A PROFILE**  
SCALE H:1"=50'; V:1"=17'

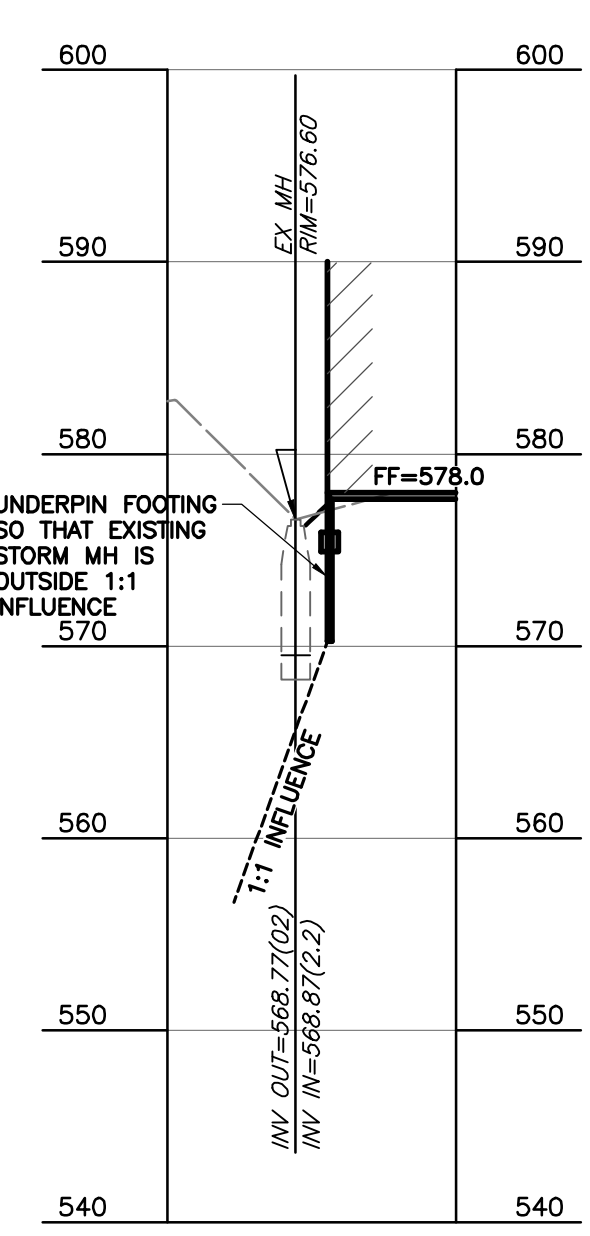

**B-B PROFILE**  
SCALE H:1"=50'; V:1"=17'

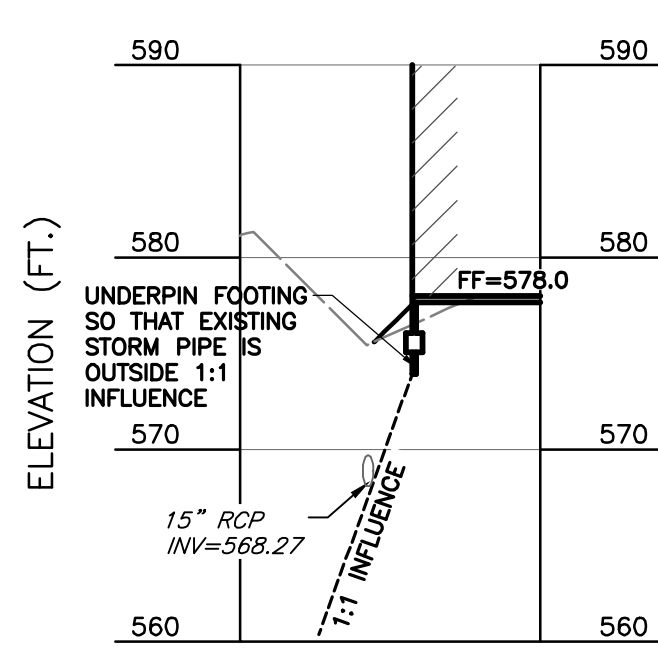

**C-C PROFILE**  
SCALE H:1"=50'; V:1"=17'

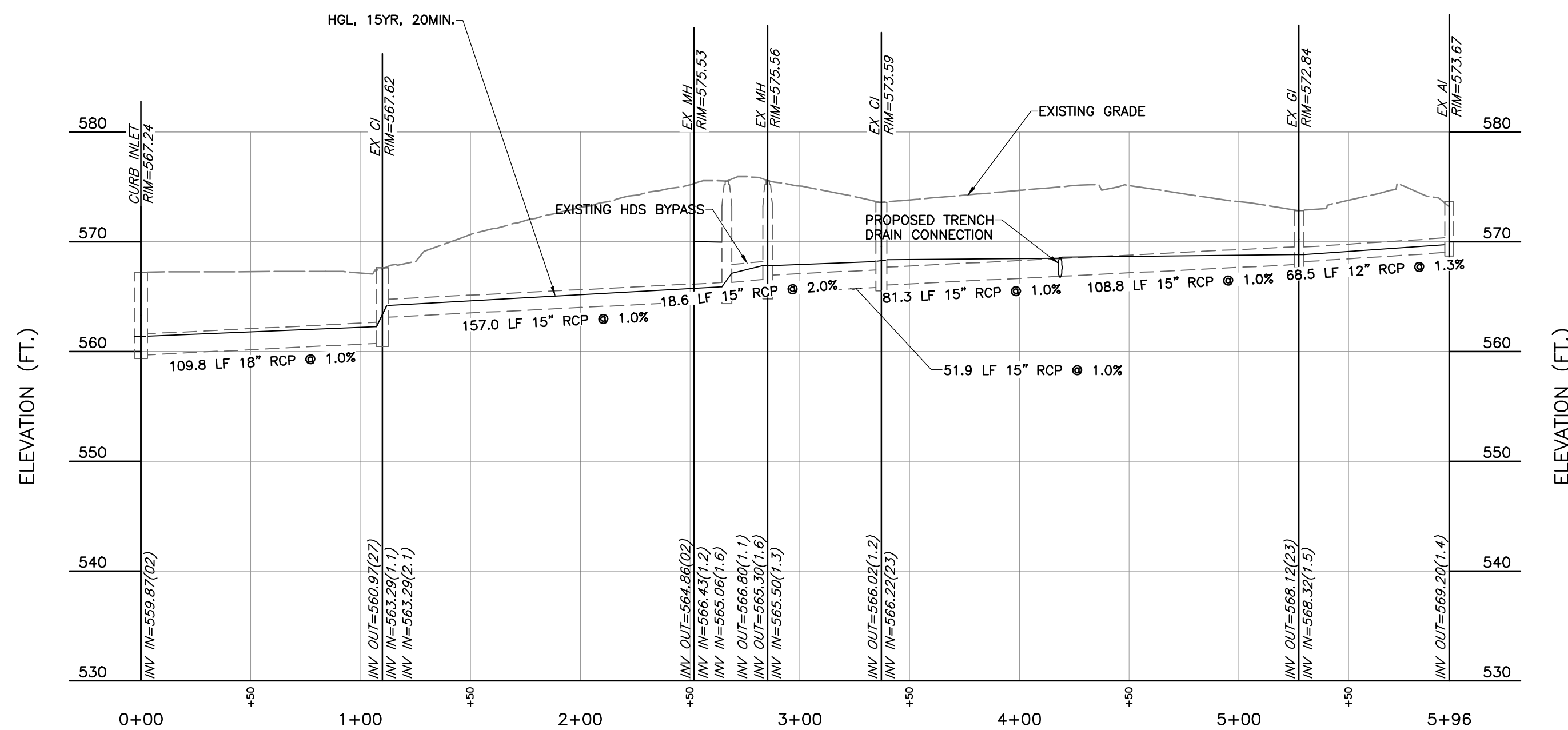

**320511-X-STM 1 PROFILE**  
SCALE H:1"=50'; V:1"=10'

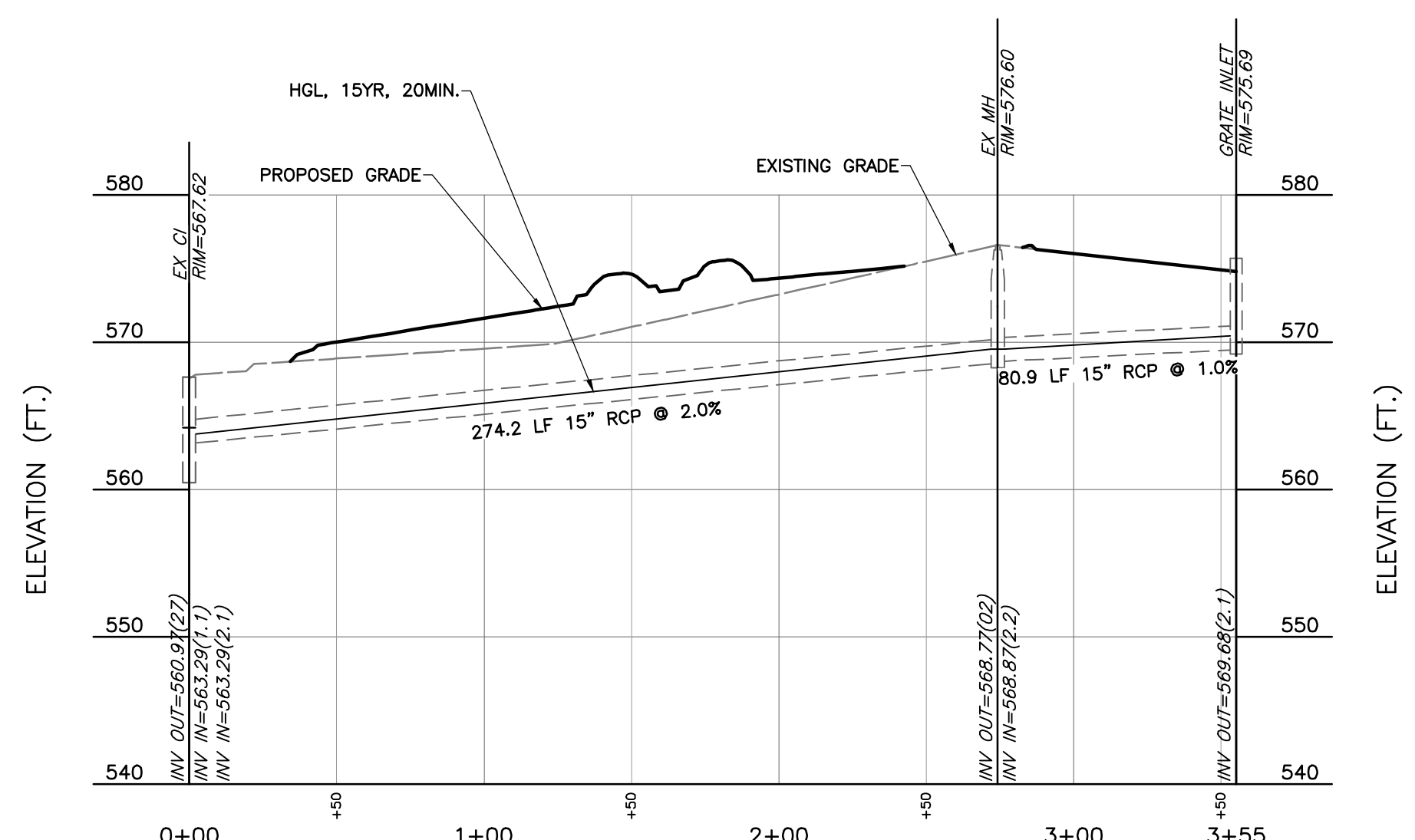

**320511-X-STM 2 PROFILE**  
SCALE H:1"=50'; V:1"=10'

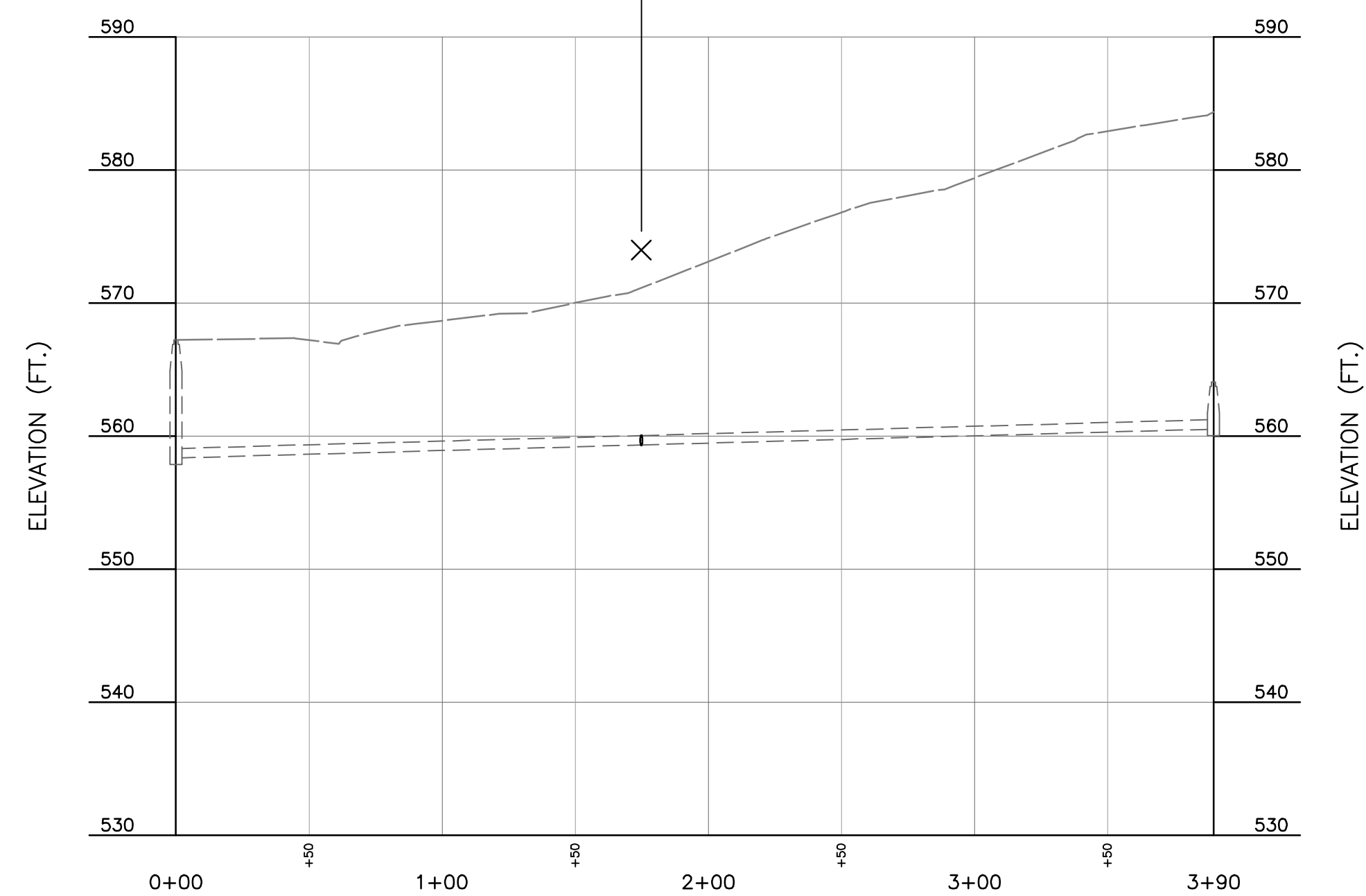

**320511-X-SAN PROFILE**  
SCALE H:1"=50'; V:1"=10'  
**SANITARY LATERAL**

STL WHOLESAL  
CONSTRUCTION PLANS  
PROFILES

**Civil & Environmental Consultants, Inc.**  
3000 Little Hills Expressway · Suite 102 · St. Charles, MO 63301  
314-656-4566 · 866-250-3679  
www.ccecinc.com

DRAWN BY:	WTS
CHECKED BY:	KAS
APPROVED BY:	KAS
PROJECT NO:	320-910001

Owner:  
**Pinkerton Properties LLC**  
801 Texas Court  
O'Fallon MO 63366  
**City of O'Fallon Site Plan**

P+Z No: 22-012944  
Approval Date:  
**MARCH 2, 2023**  
City No. 23-003172

Page No.  
**C600**

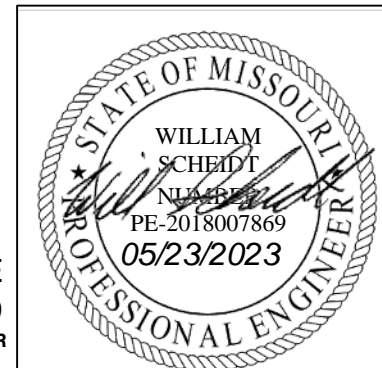

WILLIAM SCHEIDT, PE  
2018007869  
PROFESSIONAL CIVIL ENGINEER