

DUMPSTER FENCE ELEVATION (REAR)
(SCALE: N.T.S.)

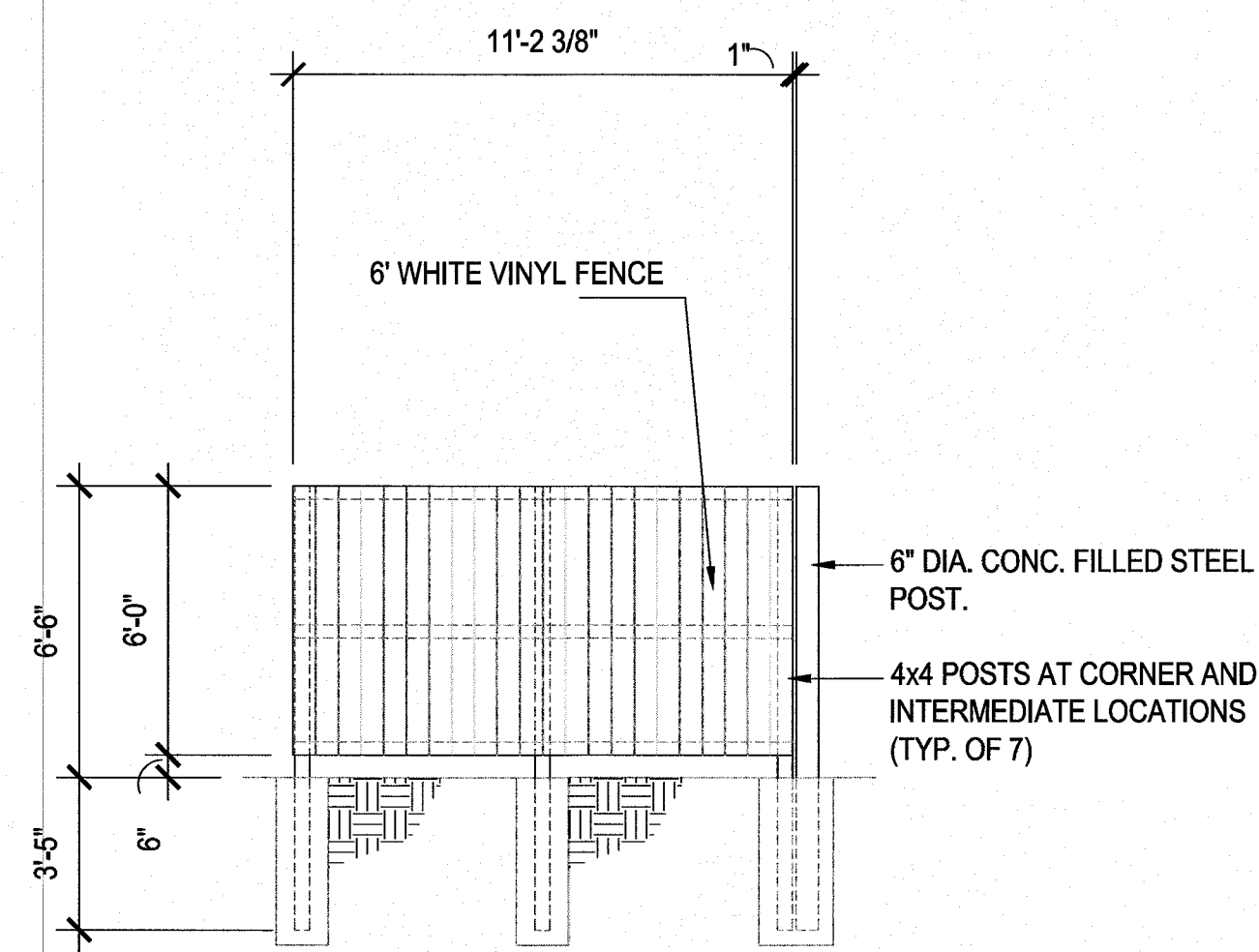

DUMPSTER FENCE ELEVATION
(SCALE: N.T.S.)

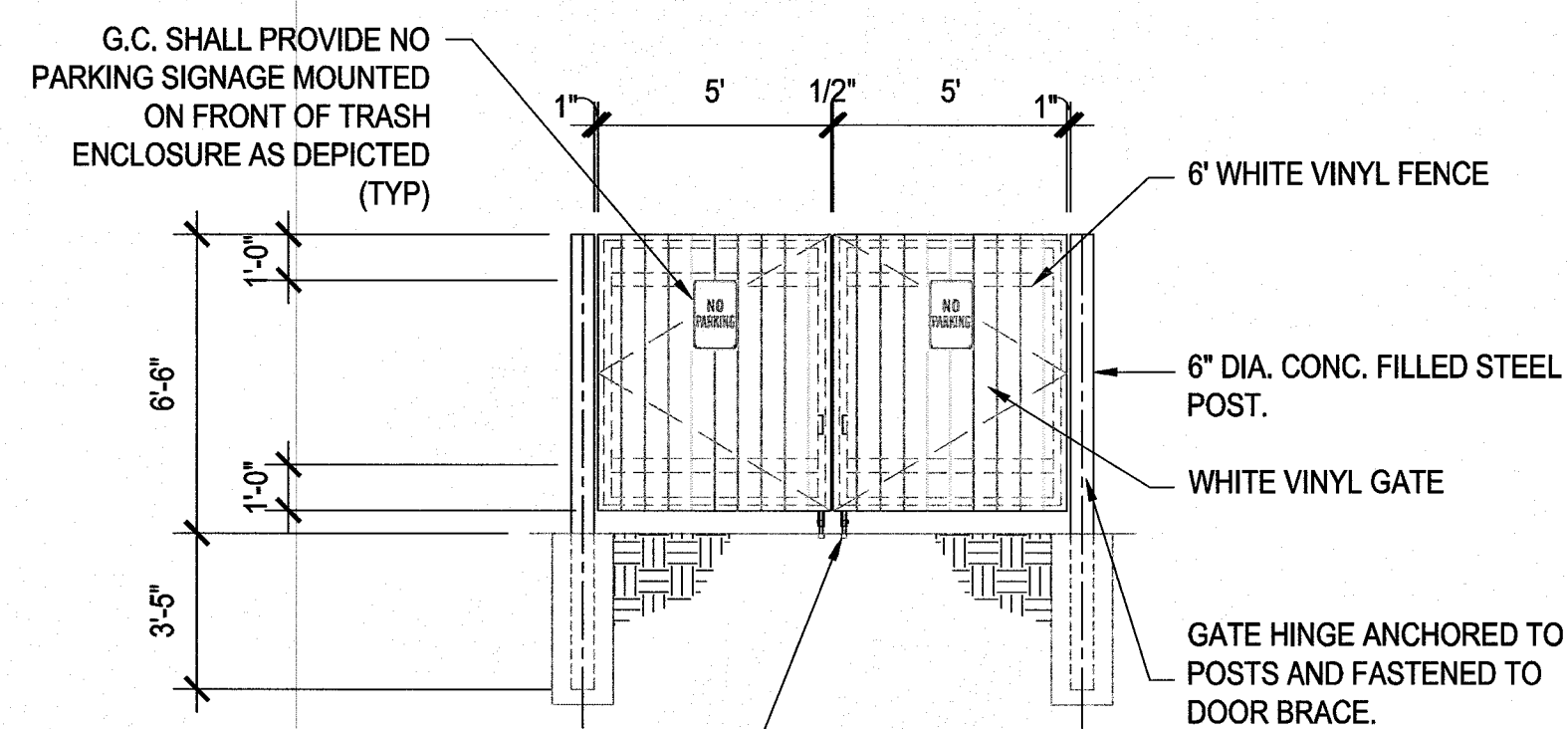

DUMPSTER GATE ELEVATION
(SCALE: N.T.S.)

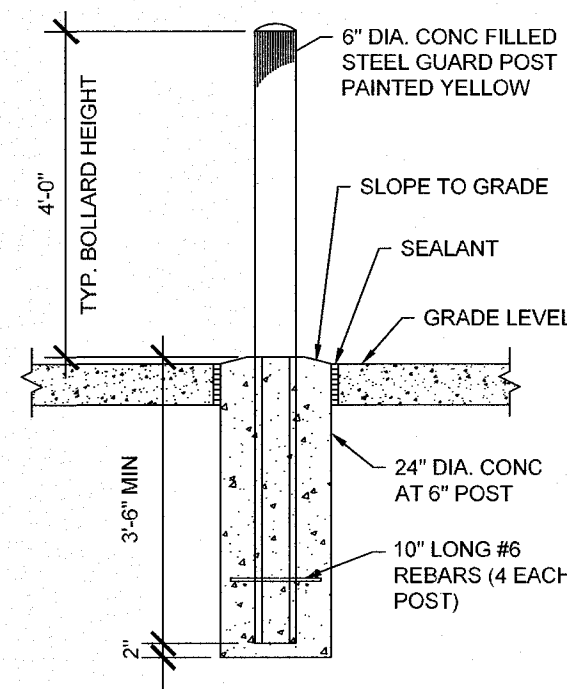

BOLLARD DETAIL
(SCALE: N.T.S.)

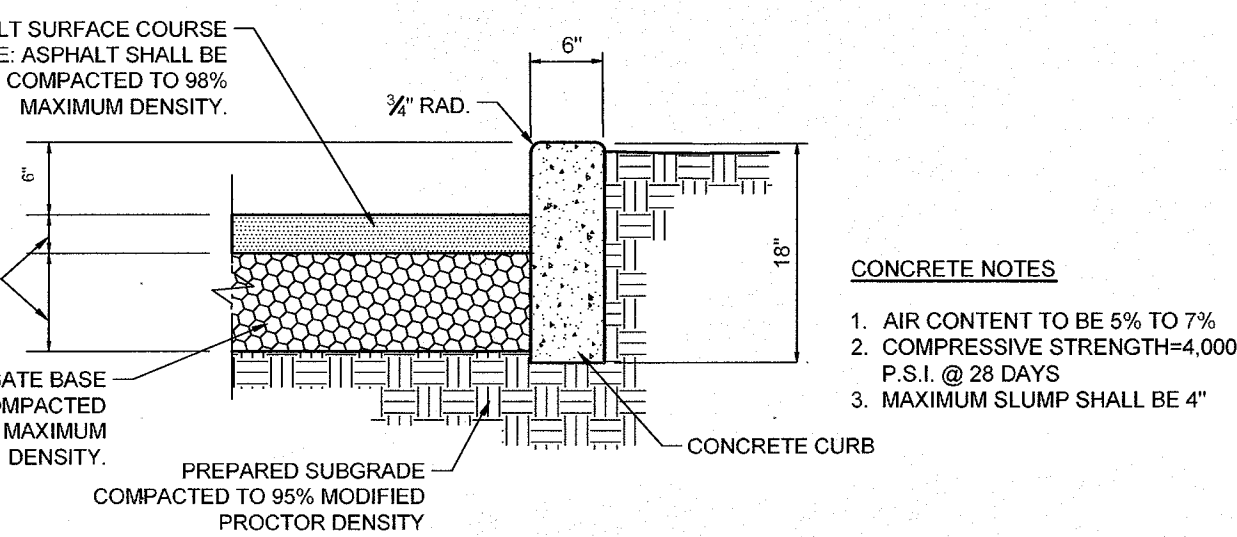

6" VERTICAL CONCRETE CURB DETAIL
(SCALE: N.T.S.)

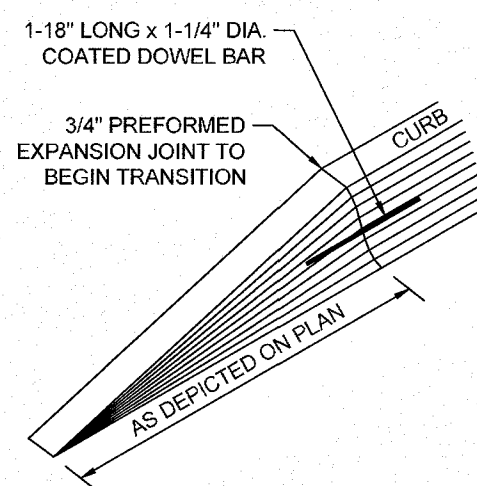

CURB TAPER DETAIL
(SCALE: N.T.S.)

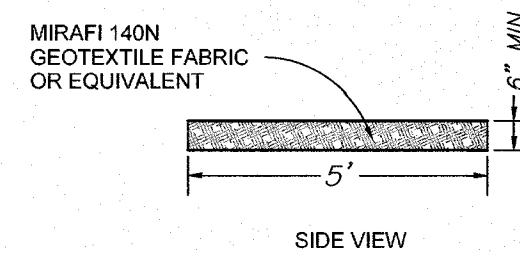
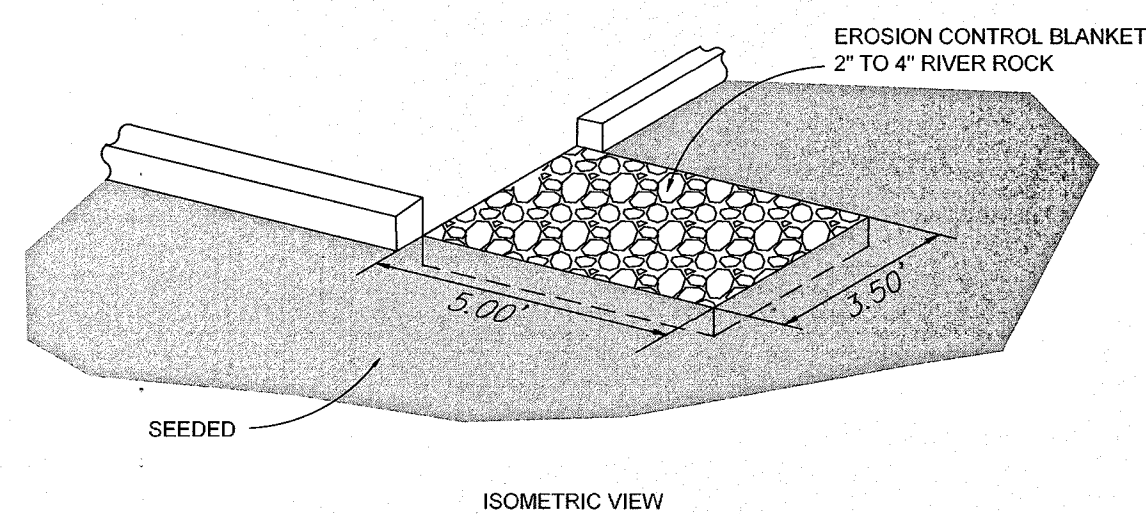

DRAIN SPLASH DETAIL
(SCALE: N.T.S.)

STRIPING AND SIGNAGE NOTES:

- PAVEMENT MARKING PAINT: ALKYD-RESIN TYPE, LEAD AND CHROMATE FREE, READY MIXED, COMPLYING WITH FS TT-P-115, TYPE I OR AASHTO M 248, TYPE N.
- NEW ACCESSIBLE STRIPING FOR STALLS AND ACCESS AISLES SHALL BE OUTLINED IN BLUE PER LOCAL REQUIREMENTS. STRIPING VENDOR SHALL VERIFY LOCAL CODE. ALL OTHER NEW STRIPING SHOULD MATCH EXISTING SCHEME.
- DO NOT APPLY PAVEMENT-MARKING PAINT UNTIL LAYOUT, COLORS, AND PLACEMENT HAVE BEEN VERIFIED WITH REGISTERED DESIGN PROFESSIONAL. A COLOR SAMPLE AND SKETCH IS TO BE PROVIDED TO DESIGN PROFESSIONAL.
- SWEEP AND CLEAN SURFACE TO ELIMINATE LOOSE MATERIAL AND DUST DAILY.
- APPLY PAINT WITH MECHANICAL EQUIPMENT TO PRODUCE PAVEMENT MARKINGS WITH UNIFORM STRAIGHT EDGES. APPLY AT MANUFACTURER'S RECOMMENDED RATES TO PROVIDE MINIMUM WET FILM THICKNESS OF 15 MILS (0.4 MM).
- 4" WIDE STRIPES IN ACCESS AISLES SHALL BE 2" ON CENTER.

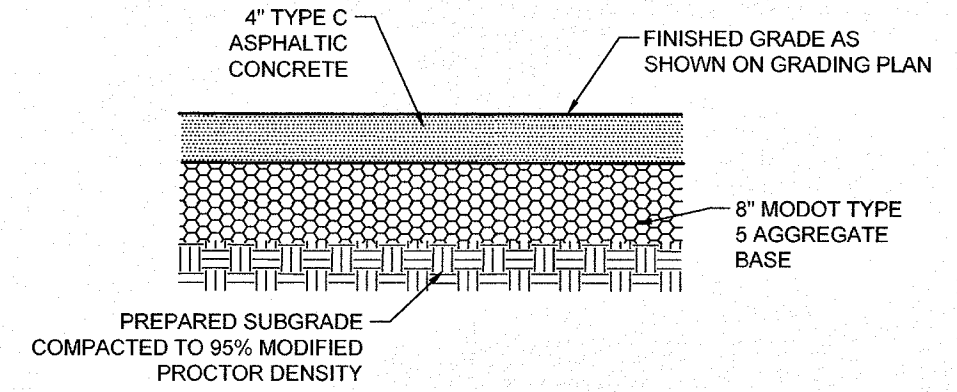

LIGHT DUTY PAVEMENT DETAIL
(SCALE: N.T.S.)

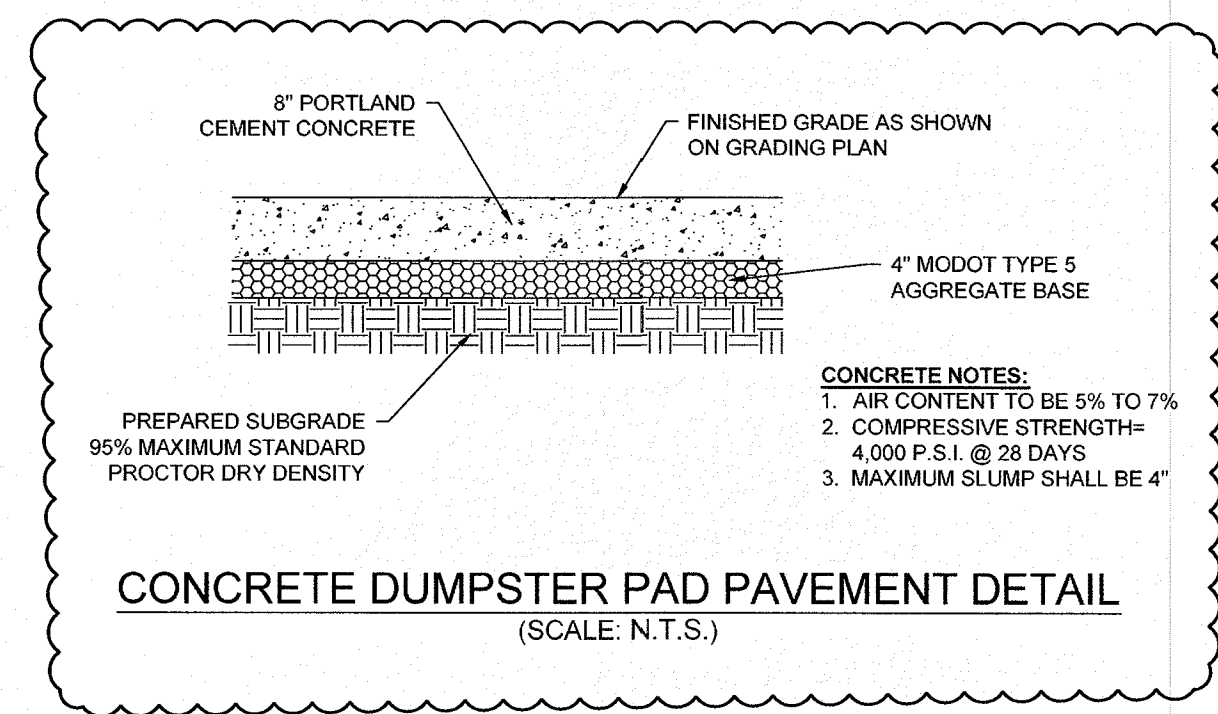

CONCRETE DUMPSTER PAD PAVEMENT DETAIL
(SCALE: N.T.S.)

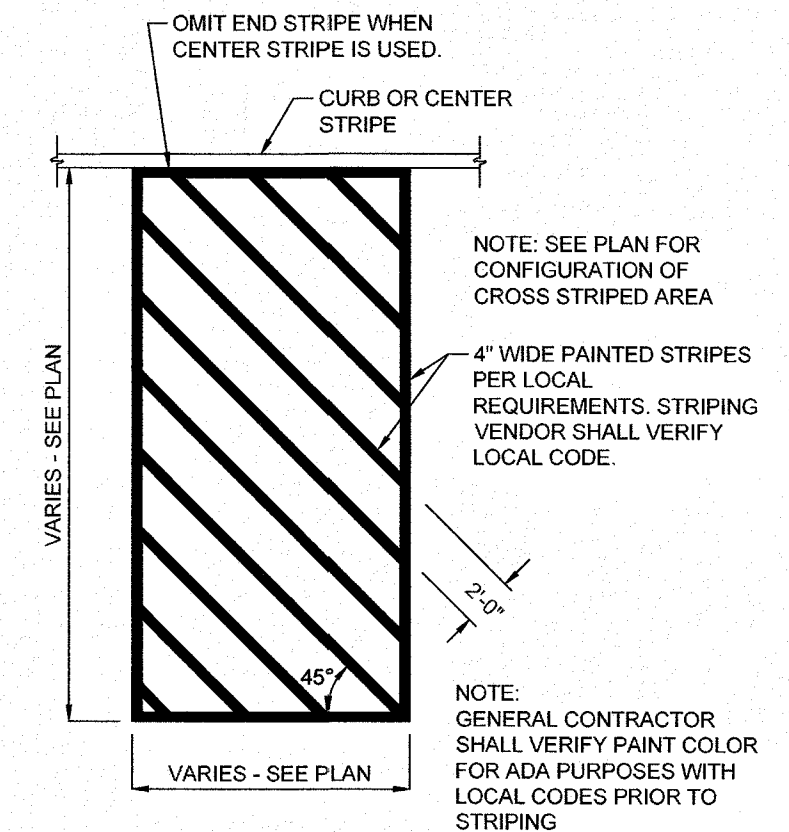

CROSS STRIPING DETAIL
(SCALE: N.T.S.)

NOTE: ASPHALT PAVEMENT PARKING LINES 4" WIDE PAINTED WHITE WITH TWO (2) COATS OF SHERWIN WILLIAMS "HOTLINE" FAST DRYING TRAFFIC MARKING PAINT. REFER TO DETAILS FOR ADDITIONAL INFORMATION.

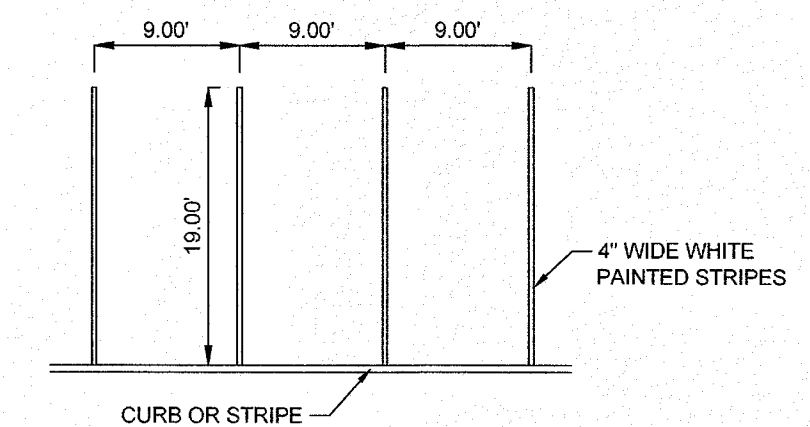

TYPICAL PARKING DIMENSIONS
(SCALE: N.T.S.)

REVISED PER CITY OF O'FALLON COMMENTS DATED 10/25/2016

SITE ADDRESS: 835 WEST TERRA LANE
O'FALLON, MISSOURI 63366

PROJECT TITLE



PREMIER CIVIL ENGINEERING

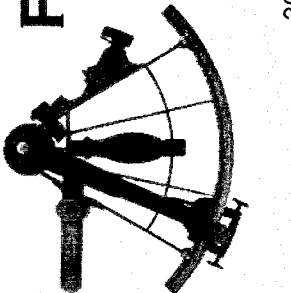

308 TCW Court
Lake Saint Louis, MO 63367
Phone: (314) 925-7444 Fax: (314) 925-7457
Missouri Certificate of Authority # E-2011000031
Missouri Certificate of Authority # LS-2012007849

ENGINEERS AUTHENTICATION
The responsibility for professional engineering liability on this project is hereby limited to the seal of the engineer who has signed, sealed, and dated hereon attached. Responsibility is disclaimed for all other engineering plans involved in this project and specifically includes revisions after the date herein reauthorized.

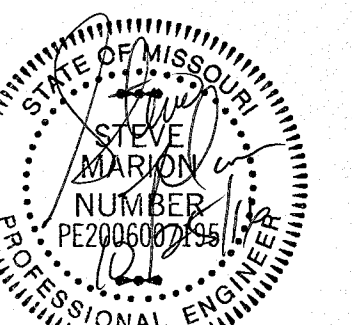

STEVE MARSTON P.E.
ENGINEER
PE200600795

Developer / Owner Information

LIGHTHOUSE PENTECOSTAL CHURCH
835 WEST TERRA LANE
O'FALLON, MO 63366

CONSTRUCTION DETAILS

P+Z No. APPROVED: JULY 7, 2016

City No. 08-11.03

Sheet Number:

C6.0

PCE PROJECT NO. 162201



NOTE:
Underground utilities and structures have been plotted from available information and therefore, their location must be considered approximate only. It is the responsibility of the individual contractors to notify the utility companies before actual construction.

All O.S.H.A. rules and regulations established for the type of construction required by these plans shall be strictly followed (i.e. trenching, blasting, etc.).