

KEYED NOTES:

- 1 SAWCUT FULL DEPTH FOR A CLEAN EDGE. REMOVE EXISTING PAVEMENT AND CURB AS NECESSARY.
- 2 EXISTING LIGHT POLE TO REMAIN IN PLACE AND SHALL BE PROTECTED DURING CONSTRUCTION.
- 3 REMOVE SITE LIGHT, POLE, BASE AND FEEDERS PER APPLICABLE CODES. REUSE POLE AND LIGHT IN NEW LOCATION, SEE UTILITY PLAN.
- 4 EXISTING TRANSFORMER TO BE RELOCATED BY AMEREN UE, SEE UTILITY PLAN.
- 5 EXISTING BIKE RACK TO BE RELOCATED, SEE SITE PLAN.

NOTES:

SEE SHEET C001 FOR SYMBOLOLOGY LEGEND.
 A CLEAN, FULL DEPTH SAWCUT SHALL BE PROVIDED IN ALL AREAS WHERE PROPOSED PAVEMENT MEETS EXISTING PAVEMENT.
 DURING CONSTRUCTION CONTRACTOR SHALL PROTECT ALL APPURTENANCES THAT ARE TO REMAIN.
 PROTECT IN PLACE ALL TREES, WALKS, ROADS, VEHICLE CONTROL POSTS, AND LIGHTS TO REMAIN. REMOVE AND REINSTALL THESE ITEMS IN AREAS WHERE THEY CANNOT REMAIN DURING CONSTRUCTION. LEAVE REMAINING SYSTEMS FULLY OPERATIONAL.

LEGEND:

- ALL TREES, SHRUBS, BRUSH, PAVEMENT AND SIDEWALK WITHIN THE HATCHED AREA SHALL BE REMOVED. UNDERGROUND UTILITIES SHALL BE LEFT IN PLACE UNLESS OTHERWISE NOTED.
- PAVEMENT MILLING AREA, SEE SITE PLAN. EXISTING CURBING TO BE LEFT IN PLACE UNLESS OTHERWISE NOTED.

| ISSUE | REMARKS/DATE |
|-------|------------------------|
| 1 | REVISION 2 (8/15/2017) |

Aldi, Inc.
 475 Pearl Drive
 O'Fallon, Missouri 63376
 Ph. (636) 278-4700

SAWYER ENGINEERING, INC.
 P.O. Box 157
 Gillespie, Illinois 62033
 Phone 314-800-5914
 Fax 618-982-6113
 SawyerEngr.com

ALDI O'FALLON, MO
 8615 Veterans Memorial Parkway, O'Fallon, Missouri 63366
EXISTING CONDITIONS

Date: 8/15/2017
 John P. Sawyer, PE
 License No. E-2001031672
 Civil Engineer

Job Number: 2016-130
 Date: 8/15/2017
 Designed: SWU Sheet
 Drawn: SWU **C100**
 Checked: JPS

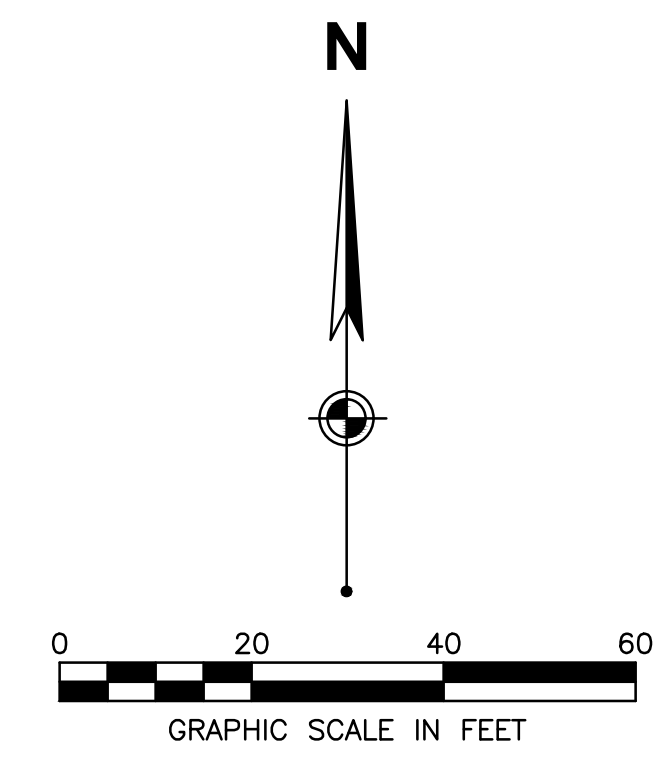

Drawing name: X:\Sawyer\Engineering\Working\O'Fallon, MO\Drawings\2017-08-01-SitePlan\2016-130-EX1.dwg Plotted on: Aug 17, 2017 - 8:06am Plotted by: User