

A:\ALDI\CIVIL\O'Fallon, Mo\Design 64702\64702-PRO.dwg, Plotted By: bruced, Plotted: Jul 07, 2006 - 3:15pm

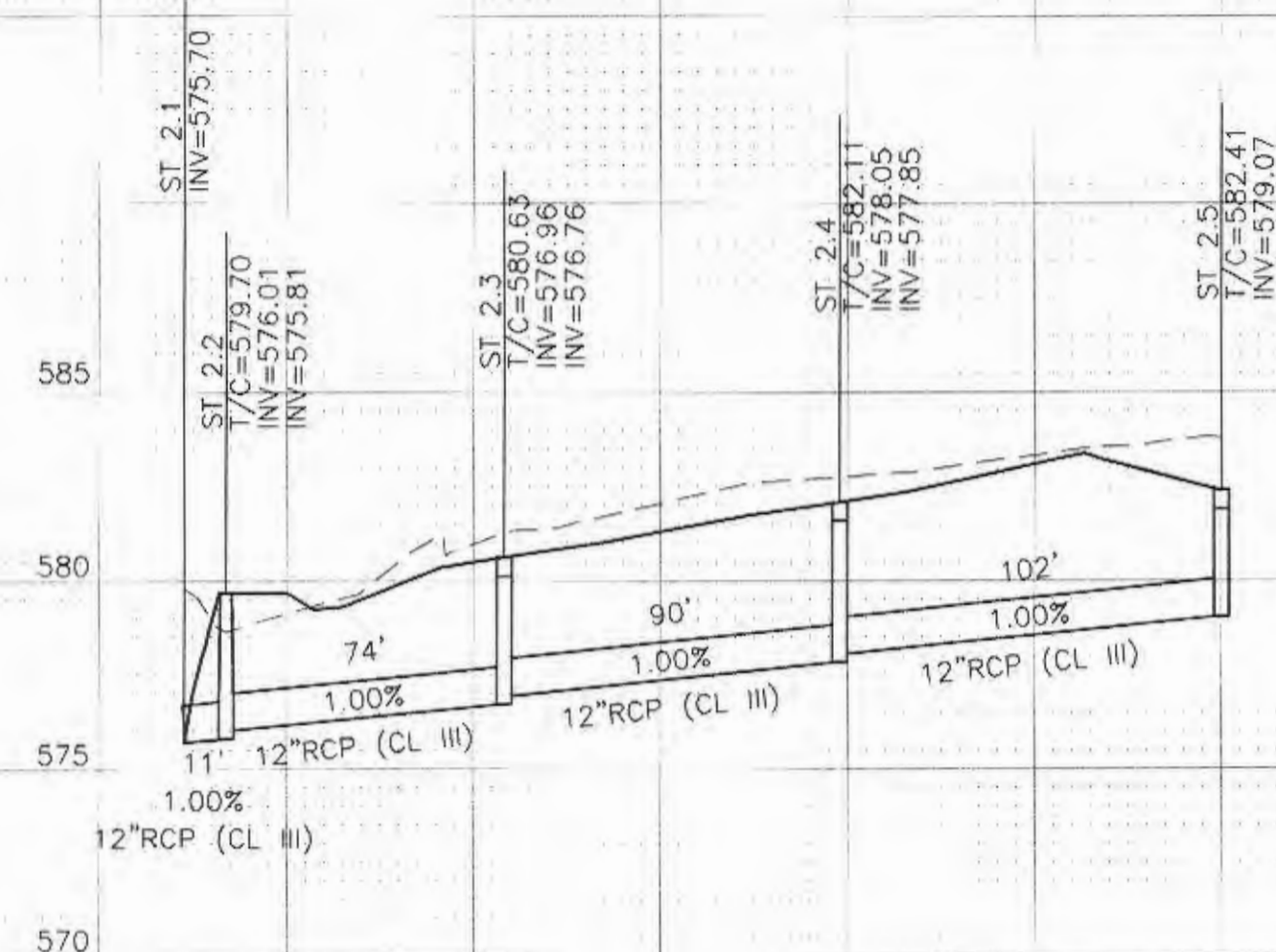

**STORM SEWER 2 (PRIVATE)**

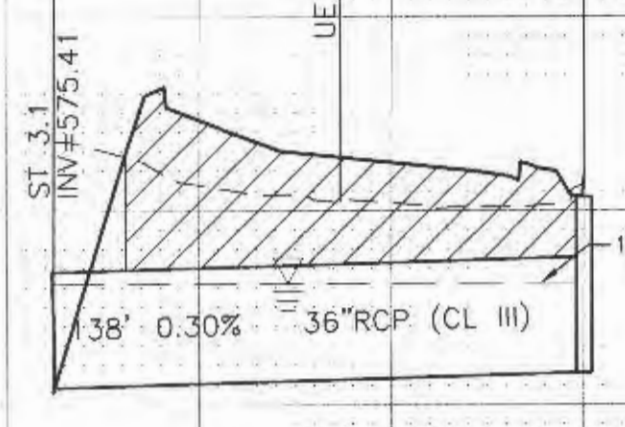

**STORM SEWER 3 (PRIVATE)**

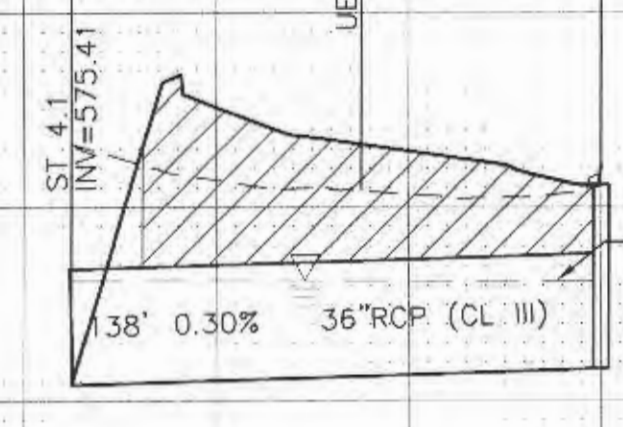

**STORM SEWER 4 (PRIVATE)**

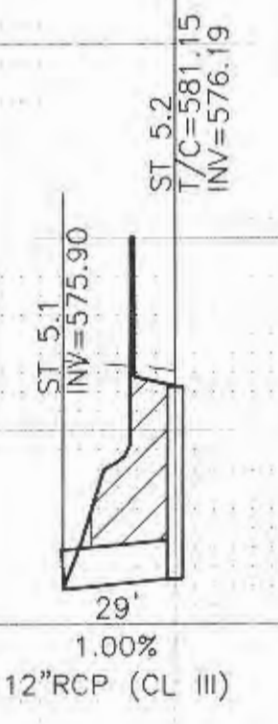

**STORM SEWER 5 (PRIVATE)**

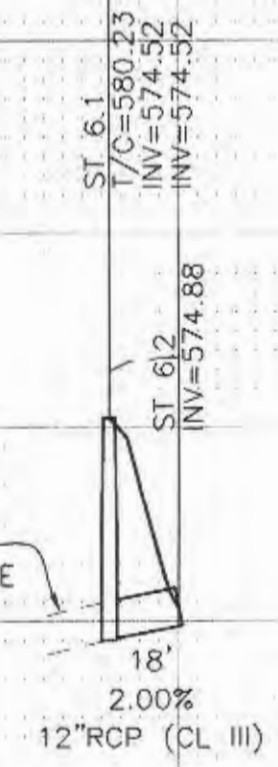

**STORM SEWER 6 (PRIVATE)**

**PROPOSED SEWER STRUCTURE SCHEDULE**

STR	STRUCTURE TYPE	GRATE/RIM ELEVATION	INVERTS	CASTING
ST 2.1	FLARED END SECTION	N/A	12" INV 575.70	N/A
ST 2.2	MANHOLE (4' DIA)	579.70	12" INV 575.81 & 576.01	TYPE A
ST 2.3	NYLOPLAST INLINE DRAIN	580.63	12" INV 576.76 & 576.96	12" H-25 HINGED GRATE
ST 2.4	NYLOPLAST INLINE DRAIN	582.11	12" INV 577.85 & 578.05	12" H-25 HINGED GRATE
ST 2.5	NYLOPLAST INLINE DRAIN	582.41	12" INV 579.07	12" H-25 HINGED GRATE
ST 3.1	FLARED END SECTION	N/A	36" INV 575.41	N/A
ST 3.2	MANHOLE (4' DIA)	580.37	36" INV 575.82	MSD (2) 15"X30" F/G
ST 4.1	FLARED END SECTION	N/A	36" INV 575.41	N/A
ST 4.2	MANHOLE (4' DIA)	580.56	36" INV 575.82	MSD (2) 15"X30" F/G
ST 5.1	FLARED END SECTION	N/A	12" INV 575.90	N/A
ST 5.2	SEE ARCH. PLANS	581.15	12" INV 576.19	SEE ARCH. PLANS
ST 6.1	DETENTION OULET MH (4' DIA)	580.23	EX. 12" INV ±574.52 12" INV 574.52	TYPE A
ST 6.2	FLARED END SECTION	N/A	12" INV 574.88	N/A

\* A CITY OF O'FALLON APPROVED EPOXY ADHESIVE MARKING BY ACP INTERNATIONAL (www.acpinternational.com - CRYSTAL CAP, SD-W-CC) OR DAS MANUFACTURING, INC. (www.dasmanufacturing.com - STANDARD, #SDS) SHALL BE PROVIDED AT ALL STORM SEWER INLETS. PEEL AND STICK ADHESIVE PADS WILL NOT BE ALLOWED.

**NOTES**

T/C SHALL INDICATE THE TOP RIM ELEVATION OF THE STRUCTURE. T/C SHALL INDICATE TOP OF CURB WHEN STRUCTURE IS A CURB INLET.

**LEGEND**

COMPACTED GRANULAR BACKFILL

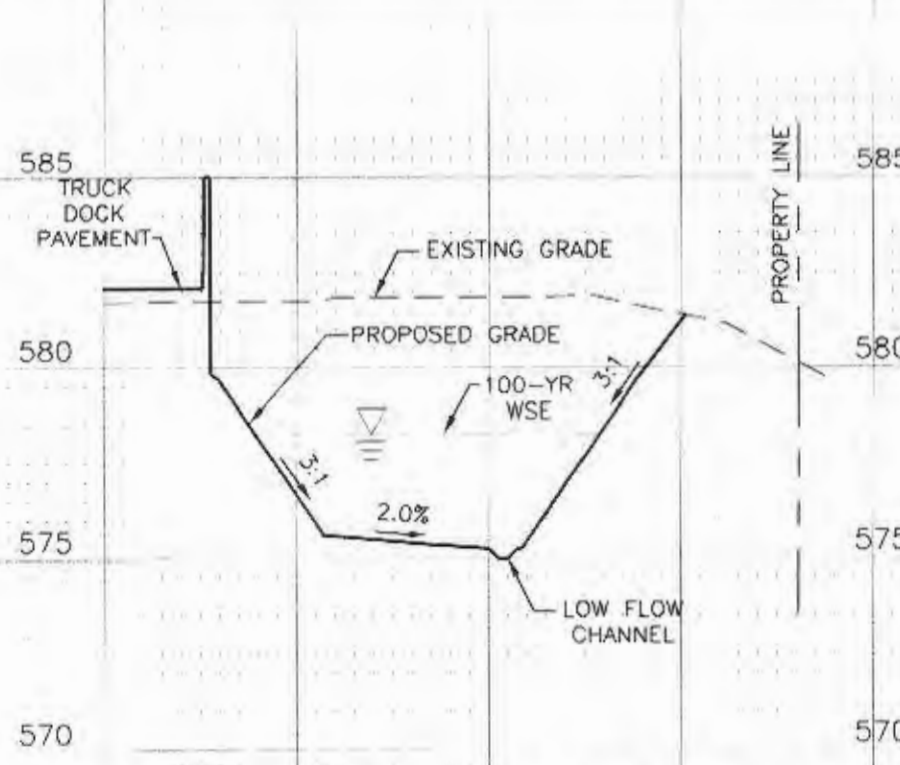
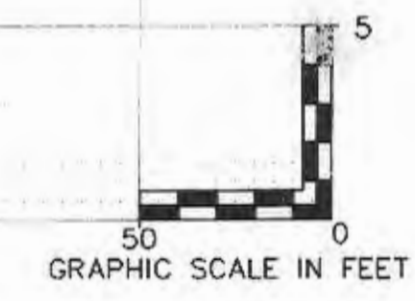

**BASIN CROSS SECTION A-A**

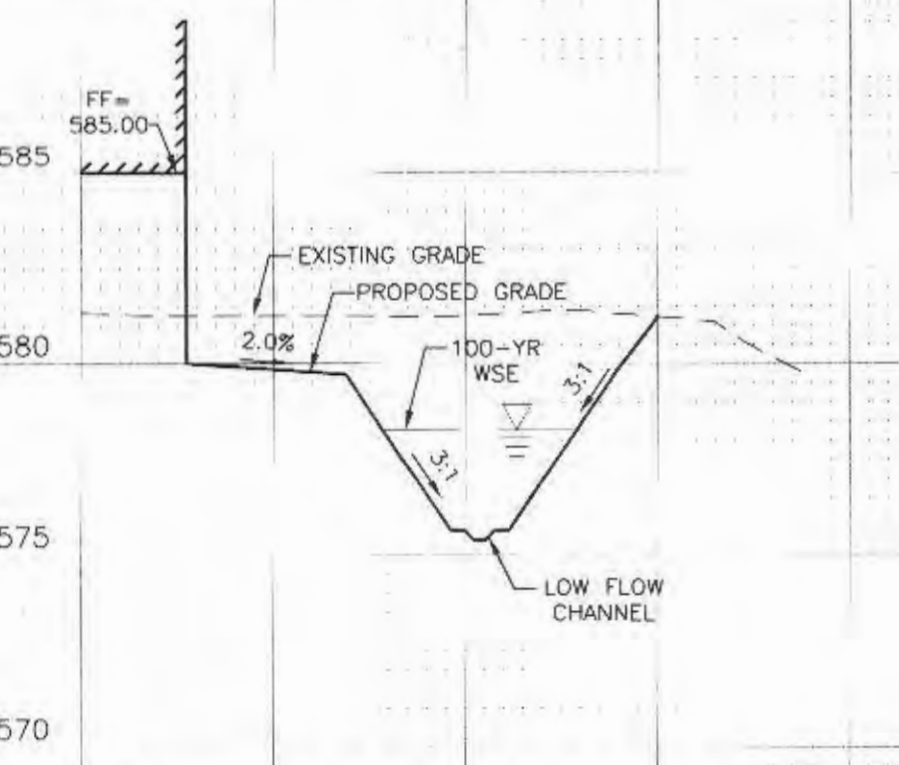

**BASIN CROSS SECTION B-B**

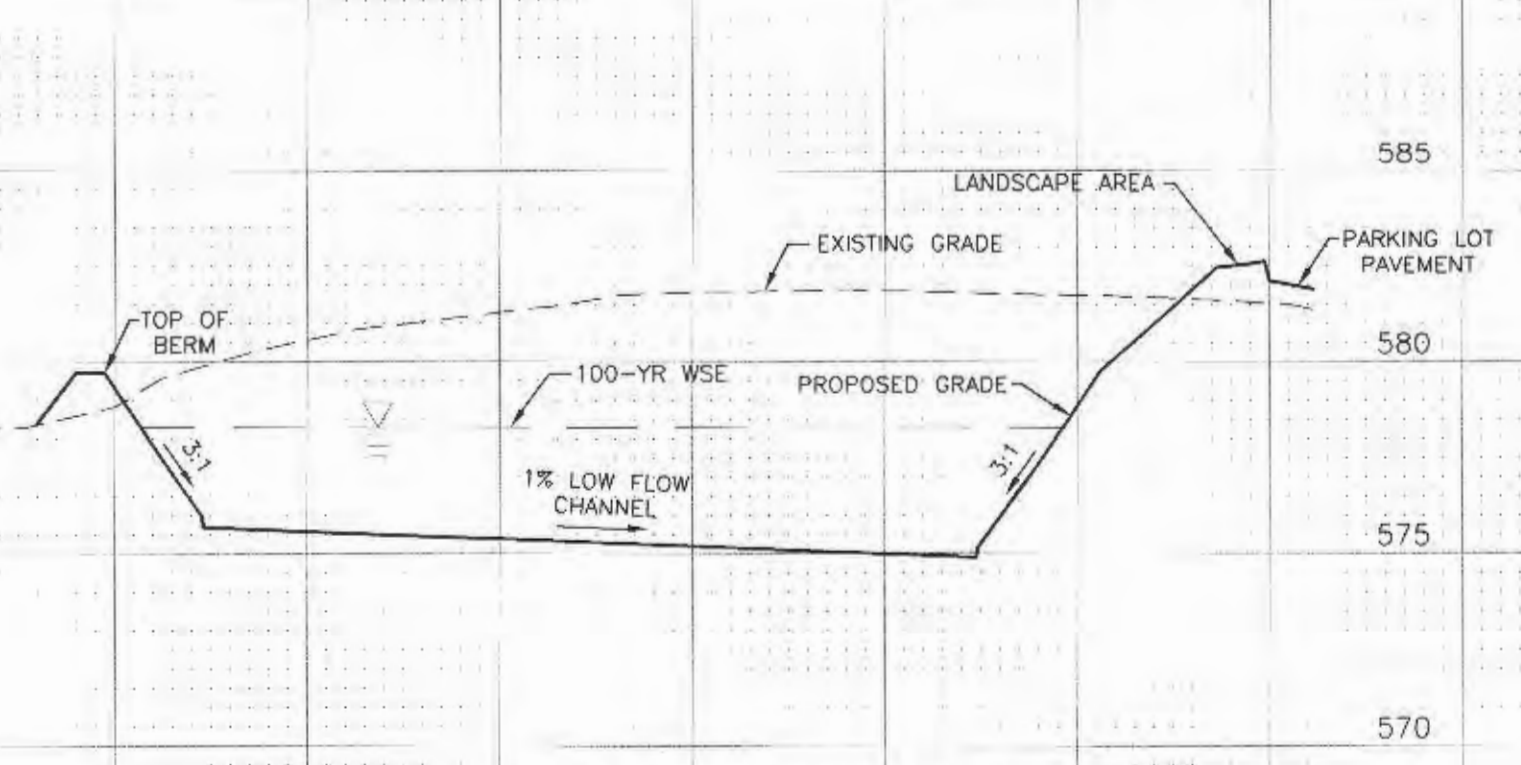

**BASIN CROSS SECTION C-C**

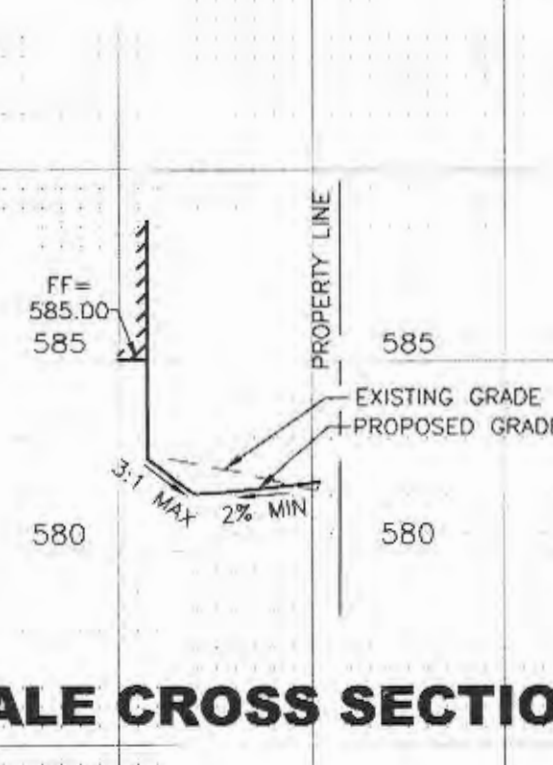

**SWALE CROSS SECTION D-D**

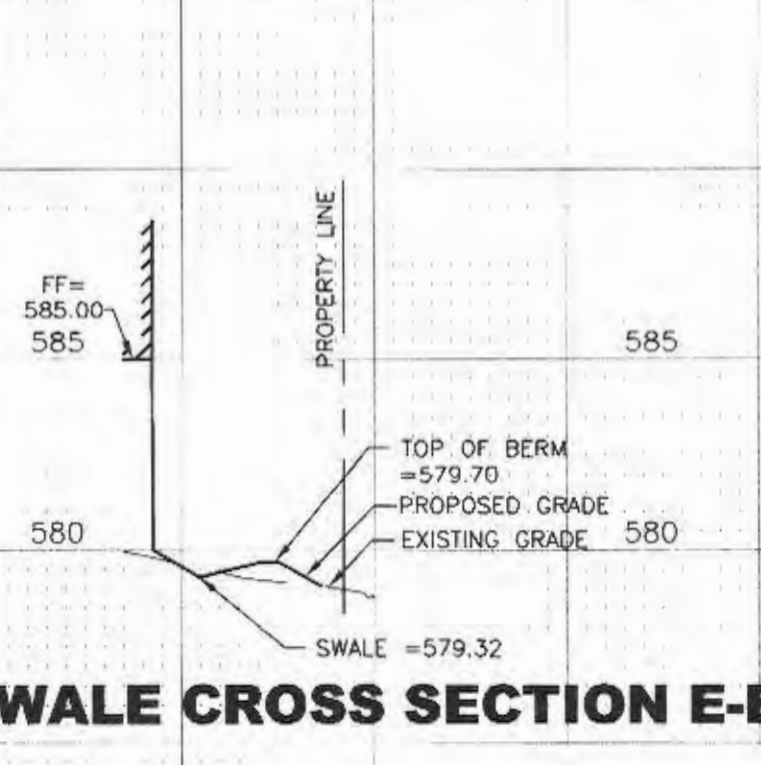

**SWALE CROSS SECTION E-E**

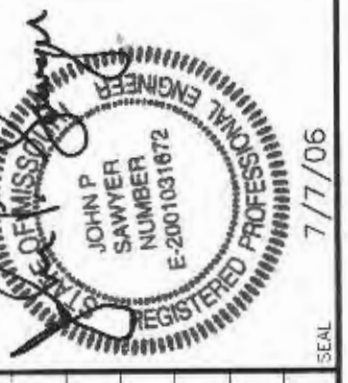

**REVISION**

**DATE**

**PROJECT No:** 64702

**DATE:** APR 06

**DES.:** JPS

**DR.:** CAD

**CKD.:** JPS

WOOLPERT, INC.  
1910 Pine Street, Suite 420  
Saint Louis, Missouri  
63103-2254  
314.241.3005  
FAX: 314.436.0884



**ALDI - O'FALLON, MO**  
**ALDI, INC.**  
8615 VETERANS MEMORIAL PARKWAY  
O'FALLON, MISSOURI 63386

**PROFILES**