

NOTES - FEBRUARY 28, 2001

The handicap sign shall post a fine of \$50 - 300

All proposed utilities shall be located underground.

The six inch vertical curbing on drives and parking areas will be concrete.

The vegetation shall be:

- 10-10-10 800# per acre
- Kentucky 31 fescue 25# per acre
- Annual rye grass 15# per acre
- Wheat 50# per acre
- (The wheat is a nurse crop and will be mowed before it crowds out the fescue.)

Currently there are erosion problems on this site and the owner will address any erosion problem(s) resulting from this project.

Approval will be obtained from the O'Fallon Fire District.

GENERAL NOTES:

1. GAS, WATER AND OTHER UNDERGROUND UTILITIES SHALL NOT CONFLICT WITH THE DEPTH OF HORIZONTAL LOCATION OF EXISTING AND PROPOSED SANITARY AND STORM SEWERS, INCLUDING HOUSE LATERALS.
2. POLYVINYL CHLORIDE (PVC) SHALL CONFORM TO THE REQUIREMENTS OF ASTM D-3034 STANDARD SPECIFICATIONS FOR THE F5M POLYVINYL CHLORIDE (PVC) SEWER PIPE AND FITTINGS, SDR-35.
3. STORM SEWERS 18" IN DIAMETER OR SMALLER SHALL BE ASTM C-14.
4. STORM SEWERS 24" IN DIAMETER OR LARGER SHALL BE ASTM C-76, CLASS II.
5. ALL STORM SEWER PIPE UNDER PAVEMENT, REGARDLESS OF SIZE, SHALL BE REINFORCED CONCRETE PIPE (ASTM C-76 CLASS III) UNLESS NOTED OTHERWISE ON THE PLANS.
6. CORRUGATED METAL PIPE SHALL CONFORM TO THE STANDARD SPECIFICATIONS FOR CORRUGATED GALVANIZED PIPE M-36, A.A.S.H.O.
7. ALL FILLED PLACES UNDER BUILDINGS, PROPOSED SANITARY AND STORM SEWER LINES, AND/OR PAVED AREAS INCLUDING TRENCH BACKFILLS SHALL BE COMPACTED TO 90% OF MAXIMUM DENSITY AS DETERMINED BY THE MODIFIED A.A.S.H.O. T-190 COMPACTION TEST (ASTM D-1557) UNLESS OTHERWISE SPECIFIED BY THE LOCAL GOVERNING AUTHORITY SPECIFICATIONS. ALL TESTS WILL BE VERIFIED BY A SOIL ENGINEER.
8. ALL EARTHEN FILLED PLACES WITHIN STATE, COUNTY OR CITY ROADS (HIGHWAYS) SHALL BE COMPACTED TO 90% OF MAXIMUM DENSITY AS DETERMINED BY THE STANDARD PROCTOR TEST A.A.S.H.O. T-99 (ASTM D-698) UNLESS OTHERWISE SPECIFIED BY LOCAL GOVERNING AUTHORITY SPECIFICATIONS. ALL TESTS WILL BE VERIFIED BY A SOILS ENGINEER.
9. ALL STORM AND SANITARY TRENCH BACKFILLS SHALL BE WATER JETTED, GRANULAR FILL WILL BE USED UNDER PAVED AREAS.
11. NO AREA SHALL BE CLEARED WITHOUT THE PERMISSION OF THE DEVELOPER.
12. ALL GRADE SHALL BE WITHIN 0.2 FEET (MORE OR LESS) OF THOSE SHOWN ON THE GRADING PLAN.
13. NO SLOPE SHALL BE GREATER THAN 3:1 AND SHALL BE EITHER SODDED OR SEEDED OF MULCHED.
14. ALL STANDARD STREET CURBS INLETS TO HAVE FRONT OF INLET 2 FEET BEHIND CURB.
15. WATER LINES, VALVES, SLEEVES, METERS AND ETC. SHALL MEET ALL SPECIFICATIONS AND INSTALLATION REQUIREMENTS OF THE LOCAL GOVERNING AUTHORITY.
16. THE SANITARY COVER WILL BE 3.5 FT. MINIMUM AND THE STORM COVER WILL BE 3.0 FT. MINIMUM. MANHOLES WILL HAVE A 0.2 FT. MINIMUM DROP FROM INLET TO OUTLET.
17. ALL WATER HYDRANTS AND VALVES SHALL BE CAST IRON AND INSTALLED IN ACCORDANCE WITH PLANS AND DETAILS.
18. ALL SANITARY AND STORM SEWERS SHALL MEET ALL SPECIFICATIONS AND INSTALLATION REQUIREMENTS OF THE LOCAL GOVERNING AUTHORITY.
19. ALL PVC WATER PIPE SHALL HAVE A MINIMUM PRESSURE RATING OF PR-200 OR SDR-21
20. ALL PVC SANITARY SEWER PIPE SHALL BE DR-35 OR EQUAL WITH CRUSHED STONE BEDDING UNIFORMLY GRADED BETWEEN 1" AND 1/4" SIZE. THIS BEDDING SHALL EXTEND FROM 6" BELOW THE PIPE TO 12" ABOVE THE TOP OF THE PIPE.
22. ALL STREETS MUST MEET THE SPECIFICATIONS AND INSTALLATION REQUIREMENTS OF THE CITY OF FALLON.
23. ALL SANITARY MANHOLE TOPS SHALL HAVE A 3/16" THICK COAT OF COAL TAR BITCH WATER PROOFING.
24. ALL SANITARY SERVICE LINES SHALL HAVE A 6" DIAMETER.
25. MANHOLE FRAME AND COVER SHALL BE CLAY AND BAILEY NO. 2006 FOR NEENAH R-1736 OF DEETER 1315 OR APPROVED EQUAL.
26. A DROP OF 0.2 FEET IS REQUIRED THROUGH EACH SANITARY MANHOLE.
27. THE CITY OF FALLON, SHALL BE NOTIFIED AT LEAST 48 HOURS PRIOR TO CONSTRUCTION OF SANITARY SEWERS FOR COORDINATION AND INSPECTION.

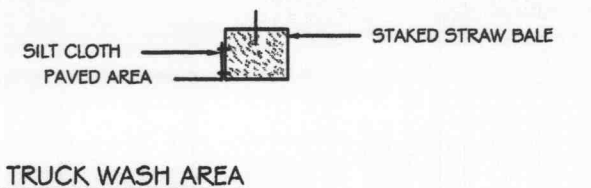
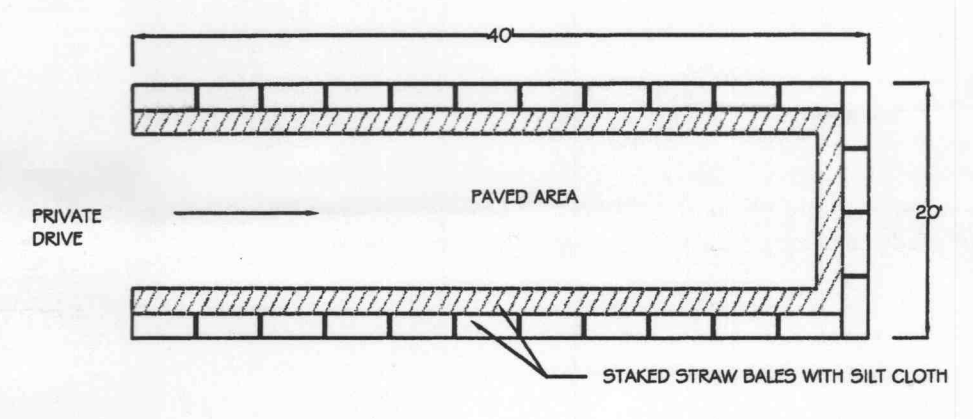
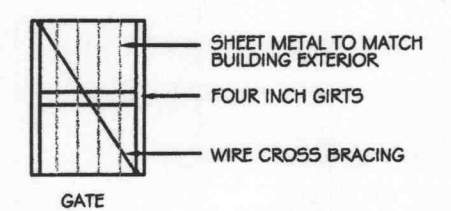
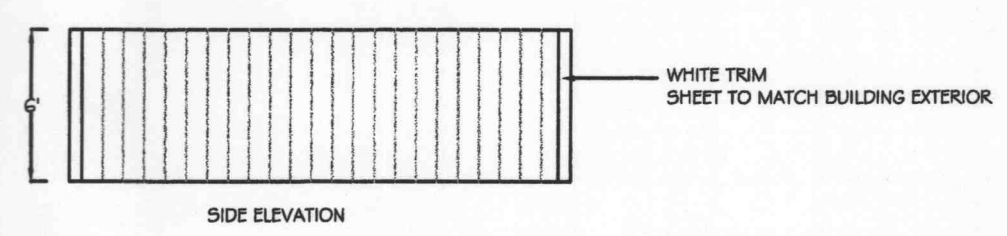
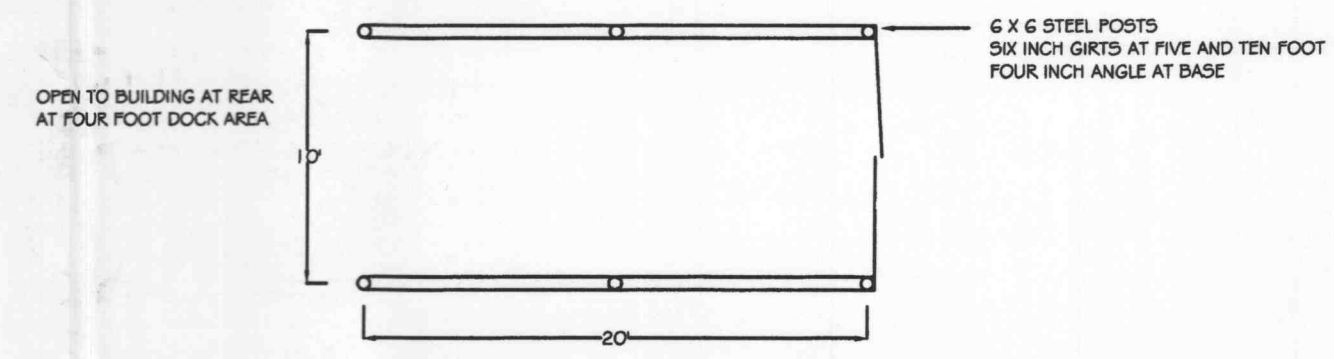

PERMANENT BENCHMARK U.S.G.S. DATUM R.M. 45 AS SHOWN F.I.R.M. 29 163C0220E
 CHISELED SQUARE ON THE SOUTHEAST CORNER OF THE LAKE ST. LOUIS B.V.D.
 BRIDGE OVER THE SPILLWAY OF LAKE ST. LOUIS ELEV. 526.16

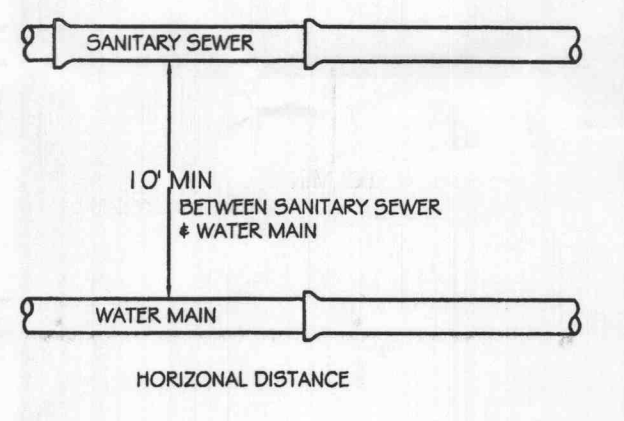
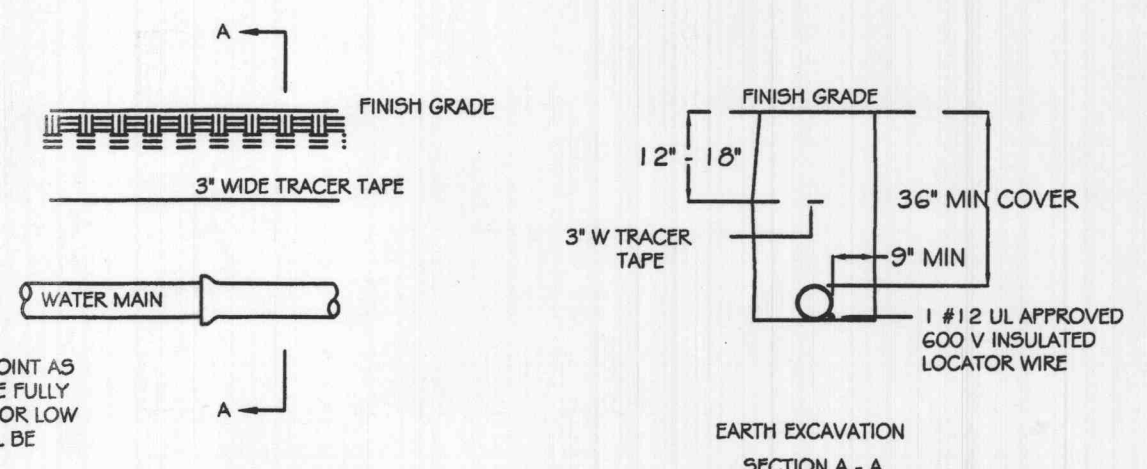

TYPICAL WATER & SEWER SEPARATION
 N.T.S.

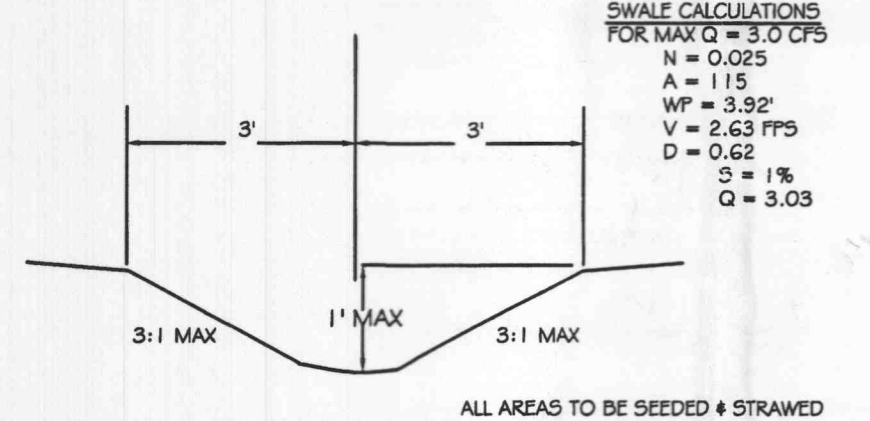
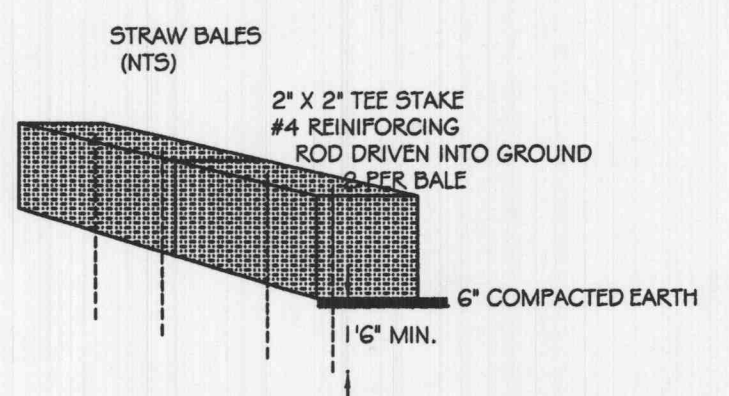
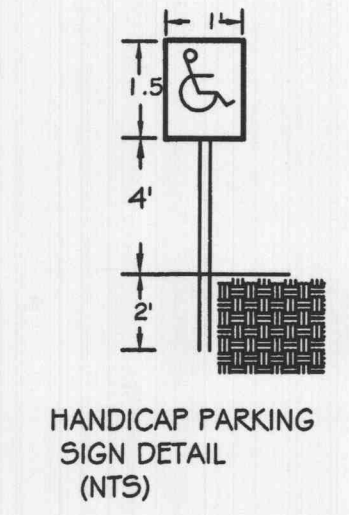
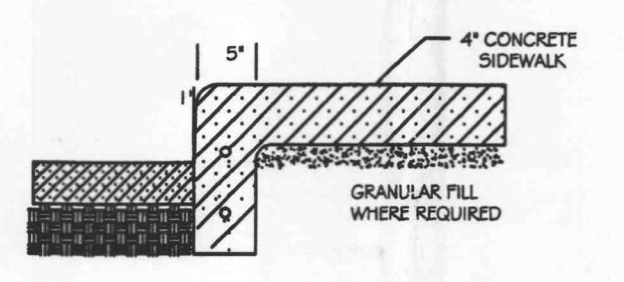
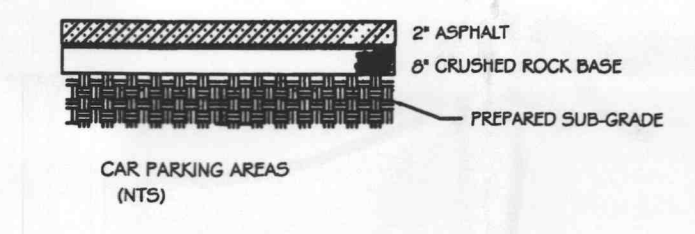
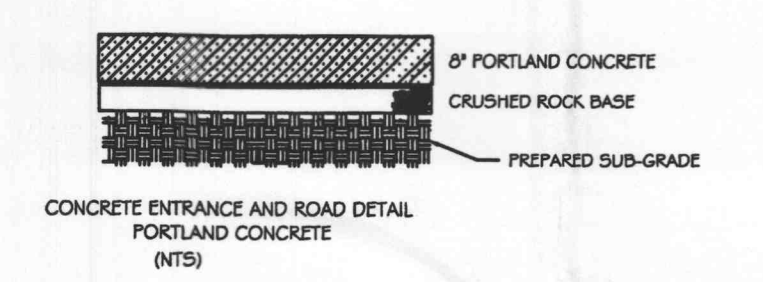
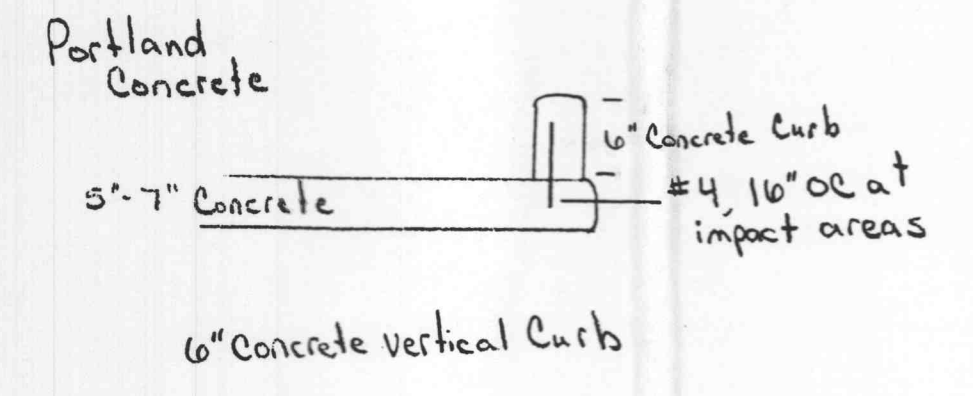

TYPICAL GRASS SWALE
 N.T.S.

A NEW 30,000 SQ. FT. ADDITION
 ABBOTT TOOL AND DIE
 920 LONE STAR DRIVE
 OF FALLON, MO. 63366

COVER SHEET

[Signature]
 3/5/01
 APPROVED

BACKING BLOCKS

BENDS	B	C	D	E	F
6" - 11 1/4"	8"	15"	12"	24"	0'
6" - 22 1/2"	8"	19"	12"	24"	13"
6" - 45"	8"	30"	12"	24"	14"
6" - 90"	8"	30"	12"	24"	27"
8" - 11 1/4"	8"	20"	12"	24"	10"
8" - 22 1/2"	8"	22"	12"	24"	17"
8" - 45"	8"	30"	12"	24"	24"
8" - 90"	8"	38"	12"	24"	36"
12" - 11 1/4"	8"	30"	12"	24"	15"
12" - 22 1/2"	8"	35"	12"	24"	25"
12" - 45"	8"	40"	12"	24"	40"
12" - 90"	8"	60"	12"	24"	52"

NOTES: 1. 2" x 4", FITTINGS EQUIVALENT TO 6" FITTINGS.
 2. TAPPING SLEEVES TO HAVE BACKING BLOCKS SAME SIZE AS REQUIRED FOR TEES.

TEES	G	H	J	K
6" x 6" x 6"	12"	24"	24"	18"
8" x 8" x 8"	12"	24"	24"	18"
8" x 8" x 8"	12"	24"	24"	24"
12" x 12" x 6"	12"	24"	24"	18"
12" x 12" x 8"	12"	24"	24"	24"
12" x 12" x 12"	12"	36"	24"	36"

CUBIC FEET OF CONCRETE REQUIRED				
BEND	11 1/4"	22 1/2"	45"	90"
6"	1.7	2.4	5.5	5.5
8"	2.1	3.1	5.0	8.5
12"	3.7	5.9	9.7	17.5

TEE X	6"	8"	12"	PLUG
6"	4.0	~	4.0	~
8"	4.0	5.0	5.0	~
12"	4.5	5.5	10.5	10.5

TYPICAL THRUST BLOCK DETAILS
 N.T.S.

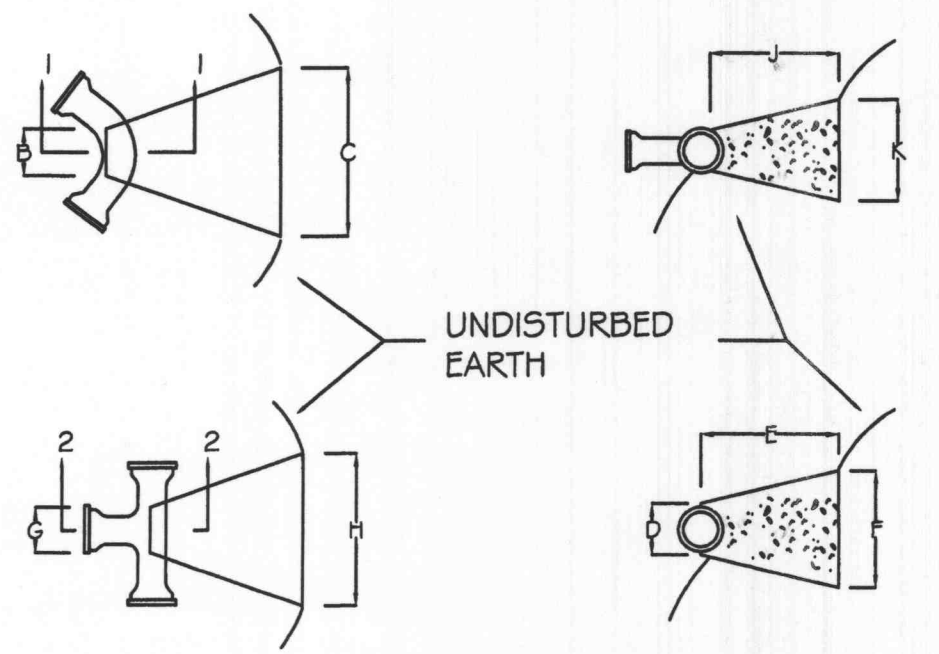

Bill Davis Inc.
 2209 Droste Road
 St. Charles, Mo. 63301
 (636) 949-0680
 Fax (636) 949-6706

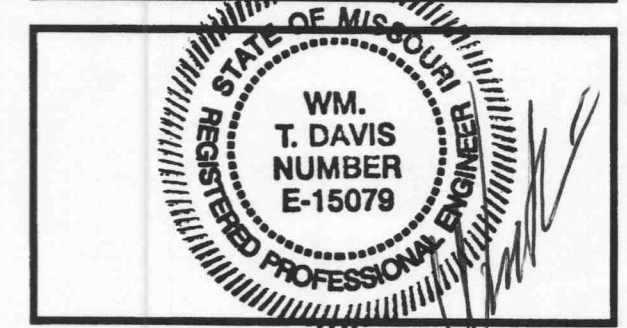

ABBOTT TOOL AND DIE
 COVER SHEET
 920 LONE STAR DRIVE
 A 30,000 SQ. FT. ADDITION

Project ABBOTT TOOL	Sheet 1/5
Date 1/21/00	
REV #1 - 2/1/01	
REV #2 - 3/1/01	
Scale 1" = 40'	