

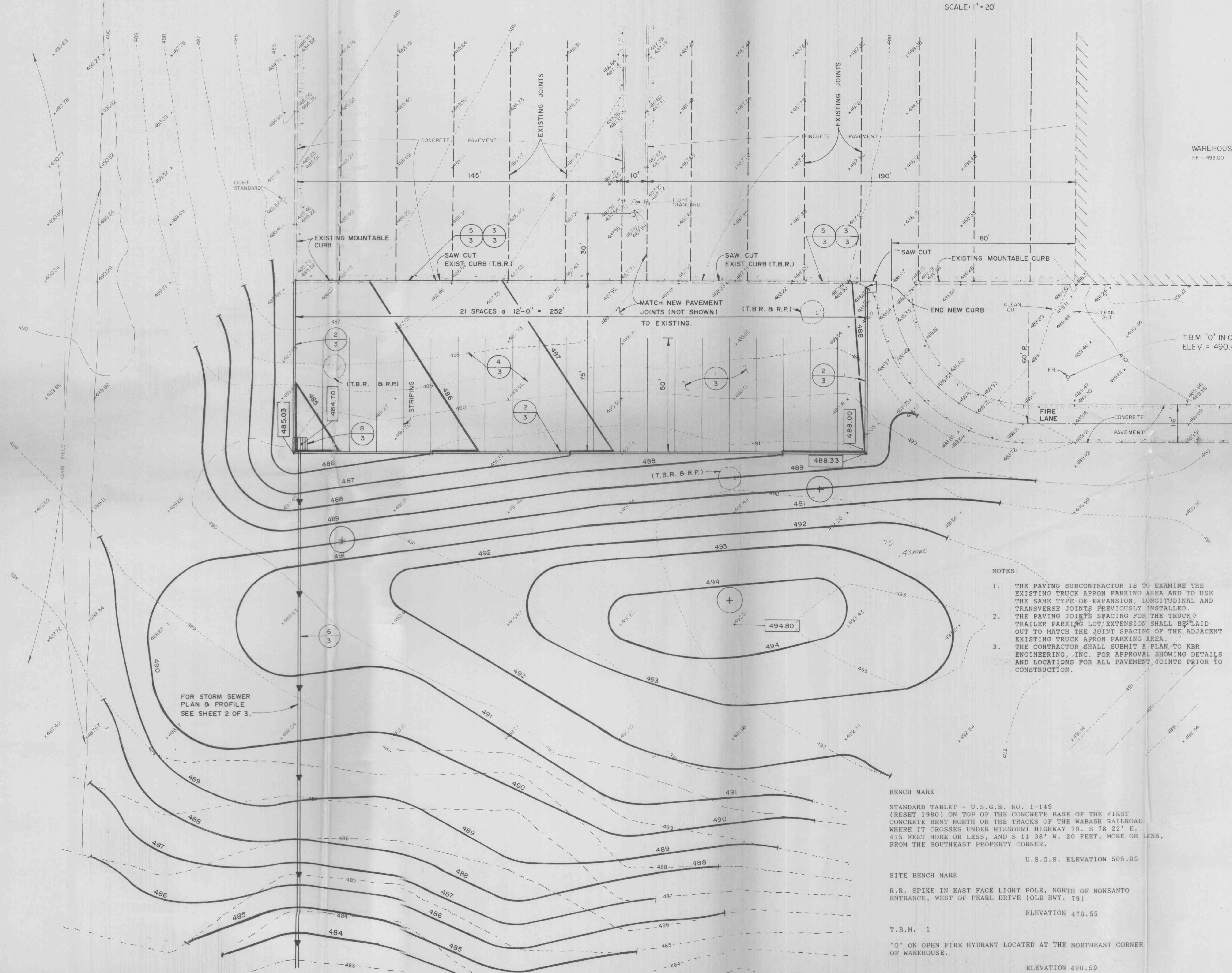

SCALE: 1" = 20'



LEGEND

- EXISTING CONTOUR 489
- NEW CONTOUR 489
- EXISTING SPOT ELEVATIONS 488.01
- NEW STORM SEWER PIPE
- EXISTING TREE +
- RELOCATED TREE +
- EXISTING PAVEMENT JOINTS
- NEW GRATE INLET +
- CONCRETE PAVEMENT
- EXISTING CURB & GUTTER
- NEW CURB & GUTTER
- DETAIL NUMBER 1
- SHEET NUMBER 3
- NEW SPOT ELEVATION 488.00

NOTES:

1. THE PAVING SUBCONTRACTOR IS TO EXAMINE THE EXISTING TRUCK APRON PARKING AREA AND TO USE THE SAME TYPE-OF-EXPANSION, LONGITUDINAL AND TRANSVERSE JOINTS PREVIOUSLY INSTALLED. THE PAVING JOINTS SPACING FOR THE TRUCK & TRAILER PARKING LOT/EXTENSION SHALL BE LAID OUT TO MATCH THE JOINT SPACING OF THE ADJACENT EXISTING TRUCK APRON PARKING AREA.
2. THE CONTRACTOR SHALL SUBMIT A PLAN TO KBR ENGINEERING, INC. FOR APPROVAL SHOWING DETAILS AND LOCATIONS FOR ALL PAVEMENT JOINTS PRIOR TO CONSTRUCTION.

ABBREVIATIONS

- T.B.R. TO BE REMOVED
- T.B.R.&R.P. TO BE REMOVED & REPLANTED
- EXIST. EXISTING

FILE APPROVED AS NOTED
9-29-91
Frank Johnson

INDEX OF SHEETS

SHEET	TITLE
1	SITE PLAN
2	STORM SEWER, PLAN & PROFILE
3	DETAILS
4	DRAINAGE AREA MAP

BENCH MARK

STANDARD TABLET - U.S.G.S. NO. 1-149 (RESET 1980) ON TOP OF THE CONCRETE BASE OF THE FIRST CONCRETE BENT NORTH OR THE TRACKS OF THE WABASH RAILROAD WHERE IT CROSSES UNDER MISSOURI HIGHWAY 79. S 78 22' E. 415 FEET MORE OR LESS, AND S 11 38' W, 20 FEET, MORE OR LESS, FROM THE SOUTHEAST PROPERTY CORNER.

U.S.G.S. ELEVATION 505.05

SITE BENCH MARK

R.R. SPIKE IN EAST FACE LIGHT POLE, NORTH OF MONSANTO ENTRANCE, WEST OF PEARL DRIVE (OLD HWY. 79)

ELEVATION 476.55

T.B.M. 1

"O" ON OPEN FIRE HYDRANT LOCATED AT THE NORTHEAST CORNER OF WAREHOUSE.

ELEVATION 490.59



204 west main street
bellville, missouri 63220
(417) 253-6816

KBR engineering, inc.
consulting engineers

8700 grimes
st. louis, mo. 63123
(314) 638-9998

ALDI INCORPORATED
P.O. BOX 8800
O'FALLON, MISSOURI
(314) 278-4700

ALDI FACILITY
TRAILER PARKING EXTENSION
O'FALLON, MISSOURI

TITLE	SITE PLAN
PROJECT NO.	91-16
DATE	SEPT. 18, 1991
SHEET	1
OF	4