

match line, see below

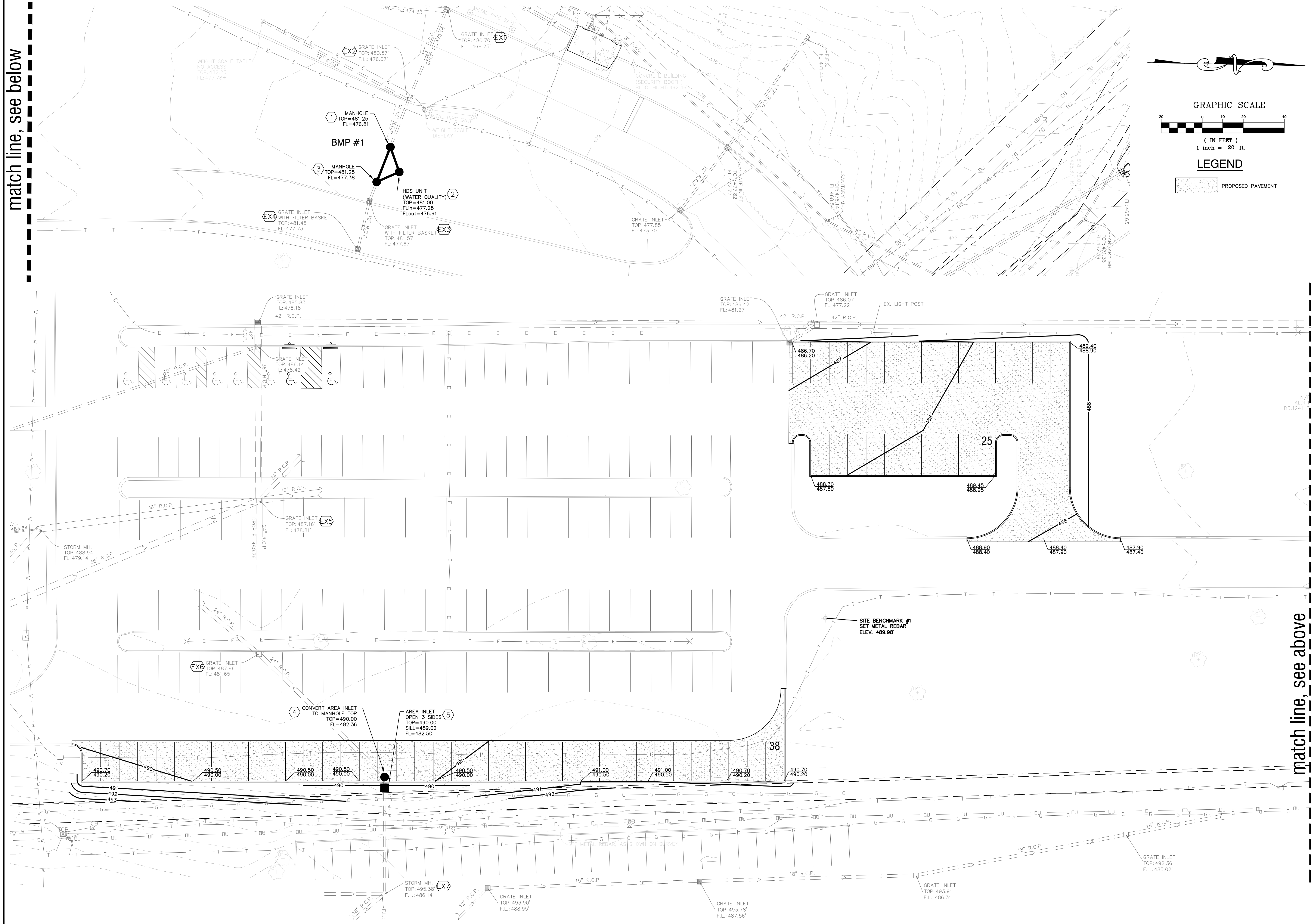

match line, see above

BRANDON A. HARP, P.E. E-28650
 PROFESSIONAL ENGINEER
 CEDC LICENSE NO.: 2003004674

10820 Sunset Office Drive
 Suite 200
 Saint Louis, Missouri 63127
 314.729.1400
 Fax: 314.729.1404
 www.cedc.net

CEDC
 CIVIL ENGINEERING
 DESIGN CONSULTANTS

Site Improvement Plans for
ALDI ~ WAREHOUSE PARKING EXPANSION
 475 Pearl Drive
 O'Fallon, Missouri 63376

Proj. #	1888.4
No. Description	Date
To City	07-14-23
Per City	08-16-23

SITE & GRADING PLAN

C5