

match line, see below

TOP: 482.23
FL: 477.784

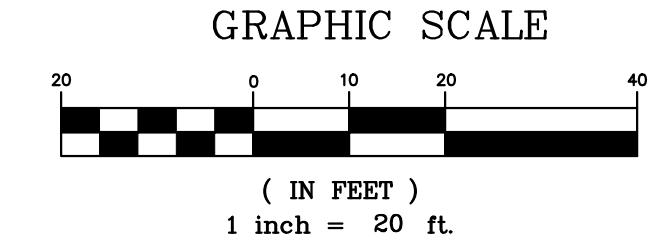

BRANDON A. HARP, P.E. E-28650
PROFESSIONAL ENGINEER
CEDC LICENSE NO.: 2003004674



LEGEND
[Patterned Box] PROPOSED PAVEMENT

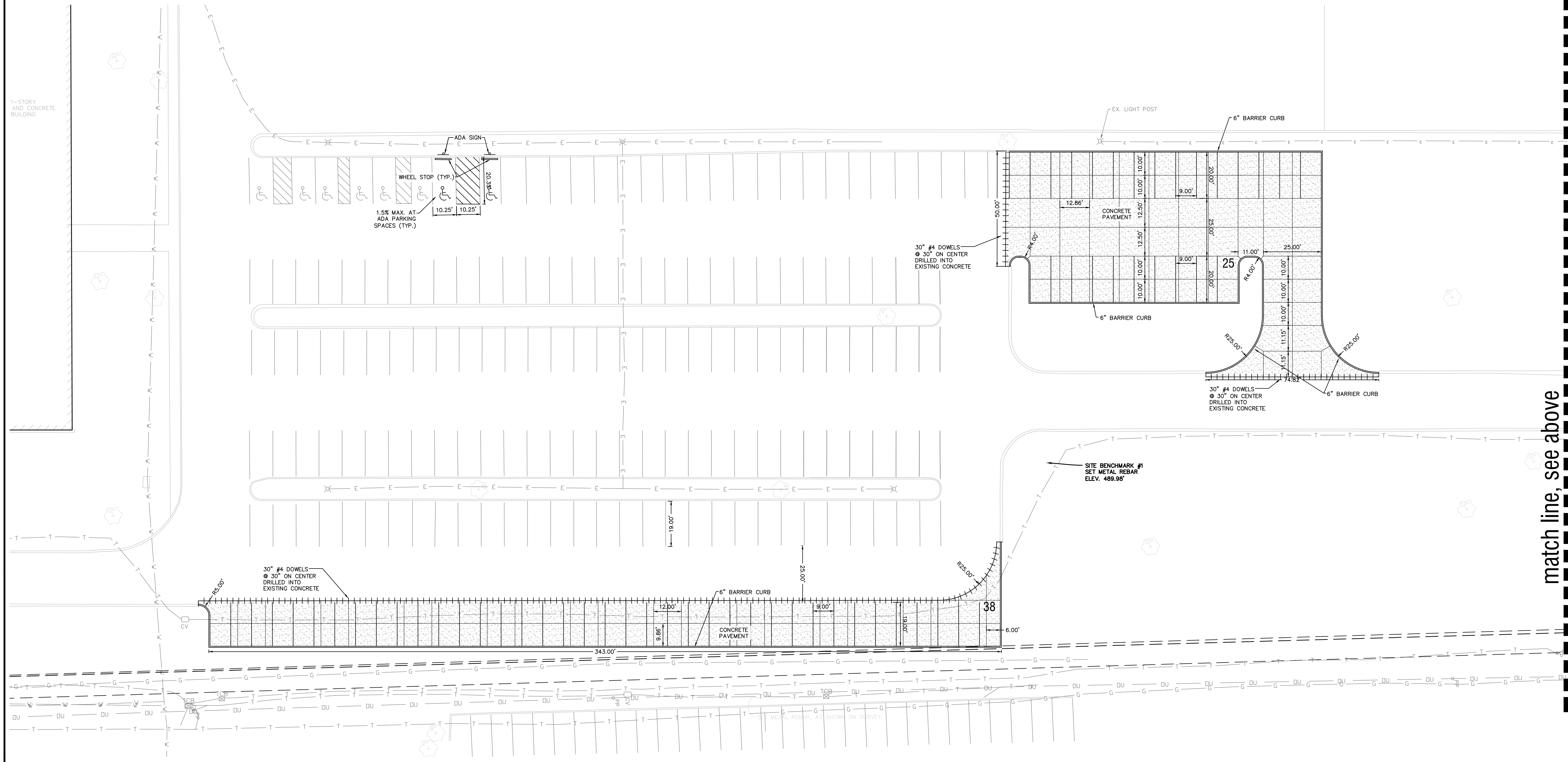

match line, see above

10820 Sunset Office Drive
Suite 200
Saint Louis, Missouri 63127
314-729-1400
Fax: 314-729-1404
www.cedc.net

CEDC
CIVIL ENGINEERING
DESIGN CONSULTANTS

Site Improvement Plans for
ALDI ~ WAREHOUSE PARKING EXPANSION
475 Pearl Drive
O'Fallon, Missouri 63376

Proj. #	1888.4
No. Description	Date
To City	07-14-23
Per City	08-16-23

SITE GEOMETRY & UTILITY PLAN

C6