

GENERAL NOTES:

No part of the driveway excluding tapers shall be constructed outside of the property frontage.

Pipe size & location to be determined by geometrics & drainage conditions (see plans).

Surfacing shall be shown on the plans and / or permit.

Length of pipe shall be determined by depth and location of ditch. (see plans)

If a paved approach is required, refer to standard plan 608.00 for construction details and construct curb to meet curb on paved approach.

Curb or curb and gutter between right of way line & pipe may meet local agency standards.

This drawing illustrates driveway details for minimum situations. Traffic volumes generated, safety considerations, drainage considerations, local requirements, etc. may dictate more extensive improvements than those illustrated on this drawing.

MISSOURI DEPARTMENT OF TRANSPORTATION

D6 PERMITS

TYPE III COMMERCIAL DRIVE

RECOMMENDED WIDTH 30 FEET

SHEET NO. 1 OF 2

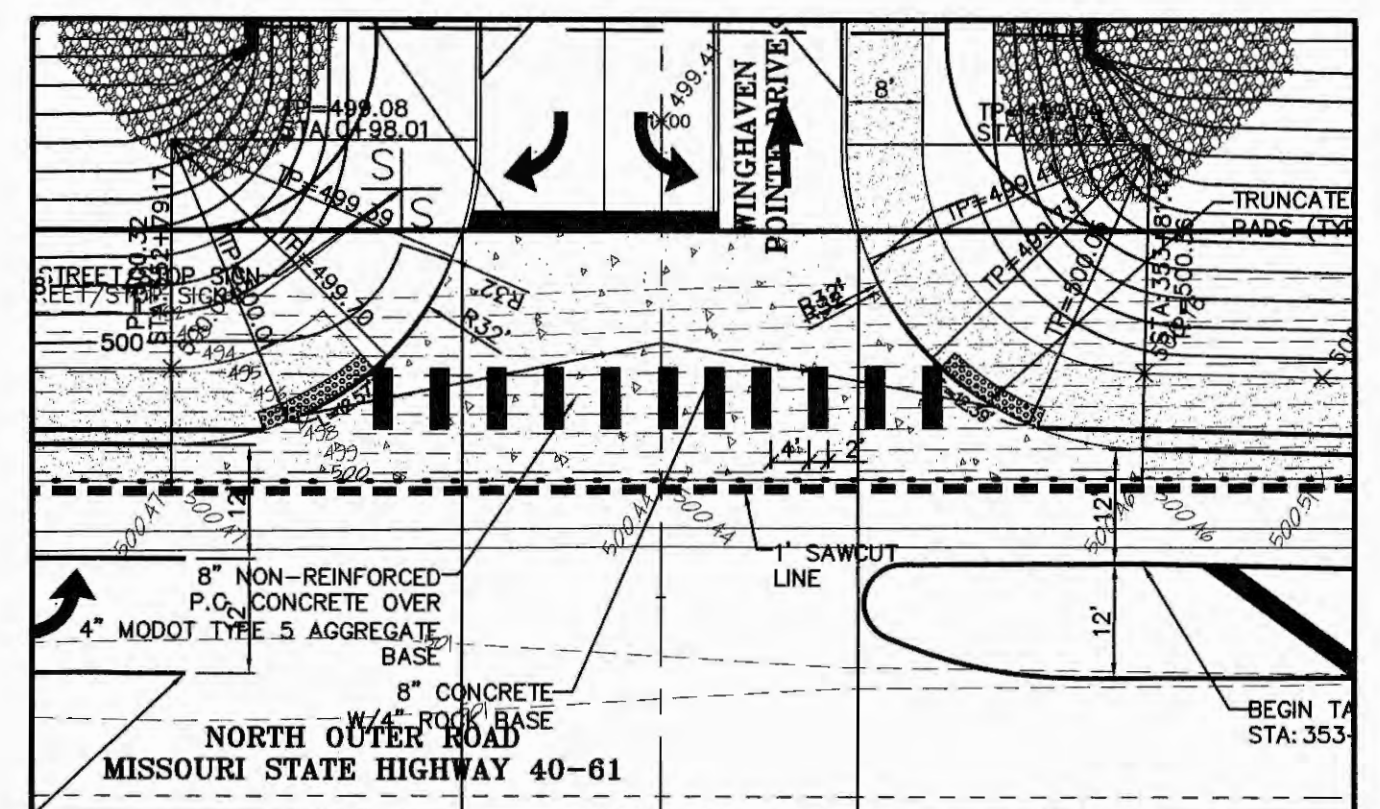

NORTH INTERSECTION DETAIL
SCALE: 1"=20'

NOTE:
ALL ELEVATIONS ARE TO TOP OF PAVEMENT UNLESS OTHERWISE NOTED.

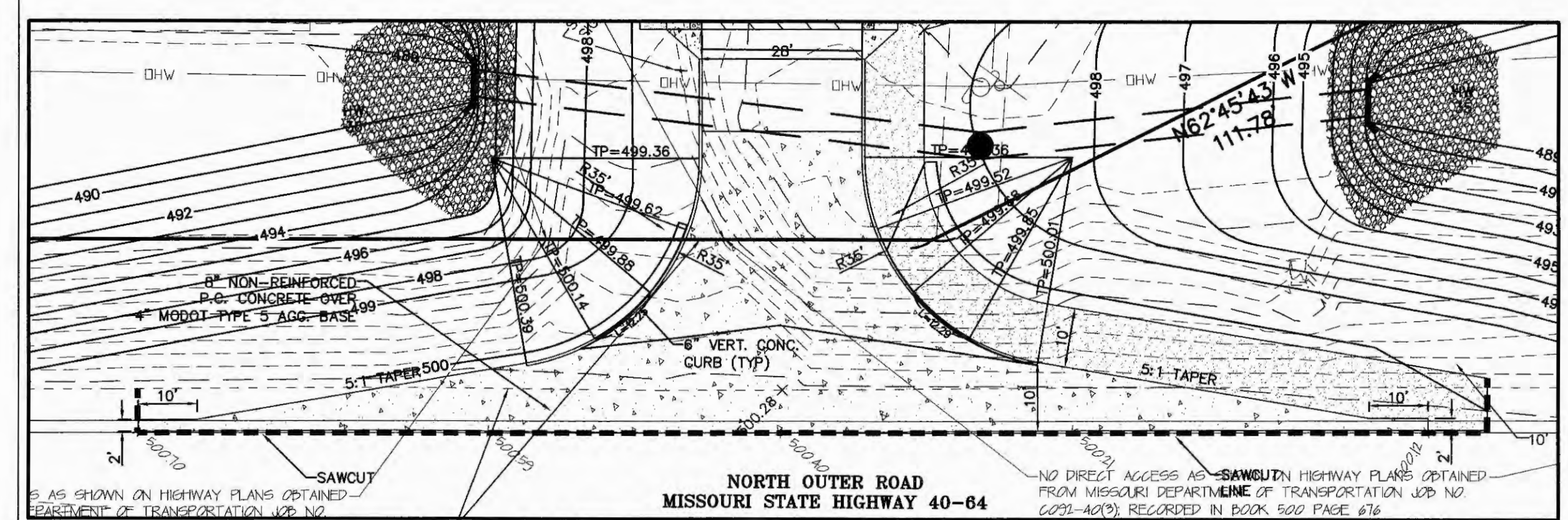

SOUTH INTERSECTION DETAIL
SCALE: 1"=20'

NOTE:
ALL ELEVATIONS ARE TO TOP OF PAVEMENT UNLESS OTHERWISE NOTED.

	CROSS SECTION	CONDITION		TREATMENT	SIGN		
		DIFFERENTIAL	TIME		MAINLINE (1)	SIDE ROAD (2)	
EDGE DROP-OFF		PAVEMENT EDGE DIFFERENTIAL > 2" TO ≤ 3"	NON-WORKING HOURS	WEDGE SLOPE TO 1V:1H OR FLATTER		NO SIGNS REQUIRED	(1) SIGNS SHALL BE SPACED AT APPROXIMATELY ONE MILE INTERVALS AND LOCATED WITHIN 150 FT. BEYOND ANY STATE ROADS. WHEN A SIGN PLACED AT THE ONE MILE INTERVAL FALLS WITHIN 1/2 MILE OF A SIGN PLACED AFTER AN INTERSECTION, THE SIGN PLACED AT THE 1/2 MILE INTERVAL MAY BE OMITTED. WHEN LOW SHOULDER/SIDE DROPP-OFF SIGNS WITH UNEVEN LANES ARE BOTH SPECIFIED, ALTERNATING SIGN MESSAGES SHALL BE USED AT 1 MILE SPACINGS.
			WORKING HOURS	NO EDGE TREATMENT REQUIRED		NO SIGNS REQUIRED	
		PAVEMENT EDGE DIFFERENTIAL > 3"	NON-WORKING HOURS	WEDGE SLOPE TO 1V:1H OR FLATTER		NO SIGNS REQUIRED	(3) SIGNS SHALL BE LOCATED ON THE SIDE OF THE ROADWAY WHERE THE PAVEMENT EDGE DIFFERENTIAL EXISTS, ON TWO-LANE UNDIVIDED HIGHWAYS, BACK-TO-BACK SIGNS SHALL BE PROVIDED ON THE SIDE OF THE ROADWAY, WHERE THE PAVEMENT EDGE DIFFERENTIAL EXISTS, "BACK TO BACK" SIGNS SHALL BE SEPARATED BY 7-10 FEET.
LANE DIFFERENTIAL		PAVEMENT EDGE DIFFERENTIAL > 3"	NON-WORKING HOURS	WEDGE SLOPE TO 1V:3H OR FLATTER		BUMP	(4) SIGNS TO REMAIN VISIBLE UNTIL SHOULDER SHAPING IS COMPLETE.
			WORKING HOURS	DELINEATE DIFFERENTIAL WITH CHANNELIZERS		NO SIGNS REQUIRED	(5) SIGNS SHALL BE LOCATED ON RIGHT SIDE OF NON-DIVIDED HIGHWAYS AND ON BOTH SIDES OF DIVIDED HIGHWAYS WHERE A LANE LINE DIFFERENTIAL EXISTS.
LANE DIFFERENTIAL		ANY PAVEMENT EDGE OR LANE LINE DIFFERENTIAL	NON-WORKING AND WORKING HOURS WHERE PLANS REQUIRE ADJACENT LANE CLOSURE WITH CHANNELIZATION OR PARTIAL LANE CLOSURE WITH BARRIER.	NO EDGE TREATMENT REQUIRED	NO SIGNS REQUIRED	NO SIGNS REQUIRED	(6) WHEN THE SHOULDER DROP-OFF SIGNS ARE IN PLACE FOR GREATER THAN THREE DAYS, THE SHOULDER DROP-OFF PLAQUE SHOULD BE USED IN ADDITION WITH THE SHOULDER DROP-OFF SIGN.
		LANE LINE DIFFERENTIAL ≤ 2"	NON-WORKING AND WORKING HOURS	NO EDGE TREATMENT REQUIRED		UNEVEN LANES	NO SIGNS REQUIRED
LANE DIFFERENTIAL		LANE LINE DIFFERENTIAL > 2"	NON-WORKING AND WORKING HOURS WHERE LANES OPEN TO TRAFFIC	WEDGE SLOPE TO 1V:3H OR FLATTER		UNEVEN LANES	GENERAL NOTES: SIGNS SHALL BE VISIBLE TO TRAFFIC ONLY WHEN AND WHERE CONDITIONS EXIST. FOR ADDITIONAL SIGN SPACING AND DETAILS SEE STANDARD PLAN 620.10.
		LANE LINE DIFFERENTIAL > 2"	NON-WORKING AND WORKING HOURS WHERE LANES CLOSED TO TRAFFIC	DELINEATE DIFFERENTIAL WITH CHANNELIZERS		BUMP	

MISSOURI HIGHWAYS AND TRANSPORTATION COMMISSION

100 WEST CAPITOL JEFFERSON CITY, MO 65101
1-888-ASK-MODOT 11-888-275-8636

PAVEMENT EDGE TREATMENT

DATE EFFECTIVE: 10/01/2015
DATE PREPARED: 8/24/2015

619.10H

SHEET NO. 1 OF 1

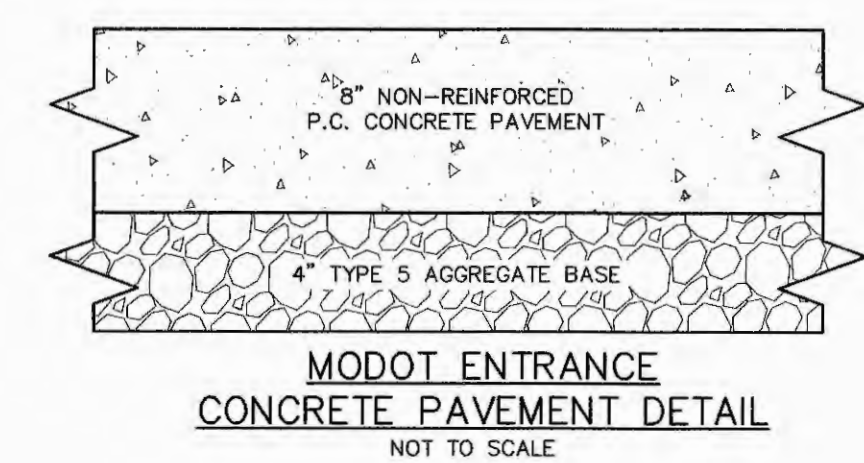

MODOT ENTRANCE CONCRETE PAVEMENT DETAIL
NOT TO SCALE

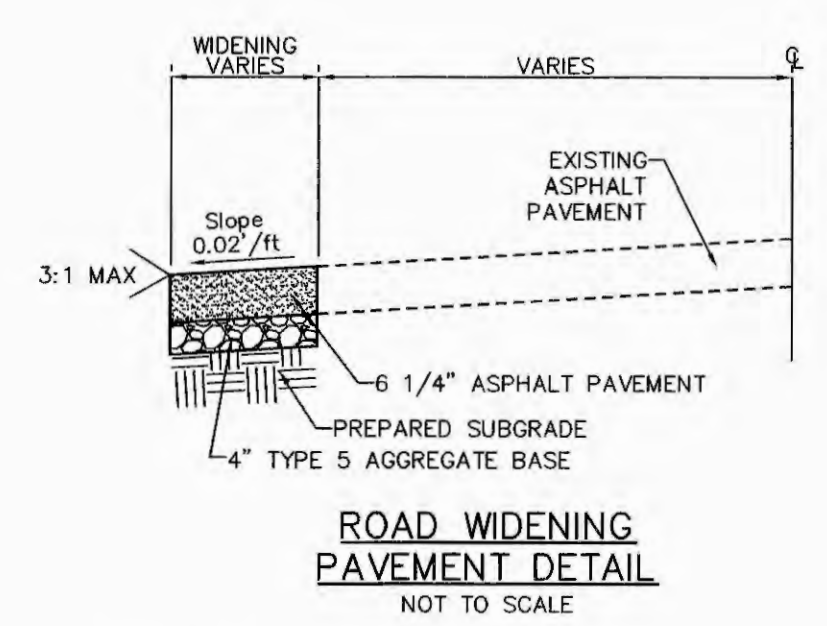

ROAD WIDENING PAVEMENT DETAIL
NOT TO SCALE

- NOTES:**
1. ALL SIGNS SHALL BE CONTRACTOR FURNISHED.
 2. A SEPARATE PERMIT IS REQUIRED FOR UTILITY WORK. CONTACT STEVE BELCHER. (steve.belcher@modot.mo.gov) 636-477-5041
 3. DEVELOPER MUST CONTACT MODOT AND MODOT CONSTRUCTION CONTRACTOR FOR MEETING PRIOR TO CONSTRUCTION. (A PRE-CONSTRUCTION MEETING IS REQUIRED.)
 4. ANY OPEN CUT 2" OR GREATER SHALL HAVE PAVEMENT EDGE TREATMENT.

PROJECT TITLE:
ALTAIR AT THE PRESERVE (FKA WINGHAVEN POINTE)

ENGINEERING SURVEYING
224 Pointe West Blvd.
St. Charles, MO 63001
636-888-6866
FAX 636-888-1718



DISCLAIMER OF RESPONSIBILITY
I hereby specify that the documents intended to be authorized by my seal are limited to this sheet, and I hereby disclaim any responsibility for all other drawings, Specifications, Estimates, Reports or other documents or instruments relating to or intended to be used for any part or parts of the architectural or engineering project or survey.

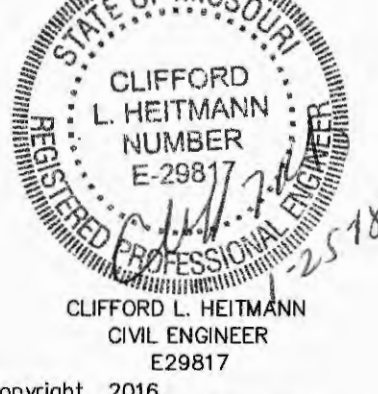

Copyright 2016
Box Engineering Company, Inc.
Authority No. 000655
All Rights Reserved

REVISIONS

DATE	BY	REVISION
04/25/2016	DCSD & PWS02	DOCUMENTS
05/16/2016	CITY REVIEW	CITY REVIEW
06/15/2016	CITY REVIEW & DCSD	COMMENTS
07/29/2016	CITY REVIEW	CITY REVIEW
08/04/2016	MODOT REVIEW	MODOT REVIEW
06/29/2017	MODOT REVIEW	MODOT REVIEW

Developer / Owner:
ROLWES DEVELOPMENT, L.L.C.
13100 MANCHESTER ROAD, SUITE 665
ST. LOUIS, MISSOURI 63131
314-821-9600

MoDOT PLAN AND DETAILS

P+Z No.
#9831.65.02

City No.
#

Page No.
20.2 of 38