

SANITARY SEWER PROFILES

SCALES:
HORIZ. 1"=30'
VERT. 1"=10'

DUCKETT CREEK SANITARY DISTRICT NOTES:

1. EXISTING SANITARY SEWER SERVICE SHALL NOT BE INTERRUPTED.
2. MODIFY SANITARY MANHOLE INVERTS TO DRAIN PROPERLY.

3. CONSTRUCTION OF SANITARY SEWERS TO BE DEDICATED TO DUCKETT CREEK SANITARY DISTRICT (DCSD) REQUIRES DCSD INSPECTION. CONTACT STEVE OVERBEY, DCSD CHIEF INSPECTOR, AT 636-441-1244 TO SCHEDULE INSPECTION. 48-HOUR ADVANCE NOTICE IS REQUIRED.

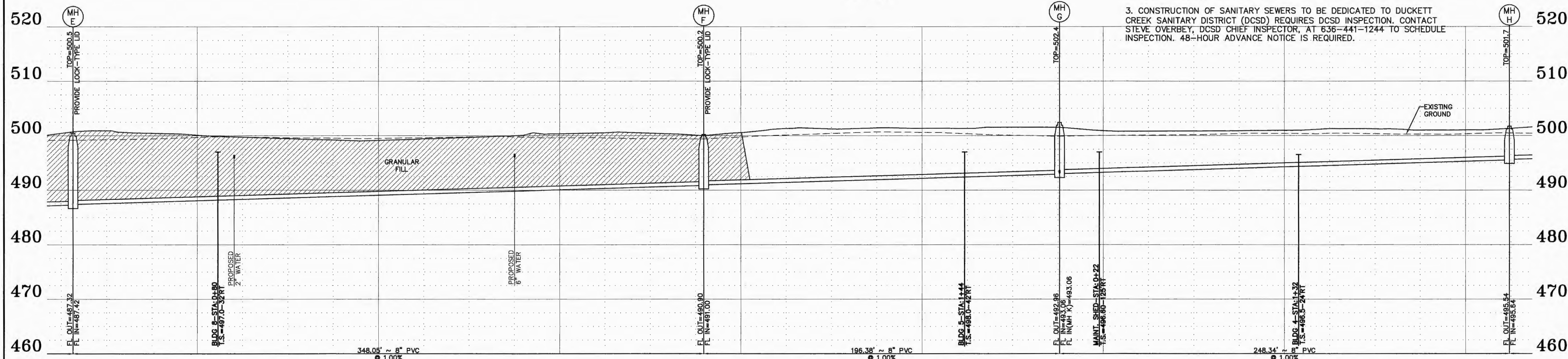

SANITARY SEWER PROFILES

SCALES:
HORIZ. 1"=30'
VERT. 1"=10'

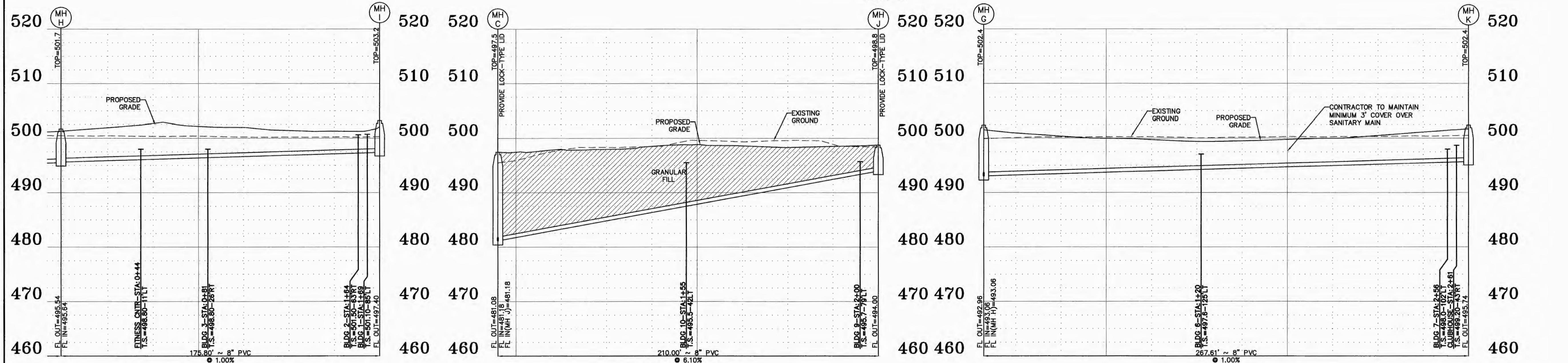

SANITARY SEWER PROFILES

SCALES:
HORIZ. 1"=30'
VERT. 1"=10'

SANITARY SEWER PROFILES

SCALES:
HORIZ. 1"=30'
VERT. 1"=10'

SANITARY SEWER PROFILES

SCALES:
HORIZ. 1"=30'
VERT. 1"=10'

PROJECT TITLE:
ALTAIR AT THE PRESERVE
(FKA WINGHAVEN POINTE)

ENGINEERING
PLANNING
SURVEYING
221 Point Treat Blvd.
St. Charles, MO 63301
636-928-5552
FAX 636-928-1718



DISCLAIMER OF RESPONSIBILITY
I hereby specify that the documents intended to be authorized by my seal are limited to this sheet, and I hereby disclaim any responsibility for all other drawings, specifications, estimates, reports or other documents or instruments relating to or intended to be used for any part or parts of the architectural or engineering project or work.



Copyright 2016
Box Engineering Company, Inc.
Authority No. 000955
All Rights Reserved

REVISIONS

DATE	BY	REVISION
04/25/2016	DCSD & PRS02	COMMENTS
05/16/2016	CITY	REVIEW
06/15/2016	CITY REVIEW & DCSD	COMMENTS
07/29/2016	CITY	REVIEW
08/04/2016	MODOT	REVIEW
11/04/2016	PH1	GRADING REVISION FOR CLIENT
06/29/2017	MODOT	REVIEW

Developer / Owner:
ROLWES DEVELOPMENT, L.L.C.
13100 MANCHESTER ROAD, SUITE 65
ST. LOUIS, MISSOURI 63131
314-821-9600

P+Z No.
#9831.65.02

City No.
#

Page No.
21 of 38

SANITARY SEWER PROFILES

Issue Date: 03/18/2016