

CRIMSON MEADOWS DRIVE
 26' WIDE PAVEMENT

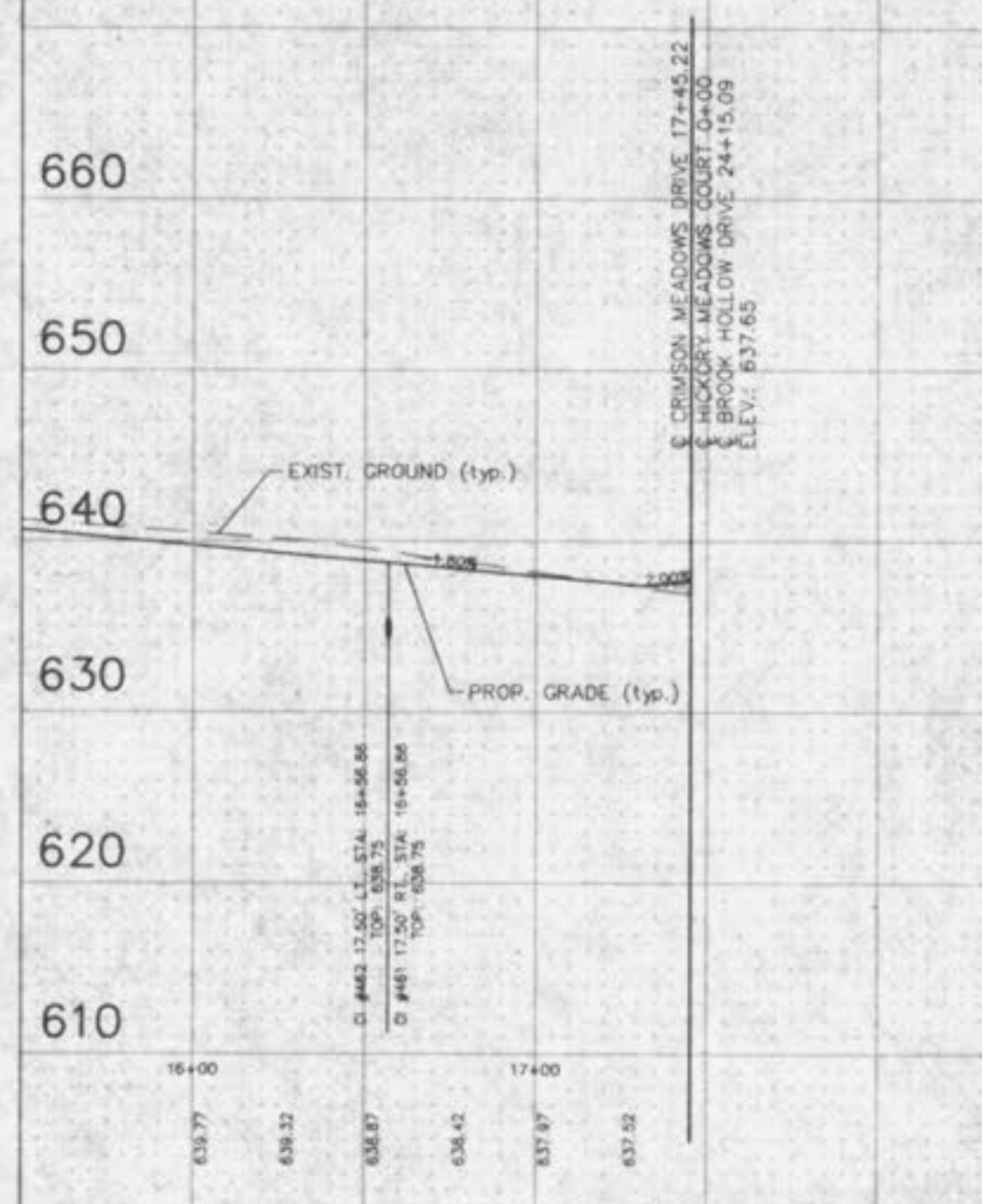

CRIMSON MEADOWS DRIVE CONT.
 26' WIDE PAVEMENT

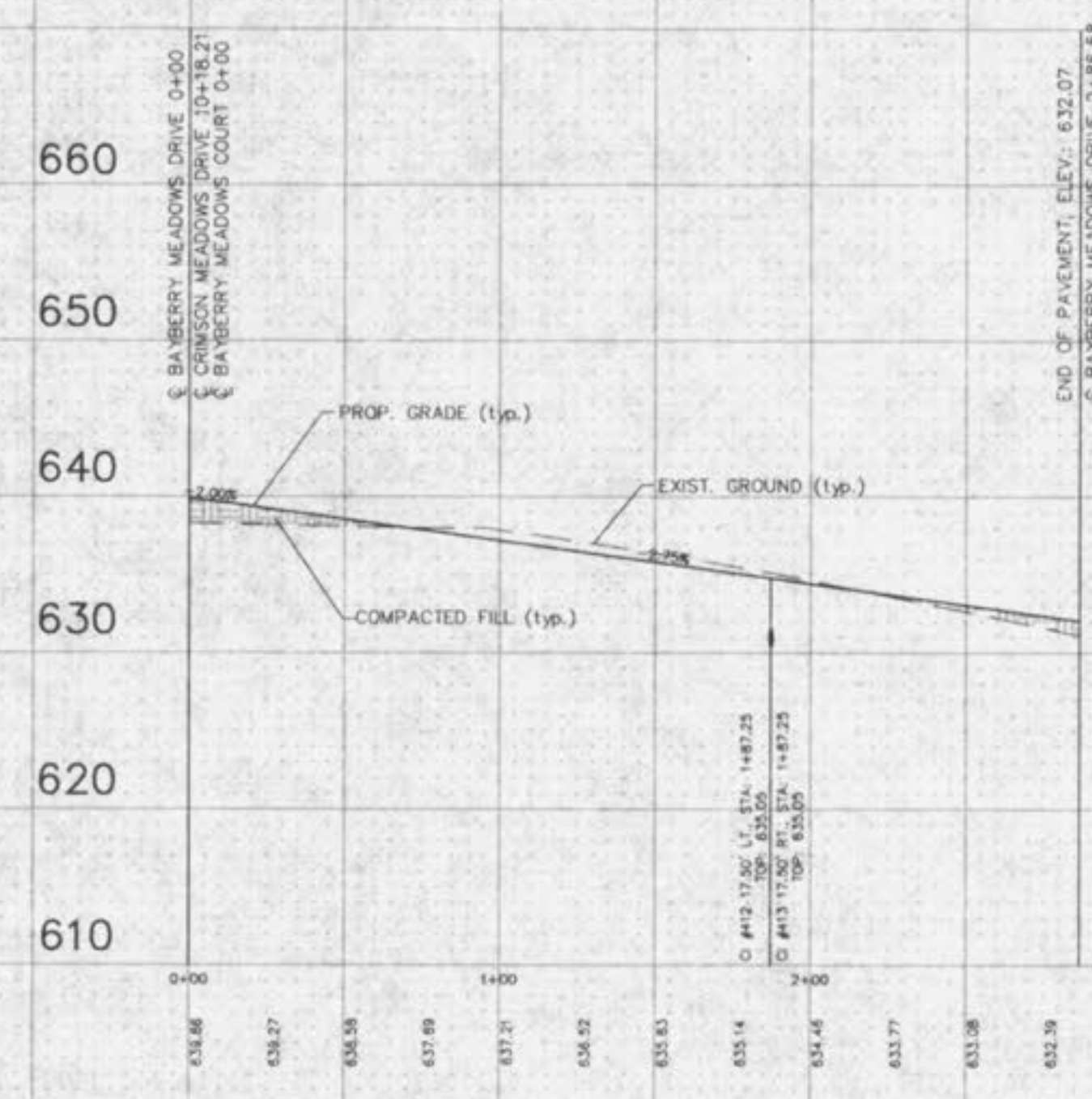

BAYBERRY MEADOWS DRIVE
 26' WIDE PAVEMENT

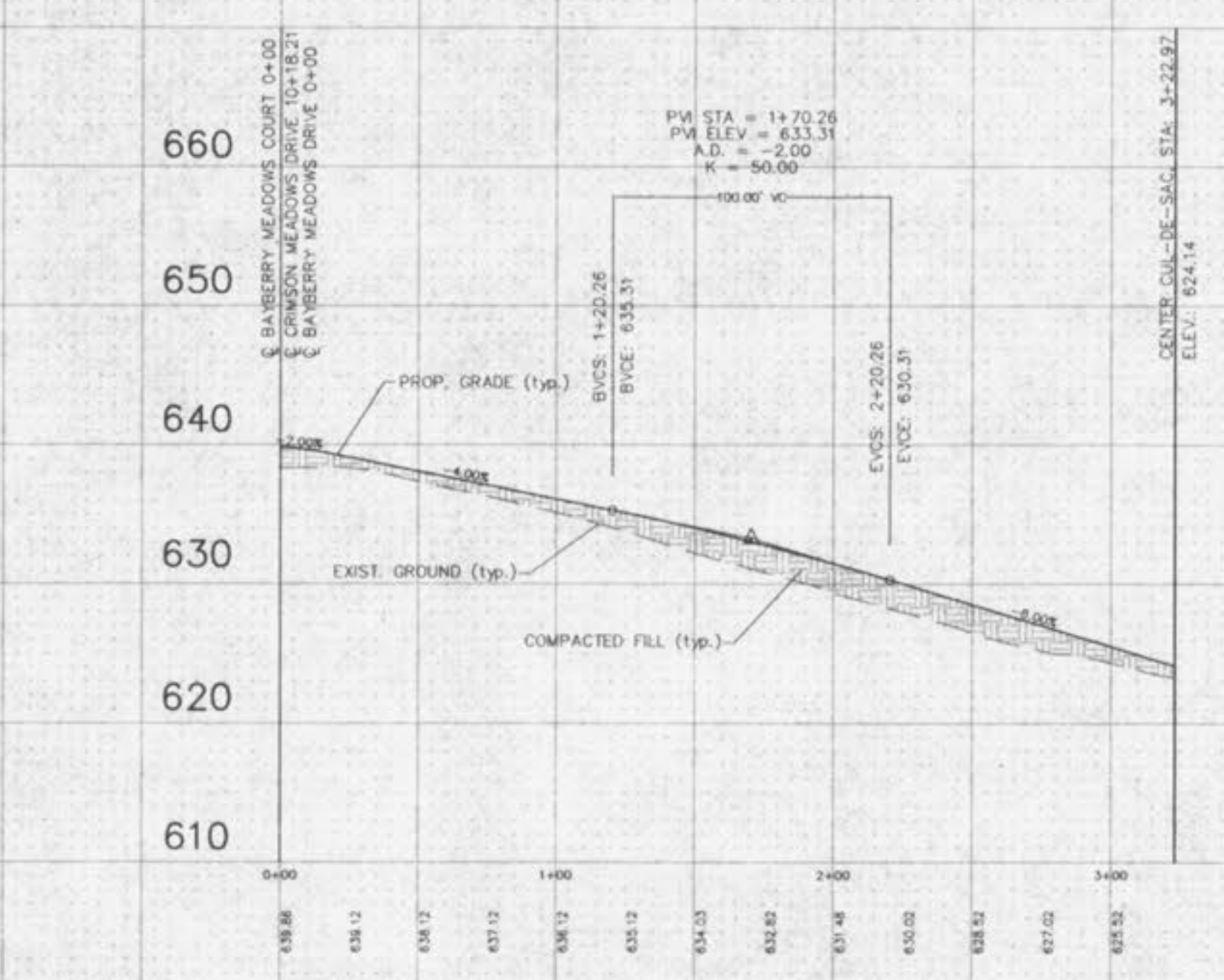

BAYBERRY MEADOWS COURT
 26' WIDE PAVEMENT

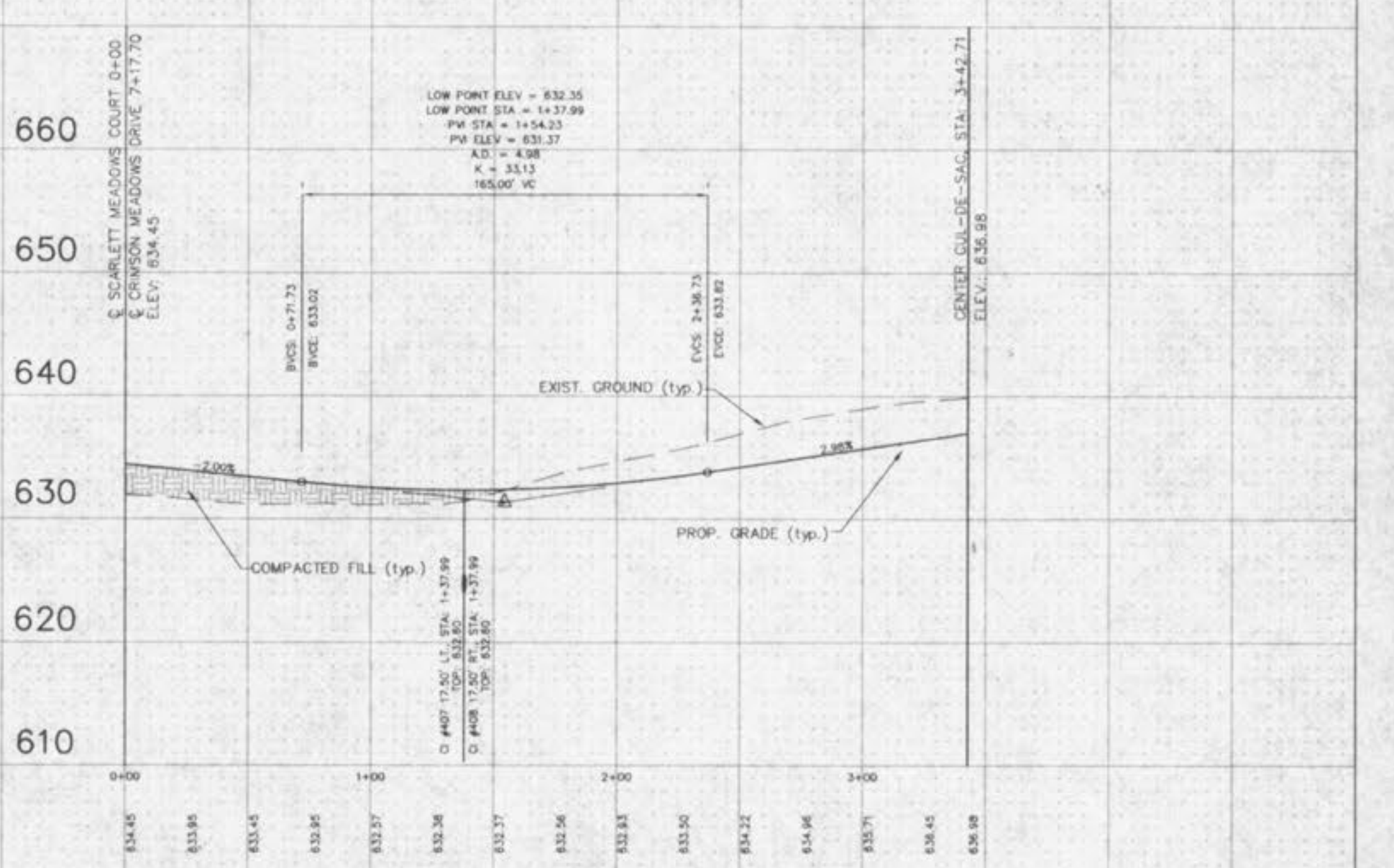

SCARLETT MEADOWS COURT
 26' WIDE PAVEMENT

UNDERGROUND UTILITIES HAVE BEEN PLOTTED FROM AVAILABLE INFORMATION AND THEREFORE THEIR LOCATIONS SHALL BE CONSIDERED APPROXIMATE ONLY. THE VERIFICATION OF THE LOCATION OF ALL UNDERGROUND UTILITIES, EITHER SHOWN OR NOT SHOWN ON THESE PLANS SHALL BE THE RESPONSIBILITY OF THE CONTRACTOR, AND SHALL BE LOCATED PRIOR TO ANY GRADING OR CONSTRUCTION OF THE IMPROVEMENTS.

ALL SANITARY SEWER LATERAL TAILSTAKE ELEVATIONS HAVE BEEN DESIGNED FOR AN 8.0' BASEMENT POUR IN HOMES WITH THE TOP OF FOUNDATION ELEVATION BEING SET 2.5' ABOVE THE TOP OF CURB ELEVATION AT THE DRIVEWAY.

SCALE:
 VERTICAL = 1" = 10'
 HORIZONTAL = 1" = 50'