

CANBRAKE COURT CUL-DE-SAC
SCALE: 1"=20'

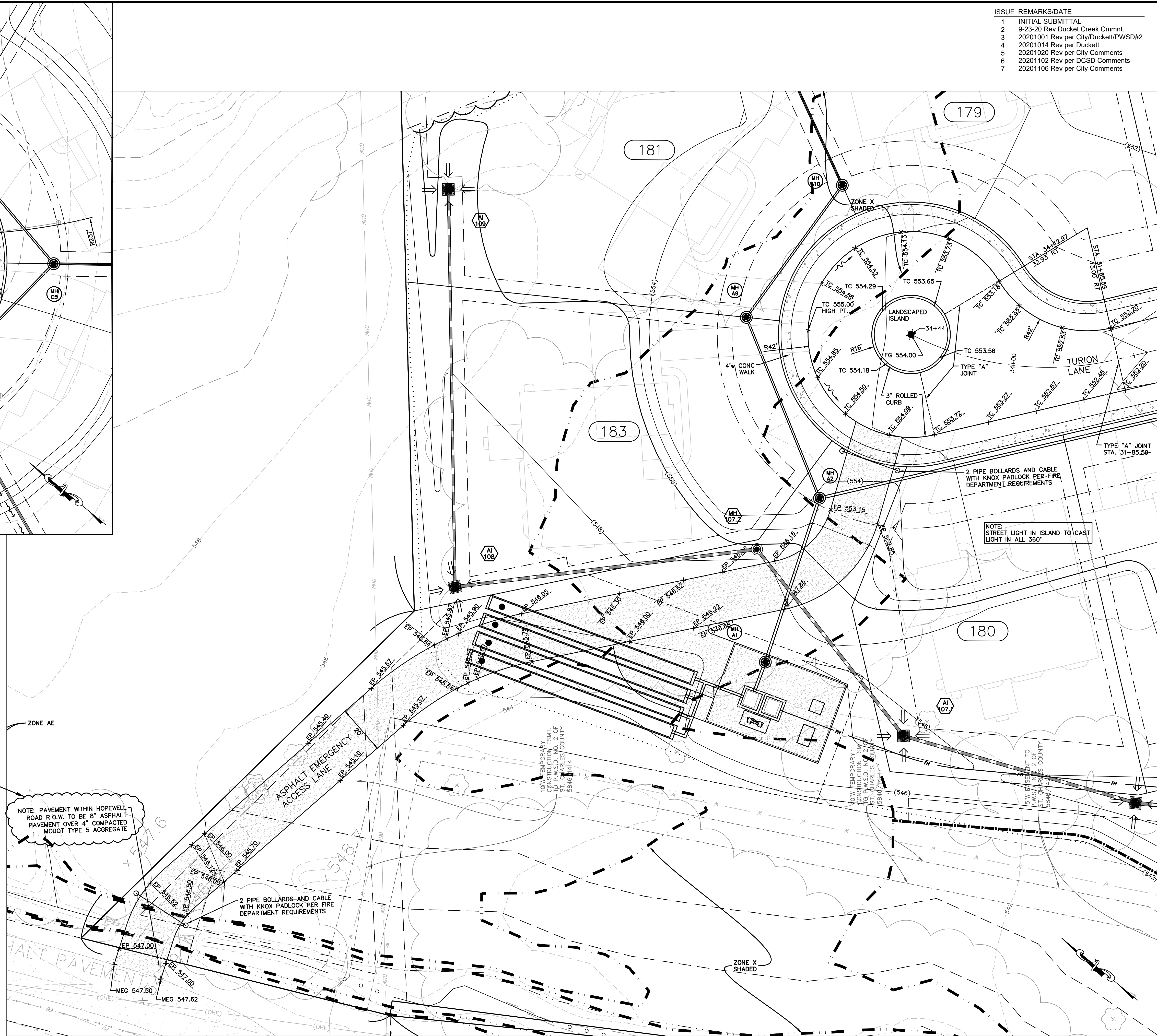

TURION LANE & EMERGENCY ACCESS LANE
SCALE: 1"=20'

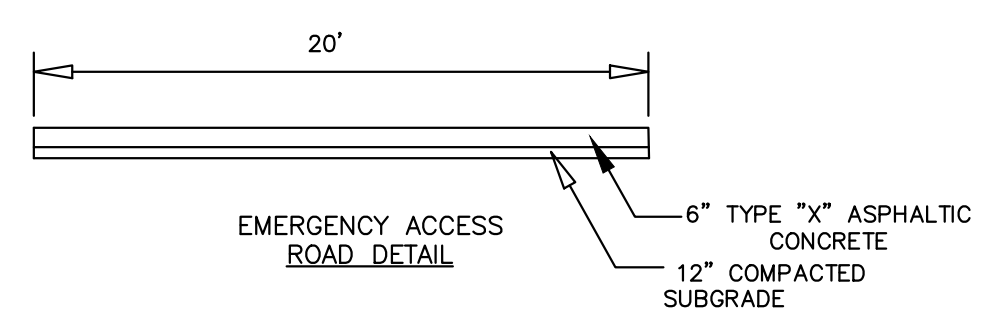

ISSUE	REMARKS/DATE
1	INITIAL SUBMITTAL
2	9-23-20 Rev Duck Creek Cmmt
3	20201001 Rev per City/Duckett/PWSD#2
4	20201014 Rev per Duckett
5	20201020 Rev per City Comments
6	20201102 Rev per DCSD Comments
7	20201106 Rev per City Comments

PROJECT TITLE

AMBERLEIGH
OF FALLON, MISSOURI

THE STERLING CO.
ENGINEERS & SURVEYORS
5055 New Baumgartner Road
St. Louis, Missouri 63129
Ph 314-487-0440 Fax 314-487-8944
www.sterling-eng-survey.com
Corporate Certificate of Authority #001348

Date: 5-18-2021
Jason D Howell
License No. PE 2007002801
Professional Engineer

LOMBARDO HOMES OF ST. LOUIS, LLC
2299 TECHNOLOGY DRIVE, SUITE 150
OF FALLON, MISSOURI 63368
Ph. 636-265-2710
Fax 636-695-3195

P+Z No. 20-000028
City No. 20-003192
Date: May 18, 2021
Job No. 14-04-136

Page No.
10.3

IMP

Drawing name: V:\1404136 Dabir CT Howell Rd\Drawings\Improvements\136IMP.dwg Printed on: Aug 27, 2021 - 1:48pm Plotted by: jhowell