

Drawing name: V:\1404136\Drawings\Engineering\Improvements\1404136\STORM.dwg Printed on: Aug 27, 2021 12:53pm Plotted by: jhowell

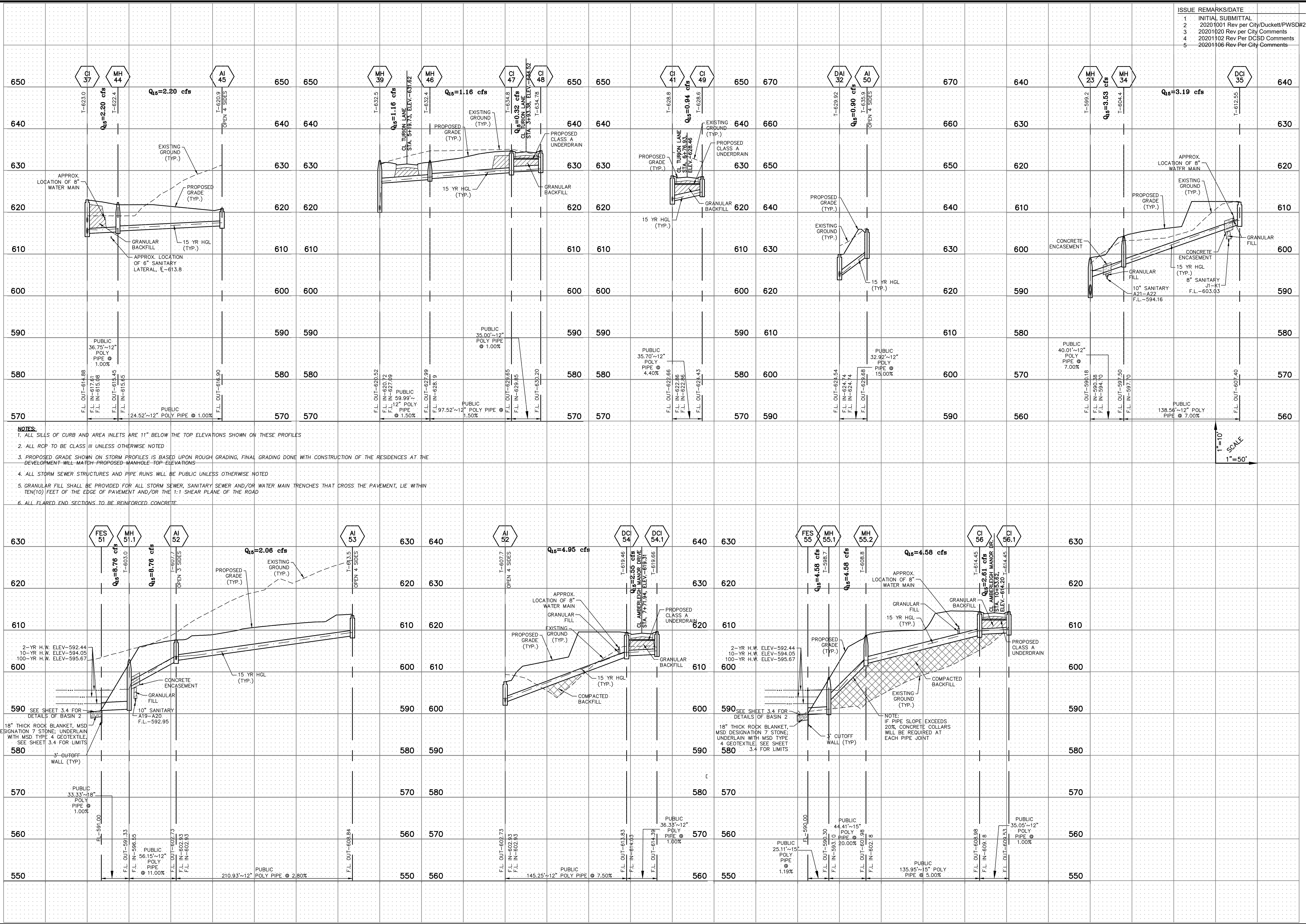

- NOTES:**
1. ALL SILLS OF CURB AND AREA INLETS ARE 11" BELOW THE TOP ELEVATIONS SHOWN ON THESE PROFILES
 2. ALL RCP TO BE CLASS III UNLESS OTHERWISE NOTED
 3. PROPOSED GRADE SHOWN ON STORM PROFILES IS BASED UPON ROUGH GRADING, FINAL GRADING DONE WITH CONSTRUCTION OF THE RESIDENCES AT THE DEVELOPMENT WILL MATCH PROPOSED MANHOLE TOP ELEVATIONS
 4. ALL STORM SEWER STRUCTURES AND PIPE RUNS WILL BE PUBLIC UNLESS OTHERWISE NOTED
 5. GRANULAR FILL SHALL BE PROVIDED FOR ALL STORM SEWER, SANITARY SEWER AND/OR WATER MAIN TRENCHES THAT CROSS THE PAVEMENT, LIE WITHIN TEN(10) FEET OF THE EDGE OF PAVEMENT AND/OR THE 1:1 SHEAR PLANE OF THE ROAD
 6. ALL FLARED END SECTIONS TO BE REINFORCED CONCRETE

ISSUE	REMARKS/DATE
1	INITIAL SUBMITTAL
2	20201001 Rev per City/Duckett/PWSD#2
3	20201020 Rev per City Comments
4	20201102 Rev Per DCSD Comments
5	20201106 Rev Per City Comments

PROJECT TITLE
STORM SEWER PROFILE

THE STERLING CO.
ENGINEERS & SURVEYORS
 5055 New Baumgartner Road
 St. Louis, Missouri 63129
 Ph 314-487-0440 Fax 314-487-8944
 www.sterling-eng-survey.com
 Corporate Certificate of Authority #001948

AMBERLEIGH
 OF FALLON, MISSOURI

Date: 5-18-2021
 Jason D Howell
 License No. PE 2007002801
 Professional Engineer

LOMBARDO HOMES OF ST. LOUIS, LLC
 2299 TECHNOLOGY DRIVE, SUITE 150
 OF FALLON, MISSOURI 63368
 Ph 636-265-2710
 Fax 636-695-3195

P+Z No. 20-00028
 City No. 20-003192
 Date: May 18, 2021
 Job No. 14-04-136
 Page No. **8.3** IMP