



LePIQUE & ORNE
ARCHITECTS, INC.
ESTABLISHED 1916
701 N. FIFTH STREET
SAINT CHARLES, MO 63301
PHONE 636-947-0099
FAX 636-947-8700

MISSOURI STATE
CERTIFICATE OF AUTH. #
A-000508-D

CIVIL ENGINEER
BAX ENGINEERING
221 POINT WEST BLVD.
ST. CHARLES, MO 63301
CONTACT: LARRY WALKER
PHONE: 636-928-5552
FAX: 636-928-1718

STRUCTURAL ENGINEER
SAMPL & ASSOCIATES
1047 DRIFTWOOD TRAILS
FLOISSANT, MO 63091
CONTACT: MIKE SAMPL
PHONE: 314-831-3751

MECHANICAL/ELECTRICAL
PLUMBING ENGINEER
G & W ENGINEERING
CORPORATION
138 WELDON PARKWAY
MARYLAND HEIGHTS, MO 63043
CONTACT: DUSTIN SCHELLER, P.E.
PHONE: 314-469-3757, EXT. 208
FAX: 314-469-5420

New Base Station #18 Facility For
**ST. CHARLES COUNTY
AMBULANCE DISTRICT**
335 Capri Drive
O'Fallon, Missouri 63377

DATE	ISSUE	R#
08-19-17	BIDDING & PERMITS	
09-01-17	CONSTRUCTION SET	

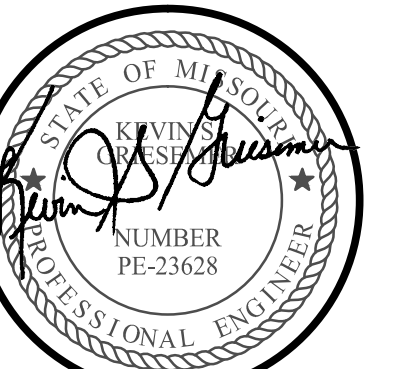

08/21/2017
KEVIN S. GRIESEMER
ENGINEER
MO # PE-23628

PROJECT MANAGER: DS
DRAWN BY: DS,FS

PROJECT NUMBER
2016-0396.01
DATE
SEPTEMBER 1, 2017

SHEET
E1.0
SITE LIGHTING
PHOTOMETRIC

Symbol	Label	QTY	Catalog Number	Description	Lamp	Lumens per Lamp	LLF	Wattage
⊙	SA	4	XTOR3B-W	CROSSTOUR 26W WALL MOUNT LED	EATON LED 4000K	2708.738	0.95	25.5
⊙	SB	9	XTOR6BRL-W	CROSSTOUR WALL MOUNT LED WITH REFRACTIVE LENS	EATON LED 4000K	6123.138	0.95	58
○	SD	3	ML5612835-6825C	HALO 6 INCH ML56 LED DOWNLIGHT WITH SPECULAR REFLECTOR	(1) HIGH LUMEN LED 80CRI 3500K CCT ABSOLUTE PHOTOMETRY IS BASED ON CALIBRATION FACTORS CREATED USING LAB LUMEN STANDARDS IN GONIOPHOTOMETER WITH TEST DISTANCE OF 28.75 FEET	1559.613	0.95	17.3
⊕	SE	1	AR13-10M-MV-NW-3-DB-530 FROM L01140605	26"L X 13-1/2"W X 8-1/4"H LED WITH OPTIC LENS		7249.608	0.95	65
⊕	SF	1	AR13-10M-MV-NW-2-DB-530 FROM L01140605	25-3/4"L X 13-1/2"W X 8"H LED LUMINAIRE LEDES WITH OPTICS		7337.677	0.95	66
⊕	SG	2	AR13-6M-MV-NW-2-DB-530 FROM L01140605	25-3/4"L X 13-1/2"W X 8"H LED LUMINAIRE LEDES WITH OPTICS		4402.611	0.95	39
⊕	SH	2	AR13-10M-MV-NW-4-DB-530 FROM L01140502	25-3/4"L X 13-1/2"W X 8-3/4"H LED LUMINAIRE LEDES WITH OPTICS		7459.111	0.95	68

Statistics						
Description	Symbol	Avg	Max	Min	Max/Min	Avg/Min
Calc Zone #2	+	2.0 fc	24.5 fc	0.0 fc	N/A	N/A

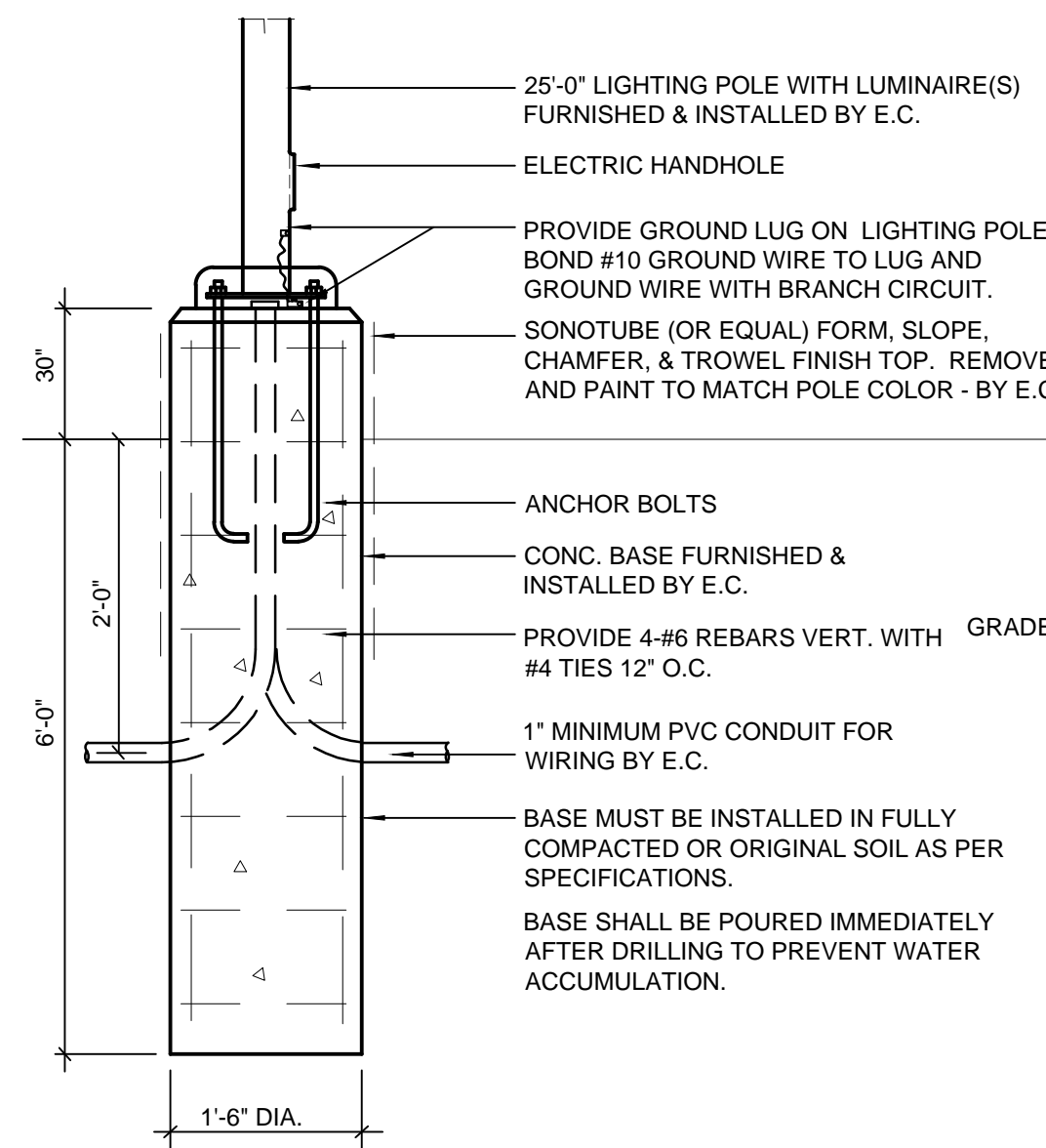

1 LIGHT STANDARD DETAIL
E1.0 NO SCALE

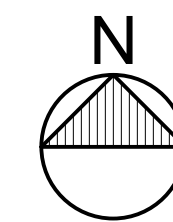
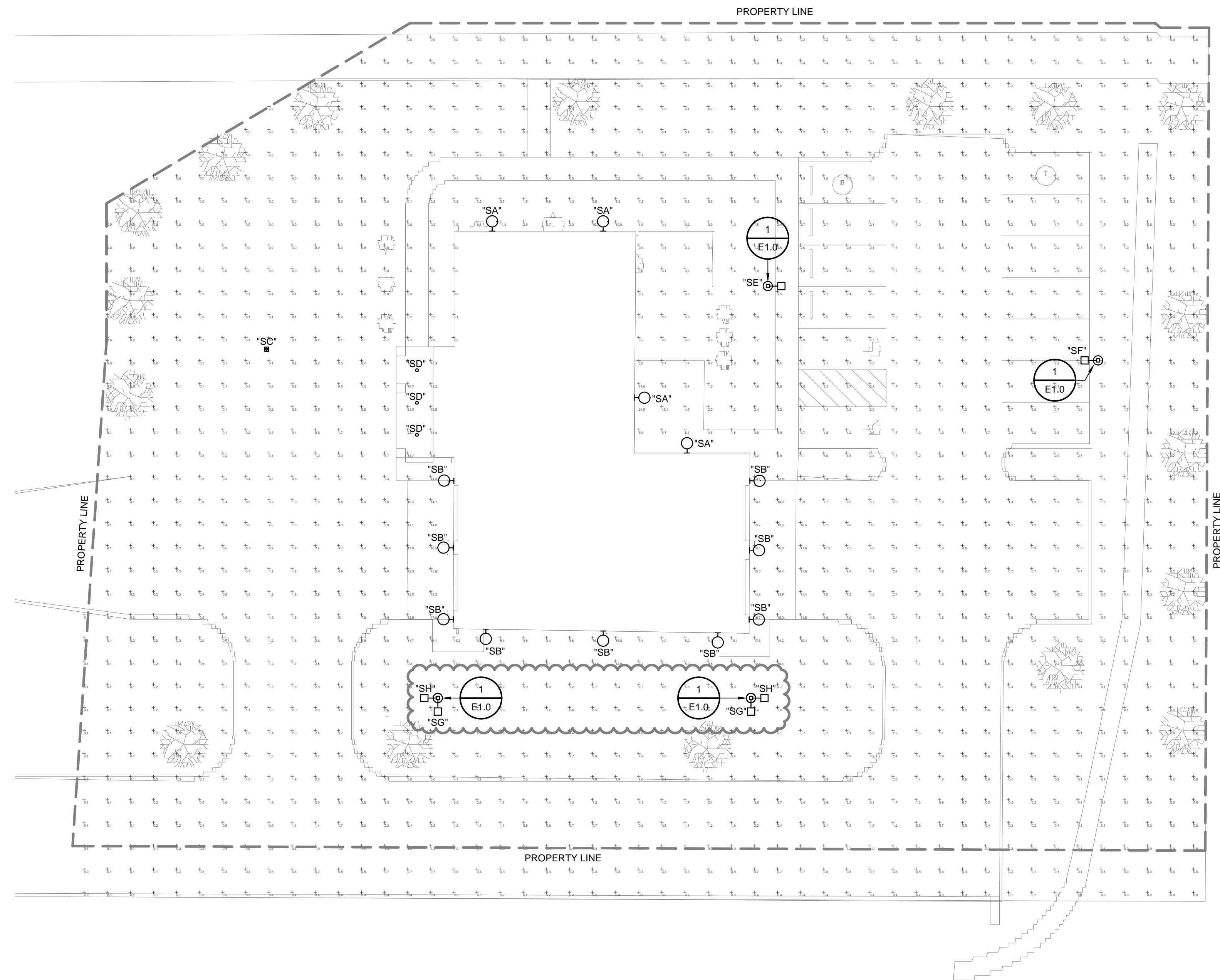

SITE LIGHTING PHOTOMETRIC

SCALE: 1/16" = 1'-0"