

| | | | |
|---|-------------|-----------|--|
| PRINT DIST. | | | |
| REVISIONS | | | |
| REV. 0 | W.O. 10969 | | |
| FIRST ISSUE | | | |
| REV. 1 | DATE 050200 | DRAWN JS | |
| CHKD NOT | SUPV SAH | APPD | |
| W.O. 10969 | FILM | | |
| ADD FDNS. PF-1A & C, & PF-2B & C | | | |
| REV. 2 | DATE 072100 | DRAWN MSM | |
| CHKD NOT | SUPV SAH | APPD | |
| W.O. 10696 | FILM | | |
| REVISE & RELOC. ANTENNA MAST FOUNDATION | | | |

9443-Y-149195

3

2

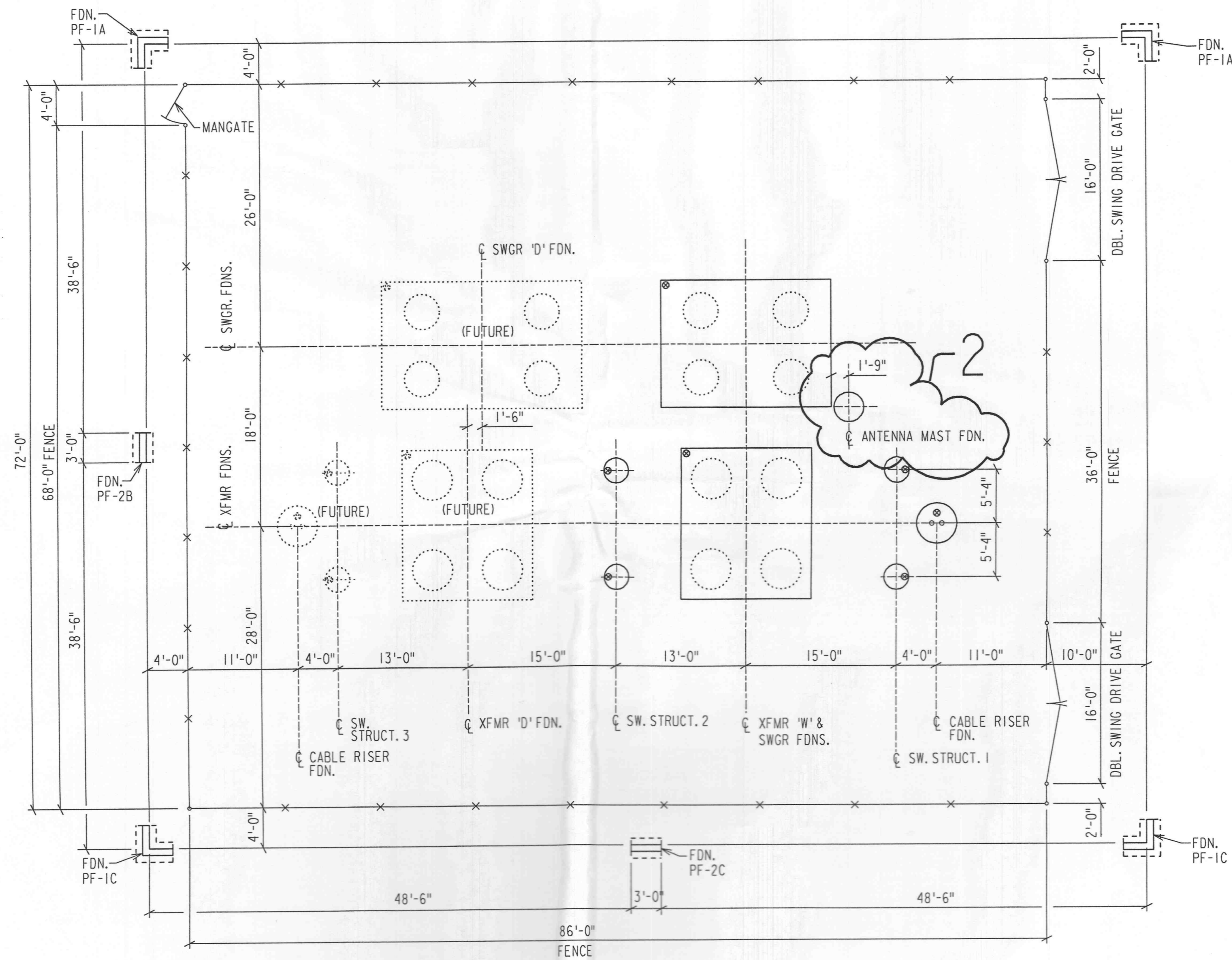

PLAN

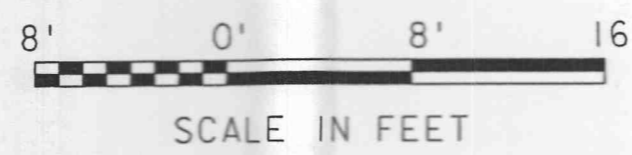
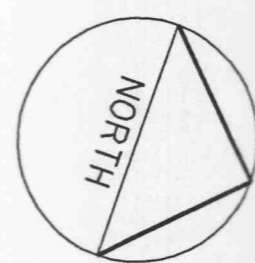

FOR CONSTRUCTION
 FOR RECORD ONLY
 C.J.O. NO.

FOUNDATION NOTES

1. REFERENCE MARKS ARE USED TO ORIENT THE FOUNDATIONS. MATCH THE ORIENTATION MARK ON THE FOUNDATION DETAIL DRAWING TO THE FOUNDATION LOCATION PLAN (THIS DRAWING).
2. ALL CONCRETE SHALL HAVE A MINIMUM COMPRESSIVE STRENGTH OF 4000 P.S.I. @ 28 DAYS.
3. CHAMFER ALL EXPOSED EDGES.
4. TOP OF CONCRETE ELEVATION SHALL BE 527.20' EXCEPT FOR PRIVACY FENCE FOUNDATIONS. REFER TO CHART AT RIGHT FOR PRIVACY FENCE FOUNDATIONS T.O.C.

| PRIVACY FENCE FOUNDATIONS | |
|---------------------------|---------|
| FDN. NO. | T.O.C. |
| PF-1A | 526.65' |
| PF-2B | 526.95' |
| PF-1C | 527.25' |
| PF-2C | 527.25' |

PROPERTY - SITE PLAN 9443-Y-149192
 EQUIPMENT ASSEMBLY 9443-Y-149201
 EQUIPMENT ASSEMBLY - SECTIONS 9443-Y-149202

| | | | |
|---|--|--|--|
| <p>NOTICE OF LIMITED RESPONSIBILITY</p> <p>THE RESPONSIBILITY OF THE UNDERSIGNED ENGINEER IS LIMITED TO THE DESIGN WORK SHOWN ON PROJECT DRAWINGS AND DOCUMENTS BEARING HIS/HER SEAL, SIGNATURE OR INITIALS. HE/SHE DOES NOT HAVE AUTHORITY OVER THE PROJECT AS A WHOLE. THE UNDERSIGNED DISCLAIMS ANY RESPONSIBILITY FOR WORK DONE UNDER SUBSEQUENT REVISIONS AND ANY OTHER DOCUMENTS ASSOCIATED WITH THE PROJECT WHICH DO NOT BEAR HIS/HER SEAL, SIGNATURE OR INITIALS.</p> | | <p>PREPARED FOR Ameren</p> | |
| <p>REV. 0 SEALED BY</p> <p></p> | <p>DRAWN 4 FEB 00 P. MANIS</p> <p>CHKD. NOT CHKD.</p> <p>SUPV. SAH</p> <p>APPD. 2-14-00 C.J.G.</p> | <p>FOUNDATION LOCATION PLAN</p> <p>LOCATION WINGHAVEN SUBSTATION CLASS 04020</p> <p>ST. LOUIS, MISSOURI 9443-Y-149195 REV. 2</p> | |

37-13-18 Rev. 9-85