

STORM SEWER PROFILE
 SCALES:
 HORIZ. 1" = 40'
 VERT. 1" = 10'

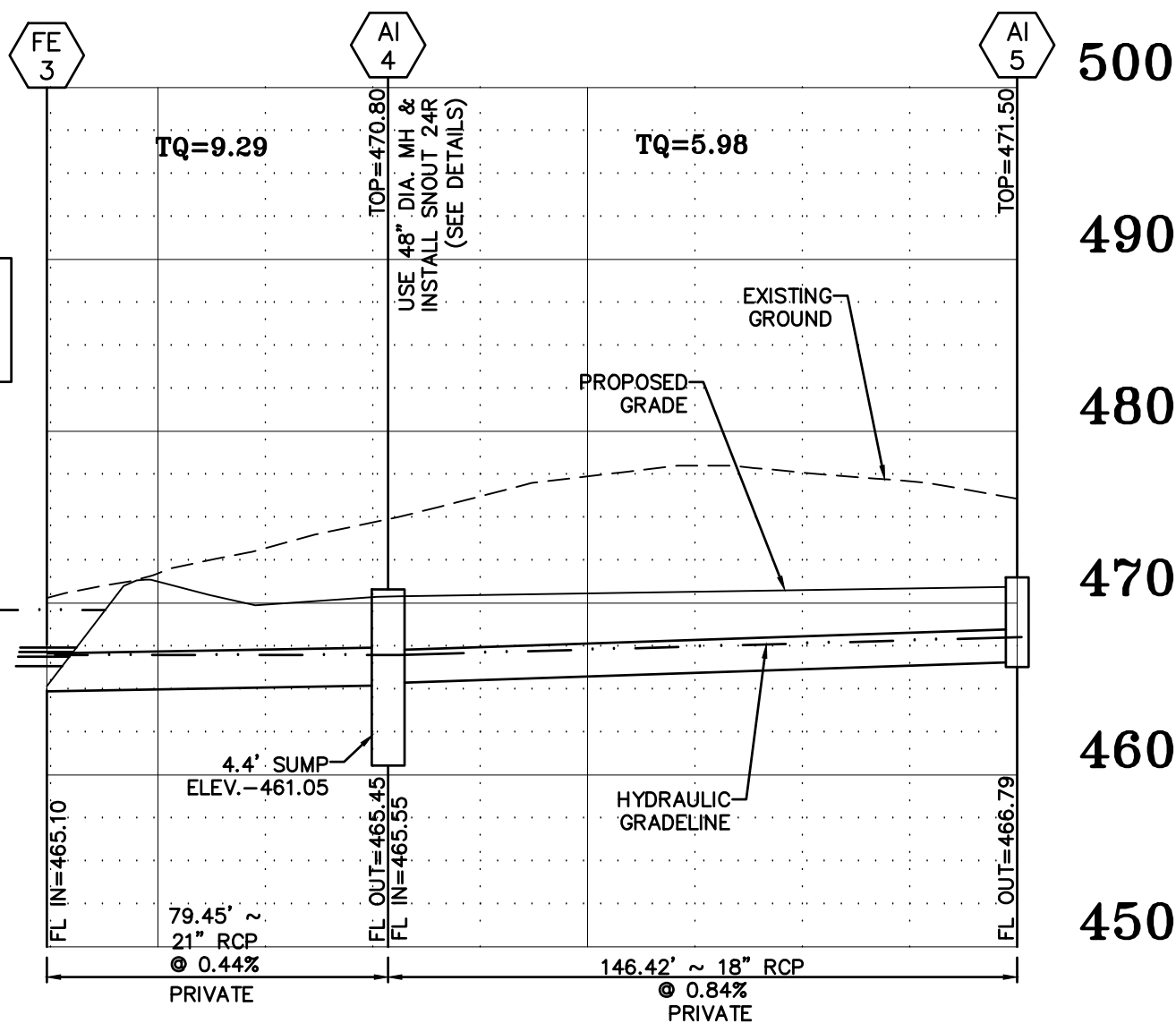

STORM SEWER PROFILE
 SCALES:
 HORIZ. 1" = 40'
 VERT. 1" = 10'

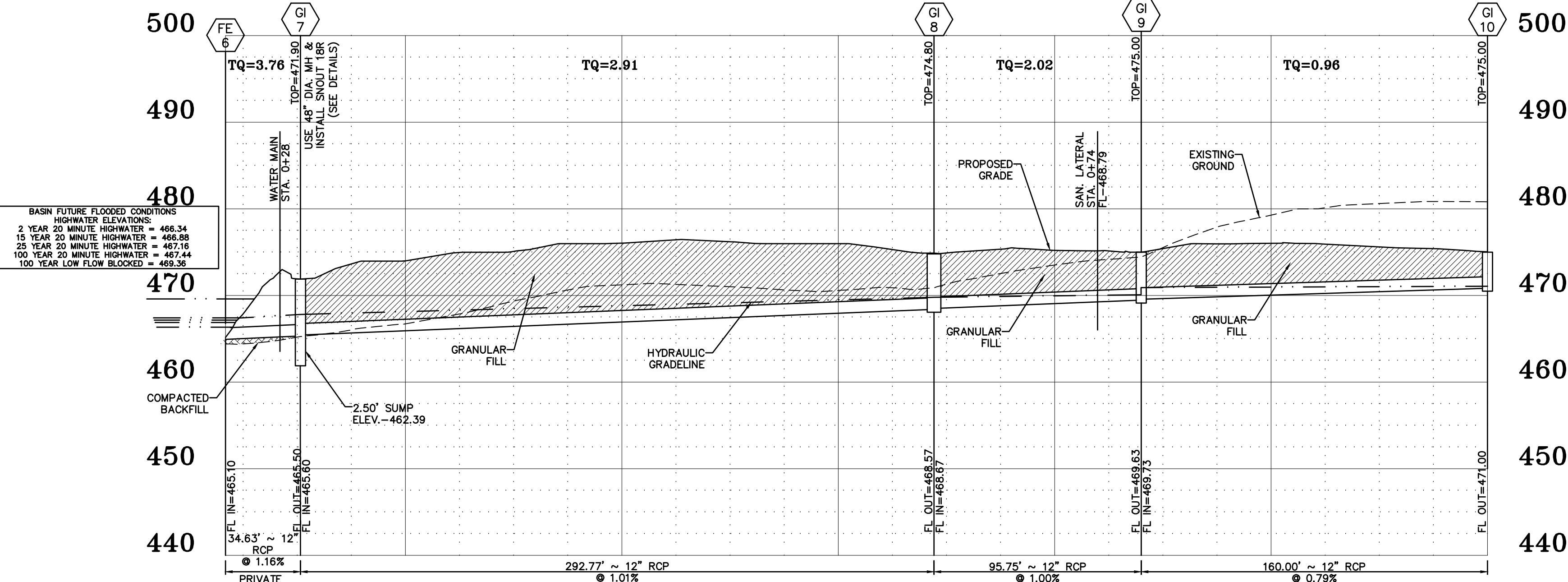

STORM SEWER PROFILE
 SCALES:
 HORIZ. 1" = 40'
 VERT. 1" = 10'

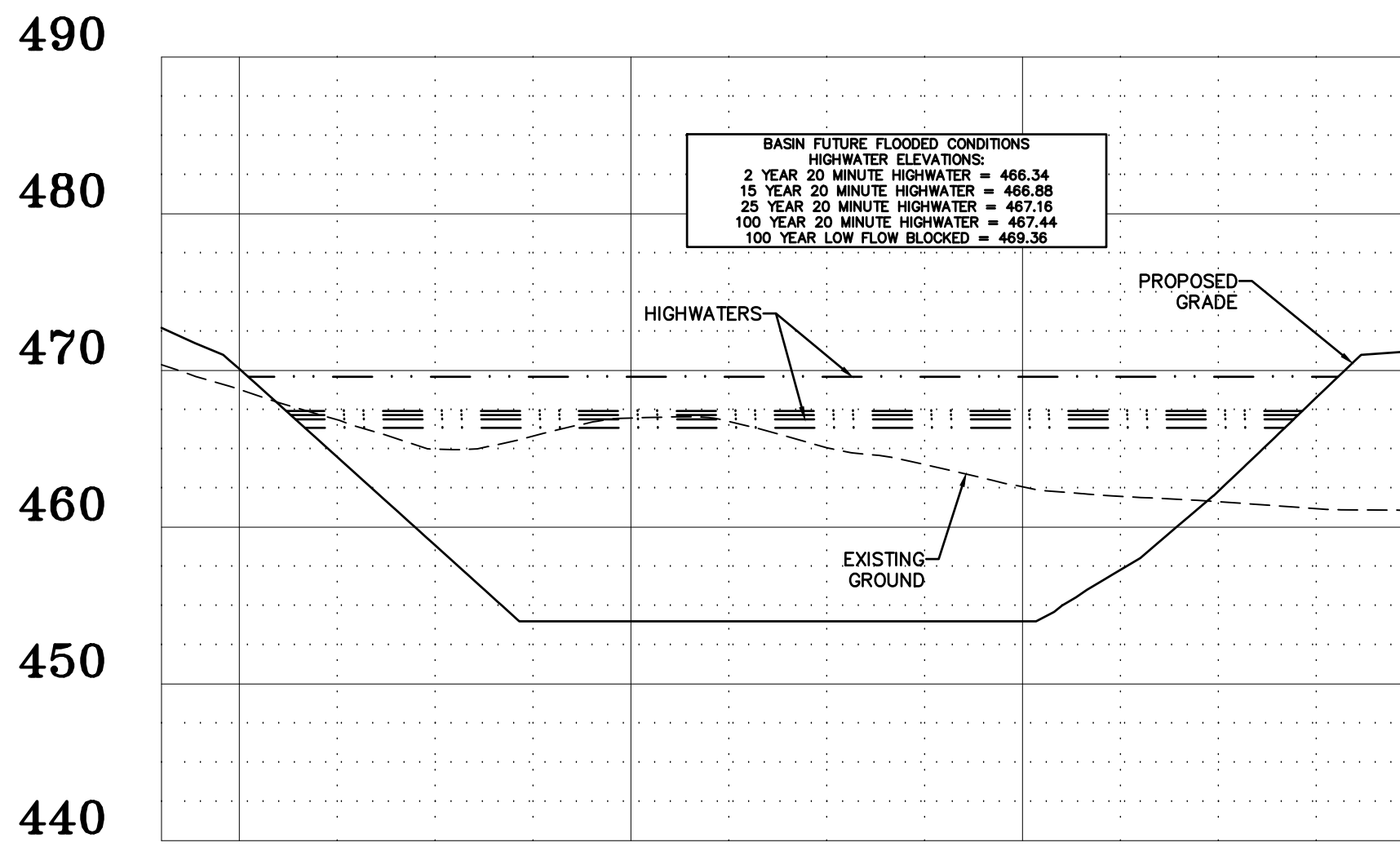

DETENTION BASIN CROSS SECTION A-A
 SCALES:
 HORIZ. 1" = 40'
 VERT. 1" = 10'

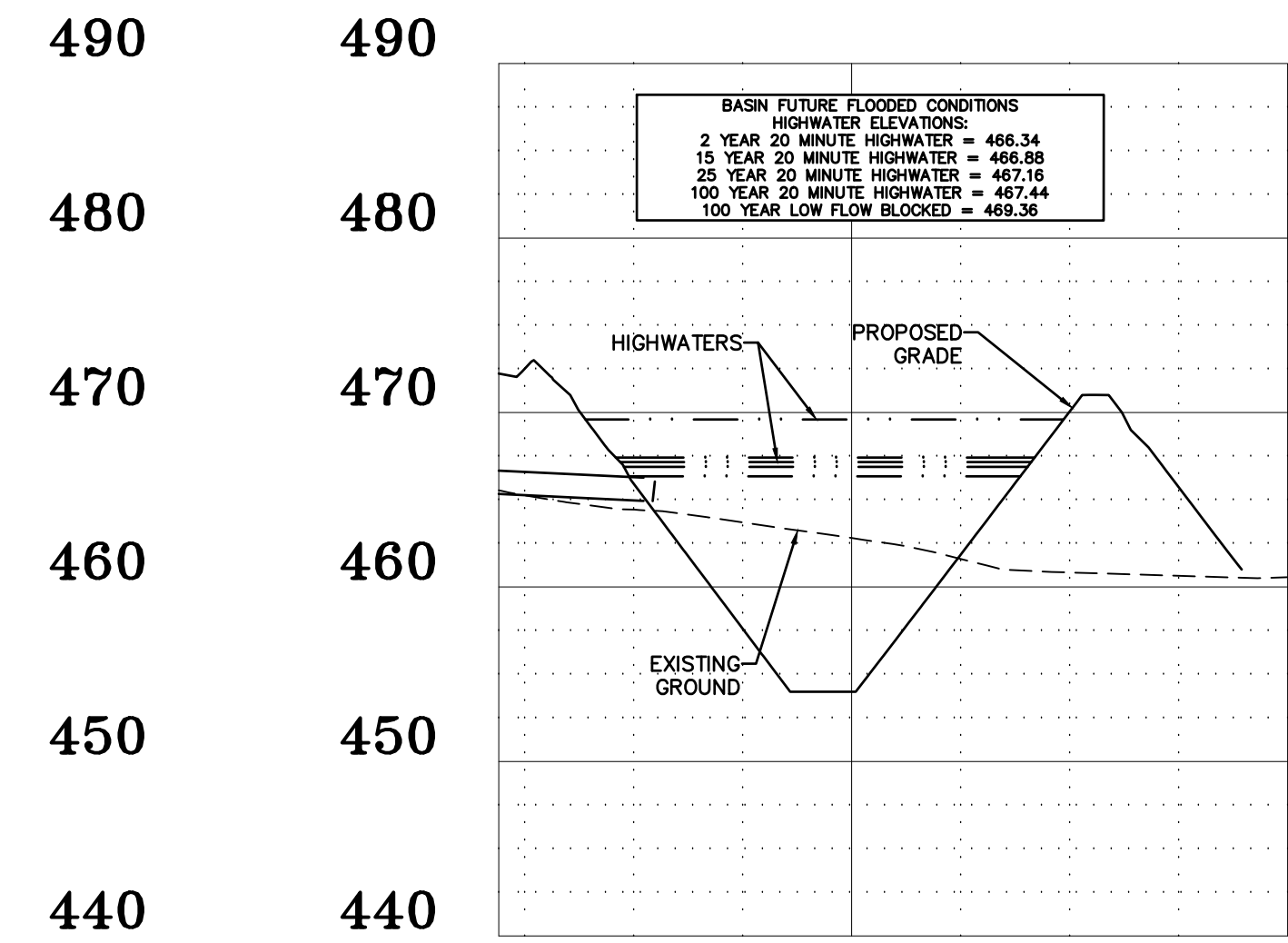

DETENTION BASIN CROSS SECTION B-B
 SCALES:
 HORIZ. 1" = 40'
 VERT. 1" = 10'

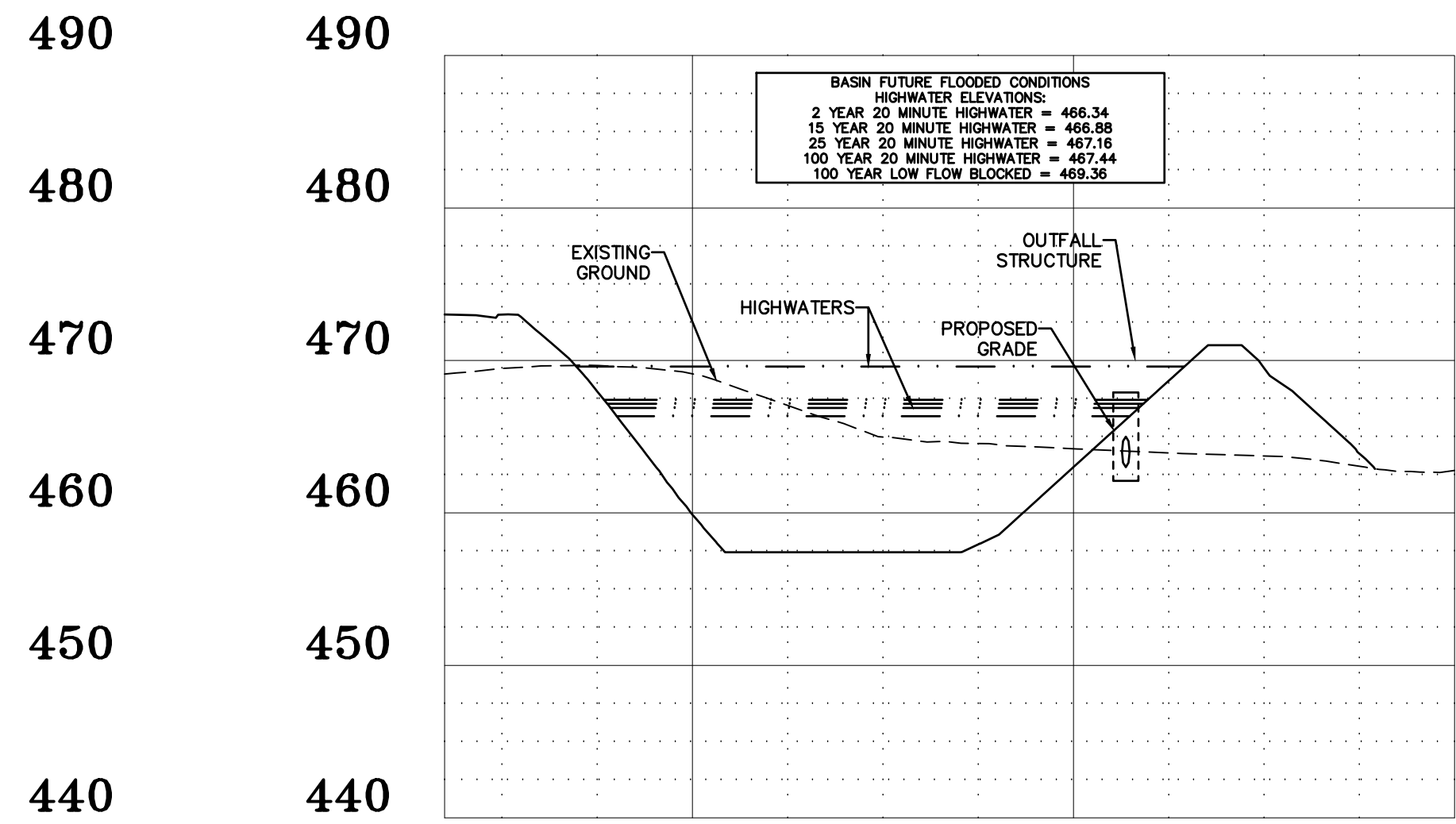

DETENTION BASIN CROSS SECTION C-C
 SCALES:
 HORIZ. 1" = 40'
 VERT. 1" = 10'

St Charles County Government
 Hydraulic Review Output Data
 \\VAULTSERVER\FileFolders\18000\18663 - 65 Schaper Rd_Wholesale Plumbing\Engineering\Hydraulics\18663_revised.txt
 11/22/2022
 Calculations Under Full Flow

Upp Str	Low Str	PL	S	Upp FL LN	Low FL LN	PS	Upp STEL	Depth HY GR	Upp HY EL	Low HY EL	Hydr Grade	FR Head	VEL	Junc Loss	Turn Loss	Curve Loss	STR Grade	Inl Cap	DR Area	P.I.	Q	TQ	Pipe Cap	Remarks	
1	GI14	GI13	49	12	661.91	661.42	1.00	665.60	2.78	662.82	662.56	0.00300	0.15	2.70	0.11	0.11	0.00	0.00	2	4.00			2.12	3.86	
2	GI13	FE12	34	12	661.32	661.00	0.94	665.60	3.04	662.56	662.31	0.00700	0.24	4.10	0.26	0.00	0.01	0.00	2	4.00			3.22	3.74	
3	OS11	FE10	70	12	654.94	653.20	2.49	662.00	5.62	656.38	654.20	0.02030	1.42	7.00	0.76	0.76	0.00	0.00	0	6.00			5.50	6.09	
4	GI8	GI7	259	12	670.03	664.85	2.00	677.20	6.65	670.56*	667.47	0.00610	1.58	3.85	0.23	0.23	0.00	0.00	2	4.00			3.02	5.46	
5	GI7	FE6	31	12	664.75	664.00	2.42	670.00	2.53	667.47	666.95	0.01290	0.40	5.59	0.49	0.00	0.12	0.00	4	4.00			4.39	6.00	
6	EXA19	AI4	217	36	662.75	654.73	3.70	674.40	10.52	663.88*	657.76	0.00310	0.67	5.67	0.50	0.50	0.00	0.00	0	4.00			40.05	138.99	
7	OS5	AI4	67	12	658.50	654.73	5.63	665.00	5.57	659.43	657.76	0.01600	1.07	6.21	0.60	0.60	0.00	0.00	0	6.00			4.88	9.16	
8	AI4	GI3	36	36	654.63	654.27	1.00	663.70	5.94	657.76	657.27	0.00430	0.15	6.71	0.70	0.34	0.00	0.00	2	4.00			47.43	72.26	
9	GI3	GI2	20	36	654.17	653.77	2.00	662.55	5.46	657.09	656.77	0.00440	0.09	6.79	0.72	0.00	0.23	0.00	2	4.00			48.00	102.19	
10	GI2	FE1	48	36	653.67	650.00	7.85	662.55	7.86	654.69*	653.00	0.00450	0.22	6.88	0.74	0.00	0.25	0.00	2	4.00			48.64	199.85	

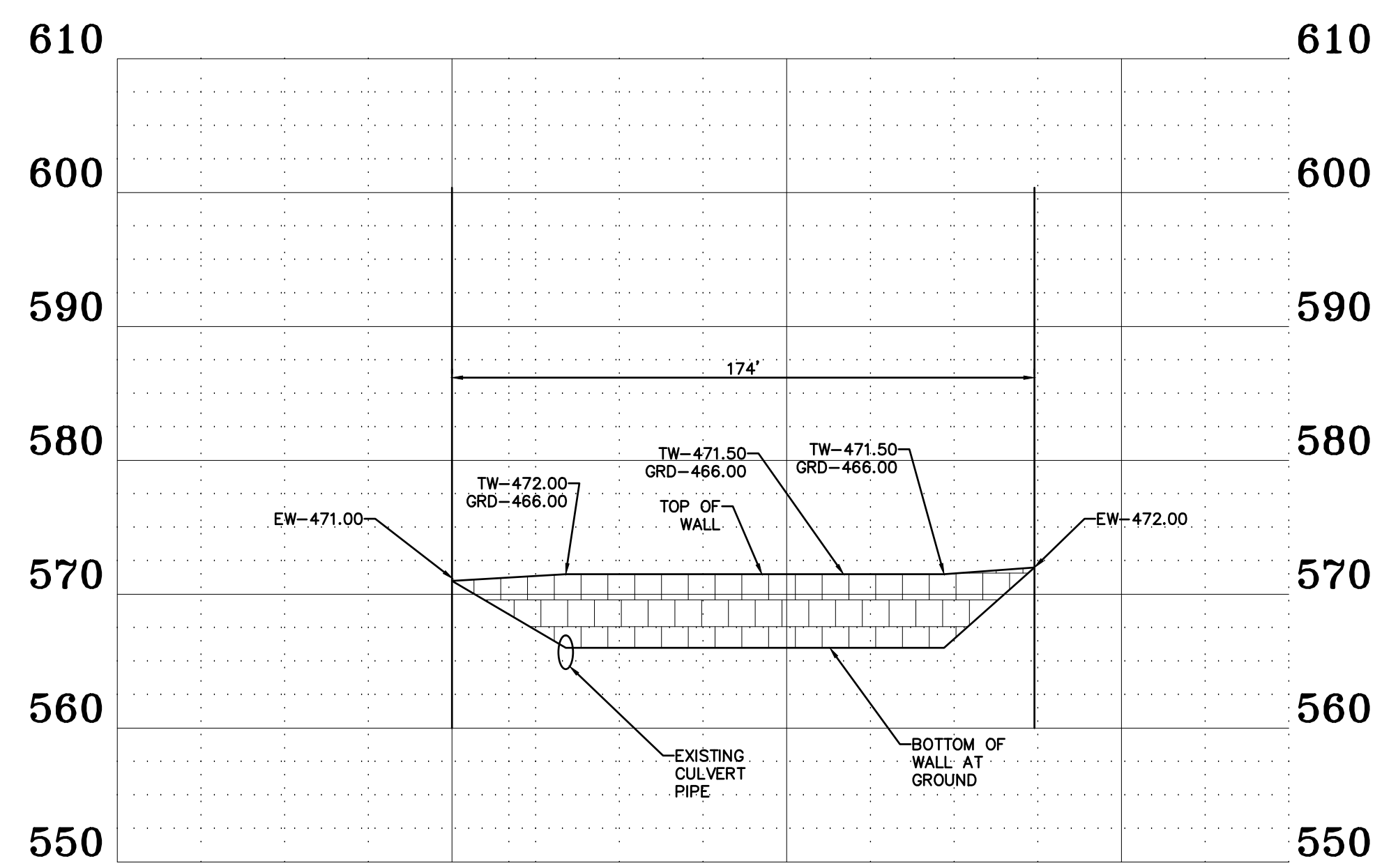

RETAINING WALL PROFILE
 SCALES:
 HORIZ. 1" = 40'
 VERT. 1" = 10'

PROJECT TITLE:
 Anjon Manufacturing
 South Cool Springs Road

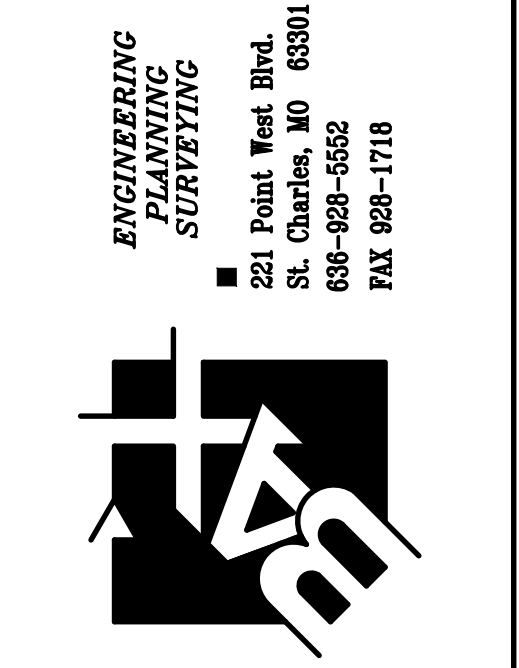

DISCLAIMER OF RESPONSIBILITY
 I hereby specify that the documents intended to be authorized by my seal are limited to this sheet, and I hereby disclaim any responsibility for all other Drawings, Specifications, Estimates, Reports or other documents or instruments relating to or intended to be used for any part or parts of the architectural or engineering project or survey.

CLIFFORD L. HEITMANN
 CIVIL ENGINEER
 E29817
 Copyright 2022
 Box Engineering Company, Inc.
 Authority No. 000655
 All Rights Reserved

REVISIONS

06-09-22	CITY COMMENTS
06-27-22	CITY COMMENTS
07-06-22	CITY COMMENTS
08-23-22	CITY COMMENTS
09-16-22	CITY COMMENTS
11-22-22	CLIENT REVISIONS
12-01-22	CITY COMMENTS
01-25-23	CLIENT REVISIONS

Owner:
 Lottes Springs, LLC
 1000 Liberty Industrial Drive
 O'Fallon, MO 63366
 800-553-5605

P+Z No. #21-011066
Approval Date: 02-07-22

City No.

Page No.
 C9

Box Project # 99-106393 Issue Date: 04/01/2022

STORM SEWER PROFILES