

MATCH LINE @ STA 85+50 (SEE SHEET 16)

MATCH LINE @ STA 91+50

MATCH LINE @ STA 91+50

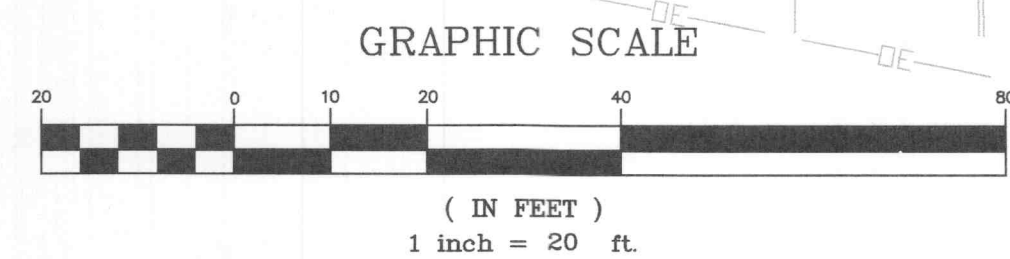
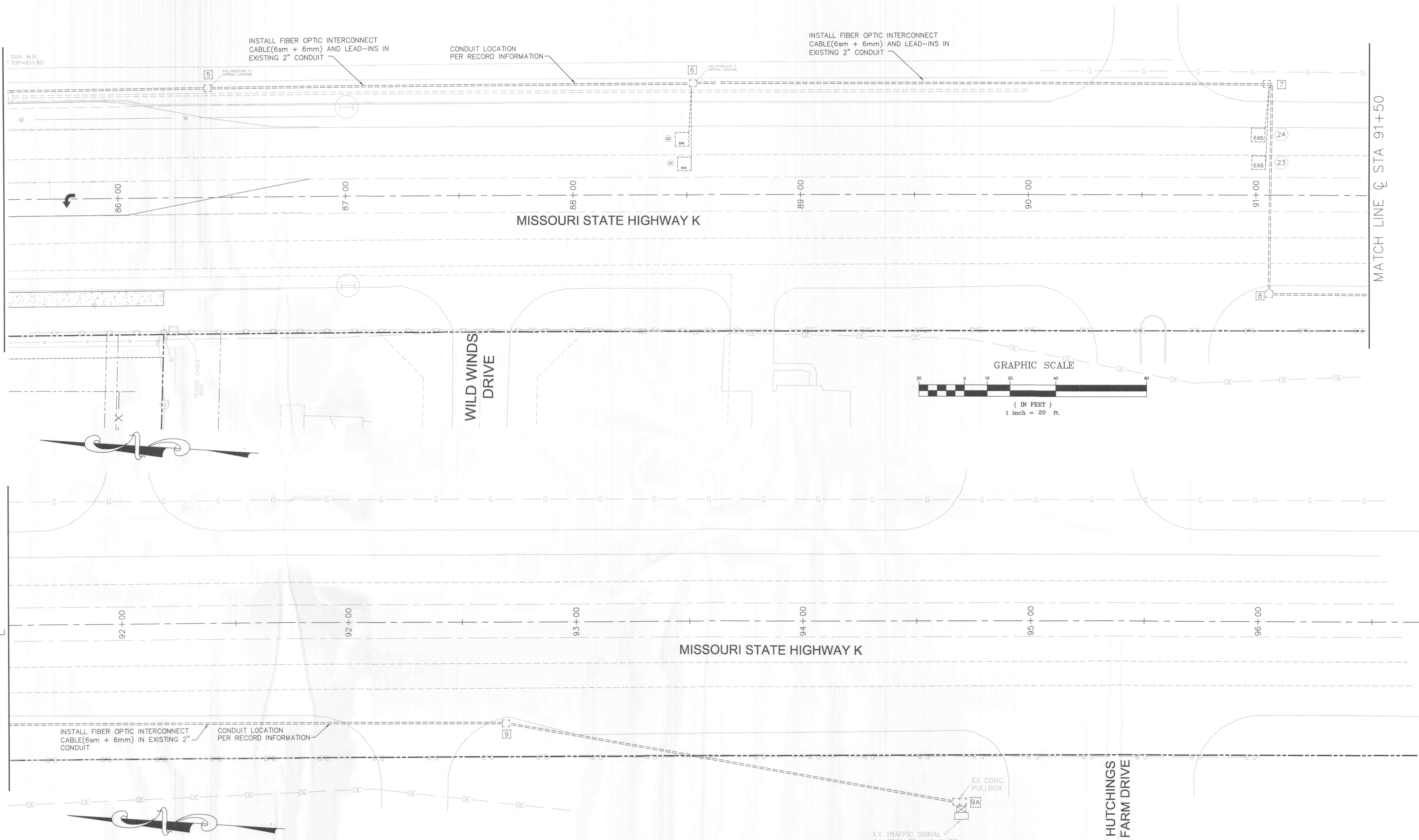

HUTCHINGS FARM DRIVE

REVISD FOR MoDOT COMMENTS AND VALUE ENGINEERING 03/10/05

SIGNAL PLAN - SYMBOLS AND DETAILS
TERRA RETAIL DEVELOPMENT/ASHLEY FURNITURE

P&Z NOS: 98-126.03
98-126.04
05/06/05

UTILITY NOTE:

UNDERGROUND FACILITIES, STRUCTURES AND UTILITIES HAVE BEEN PLOTTED FROM AVAILABLE SURVEYS, RECORDS AND INFORMATION, AND, THEREFORE DO NOT NECESSARILY REFLECT THE ACTUAL EXISTENCE, NON-EXISTENCE, SIZE, TYPE, NUMBER, OR LOCATION OF THESE FACILITIES, STRUCTURES AND UTILITIES. THE CONTRACTOR SHALL BE RESPONSIBLE FOR VERIFYING THE ACTUAL LOCATION OF ALL UNDERGROUND FACILITIES, STRUCTURES, AND UTILITIES, EITHER SHOWN OR NOT SHOWN ON THESE PLANS. THE UNDERGROUND FACILITIES, STRUCTURES, AND UTILITIES SHALL BE LOCATED IN THE FIELD PRIOR TO ANY GRADING, EXCAVATION OR CONSTRUCTION OF IMPROVEMENTS. THESE PROVISIONS SHALL IN NO WAY ABSOLVE ANY PARTY FROM COMPLYING WITH THE UNDERGROUND FACILITY SAFETY AND DAMAGE PREVENTION ACT, CHAPTER 319 RSMo.

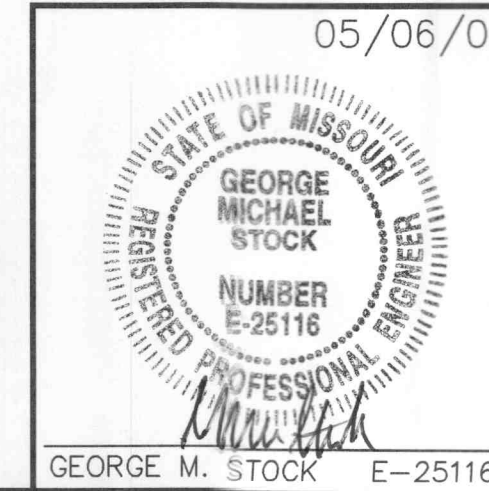
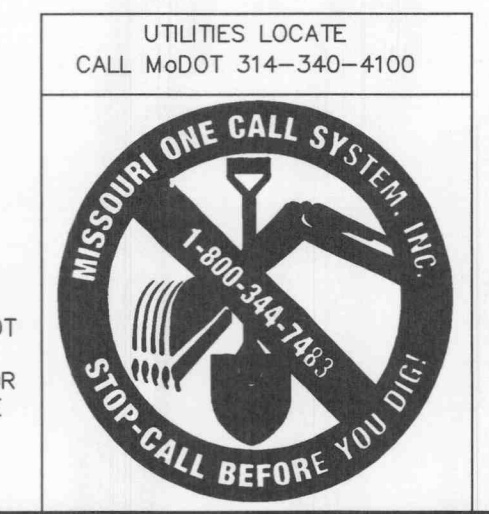

Stock & Associates
Consulting Engineers, Inc.

257 Chesterfield Business Parkway
St. Louis, MO 63005
PH. (636) 530-9100
FAX (636) 530-9130
e-mail: general@stockassoc.com
Web: www.stockassoc.com

DRAWN BY: S.J.K. DATE: 11/23/04
CHECKED BY: G.M.S. DATE: 11/23/04
JOB NUMBER: 204-3381
SHEET: C17 of 23