

AUBURN TRACE  
FLAT PLAN

GRAPHIC SCALE



"ROSE HILL  
ESTATES"  
P.B. 23, PG. 35

CURB INLET	STATION	OFFSET
CI 4 & CI 5	3+88.86	17.0'
CI 8 & CI 9	5+17.09	17.0'
CI 11	2+88.08	17.0'
CI 12 & CI 13	0+49	17.0'
CI 31	0+63.67	17.0'

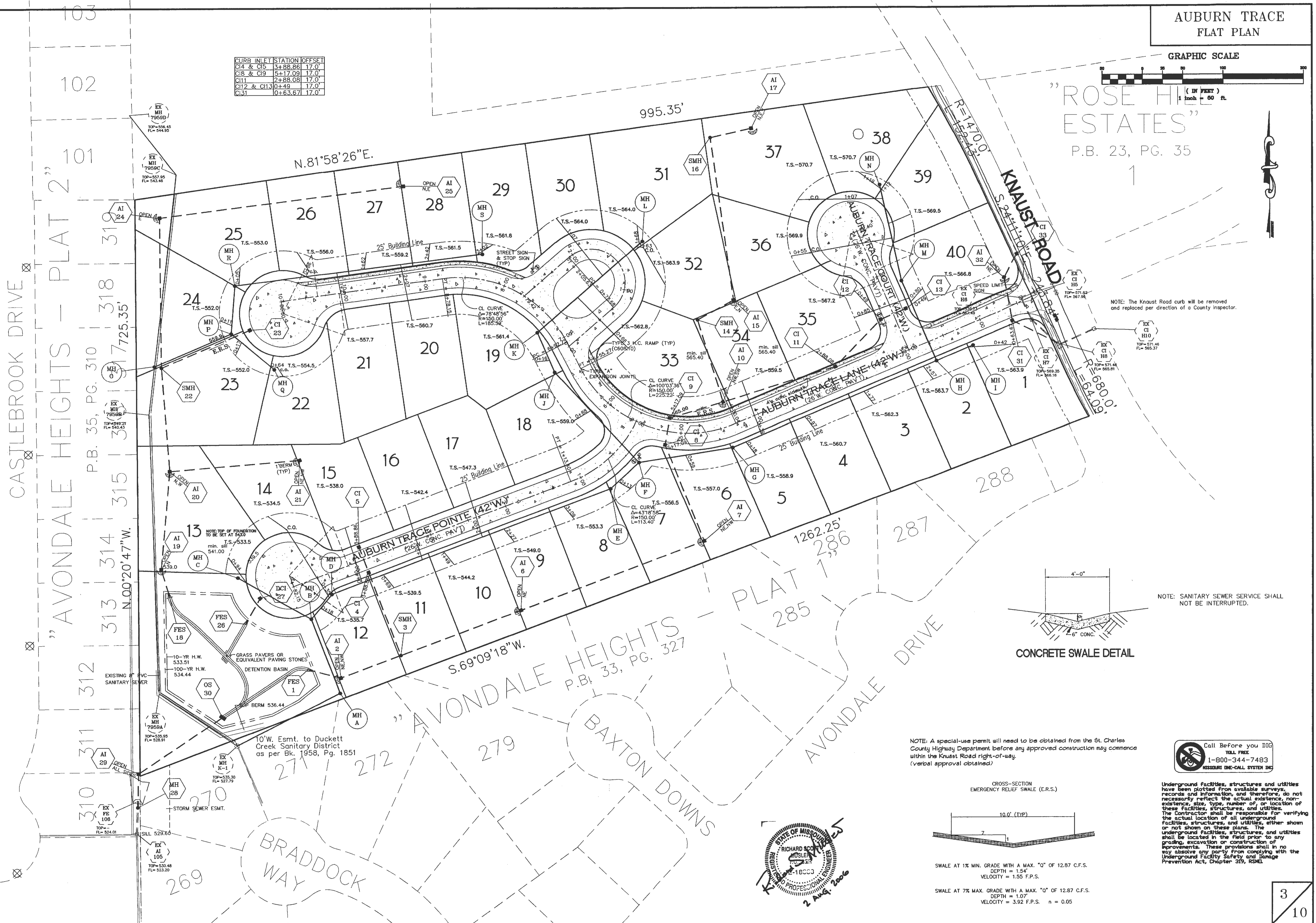

NOTE: The Knaust Road curb will be removed and replaced per direction of a County Inspector.

NOTE: SANITARY SEWER SERVICE SHALL NOT BE INTERRUPTED.

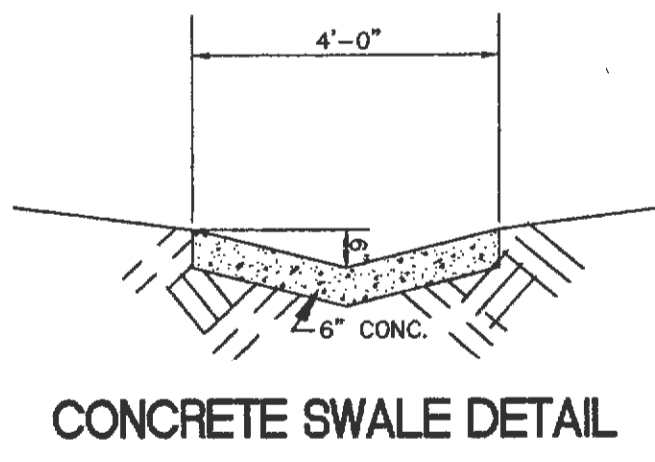

NOTE: A special-use permit will need to be obtained from the St. Charles County Highway Department before any approved construction may commence within the Knaust Road right-of-way. (verbal approval obtained)



Underground facilities, structures and utilities have been plotted from available surveys, records and information and therefore, do not necessarily reflect the actual existence, non-existence, size, type, number of, or location of these facilities, structures, and utilities. The Contractor shall be responsible for verifying the actual location of all underground facilities, structures, and utilities, either shown or not shown on these plans. The underground facilities, structures, and utilities shall be located in the field prior to any grading, excavation or construction of improvements. These provisions shall in no way absolve any party from complying with the Underground Facility Safety and Damage Prevention Act, Chapter 319, RSMo.

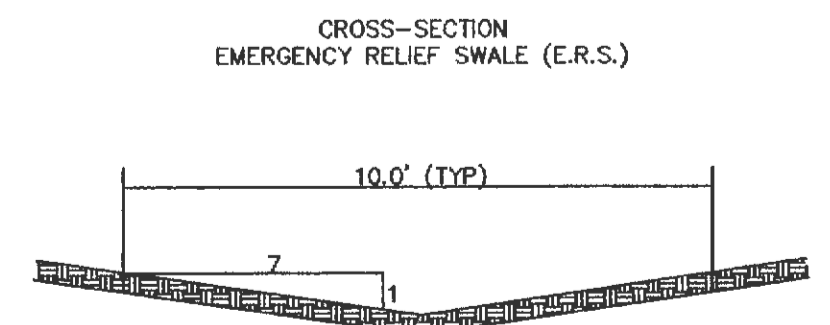

SWALE AT 1% MIN. GRADE WITH A MAX. "Q" OF 12.87 C.F.S.  
DEPTH = 1.54'  
VELOCITY = 1.55 F.P.S.

SWALE AT 7% MAX. GRADE WITH A MAX. "Q" OF 12.87 C.F.S.  
DEPTH = 1.07'  
VELOCITY = 3.92 F.P.S. n = 0.05

