

**AUBURN TRACE
GRADING PLAN**

GRAPHIC SCALE

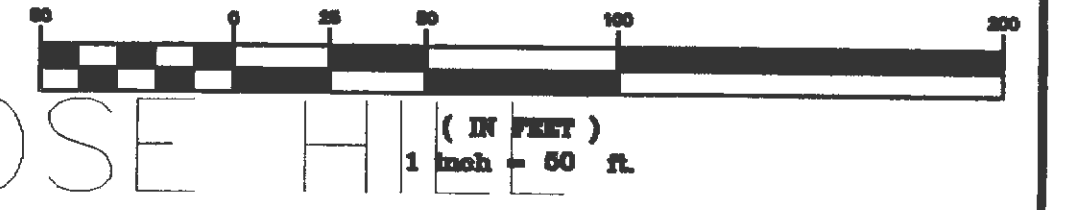

ROSE HILL
ESTATES
P.B. 23, PG. 35

NOTE: The Knaut Road curb will be removed and replaced per direction of a County inspector.

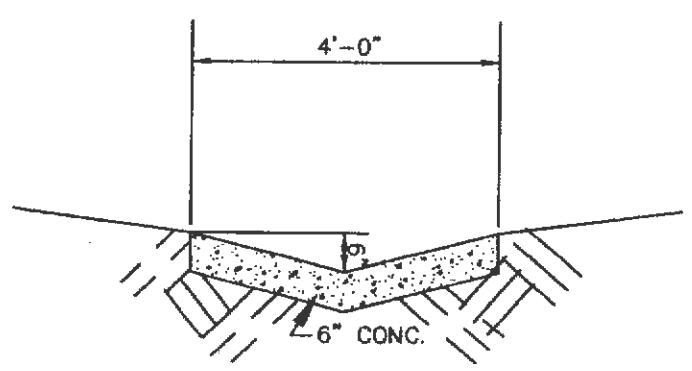
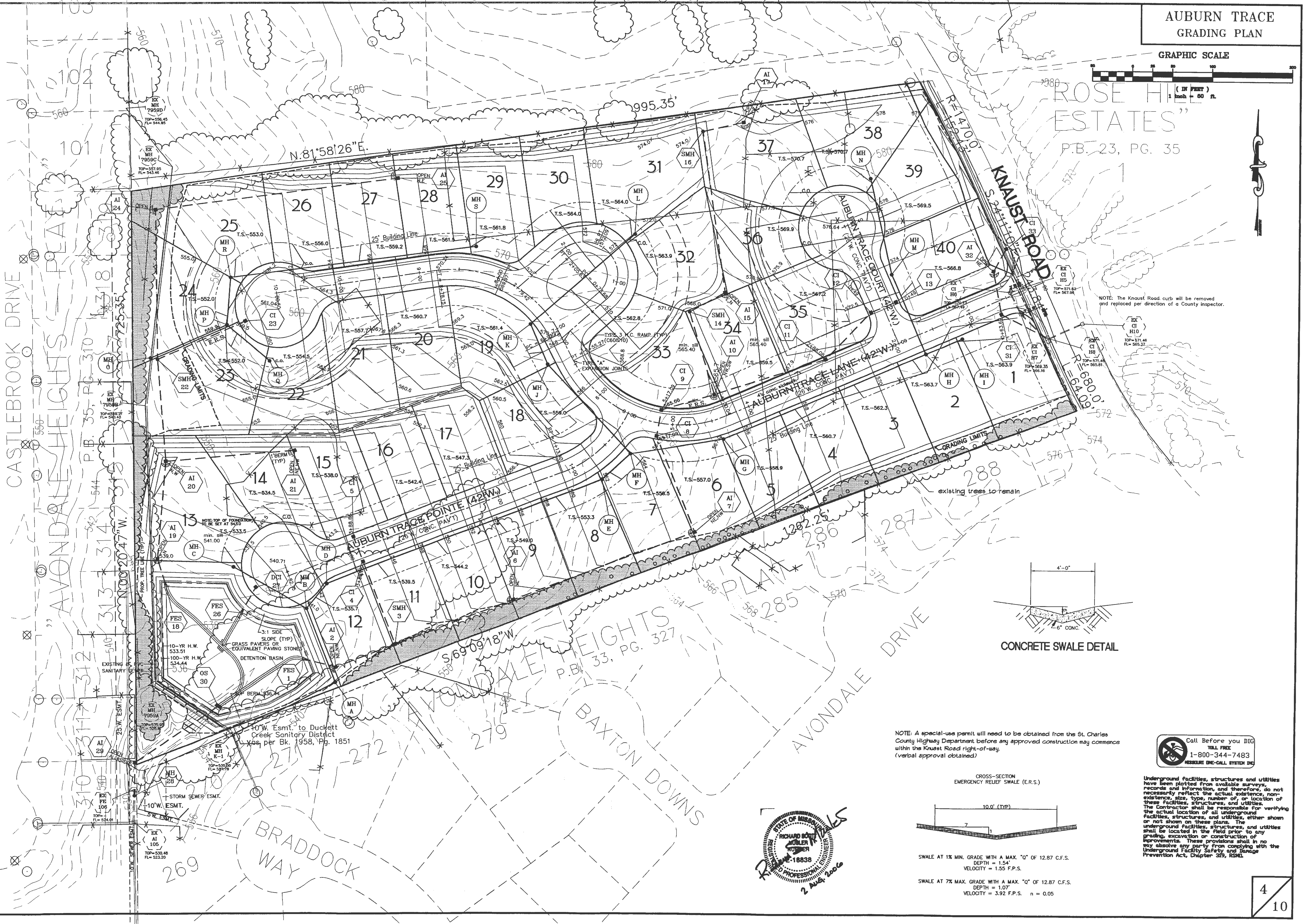

CONCRETE SWALE DETAIL

NOTE: A special-use permit will need to be obtained from the St. Charles County Highway Department before any approved construction may commence within the Knaut Road right-of-way. (verbal approval obtained)

Call Before you DIG
TOLL FREE
1-800-344-7483
RESURFACE ONE-CALL SYSTEM INC.

Underground facilities, structures and utilities have been plotted from available surveys, records and information, and therefore, do not necessarily reflect the actual existence, non-existence, size, type, number of, or location of these facilities, structures, and utilities. The Contractor shall be responsible for verifying the actual location of all underground facilities, structures, and utilities, either shown or not shown on these plans. The underground facilities, structures, and utilities shall be located in the field prior to any grading, excavation or construction of improvements. These provisions shall in no way absolve any party from complying with the Underground Facility Safety and Damage Prevention Act, Chapter 319, RSM.

CROSS-SECTION EMERGENCY RELIEF SWALE (E.R.S.)

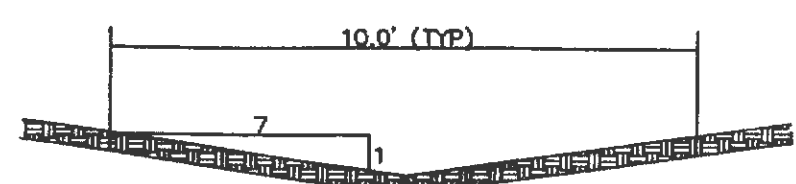

SWALE AT 1% MIN. GRADE WITH A MAX. "Q" OF 12.87 C.F.S.
DEPTH = 1.54'
VELOCITY = 1.55 F.P.S.

SWALE AT 7% MAX. GRADE WITH A MAX. "Q" OF 12.87 C.F.S.
DEPTH = 1.07'
VELOCITY = 3.92 F.P.S. n = 0.05

