

REVISED - 03-10-00 CITY & DCSO COMMENTS
 REVISED - 04-07-00 CITY COMMENTS
 REVISED - 04-25-00 CITY COMMENTS

TYPE 3 CURB RAMP		
GRADE ALONG CURB (±)	MIN. LENGTH OF RAMP SLOPE (L.F.)	NOTES
0 TO +2	7	
+2.01 TO +3	8	
+3.01 TO +4	9	
+4.01 TO +5	10	
+5.01 TO +6	11	
GREATER THAN +6	12	

NOTE: Positive (+) "G" - Proceeding away from intersection and up a grade.
 Negative (-) "G" - Proceeding away from intersection and down a grade.

GENERAL NOTES

- Do not scale drawing. Follow dimensions.
- Sidewalks and sidewalk curb ramps shall be constructed in accordance with these details and the current approved "Americans with Disabilities Act Accessibility Guidelines" (A.D.A.A.G.).
- Provide a landing at the top of each straight ramp when Grade Along Curb ("G") is greater than +2% and less than +7%. For other values of "G", including all negative (-) values, no landing is required.
- Minimum sidewalk width along 3" rolled curb shall be 4 feet.
- Maximum sidewalk cross slope 0.02'/ft.
- All sidewalk sections shall be 4" thick, except where indicated otherwise by shaded portions shown on details. All sidewalk sections and curb ramps, regardless of thickness, shall be paid for as "Concrete Sidewalk".
- Where curb ramp meets pavement, bullnose will not be permitted.
- Construct a diagonal ramp when the maximum corner radius allowed for a straight ramp is exceeded.
- If integral concrete curb is constructed, strike a dummy joint across bottom of ramp at curb line. If concrete curb is dowel-on, block out pavement to provide full depth curb across ramp from outer point of curb taper to outer point of curb taper.
- For sidewalk locations on cul-de-sacs, refer to "Pavement Construction Details".
- For pavement longitudinal and transverse joints and dowel and tie bar requirements and dimensions, refer to the "Pavement Construction Details for Joints and Curbs", Standard Drawing CS02.03.
- For roadway cross slopes, pavement types, and thicknesses, refer to "Standard Typical Section".
- The intersection of two sidewalks or the intersection of a sidewalk and a driveway may serve as a wheelchair passing spaces on sidewalks less than 5 feet wide.

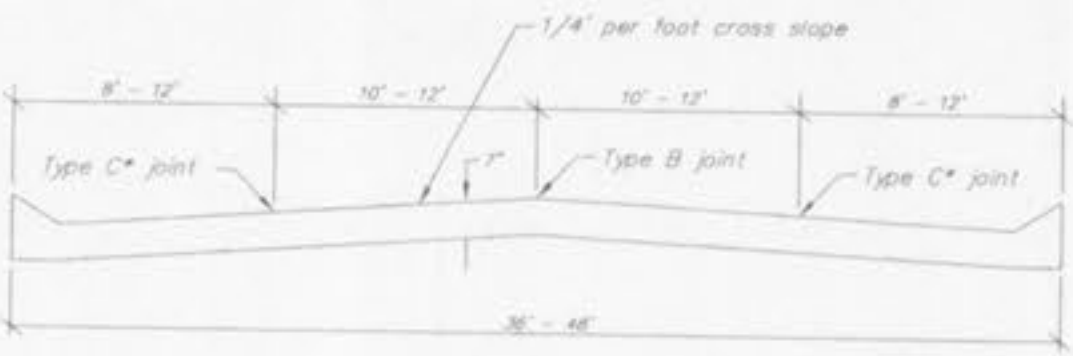

SECTION - 36'-48' WIDTH
 NOT TO SCALE

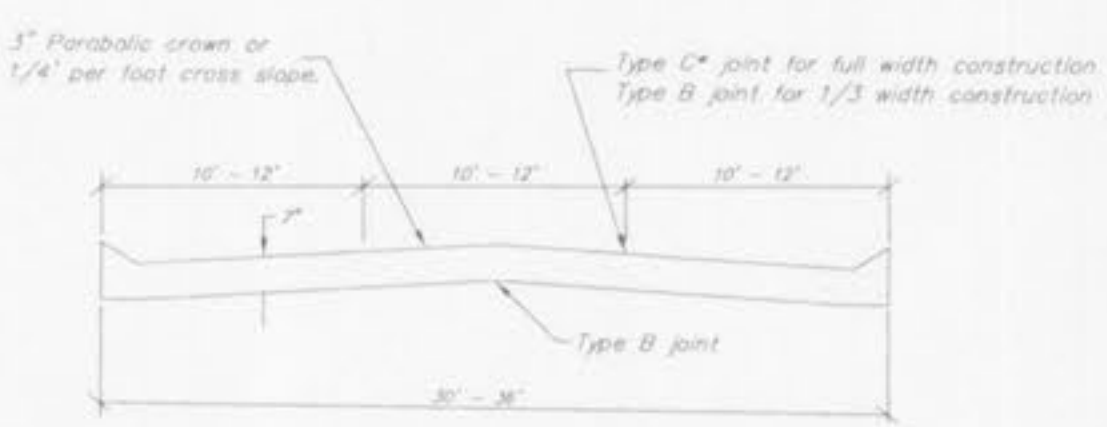

SECTION - 30'-36' WIDTH
 NOT TO SCALE

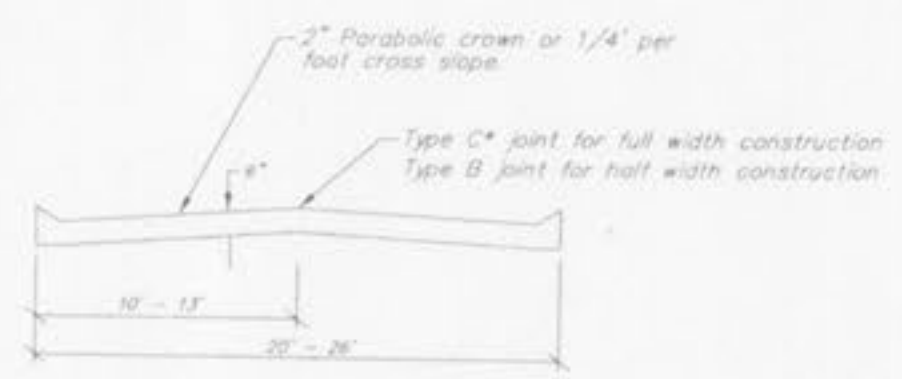

SECTION - 20'-26' WIDTH
 NOT TO SCALE

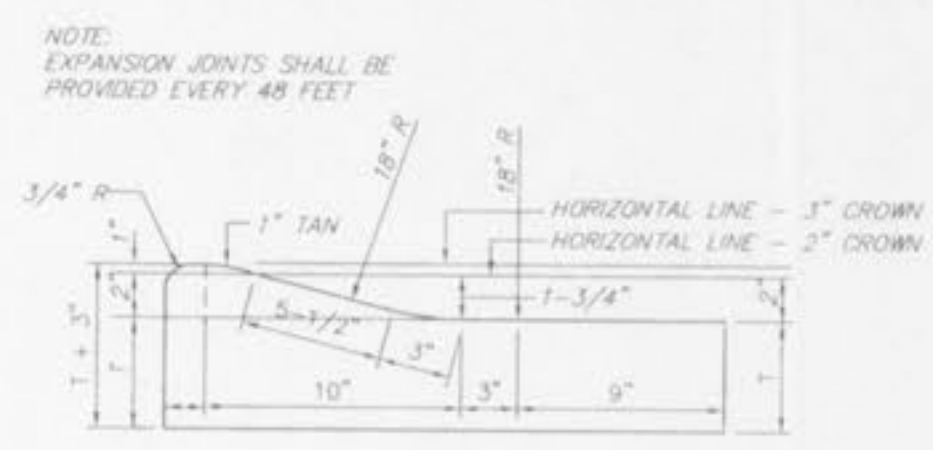

INTEGRAL ROLLED CURB
INTEGRAL CURB PAVEMENT TYPICAL SECTIONS AND DETAILS

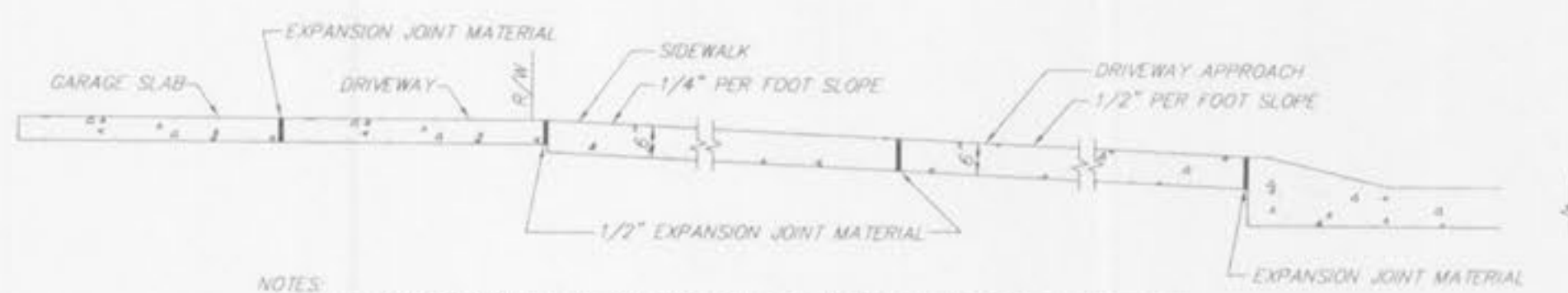

- NOTES:
 1. A 1/2" JOINT IS REQUIRED AT THE CURB AND GARAGE FOR ALL DRIVEWAYS LOCATED ON THE OUTER EDGE OF CURVED PAVEMENT.
 2. A 1/2" JOINT IS REQUIRED AT THE CURB AND GARAGE FOR ALL DRIVEWAYS LOCATED ON TANGENT SECTIONS OF PAVEMENT OR ON THE INNER EDGE OF CURVED PAVEMENT.
 3. EXPANSION JOINT MATERIAL MUST EXTEND THROUGH THE FULL DEPTH OF THE PAVEMENT.

INTEGRAL CURB DETAIL "B" AT DRIVEWAYS
 N.T.S.

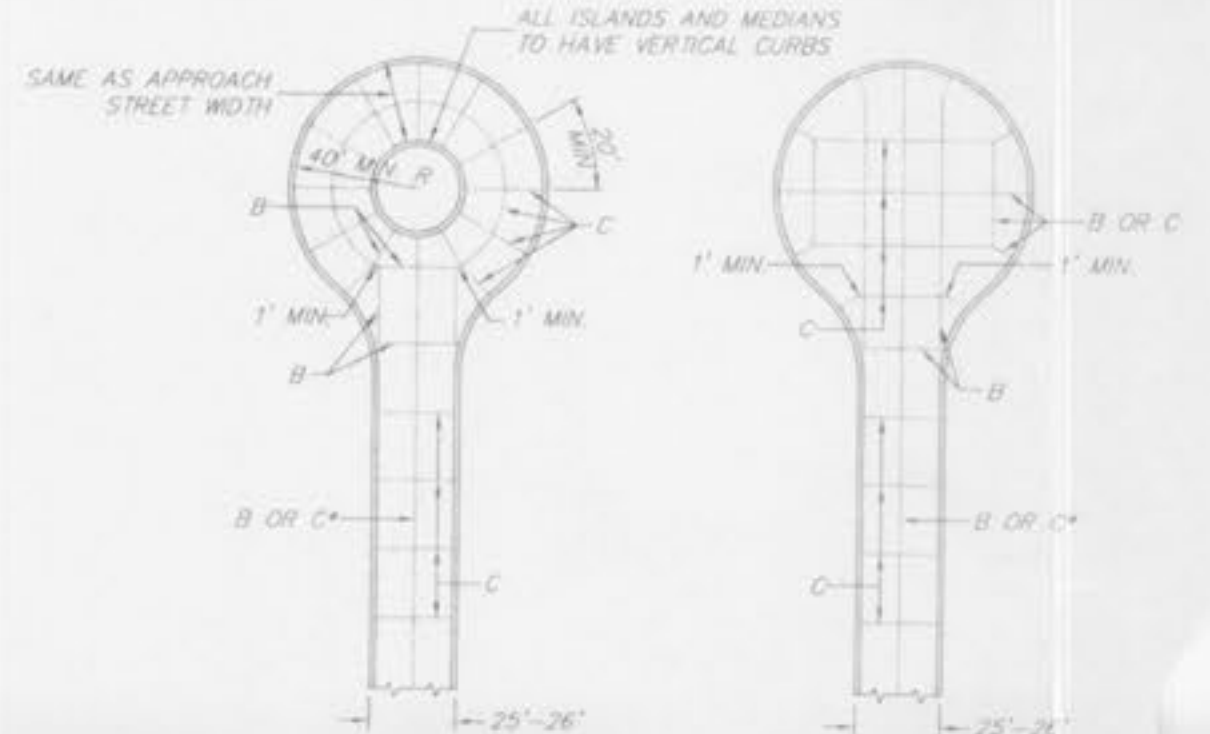
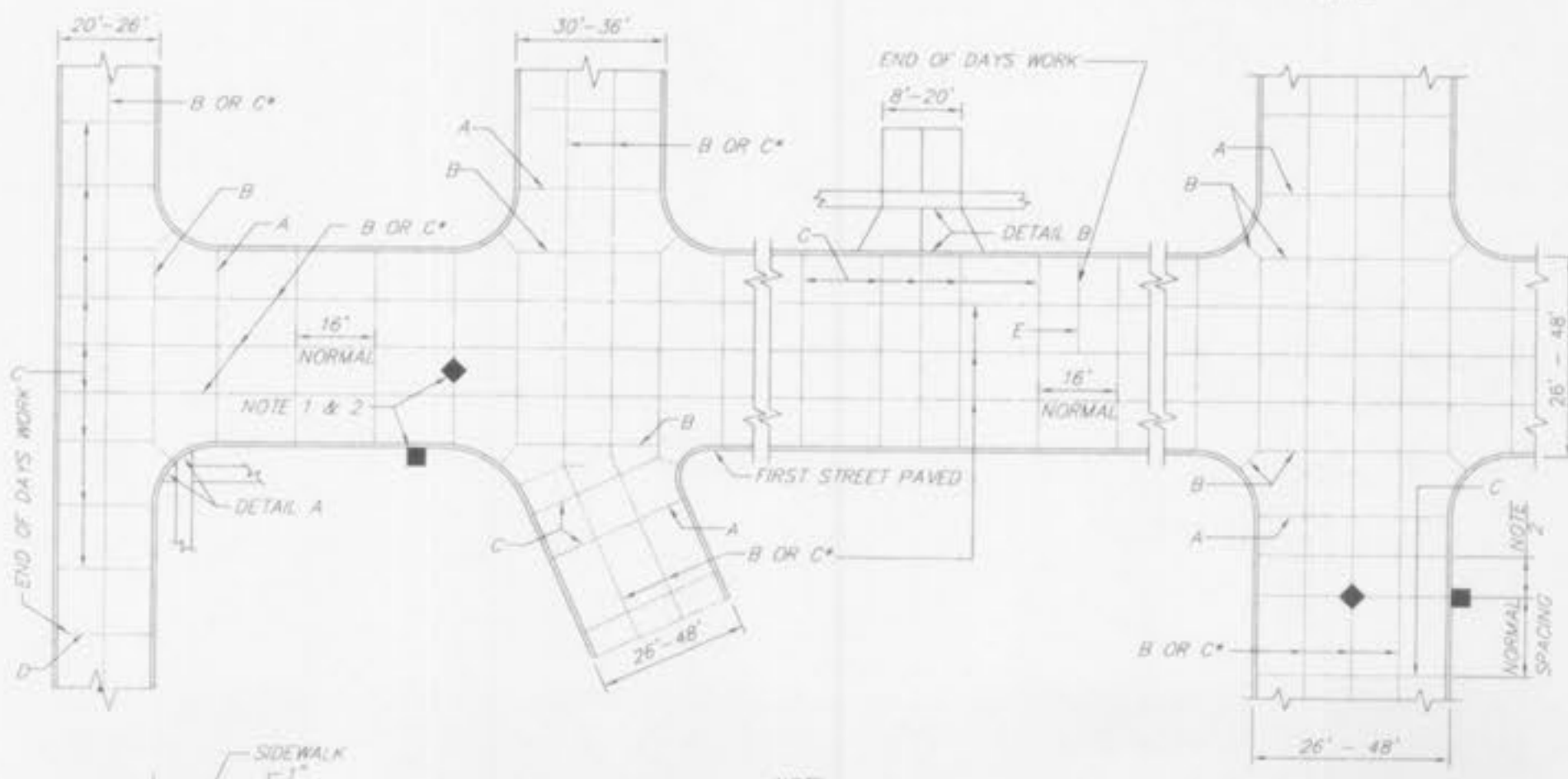

CUL-DE-SAC OPEN CENTER
 N.T.S.
 CUL-DE-SAC FULLY PAVED
 N.T.S.

NOTE:
 JOINT FILLER MATERIAL SHALL MEET ASTM DESIGNATIONS AS FOLLOWS:
 BRITUMINOUS TYPE - ASTM D-944-53
 NONEXTRUDING & RESILIENT BRITUMINOUS TYPE (FIBER) - ASTM 1751-50T
 NONEXTRUDING & RESILIENT NONBRITUMINOUS TYPE (RUBBER) - ASTM D-5249

PLAN OF JOINT LOCATION
 N.T.S.

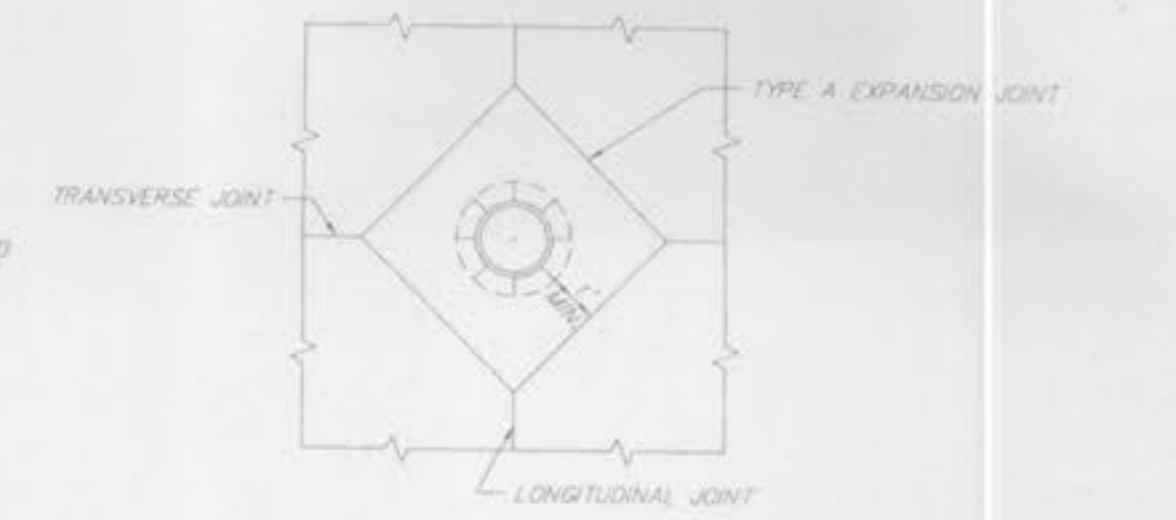

MANHOLE BOXING
 N.T.S.



INLET JOINT
 N.T.S.



SECTION A-A
 N.T.S.

- NOTES:
 1) ALL CATCH BASINS SHALL BE SEPARATED FROM THE PAVEMENT AND CURB BY EXPANSION JOINT MATERIAL EXTENDING COMPLETELY THROUGH CURB AND SLAB. MANHOLE CASTINGS WITHIN THE PAVEMENT LIMITS SHALL BE BORED IN AS SHOWN.
 2) WHEN A JOINT FALLS WITHIN 5 FEET OF OR CONTACTS BASIN, MANHOLES OR OTHER STRUCTURES, SHORTEN ONE OR MORE PANELS EITHER SIDE OF OPENING TO PERMIT JOINT TO FALL ON ROUND STRUCTURES AND AT OR BETWEEN CORNERS OF RECTANGULAR STRUCTURES.
 3) T = 6" ON LOCAL STREET.
 4) T = 7" ON MAJOR OR THRU STREET.

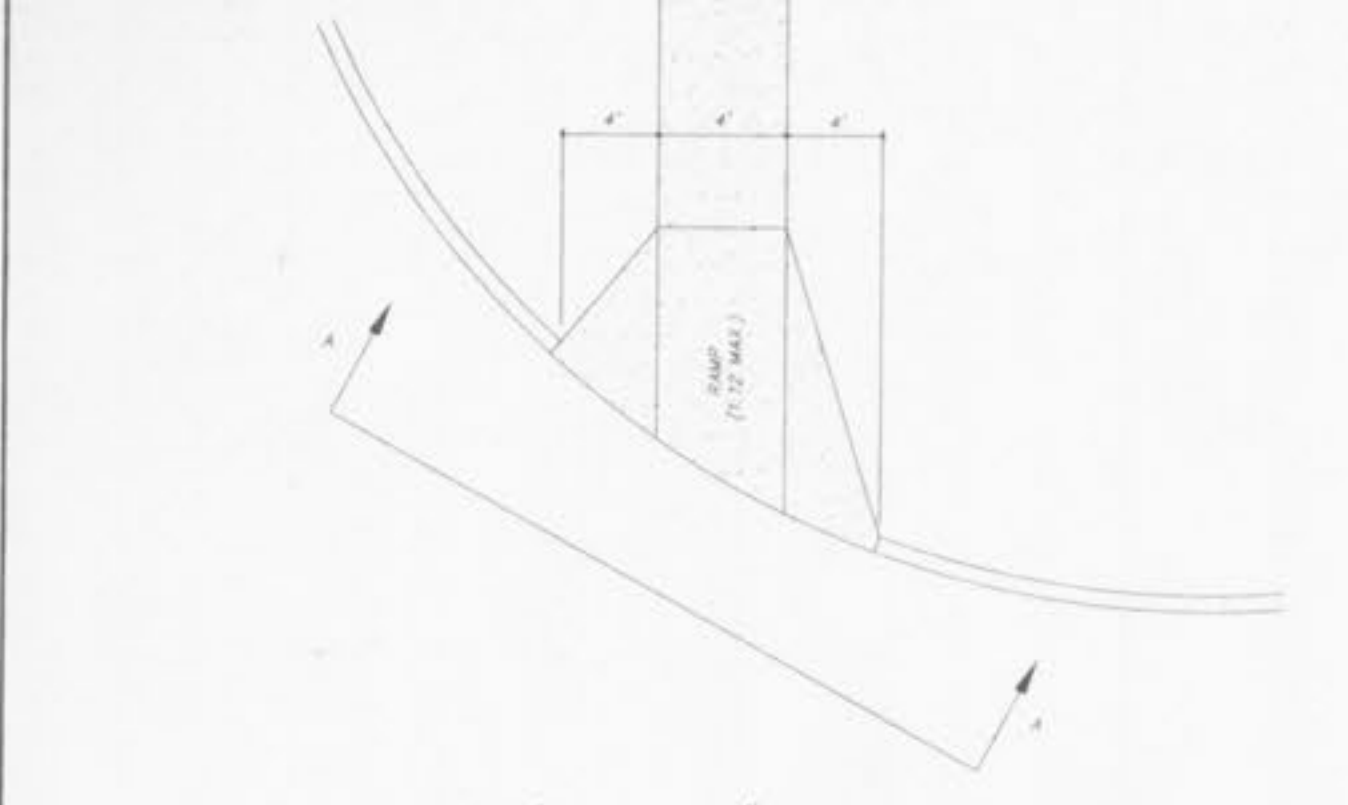

HANDICAPPED RAMP DETAIL
 NOT TO SCALE

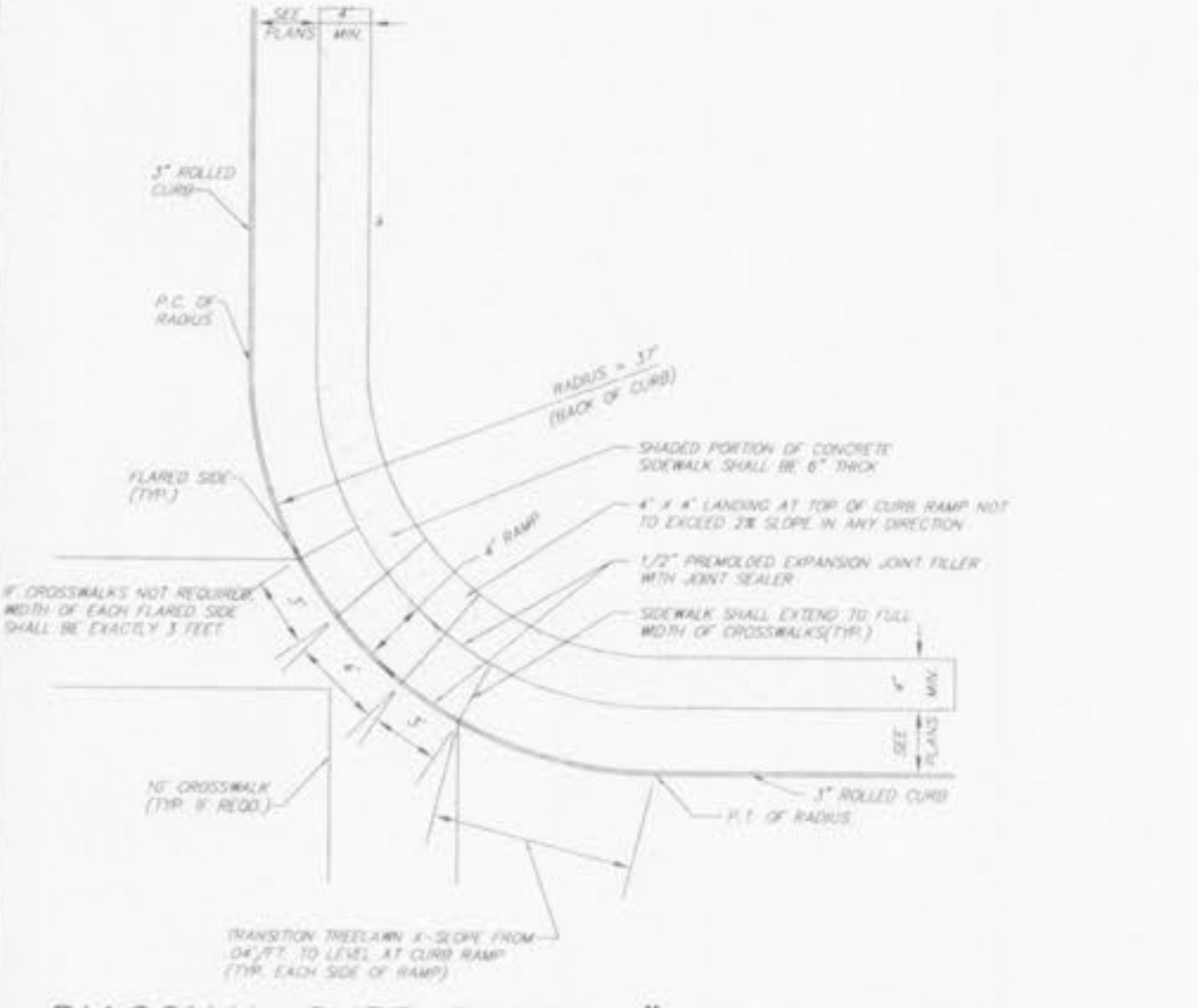

**DIAGONAL CURB RAMP-3\"/>
 (TYPE 9)
 NOT TO SCALE**

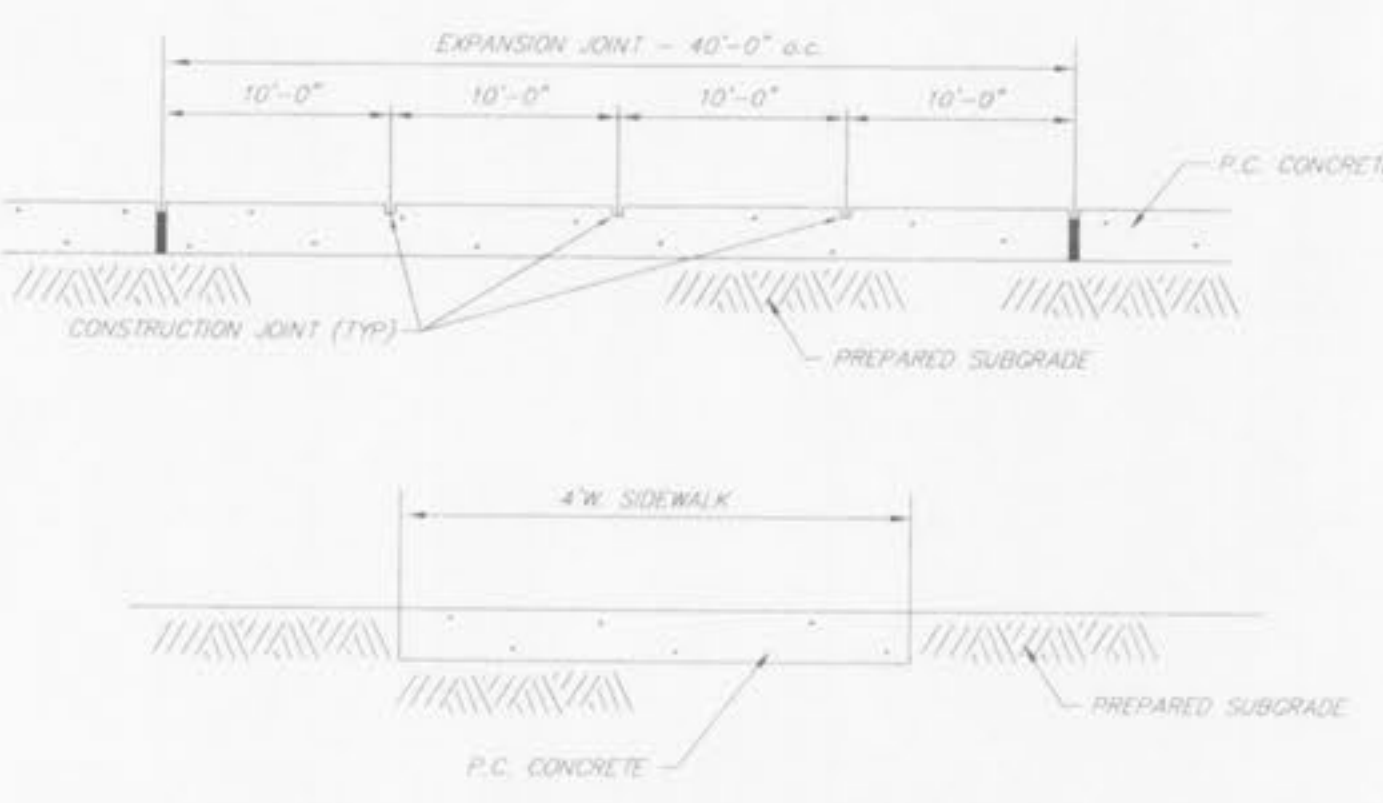

CONCRETE SIDEWALK DETAIL
 NOT TO SCALE

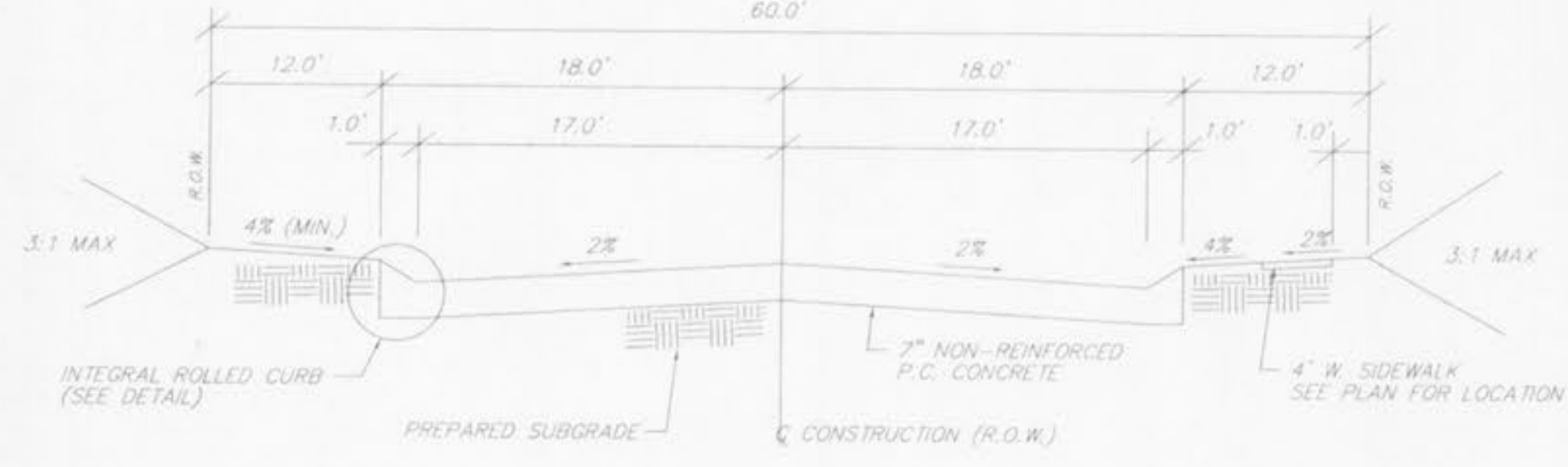

TYPICAL SECTION

(36" W. P.C. CONC. PVMNT.)
 (NOT TO SCALE)

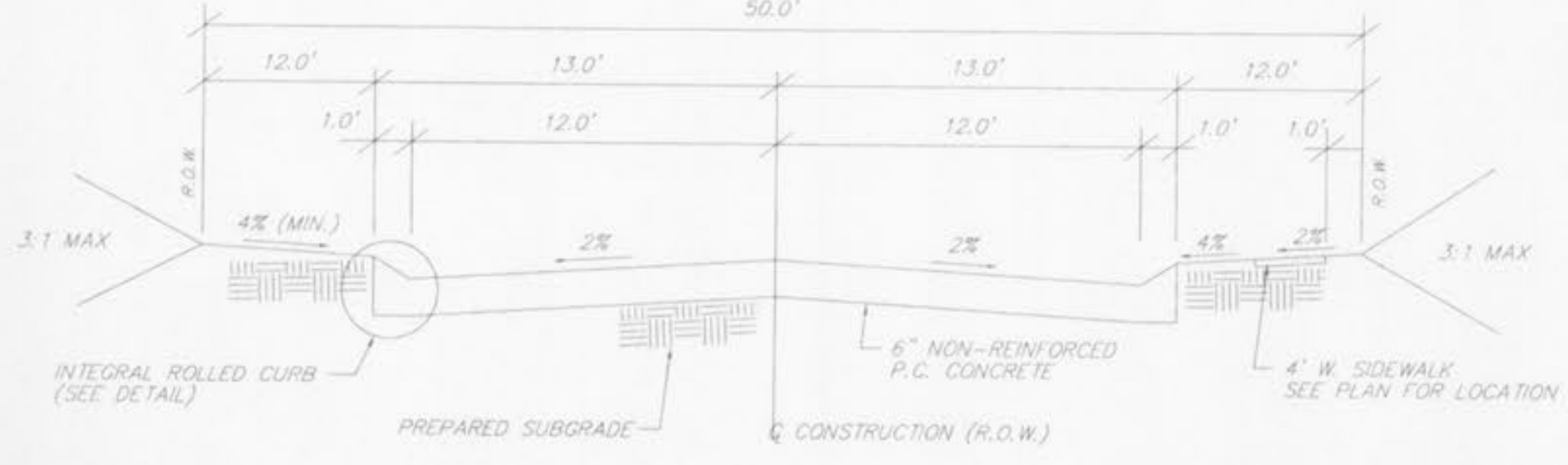

TYPICAL SECTION

(26" W. P.C. CONC. PVMNT.)
 (NOT TO SCALE)

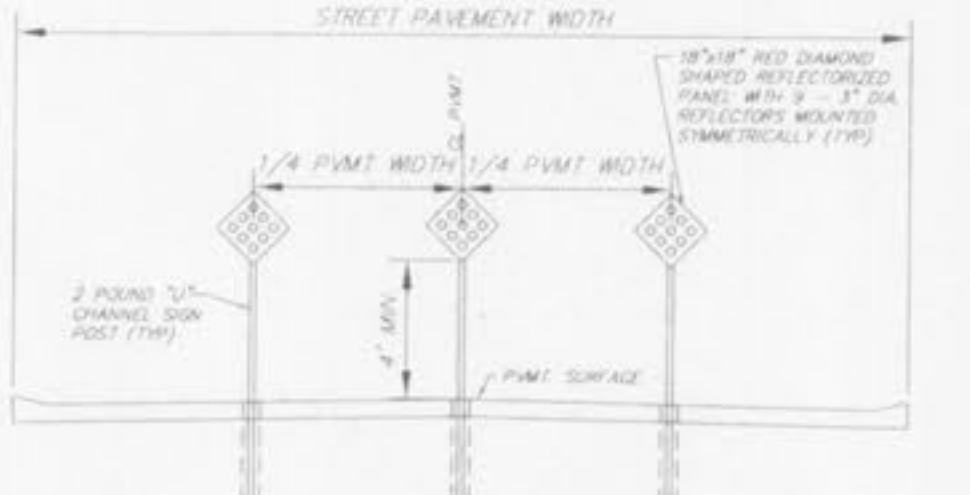

END OF PAVEMENT BARRICADE DETAIL
 NOT TO SCALE

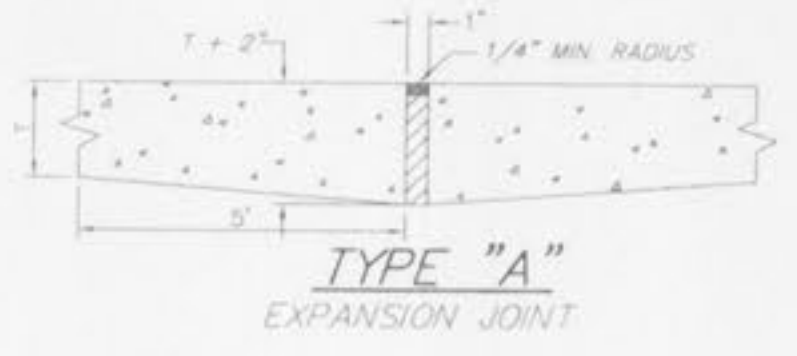

TYPE "A" EXPANSION JOINT

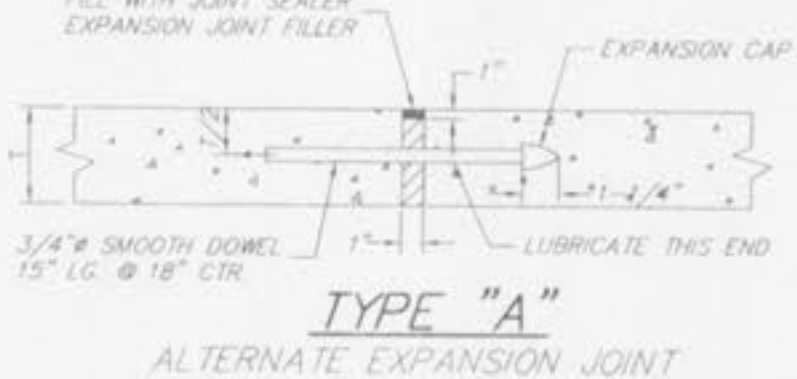

TYPE "A" ALTERNATE EXPANSION JOINT

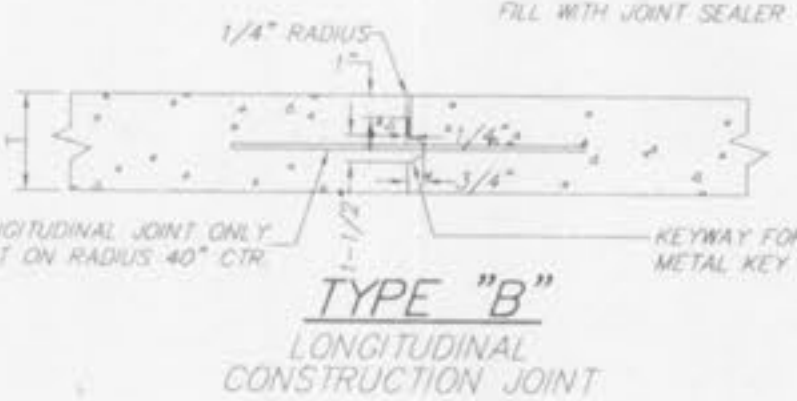

TYPE "B" LONGITUDINAL CONSTRUCTION JOINT

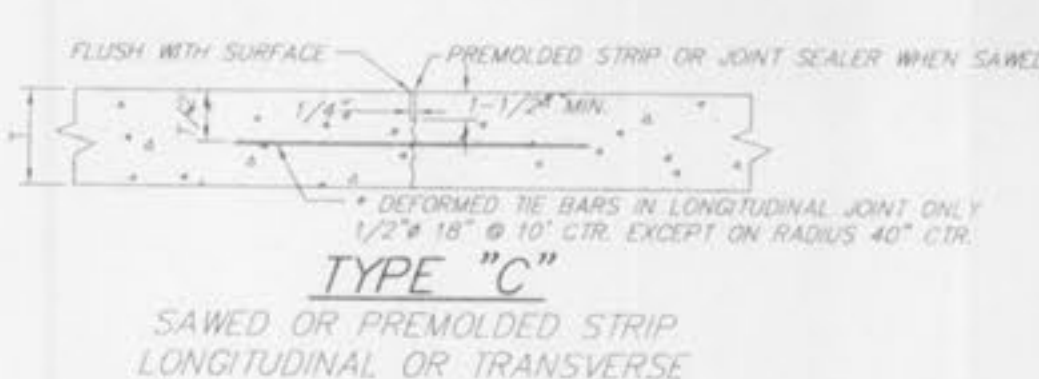

TYPE "C" SAWED OR PREMOULDED STRIP LONGITUDINAL OR TRANSVERSE JOINT

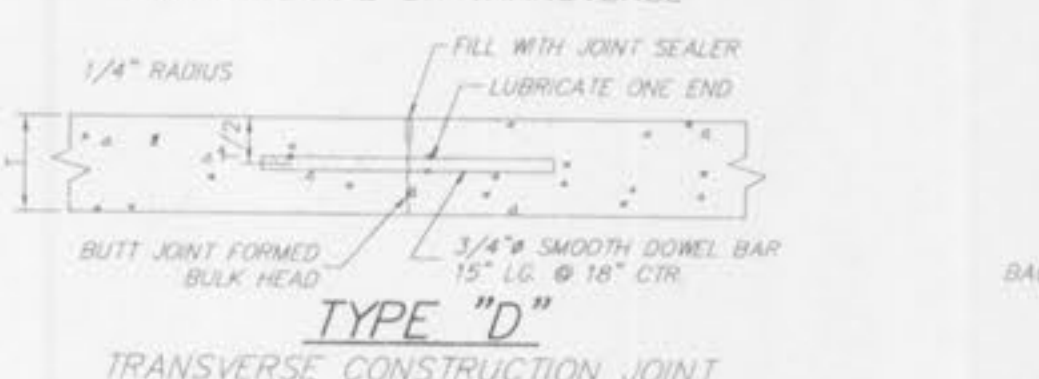

TYPE "D" TRANSVERSE CONSTRUCTION JOINT

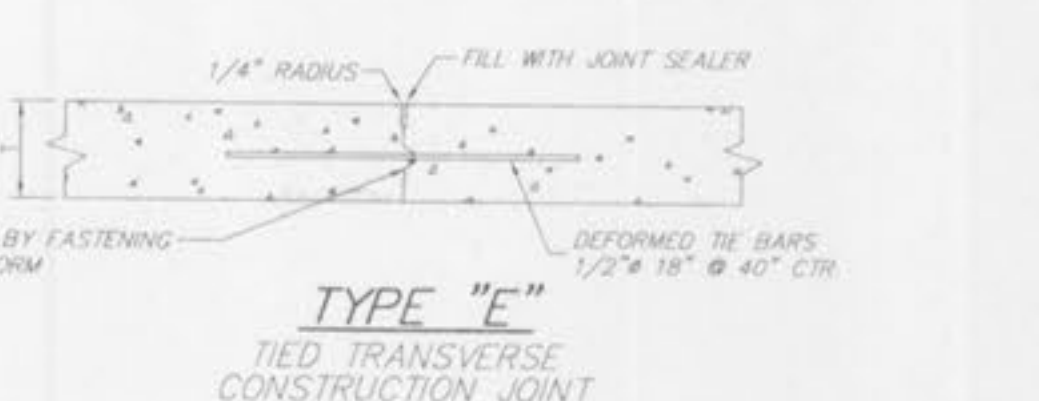

TYPE "E" TIED TRANSVERSE CONSTRUCTION JOINT

NOTE:
 Joint Sealer Material shall meet A.S.T.M. and A.A.S.H.T.O. Designations as follows:
 A.S.T.M. D-5405 - A.A.S.H.T.O. M-301 or A.S.T.M. D-1190-74 - A.A.S.H.T.O. M-173-84 or the latest revisions thereof.