

1. FILTER BARRIERS SHALL BE INSPECTED IMMEDIATELY AFTER EACH RAINFALL AND AT LEAST DAILY DURING PROLONGED RAINFALL. ANY REQUIRED REPAIRS SHALL BE MADE IMMEDIATELY.
2. SHOULD THE FABRIC DISCOURE OR BECOME WEAR/TEAR TO THE END OF THE EXPECTED USABLE LIFE AND THE BARRIER SHALL BE NECESSARILY THE FABRIC SHALL BE REPLACED PROMPTLY.
3. SEDIMENT DEPOSITS SHOULD BE REMOVED AFTER EACH STORM EVENT. THEY MUST BE REMOVED WHEN DEPOSITS REACH APPROXIMATELY HALF THE HEIGHT OF THE BARRIER.
4. ANY SEDIMENT DEPOSITS REMAINING IN PLACE AFTER THE SET FENCE OR FILTER BARRIER IS NO LONGER REQUIRED SHALL BE CLEARED TO CONFORM WITH THE EXISTING GRADE, PREPARED AND SLOPED.

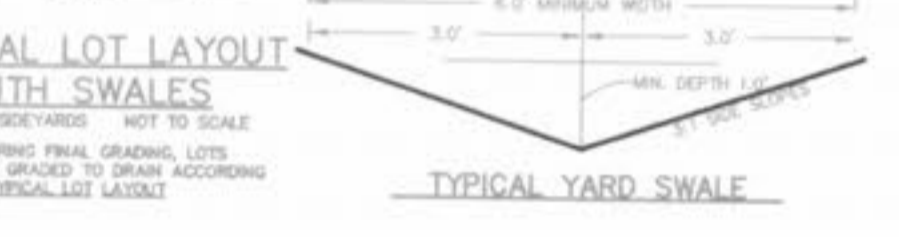

SILTATION FENCE DETAIL
 NOT TO SCALE

Length (ft)	Discharge (cfs)	Velocity (ft/sec)	Depth (ft)
1.0	0.000000	0.000000	0.000000
2.0	0.000000	0.000000	0.000000
3.0	0.000000	0.000000	0.000000
4.0	0.000000	0.000000	0.000000
5.0	0.000000	0.000000	0.000000
6.0	0.000000	0.000000	0.000000
7.0	0.000000	0.000000	0.000000
8.0	0.000000	0.000000	0.000000
9.0	0.000000	0.000000	0.000000
10.0	0.000000	0.000000	0.000000



TYPICAL LOT LAYOUT WITH SWALES
 MIN. SIDEWAYS NOT TO SCALE
 SIZE DURING FINAL GRADING, LOTS SHALL BE GRADDED TO CONFORM TO THE TYPICAL LOT LAYOUT

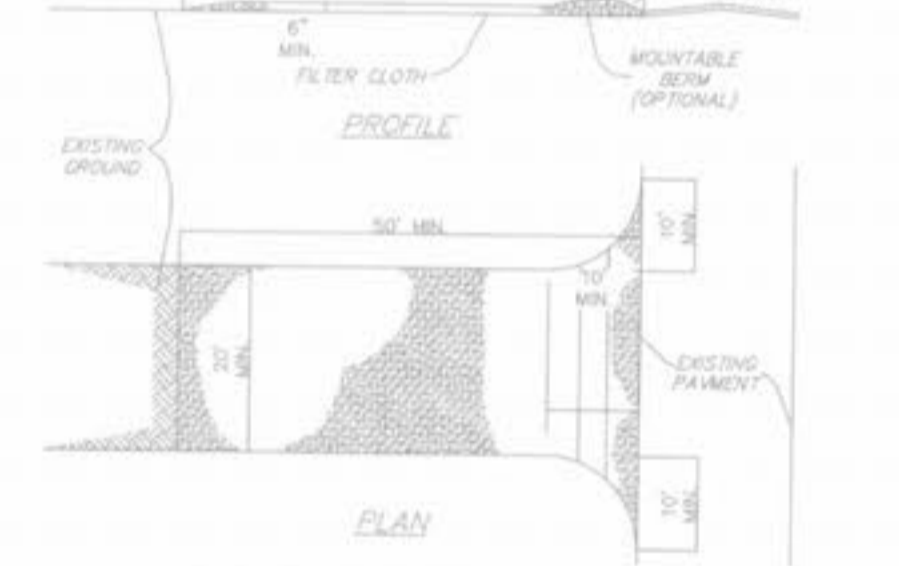

TYPICAL YARD SWALE

- CONSTRUCTION SPECIFICATIONS**
1. Stone Size - One 2" stone, or reclaimed or recycled concrete equivalent.
 2. Length - As required, but not less than 50 feet (except on a single residence lot where a 30 foot minimum length would apply).
 3. Thickness - Not less than six (6) inches.
 4. Width - Twenty (20) foot minimum, but not less than the full width at points where ingress or egress occurs.
 5. Filter Cloth - Will be placed over the entire area prior to placing of stone. Filter will not be required on a single family residence lot.
 6. Surface Rate - All surface water flowing or diverted toward construction entrances shall be placed across the entrance. If paving is impractical, a mountable berm with 5:1 slopes will be permitted.
 7. Maintenance - The entrance shall be maintained in a condition which will prevent tracking or flowing of sediment onto public right-of-way. This may require periodic top dressing with additional stone as conditions demand and repair and/or cleanout of any measures used to trap sediment. All sediment washed, dropped, washed or tracked onto public rights-of-way must be removed immediately.
 8. Washing - Wheels shall be cleaned to remove sediment prior to entrance onto public rights-of-way. When washing is required, it shall be done on a site established with stone and which drains into an approved sediment trapping device.
 9. Periodic inspection and needed maintenance shall be provided after each rain.



GRAPHIC SCALE
 (IN FEET)
 1 inch = 50 ft.

