

NOTE: EXPANSION JOINT MATERIAL SHALL BE INSTALLED IN THE WALK FOR ITS FULL WIDTH AND DEPTH AT INTERVALS OF APPROX. 50'. CONTROL JOINTS AT INTERVALS OF 1.5 TIMES ITS WIDTH.

INTEGRAL SIDEWALK & CURB

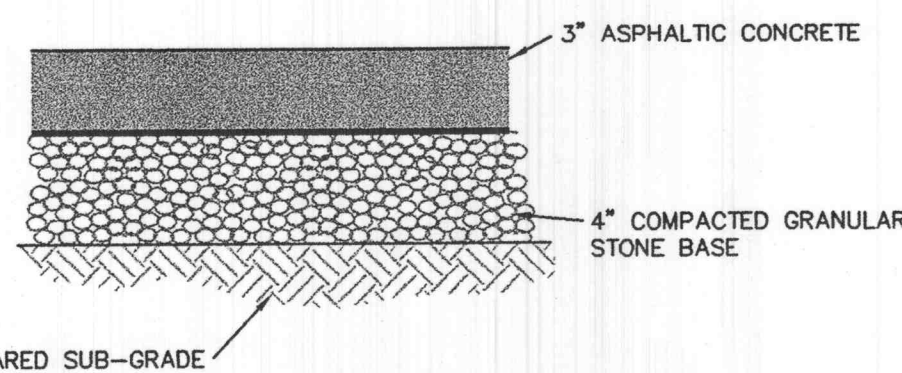

MULTI-USE TRAIL ASPHALT PAVEMENT

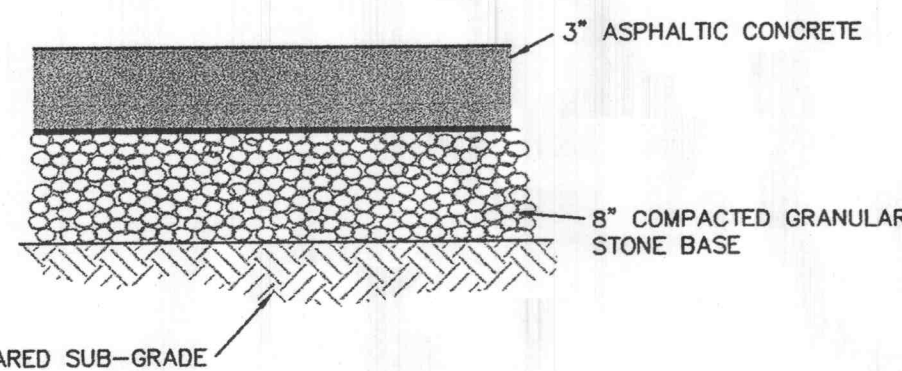

LIGHT DUTY ASPHALT PAVEMENT

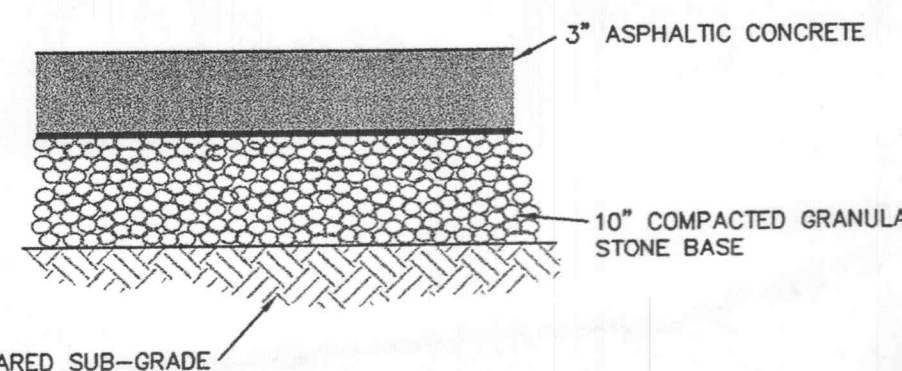

HEAVY DUTY ASPHALT PAVEMENT

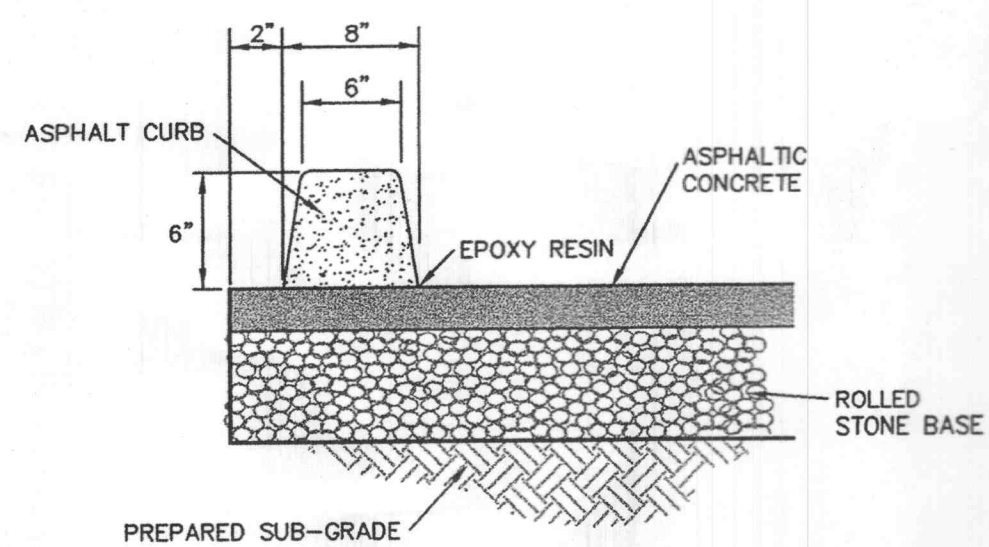

ASPHALT CURBING DETAIL
(AT END OF FUTURE DRIVE EXTENSIONS)

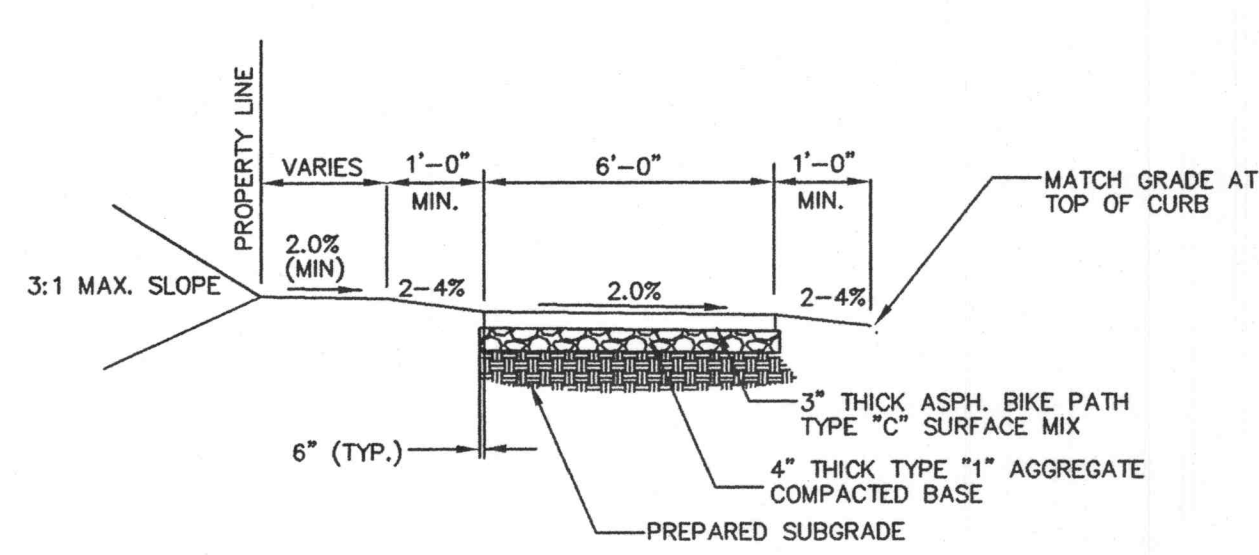

NOTES: PROVIDE CONCRETE HANDICAP RAMP WHERE TRAIL INTERSECTS ACCESS DRIVES OR STREETS OR WHERE TRAIL INTERSECTS WITH CURBING (SEE PLAN).

PROVIDE STRIPING OR A COLORED TEXTURED PAVEMENT THROUGH THE ACCESS DRIVES OR STREETS INTO THE DEVELOPMENT.

MAXIMUM SLOPE OF THE PATH SHALL NOT EXCEED 8% AND 2% CROSS SLOPE PER CITY OF FALLON SPECIFICATIONS.

THE TRAIL SHALL BE CONSTRUCTED WITH A CONSISTENT SLOPE WITH VERTICAL CURVES A MINIMUM OF 50' IN LENGTH. AFTER FINAL COMPRESSION, THE SURFACE SHALL BE SMOOTH AND TRUE TO THE ESTABLISHED CROWN AND GRADE. ANY LOW OR DEFECTIVE PLACES SHALL IMMEDIATELY BE REMEDIED BY CUTTING OUT THE COURSE AT SUCH SPOTS AND REPLACING IT WITH FRESH HOT MIXTURE, WHICH SHALL BE IMMEDIATELY COMPACTED TO CONFORM WITH THE SURROUNDING AREA AND SHALL BE THOROUGHLY BONDED TO IT. THE FINISHED PAVEMENT SHALL BE SET FREE FROM DEPRESSIONS EXCEEDING ONE-EIGHTH INCH AS MEASURED WITH A TEN-FOOT STRAIGHT EDGE PARALLELING THE CENTERLINE OF THE TRAIL.

MULTI-USE PATH DETAIL

OR 4" ASP./8" COMP. STONE BASE
1/20/04 F.G.

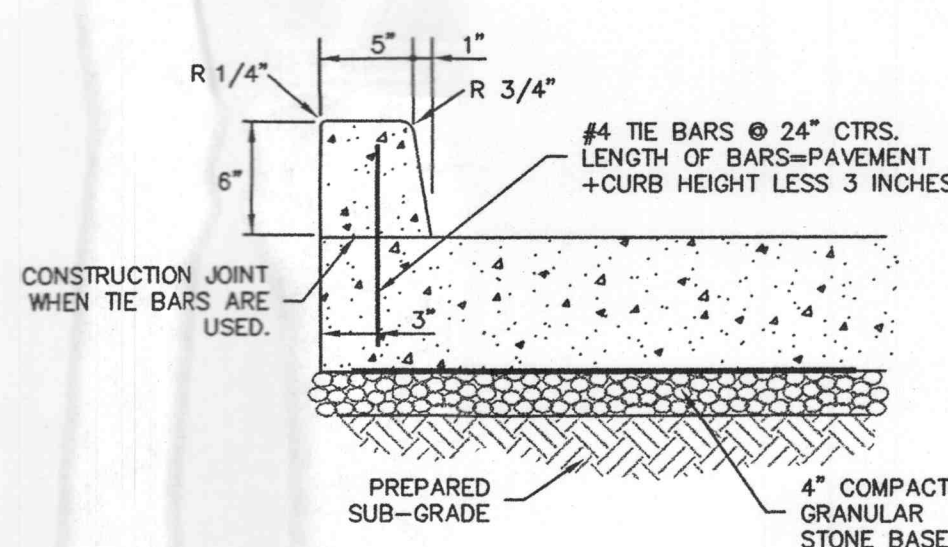

BARRIER CURBING DETAIL
PER STATE SPECIFICATIONS

NOTES:

1. ALL CONCRETE SHALL BE MIN. FC=3000 P.S.I.
2. ALL CONSTRUCTION MATERIALS AND METHODS OF CONSTRUCTION SHALL BE IN ACCORDANCE WITH ST. LOUIS COUNTY DEPARTMENT OF HIGHWAYS & TRAFFIC.
3. ANY UNSUITABLE SOIL (AS DETERMINED BY SOILS ENGINEER) BELOW STRUCTURE SHALL BE REMOVED AND REPLACED WITH SELECT EARTHEN MATERIAL COMPACTED IN PLACE WITH VIBRATORY TAMPER.
4. PROVIDE 1/2" EXPANSION JOINTS AT 20' CENTERS.

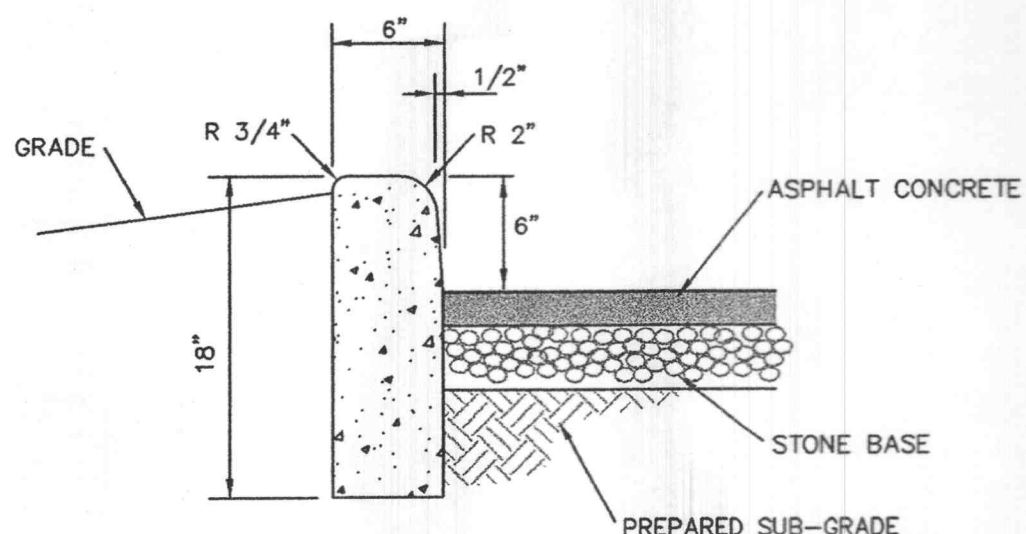

18" BARRIER CURB AND PAVEMENT DETAIL

PREPARED FOR:
AEDIS, INC.
6317 CLAYTON ROAD
CLAYTON, MO 63117
PH: (314) 862-1101
FAX: (314) 862-8001

STATE HIGHWAY K (WIDTH VARIES)

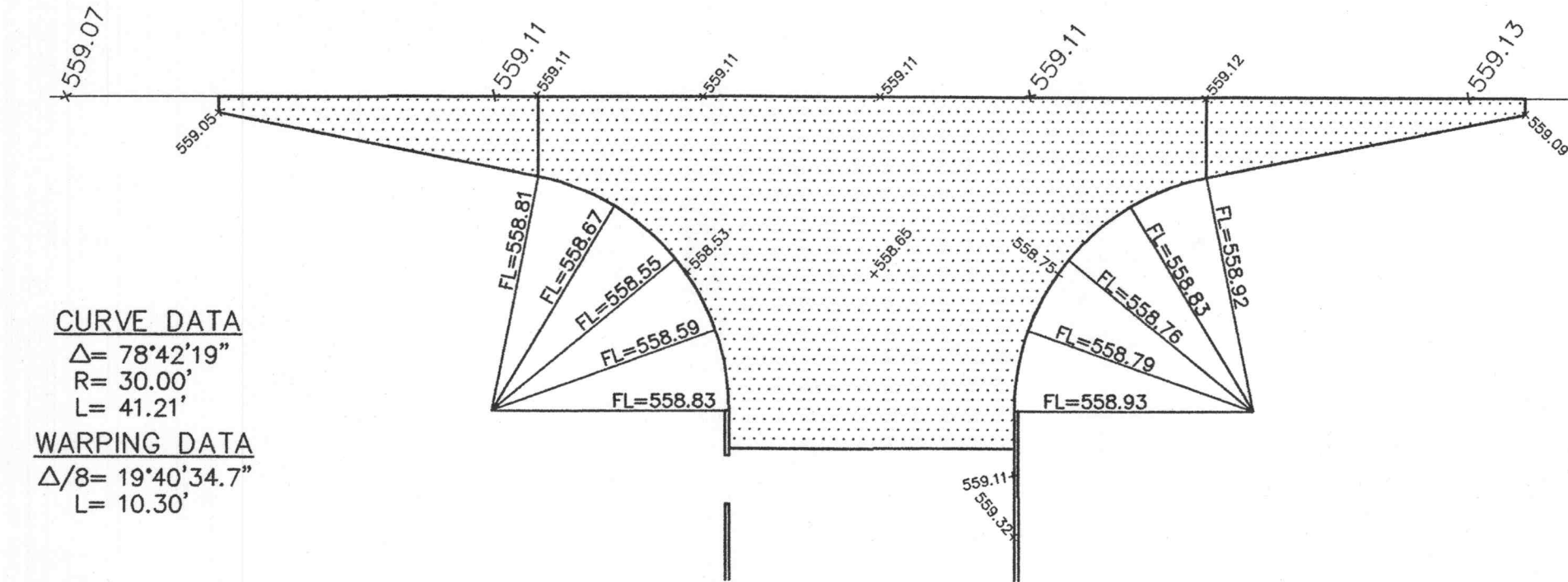

CURVE DATA
Δ= 78°42'19"
R= 30.00'
L= 41.21'
WARPING DATA
Δ/8= 19°40'34.7"
L= 10.30'

CURVE DATA
Δ= 78°42'19"
R= 30.00'
L= 41.21'
WARPING DATA
Δ/8= 19°40'34.7"
L= 10.30'

ENTRANCE WARPING

1"=20'

NOTE: ALL ELEVATIONS SHOWN ARE PAVEMENT GRADE. CURVE DATA TO BACK OF CURB.

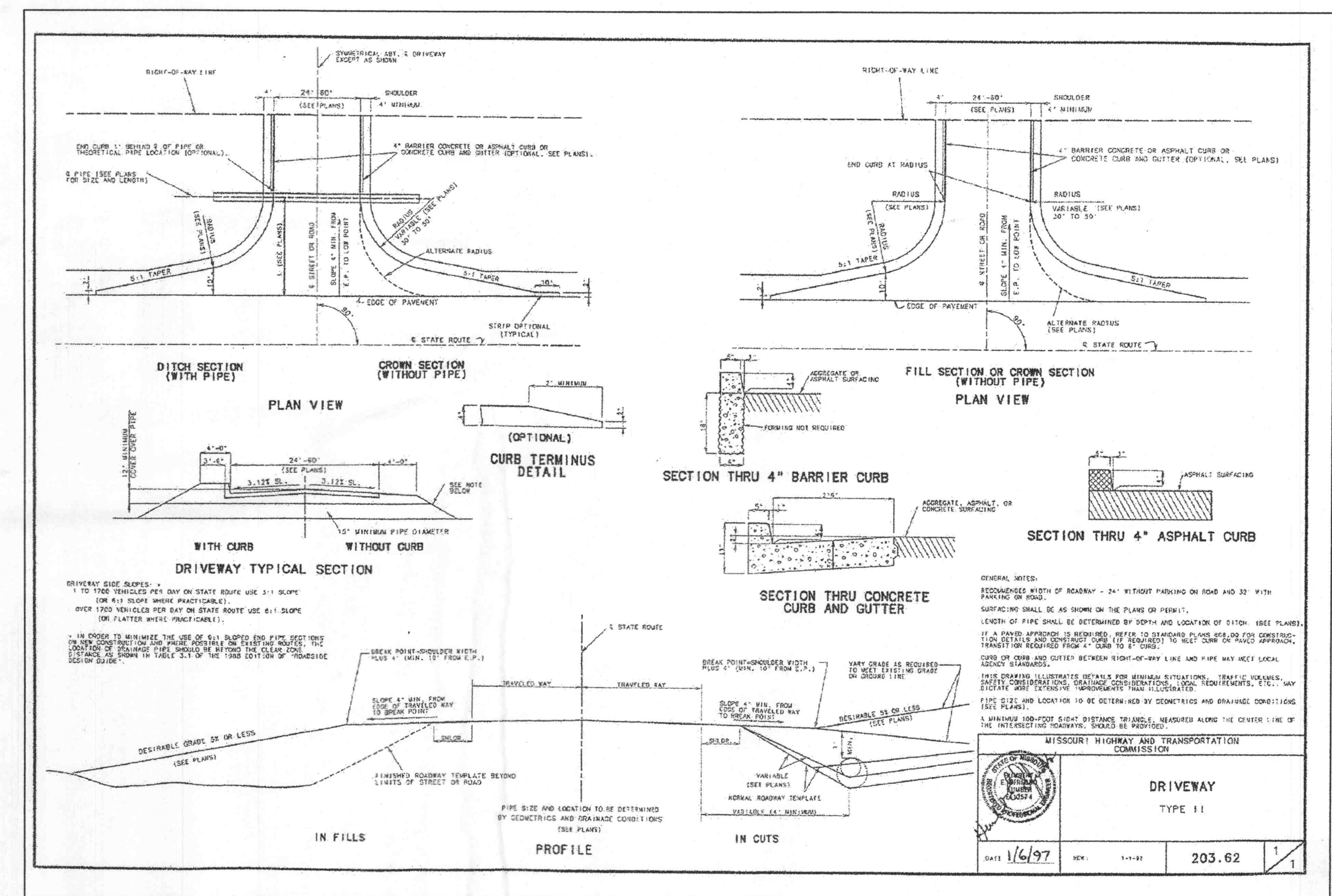

J. R. GRIMES CONSULTING ENGINEERS, INC. AND THE UNDERSIGNED ENGINEER HAVE NO RESPONSIBILITY FOR SERVICES PROVIDED BY OTHERS TO IMPLEMENT THE IMPROVEMENTS SHOWN ON THIS PLAN AND ALL OTHER DRAWINGS WHERE THE UNDERSIGNED ENGINEER'S SEAL APPEARS. THE CONSTRUCTION MEANS AND METHODS ARE THE SOLE RESPONSIBILITY OF THE OWNER AND CONTRACTOR. J. R. GRIMES CONSULTING ENGINEERS, INC. HAS NO RESPONSIBILITY TO VERIFY FINAL IMPROVEMENTS AS SHOWN ON THIS PLAN UNLESS SPECIFICALLY ENGAGED AND AUTHORIZED TO DO SO BY THE OWNER OR CONTRACTOR.

PLANNING & ZONING #: 4703

		BANK MIDWEST	
		PAVEMENT WARPING SHEET	
J. R. GRIMES CONSULTING ENGINEERS, INC.		12300 OLD TESSON ROAD SUITE 3000 ST. LOUIS, MO. 63128 PH. (314) 849-6100 FAX (314) 849-6010 E-MAIL jrgeng@mlnk.com	
		DRAWN BY: GJG DATE: 10/28/03	CHECKED BY: LJM DATE: 10/28/03

△ 11/20/03 PER CITY COMMENTS