

SEWER PROFILES
BAYFIELD

SCALE: 1" = 50'H.
1" = 10'V.

MARCH 15, 1989 83-1200N
REV. 3-1-89
REV. 3-15-89

FINAL SURVEY
NO. DATE
BY
REVISIONS
PLOTTED
NOTE BOOK
AREA
CHECKED

ORIGINAL SURVEY
NO. DATE
BY
REVISIONS
PLOTTED
NOTE BOOK
AREA
CHECKED

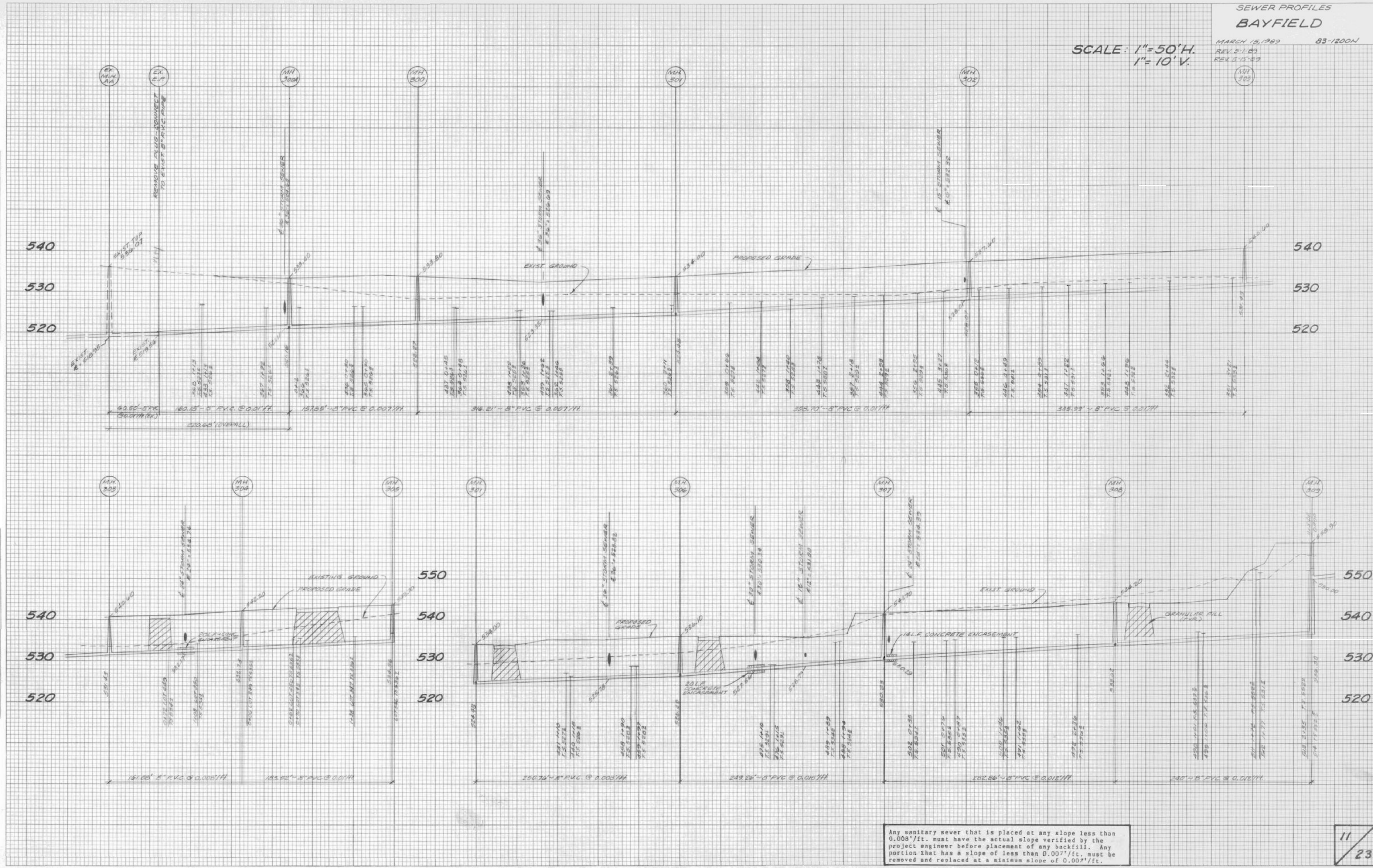

Any sanitary sewer that is placed at any slope less than 0.008'/ft. must have the actual slope verified by the project engineer before placement of any backfill. Any portion that has a slope of less than 0.007'/ft. must be removed and replaced at a minimum slope of 0.007'/ft.