

BRAMBLETT CROSSING

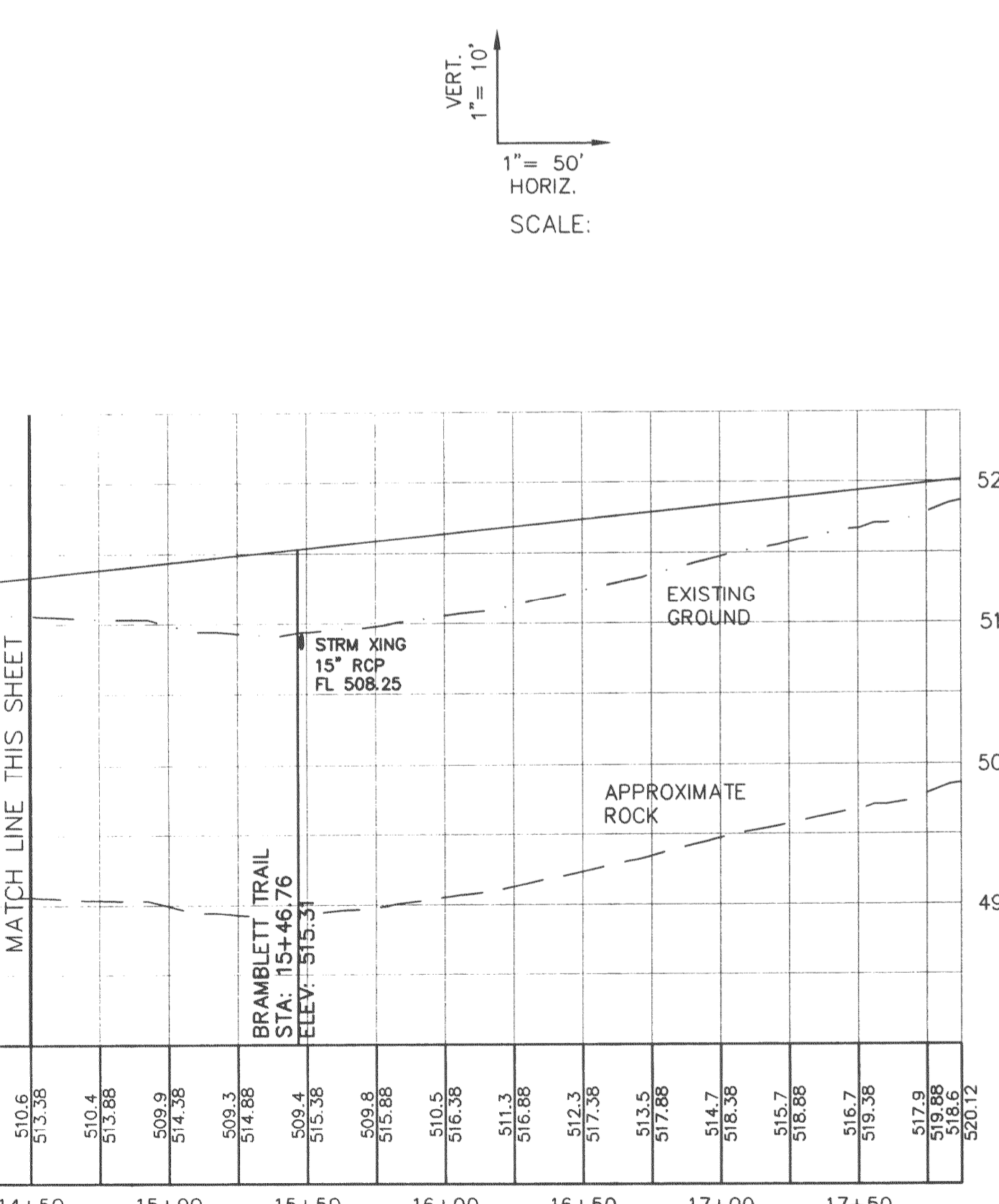

BRAMBLETT CROSSING

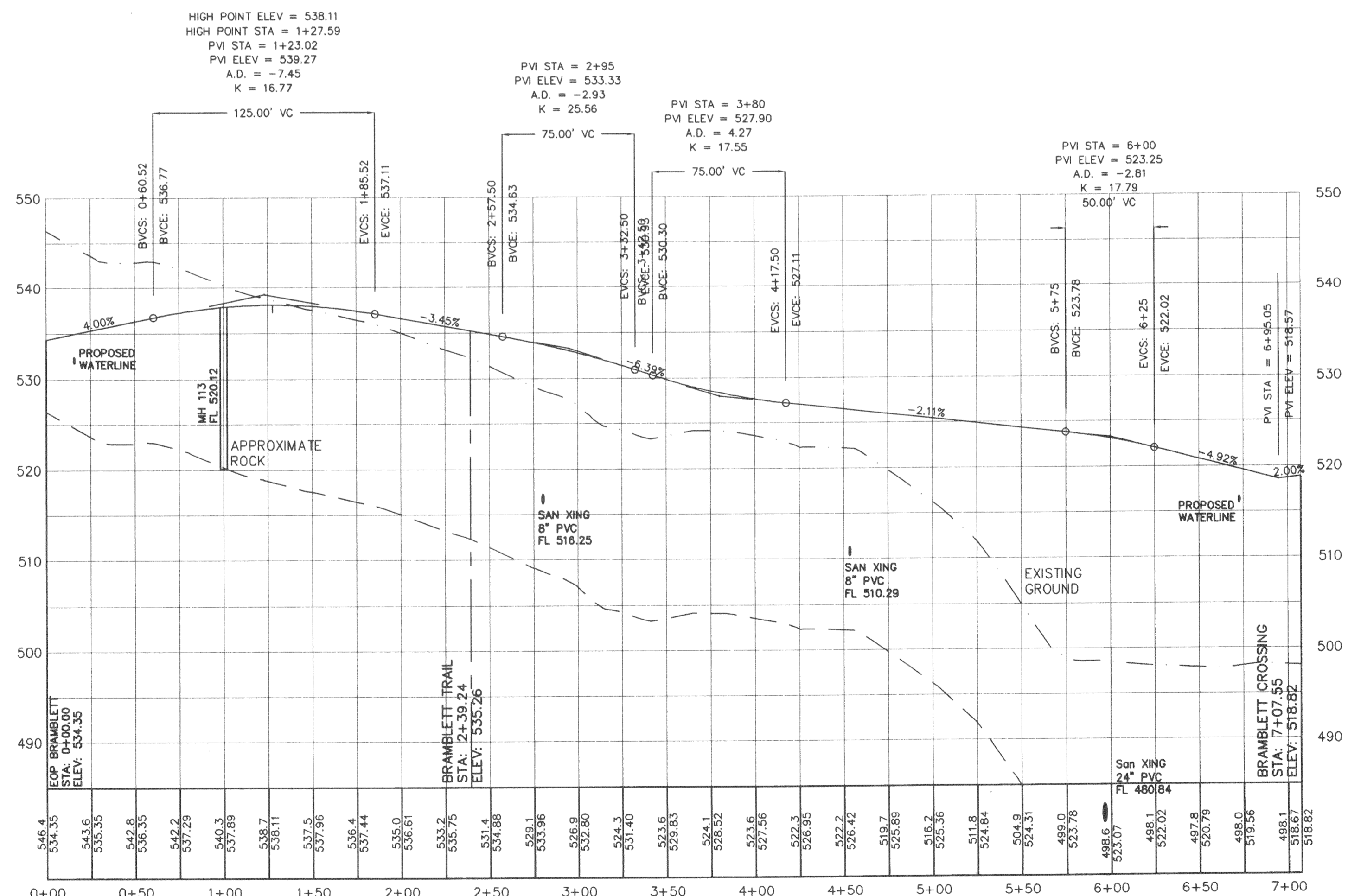

BRAMBLETT HILLS

02/18/08 REVISED PER CITY COMMENTS

BELLEAU CROSSING STREET

ST. CHARLES ENGINEERING & SURVEYING, INC.
 801 S. FIFTH STREET, SUITE 202
 ST. CHARLES, MO 63801
 TEL: (636) 947-0607 FAX: (636) 947-2448

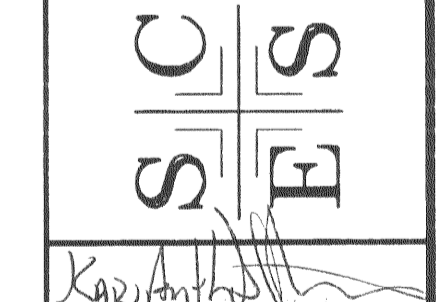

ORDER NO. 04-1419-01
 DATE

C-10

O'FALLON P+Z NO. 3805.05
 APPROVED AUGUST 16, 2007
 I:\041419\dwg\041419.dwg 05/01/08-2:39pm