

**GENERAL NOTES:**

1. THE INSTALLATION OF THE TRAFFIC SIGNALS SHALL BE IN ACCORDANCE WITH THE MISSOURI HIGHWAY AND TRANSPORTATION COMMISSION'S STANDARD SPECIFICATIONS, LATEST EDITION.
2. EXISTING UNDERGROUND AND OVERHEAD FACILITIES, STRUCTURES AND UTILITIES IF SHOWN ON THESE PLANS, SHALL BE CONSIDERED APPROXIMATE ONLY. VERIFICATION OF THE LOCATIONS OF ALL EXISTING UNDERGROUND FACILITIES, STRUCTURES AND UTILITIES, EITHER SHOWN OR NOT SHOWN ON THESE PLANS, SHALL BE THE RESPONSIBILITY OF THE CONTRACTOR, AND SHALL BE VERIFIED PRIOR TO ANY GRADING, EXCAVATION OR CONSTRUCTION OF IMPROVEMENTS. CALL MISSOURI ONE-CALL SYSTEM AT 1-800-DIG-RITE (344-7483).
3. TRAFFIC CONTROL SHALL BE THE RESPONSIBILITY OF THE CONTRACTOR AND SHALL CONFORM TO THE MANUAL ON UNIFORM TRAFFIC CONTROL DEVICES FOR STREETS AND HIGHWAYS AND MISSOURI DEPARTMENT OF TRANSPORTATION STANDARDS.
4. DIRECTIONAL BORING MAY BE USED INSTEAD OF TRENCHING OR PUSHING CONDUIT, HOWEVER, NO ADDITIONAL PAYMENT WILL BE MADE.
5. THE TRAFFIC SIGNAL CONSTRUCTION SHALL BE COORDINATED WITH THE ROADWAY CONSTRUCTION.
6. REFER TO THE ROADWAY PLANS FOR STRIPING AND SIGNING EXCEPT FOR SIGNS MOUNTED ON SIGNAL EQUIPMENT.
7. ALL PEDESTRIAN FACILITIES MUST COMPLY TO CURRENT ADA STANDARDS.
8. THE CONTRACTOR WILL BE RESPONSIBLE FOR SPOTTING THE LOCATION OF ALL SIGNAL EQUIPMENT. THE CONTRACTOR SHALL NOTIFY THE CITY OF O'FALLON A MINIMUM OF ONE WEEK IN ADVANCE OF THE DESIRED DATE OF INSTALLATION.
9. CONCRETE BASES SHALL BE REMOVED A MINIMUM OF 6 INCHES BELOW GRADE.
10. ANY EQUIPMENT REMOVED FROM THIS LOCATION AND NOT UTILIZED IN THE FINAL INSTALLATION SHALL REMAIN THE PROPERTY OF THE CITY OF O'FALLON AND SHALL BE TRANSPORTED TO CITY STREET DIVISION BUILDING AT 405 COOL SPRINGS RD, O'FALLON, MO.
11. ALL UNUSED TRAFFIC SIGNAL PULL BOXES SHALL BE REMOVED, ALL UNUSED CABLE SHALL BE REMOVED, AND UNUSED CONDUIT ABANDONED.

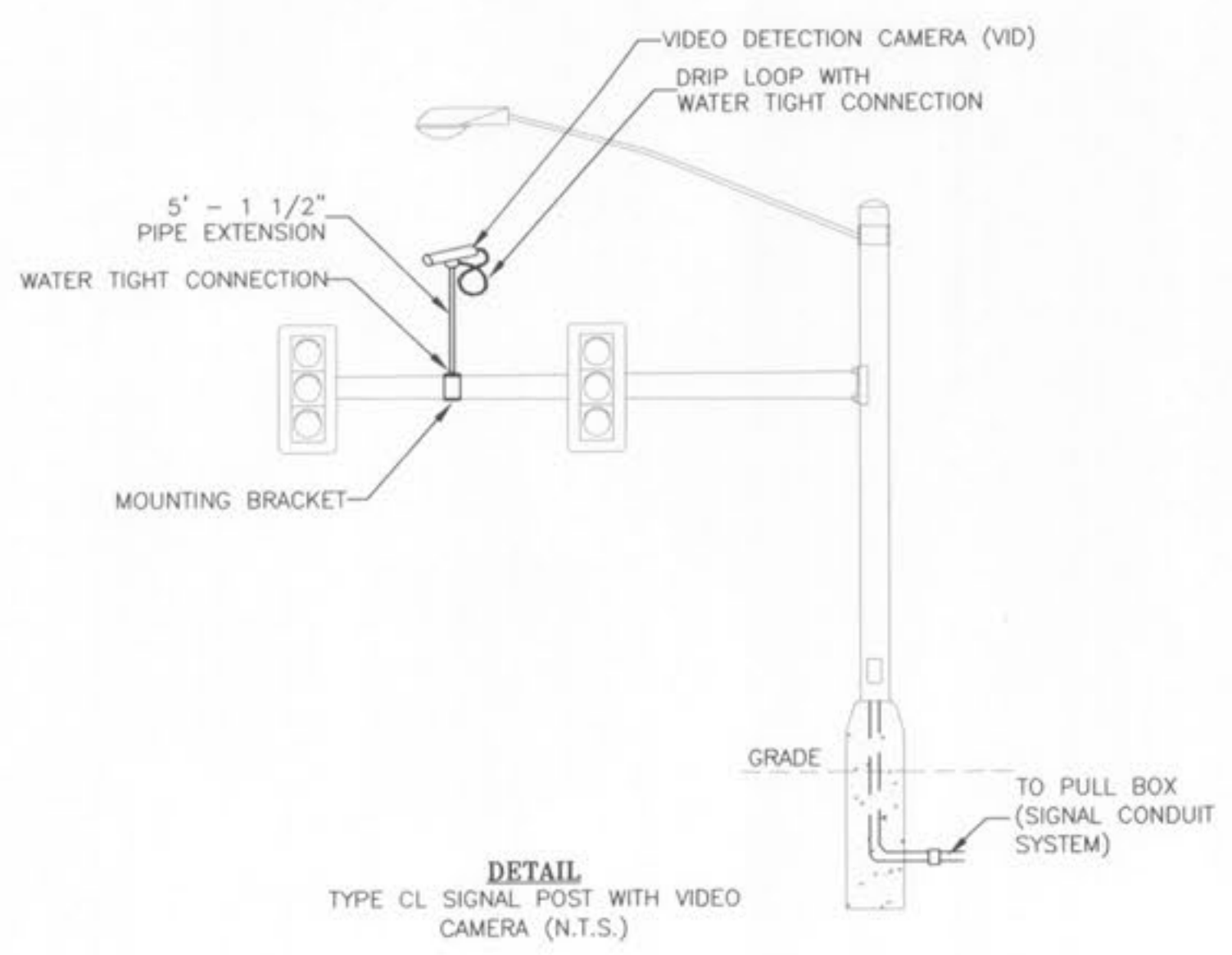
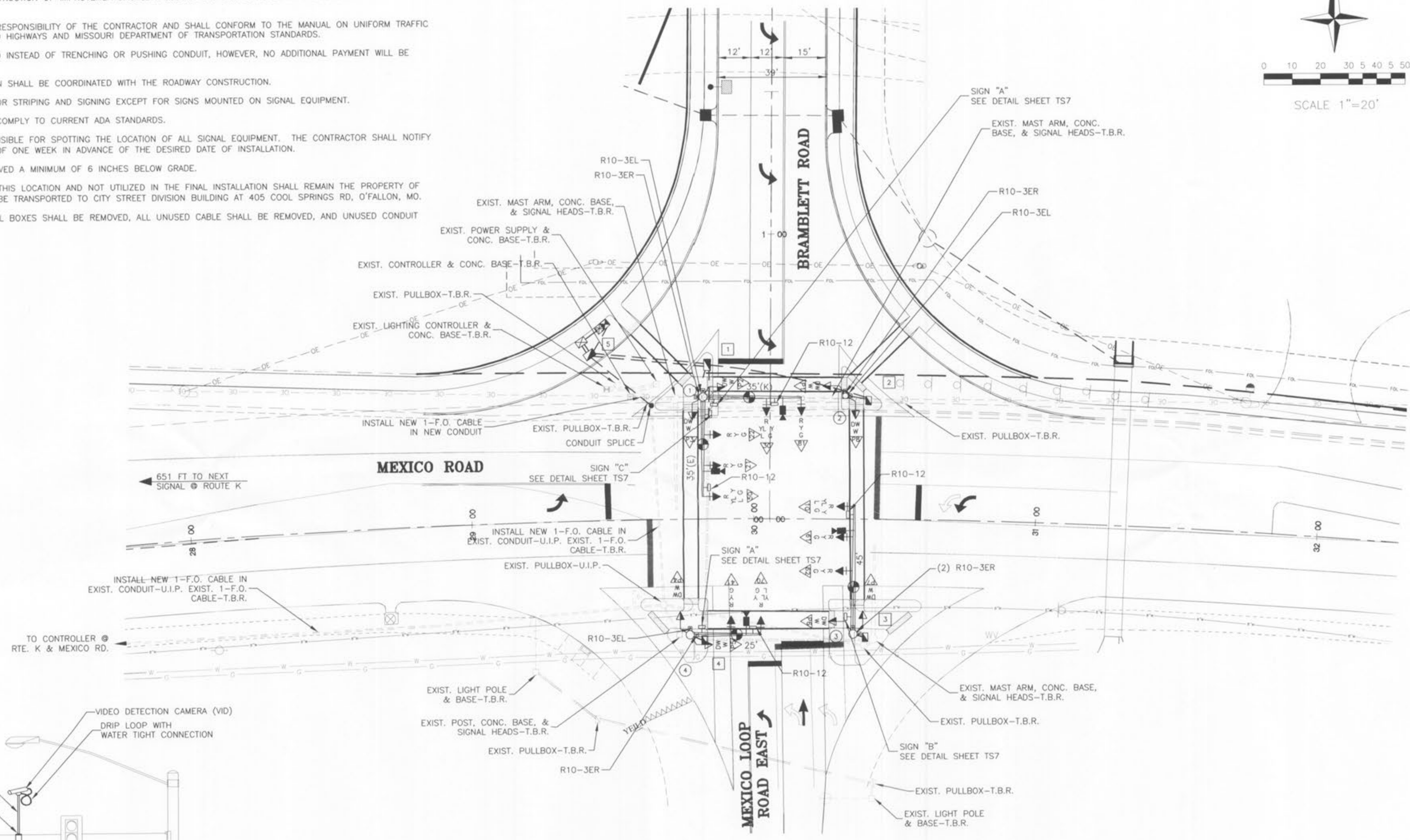
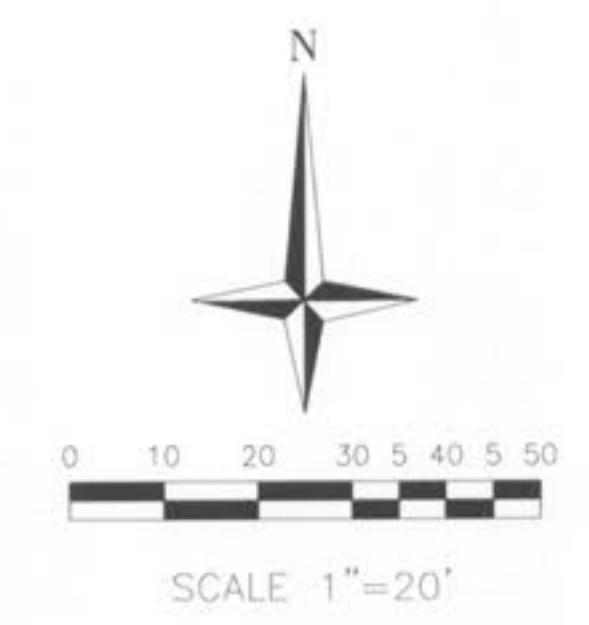

SHEET NO.  
**TS1**

Job No. 238-07  
Scale: 1"=20'  
Drawn by: D.J.  
Design by: N.N.  
Approved by: R.S.  
File Name: TS238-07

ISSUE RECORD	
4/13/09	50% PRELIMINARY DESIGN
6/5/09	90% DESIGN SUBMITTAL
7/17/09	100% FINAL SUBMITTAL

7/17/09

**CBB** Crawford Bunte Brammeyer  
Traffic and Transportation Engineers

St. Louis, Missouri/Glen Carbon, Illinois  
314-878-6644 618-656-2612  
Fax: 314-878-5876 E-Mail: cbb@cbbtraffic.com

**TRAFFIC SIGNAL PLAN**

**MEXICO ROAD AND BRAMBLETT ROAD/MEXICO LOOP ROAD EAST O'FALLON, MISSOURI**