

Luminaire Schedule						
Symbol	Qty	Label	Arrangement	Lumens	LLF	Description
+	6	SA	SINGLE	20500	0.780	TLM-250-MH-XX-SL-FG
○	9	SB	SINGLE	5900	0.880	BRC-70-MH
○	13	SC	SINGLE	2400	0.800	PD6-V14ZE-6VC

TYPE SA FIXTURES MOUNTED ON 22' POLE WITH TWO FOOT BASE

Calculation Summary							
Label	CalcType	Units	Avg	Max	Min	Avg/Min	Max/Min
PARKING LOT	Illuminance	Fc	2.02	115	0.0	N.A.	N.A.
NON PARKING	Illuminance	Fc	0.19	3.5	0.0	N.A.	N.A.

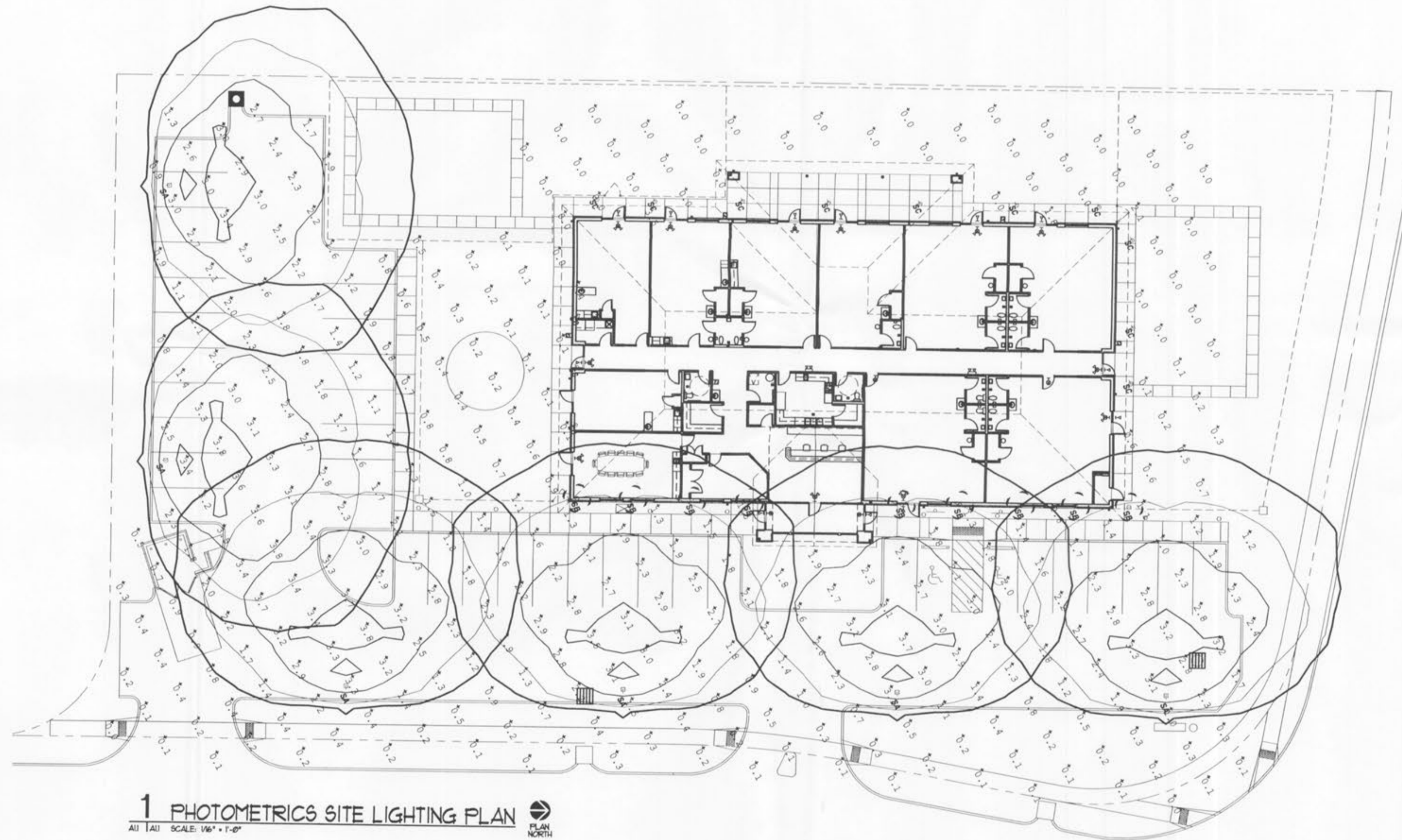

LePIQUE & ORNE ARCHITECTS, INC.
 ESTABLISHED 1916
 701 N. FIFTH STREET
 SAINT CHARLES, MO 63301
 PHONE (636) 947-0099
 FAX (636) 947-8700

MISSOURI STATE
 CERTIFICATE OF AUTH. #
 A-000508-D

STRUCTURAL
AEDIFICA CASE
ENGINEERING
 MO CA# E-1875-D
 782 MERUS COURT
 ST. LOUIS, MO 63026
 STEVEN J. SACCO
 PHONE (636) 349-1600
 FAX (636) 349-1700

M/P/E
FACILITY ENGINEERING
SERVICES LLC
 MO CA# E-2004011833-D
 13067 WINDING TRAIL LN
 ST. LOUIS, MO 63131
 JACK HOPSON
 PHONE (314) 821-1339
 FAX (314) 822-9736

NEW DAYCARE AND EDUCATION FACILITY FOR:
BETH ACADEMY DAYCARE
BETH HOLDINGS, L.L.C.
 KEATON CROSSING & KEATON CORPORATE PARKWAY
 O'FALLON, MO 63368

DATE	ISSUE	R.#
4/29/10	OWNER REVIEW	
5/7/10	PERMIT & BID ISSUE	

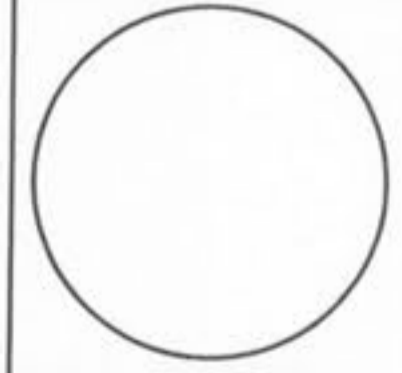

DENNIS GRAY ORNE
 ARCHITECT
 MO# A-004559

PROJECT MANAGER: KSB
 DRAWN BY: KSB

PROJECT NUMBER
 09-101
 DATE
 May 7, 2010

SHEET
PH-1
PHOTOMETRICS
SITE LIGHTING
PLAN